



(12) **EUROPEAN PATENT APPLICATION**

(88) Date of publication A3:  
**23.11.2016 Bulletin 2016/47**

(51) Int Cl.:  
**H02K 29/08 (2006.01) H02K 11/00 (2016.01)**

(43) Date of publication A2:  
**07.04.2010 Bulletin 2010/14**

(21) Application number: **09275095.9**

(22) Date of filing: **06.10.2009**

(84) Designated Contracting States:  
**AT BE BG CH CY CZ DE DK EE ES FI FR GB GR HR HU IE IS IT LI LT LU LV MC MK MT NL NO PL PT RO SE SI SK SM TR**  
Designated Extension States:  
**AL BA RS**

(72) Inventors:  
• **Onozawa, Izumi**  
**Toshima-ku Tokyo (JP)**  
• **Miyazawa, Masashi**  
**Toshima-ku Tokyo (JP)**

(30) Priority: **06.10.2008 JP 2008260094**

(74) Representative: **Wilson Gunn**  
**Blackfriars House**  
**The Parsonage**  
**5th Floor**  
**Manchester M3 2JA (GB)**

(71) Applicant: **Sanyo Denki Co., Ltd.**  
**Tokyo (JP)**

(54) **Brushless motor stator**

(57) A brushless motor stator is provided that may be applied to a plurality of types of motors having different rotational speeds, merely by providing one type of a circuit substrate. A pair of fitting convex portions that project radially outside of a virtual circle centering on a center line C are formed on one insulator divided body of a slot insulator. Three pairs of diagonally located fitting concave portions are formed in an inner circumferential wall portion surrounding a through-hole of a circuit substrate. The pair of fitting convex portions of the one insulator divided body are fitted in one of the three pairs of fitting concave portions. With this, a positional relationship between three hall elements and stator magnetic poles is selected, corresponding to the speed range of a motor to be used.

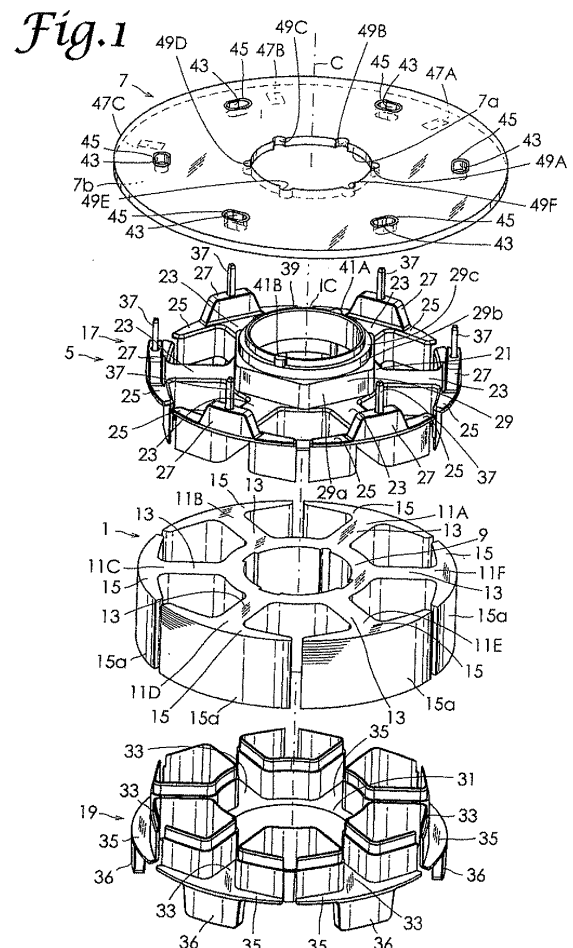



## EUROPEAN SEARCH REPORT

Application Number  
EP 09 27 5095

5

10

15

20

25

30

35

40

45

50

55

DOCUMENTS CONSIDERED TO BE RELEVANT			
Category	Citation of document with indication, where appropriate, of relevant passages	Relevant to claim	CLASSIFICATION OF THE APPLICATION (IPC)
Y	WO 2008/027535 A2 (SEARS DAVID B [US]; MOIR MICHAEL BRUCE [US]; THOMAS PETER JEFFREY [US]) 6 March 2008 (2008-03-06) * paragraph [0044] - paragraph [0046] * * paragraph [0056] - paragraph [0061] *	1-9	INV. H02K29/08 H02K11/00
Y	JP H06 70525 A (MATSUSHITA ELECTRIC IND CO LTD) 11 March 1994 (1994-03-11) * paragraphs [0010], [0011] *	1-9	
Y	US 4 540 906 A (BLOM HANS A [US]) 10 September 1985 (1985-09-10) * column 3, line 17 - column 4, line 45 *	2-4,6,8	
A	DE 26 12 464 B1 (PAPST MOTOREN KG) 4 August 1977 (1977-08-04) * column 8, line 6 - line 16 *	1-9	
A	US 6 023 117 A (CHEN CHANG-SHUN [TW]) 8 February 2000 (2000-02-08) * column 2, line 55 - column 3, line 30 *	1-9	TECHNICAL FIELDS SEARCHED (IPC)
A	US 2008/054735 A1 (YOSHIDA YUSUKE [JP] ET AL) 6 March 2008 (2008-03-06) * abstract *	1-9	H02K H02P
The present search report has been drawn up for all claims			
Place of search <b>Munich</b>		Date of completion of the search <b>17 October 2016</b>	Examiner <b>Frapporti, Marc</b>
CATEGORY OF CITED DOCUMENTS X : particularly relevant if taken alone Y : particularly relevant if combined with another document of the same category A : technological background O : non-written disclosure P : intermediate document T : theory or principle underlying the invention E : earlier patent document, but published on, or after the filing date D : document cited in the application L : document cited for other reasons & : member of the same patent family, corresponding document			

EPO FORM 1503 03/82 (P04C01)

**ANNEX TO THE EUROPEAN SEARCH REPORT  
ON EUROPEAN PATENT APPLICATION NO.**

EP 09 27 5095

5

This annex lists the patent family members relating to the patent documents cited in the above-mentioned European search report.  
The members are as contained in the European Patent Office EDP file on  
The European Patent Office is in no way liable for these particulars which are merely given for the purpose of information.

17-10-2016

10

15

20

25

30

35

40

45

50

55

Patent document cited in search report	Publication date	Patent family member(s)	Publication date
WO 2008027535 A2	06-03-2008	US 2009324435 A1 US 2013259674 A1 WO 2008027535 A2	31-12-2009 03-10-2013 06-03-2008
JP H0670525 A	11-03-1994	NONE	
US 4540906 A	10-09-1985	JP S60226760 A US 4540906 A	12-11-1985 10-09-1985
DE 2612464 B1	04-08-1977	DE 2612464 B1 US 4099104 A	04-08-1977 04-07-1978
US 6023117 A	08-02-2000	JP 3051959 B2 JP H11324978 A TW 395625 U US 6023117 A	12-06-2000 26-11-1999 21-06-2000 08-02-2000
US 2008054735 A1	06-03-2008	CN 101136563 A JP 4946276 B2 JP 2008061391 A TW 200830671 A US 2008054735 A1	05-03-2008 06-06-2012 13-03-2008 16-07-2008 06-03-2008