



(12) **CORRECTED EUROPEAN PATENT APPLICATION**

(15) Correction information:  
**Corrected version no 1 (W1 A1)**  
**Corrections, see**  
**Bibliography INID code(s) 84**

(51) Int Cl.:  
**F16B 12/24 (2006.01)**

(48) Corrigendum issued on:  
**07.07.2010 Bulletin 2010/27**

(43) Date of publication:  
**21.04.2010 Bulletin 2010/16**

(21) Application number: **09160165.8**

(22) Date of filing: **13.05.2009**

(84) Designated Contracting States:  
**AT BE BG CH CY CZ DE DK EE ES FI FR GB GR**  
**HR HU IE IS IT LI LT LU LV MC MK MT NL NO PL**  
**PT RO SE SI SK TR**  
Designated Extension States:  
**AL BA RS**

(71) Applicant: **Manufatti Plastici Traversa S.p.A.**  
**22075 Lurate Caccivio (IT)**

(72) Inventor: **Ricca, Giovanni**  
**21047 Saronno (IT)**

(74) Representative: **Jorio, Paolo et al**  
**Studio Torta S.r.l.**  
**Via Viotti 9**  
**10121 Torino (IT)**

(30) Priority: **17.10.2008 IT MI20081847**

(54) **Joining device for structural furniture elements**

(57) A joining device for structural furniture elements is provided with a supporting element (2; 52; 102) carried by a first structural element of a piece of furniture and adapted to be engaged by a pin (4; 54; 104) which is couplable to a second structural element of the piece of

furniture; and a locking element (3; 53; 103) extending along a first longitudinal axis (B; E; L) and adapted to be coupled to the supporting element (2; 52; 102); the locking element (3; 53; 103) and the supporting element (2; 52; 102) being shaped so as to lock the pin (4; 54; 104) in a given position when coupled to each other.

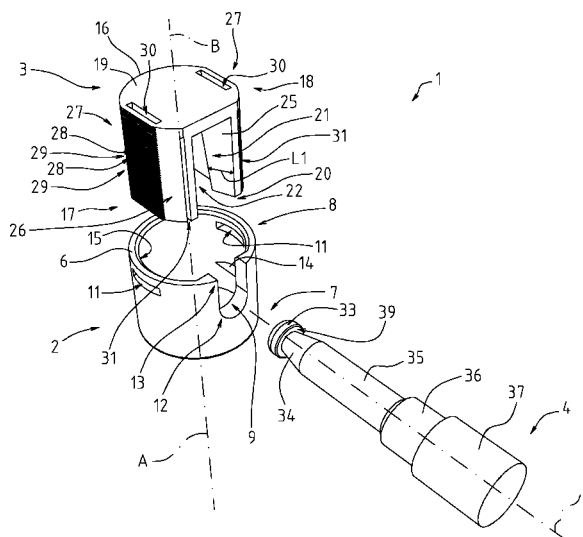

Fig.1