



(12) **EUROPEAN PATENT APPLICATION**

(88) Date of publication A3:
25.03.2015 Bulletin 2015/13

(51) Int Cl.:
D05B 65/06 (2006.01)

(43) Date of publication A2:
20.10.2010 Bulletin 2010/42

(21) Application number: **10159698.9**

(22) Date of filing: **13.04.2010**

(84) Designated Contracting States:
AT BE BG CH CY CZ DE DK EE ES FI FR GB GR HR HU IE IS IT LI LT LU LV MC MK MT NL NO PL PT RO SE SI SK SM TR
Designated Extension States:
AL BA ME RS

(72) Inventors:
• **Okui, Hirokazu**
Tokyo 182-8655 (JP)
• **Kadowaki, Shinjiro**
Tokyo 182-8655 (JP)
• **Yahagi, Tomoo**
Tokyo 182-8655 (JP)

(30) Priority: **15.04.2009 JP 2009098775**

(71) Applicant: **JUKI Corporation**
Chofu-Shi,
Tokyo 182-8655 (JP)

(74) Representative: **Hoeger, Stellrecht & Partner**
Patentanwälte
Uhlandstrasse 14c
70182 Stuttgart (DE)

(54) **Thread cutting device for sewing machine**

(57) The invention relates to a thread cutting device for a sewing machine. The thread cutting device includes: a cutting knife including a cutting edge and serving to carry out a rotation to an initial position and a thread cutting position advanced from the initial position to a stitch point side; a moving knife rotated to the initial position, a thread catching position advanced from the initial position and the thread cutting position retreated from the thread catching position in order and serving to cut a bobbin thread and a needle thread in cooperation with the cutting knife in the thread cutting position; and a clamp member for interposing and holding the bobbin thread between the clamp member and the moving knife by an elastic force applied through an elastic deformation, the clamp member including a first interposing portion for interposing the bobbin thread between the first interposing portion and the moving knife when the moving knife is returned from the thread cutting position to the initial position. The moving knife includes a catching portion for catching the bobbin thread in the thread catching position. The clamp member includes a second interposing portion for interposing the bobbin thread in abutment on a first abutting portion provided on a tip side of the moving knife from the catching portion when the moving knife is placed in the thread cutting position. The bobbin thread interposed by the second interposing portion in the thread cutting position is transferred to the first interposing portion and is held by the first interposing portion with a movement of the moving knife to the initial position.

Fig. 1

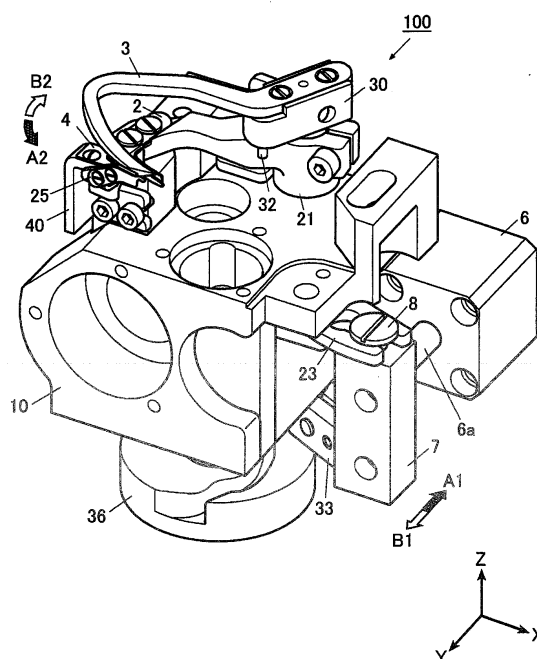



EUROPEAN SEARCH REPORT

Application Number
EP 10 15 9698

5

10

15

20

25

30

35

40

45

50

55

DOCUMENTS CONSIDERED TO BE RELEVANT			
Category	Citation of document with indication, where appropriate, of relevant passages	Relevant to claim	CLASSIFICATION OF THE APPLICATION (IPC)
X,D	DE 10 2007 045597 A1 (JUKI KK [JP]) 3 April 2008 (2008-04-03) * paragraph [0045] - paragraph [0113]; figures 1-27 *	1-4	INV. D05B65/06
A	US 5 755 170 A (TAJIMA IKUO [JP] ET AL) 26 May 1998 (1998-05-26) * column 3, line 1 - column 6, line 3; figures 1-8 *	1-4	
A	JP H05 245287 A (BROTHER IND LTD) 24 September 1993 (1993-09-24) * abstract; figures 1-8 *	1-4	
A	JP H07 231993 A (JUKI KK) 5 September 1995 (1995-09-05) * abstract; figures 1-4 *	1-4	
			TECHNICAL FIELDS SEARCHED (IPC)
			D05B
The present search report has been drawn up for all claims			
Place of search Munich		Date of completion of the search 4 February 2015	Examiner Herry-Martin, D
CATEGORY OF CITED DOCUMENTS X : particularly relevant if taken alone Y : particularly relevant if combined with another document of the same category A : technological background O : non-written disclosure P : intermediate document T : theory or principle underlying the invention E : earlier patent document, but published on, or after the filing date D : document cited in the application L : document cited for other reasons & : member of the same patent family, corresponding document			

EPO FORM 1503 03.82 (P04C01)

**ANNEX TO THE EUROPEAN SEARCH REPORT
ON EUROPEAN PATENT APPLICATION NO.**

EP 10 15 9698

This annex lists the patent family members relating to the patent documents cited in the above-mentioned European search report.
The members are as contained in the European Patent Office EDP file on
The European Patent Office is in no way liable for these particulars which are merely given for the purpose of information.

04-02-2015

Patent document cited in search report	Publication date	Patent family member(s)	Publication date
DE 102007045597 A1	03-04-2008	CN 101144231 A	19-03-2008
		DE 102007045597 A1	03-04-2008
		JP 2008068005 A	27-03-2008

US 5755170 A	26-05-1998	CN 1150190 A	21-05-1997
		DE 19638742 A1	20-03-1997
		JP H0975575 A	25-03-1997
		TW 301681 B	01-04-1997
		US 5755170 A	26-05-1998

JP H05245287 A	24-09-1993	JP 2797740 B2	17-09-1998
		JP H05245287 A	24-09-1993

JP H07231993 A	05-09-1995	JP 3510916 B2	29-03-2004
		JP H07231993 A	05-09-1995

EPO FORM P0459

For more details about this annex : see Official Journal of the European Patent Office, No. 12/82