



(12) **EUROPEAN PATENT APPLICATION**

(88) Date of publication A3:
03.08.2011 Bulletin 2011/31

(51) Int Cl.:
A43C 7/00 (2006.01) A43C 9/02 (2006.01)

(43) Date of publication A2:
08.12.2010 Bulletin 2010/49

(21) Application number: **09178290.4**

(22) Date of filing: **08.12.2009**

(84) Designated Contracting States:
AT BE BG CH CY CZ DE DK EE ES FI FR GB GR HR HU IE IS IT LI LT LU LV MC MK MT NL NO PL PT RO SE SI SK SM TR
Designated Extension States:
AL BA RS

(72) Inventor: **Liu, Kun-Chung**
Hou-Li Hsiang, Taichung Hsien (TW)

(74) Representative: **Borchert, Uwe Rudolf**
Puschmann Borchert Bardehle
Patentanwälte Partnerschaft
Bajuwarenring 21
82041 Oberhaching (DE)

(30) Priority: **06.06.2009 TW 98118922**

(71) Applicant: **Liu, Kun-Chung**
Hou-Li Hsiang, Taichung Hsien (TW)

(54) **Lace adjuster**

(57) A lace adjuster (100) includes a longitudinal hollow body (10) and two stop members (20). The hollow body (10) defines a longitudinal passage (13), and has longitudinally opposite first and second ends (111, 112), and an operating opening (14) disposed between the first and second ends (111, 112) and communicated with the longitudinal passage (13). The longitudinal passage (13) has first and second openings (131, 132) at the first and

second ends (111, 112), respectively. The stop members (20) are pivotally and transversely mounted in the longitudinal passage (13) and are respectively proximate to the first and second openings (131, 132) of the longitudinal passage (13). Each of the stop members (20) has a lace-engaging portion (22), and a handle portion (23) connected to the lace-engaging portion (22), and is operable so as to adjust the lengths of lace segments (200).

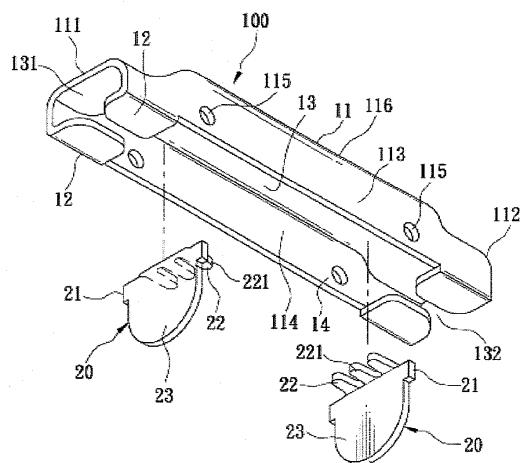

FIG. 2



EUROPEAN SEARCH REPORT

Application Number
EP 09 17 8290

DOCUMENTS CONSIDERED TO BE RELEVANT			
Category	Citation of document with indication, where appropriate, of relevant passages	Relevant to claim	CLASSIFICATION OF THE APPLICATION (IPC)
A	DE 10 2006 033997 A1 (TONG JADORE [DE]) 31 January 2008 (2008-01-31) * paragraph [0033] - paragraph [0036]; figures *	1-6	INV. A43C7/00 A43C9/02
A	US 6 817 070 B1 (LIU KUN-CHUNG [TW]) 16 November 2004 (2004-11-16) * column 3 - column 4; figures *	1-6	
A	US 2004/154193 A1 (LIU KUN-CHUNG [TW]) 12 August 2004 (2004-08-12) * paragraph [0034] - paragraph [0043]; figures *	1-6	
A	US 2008/066273 A1 (LIU KUN-CHUNG [TW]) 20 March 2008 (2008-03-20) * the whole document *	1-6	
The present search report has been drawn up for all claims			TECHNICAL FIELDS SEARCHED (IPC)
			A43C
Place of search		Date of completion of the search	Examiner
Munich		21 June 2011	Herry, Manuel
CATEGORY OF CITED DOCUMENTS X : particularly relevant if taken alone Y : particularly relevant if combined with another document of the same category A : technological background O : non-written disclosure P : intermediate document T : theory or principle underlying the invention E : earlier patent document, but published on, or after the filing date D : document cited in the application L : document cited for other reasons & : member of the same patent family, corresponding document			

1
EPO FORM 1503 03.82 (P04C01)

**ANNEX TO THE EUROPEAN SEARCH REPORT
ON EUROPEAN PATENT APPLICATION NO.**

EP 09 17 8290

This annex lists the patent family members relating to the patent documents cited in the above-mentioned European search report.
The members are as contained in the European Patent Office EDP file on
The European Patent Office is in no way liable for these particulars which are merely given for the purpose of information.

21-06-2011

Patent document cited in search report	Publication date	Patent family member(s)	Publication date
DE 102006033997 A1	31-01-2008	CA 2658450 A1	31-01-2008
		EP 2043473 A1	08-04-2009
		WO 2008012048 A1	31-01-2008
		JP 2009544343 T	17-12-2009
		US 2010018018 A1	28-01-2010

US 6817070 B1	16-11-2004	NONE	

US 2004154193 A1	12-08-2004	NONE	

US 2008066273 A1	20-03-2008	NONE	
