



(12) **EUROPEAN PATENT APPLICATION**

(43) Date of publication:  
**19.01.2011 Bulletin 2011/03**

(51) Int Cl.:  
**A47B 67/02 (2006.01)**

(21) Application number: **09165830.2**

(22) Date of filing: **17.07.2009**

(84) Designated Contracting States:  
**AT BE BG CH CY CZ DE DK EE ES FI FR GB GR  
 HR HU IE IS IT LI LT LU LV MC MK MT NL NO PL  
 PT RO SE SI SK SM TR**

(74) Representative: **Baldi, Claudio**  
**Ing. Claudio Baldi s.r.l.**  
**Viale Cavallotti 13**  
**P.O. Box 187**  
**60035 Jesi (AN) (IT)**

(71) Applicant: **Monacelli, Paolo**  
**63039 San Benedetto del Tronto (AP) (IT)**

Remarks:  
 A correction of the claims numbering has been made  
 "ex officio" i.e. claim 4 to claim 5, claim 8 to claim 9

(72) Inventor: **Monacelli, Paolo**  
**63039 San Benedetto del Tronto (AP) (IT)**

(54) **Sliding cabinet, preferably for bathrooms**

(57) The present invention relates to a cabinet for space optimisation in small bathrooms, which is suitably provided with means to hang it and make it slide alternatively on the front of a wall-mounted horizontal guide.

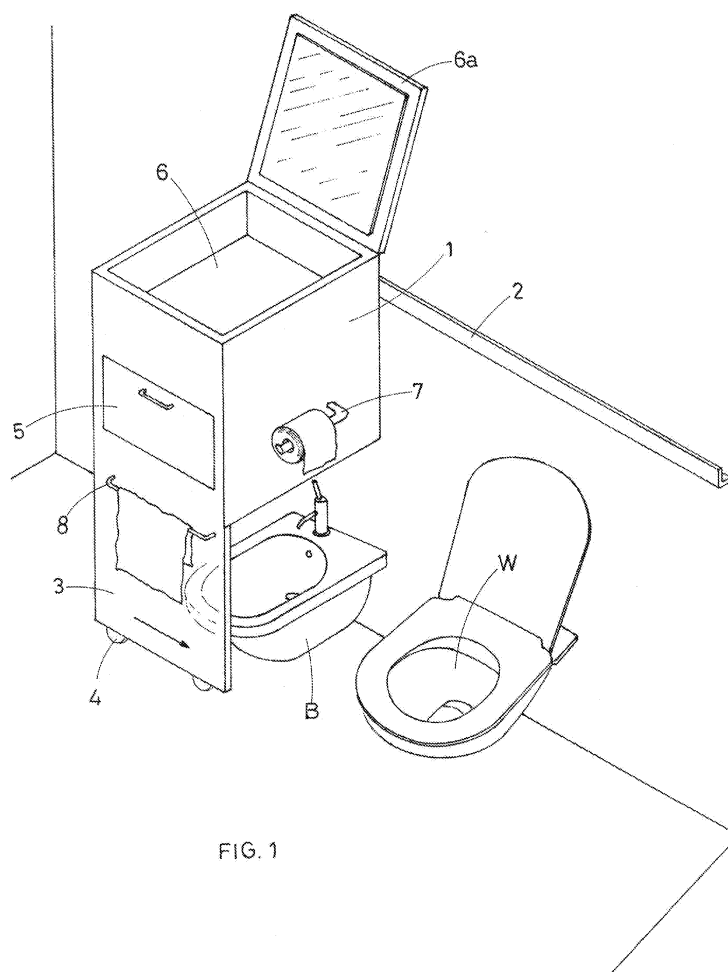

FIG. 1

## Description

**[0001]** The present patent application relates to a sliding cabinet, preferably for bathrooms.

**[0002]** As it is known, the building sector has consolidated the tendency to reduce the area of apartments, especially in view of the high cost by square metre.

**[0003]** This has resulted in the larger and larger diffusion of the so-called "studio apartments" or in any case apartments with a few rooms.

**[0004]** Such a tendency has resulted in a gradual reduction of the surface used for the bathroom.

**[0005]** In turn, this has reduced the "usable" space and has limited the possibility of equipping such a space with typical bathroom furniture items, since the presence of a cabinet or a wall cabinet would intolerably reduce said "usable" space.

**[0006]** However, the elimination of said furniture items in the bathroom is extremely penalizing, in view of the difficulties encountered in storing the objects that are normally used in such a space.

**[0007]** A careful examination of the current situation has led to devising the specific sliding cabinet of the present patent application.

**[0008]** The specific purpose of the present invention is to devise a cabinet able to change position with respect to the installation wall according to the user's desire.

**[0009]** More precisely, said cabinet is hung on the front of a wall-mounted horizontal guide.

**[0010]** In view of the above, said cabinet can make alternative travels in parallel direction along the guide, changing position in the room following to a simple manual push by the user.

**[0011]** So, from time to time, the user can give the most suitable position to the cabinet according to his specific needs, i.e. the desire to have a larger space on either side of the room.

**[0012]** It must be noted that the cabinet of the invention can be installed in any domestic space, although, as mentioned earlier, the preferred destination is in a bathroom, also in consideration of the fact that the bathroom is normally the smallest space of the apartment.

**[0013]** In case of bathroom installation, the presence of the cabinet of the invention is especially appreciated on the bathroom wall in front of which the water closet and the bidet are mounted one next to the other.

**[0014]** In fact, once the cabinet of the invention has been hung to a guide mounted above the water closet and the bidet, it appears evident that its position can be changed as desired by the user in order to use either the water closet or the bidet.

**[0015]** In particular, when using the water closet, the user can slide the cabinet towards the bidet, until it is positioned immediately above the bidet.

**[0016]** This allows the user to sit comfortably on the water closet, prohibiting the access to the bidet (which is not necessary in that particular moment).

**[0017]** As soon as the user is done with the water closet,

he can slide the cabinet of the invention in the opposite direction, in such a way that it is positioned entirely above the water closet, thus freeing the access to the bidet completely.

**[0018]** It must be noted that the cabinet of the invention can be equipped on the sides with shelves, compartments and/or supports for detergents, towels or hygienic paper rolls that can be easily accessed by the user that is sitting on the water closet or on the bidet.

**[0019]** For example, the side of the cabinet facing the water closet can be provided with a support for a hygienic paper roll.

**[0020]** In view of the above, the user sitting on the water closet with the cabinet positioned above the bidet can easily reach the hygienic paper roll supported on the side of the cabinet without getting up from the water closet.

**[0021]** Likewise, the side of the cabinet facing the bidet can be provided with a towel-holder and a soap-holder that can be easily reached by the hand of the user sitting on the bidet while the cabinet of the invention is positioned above the adjacent water closet.

**[0022]** For major clarity, the description of the invention continues with reference to the enclosed drawing, which only has an illustrative, not limitative purpose, whereby figure 1 is an axonometric view of the cabinet of the invention in a possible mounting solution.

**[0023]** With reference to fig. 1, a cabinet (1) is used in the space dedicated to a water closet (W) and a bidet (B) mounted one next to the other.

**[0024]** As mentioned above, said cabinet (1) is hung as wall-cabinet to a guide (2) mounted on the wall in horizontal position, above the water closet and the bidet (W, B).

**[0025]** The back of said cabinet (1) is provided with means (not shown in the enclosed figure) that allow the cabinet to be firmly coupled with said guide (2) and make alternative slides with respect to the guide (2) in parallel direction.

**[0026]** In particular, fig. 1 shows the cabinet (1) in the position that frees the space above the water closet (W) and occupies the space above the bidet (B).

**[0027]** Evidently, this is the first of the two possible positions, since in the second position (not shown in fig. 1) the cabinet (1) occupies the space above the water closet (W) and frees the space above the bidet (B).

**[0028]** In order to ensure a higher structural strength and a higher balance during the alternative sliding travels of the cabinet (1), the cabinet (1) is provided on the bottom, preferably starting from the longitudinal front border, with a long vertical panel (3) that touches the floor with a pair of wheels (4).

**[0029]** Within such an inventive idea, the specific configuration of the cabinet of the invention can be determined freely according to the specific installation and use requirements.

**[0030]** With reference to fig. 1, it must be noted that the embodiment of cabinet is provided with a front drawer (5), and a top internal compartment (6) that can be ac-

cessed from above by means of a collapsible door (6a) internally provided with a mirror.

**[0031]** The side facing the water closet (W) is equipped with a support (7) for hygienic paper rolls and a towel-holder (8) is mounted on the front of the vertical panel (3) that rests on the floor. 5

## Claims

1. Cabinet **characterised in that** it is provided on the back with means to hang it and make it alternatively slide on the front of a wall-mounted horizontal guide (2). 10
2. Cabinet according to claim 1 **characterised in that** it is provided on the bottom with vertical means (3) adapted to touch the floor with corresponding wheels (4). 15
3. Cabinet according to claim 2 **characterised in that** said vertical means consist in a panel (3) applied on the bottom to the front border of said cabinet (1). 20
4. Cabinet according to one or more of the preceding claims **characterised in that** it is provided with a front drawer (5). 25
4. Cabinet according to one or more of the preceding claims **characterised in that** it is provided with a top compartment (6) that can be accessed from above. 30
6. Cabinet according to claim 5, **characterised in that** said top compartment (6) is closed by means of a collapsible door (6a). 35
7. Cabinet according to claim 6, **characterised in that** said collapsible door (6a) is internally provided with a mirror. 40
8. Cabinet according to one or more of the preceding claims, **characterised in that** it is provided on one of the side walls with a support (7) for hygienic paper rolls and/or a towel-holder (8). 45
8. Cabinet according to one or more of the preceding claims, **characterised in that** it is provided on the front panel (3) with a towel-holder (8) and/or a support (7) for hygienic paper rolls. 50

55

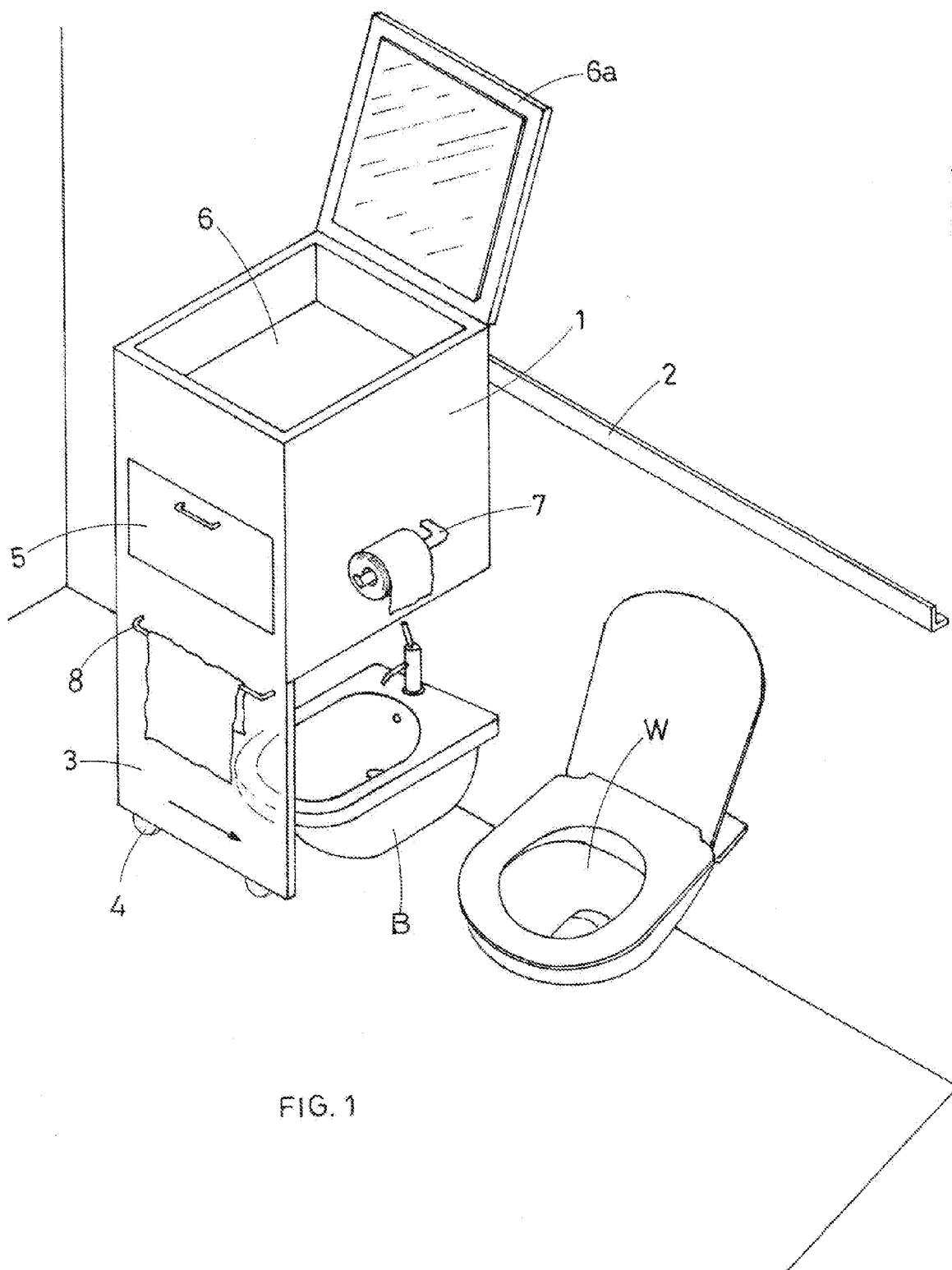



## EUROPEAN SEARCH REPORT

Application Number  
EP 09 16 5830

DOCUMENTS CONSIDERED TO BE RELEVANT			
Category	Citation of document with indication, where appropriate, of relevant passages	Relevant to claim	CLASSIFICATION OF THE APPLICATION (IPC)
X	US 4 457 436 A (KELLEY LAURENCE J [US]) 3 July 1984 (1984-07-03)	1	INV. A47B67/02
A	* column 2, line 37 - column 4, line 9; figures 1-4 *	2-9	
-----			
X	DE 196 20 981 A1 (A & S BAEDER GMBH [DE]) 27 November 1997 (1997-11-27)	1	
A	* column 2, line 42 - column 3, line 38; figures 1-4 *	2-9	
-----			
X	US 5 718 493 A (NIKOLAI GERHARD [CA]) 17 February 1998 (1998-02-17)	1	TECHNICAL FIELDS SEARCHED (IPC)  A47B
A	* column 3, line 7 - column 7, line 64; figures 1-17 *	2-9	
-----			
The present search report has been drawn up for all claims			
Place of search <b>Munich</b>			
Date of completion of the search <b>13 January 2010</b>			
Examiner <b>Klintebäck, Daniel</b>			
CATEGORY OF CITED DOCUMENTS X : particularly relevant if taken alone Y : particularly relevant if combined with another document of the same category A : technological background O : non-written disclosure P : intermediate document T : theory or principle underlying the invention E : earlier patent document, but published on, or after the filing date D : document cited in the application L : document cited for other reasons ..... & : member of the same patent family, corresponding document			

1  
EPO FORM 1503 03.82 (P04C01)

**ANNEX TO THE EUROPEAN SEARCH REPORT  
ON EUROPEAN PATENT APPLICATION NO.**

EP 09 16 5830

This annex lists the patent family members relating to the patent documents cited in the above-mentioned European search report.  
The members are as contained in the European Patent Office EDP file on  
The European Patent Office is in no way liable for these particulars which are merely given for the purpose of information.

13-01-2010

Patent document cited in search report		Publication date	Patent family member(s)	Publication date
US 4457436	A	03-07-1984	NONE	
DE 19620981	A1	27-11-1997	NONE	
US 5718493	A	17-02-1998	CA 2173568 A1	05-10-1996