



(12) **EUROPEAN PATENT APPLICATION**

(88) Date of publication A3:  
**20.04.2011 Bulletin 2011/16**

(51) Int Cl.:  
**H01R 31/02 (2006.01) H01R 31/06 (2006.01)**

(43) Date of publication A2:  
**26.01.2011 Bulletin 2011/04**

(21) Application number: **10170190.2**

(22) Date of filing: **20.07.2010**

(84) Designated Contracting States:  
**AL AT BE BG CH CY CZ DE DK EE ES FI FR GB GR HR HU IE IS IT LI LT LU LV MC MK MT NL NO PL PT RO SE SI SK SM TR**  
Designated Extension States:  
**BA ME RS**

(30) Priority: **21.07.2009 GB 0912618**  
**28.08.2009 GB 0914991**  
**07.05.2010 PCT/GB2010/050745**

(71) Applicant: **Low, Mr Eng Choon**  
**56 Dundas Street, Mongkok**  
**Hong Kong Hong Kong Kowloon (CN)**

(72) Inventor: **Low, Mr Eng Choon**  
**56 Dundas Street, Mongkok**  
**Hong Kong Hong Kong Kowloon (CN)**

(74) Representative: **Browne, Robin Forsythe**  
**Hepworth Browne**  
**Pearl Chambers**  
**22 East Parade**  
**Leeds**  
**LS1 5BY (GB)**

(54) **Power supply adapter**

(57) A portable power supply adapter comprising:  
a casing;  
a mains power supply cable extending from the casing for connection to a mains power supply;  
a portable computer power supply cable extending from the casing for connection to a portable computer;  
the casing including power supply circuitry;

the casing having an upwardly facing surface, the surface including a plurality of sockets, each adapted to receive a portable electric device and arranged so that a plurality of portable electric devices may be charged from the mains power supply directly whether or not a portable computer is connected to the portable computer power supply cable for charging.

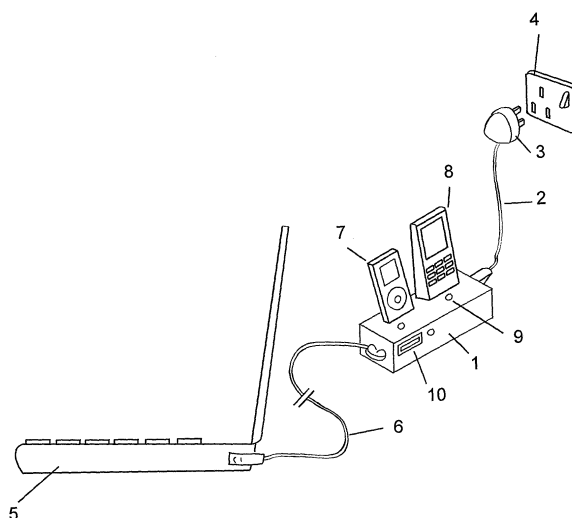

Fig 1



## EUROPEAN SEARCH REPORT

Application Number  
EP 10 17 0190

DOCUMENTS CONSIDERED TO BE RELEVANT			
Category	Citation of document with indication, where appropriate, of relevant passages	Relevant to claim	CLASSIFICATION OF THE APPLICATION (IPC)
X A	WO 2006/054873 A1 (CHOI SOON-KYU [KR]) 26 May 2006 (2006-05-26) * abstract * * paragraph [0001] - paragraph [0002] * * paragraph [0010] - paragraph [0016] * * paragraph [0045] * * paragraph [0050] - paragraph [0052] * * paragraph [0056] - paragraph [0061] * * paragraph [0074] - paragraph [0075] * * figures 3, 6-8, 10-11, 14 * -----	1-9,13, 15 10-12	INV. H01R31/02 H01R31/06
X A	US 2006/250764 A1 (HOWARTH RICHARD P [US] ET AL) 9 November 2006 (2006-11-09) * abstract * * figures 1, 19 * * paragraph [0041] - paragraph [0043] * * paragraphs [0047], [ 0049] * * paragraph [0085] - paragraph [0089] * -----	1-9,13, 15 10-12	
X	WO 2007/047453 A2 (NYKO TECHNOLOGIES INC [US]; NAVID AMIR [US]; NAGHI HERSCHEL [US]) 26 April 2007 (2007-04-26) * abstract * * paragraph [0003] - paragraph [0016] * * figures 8, 10 * -----	1-13,15	TECHNICAL FIELDS SEARCHED (IPC)  H01R G06F H02J
A	US 2009/072782 A1 (RANDALL MITCH [US]) 19 March 2009 (2009-03-19) * paragraph [0093] - paragraph [0160] * -----	1-13,15	
1 <del>The present search report has been drawn up for all claims</del>			
Place of search <b>The Hague</b>		Date of completion of the search <b>28 October 2010</b>	Examiner <b>Mier, Ana</b>
CATEGORY OF CITED DOCUMENTS X : particularly relevant if taken alone Y : particularly relevant if combined with another document of the same category A : technological background O : non-written disclosure P : intermediate document		T : theory or principle underlying the invention E : earlier patent document, but published on, or after the filing date D : document cited in the application L : document cited for other reasons ..... & : member of the same patent family, corresponding document	

EPO FORM 1503 03.82 (P04C01)



Application Number

EP 10 17 0190

**CLAIMS INCURRING FEES**

The present European patent application comprised at the time of filing claims for which payment was due.

☐ Only part of the claims have been paid within the prescribed time limit. The present European search report has been drawn up for those claims for which no payment was due and for those claims for which claims fees have been paid, namely claim(s):

☐ No claims fees have been paid within the prescribed time limit. The present European search report has been drawn up for those claims for which no payment was due.

**LACK OF UNITY OF INVENTION**

The Search Division considers that the present European patent application does not comply with the requirements of unity of invention and relates to several inventions or groups of inventions, namely:

see sheet B

☐ All further search fees have been paid within the fixed time limit. The present European search report has been drawn up for all claims.

☐ As all searchable claims could be searched without effort justifying an additional fee, the Search Division did not invite payment of any additional fee.

☐ Only part of the further search fees have been paid within the fixed time limit. The present European search report has been drawn up for those parts of the European patent application which relate to the inventions in respect of which search fees have been paid, namely claims:

☒ None of the further search fees have been paid within the fixed time limit. The present European search report has been drawn up for those parts of the European patent application which relate to the invention first mentioned in the claims, namely claims:

1-13, 15

☐ The present supplementary European search report has been drawn up for those parts of the European patent application which relate to the invention first mentioned in the claims (Rule 164 (1) EPC).

**LACK OF UNITY OF INVENTION  
SHEET B**

Application Number

EP 10 17 0190

The Search Division considers that the present European patent application does not comply with the requirements of unity of invention and relates to several inventions or groups of inventions, namely:

1. claims: 1-13, 15

the subject-matter of claim 1 refers to a portable supply adapter that comprises a casing, a mains power supply cable extending from the casing for connection to a mains power supply, and a portable computer power supply cable extending from the casing for connection to a portable computer; furthermore, the casing includes power supply circuitry and has an upwardly facing surface, the surface including one or more sockets, the or each socket being each adapted to receive a portable electric device and arranged so that the portable electric device may be charged from the mains power supply directly whether or not a portable computer is connected to the portable computer power supply cable for charging.

---

2. claim: 14

the subject-matter of claim 14 refers to a detachable connector for a portable device power supply adapter comprising a housing, a power supply and/or data connector extending in a first direction from the housing and a device connector extending from the housing parallel to the first direction in an opposite direction, and a power supply circuit located within the housing between the power supply connector and the device connector and arranged to control the power supply to the device connector.

---

**ANNEX TO THE EUROPEAN SEARCH REPORT  
ON EUROPEAN PATENT APPLICATION NO.**

EP 10 17 0190

This annex lists the patent family members relating to the patent documents cited in the above-mentioned European search report. The members are as contained in the European Patent Office EDP file on  
The European Patent Office is in no way liable for these particulars which are merely given for the purpose of information.

28-10-2010

Patent document cited in search report	Publication date	Patent family member(s)	Publication date
WO 2006054873 A1	26-05-2006	KR 20060074967 A KR 20060055407 A	04-07-2006 23-05-2006
US 2006250764 A1	09-11-2006	AT 426851 T CN 101164034 A EP 1880264 A1 ES 2324999 T3 HK 1112769 A1 US 2010188808 A1 WO 2006121696 A1	15-04-2009 16-04-2008 23-01-2008 21-08-2009 06-11-2009 29-07-2010 16-11-2006
WO 2007047453 A2	26-04-2007	US 2007091656 A1	26-04-2007
US 2009072782 A1	19-03-2009	NONE	