



(12) **EUROPEAN PATENT APPLICATION**

(88) Date of publication A3:
07.12.2011 Bulletin 2011/49

(51) Int Cl.:
F04B 9/02 (2006.01) **F04B 9/04 (2006.01)**
F04B 53/16 (2006.01) **F04B 17/03 (2006.01)**

(43) Date of publication A2:
02.02.2011 Bulletin 2011/05

(21) Application number: **10184231.8**

(22) Date of filing: **28.08.2000**

(84) Designated Contracting States:
DE ES FR GB IT

(30) Priority: **31.08.1999 US 151794 P**
22.11.1999 US 166946 P

(62) Document number(s) of the earlier application(s) in accordance with Art. 76 EPC:
05077480.1 / 1 635 062
00961390.2 / 1 208 287

(71) Applicant: **Graco Minnesota Inc.**
Minneapolis, MN 55440-1441 (US)

(72) Inventors:

- **Davidson, Glen W**
Roseville, MN 55113 (US)
- **Kapelevich, Alexander P**
Shoreview, MN 55126 (US)

(74) Representative: **Cloughley, Peter Andrew**
Miller Sturt Kenyon
9 John Street
London WC1N 2ES (GB)

(54) **Airless spray pump**

(57) An airless spray pump having an inlet tube and an inlet filter screen, the improvement comprising said inlet tube being provided with a female threaded end and said inlet filter screen assembly being provided with a

male threaded end threaded engagement with female end, said ends having the same size and thread as a common garden hose such that a user need merely remove said screen assembly and attach a garden hose to said inlet tube to flush out the assembly.

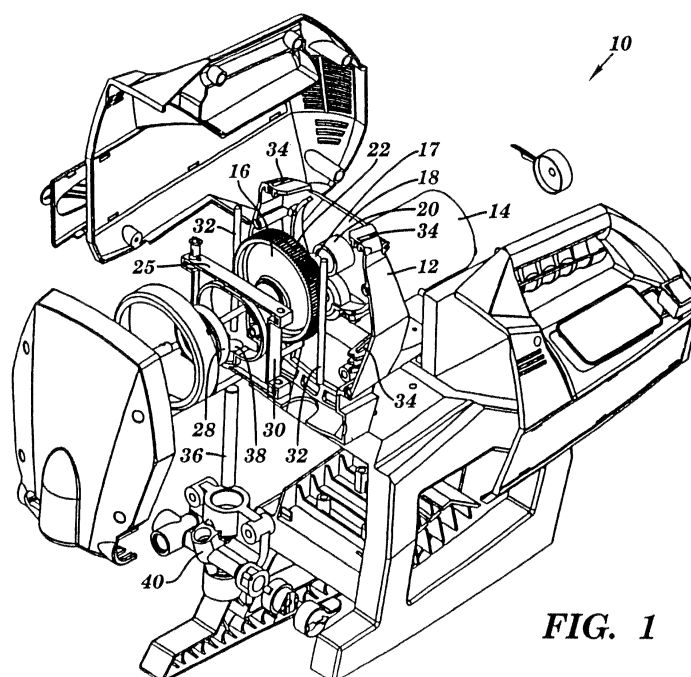

FIG. 1



EUROPEAN SEARCH REPORT

Application Number
EP 10 18 4231

DOCUMENTS CONSIDERED TO BE RELEVANT			
Category	Citation of document with indication, where appropriate, of relevant passages	Relevant to claim	CLASSIFICATION OF THE APPLICATION (IPC)
X	US 5 769 321 A (CYPHERS ET AL) 23 June 1998 (1998-06-23) * abstract; figures 1,3,4,6 * * column 1, line 44 - column 3, line 23 * -----	1-9	INV. F04B9/02 F04B9/04 F04B53/16 F04B17/03
A	US 5 435 697 A (GUEBELI FERDINAND N [US] ET AL) 25 July 1995 (1995-07-25) * figures 2,11 * * column 2, lines 12-23 * * column 2, lines 37-62 * -----	1-9	
A	US 2 366 237 A (WITT CLAUSEN DE) 2 January 1945 (1945-01-02) * figures 1,2 * * page 1, column 1, line 40 - column 2, line 19 * -----	1-9	
A	US 2 366 238 A (WITT CLAUSEN DE) 2 January 1945 (1945-01-02) * figure 1 * * page 1, column 1, line 40 - column 2, line 18 * -----	1-9	TECHNICAL FIELDS SEARCHED (IPC)
A	US 3 067 624 A (HENRY NORTON ET AL) 11 December 1962 (1962-12-11) * figures 1,2 * * column 2, lines 3-38 * -----	1-9	F04B B01D
The present search report has been drawn up for all claims			
Place of search Munich		Date of completion of the search 21 October 2011	Examiner Richmond, Robin
<p>CATEGORY OF CITED DOCUMENTS</p> <p>X : particularly relevant if taken alone Y : particularly relevant if combined with another document of the same category A : technological background O : non-written disclosure P : intermediate document</p> <p>T : theory or principle underlying the invention E : earlier patent document, but published on, or after the filing date D : document cited in the application L : document cited for other reasons & : member of the same patent family, corresponding document</p>			

 4
EPO FORM 1503 03.82 (P04C01)

**ANNEX TO THE EUROPEAN SEARCH REPORT
ON EUROPEAN PATENT APPLICATION NO.**

EP 10 18 4231

This annex lists the patent family members relating to the patent documents cited in the above-mentioned European search report.
The members are as contained in the European Patent Office EDP file on
The European Patent Office is in no way liable for these particulars which are merely given for the purpose of information.

21-10-2011

Patent document cited in search report	Publication date	Patent family member(s)	Publication date
US 5769321	A	23-06-1998	DE 69615710 D1 08-11-2001
			EP 0882182 A1 09-12-1998
			JP 2000505170 A 25-04-2000
			WO 9731186 A1 28-08-1997
US 5435697	A	25-07-1995	NONE
US 2366237	A	02-01-1945	NONE
US 2366238	A	02-01-1945	NONE
US 3067624	A	11-12-1962	NONE