



(11) **EP 2 299 191 A3**

(12) **EUROPEAN PATENT APPLICATION**

(88) Date of publication A3:  
**02.05.2012 Bulletin 2012/18**

(51) Int Cl.:  
**F24F 1/00 (2011.01) F24F 13/20 (2006.01)**

(43) Date of publication A2:  
**23.03.2011 Bulletin 2011/12**

(21) Application number: **09252631.8**

(22) Date of filing: **16.11.2009**

(84) Designated Contracting States:  
**AT BE BG CH CY CZ DE DK EE ES FI FR GB GR HR HU IE IS IT LI LT LU LV MC MK MT NL NO PL PT RO SE SI SK SM TR**  
Designated Extension States:  
**AL BA RS**

(71) Applicant: **LG Electronics Inc.**  
**Seoul (KR)**

(72) Inventor: **Yang, Seung Hoon**  
**Changwon City,**  
**Gyoungsangnam, 641-711 (KR)**

(30) Priority: **10.09.2009 KR 20090085618**  
**10.09.2009 KR 20090085620**  
**10.09.2009 KR 20090085619**

(74) Representative: **Palmer, Jonathan R. et al**  
**Boult Wade Tennant**  
**Verulam Gardens**  
**70 Gray's Inn Road**  
**London WC1X 8BT (GB)**

(54) **Indoor unit of air conditioner**

(57) The present embodiment provides an indoor unit of an air conditioner. The indoor unit of the air conditioner includes: a main body that includes a chassis and a front frame coupled to the chassis; a fan that is provided inside the main body to compulsorily flow air; a fan motor that rotates the ventilation fan; a heat-exchanger that is provided inside the main body; a control box in which control components for operating the main body are included; and a control box seating part that is formed at the chassis and on which the control box is seated, wherein a space part through which a pipe unit connected to the heat-exchanger passes is formed at the chassis, the space part is located at the rear side of the control box.

Fig. 2

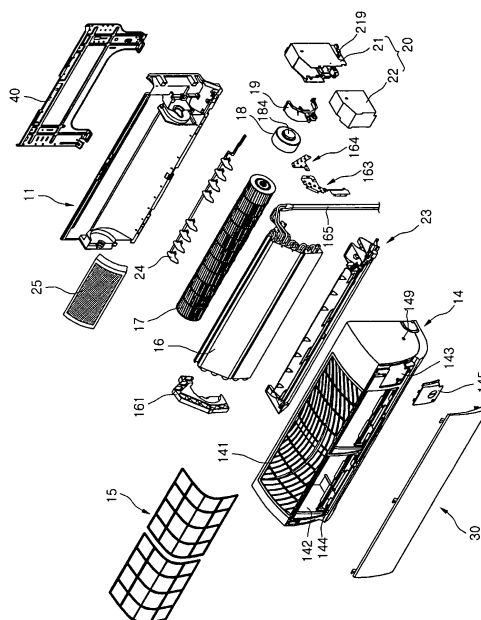



## EUROPEAN SEARCH REPORT

Application Number  
EP 09 25 2631

DOCUMENTS CONSIDERED TO BE RELEVANT			
Category	Citation of document with indication, where appropriate, of relevant passages	Relevant to claim	CLASSIFICATION OF THE APPLICATION (IPC)
X	US 2005/115264 A1 (TERADA YUICHI [JP]) 2 June 2005 (2005-06-02) * paragraphs [0047], [0057], [0068] - [0086]; figures 3B,4,6,8 *	1-13	INV. F24F1/00 F24F13/20
X	JP 2005 106397 A (DAIKIN IND LTD) 21 April 2005 (2005-04-21) * the whole document *	1-13	
X	EP 1 522 795 A1 (LG ELECTRONICS INC [KR]) 13 April 2005 (2005-04-13) * paragraphs [0128] - [0130], [0137]; figures 6,43-46 *	1-13	
X	WO 2007/088962 A1 (DAIKIN IND LTD [JP]; SAKASHITA AKIHIKO [JP]; OHTA NAUYUKI [JP]) 9 August 2007 (2007-08-09) * abstract *	1	
			TECHNICAL FIELDS SEARCHED (IPC)
			F24F
The present search report has been drawn up for all claims			
Place of search Munich		Date of completion of the search 21 March 2012	Examiner Lienhard, Dominique
<p>CATEGORY OF CITED DOCUMENTS</p> <p>X : particularly relevant if taken alone Y : particularly relevant if combined with another document of the same category A : technological background O : non-written disclosure P : intermediate document</p> <p>T : theory or principle underlying the invention E : earlier patent document, but published on, or after the filing date D : document cited in the application L : document cited for other reasons</p> <p>&amp; : member of the same patent family, corresponding document</p>			

1  
EPO FORM 1503 03.02 (P04C01)

**ANNEX TO THE EUROPEAN SEARCH REPORT  
ON EUROPEAN PATENT APPLICATION NO.**

EP 09 25 2631

This annex lists the patent family members relating to the patent documents cited in the above-mentioned European search report.  
The members are as contained in the European Patent Office EDP file on  
The European Patent Office is in no way liable for these particulars which are merely given for the purpose of information.

21-03-2012

Patent document cited in search report		Publication date	Patent family member(s)	Publication date
US 2005115264	A1	02-06-2005	AU 2003277626 A1	03-06-2004
			CN 1692253 A	02-11-2005
			EP 1568945 A1	31-08-2005
			JP 3731070 B2	05-01-2006
			JP 2004163018 A	10-06-2004
			US 2005115264 A1	02-06-2005
			WO 2004044496 A1	27-05-2004
-----				
JP 2005106397	A	21-04-2005	CN 2744967 Y	07-12-2005
			JP 2005106397 A	21-04-2005
-----				
EP 1522795	A1	13-04-2005	AT 360786 T	15-05-2007
			AU 2004277553 A1	14-04-2005
			CN 1605804 A	13-04-2005
			EP 1522795 A1	13-04-2005
			ES 2283959 T3	01-11-2007
			JP 2005114346 A	28-04-2005
			US 2005076671 A1	14-04-2005
			WO 2005033589 A1	14-04-2005
-----				
WO 2007088962	A1	09-08-2007	JP 4023505 B2	19-12-2007
			JP 2007205659 A	16-08-2007
			WO 2007088962 A1	09-08-2007
-----				