



(11) **EP 2 299 245 A3**

(12) **EUROPEAN PATENT APPLICATION**

(88) Date of publication A3:
15.01.2014 Bulletin 2014/03

(51) Int Cl.:
G01D 5/14 (2006.01)

(43) Date of publication A2:
23.03.2011 Bulletin 2011/12

(21) Application number: **10176721.8**

(22) Date of filing: **15.09.2010**

(84) Designated Contracting States:
**AL AT BE BG CH CY CZ DE DK EE ES FI FR GB
GR HR HU IE IS IT LI LT LU LV MC MK MT NL NO
PL PT RO SE SI SK SM TR**
Designated Extension States:
BA ME RS

(71) Applicant: **Mikuni Corp.**
Tokyo 101-0021 (JP)

(72) Inventor: **Ogura, Takahiro**
Kanagawa (JP)

(74) Representative: **Schwabe - Sandmair - Marx**
Patentanwälte
Stuntzstraße 16
81677 München (DE)

(30) Priority: **16.09.2009 JP 2009214730**

(54) **Rotation angle detecting apparatus**

(57) An object of the present invention is to fix a magnet of a rotation angle sensor easily and steadily without using a heat caulking method and the like. To achieve the object, provided is a rotation angle sensor for detecting a rotation angle of a rotating member in which, when fixing a magnet to the rotating member, the magnet can be fixed easily by employing a fixing member that generates a biasing force by rotating in a gap between the magnet and the rotating member. Furthermore, provided is a rotation angle sensor in which a magnet can be prevented from loosening by external shock and variation of the detection angle of the magnet can be suppressed by providing a rotation preventing part for preventing a fixing member from loosening due to its inverse rotation.

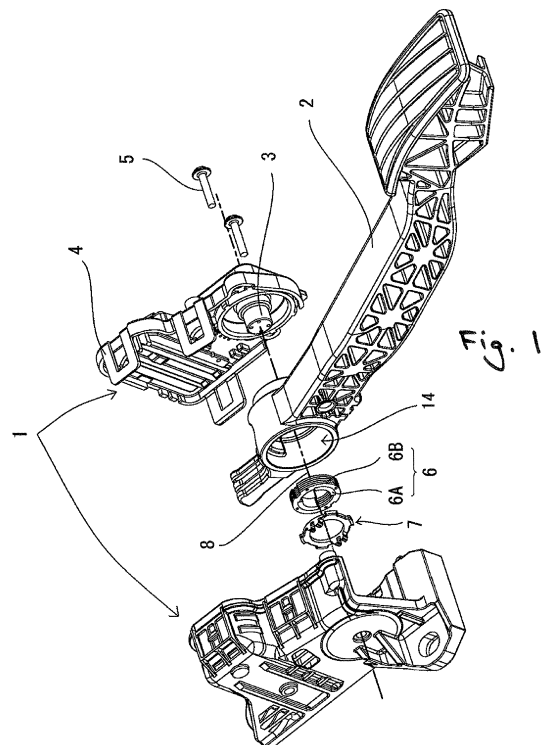



EUROPEAN SEARCH REPORT

 Application Number
 EP 10 17 6721

DOCUMENTS CONSIDERED TO BE RELEVANT			
Category	Citation of document with indication, where appropriate, of relevant passages	Relevant to claim	CLASSIFICATION OF THE APPLICATION (IPC)
X	JP H06 117807 A (AISAN IND) 28 April 1994 (1994-04-28)	1	INV. G01D5/14
Y	* Abstract, Desc. [0001], [0012], [0015], Figs. 1, 3 *	1-6	
Y	DE 21 21 309 A1 (EG & G INC) 25 November 1971 (1971-11-25) * Desc. p. 6 / l. 3-15, claim 8 and Fig. 1 *	2-6	
Y	US 5 859 425 A (MLEINEK KLAUS [DE] ET AL) 12 January 1999 (1999-01-12)	3-6	
A	* Abstract, Desc. col. 2 / l. 45-49 / col. 3 / l. 13-17, Figs. 1, 3a, 3b *	1,2	
Y	US 2008/012555 A1 (IKEDA TSUTOMU [JP]) 17 January 2008 (2008-01-17)	6	
A	* Abstract, Desc. [0078] *	1-5	
Y	US 4 349 735 A (MAEDA KOICHI) 14 September 1982 (1982-09-14) * Abstract, Desc. col. 3 / l. 18-20, Figs. 3, 4 *	1-6	
A	DE 10 2006 024680 A1 (KOSTAL LEOPOLD GMBH & CO KG [DE]) 29 November 2007 (2007-11-29) * Abstract, Desc. [0014], [0020]-[0022] *	1-6	G01D H02K A61M G01L G01B B60G
The present search report has been drawn up for all claims			
Place of search Munich		Date of completion of the search 9 December 2013	Examiner Reim, Klaus
CATEGORY OF CITED DOCUMENTS X : particularly relevant if taken alone Y : particularly relevant if combined with another document of the same category A : technological background O : non-written disclosure P : intermediate document T : theory or principle underlying the invention E : earlier patent document, but published on, or after the filing date D : document cited in the application L : document cited for other reasons & : member of the same patent family, corresponding document			

 2
 EPO FORM 1503 03/02 (P04C01)

**ANNEX TO THE EUROPEAN SEARCH REPORT
ON EUROPEAN PATENT APPLICATION NO.**

EP 10 17 6721

This annex lists the patent family members relating to the patent documents cited in the above-mentioned European search report.
The members are as contained in the European Patent Office EDP file on
The European Patent Office is in no way liable for these particulars which are merely given for the purpose of information.

09-12-2013

Patent document cited in search report	Publication date	Patent family member(s)	Publication date
JP H06117807 A	28-04-1994	JP 3043529 B2 JP H06117807 A	22-05-2000 28-04-1994
DE 2121309 A1	25-11-1971	NONE	
US 5859425 A	12-01-1999	DE 19641929 A1 DE 59704358 D1 EP 0836079 A1 JP 3137913 B2 JP H10122902 A US 5859425 A	16-04-1998 27-09-2001 15-04-1998 26-02-2001 15-05-1998 12-01-1999
US 2008012555 A1	17-01-2008	DE 102007030093 A1 US 2008012555 A1	05-06-2008 17-01-2008
US 4349735 A	14-09-1982	JP S563410 U US 4349735 A	13-01-1981 14-09-1982
DE 102006024680 A1	29-11-2007	NONE	