



(12) **EUROPEAN PATENT APPLICATION**

(88) Date of publication A3:
15.06.2011 Bulletin 2011/24

(51) Int Cl.:
E05D 13/00 (2006.01)

(43) Date of publication A2:
04.05.2011 Bulletin 2011/18

(21) Application number: **10188522.6**

(22) Date of filing: **22.10.2010**

(84) Designated Contracting States:
AL AT BE BG CH CY CZ DE DK EE ES FI FR GB GR HR HU IE IS IT LI LT LU LV MC MK MT NL NO PL PT RO RS SE SI SK SM TR
Designated Extension States:
BA ME

(71) Applicant: **Champion Door OY**
85500 Nivala (FI)

(72) Inventor: **Hosio, Pekka**
FI-85500, Nivala (FI)

(74) Representative: **Vanhala, Jorma Kalevi**
Berggren Oy Ab
Kirkkokatu 9
90100 Oulu (FI)

(30) Priority: **27.10.2009 FI 20096100**

(54) **Safety catch for vertically movable door and vertically movable door**

(57) The vertically movable door has a flexible door plate, a hoist mechanism for lifting and lowering the door plate and a lower beam, which is attached with suspension members, such as hoist lines (34), to the hoist mechanism. In the edges of the door plate there are side rails guiding the vertical movement of the door plate. The vertically movable door has a safety catch, which has a protruding locking cam (56), which attaches to the side rail. The safety catch prevents the uncontrolled falling of the vertically movable door due for example to the breaking of the suspension member. The safety catch comprises a catch plate (30), wherein said locking cam is formed, a turning axis (32) for attaching the catch plate in a ro-

tating manner to the lower beam of the vertically movable door and attaching members for attaching the hoist line to the catch plate. The catch plate is arranged to rotate into a locking position, where the locking cam is pushed up, when the tension force of the suspension member attached thereto falls below a predetermined value. Correspondingly the catch plate is arranged to remain in a standby position, where the locking cam is not protruding, when the tension force of the suspension member attached thereto exceeds the predetermined value. The locking cam is arranged to protrude from the vertical edge of the door plate in the direction of the tangent of the door plate. The side rails comprise a catch rail (60), which has locking holes (70) for receiving the locking cam.

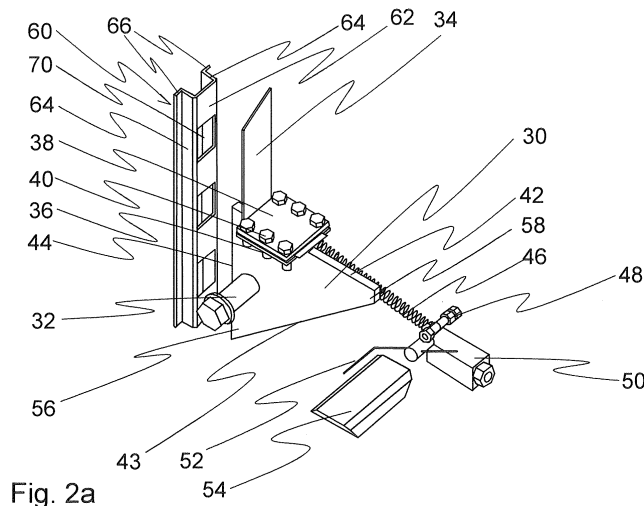

Fig. 2a



EUROPEAN SEARCH REPORT

Application Number
EP 10 18 8522

DOCUMENTS CONSIDERED TO BE RELEVANT			
Category	Citation of document with indication, where appropriate, of relevant passages	Relevant to claim	CLASSIFICATION OF THE APPLICATION (IPC)
X	US 1 936 269 A (SCHAFFERT ADOLF H ET AL) 21 November 1933 (1933-11-21)	1-11	INV. E05D13/00
Y	* page 1, line 37 - page 2, line 21; figures 1,2,4 *	12	
Y	----- US 4 368 770 A (ULFHIELM TORBJORN [SE]) 18 January 1983 (1983-01-18) * abstract; figures 1-5 * -----	12	
The present search report has been drawn up for all claims			TECHNICAL FIELDS SEARCHED (IPC)
			E05D
Place of search		Date of completion of the search	Examiner
The Hague		4 May 2011	Guillaume, Geert
CATEGORY OF CITED DOCUMENTS		T : theory or principle underlying the invention E : earlier patent document, but published on, or after the filing date D : document cited in the application L : document cited for other reasons	
X : particularly relevant if taken alone Y : particularly relevant if combined with another document of the same category A : technological background O : non-written disclosure P : intermediate document		& : member of the same patent family, corresponding document	

1
EPO FORM 1503 03.82 (P04C01)

**ANNEX TO THE EUROPEAN SEARCH REPORT
ON EUROPEAN PATENT APPLICATION NO.**

EP 10 18 8522

This annex lists the patent family members relating to the patent documents cited in the above-mentioned European search report. The members are as contained in the European Patent Office EDP file on
The European Patent Office is in no way liable for these particulars which are merely given for the purpose of information.

04-05-2011

Patent document cited in search report		Publication date	Patent family member(s)	Publication date
US 1936269	A	21-11-1933	NONE	

US 4368770	A	18-01-1983	NONE	

EPO FORM P 0459

For more details about this annex : see Official Journal of the European Patent Office, No. 12/82