



(12) **EUROPEAN PATENT APPLICATION**

(88) Date of publication A3:  
**26.09.2012 Bulletin 2012/39**

(51) Int Cl.:  
**A47L 15/42 (2006.01)**

(43) Date of publication A2:  
**15.06.2011 Bulletin 2011/24**

(21) Application number: **10194718.2**

(22) Date of filing: **13.12.2010**

(84) Designated Contracting States:  
**AL AT BE BG CH CY CZ DE DK EE ES FI FR GB GR HR HU IE IS IT LI LT LU LV MC MK MT NL NO PL PT RO RS SE SI SK SM TR**  
Designated Extension States:  
**BA ME**

(71) Applicant: **Bitron S.p.A.**  
**10122 Torino (TO) (IT)**

(72) Inventor: **Brignone, Enzo**  
**12025 Fr. Monastero Dronero (Cuneo) (IT)**

(74) Representative: **Gerbino, Angelo et al**  
**Jacobacci & Partners S.p.A.**  
**Corso Emilia 8**  
**10152 Torino (IT)**

(30) Priority: **14.12.2009 IT TO20090981**

(54) **Integrated accessory for supplying a dishwasher**

(57) The integrated accessory for a dishwasher comprises at least an electric power supply cable (38) and a water supply tube (24), each having a first end associated

with a casing (10), the latter having means for electrical connection to an electric circuit inside the dishwasher. A second end of the water supply tube (24) is also connected to an anti-flood device (36).

**FIG 1**

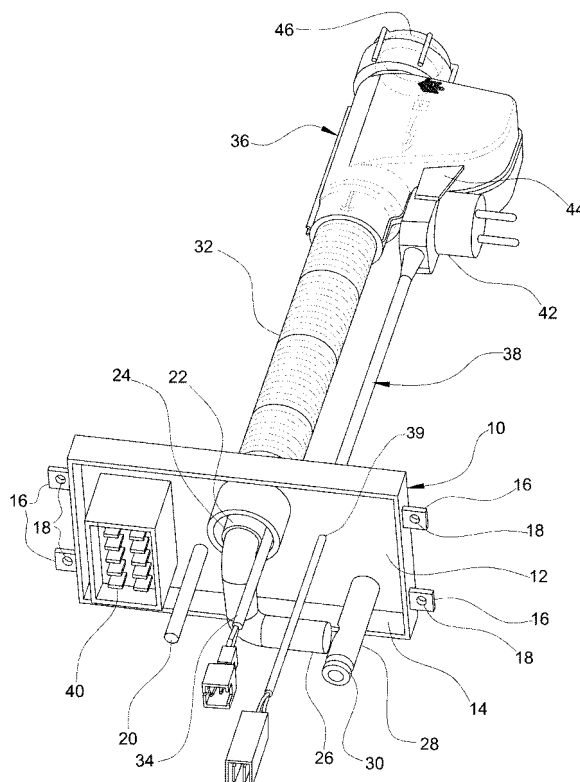



## EUROPEAN SEARCH REPORT

Application Number  
EP 10 19 4718

DOCUMENTS CONSIDERED TO BE RELEVANT				
Category	Citation of document with indication, where appropriate, of relevant passages	Relevant to claim	CLASSIFICATION OF THE APPLICATION (IPC)	
X	US 2003/005731 A1 (MONTGOMERY DANNY K [US]) 9 January 2003 (2003-01-09)	1,4,13	INV. A47L15/42	
Y	* columns 35-52; figures *	2,3,6, 9-12		
Y	GB 1 119 564 A (ELECTROLUX AB) 10 July 1968 (1968-07-10) * page 1, line 54 - page 2, line 24; figures *	1,4,5,9, 10,12,13		
Y	JP 2007 202876 A (MATSUSHITA ELECTRIC IND CO LTD) 16 August 2007 (2007-08-16) * abstract; figures *	1,4,5,9, 10,12,13		
Y	DE 195 37 034 C1 (BAUKNECHT HAUSGERAETE [DE]) 2 October 1996 (1996-10-02) * column 3, lines 61-64 *	2,3,9-13		
Y	DE 10 2007 052086 A1 (BSH BOSCH SIEMENS HAUSGERAETE [DE]) 7 May 2009 (2009-05-07)  * paragraph [0044]; figure 2 *	1-5, 8-10,12, 13		TECHNICAL FIELDS SEARCHED (IPC)
Y	WO 2008/122851 A1 (VESTEL BEYAZ ESYA SANAYI VE TI [TR]; ELDEM MEHMET; HASPOLAT ERDAL [TR]) 16 October 2008 (2008-10-16) * page 4 - page 5; figures *	1-5, 8-10,12, 13		A47L D06F H01R
Y	DE 197 56 208 A1 (BITRON SPA [IT]) 25 June 1998 (1998-06-25) * column 1 - column 2; figures *	1,3-5, 9-13		
Y	WO 2008/054321 A1 (ERIKSSON STELLAN [SE]) 8 May 2008 (2008-05-08) * pages 3,5,8; figures *	1,3-5, 9-13		
Y	GB 2 387 043 A (ELECTROLUX HOME PROD CORP [BE]) 1 October 2003 (2003-10-01) * page 3 - page 4; figures *	6		
The present search report has been drawn up for all claims				
Place of search Munich		Date of completion of the search 10 August 2012	Examiner Lopez Vega, Javier	
<p>CATEGORY OF CITED DOCUMENTS</p> <p>X : particularly relevant if taken alone Y : particularly relevant if combined with another document of the same category A : technological background O : non-written disclosure P : intermediate document</p> <p>T : theory or principle underlying the invention E : earlier patent document, but published on, or after the filing date D : document cited in the application L : document cited for other reasons &amp; : member of the same patent family, corresponding document</p>				

3  
EPO FORM 1503 03.82 (P04C01)



Application Number

EP 10 19 4718

**CLAIMS INCURRING FEES**

The present European patent application comprised at the time of filing claims for which payment was due.

☐ Only part of the claims have been paid within the prescribed time limit. The present European search report has been drawn up for those claims for which no payment was due and for those claims for which claims fees have been paid, namely claim(s):

☐ No claims fees have been paid within the prescribed time limit. The present European search report has been drawn up for those claims for which no payment was due.

**LACK OF UNITY OF INVENTION**

The Search Division considers that the present European patent application does not comply with the requirements of unity of invention and relates to several inventions or groups of inventions, namely:

see sheet B

☒ All further search fees have been paid within the fixed time limit. The present European search report has been drawn up for all claims.

☐ As all searchable claims could be searched without effort justifying an additional fee, the Search Division did not invite payment of any additional fee.

☐ Only part of the further search fees have been paid within the fixed time limit. The present European search report has been drawn up for those parts of the European patent application which relate to the inventions in respect of which search fees have been paid, namely claims:

☐ None of the further search fees have been paid within the fixed time limit. The present European search report has been drawn up for those parts of the European patent application which relate to the invention first mentioned in the claims, namely claims:

☐ The present supplementary European search report has been drawn up for those parts of the European patent application which relate to the invention first mentioned in the claims (Rule 164 (1) EPC).



**LACK OF UNITY OF INVENTION  
SHEET B**

Application Number  
EP 10 19 4718

The Search Division considers that the present European patent application does not comply with the requirements of unity of invention and relates to several inventions or groups of inventions, namely:

1. claims: 1, 2, 4, 5, 9, 10, 12, 13

integrated accessory with means for retaining a plug

---

2. claim: 3

integrated accessory with enclosed water supply tube

---

3. claims: 6, 7

integrated accessory with anti-jamming filter

---

4. claims: 8, 11

integrated accessory with connecting piece for the water supply tube or with a centering pin

---

**ANNEX TO THE EUROPEAN SEARCH REPORT  
ON EUROPEAN PATENT APPLICATION NO.**

EP 10 19 4718

This annex lists the patent family members relating to the patent documents cited in the above-mentioned European search report.  
The members are as contained in the European Patent Office EDP file on  
The European Patent Office is in no way liable for these particulars which are merely given for the purpose of information.

10-08-2012

Patent document cited in search report	Publication date	Patent family member(s)	Publication date
US 2003005731 A1	09-01-2003	NONE	
GB 1119564 A	10-07-1968	DE 1460825 A1	30-04-1969
		DK 109741 C	24-06-1968
		FI 41735 B	31-10-1969
		FR 1454126 A	22-07-1966
		GB 1119564 A	10-07-1968
		NO 116755 B	19-05-1969
		US 3381700 A	07-05-1968
JP 2007202876 A	16-08-2007	CN 101011230 A	08-08-2007
		JP 4676347 B2	27-04-2011
		JP 2007202876 A	16-08-2007
		KR 20070079918 A	08-08-2007
DE 19537034 C1	02-10-1996	NONE	
DE 102007052086 A1	07-05-2009	AT 520815 T	15-09-2011
		DE 102007052086 A1	07-05-2009
		EP 2209938 A1	28-07-2010
		ES 2368778 T3	22-11-2011
		WO 2009056456 A1	07-05-2009
WO 2008122851 A1	16-10-2008	AT 541981 T	15-02-2012
		EP 2132369 A1	16-12-2009
		ES 2380390 T3	11-05-2012
		TR 200702331 A2	21-11-2008
		WO 2008122851 A1	16-10-2008
DE 19756208 A1	25-06-1998	DE 19756208 A1	25-06-1998
		FR 2757603 A1	26-06-1998
		IT T0960261 U1	22-06-1998
WO 2008054321 A1	08-05-2008	CA 2667757 A1	08-05-2008
		CN 101548126 A	30-09-2009
		EP 2084443 A1	05-08-2009
		RU 2009115378 A	10-12-2010
		SE 0602301 A	01-05-2008
		US 2010000045 A1	07-01-2010
		WO 2008054321 A1	08-05-2008
GB 2387043 A	01-10-2003	DE 20303849 U1	15-05-2003
		ES 1054193 U	16-06-2003
		FR 2837086 A1	19-09-2003
		GB 2387043 A	01-10-2003
		IT PN20020015 U1	15-09-2003

EPO FORM P0459

For more details about this annex : see Official Journal of the European Patent Office, No. 12/82

10-08-2012

Patent document cited in search report	Publication date	Patent family member(s)	Publication date
<hr/>			

EPO FORM P0459

For more details about this annex : see Official Journal of the European Patent Office, No. 12/82