



(12) **EUROPEAN PATENT APPLICATION**

(88) Date of publication A3:
18.03.2015 Bulletin 2015/12

(51) Int Cl.:
B65H 67/04 (2006.01) **B65H 54/26 (2006.01)**
D01H 9/10 (2006.01) **D01H 13/00 (2006.01)**

(43) Date of publication A2:
20.07.2011 Bulletin 2011/29

(21) Application number: **11150362.9**

(22) Date of filing: **07.01.2011**

(84) Designated Contracting States:
AL AT BE BG CH CY CZ DE DK EE ES FI FR GB GR HR HU IE IS IT LI LT LU LV MC MK MT NL NO PL PT RO RS SE SI SK SM TR
Designated Extension States:
BA ME

(30) Priority: **15.01.2010 JP 2010007385**
01.06.2010 JP 2010126031

(71) Applicant: **Murata Machinery, Ltd.**
Minami-ku
Kyoto-shi
Kyoto 601-8326 (JP)

(72) Inventors:
• **Inoue, Takuya**
Kyoto Kyoto 612-8686 (JP)
• **Sawanoi, Kaname**
Kyoto Kyoto 612-8686 (JP)
• **Murayama, Kenichi**
Kyoto Kyoto 612-8686 (JP)
• **Shiota, Takeshi**
Kyoto Kyoto 612-8686 (JP)

(74) Representative: **Weickmann & Weickmann**
Maximilianstrasse 4b
82319 Starnberg (DE)

(54) **Doffing apparatus**

(57) A textile machine represented by an automatic winder (1, 103) including multiple winding units (2, 112) arranged in a row and a doffing apparatus (3, 103) capable of running in an arrangement direction of the winding units. The winding units wind on a winding tube (7, 133) a spun yarn that is unwound from multiple yarn supplying bobbins (5) while performing yarn joining thereby creating a fully-wound package of a specific yarn amount. The doffing apparatus (3, 103) of the automatic winder (1, 103) includes, for example, a cradle opener (32, 140) that performs opening/closing operation and raising/lowering operation of a cradle (12, 132), and a yarn catching unit (60, 145) that catches a yarn end on the yarn supplying bobbin side and guides the yarn end to a winding tube (7, 133). The cradle opener (32, 140) is raised or lowered by a fluid pressure cylinder (38, 158) and opened or closed by a driving motor (52, 152, 156). The yarn catching unit (60, 145) is driven by a driving source (62, 171, 182).

FIG. 3

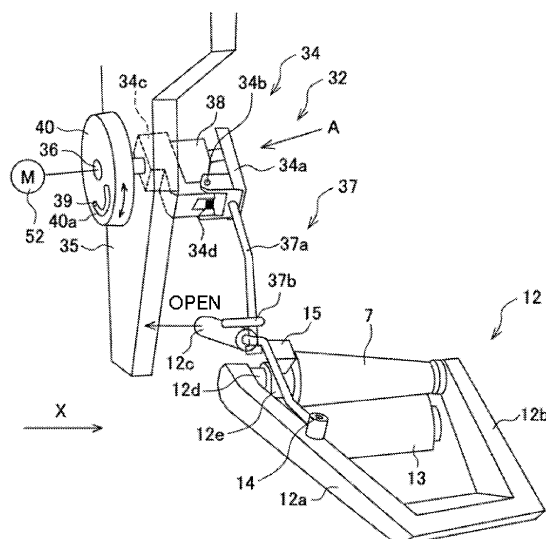



EUROPEAN SEARCH REPORT

Application Number
EP 11 15 0362

5

10

15

20

25

30

35

40

45

50

55

DOCUMENTS CONSIDERED TO BE RELEVANT			
Category	Citation of document with indication, where appropriate, of relevant passages	Relevant to claim	CLASSIFICATION OF THE APPLICATION (IPC)
X	DE 10 2007 036696 A1 (OERLIKON TEXTILE GMBH & CO KG [DE]) 5 February 2009 (2009-02-05) * the whole document *	1-8	INV. B65H67/04 B65H54/26 D01H9/10 D01H13/00
X	DE 199 35 695 A1 (STAHLECKER FRITZ [DE]; STAHLECKER HANS [DE]) 1 February 2001 (2001-02-01) * column 4, lines 49-67; figure 2 *	1,2	
			TECHNICAL FIELDS SEARCHED (IPC)
			B65H D01H
The present search report has been drawn up for all claims			
Place of search The Hague		Date of completion of the search 6 February 2015	Examiner Pussemier, Bart
CATEGORY OF CITED DOCUMENTS X : particularly relevant if taken alone Y : particularly relevant if combined with another document of the same category A : technological background O : non-written disclosure P : intermediate document T : theory or principle underlying the invention E : earlier patent document, but published on, or after the filing date D : document cited in the application L : document cited for other reasons & : member of the same patent family, corresponding document			

 1
EPO FORM 1503 03/82 (P04C01)

**ANNEX TO THE EUROPEAN SEARCH REPORT
ON EUROPEAN PATENT APPLICATION NO.**

EP 11 15 0362

5

This annex lists the patent family members relating to the patent documents cited in the above-mentioned European search report.
The members are as contained in the European Patent Office EDP file on
The European Patent Office is in no way liable for these particulars which are merely given for the purpose of information.

06-02-2015

10

Patent document cited in search report	Publication date	Patent family member(s)	Publication date
DE 102007036696 A1	05-02-2009	NONE	
DE 19935695 A1	01-02-2001	NONE	

15

20

25

30

35

40

45

50

55

EPO FORM P0459

For more details about this annex : see Official Journal of the European Patent Office, No. 12/82