



(12) **EUROPEAN PATENT APPLICATION**

(88) Date of publication A3:
10.12.2014 Bulletin 2014/50

(51) Int Cl.:
D03J 1/22 (2006.01) D03D 49/12 (2006.01)

(43) Date of publication A2:
11.01.2012 Bulletin 2012/02

(21) Application number: **11004933.5**

(22) Date of filing: **16.06.2011**

(84) Designated Contracting States:
AL AT BE BG CH CY CZ DE DK EE ES FI FR GB GR HR HU IE IS IT LI LT LU LV MC MK MT NL NO PL PT RO RS SE SI SK SM TR
Designated Extension States:
BA ME

(72) Inventors:
• **Kakutani, Kazuto**
Kanazawa-shi
Ishikawa-ken 921-8650 (JP)
• **Itou, Naoyuki**
Kanazawa-shi
Ishikawa-ken 921-8650 (JP)

(30) Priority: **06.07.2010 JP 2010154107**

(71) Applicant: **Tsudakoma Kogyo Kabushiki Kaisha**
Kanazawa-shi, Ishikawa 921-8650 (JP)

(74) Representative: **Samson & Partner**
Widenmayerstraße 5
80538 München (DE)

(54) **Temple device for loom including automatic temple position switching mechanism and method of driving temple thereof**

(57) Provided is a method of driving a temple (41) of a temple device (40) including an automatic temple position switching mechanism (42), the temple device (40) being used for a loom that successively weaves a fabric (2a) having two or more weave sections with different weft densities in accordance with a set weaving length that has been set, the temple (41) being displaceable between two positions, the automatic temple position switching mechanism (42) automatically switching a position of the temple (41) between two positions that are an operating position and a standby position, the method being performed when displacing the temple (41) from

the operating position toward the standby position in accordance with switching between the weave sections, the method including successively detecting a weaving length of a weave section that is being woven, and displacing the temple (41) in accordance with a preset operation mode including a movement start timing of the temple (41) such that movement of the temple (41) is started before the detected weaving length reaches the set weaving length and such that the temple (41) reaches a non-operating position after a plurality of weft-insertion periods.

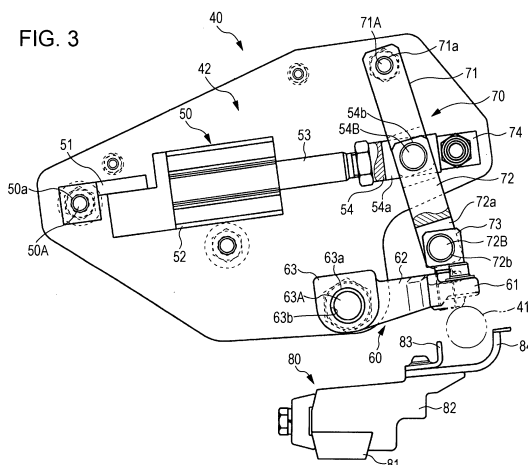



EUROPEAN SEARCH REPORT

Application Number
EP 11 00 4933

DOCUMENTS CONSIDERED TO BE RELEVANT			
Category	Citation of document with indication, where appropriate, of relevant passages	Relevant to claim	CLASSIFICATION OF THE APPLICATION (IPC)
A,D	US 5 065 796 A (ROACH ERNEST F [US] ET AL) 19 November 1991 (1991-11-19) * abstract * * column 4, line 25 - column 6, line 46 * * figures 1-6 *	1-7	INV. D03J1/22 D03D49/12
A	DE 90 06 343 U1 (GEBRÜDER SULZER AG) 20 September 1990 (1990-09-20) * page 4, lines 3-20 * * page 7, paragraph 3 * * figures 1-5 *	1-7	
A	DD 261 383 A1 (FUERSTENWALDE REIFEN VEB K [DD]) 26 October 1988 (1988-10-26) * the whole document *	1-7	
A	JP H10 298853 A (TSUDAKOMA IND CO LTD) 10 November 1998 (1998-11-10) * abstract; figures 1-8 *	1-7	
			TECHNICAL FIELDS SEARCHED (IPC)
			D03J D03D
The present search report has been drawn up for all claims			
Place of search Munich		Date of completion of the search 28 October 2014	Examiner Louter, Petrus
<p>CATEGORY OF CITED DOCUMENTS</p> <p>X : particularly relevant if taken alone Y : particularly relevant if combined with another document of the same category A : technological background O : non-written disclosure P : intermediate document</p> <p>T : theory or principle underlying the invention E : earlier patent document, but published on, or after the filing date D : document cited in the application L : document cited for other reasons & : member of the same patent family, corresponding document</p>			

**ANNEX TO THE EUROPEAN SEARCH REPORT
ON EUROPEAN PATENT APPLICATION NO.**

EP 11 00 4933

This annex lists the patent family members relating to the patent documents cited in the above-mentioned European search report.
The members are as contained in the European Patent Office EDP file on
The European Patent Office is in no way liable for these particulars which are merely given for the purpose of information.

28-10-2014

Patent document cited in search report	Publication date	Patent family member(s)	Publication date
US 5065796 A	19-11-1991	CS 9102959 A3	13-05-1992
		DE 4132696 A1	09-04-1992
		EP 0479499 A1	08-04-1992
		JP H04281041 A	06-10-1992
		US 5065796 A	19-11-1991

DE 9006343 U1	20-09-1990	NONE	

DD 261383 A1	26-10-1988	NONE	

JP H10298853 A	10-11-1998	NONE	

EPO FORM P0459

For more details about this annex : see Official Journal of the European Patent Office, No. 12/82