



(12) **EUROPEAN PATENT APPLICATION**

(88) Date of publication A3:  
**20.04.2016 Bulletin 2016/16**

(51) Int Cl.:  
**B25B 13/10** (2006.01) **B25B 27/00** (2006.01)  
**B25B 13/06** (2006.01) **B25B 23/00** (2006.01)  
**B25B 13/48** (2006.01) **B25B 13/50** (2006.01)

(43) Date of publication A2:  
**07.03.2012 Bulletin 2012/10**

(21) Application number: **11180078.5**

(22) Date of filing: **05.09.2011**

(84) Designated Contracting States:  
**AL AT BE BG CH CY CZ DE DK EE ES FI FR GB GR HR HU IE IS IT LI LT LU LV MC MK MT NL NO PL PT RO RS SE SI SK SM TR**  
Designated Extension States:  
**BA ME**

(71) Applicant: **Vibropac B.V.**  
**4131 NR Vianen (NL)**

(72) Inventor: **Van Baal, Peter Gerardus**  
**4131 NR Vianen (NL)**

(74) Representative: **Van Breda, Jacobus**  
**Octrooibureau Los & Stigter B.V.,**  
**Weteringschans 96**  
**1017 XS Amsterdam (NL)**

(30) Priority: **03.09.2010 NL 2005310**

(54) **Device for loosening of a detachable motor part that is jammed in a cylinder head of a motor**

(57) Device for loosening of a detachable motor part, such as an injection nozzle (1) or similar, that is jammed in a cylinder head of a motor, comprising the socket wrench (5) with hexagonal recesses that is known as such, as well as at least two insert pieces (4) that can be inserted in the recess of the socket wrench for adapting the size of the socket wrench to the motor part, wherein each insert piece comprises a surface that during use of the device for loosening the motor part is in contact therewith, and is shaped in conformity to at least part (6) of the external circumference of the motor part.

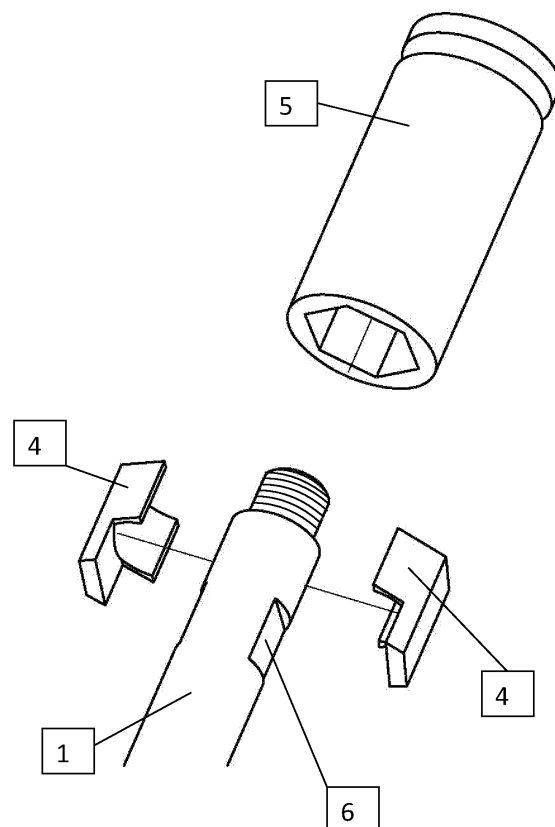

**Fig. 2**



## EUROPEAN SEARCH REPORT

Application Number  
EP 11 18 0078

5

10

15

20

25

30

35

40

45

50

55

1

EPO FORM 1503 03.82 (P04C01)

| DOCUMENTS CONSIDERED TO BE RELEVANT  |   |   |  |
|--|---|---|--|
| Category   | Citation of document with indication, where appropriate, of relevant passages   | Relevant to claim                                 | CLASSIFICATION OF THE APPLICATION (IPC)  |
| X  | FR 898 139 A (ARGUS MOTOREN GMBH)<br>11 April 1945 (1945-04-11)<br>* page 1, line 37 - page 2, line 17;<br>figures 1-4,7 *<br>----- | 1-4   | INV.<br>B25B13/10<br>B25B27/00<br>B25B13/06<br>B25B23/00<br>B25B13/48<br>B25B13/50 |
|  |   |   | TECHNICAL FIELDS SEARCHED (IPC)  |
|  |   |   | B25B   |
| The present search report has been drawn up for all claims   |   |   |  |
| Place of search<br>Munich  |   | Date of completion of the search<br>10 March 2016 | Examiner<br>Kühn, Thomas   |
| <p>CATEGORY OF CITED DOCUMENTS</p> <p>X : particularly relevant if taken alone<br/>Y : particularly relevant if combined with another document of the same category<br/>A : technological background<br/>O : non-written disclosure<br/>P : intermediate document</p> <p>T : theory or principle underlying the invention<br/>E : earlier patent document, but published on, or after the filing date<br/>D : document cited in the application<br/>L : document cited for other reasons</p> <p>&amp; : member of the same patent family, corresponding document</p> |   |   |  |

10-03-2016

| Patent document<br>cited in search report | Publication<br>date | Patent family<br>member(s) | Publication<br>date |
|---|---------------------|----------------------------|---------------------|
| FR 898139                                 | A                   | 11-04-1945                 | NONE                |
| -----                                     |                     |                            |                     |

EPO FORM P0459

For more details about this annex : see Official Journal of the European Patent Office, No. 12/82