



(12) **EUROPEAN PATENT APPLICATION**

(88) Date of publication A3:
08.01.2014 Bulletin 2014/02

(51) Int Cl.:
F21V 15/01 (2006.01) **F21V 31/00** (2006.01)

(43) Date of publication A2:
26.09.2012 Bulletin 2012/39

(21) Application number: **12159343.8**

(22) Date of filing: **13.03.2012**

(84) Designated Contracting States:
AL AT BE BG CH CY CZ DE DK EE ES FI FR GB GR HR HU IE IS IT LI LT LU LV MC MK MT NL NO PL PT RO RS SE SI SK SM TR
Designated Extension States:
BA ME

(72) Inventor: **Kamata, Yoshiji**
Kanagawa, 237-8510 (JP)

(74) Representative: **Willquist, Sofia Ellinor**
Awapatent AB
Junkersgatan 1
582 35 Linköping (SE)

(30) Priority: **24.03.2011 JP 2011066534**

(71) Applicant: **Toshiba Lighting & Technology Corporation**
Yokosuka-shi
Kanagawa 237-8510 (JP)

(54) **Sealed casing and luminaire**

(57) According to one embodiment, a sealed casing (11) includes a main body (12), a lid (45), a waterproof packing (61), and a plurality of screws (69). The main body (12) includes an opening (41) with a plurality of threaded holes (42). The lid (45) has a size sufficient for closing the opening (41) and includes a plurality of screw

through holes (49) in the peripheral portion (47). The waterproof packing (61) is attached to the lid (45) so as to enwrap the peripheral portion (47) from a side facing the opening (41) to the opposite side, and includes screw through holes (66) which communicates with the screw through holes (49). The screws (69) fasten the lid (45) to the main body (12).

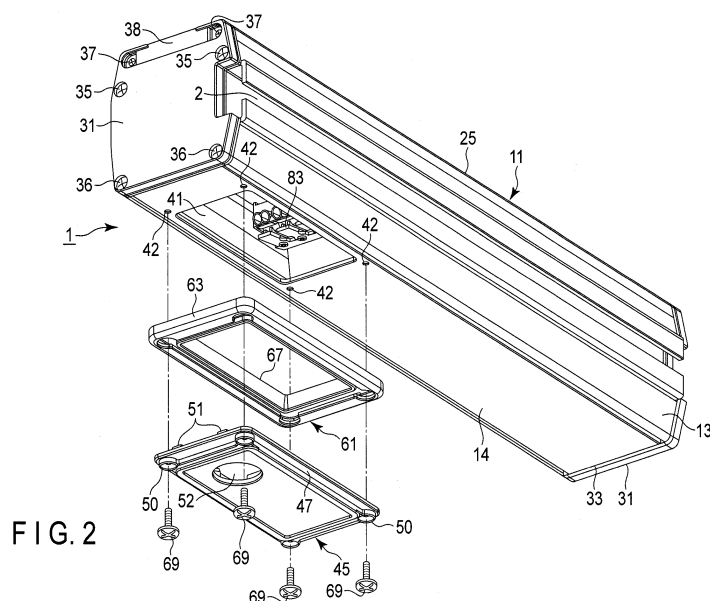

FIG. 2



EUROPEAN SEARCH REPORT

Application Number
EP 12 15 9343

DOCUMENTS CONSIDERED TO BE RELEVANT			
Category	Citation of document with indication, where appropriate, of relevant passages	Relevant to claim	CLASSIFICATION OF THE APPLICATION (IPC)
X	EP 1 541 906 A1 (HARTING ELECTRIC GMBH & CO KG [DE]) 15 June 2005 (2005-06-15)	1	INV. F21V15/01 F21V31/00
Y	* paragraph [0005] - paragraph [0019];	2,6,7	
A	figures 1-4 *	3-5	
Y	WO 92/13230 A1 (COLLINS WILLIAM J [US]) 6 August 1992 (1992-08-06) * page 4, line 30 - page 10, line 20; figures 1-5 *	2,6,7	
A	EP 1 718 898 A1 (ZUMTOBEL LIGHTING GMBH & CO KG [DE]) 8 November 2006 (2006-11-08) * paragraph [0019] - paragraph [0044]; figure 1 *	1,7	
			TECHNICAL FIELDS SEARCHED (IPC)
			F21V F16J
The present search report has been drawn up for all claims			
Place of search Munich		Date of completion of the search 4 December 2013	Examiner Arboreanu, Antoniu
<p>CATEGORY OF CITED DOCUMENTS</p> <p>X : particularly relevant if taken alone Y : particularly relevant if combined with another document of the same category A : technological background O : non-written disclosure P : intermediate document</p> <p>T : theory or principle underlying the invention E : earlier patent document, but published on, or after the filing date D : document cited in the application L : document cited for other reasons & : member of the same patent family, corresponding document</p>			

1
EPO FORM 1503 03/82 (P04C01)

**ANNEX TO THE EUROPEAN SEARCH REPORT
ON EUROPEAN PATENT APPLICATION NO.**

EP 12 15 9343

This annex lists the patent family members relating to the patent documents cited in the above-mentioned European search report.
The members are as contained in the European Patent Office EDP file on
The European Patent Office is in no way liable for these particulars which are merely given for the purpose of information.

04-12-2013

Patent document cited in search report		Publication date		Patent family member(s)		Publication date
EP 1541906	A1	15-06-2005	CA	2489066 A1		11-06-2005
			CN	1626856 A		15-06-2005
			DE	10357881 A1		14-07-2005
			EP	1541906 A1		15-06-2005
			ES	2303621 T3		16-08-2008
			JP	4015657 B2		28-11-2007
			JP	2005172239 A		30-06-2005
			US	2005127616 A1		16-06-2005

WO 9213230	A1	06-08-1992	AU	1275892 A		27-08-1992
			CA	2100752 A1		19-07-1992
			US	5154507 A		13-10-1992
			WO	9213230 A1		06-08-1992

EP 1718898	A1	08-11-2006	AT	409831 T		15-10-2008
			CN	1922435 A		28-02-2007
			DE 102004009632	A1		15-09-2005
			EP	1718898 A1		08-11-2006
			WO	2005083316 A1		09-09-2005
