



(12) **EUROPEAN PATENT APPLICATION**

(88) Date of publication A3:
24.04.2013 Bulletin 2013/17

(51) Int Cl.:
E03C 1/02 (2006.01) E04G 21/18 (2006.01)

(43) Date of publication A2:
14.11.2012 Bulletin 2012/46

(21) Application number: **12167587.0**

(22) Date of filing: **10.05.2012**

(84) Designated Contracting States:
**AL AT BE BG CH CY CZ DE DK EE ES FI FR GB
GR HR HU IE IS IT LI LT LU LV MC MK MT NL NO
PL PT RO RS SE SI SK SM TR**
Designated Extension States:
BA ME

(71) Applicant: **Erdelyi, Ladislav**
900 28 Zálesie (SK)

(72) Inventor: **Erdelyi, Ladislav**
900 28 Zálesie (SK)

(74) Representative: **Porubcan, Róbert**
Puskinova 19
900 28 Ivanka pri Dunaji (SK)

(30) Priority: **11.05.2011 SK 500592011 U**
10.05.2012 SK 500442012 U

(54) **Position adjustment device for the installation of plumbing components**

(57) Device for adjusting the position of pipe endings at mounting has a flat body (1) with two oblong hubs (3) with a fixed pitch. The hub axis (3) are parallel and in the hub axis (3) connecting elements (2) with a thread (14) are placed. Flat body (1) has at least two one-dimensional vials (4,5) or at least one two-dimensional vial to determine the horizontal position of the device. Flat body (1) has a predetermined spacing of the connecting elements

(2), preferably 100 or 150 mm and in a preferred arrangement will have a rotary arms (9) with adjustable stops (10). The device can contain a plate adapter (7) for connecting concealed mixing boxes. Plate adapter (7), as part of the device and also as a standalone product designated later for connection to a device includes a group of holes (16) and two holes (15) with threads for connection to the connecting element (2).

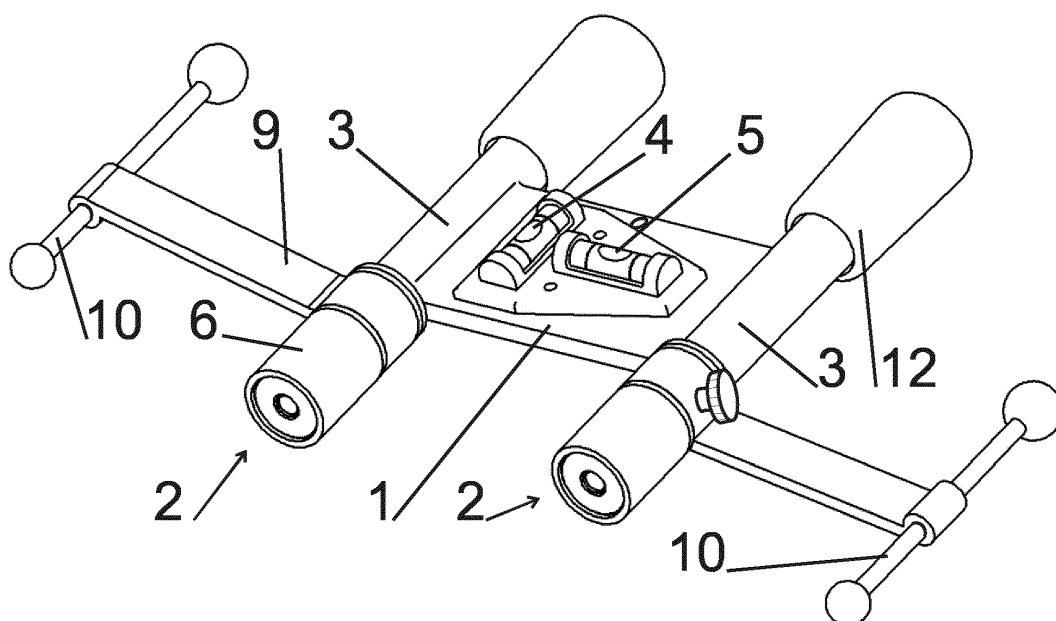

Fig. 3

**PARTIAL EUROPEAN SEARCH REPORT**

Application Number

under Rule 62a and/or 63 of the European Patent Convention.
This report shall be considered, for the purposes of
subsequent proceedings, as the European search report

EP 12 16 7587

DOCUMENTS CONSIDERED TO BE RELEVANT			
Category	Citation of document with indication, where appropriate, of relevant passages	Relevant to claim	CLASSIFICATION OF THE APPLICATION (IPC)
X,D	WO 01/65913 A1 (VILJOEN CAREL JOHANNES [ZA]) 13 September 2001 (2001-09-13)	1,4-7, 10-14	INV. E03C1/02
Y	* the whole document *	8,9	E04G21/18

X,D	DE 82 06 728 U1 (NICKEL KARL-HEINZ) 9 June 1982 (1982-06-09)	1	
	* the whole document *		

X	DE 20 2007 016289 U1 (DORNBRACHT ALOYS F GMBH [DE]) 21 February 2008 (2008-02-21)	15	
Y	* the whole document *	8,9	

X	EP 2 280 123 A1 (T P S TOULOUSE PREFABRICATION SANITAIRE [FR]) 2 February 2011 (2011-02-02)	15	
Y	* the whole document *	8,9	

			TECHNICAL FIELDS SEARCHED (IPC)
			E03C E04G
INCOMPLETE SEARCH			
<p>The Search Division considers that the present application, or one or more of its claims, does/do not comply with the EPC so that only a partial search (R.62a, 63) has been carried out.</p> <p>Claims searched completely :</p> <p>Claims searched incompletely :</p> <p>Claims not searched :</p> <p>Reason for the limitation of the search:</p> <p>see sheet C</p>			
Place of search		Date of completion of the search	Examiner
Munich		15 March 2013	Horst, Werner
CATEGORY OF CITED DOCUMENTS		<p>T : theory or principle underlying the invention</p> <p>E : earlier patent document, but published on, or after the filing date</p> <p>D : document cited in the application</p> <p>L : document cited for other reasons</p> <p>.....</p> <p>& : member of the same patent family, corresponding document</p>	
<p>X : particularly relevant if taken alone</p> <p>Y : particularly relevant if combined with another document of the same category</p> <p>A : technological background</p> <p>O : non-written disclosure</p> <p>P : intermediate document</p>			

 1
EPO FORM 1503 03.82 (P04E07)



**INCOMPLETE SEARCH
SHEET C**

Application Number
EP 12 16 7587

Claim(s) completely searchable:
1, 4-15

Claim(s) not searched:
2, 3

Reason for the limitation of the search:
see separate sheet

**ANNEX TO THE EUROPEAN SEARCH REPORT
ON EUROPEAN PATENT APPLICATION NO.**

EP 12 16 7587

This annex lists the patent family members relating to the patent documents cited in the above-mentioned European search report.
The members are as contained in the European Patent Office EDP file on
The European Patent Office is in no way liable for these particulars which are merely given for the purpose of information.

15-03-2013

Patent document cited in search report		Publication date		Patent family member(s)		Publication date
WO 0165913	A1	13-09-2001	AU	5007001 A		17-09-2001
			WO	0165913 A1		13-09-2001

DE 8206728	U1	09-06-1982	NONE			

DE 202007016289	U1	21-02-2008	NONE			

EP 2280123	A1	02-02-2011	EP	2280123 A1		02-02-2011
			FR	2948434 A1		28-01-2011
