

(19)



(11)

**EP 2 543 761 A3**

(12)

**EUROPEAN PATENT APPLICATION**

(88) Date of publication A3:  
**12.03.2014 Bulletin 2014/11**

(51) Int Cl.:  
**D06F 39/00 (2006.01) D06F 39/12 (2006.01)**

(43) Date of publication A2:  
**09.01.2013 Bulletin 2013/02**

(21) Application number: **12179178.4**

(22) Date of filing: **05.08.2011**

(84) Designated Contracting States:  
**AL AT BE BG CH CY CZ DE DK EE ES FI FR GB GR HR HU IE IS IT LI LT LU LV MC MK MT NL NO PL PT RO RS SE SI SK SM TR**  
Designated Extension States:  
**BA ME**

(71) Applicant: **Indesit Company S.p.A.**  
**60044 Fabriano (AN) (IT)**

(72) Inventor: **Gigioni, Cristiana**  
**60030 Mergo (AN) (IT)**

(74) Representative: **Santonicola, Paolo**  
**Indesit Company S.p.A.**  
**Industrial Property Management Team**  
**Via Lamberto Corsi, 55**  
**60044 Fabriano (AN) (IT)**

(30) Priority: **05.08.2010 IT RN20100047**

(62) Document number(s) of the earlier application(s) in accordance with Art. 76 EPC:  
**11176677.0 / 2 415 925**

(54) **A system comprising an electrical household appliance and means for releasing the faceplate of the electrical household appliance from the rest of the electrical household appliance**

(57) Electrical household appliance (1) comprising a faceplate (2) comprising a user interface (20) for controlling the electrical household appliance (1), a machine body (3) coinciding with the parts of the electrical household appliance (1) outside the faceplate (2), the machine body (3) comprising a recess (30) for positioning the faceplate (2) and means (4) for fastening the faceplate (2) to the positioning housing (30), the fastening means (4) being partly integrated in the faceplate (2) and partly integrated in the machine body (3), the fastening means (4)

comprising at least a first snap-on connector (41) to allow the faceplate (2) to be connected without the aid of tools outside the electrical household appliance (1), and means (5) for releasing the faceplate (2) from the rest of the electrical household appliance (1).

According to the present invention, the release means (5) comprise a tool which is both outside of, and removable from, both the faceplate (2) and the machine body (3) of the electrical household appliance (1) and which is designed to interact with the first connector (41).

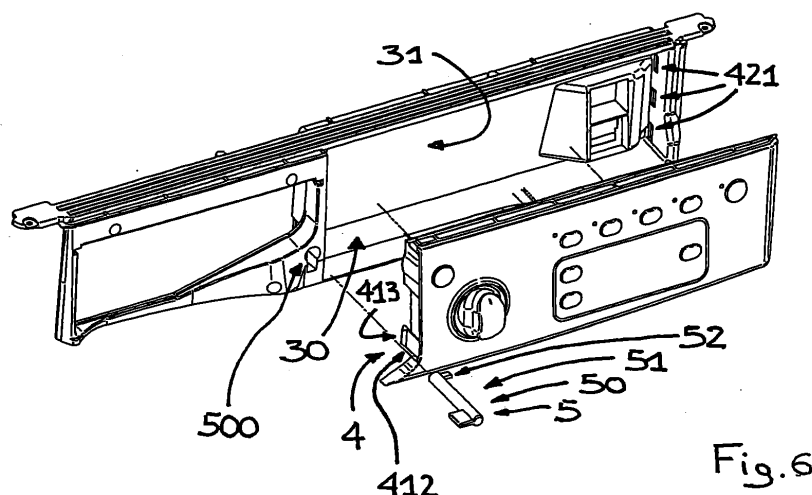

**EP 2 543 761 A3**



## EUROPEAN SEARCH REPORT

Application Number  
EP 12 17 9178

DOCUMENTS CONSIDERED TO BE RELEVANT			
Category	Citation of document with indication, where appropriate, of relevant passages	Relevant to claim	CLASSIFICATION OF THE APPLICATION (IPC)
X	DE 38 03 614 A1 (LICENTIA GMBH [DE]) 17 August 1989 (1989-08-17) * column 1, lines 1-14; column 2, lines 20-49; column 3, lines 3-31; claims; figures *	1-3	INV. D06F39/00 D06F39/12
A	----- WO 2004/025013 A1 (LG ELECTRONICS INC [KR]; KIM JONG SEOK [KR]; NO YANG HWAN [KR]; CHO HA) 25 March 2004 (2004-03-25) * page 4, line 17 - page 7, line 22; figures 1-4 *	1-3	
A	----- US 2005/178164 A1 (KIM JAE K [KR] ET AL KIM JAE KYUM [KR] ET AL) 18 August 2005 (2005-08-18) * paragraphs [0002], [0003], [0033], [0034], [0040] - [0053] *	1-3	
			TECHNICAL FIELDS SEARCHED (IPC)
			D06F
The present search report has been drawn up for all claims			
Place of search Munich		Date of completion of the search 4 February 2014	Examiner Clivio, Eugenio
CATEGORY OF CITED DOCUMENTS X : particularly relevant if taken alone Y : particularly relevant if combined with another document of the same category A : technological background O : non-written disclosure P : intermediate document T : theory or principle underlying the invention E : earlier patent document, but published on, or after the filing date D : document cited in the application L : document cited for other reasons & : member of the same patent family, corresponding document			

 1  
EPO FORM 1503 03.82 (P04C01)

**ANNEX TO THE EUROPEAN SEARCH REPORT  
ON EUROPEAN PATENT APPLICATION NO.**

EP 12 17 9178

This annex lists the patent family members relating to the patent documents cited in the above-mentioned European search report. The members are as contained in the European Patent Office EDP file on  
The European Patent Office is in no way liable for these particulars which are merely given for the purpose of information.

04-02-2014

Patent document cited in search report	Publication date	Patent family member(s)	Publication date
DE 3803614	A1	17-08-1989	NONE
-----			
WO 2004025013	A1	25-03-2004	AT 352655 T 15-02-2007
		AU 2003260994 A1	30-04-2004
		CN 1606644 A	13-04-2005
		DE 60311480 T2	31-10-2007
		EP 1540067 A1	15-06-2005
		ES 2279221 T3	16-08-2007
		JP 4313309 B2	12-08-2009
		JP 2005538765 A	22-12-2005
		US 2005012439 A1	20-01-2005
		WO 2004025013 A1	25-03-2004
-----			
US 2005178164	A1	18-08-2005	KR 20050081455 A 19-08-2005
		US 2005178164 A1	18-08-2005
		US 2008229789 A1	25-09-2008
-----			