

(19)



(11)

**EP 2 549 124 A3**

(12)

## EUROPEAN PATENT APPLICATION

(88) Date of publication A3:  
**06.03.2013 Bulletin 2013/10**

(51) Int Cl.:  
**F15B 13/01** <sup>(2006.01)</sup> **F16K 17/04** <sup>(2006.01)</sup>  
**F16K 27/04** <sup>(2006.01)</sup>

(43) Date of publication A2:  
**23.01.2013 Bulletin 2013/04**

(21) Application number: **12176655.4**

(22) Date of filing: **17.07.2012**

(84) Designated Contracting States:  
**AL AT BE BG CH CY CZ DE DK EE ES FI FR GB GR HR HU IE IS IT LI LT LU LV MC MK MT NL NO PL PT RO RS SE SI SK SM TR**  
Designated Extension States:  
**BA ME**

(71) Applicant: **Atlantic Fluid Tech S.r.l.**  
**41018 San Cesario sul Panaro (MO) (IT)**

(72) Inventor: **Storci, Christian**  
**41121 Modena (IT)**

(74) Representative: **Crugnola, Pietro et al**  
**Luppi Crugnola & Partners S.r.l.**  
**Viale Corassori 54**  
**41124 Modena (IT)**

(30) Priority: **19.07.2011 IT MO20110175**

### (54) Load supporting valve

(57) A valve (1) comprises a body (2), provided with a plurality of openings (3, 4, 5, 55) through which a pressurised fluid can enter or exit said valve (1) and cavity means (8, 9, 26, 54), made in the body (2) and suitable for receiving the fluid. The cavity means (8, 9, 26, 54) comprises a first cavity (8) and a second cavity (9), the

first cavity (8) comprising a portion (10) suitable for receiving a containing element (16) and the second cavity (9) comprising an end portion (9b) suitable for receiving a closing element (46). The valve (1) further comprises connecting means (58) suitable for making the portion (10) and the end portion (9b) reciprocally communicating.

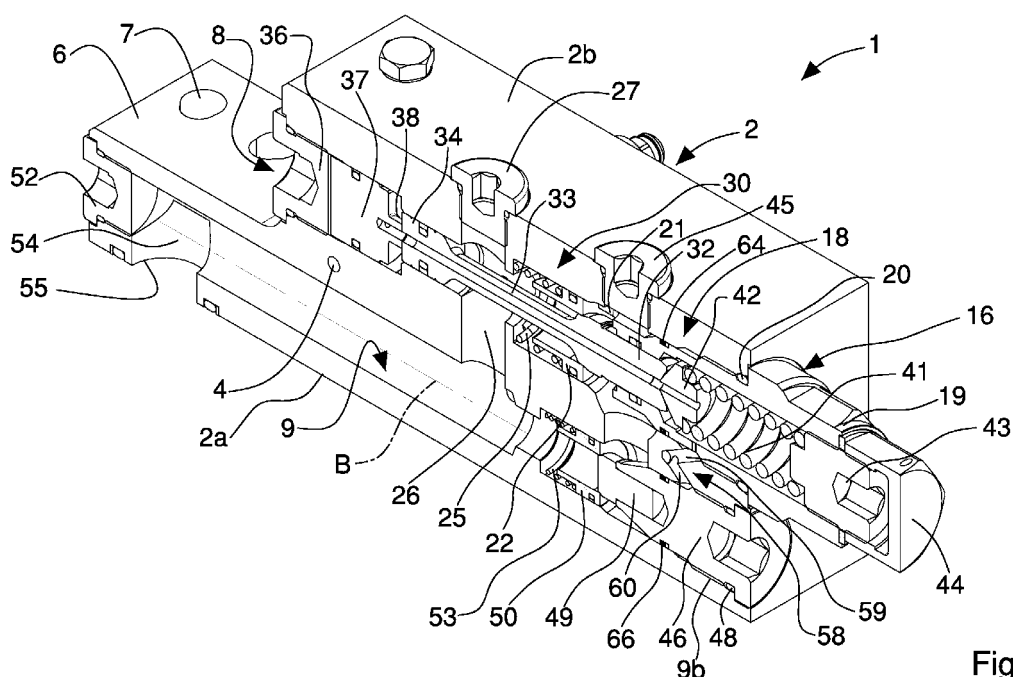

Fig. 2



## EUROPEAN SEARCH REPORT

Application Number  
EP 12 17 6655

DOCUMENTS CONSIDERED TO BE RELEVANT			
Category	Citation of document with indication, where appropriate, of relevant passages	Relevant to claim	CLASSIFICATION OF THE APPLICATION (IPC)
X	US 2009/249776 A1 (DAVIDSON NOAM [CA]) 8 October 2009 (2009-10-08) * abstract; figures 1,1A, 1B * -----	1-11	INV. F15B13/01 F16K17/04 F16K27/04
X	CN 201 021 682 Y (BEIJING AVIAT LAUNCH TECH RES [CN]) 13 February 2008 (2008-02-13) * abstract; figure 3 * -----	1-6	
X	US 3 665 810 A (PARRETT JOHN T) 30 May 1972 (1972-05-30) * abstract; figures 1-6 * -----	1-6	
X	US 3 472 261 A (BRANNON EDWARD O) 14 October 1969 (1969-10-14) * abstract; figure 1 * -----	1	
X	EP 0 049 034 A2 (MODULAR CONTROLS CORP [US]) 7 April 1982 (1982-04-07) * abstract; figures 1-4 * -----	1	
A	DE 10 2006 013482 A1 (RAUSCH & PAUSCH GMBH [DE]) 27 September 2007 (2007-09-27) * abstract; figures 3,4 * -----	1-11	TECHNICAL FIELDS SEARCHED (IPC)  F16K F15B
The present search report has been drawn up for all claims			
Place of search <b>Munich</b>		Date of completion of the search <b>30 January 2013</b>	Examiner <b>Podratzky, Andreas</b>
CATEGORY OF CITED DOCUMENTS X : particularly relevant if taken alone Y : particularly relevant if combined with another document of the same category A : technological background O : non-written disclosure P : intermediate document		T : theory or principle underlying the invention E : earlier patent document, but published on, or after the filing date D : document cited in the application L : document cited for other reasons ..... & : member of the same patent family, corresponding document	

 1  
EPO FORM 1503 03.02 (P04C01)

**ANNEX TO THE EUROPEAN SEARCH REPORT  
ON EUROPEAN PATENT APPLICATION NO.**

EP 12 17 6655

This annex lists the patent family members relating to the patent documents cited in the above-mentioned European search report.  
The members are as contained in the European Patent Office EDP file on  
The European Patent Office is in no way liable for these particulars which are merely given for the purpose of information.

30-01-2013

Patent document cited in search report	Publication date	Patent family member(s)	Publication date
US 2009249776 A1	08-10-2009	NONE	
CN 201021682 Y	13-02-2008	NONE	
US 3665810 A	30-05-1972	NONE	
US 3472261 A	14-10-1969	GB 1115144 A US 3472261 A	29-05-1968 14-10-1969
EP 0049034 A2	07-04-1982	CA 1150138 A1 DE 3169376 D1 EP 0049034 A2 JP 1038965 B JP 57061803 A US 4341148 A	19-07-1983 25-04-1985 07-04-1982 17-08-1989 14-04-1982 27-07-1982
DE 102006013482 A1	27-09-2007	NONE	

EPO FORM P0459

For more details about this annex : see Official Journal of the European Patent Office, No. 12/82