



(12) **EUROPEAN PATENT APPLICATION**

(88) Date of publication A3:
22.01.2014 Bulletin 2014/04

(51) Int Cl.:
B65H 69/06 (2006.01)

(43) Date of publication A2:
27.03.2013 Bulletin 2013/13

(21) Application number: **12171726.8**

(22) Date of filing: **13.06.2012**

(84) Designated Contracting States:
AL AT BE BG CH CY CZ DE DK EE ES FI FR GB GR HR HU IE IS IT LI LT LU LV MC MK MT NL NO PL PT RO RS SE SI SK SM TR
 Designated Extension States:
BA ME

(72) Inventors:
 • **Sato, Motohiko**
Kyoto, Kyoto 612-8686 (JP)
 • **Umeoka, Toshinari**
Kyoto, Kyoto 612-8686 (JP)

(30) Priority: **21.09.2011 JP 2011206334**

(74) Representative: **Beck, Alexander**
Hansmann & Vogeser
Patent- und Rechtsanwälte
Maximilianstrasse 4b
82319 Starnberg (DE)

(71) Applicant: **Murata Machinery, Ltd.**
Minami-ku, Kyoto 601-8326 (JP)

(54) **Yarn processing device and yarn winding device**

(57) A splicer (8) is a device that carries out processing of joining yarn ends as processing of a yarn, and includes an operation mechanism (80) that performs a plurality of operations to carry out the processing of join-

ing the yarn ends, and a cam mechanism (60) that controls the operation of the operation mechanism (80). The cam mechanism (60) includes a plurality of pattern portions corresponding to each operation of the operation mechanism (80).

FIG. 2

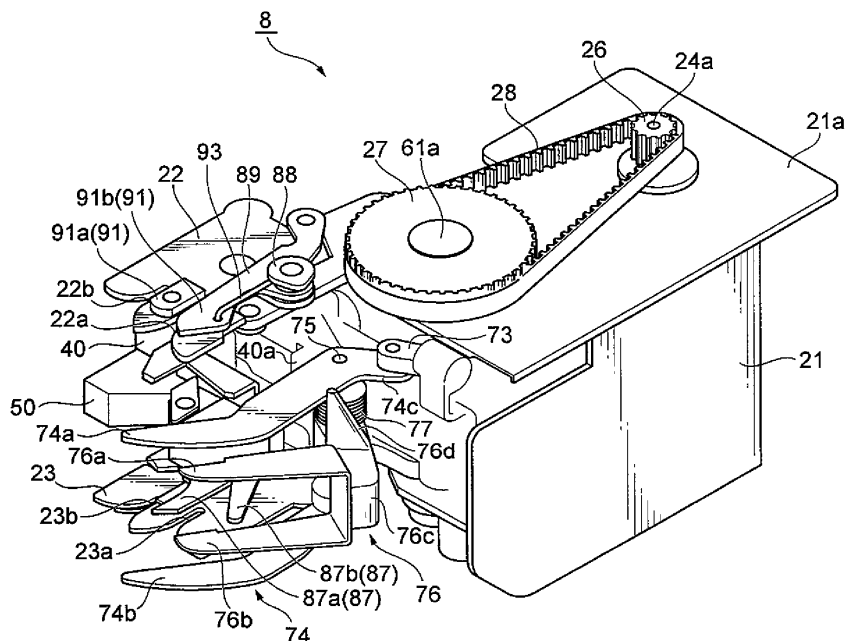



EUROPEAN SEARCH REPORT

Application Number
EP 12 17 1726

DOCUMENTS CONSIDERED TO BE RELEVANT				
Category	Citation of document with indication, where appropriate, of relevant passages	Relevant to claim	CLASSIFICATION OF THE APPLICATION (IPC)	
X	EP 0 454 238 A1 (CEM ITALIA SRL [IT]) 30 October 1991 (1991-10-30) * the whole document *	1-3,12	INV. B65H69/06	
X	EP 0 293 019 A2 (MANEA COST MECC [IT]) 30 November 1988 (1988-11-30) * the whole document *	1-3,12		
X	US 4 076 049 A (MANEA ANTONIO) 28 February 1978 (1978-02-28) * column 2, line 31 - column 6, line 3; figures 1-5 *	1-3,12		
X	US 6 199 360 B1 (PREMI MAURO [IT]) 13 March 2001 (2001-03-13) * the whole document *	1,4,5, 12-14		
X	US 4 733 829 A (MIMA HIROSHI [JP]) 29 March 1988 (1988-03-29) * column 15, line 48 - column 22, line 34 *	1,2,4, 12,14		
X	US 5 680 751 A (PREMI MAURO [IT]) 28 October 1997 (1997-10-28) * column 3, line 25 - column 4, line 63; figures 6-8 *	1,4,5, 12,13		TECHNICAL FIELDS SEARCHED (IPC) B65H D03D
X	EP 0 442 721 A2 (SHIMA SEIKI MFG [JP]) 21 August 1991 (1991-08-21) * column 4, lines 26-40; figure 3 *	1,4,6, 12,15 7,16		
Y	EP 1 426 568 A1 (TOYOTA MOTOR CO LTD [JP]) 9 June 2004 (2004-06-09) * paragraph [0064] *	7,16		
A	US 5 301 886 A (KATHKE GREGOR [DE] ET AL) 12 April 1994 (1994-04-12) * claim 14 *	4,15		
	----- -/--			
The present search report has been drawn up for all claims				
Place of search The Hague		Date of completion of the search 16 December 2013	Examiner Pussemier, Bart	
CATEGORY OF CITED DOCUMENTS X : particularly relevant if taken alone Y : particularly relevant if combined with another document of the same category A : technological background O : non-written disclosure P : intermediate document		T : theory or principle underlying the invention E : earlier patent document, but published on, or after the filing date D : document cited in the application L : document cited for other reasons & : member of the same patent family, corresponding document		

2
EPO FORM 1503 03.82 (P04C01)



EUROPEAN SEARCH REPORT

Application Number
EP 12 17 1726

DOCUMENTS CONSIDERED TO BE RELEVANT			
Category	Citation of document with indication, where appropriate, of relevant passages	Relevant to claim	CLASSIFICATION OF THE APPLICATION (IPC)
X,D	JP H04 42169 U (-) 9 April 1992 (1992-04-09)	1	
A	* the whole document * -----	8-11,17	
A	US 4 939 893 A (FUJIWARA MICHIAKI [JP]) 10 July 1990 (1990-07-10) * claim 1 *	8-11,17	
A	WO 98/42608 A1 (PENTWYN SPLICERS LTD [GB]; WATERS GRAHAM THOMAS [GB]) 1 October 1998 (1998-10-01) * claims 16,17,20 * -----	8,9,17	
The present search report has been drawn up for all claims			TECHNICAL FIELDS SEARCHED (IPC)
Place of search The Hague		Date of completion of the search 16 December 2013	Examiner Pussemier, Bart
CATEGORY OF CITED DOCUMENTS X : particularly relevant if taken alone Y : particularly relevant if combined with another document of the same category A : technological background O : non-written disclosure P : intermediate document		T : theory or principle underlying the invention E : earlier patent document, but published on, or after the filing date D : document cited in the application L : document cited for other reasons & : member of the same patent family, corresponding document	

2
EPO FORM 1503 03 82 (P04C01)



Application Number

EP 12 17 1726

CLAIMS INCURRING FEES

The present European patent application comprised at the time of filing claims for which payment was due.

- Only part of the claims have been paid within the prescribed time limit. The present European search report has been drawn up for those claims for which no payment was due and for those claims for which claims fees have been paid, namely claim(s):
- No claims fees have been paid within the prescribed time limit. The present European search report has been drawn up for those claims for which no payment was due.

LACK OF UNITY OF INVENTION

The Search Division considers that the present European patent application does not comply with the requirements of unity of invention and relates to several inventions or groups of inventions, namely:

see sheet B

- All further search fees have been paid within the fixed time limit. The present European search report has been drawn up for all claims.
- As all searchable claims could be searched without effort justifying an additional fee, the Search Division did not invite payment of any additional fee.
- Only part of the further search fees have been paid within the fixed time limit. The present European search report has been drawn up for those parts of the European patent application which relate to the inventions in respect of which search fees have been paid, namely claims:
- None of the further search fees have been paid within the fixed time limit. The present European search report has been drawn up for those parts of the European patent application which relate to the invention first mentioned in the claims, namely claims:
- The present supplementary European search report has been drawn up for those parts of the European patent application which relate to the invention first mentioned in the claims (Rule 164 (1) EPC).

**LACK OF UNITY OF INVENTION
SHEET B**Application Number
EP 12 17 1726

The Search Division considers that the present European patent application does not comply with the requirements of unity of invention and relates to several inventions or groups of inventions, namely:

1. claims: 1-3, 12

A yarn processing device and method with an operation mechanism and a transmission mechanism including a plurality of pattern portions, wherein the transmission mechanism is a cam mechanism including a rotatable plate-like member.

2. claims: 4, 5, 13, 14

A yarn processing device and method with an operation mechanism and a transmission mechanism including a plurality of pattern portions, comprising a drive source for controllably driving the transmission mechanism.

3. claims: 6, 7, 15, 16

A yarn processing device and method with an operation mechanism and a transmission mechanism including a plurality of pattern portions, with a sensor for detecting the initial position of the pattern portion.

4. claims: 8-11, 17

A yarn processing device with an operation mechanism and a transmission mechanism including a plurality of pattern portions, wherein the operations include joining of yarns.

ANNEX TO THE EUROPEAN SEARCH REPORT
ON EUROPEAN PATENT APPLICATION NO.

EP 12 17 1726

This annex lists the patent family members relating to the patent documents cited in the above-mentioned European search report. The members are as contained in the European Patent Office EDP file on The European Patent Office is in no way liable for these particulars which are merely given for the purpose of information.

16-12-2013

Patent document cited in search report		Publication date	Patent family member(s)	Publication date
EP 0454238	A1	30-10-1991	DE 69104536 D1	17-11-1994
			DE 69104536 T2	13-04-1995
			EP 0454238 A1	30-10-1991
			ES 2062665 T3	16-12-1994
			IT 1239713 B	15-11-1993
			JP H04228653 A	18-08-1992
			US 5193591 A	16-03-1993

EP 0293019	A2	30-11-1988	AU 8229587 A	01-12-1988
			CN 88101495 A	07-12-1988
			EP 0293019 A2	30-11-1988
			IT 1218130 B	12-04-1990
			JP S63303150 A	09-12-1988
			PL 272679 A1	20-02-1989
			US 4848415 A	18-07-1989

US 4076049	A	28-02-1978	BR 7602354 A	12-10-1976
			DE 2615829 A1	28-10-1976
			ES 447019 A1	16-09-1977
			FR 2307902 A1	12-11-1976
			GB 1537514 A	29-12-1978
			US 4076049 A	28-02-1978

US 6199360	B1	13-03-2001	CN 1238396 A	15-12-1999
			DE 19921855 A1	16-12-1999
			IT M1981316 A1	10-12-1999
			US 6199360 B1	13-03-2001

US 4733829	A	29-03-1988	DE 3544615 A1	26-06-1986
			IT 1208723 B	10-07-1989
			JP H0124706 B2	12-05-1989
			JP S61146827 A	04-07-1986
			US 4703651 A	03-11-1987
			US 4733829 A	29-03-1988

US 5680751	A	28-10-1997	CN 1140772 A	22-01-1997
			DE 19610818 A1	26-09-1996
			IT M1950558 A1	23-09-1996
			US 5680751 A	28-10-1997

EP 0442721	A2	21-08-1991	DE 69115948 D1	15-02-1996
			DE 69115948 T2	05-09-1996
			EP 0442721 A2	21-08-1991
			ES 2084097 T3	01-05-1996
			JP 2610533 B2	14-05-1997
			JP H03241047 A	28-10-1991

EPO FORM P0459

For more details about this annex : see Official Journal of the European Patent Office, No. 12/82

ANNEX TO THE EUROPEAN SEARCH REPORT
ON EUROPEAN PATENT APPLICATION NO.

EP 12 17 1726

This annex lists the patent family members relating to the patent documents cited in the above-mentioned European search report. The members are as contained in the European Patent Office EDP file on
The European Patent Office is in no way liable for these particulars which are merely given for the purpose of information.

16-12-2013

Patent document cited in search report	Publication date	Patent family member(s)	Publication date
		US 5251462 A	12-10-1993
EP 1426568	A1 09-06-2004	CN 1508415 A	30-06-2004
		CN 101113679 A	30-01-2008
		DE 60319495 T2	12-03-2009
		EP 1426568 A1	09-06-2004
		EP 1925787 A2	28-05-2008
		JP 4082197 B2	30-04-2008
		JP 2004183612 A	02-07-2004
		KR 20040049251 A	11-06-2004
		US 2004107928 A1	10-06-2004
		US 2006112919 A1	01-06-2006
US 5301886	A 12-04-1994	DE 4139892 A1	09-06-1993
		JP 3293909 B2	17-06-2002
		JP H05213537 A	24-08-1993
		US 5301886 A	12-04-1994
JP H0442169	U 09-04-1992	NONE	
US 4939893	A 10-07-1990	DE 3824850 A1	09-02-1989
		DE 3844759 A1	29-11-1990
		JP H0791707 B2	04-10-1995
		JP S6426741 A	30-01-1989
		US 4939893 A	10-07-1990
		US 5052173 A	01-10-1991
WO 9842608	A1 01-10-1998	AU 6411798 A	20-10-1998
		WO 9842608 A1	01-10-1998