



(12) **EUROPEAN PATENT APPLICATION**

(88) Date of publication A3:
13.11.2013 Bulletin 2013/46

(51) Int Cl.:
D03D 49/12 (2006.01)

(43) Date of publication A2:
24.04.2013 Bulletin 2013/17

(21) Application number: **12006669.1**

(22) Date of filing: **24.09.2012**

(84) Designated Contracting States:
AL AT BE BG CH CY CZ DE DK EE ES FI FR GB GR HR HU IE IS IT LI LT LU LV MC MK MT NL NO PL PT RO RS SE SI SK SM TR
Designated Extension States:
BA ME

(71) Applicant: **TSUDAKOMA KOGYO KABUSHIKI KAISHA**
Kanazawa-shi,
Ishikawa-ken 921-8650 (JP)

(72) Inventor: **Myogi, Keiichi**
Ishikawa-ken, 921-8650 (JP)

(30) Priority: **19.10.2011 JP 2011229500**

(74) Representative: **Samson & Partner**
Widenmayerstrasse 5
80538 München (DE)

(54) **Tension detection apparatus for loom**

(57) A tension detection apparatus for a loom includes a tension detection roller (1) that extends in a weaving-width direction between a pair of loom frames (F) and around which warp yarns (T) or a woven cloth is wound, a tension detection lever (3) provided on at least one of the loom frames (F) and connected to an end portion of the tension detection roller (1) so as to support the end portion, and a tension detector (5) connected to the tension detection lever (3). The tension detection lever (3) includes a base portion (3a) and an arm portion

(3c). The base portion (3a) is rotatably supported on the at least one of the loom frames (F) by means of a first shaft (7) that is parallel to the tension detection roller (1). The arm portion (3c) extends from the base portion (3a) and supports a second shaft (9) that supports the tension detection roller (1). The second shaft (9) extends in the weaving-width direction and is supported by the at least one of the loom frames (F), on which the tension detection lever (3) is supported, at a position different in the weaving-width direction from a position at which the second shaft (9) is supported by the tension detection lever (3).

FIG. 2

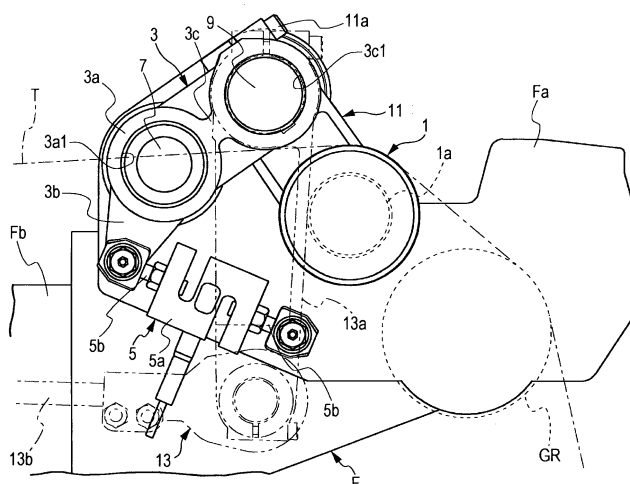



EUROPEAN SEARCH REPORT

Application Number
EP 12 00 6669

DOCUMENTS CONSIDERED TO BE RELEVANT			
Category	Citation of document with indication, where appropriate, of relevant passages	Relevant to claim	CLASSIFICATION OF THE APPLICATION (IPC)
A,D	EP 1 878 821 A1 (TSUDAKOMA IND CO LTD [JP]) 16 January 2008 (2008-01-16) * figures 1-9 *	1-4	INV. D03D49/12
A	----- EP 0 527 705 A1 (TOYODA AUTOMATIC LOOM WORKS [JP]) 17 February 1993 (1993-02-17) * figures 1-3 *	1-4	
A	----- FR 2 450 301 A1 (SULZER AG [CH]) 26 September 1980 (1980-09-26) * figure 1 *	1-4	
A	----- EP 0 547 003 A1 (TOYODA AUTOMATIC LOOM WORKS [JP]) 16 June 1993 (1993-06-16) * figure 1 *	1-4	

			TECHNICAL FIELDS SEARCHED (IPC)
			D03D
The present search report has been drawn up for all claims			
Place of search Munich		Date of completion of the search 2 October 2013	Examiner Iamandi, Daniela
CATEGORY OF CITED DOCUMENTS X : particularly relevant if taken alone Y : particularly relevant if combined with another document of the same category A : technological background O : non-written disclosure P : intermediate document T : theory or principle underlying the invention E : earlier patent document, but published on, or after the filing date D : document cited in the application L : document cited for other reasons & : member of the same patent family, corresponding document			

EPO FORM 1503 03/02 (P04C01) 1

**ANNEX TO THE EUROPEAN SEARCH REPORT
ON EUROPEAN PATENT APPLICATION NO.**

EP 12 00 6669

This annex lists the patent family members relating to the patent documents cited in the above-mentioned European search report.
The members are as contained in the European Patent Office EDP file on
The European Patent Office is in no way liable for these particulars which are merely given for the purpose of information.

02-10-2013

Patent document cited in search report		Publication date		Patent family member(s)		Publication date
EP 1878821	A1	16-01-2008	CN	101104976 A		16-01-2008
			EP	1878821 A1		16-01-2008
			JP	4955325 B2		20-06-2012
			JP	2008019516 A		31-01-2008

EP 0527705	A1	17-02-1993	EP	0527705 A1		17-02-1993
			JP	H0551845 A		02-03-1993

FR 2450301	A1	26-09-1980	AT	360922 B		10-02-1981
			CH	635627 A5		15-04-1983
			CS	219268 B2		25-03-1983
			DE	2911863 A1		04-09-1980
			FR	2450301 A1		26-09-1980
			GB	2044303 A		15-10-1980
			IT	1141901 B		08-10-1986
			JP	S55116840 A		08-09-1980
			SU	952112 A3		15-08-1982
			US	4320784 A		23-03-1982

EP 0547003	A1	16-06-1993	EP	0547003 A1		16-06-1993
			JP	2534202 Y2		30-04-1997
			JP	H0551988 U		09-07-1993
