



(12) **EUROPEAN PATENT APPLICATION**

(43) Date of publication:
26.06.2013 Bulletin 2013/26

(51) Int Cl.:
A43D 3/02 (2006.01) **A43D 95/14** (2006.01)
B41F 16/02 (2006.01) **A43B 3/00** (2006.01)
B41M 5/035 (2006.01) **A43D 3/14** (2006.01)

(21) Application number: **12194360.9**

(22) Date of filing: **27.11.2012**

(84) Designated Contracting States:
AL AT BE BG CH CY CZ DE DK EE ES FI FR GB GR HR HU IE IS IT LI LT LU LV MC MK MT NL NO PL PT RO RS SE SI SK SM TR
Designated Extension States:
BA ME

(72) Inventors:
• **Cordoba, Luis Cesar**
35014 Fontaniva (PD) (IT)
• **Zaltron, Roberto**
36100 Vicenza (VI) (IT)

(30) Priority: **20.12.2011 IT VI20110081 U**

(74) Representative: **Bettello, Pietro**
Via Col d'Echele, 25
36100 Vicenza (IT)

(71) Applicant: **Siser S.r.l.**
36100 Vicenza (IT)

(54) **Press for applying heat transferable materials for personalising products**

(57) The present finding concerns a press for applying heat transferable materials for personalising products. It is of the type comprising a base plate (1), on which the object to be personalised is arranged and an upper

heated counter-plate, (2) both supported by means of a frame (3) and reciprocally compressed through an elastic member (4), manoeuvred by a handle (5). Such a press is characterised in that it allows the personalisation of two or more finished shoes simultaneously. (fig. 1).

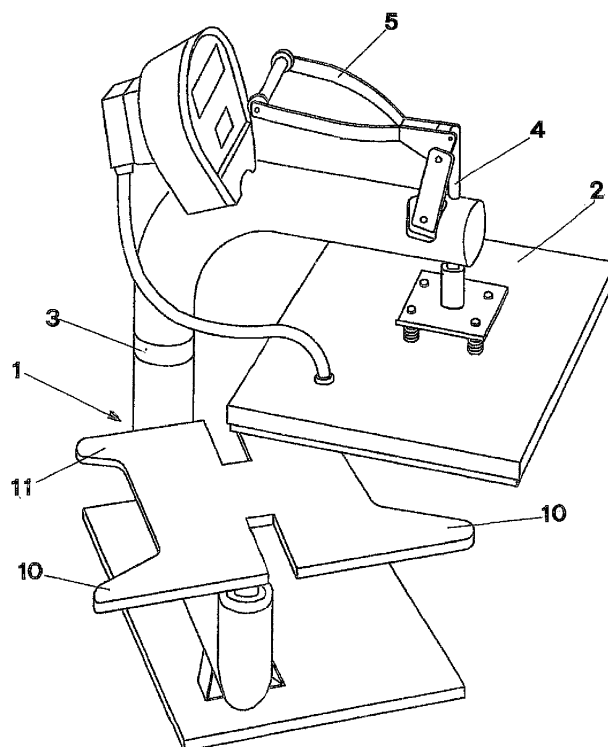

FIG.1

Description

[0001] The present finding refers to a press used for personalising products by applying heat transferable material, according to the general part of claim 1.

[0002] As it is known, it is very common to personalise clothing items, from T-shirts, to caps, to shoes, through the use of heat transferable films, which have drawings/writing to be transferred with a hot press onto the object to be personalised. Of the various machines used in the operation of "transferring" heat fix materials on fabrics or other supports, manual or automatic heat presses are widespread substantially made up of a fixed base plate, on which the garment and the heat transferable film are spread out, an upper heated plate and means for pressure clamping the two plates.

[0003] At the state of the art such types of presses (as an example see that described in patent document n. VI1996O000049, by the same applicant) are used in an optimal manner for transferring on flat garments, such as T-shirts, or also slightly curved ones, like the bill of caps. On the other hand, the personalisation of packed shoes is more difficult, since on said machines it is not possible to obtain a suitable arrangement of the shoe so as to apply the materials for the personalisation on the sides of the upper and on the heel.

[0004] Currently, in order to decorate shoes, the parts of the shoe (the upper spread out flat) with the heat transferable materials are firstly personalised, then the shoe itself is manufactured (sewing of the upper to the sole).

[0005] The main purpose of the present finding is to make a press for applying heat transferable materials, which makes it possible to personalise, in addition to clothing items, also finished shoes, in a rapid and simple manner and without jeopardising the decoration quality and the resistance of the adhesive over time.

[0006] A further purpose of the finding is that of making a press for personalising finished shoes of different types, sizes and materials (for recreational activities, made from canvas, sports shoes, made from rigid technical materials, made from leather, made from artificial leather) even simultaneously and on a wide surface of the upper and of the heel.

[0007] Such purposes are obtained by making a press, which is **characterised in that** it has the lower plate that is shaped so as to allow the positioning of two or more finished shoes arranged with the lateral side of the upper in the horizontal position, in opposition to the upper heated plate.

[0008] The finding shall become clearer with the description of a possible embodiment thereof, given purely as an example and not for limiting purposes, with the aid of the attached tables with figures, in which:

- figs. 1-2 (table I-II) represent the press according to the finding, which is equipped for the personalisation of the sides of the upper of the finished shoes, in the resting and usage conditions, respectively;

- figs. 3-4 (table III-IV) represent the press according to the finding equipped for the personalisation of the heel of the finished shoe, in the resting and usage conditions, respectively.

[0009] As visible in fig. 1, the press comprises a base plate 1, on which the object to be personalised is arranged and an upper heated counter-plate 2, both supported through a frame 3 and compressed through an elastic member 4, which is manoeuvred by the handle 5, all as *per se* known.

[0010] As visible in fig.2 the new characteristic of the finding consists of the fact that the base plate 1, instead of having a quadrilateral shape, like in machines in use, is shaped so as to allow at least two finished shoes to be held.

[0011] Specifically, the plate 1 has at least two opposite protuberances 10, on which the two shoes are fitted so as to have the lateral part "P" of the upper that is arranged horizontally (see fig.2).

[0012] Again specifically, the plate 1 can be equipped with other two protuberances 11, which are opposite to the previous ones and have sizes and shapes that are the same as or different from the previous ones, so as to be able to simultaneously "personalise", with the same heated plate 2, same or different finished shoes. Moreover, the plate 1 is advantageously applied onto the frame 3 in a removable manner, so as to be an "accessory" of the machine that is replaceable and interchangeable in relation to the different types of shoes to be personalised.

[0013] As visible in figs. 3 and 4, the machine described above is also equipped with a lower shaped support 20 and with a heated pressure blade 30, which replace the two previous plates 1 and 2 so as to complete the personalisation of the shoe at the heel "T", through the same heat process.

[0014] Analogously to the base plate 1, also the shaped surface 20 is applied onto the frame 3 in a removable manner, so as to be an "accessory" of the machine that is replaceable or interchangeable in relation to the different types of shoes to be personalised.

[0015] From what has been described above, the operative advantages of the finding are clear, allowing anybody from the craftsman to the final user to personalise finished shoes, even with very limited runs, with the application of very precise decorations and in a rapid and cost-effective manner.

[0016] The finding thus conceived can undergo variants and its details can be replaced by technically equivalent elements, all covered by the inventive concept defined by the following claims.

Claims

1. PRESS FOR APPLYING HEAT TRANSFERABLE MATERIALS FOR PERSONALISING PRODUCTS, of the type comprising a lower plate (1), on which

the object to be personalised is arranged and an upper heated counter-plate (2), both supported by means of a frame (3) and compressed through an elastic member (4), manoeuvred by a handle (5), said press being **characterised in that** it makes it possible to personalise two or more finished shoes simultaneously.

2. PRESS, according to claim 1, **characterised in that** the lower plate (1) has a shape such as to allow at least two finished shoes to be held, so as to carry out the personalisation of the upper of two or more shoes simultaneously.
3. PRESS, according to claim 2, **characterised in that** the base plate (1) has at least two opposite protuberances (10), on which the two shoes are fitted, so as to have the lateral part (P) of the upper arranged horizontally.
4. PRESS, according to claim 3, **characterised in that** the base plate (1) is equipped with a plurality of protuberances (10, 11), having dimensions and shapes that are the same as or different from one another, so as to be able to personalise, with the same heated plate (2), same or different finished shoes, simultaneously.
5. PRESS, according to one or more of the previous claims, **characterised in that** the base plate (1) is applied onto the frame (3) in a removable manner, so as to be an accessory of the machine, that is replaceable and interchangeable in relation to the different types of shoes to be personalised.
6. PRESS, according to claim 1, equipped with a lower shaped surface (20) and a heated pressure blade (30), for personalising the heel (T) of a finished shoe, **characterised in that** it foresees a shaped surface (20) applied onto the frame (3) in a removable manner, so as to be an accessory of the machine that is replaceable or interchangeable in relation to the different types of shoes to be personalised.
7. BASE PLATE (1), to be mounted on presses for applying heat transferable materials on finished shoes, **characterised in that** it is made according to the characteristics described in one or more of claims 1 to 5.

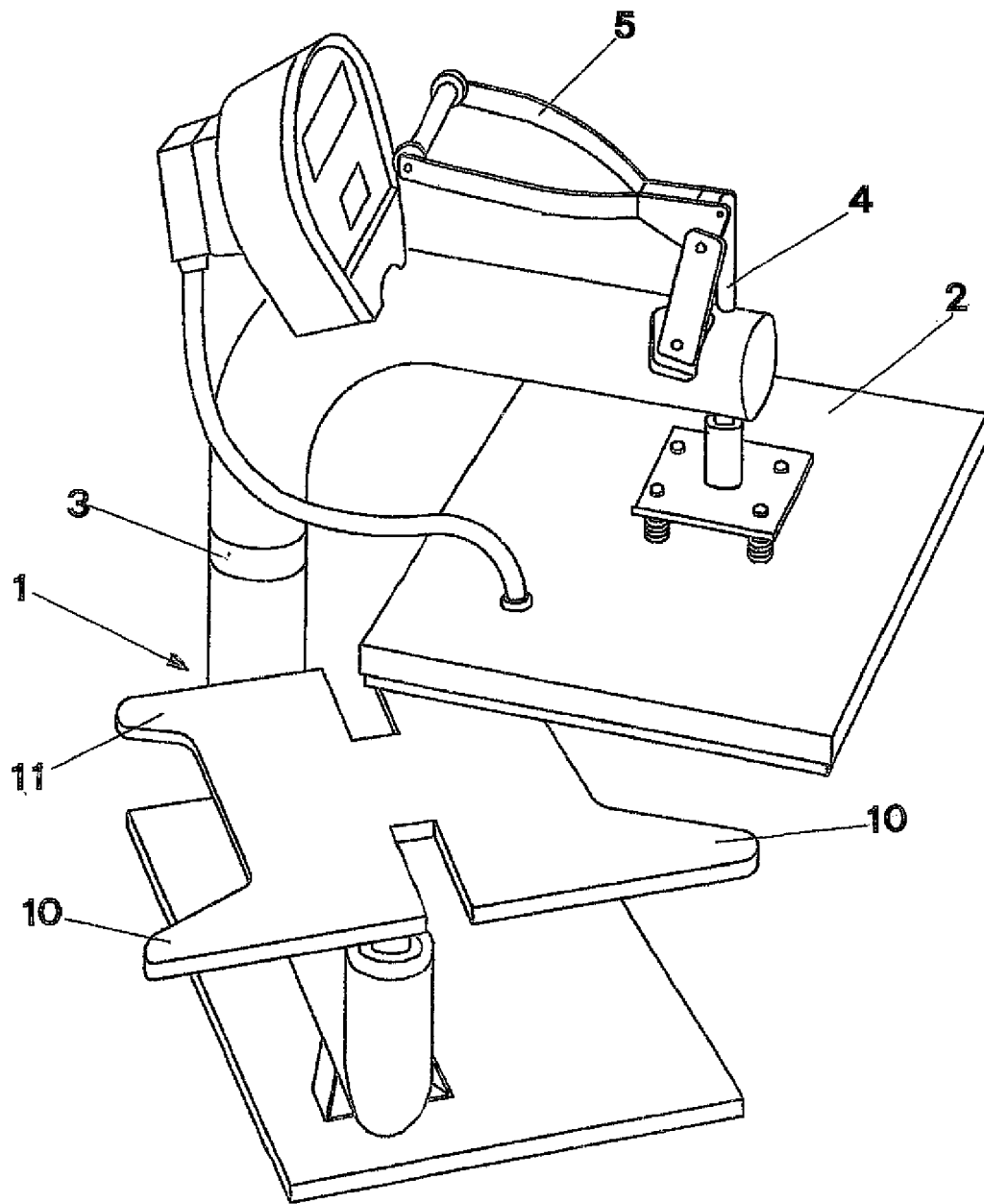

FIG.1

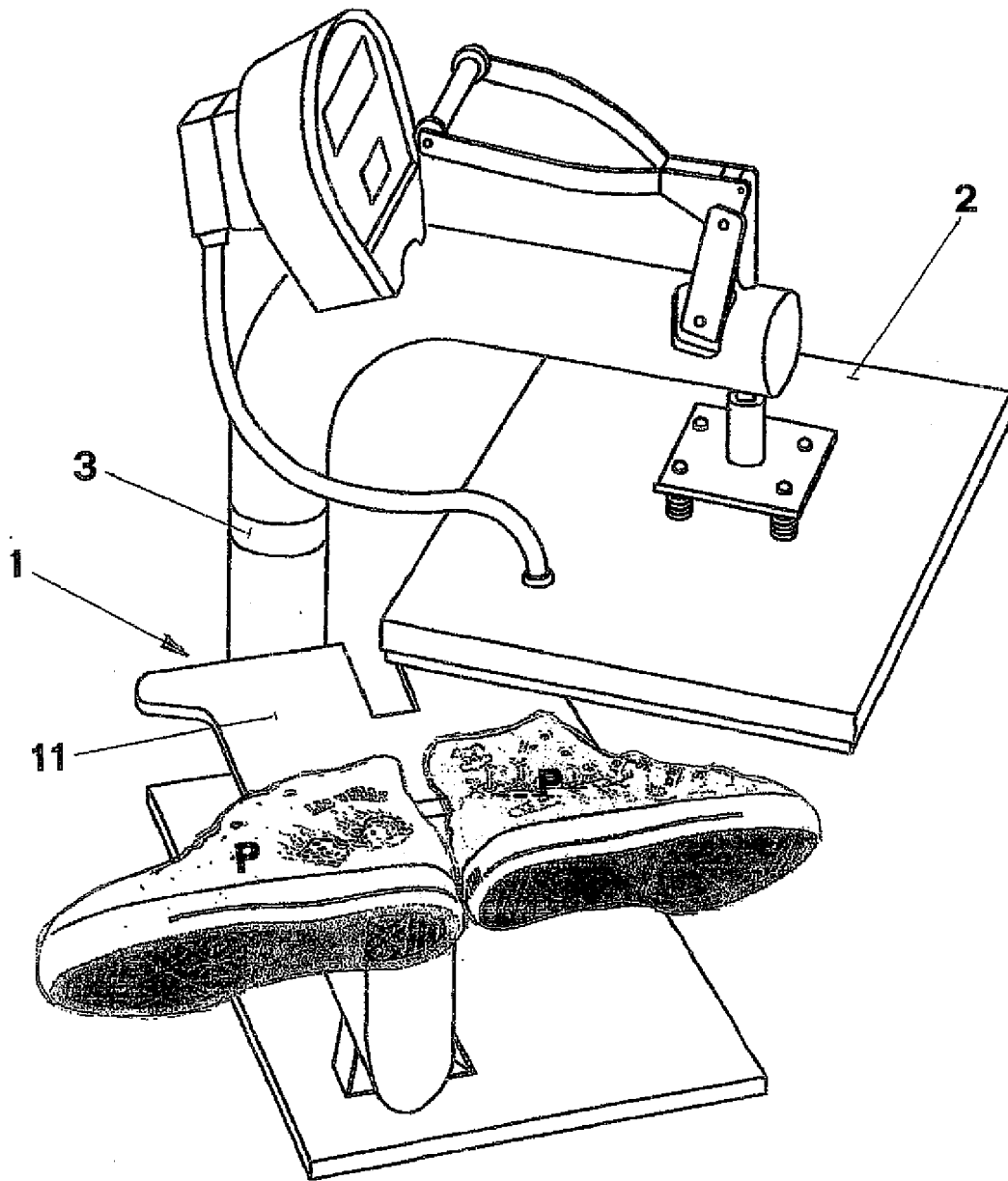

FIG. 2

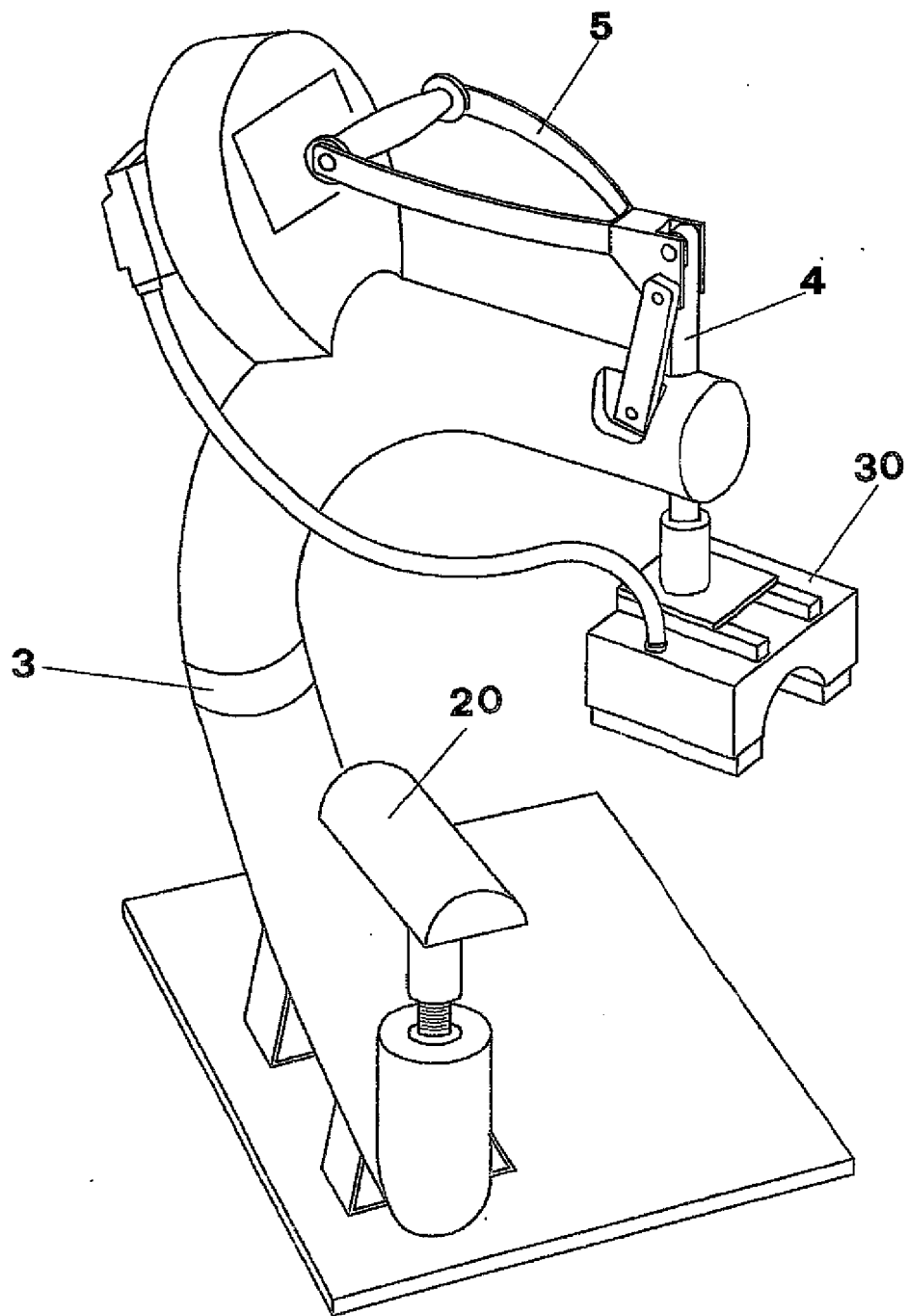

FIG. 3

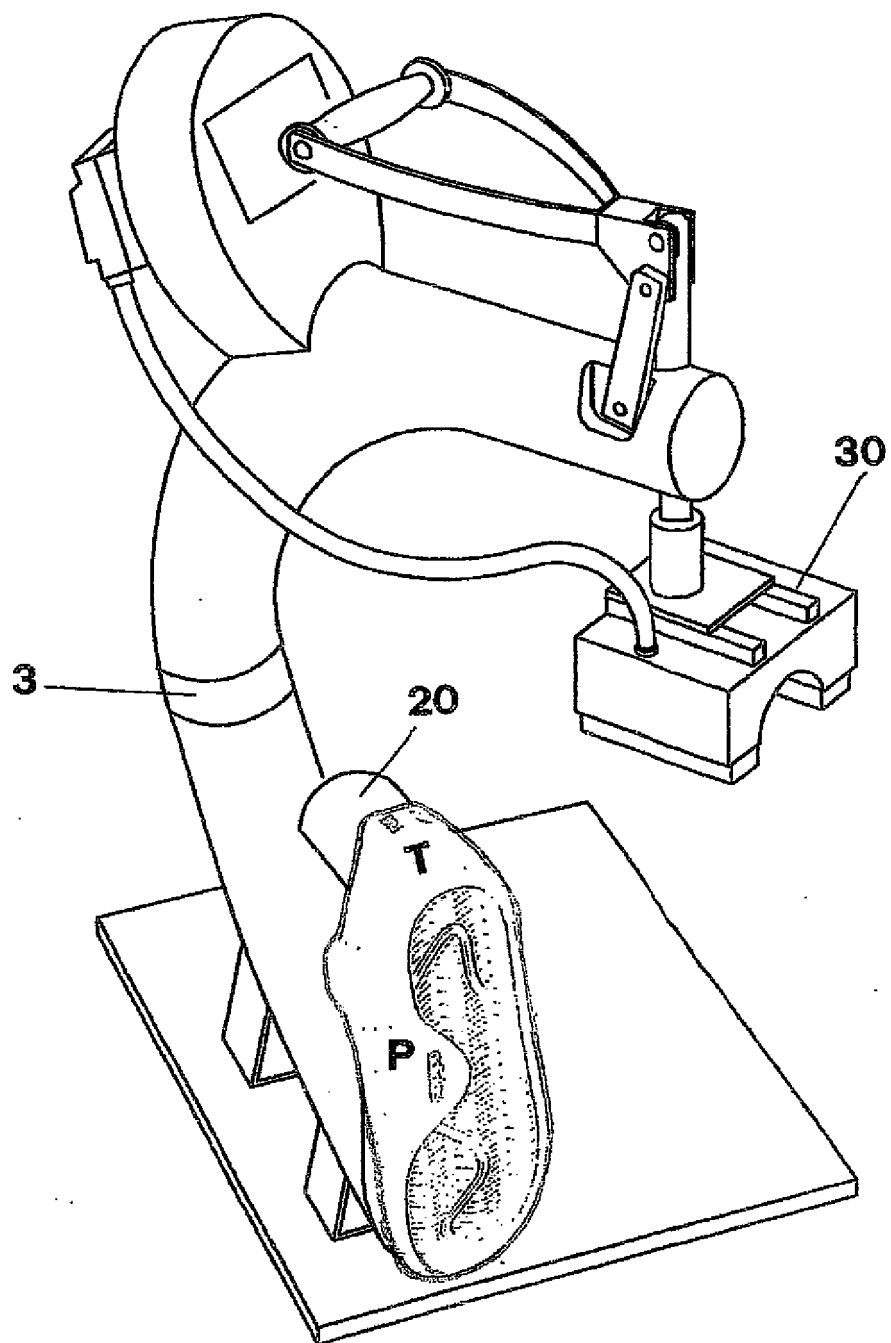

FIG. 4



EUROPEAN SEARCH REPORT

Application Number
EP 12 19 4360

DOCUMENTS CONSIDERED TO BE RELEVANT			
Category	Citation of document with indication, where appropriate, of relevant passages	Relevant to claim	CLASSIFICATION OF THE APPLICATION (IPC)
X,P	WO 2012/094371 A2 (NIKE INTERNATIONAL LTD; LEEDY GREGORY R [US]) 12 July 2012 (2012-07-12) * figures 1-12 *	1-5,7	INV. A43D3/02 A43D95/14 B41F16/02 A43B3/00 B41M5/035 A43D3/14
X	US 2010/326591 A1 (LANGVIN ELIZABETH [US] ET AL) 30 December 2010 (2010-12-30) * figures 48,44,34,32,28,26,22,19,16,14 *	1-7	
A	US 2007/231491 A1 (LAMBERT WILLIAM P [US] ET AL LAMBERT WILLIAM PAUL [US] ET AL) 4 October 2007 (2007-10-04) * paragraphs [0010], [0029], [0030]; figure 2 *	1	
A	DE 93 16 803 U1 (LIN FU TE [TW]) 20 January 1994 (1994-01-20) * page 2, lines 3-15; figures 1,2 *	1	
A	DE 302 764 C (PETER HELDMANN) 10 May 1917 (1917-05-10) * column 1, line 2; figures 1,2 *	1	TECHNICAL FIELDS SEARCHED (IPC)
A	US 224 030 A (ARTHUR W. MUSSELLS) 3 February 1880 (1880-02-03) * page 1, lines 6,21-26 *	1,6	A43D B41F A43B B41M
A	US 2005/155500 A1 (LATOS GEORGE P [US] ET AL) 21 July 2005 (2005-07-21) * paragraphs [0023], [0024], [0061]; figures 1,2,6 *	1	
A	US 4 606 268 A (JAFFA DAVID [US]) 19 August 1986 (1986-08-19) * figures 1-15 *	1	
The present search report has been drawn up for all claims			
Place of search The Hague		Date of completion of the search 7 March 2013	Examiner Duquénoy, Alain
CATEGORY OF CITED DOCUMENTS T : theory or principle underlying the invention E : earlier patent document, but published on, or after the filing date D : document cited in the application L : document cited for other reasons X : particularly relevant if taken alone Y : particularly relevant if combined with another document of the same category A : technological background O : non-written disclosure P : intermediate document & : member of the same patent family, corresponding document			

 1
EPO FORM 1503 03.82 (P04C01)

**ANNEX TO THE EUROPEAN SEARCH REPORT
ON EUROPEAN PATENT APPLICATION NO.**

EP 12 19 4360

This annex lists the patent family members relating to the patent documents cited in the above-mentioned European search report.
The members are as contained in the European Patent Office EDP file on
The European Patent Office is in no way liable for these particulars which are merely given for the purpose of information.

07-03-2013

Patent document cited in search report	Publication date	Patent family member(s)	Publication date
WO 2012094371 A2	12-07-2012	US 2012175813 A1 WO 2012094371 A2	12-07-2012 12-07-2012
US 2010326591 A1	30-12-2010	CN 102497997 A EP 2445729 A2 JP 2012531261 A KR 20120049228 A TW 201105521 A US 2010326591 A1 US 2011192537 A1 WO 2011005471 A2	13-06-2012 02-05-2012 10-12-2012 16-05-2012 16-02-2011 30-12-2010 11-08-2011 13-01-2011
US 2007231491 A1	04-10-2007	US 2007231491 A1 US 2012186103 A1	04-10-2007 26-07-2012
DE 9316803 U1	20-01-1994	NONE	
DE 302764 C	10-05-1917	NONE	
US 224030 A	03-02-1880	NONE	
US 2005155500 A1	21-07-2005	US 2005155500 A1 WO 2005072501 A2	21-07-2005 11-08-2005
US 4606268 A	19-08-1986	NONE	