



(12) **EUROPEAN PATENT APPLICATION**

(88) Date of publication A3:  
**23.10.2013 Bulletin 2013/43**

(51) Int Cl.:  
**F24B 1/20 (2006.01)**

(43) Date of publication A2:  
**10.07.2013 Bulletin 2013/28**

(21) Application number: **13150689.1**

(22) Date of filing: **09.01.2013**

(84) Designated Contracting States:  
**AL AT BE BG CH CY CZ DE DK EE ES FI FR GB GR HR HU IE IS IT LI LT LU LV MC MK MT NL NO PL PT RO RS SE SI SK SM TR**  
Designated Extension States:  
**BA ME**

(72) Inventor: **Ellis, Peter Simon**  
**Wimborne, Dorset BH21 3PU (GB)**

(74) Representative: **Wilson, Alan Stuart**  
**Barker Brettell LLP**  
**Medina Chambers Town Quay**  
**Southampton, Hampshire SO14 2AQ (GB)**

(30) Priority: **09.01.2012 GB 201200251**

(71) Applicant: **Ellis Design Associates Limited**  
**Corfe Mullen**  
**Wimborne**  
**Dorset BH21 3PU (GB)**

(54) **A portable collapsible stove**

(57) A portable collapsible stove is formed from sheet laminate material. The stove comprising a plurality of side walls (15) formed from the sheet laminate material, the side walls being joined together such that the side walls together define a tube one end of which comprises a base which rests in use on the ground and an opposed end of which comprises a mouth to at least partially receive, and support, in use a container or the like. The stove further comprising a fuel support platform (41) also formed from the sheet laminate material, the fuel support platform being located inside the tube at a position spaced from the base of the tube, with the outer periphery of the fuel support platform (41) being fastened to the side walls. At least one air inlet aperture (53) is provided in a side wall below the fuel support platform (41), and at least one exhaust aperture (57) is provided in a side wall above the fuel support platform. The stove can be collapsed from an operational condition in which the side walls define the tube and the fuel support platform extends across the tube, to a collapsed, substantially flat condition in which the side walls and fuel support platform are substantially parallel.

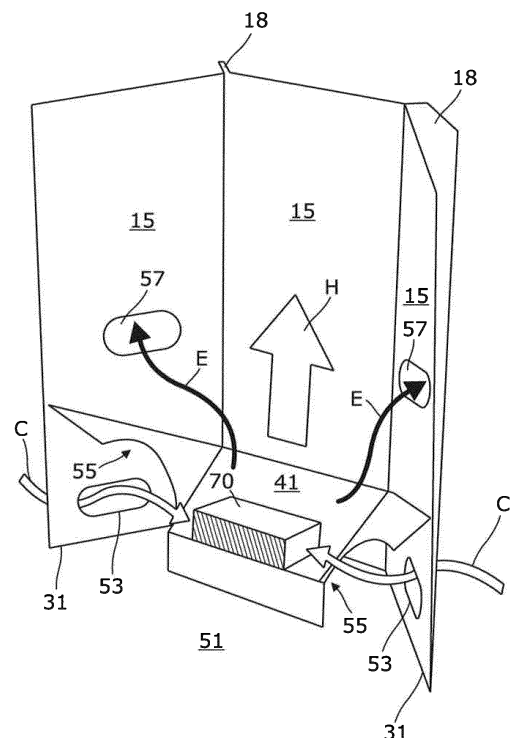

Fig. 5



## EUROPEAN SEARCH REPORT

Application Number  
EP 13 15 0689

DOCUMENTS CONSIDERED TO BE RELEVANT			
Category	Citation of document with indication, where appropriate, of relevant passages	Relevant to claim	CLASSIFICATION OF THE APPLICATION (IPC)
A	US 4 455 992 A (HSIAO CHIN-WEN [TW]) 26 June 1984 (1984-06-26) * column 1 - column 2; figures 1-4 *	1-14	INV. F24B1/20
Y	US 1 207 553 A (HILL NORFLEET [US]) 5 December 1916 (1916-12-05) * page 1, line 4 - page 3, line 65; figures 1-7 *	1-3,5-14	
Y	EP 1 957 870 A1 (ELLIS DESIGN ASSOCIATES LTD [GB]) 20 August 2008 (2008-08-20) * page 4 - page 5; figures 1-3 *	1-3,5-14	
Y	US 5 179 932 A (DECARLO DONALD J [US]) 19 January 1993 (1993-01-19) * column 4, lines 41-44 *	1-3,5-14	
Y	US 3 448 735 A (PALMER CHARLES E) 10 June 1969 (1969-06-10) * column 1, line 22 - column 2, line 54; figure 1 *	1-3,5-14	
Y	US 1 298 762 A (MILLIGAN JAMES S [US]) 1 April 1919 (1919-04-01) * page 1, lines 23-93; figure 1 *	1-3,5-14	TECHNICAL FIELDS SEARCHED (IPC) F24B
Y	US 2009/314285 A1 (MARSH BRIAN E [US]) 24 December 2009 (2009-12-24) * paragraphs [0033], [0044]; figure 1 *	2,3	
Y	US 2002/148457 A1 (RICE JARED [US]) 17 October 2002 (2002-10-17) * paragraph [0023] - paragraph [0040]; figures 1-8 *	5-7,11, 12	
X	US 2008/063875 A1 (ROBINSON JOHN W [US] ET AL) 13 March 2008 (2008-03-13) * paragraphs [0099], [0120] *	15	
1 <del>The present search report has been drawn up for all claims</del>			
Place of search The Hague		Date of completion of the search 24 May 2013	Examiner Makúch, Milan
CATEGORY OF CITED DOCUMENTS X : particularly relevant if taken alone Y : particularly relevant if combined with another document of the same category A : technological background O : non-written disclosure P : intermediate document		T : theory or principle underlying the invention E : earlier patent document, but published on, or after the filing date D : document cited in the application L : document cited for other reasons & : member of the same patent family, corresponding document	

EPO FORM 1503 03/82 (P04C01)



Application Number

EP 13 15 0689

**CLAIMS INCURRING FEES**

The present European patent application comprised at the time of filing claims for which payment was due.

- ☐ Only part of the claims have been paid within the prescribed time limit. The present European search report has been drawn up for those claims for which no payment was due and for those claims for which claims fees have been paid, namely claim(s):
- ☐ No claims fees have been paid within the prescribed time limit. The present European search report has been drawn up for those claims for which no payment was due.

**LACK OF UNITY OF INVENTION**

The Search Division considers that the present European patent application does not comply with the requirements of unity of invention and relates to several inventions or groups of inventions, namely:

see sheet B

- ☐ All further search fees have been paid within the fixed time limit. The present European search report has been drawn up for all claims.
- ☐ As all searchable claims could be searched without effort justifying an additional fee, the Search Division did not invite payment of any additional fee.
- ☐ Only part of the further search fees have been paid within the fixed time limit. The present European search report has been drawn up for those parts of the European patent application which relate to the inventions in respect of which search fees have been paid, namely claims:
- ☒ None of the further search fees have been paid within the fixed time limit. The present European search report has been drawn up for those parts of the European patent application which relate to the invention first mentioned in the claims, namely claims:
- 1-12
- ☐ The present supplementary European search report has been drawn up for those parts of the European patent application which relate to the invention first mentioned in the claims (Rule 164 (1) EPC).



**LACK OF UNITY OF INVENTION  
SHEET B**

Application Number

EP 13 15 0689

The Search Division considers that the present European patent application does not comply with the requirements of unity of invention and relates to several inventions or groups of inventions, namely:

1. claims: 1-12

A portable collapsible stove formed from sheet laminate material comprising at least one planar sheet of a metal material, the stove further comprises an aperture shield.

---

2. claim: 13

A portable collapsible stove formed from sheet laminate material comprising two planar sheets of a metal foil material, the stove further comprises the side walls and a fuel support platform.

---

3. claim: 14

A portable collapsible solid fuel stove formed from sheet laminate material comprising at least one planar sheet of a metal foil material, the stove further comprises the side walls and a fuel support platform, wherein the side margins of adjacent side walls are stitched together.

---

4. claim: 15

A sheet of laminate material.

---

**ANNEX TO THE EUROPEAN SEARCH REPORT  
ON EUROPEAN PATENT APPLICATION NO.**

EP 13 15 0689

This annex lists the patent family members relating to the patent documents cited in the above-mentioned European search report.  
The members are as contained in the European Patent Office EDP file on  
The European Patent Office is in no way liable for these particulars which are merely given for the purpose of information.

24-05-2013

Patent document cited in search report	Publication date	Patent family member(s)	Publication date
US 4455992	A	26-06-1984	NONE
US 1207553	A	05-12-1916	NONE
EP 1957870	A1	20-08-2008	EP 1957870 A1 20-08-2008
			US 2009301470 A1 10-12-2009
			WO 2007057628 A1 24-05-2007
US 5179932	A	19-01-1993	NONE
US 3448735	A	10-06-1969	NONE
US 1298762	A	01-04-1919	NONE
US 2009314285	A1	24-12-2009	NONE
US 2002148457	A1	17-10-2002	NONE
US 2008063875	A1	13-03-2008	NONE