



(11)

**EP 2 615 365 A3**

(12)

**EUROPEAN PATENT APPLICATION**

(88) Date of publication A3:  
**02.10.2013 Bulletin 2013/40**

(43) Date of publication A2:  
**17.07.2013 Bulletin 2013/29**

(21) Application number: **12154378.9**

(22) Date of filing: **08.02.2012**

(51) Int Cl.:  
**F21S 2/00** <sup>(2006.01)</sup> **F21S 8/06** <sup>(2006.01)</sup>  
**F21V 21/116** <sup>(2006.01)</sup> **F21Y 101/02** <sup>(2006.01)</sup>  
**F21Y 103/02** <sup>(2006.01)</sup>

(84) Designated Contracting States:  
**AL AT BE BG CH CY CZ DE DK EE ES FI FR GB  
GR HR HU IE IS IT LI LT LU LV MC MK MT NL NO  
PL PT RO RS SE SI SK SM TR**  
Designated Extension States:  
**BA ME**

(30) Priority: **06.04.2011 IT BS20110041**

(71) Applicant: **Flos S.P.A.**  
**25073 Bovezzo (Brescia) (IT)**

(72) Inventor: **Gandini, Piero**  
**I-25073 Bovezzo, BRESCIA (IT)**

(74) Representative: **Pulieri, Gianluca Antonio**  
**Jacobacci & Partners S.p.A.**  
**Piazza della Vittoria, 11**  
**25122 Brescia (IT)**

(54) **Modular lighting device**

(57) A lighting device comprises a stem (2) and a plurality of rings (10), which can be attached to the stem (2). The attachment means are releasable and comprise first electrical contacts associated with the stem (2) and second electrical contacts (60) associated with the ring (10), a centring pin (40) associated with the stem (2) and a centring hole associated with the ring (10), and an attachment screw associated with the stem (2) and an attachment pin (70) rotatable to engage the screw, pulling it to block the ring (10) to the stem (2).

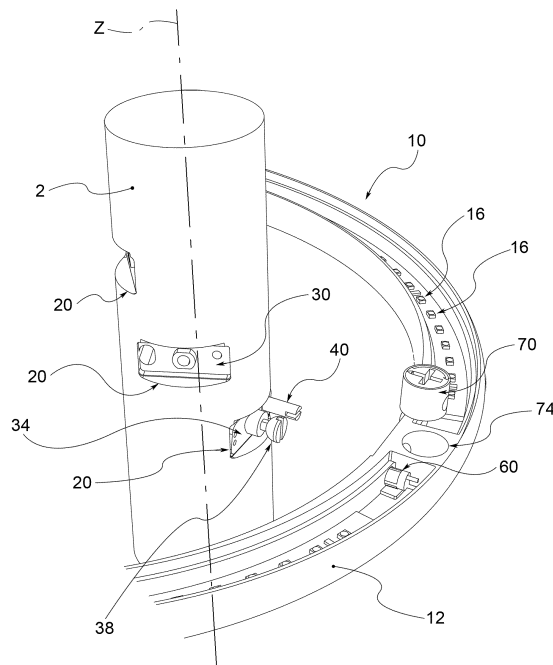

*Fig. 2*

**EP 2 615 365 A3**

**PARTIAL EUROPEAN SEARCH REPORT**

Application Number

under Rule 62a and/or 63 of the European Patent Convention.  
This report shall be considered, for the purposes of  
subsequent proceedings, as the European search report

EP 12 15 4378

DOCUMENTS CONSIDERED TO BE RELEVANT			
Category	Citation of document with indication, where appropriate, of relevant passages	Relevant to claim	CLASSIFICATION OF THE APPLICATION (IPC)
X	GB 618 128 A (BRITISH THOMSON HOUSTON CO LTD) 16 February 1949 (1949-02-16)	1,3-5,8	INV. F21S2/00 F21S8/06 F21V21/116  ADD. F21Y101/02 F21Y103/02
Y	* the whole document *	6,7	
X	US 2 943 238 A (REAVES EDWARD G) 28 June 1960 (1960-06-28) * column 2, line 20 - column 3, line 19; figures 1, 2, 11 *	1,3-5,8	
Y	US 2008/285263 A1 (GARRETT CLAYTON M [US]) 20 November 2008 (2008-11-20) * paragraphs [0051] - [0055]; figures 1-3 *	1,3-5,8	
Y	DE 20 2006 018383 U1 (LITE LICHT GMBH [DE]) 10 January 2008 (2008-01-10) * the whole document *	1,3-5,8	
Y	US 2008/055894 A1 (DENG J H) 6 March 2008 (2008-03-06) * paragraph [0043]; figure 5 *	6,7	
			TECHNICAL FIELDS SEARCHED (IPC)
			F21V F21S
<b>INCOMPLETE SEARCH</b>			
<p>The Search Division considers that the present application, or one or more of its claims, does/do not comply with the EPC so that only a partial search (R.62a, 63) has been carried out.</p> <p>Claims searched completely :</p> <p>Claims searched incompletely :</p> <p>Claims not searched :</p> <p>Reason for the limitation of the search: see sheet C</p>			
Place of search Munich		Date of completion of the search 27 August 2013	Examiner von der Hardt, M
CATEGORY OF CITED DOCUMENTS		<p>T : theory or principle underlying the invention E : earlier patent document, but published on, or after the filing date D : document cited in the application L : document cited for other reasons &amp; : member of the same patent family, corresponding document</p>	
<p>X : particularly relevant if taken alone Y : particularly relevant if combined with another document of the same category A : technological background O : non-written disclosure P : intermediate document</p>			

 2  
EPO FORM 1503 03.82 (P04E07)



**INCOMPLETE SEARCH  
SHEET C**

Application Number

EP 12 15 4378

Claim(s) completely searchable:  
1-8

Claim(s) not searched:  
9-14

Reason for the limitation of the search:

The search has been restricted to the subject-matter indicated by the applicant in his letter of 9 July 2013 filed in reply to the invitation pursuant to Rule 62a(1) EPC.

**ANNEX TO THE EUROPEAN SEARCH REPORT  
ON EUROPEAN PATENT APPLICATION NO.**

EP 12 15 4378

This annex lists the patent family members relating to the patent documents cited in the above-mentioned European search report.  
The members are as contained in the European Patent Office EDP file on  
The European Patent Office is in no way liable for these particulars which are merely given for the purpose of information.

27-08-2013

Patent document cited in search report		Publication date	Patent family member(s)	Publication date
GB 618128	A	16-02-1949	NONE	
US 2943238	A	28-06-1960	NONE	
US 2008285263	A1	20-11-2008	NONE	
DE 202006018383	U1	10-01-2008	DE 202006018383 U1	10-01-2008
			EP 1930650 A1	11-06-2008
US 2008055894	A1	06-03-2008	NONE	

EPO FORM P0459

For more details about this annex : see Official Journal of the European Patent Office, No. 12/82