



(12) **EUROPEAN PATENT APPLICATION**

(88) Date of publication A3:
25.12.2013 Bulletin 2013/52

(51) Int Cl.:
E06B 9/266 (2006.01)

(43) Date of publication A2:
23.10.2013 Bulletin 2013/43

(21) Application number: **12195106.5**

(22) Date of filing: **30.11.2012**

(84) Designated Contracting States:
AL AT BE BG CH CY CZ DE DK EE ES FI FR GB GR HR HU IE IS IT LI LT LU LV MC MK MT NL NO PL PT RO RS SE SI SK SM TR
Designated Extension States:
BA ME

(71) Applicant: **DALLAN S.P.A.**
31033 Castelfranco Veneto (IT)

(72) Inventor: **Dallan, Sergio**
31033 Castelfranco Veneto, Treviso (IT)

(74) Representative: **Mitola, Marco**
Jacobacci & Partners S.p.A.
Via Berchet 9
35131 Padova (IT)

(30) Priority: **02.03.2012 IT PD20120061**

(54) **Stacking unit of slats on support half-ladders for the production of venetian blinds and combined application method of hooks and half-ladders to a slat**

(57) The invention relates to a stacking unit of slats on support half-ladders for the production of venetian blinds, comprising at least one group 2 for assembling on a slat a hook and a half-ladder with eyelets O. Such group is positioned laterally with respect to a longitudinal sliding axis X of the slats and comprises: - a matrix 11, 12 having a cavity 13 for a portion of rim and two apertures 14 and 15 of access to the cavity, between which a through aperture 16 is made; - a device 31 for applying hooks in correspondence with the first aperture 14; - a

device 40 for guiding a half-ladder in correspondence with the through aperture 16, leaving an eyelet in correspondence with the through aperture 16; - a device 32 for closing the hook (G) in correspondence with the second aperture 15 of the matrix. The stacking unit comprises means 4, 5 for generating a relative movement between the slat and the matrix so that a hook anchored to the rim shifts along the cavity from said first aperture to the second 15 crossing the through aperture 16 engaging the eyelet. The hook is closed in correspondence with the second aperture 15.

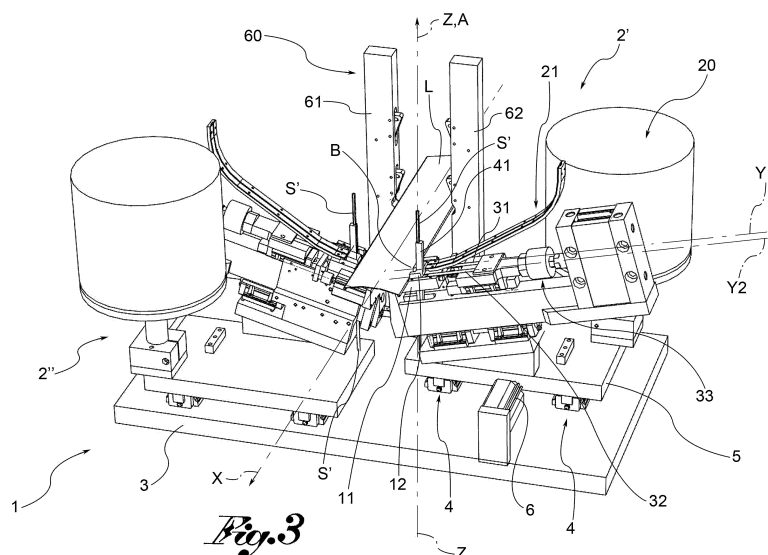

Fig. 3



EUROPEAN SEARCH REPORT

Application Number
EP 12 19 5106

DOCUMENTS CONSIDERED TO BE RELEVANT			
Category	Citation of document with indication, where appropriate, of relevant passages	Relevant to claim	CLASSIFICATION OF THE APPLICATION (IPC)
A	US 4 606 099 A (SCHLUEP RENE [CH] ET AL) 19 August 1986 (1986-08-19) * the whole document *	1-20	INV. E06B9/266
A	EP 2 253 794 A2 (ZEBR S R O [CZ]) 24 November 2010 (2010-11-24) * abstract; figure 1 *	1-20	
			TECHNICAL FIELDS SEARCHED (IPC)
			E06B
The present search report has been drawn up for all claims			
Place of search Munich		Date of completion of the search 13 November 2013	Examiner Kofoed, Peter
<p>CATEGORY OF CITED DOCUMENTS</p> <p>X : particularly relevant if taken alone Y : particularly relevant if combined with another document of the same category A : technological background O : non-written disclosure P : intermediate document</p> <p>T : theory or principle underlying the invention E : earlier patent document, but published on, or after the filing date D : document cited in the application L : document cited for other reasons & : member of the same patent family, corresponding document</p>			

1
EPO FORM 1503 03.82 (P04C01)

**ANNEX TO THE EUROPEAN SEARCH REPORT
ON EUROPEAN PATENT APPLICATION NO.**

EP 12 19 5106

This annex lists the patent family members relating to the patent documents cited in the above-mentioned European search report.
The members are as contained in the European Patent Office EDP file on
The European Patent Office is in no way liable for these particulars which are merely given for the purpose of information.

13-11-2013

Patent document cited in search report	Publication date	Patent family member(s)	Publication date
US 4606099 A	19-08-1986	AT 395044 B	25-08-1992
		CH 658881 A5	15-12-1986
		DE 3406873 A1	27-09-1984
		FR 2543211 A1	28-09-1984
		IT 1173462 B	24-06-1987
		JP S59179992 A	12-10-1984
		US 4606099 A	19-08-1986

EP 2253794 A2	24-11-2010	NONE	
