



(12) **EUROPEAN PATENT APPLICATION**

(88) Date of publication A3:
20.05.2015 Bulletin 2015/21

(51) Int Cl.:
F16H 9/18 (2006.01) **F02B 61/02** (2006.01)
F02B 75/06 (2006.01)

(43) Date of publication A2:
18.12.2013 Bulletin 2013/51

(21) Application number: **13180600.2**

(22) Date of filing: **29.08.2008**

(84) Designated Contracting States:
AT BE BG CH CY CZ DE DK EE ES FI FR GB GR HR HU IE IS IT LI LT LU LV MC MT NL NO PL PT RO SE SI SK TR
Designated Extension States:
AL BA MK RS

(30) Priority: **31.08.2007 JP 2007227088**
03.12.2007 JP 2007312912
21.04.2008 JP 2008109854

(62) Document number(s) of the earlier application(s) in accordance with Art. 76 EPC:
08252876.1 / 2 031 210

(71) Applicant: **Yamaha Hatsudoki Kabushiki Kaisha Iwata-shi, Shizuoka-ken 438 (JP)**

(72) Inventor: **Nakayama, Yoshiharu Shizouka-ken, 438-8501 (JP)**

(74) Representative: **Moreland, David Marks & Clerk LLP Aurora 120 Bothwell Street Glasgow G2 7JS (GB)**

(54) **Engine and straddle type vehicle**

(57) An engine of the invention includes a crankshaft including a crank web; a clutch shaft disposed behind the crankshaft and provided with a clutch; a balancer shaft disposed in front of the crankshaft and provided with a balancer weight; a crankcase for accommodating the crankshaft, the balancer shaft and the clutch shaft; a cylinder section attached to the crankcase; and a starter motor disposed above the cylinder section and capable of driving the crankshaft, wherein the balancer shaft is disposed between a first horizontal surface intersecting an axial center of the crankshaft when the engine is mounted on a vehicle and a second horizontal surface intersecting a lower end of the crank web when the engine is mounted on the vehicle, the balancer weight is disposed below the first horizontal surface, and the starter motor is disposed forward of a vertical surface intersecting the axial center of the crankshaft when the engine is mounted on the vehicle.

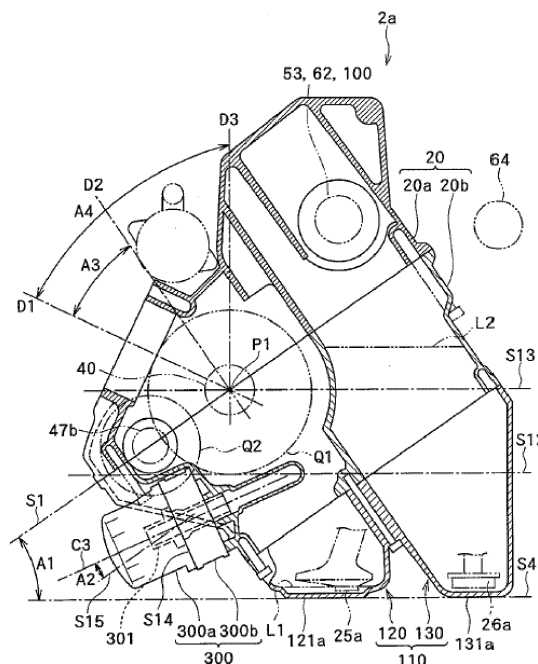

FIG. 15



EUROPEAN SEARCH REPORT

Application Number
EP 13 18 0600

5

10

15

20

25

30

35

40

45

50

55

DOCUMENTS CONSIDERED TO BE RELEVANT			
Category	Citation of document with indication, where appropriate, of relevant passages	Relevant to claim	CLASSIFICATION OF THE APPLICATION (IPC)
X	JP 2007 085278 A (SUZUKI MOTOR CO) 5 April 2007 (2007-04-05) * abstract * * figures *	1,3-6, 8-11	INV. F16H9/18 F02B61/02 F02B75/06
X	US 2006/005799 A1 (SUZUKI MAMORU [JP] ET AL) 12 January 2006 (2006-01-12) * abstract * * figures *	1-3,9-11	
X	JP 2005 248966 A (SUZUKI MOTOR CO) 15 September 2005 (2005-09-15) * abstract * * figures *	1,4,10, 11	
X	EP 1 433 931 A2 (HONDA MOTOR CO LTD [JP]) 30 June 2004 (2004-06-30) * abstract * * figures 1, 2, 7 *	1,3-6, 9-11	
X	US 2005/119076 A1 (CHONAN MITSUGI [JP] ET AL) 2 June 2005 (2005-06-02) * abstract * * figures *	1,3,10, 11	TECHNICAL FIELDS SEARCHED (IPC)
X	JP 2 163539 A (YAMAHA MOTOR CO LTD) 22 June 1990 (1990-06-22) * abstract * * figures *	1,4,10, 11	F16H B62M B62K F02B
X	JP 5 296040 A (HONDA MOTOR CO LTD) 9 November 1993 (1993-11-09) * abstract * * figures 1, 2, 6 *	1,2,10, 11	
A	EP 0 369 618 A1 (YAMAHA MOTOR CO LTD [JP]) 23 May 1990 (1990-05-23) * figures *	7	
The present search report has been drawn up for all claims			
Place of search The Hague		Date of completion of the search 14 April 2015	Examiner Matray, J
CATEGORY OF CITED DOCUMENTS X : particularly relevant if taken alone Y : particularly relevant if combined with another document of the same category A : technological background O : non-written disclosure P : intermediate document T : theory or principle underlying the invention E : earlier patent document, but published on, or after the filing date D : document cited in the application L : document cited for other reasons & : member of the same patent family, corresponding document			

EPO FORM 1503 (03.02 (P04C01))

**ANNEX TO THE EUROPEAN SEARCH REPORT
ON EUROPEAN PATENT APPLICATION NO.**

EP 13 18 0600

5

This annex lists the patent family members relating to the patent documents cited in the above-mentioned European search report.
The members are as contained in the European Patent Office EDP file on
The European Patent Office is in no way liable for these particulars which are merely given for the purpose of information.

14-04-2015

10

15

20

25

30

35

40

45

50

55

Patent document cited in search report	Publication date	Patent family member(s)	Publication date
JP 2007085278 A	05-04-2007	JP 4622776 B2 JP 2007085278 A	02-02-2011 05-04-2007
US 2006005799 A1	12-01-2006	JP 4451234 B2 JP 2006022725 A US 2006005799 A1	14-04-2010 26-01-2006 12-01-2006
JP 2005248966 A	15-09-2005	JP 4029890 B2 JP 2005248966 A	09-01-2008 15-09-2005
EP 1433931 A2	30-06-2004	BR 0306061 A CA 2450317 A1 CN 1510253 A DE 60310672 T2 EP 1433931 A2 JP 4003875 B2 JP 2004204771 A MX PA03011362 A US 2004173176 A1	17-05-2005 25-06-2004 07-07-2004 03-05-2007 30-06-2004 07-11-2007 22-07-2004 19-04-2005 09-09-2004
US 2005119076 A1	02-06-2005	CA 2461867 A1 JP 4322030 B2 JP 2004284557 A US 2005119076 A1	25-09-2004 26-08-2009 14-10-2004 02-06-2005
JP 2163539 A	22-06-1990	-----	-----
JP 5296040 A	09-11-1993	-----	-----
EP 0369618 A1	23-05-1990	DE 68918668 D1 DE 68918668 T2 EP 0369618 A1 US 5078105 A	10-11-1994 04-05-1995 23-05-1990 07-01-1992

EPO FORM P0459

For more details about this annex : see Official Journal of the European Patent Office, No. 12/82