

(19)



(11)

**EP 2 710 910 A1**

(12)

**EUROPEAN PATENT APPLICATION**

(43) Date of publication:

**26.03.2014 Bulletin 2014/13**

(51) Int Cl.:

**A43B 3/24** (2006.01)

**A43B 23/06** (2006.01)

**A43B 3/02** (2006.01)

**A43B 1/06** (2006.01)

(21) Application number: **12193913.6**

(22) Date of filing: **22.11.2012**

(84) Designated Contracting States:

**AL AT BE BG CH CY CZ DE DK EE ES FI FR GB  
GR HR HU IE IS IT LI LT LU LV MC MK MT NL NO  
PL PT RO RS SE SI SK SM TR**

Designated Extension States:

**BA ME**

(72) Inventor: **Webb, David**

**Sutton SM3 9NJ (GB)**

(74) Representative: **Games, Robert Harland et al**

**Albright Patents LLP**

**Eagle Tower**

**Montpellier Drive**

**Cheltenham GL50 1TA (GB)**

(30) Priority: **19.09.2012 GB 201216709**

(71) Applicant: **Webb, David**

**Sutton SM3 9NJ (GB)**

(54) **Boot**

(57) A boot comprises a sole (12), an upper (14) including a foot portion (15) and a leg portion (16). The leg portion (16) is moveable in use between a first position

around a wearer's leg and a second position, in which the leg portion (16) is reversed and passed over the foot portion (15) and sole (12) to enclose the foot portion (15) and sole (12).

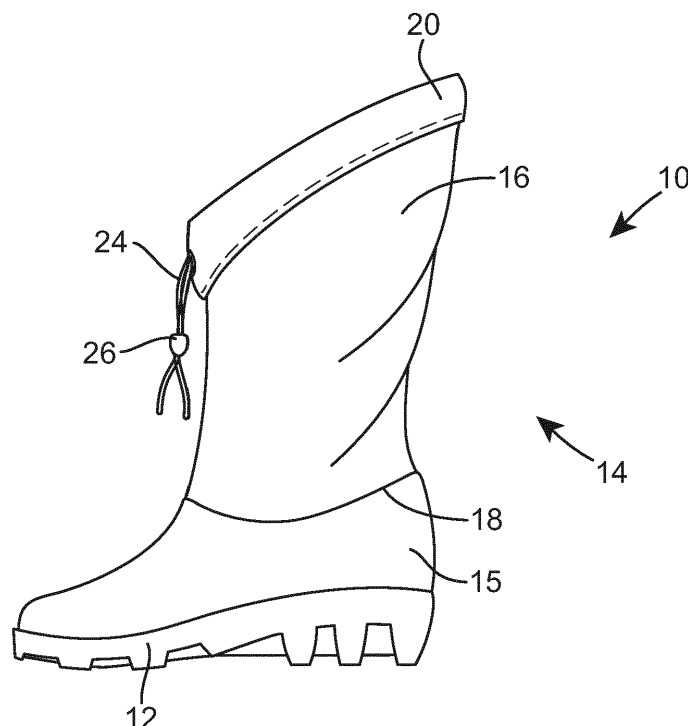

**Fig. 1**

**EP 2 710 910 A1**

## Description

**[0001]** The present invention relates to a boot, and particularly but not exclusively to a boot with a leg portion, such as a Wellington boot.

## BACKGROUND TO THE INVENTION

**[0002]** The Wellington boot is one of the most commonly used domestic boots. Wellington boots are waterproof boots, most commonly of rubber or polyvinyl chloride. Typically the boots have a rugged sole with a deep tread and a flexible rubber upper extending to just below the knee.

**[0003]** Wellington boots have become increasingly popular and now find particular use at festivals, where the addition of graphic designs have made such boots fashionable as well as practical. Although such boots provide a useful solution to walking on wet and/or muddy ground, they can be awkward to handle, carry and store after use, particularly if they are very muddy. Such handling and storage can present difficulty for a wearer because clothes can become muddied by the dirty boots. They can also be hot and uncomfortable to wear, should the prevailing conditions change to being warm.

**[0004]** It is an object of the invention to provide a boot which substantially mitigates or reduces these problems.

## STATEMENT OF INVENTION

**[0005]** According to the present invention there is provided a boot comprising a sole, an upper including a foot portion and a leg portion, the leg portion being moveable in use between a first position around a wearer's leg and a second position, in which the leg portion is reversed and passed over the foot portion and sole to enclose the foot portion and sole.

**[0006]** The boot is advantageous in that the leg portion can be rolled back on itself over the foot portion and sole to entirely cover or enclose the foot portion and sole. This allows for the easy storage of the boot, in particular, when it is muddy, because the relatively clean inner of the inside of the leg portion in the reversed position provides the outer of a bag for enclosing and carrying the muddy exterior of the boot. The wearer of the boot is provided with an easy mechanism by which to cover the muddy outer of the boot, when storage of the boot is required. Means may be provided for fastening together a pair of boots, when the leg portion is in either the first or second position.

**[0007]** The leg portion may be of any suitably flexible material, which allows the leg portion to be easily reversed and moved to the second position, to enclose the foot portion and sole of the boot.

**[0008]** The leg portion may be of a fabric, in particular a waterproof fabric, such as Gore-Tex (RTM). The fabric may be breathable and may have an abrasion resistant outer shell. Alternatively, the leg portion may be made

from a combination of materials, such as a fabric having a rubber coating. The leg portion may also be of a polymeric material, for example, polyvinyl chloride. The use of such materials is advantageous in allowing the wearer to easily move the leg portion between the first and second positions, in use. Furthermore, the use of such materials permits the leg portion to be easily formed to the profile of the foot portion and sole, to fully enclose the foot portion and sole and to contain mud and the like inside, when the leg portion is held in the second position and the open end is closed.

**[0009]** The leg portion may be provided with a plurality of fasteners, provided along the rear of the leg portion. The fasteners are preferably spaced apart, enabling the leg portion to be folded or rolled down and fastened at a desired position. The inside of the leg portion may be of a different colour or texture to the outside, so that when the fabric is folded or rolled down, a contrast in colour and/or texture is presented.

**[0010]** The fasteners combined with the flexibility of the material provide for adjustment of the leg portion, such that the wearer can adjust the length of the leg portion, for example in the event of a change in the weather. This is convenient for the wearer as the boot can be configured, for example, for normal use in the first position and altered to a partially collapsed position, in the form of an ankle boot, for use in hotter weather. This adjustability provides flexibility to the wearer, without the need to entirely change their footwear.

**[0011]** The fasteners may be provided in the form of stud fasteners. Alternatively, the fasteners are provided in the form of button poppers or the like. In each configuration, the fasteners are provided with a cooperating fastener at the upper rear portion of the leg portion. This allows for the leg portion to be folded or rolled down, and fastened to the rear of the leg portion at a predetermined location, as described above.

**[0012]** The leg portion may be provided with releasable securing means for releasably securing the leg portion to the foot portion. Such an arrangement allows for the selective removal of the leg portion from the foot portion. This arrangement allows the wearer to remove the leg portion, for example, in hot weather or for cleaning. The result of removing the leg portion is to provide a low cut boot. This arrangement is further advantageous in that a range of different leg portions may be provided, for example, each leg portion having a different stylised design.

**[0013]** The releasable securing means provided on the leg portion may be provided in the form of a zip fastener extending around the proximal end of the leg portion and foot portion. Alternative forms of releasable securing means may include hook fasteners, clips and the like, but a watertight fastening is preferred.

**[0014]** The leg portion may be provided with adjustable fastening means for fastening the leg portion to a wearer's lower leg when in the first position. The adjustable fastening means provides for the leg portion to be held

in place around a wearer's leg, when it is in use and in the first position. Providing a fastening means allows for the leg portion to be securely held to the wearer's leg and to prevent it from slipping and gathering around the ankle of the wearer. Fastening means provided in an adjustable form allows for the leg portion to be secured to a range of size of leg, when the leg portion is secured in position.

**[0015]** The adjustable fastening means may close or substantially close the leg portion when the leg portion is moved to the second position. This configuration permits the wearer to close or substantially close the leg portion around the foot portion and sole. This allows for the muddy or dirtied leg portion to be reversed and held in this position, for storage or for cleaning at a later time. The adjustable fastening means may be provided to fully close the open end, in order to tie off the leg portion around the foot portion and sole of the boot, thus reducing the risk of mud escaping.

**[0016]** In one configuration, the adjustable fastening means may be a cord having a toggle. The adjustable fastening means may alternatively be a lace or an adjustable strap. The adjustable strap may be provided with a hook and loop fastener.

**[0017]** The boot may be provided with a releasable fastening means for fastening together a pair of boots. The releasable fastening means may be provided on the boot at any suitable position. In one configuration, the releasable fastening means may be provided on the leg portion and at the distal end of the leg portion, that is away from the foot portion of the boot. The releasable fastening means may be provided as a separate component, aside from any other fastening or securing means. Alternatively, the releasable fastening means may be provided in combination with the adjustable fastening means provided on the leg portion, as previously described. In one configuration the adjustable fastening means may be a cord having a toggle, and the releasable fastening means is provided on each adjustable fastening means of a respective boot of a pair.

**[0018]** The releasable fastening means may be provided in the form of a male and female clip disposed on respective boots of a pair.

**[0019]** The leg portion of the boot may be provided with a pocket. The pocket may be an internal pocket, or alternatively the pocket may be a pocket external of the leg portion. In an even further alternative arrangement, the leg portion may be provided with both an internal and an external pocket. The addition of an internal or external pocket provides useful storage space for small personal possessions and valuables. The pocket or pockets provided on the leg portion may have any suitable releasable closure means for securing contents inside the pocket.

#### DESCRIPTION OF THE DRAWINGS

**[0020]** For a better understanding of the present invention, and to show more clearly how it may be carried into effect, reference will now be made, by way of example,

to the accompanying drawings, in which:

Figure 1 shows a side view of a first embodiment of a boot;

Figure 2 shows a perspective view of a boot of Figure 1 fitted to a wearer's foot, when in use;

Figure 3 shows a perspective view of a boot of Figure 1, with the leg portion fully reversed, enclosing the foot portion and sole of the boot;

Figure 4 shows a perspective view of a pair of boots of Figure 3;

Figure 5 shows a perspective view of a second embodiment of a boot;

Figure 6 shows a perspective view of a third embodiment of a boot; and

Figure 7 shows a perspective view of a fourth embodiment of a boot.

#### DESCRIPTION OF PREFERRED EMBODIMENT(S)

**[0021]** Referring firstly to Figures 1 and 2, a first embodiment of a boot is shown, indicated generally at 10. The boot 10 includes a sole 12, an upper indicated generally at 14 including a foot portion 15 and a leg portion 16. The sole 12 is of conventional type, of rubber and has a rugged grip on its lowermost surface. The foot portion 15 is of a semi-rigid material and completely surrounds the sole 12.

**[0022]** The leg portion 16 is of a waterproof fabric, such as Gore-Tex (RTM) or a polymeric material, such as polyvinyl chloride. The leg portion 16 is shaped to complement and conform to a wearer's lower leg and is provided in the form of a sleeve. In use, the leg portion 16 is fitted to a wearer's foot by the wearer first inserting their foot into the upper 14 and sliding the leg portion 16 up their lower leg, at least partially, as shown in Figure 2. The leg portion 16 is generally provided to enclose at least substantially the wearer's lower leg, although leg portions of different lengths may be provided, depending on the overall design of the boot 10. In construction, the leg portion 16 is connected to the upper 14 about the line indicated at 18.

**[0023]** A hem or channel 20 is provided at the upper or distal end of the leg portion 16. The channel 20 may be formed by folding back an end portion of the distal end of the leg portion and stitching the portion in position. Alternatively, the channel 20 may be formed by the addition of material stitched around the distal end of the leg portion 16. The channel 20 is provided to extend fully around the distal end of the leg portion 16, forming a closed channel. In one embodiment, eyelets 22 are provided on the forward face of the channel 20, about the

longitudinal plane of the boot 10. A cord 24 is provided and is housed within the channel 20. Each end of the cord 24 exits the channel 20 through a respective eyelet 22. A toggle 26 is provided to fasten each end of the cord 24 together and to provide adjustment of the length of the cord 24, to fasten the leg portion around the leg of the wearer, when in use. The cords 24 and toggle 26 are positioned at the front of the boot so as to be positioned in easy reach of the wearer.

**[0024]** The leg portion 16 is shaped with a generally angled upper end. The angled top of the leg portion is provided to slope towards the front of the boot. This provides a larger opening to allow the leg portion 16 to roll over the sole of the shoe when it is moved to the second position.

**[0025]** Referring now to Figure 3, the boot 10 is shown with the leg portion in a second position. In use, the leg portion 16 is moved to the second position by the wearer first loosening or lengthening the cord 24 and thus loosening the leg portion 16. The leg portion 16 may then be reversed about itself and slid down the leg of the wearer until the leg portion 16 becomes completely reversed about the connection 18 between the leg portion 16 and the upper 14, as shown. Once this action has been completed, the leg portion 16 may be further retracted until it fully encloses the upper 14 and the sole 12. The cord 24 can then be shortened to secure the leg portion 16 in position around the upper and the sole.

**[0026]** Figure 4 shows a pair of boots 10 as previously described, but with male and female resilient clips provided on the cords 24 of the boots. The clips 28 allow for the securing together of the pair of boots when the leg portion 16 is reversed over the foot portion and sole, when in the second position. The clips 28 may also be used to fasten together a pair of boots when the leg portion 16 is in the first position. Using the clips 28, the boots can be fastened together and the cord 24 connecting the boots used to carry the boots, for example, around the wearer's neck.

**[0027]** Figure 5 shows a second embodiment of a boot, indicated generally at 110. The boot 110 includes a sole 112, an upper 114 having a foot portion and a leg portion 116. The sole 112 and upper 114 have features in common with the first embodiment.

**[0028]** The leg portion 116 is releasably connected to the upper 114 about the line indicated at 118. A zip fastener 120 is provided around the proximal end of the leg portion 116 and the upper 114. The provision of a zip fastener 120 allows for the leg portion 116 to be selectively removed from the boot 110, when it is not required.

**[0029]** Referring now to Figure 6, there is shown a third embodiment of a boot, indicated generally at 210. Again, the boot 210 shown in these Figures has a sole 212, an upper indicated generally at 214 having a foot portion 215 and a leg portion 216, having features in common with the first embodiment and as described.

**[0030]** The embodiment shown in Figure 6 also has a channel 220, formed in a similar way to that previously

described. Again, a cord 224 is provided for securing the leg portion 216 to the wearer's leg. A toggle 226 is provided to clamp the cord 224 at a desired length once the leg portion 216 is in position. An external pocket 230 is provided and is attached to the channel 220 and is positioned at the back of the leg portion 228. The pocket 228 may be of any suitable size, but is ideally sized to hold keys, loose change and other small possessions. A zip fastener 232 is provided to releasably fasten the pocket 230 closed, when valuables and other such contents are to be secured away.

**[0031]** Figure 7 shows a fourth embodiment of a boot 310. The boot 310 has a sole 312, an upper indicated generally at 314 having a foot portion 315 and a leg portion 316. An internal pocket 334 is provided and attached to the internal surface of the leg portion 316. A zip fastener 336 is provided to releasably fasten the pocket closed when required. The internal pocket 334 may be provided at any position about the inner of the leg portion 316 to suit. Again, the internal pocket 334 may be of any suitable size, but is ideally of a suitable size for storing small personal possessions and the like.

**[0032]** Figure 7 also shows an alternative arrangement of fastening means for fastening the leg portion 316 to a wearer's leg when the boot 310 is in use. In this embodiment, a strap 338 is provided and extends around the outer of the leg portion 316. A clamp or buckle 340 is fastened to the leg portion 310 and allows for the strap 338 to be held in position once it has been tightened around the wearer's leg. The strap 338 may be provided with a plurality of holes for cooperating with the buckle 340. The strap 338 may also be provided with a hook and loop fastener, in an alternative form. Again the strap 338 may hold the leg portion 316 closed, thus enclosing the foot portion and sole, once the leg portion 316 has been moved to the second position.

**[0033]** In a yet further alternative embodiment, the boot is provided with a plurality of fasteners, provided along the rear of the leg portion. The fasteners are spaced apart and allow for the leg portion to be folded or rolled down, and fastened at a desired location. The upper rear portion of the leg portion is also provided with a cooperating fastener or fasteners, such that the leg portion can be fastened to the leg portion at a predetermined position. The fasteners may be stud fasteners. Alternatively, the fasteners may be bottom poppers.

**[0034]** The boot is advantageous in that the leg portion can be rolled or folded down and fastened, as described above, to form an ankle boot. In this configuration the boot is more comfortable to wear if the weather is warm and dry.

**[0035]** Furthermore, the leg portion can be moved between the first and second positions and in the second position, is arranged to enclose or substantially enclose the foot portion and sole. This allows a wearer to invert or reverse the leg portion, in particular when the leg portion is dirtied, to make handling the boot easier and to reduce the likelihood of dirtying clothes and storage re-

ceptacles. Whilst the leg portion of conventional boots, such as Wellington boots, can be folded, it is not possibly to fully reverse the leg portion to enclose the sole.

**[0036]** The provision of clips on each respective boot of a pair is also advantageous in permitting the pair of boots to be stored together, in one arrangement, with the leg portion being reversed. This allows the wearer to reverse the leg portion and to clip the boots together for storage, for example, by hanging the boots around the neck. A removable leg portion permits the selective removal of the leg portion, for example, when it is no longer required, in hot weather or when it requires cleaning. Furthermore, leg portions of different styles may be provided, allowing the wearer to customise the appearance of the boot, whilst using a standard foot portion and sole.

**[0037]** It is understood that variations may be made in the foregoing without departing from the scope of the invention as defined by the appended claims. For example, the elements and teachings of the various illustrative embodiments may be combined in whole or in part in some or all of the illustrative embodiments. In addition, one or more of the elements and teachings of the various illustrative embodiments may be omitted, at least in part, and/or combined, at least in part, with one or more of the other elements and teachings of the various illustrative embodiments.

## Claims

1. A boot (10) comprising a sole (12), an upper (14) including a foot portion (15) and a leg portion (16), the leg portion (16) being moveable in use between a first position around a wearer's leg and a second position, in which the leg portion (16) is reversed and passed over the foot portion (15) and sole (12) to enclose the foot portion (15) and sole (12).
2. A boot (10) as claimed in claim 1, in which the leg portion (16) is of a flexible material.
3. A boot (10) as claimed in claim 2, in which the leg portion (16) is of a waterproof fabric.
4. A boot (10) as claimed in claim 2, in which the leg portion (16) is of polyvinyl chloride.
5. A boot (10) as claimed in any preceding claim, in which the leg portion (16) includes a plurality of fasteners for fastening the leg portion in one of a plurality of rolled or folded positions for conversion of the boot into an ankle boot.
6. A boot (10) as claimed in any preceding claim, in which the leg portion (16) has releasable securing means (120) for releasably securing the leg portion (16) to the foot portion (15).
7. A boot (10) as claimed in claim 6, in which the releasable securing means (120) is a zip fastener extending around the proximal end of the leg portion (16) and foot portion (15).
8. A boot (10) as claimed in any preceding claim, in which the leg portion (16) is provided with adjustable fastening means (24) for fastening the leg portion (16) to a wearer's lower leg when in the first position.
9. A boot (10) as claimed in claim 8, in which the adjustable fastening means (24) closes or substantially closes the leg portion (16) when in the second position.
10. A boot (10) as claimed in either of claims 8 or 9, in which the adjustable fastening means (24) is a cord having a toggle, a lace, or an adjustable strap.
11. A boot (10) as claimed in claim 8, in which a releasable fastening means (28) is provided for fastening together a pair of boots.
12. A boot (10) as claimed in claim 11, in which the releasable fastening means (28) includes male and female clips disposed on respective boots of a pair.
13. A boot (10) as claimed in any preceding claim, in which the leg portion (16) is provided with a pocket (334).
14. A boot (10) as claimed in claim 13, in which the pocket (334) is an internal pocket.
15. A boot (10) as claimed in claim 13, in which the pocket (230) is external of the leg portion (16).

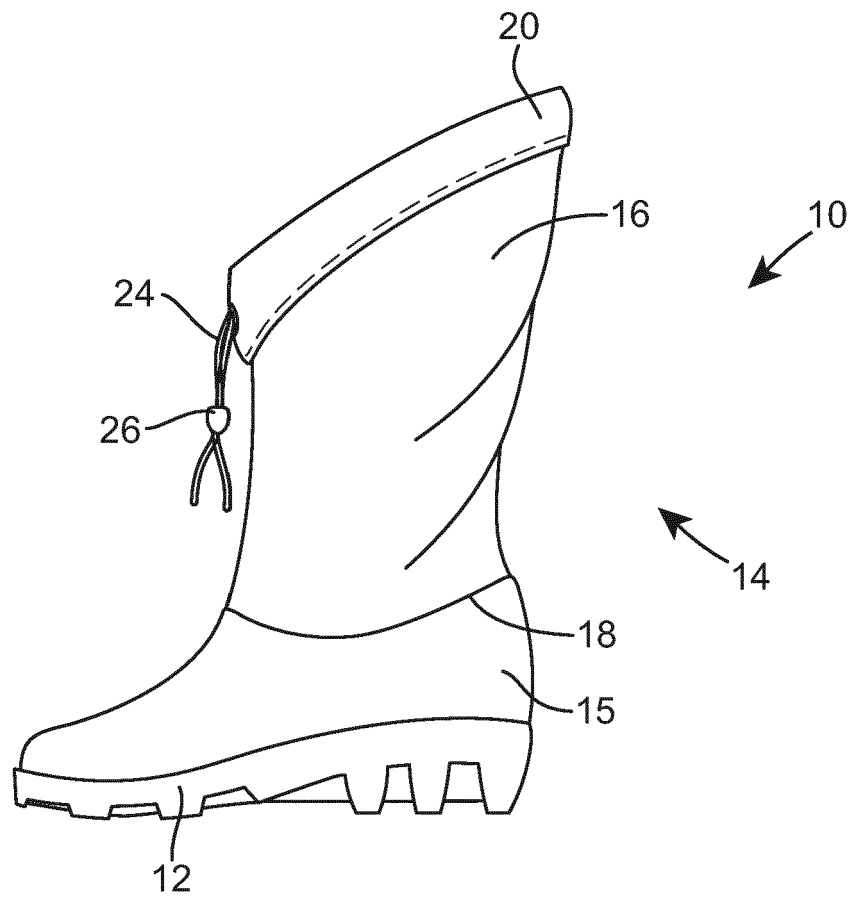

Fig. 1

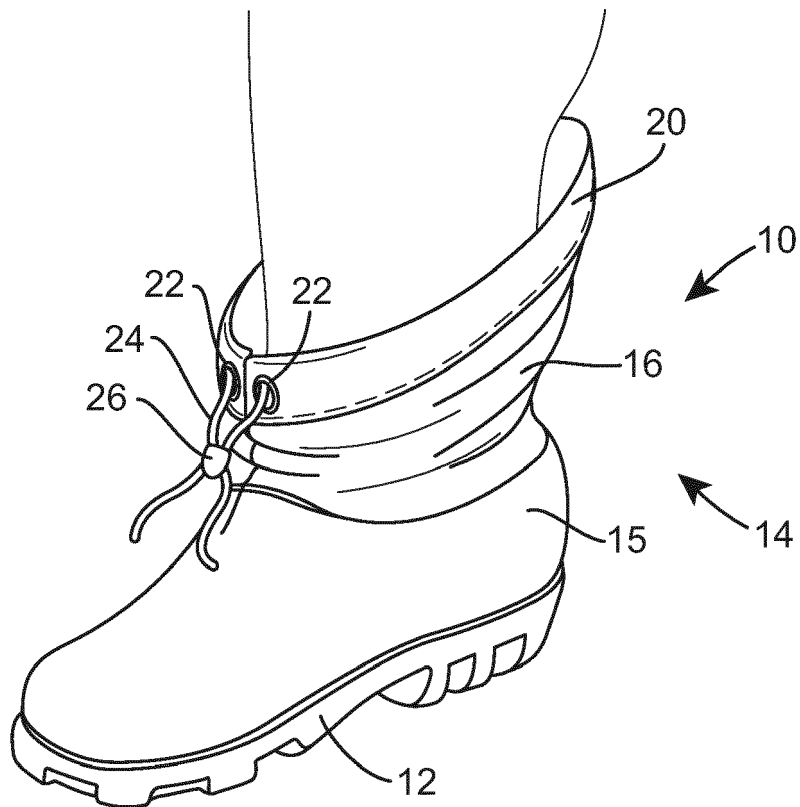

Fig. 2

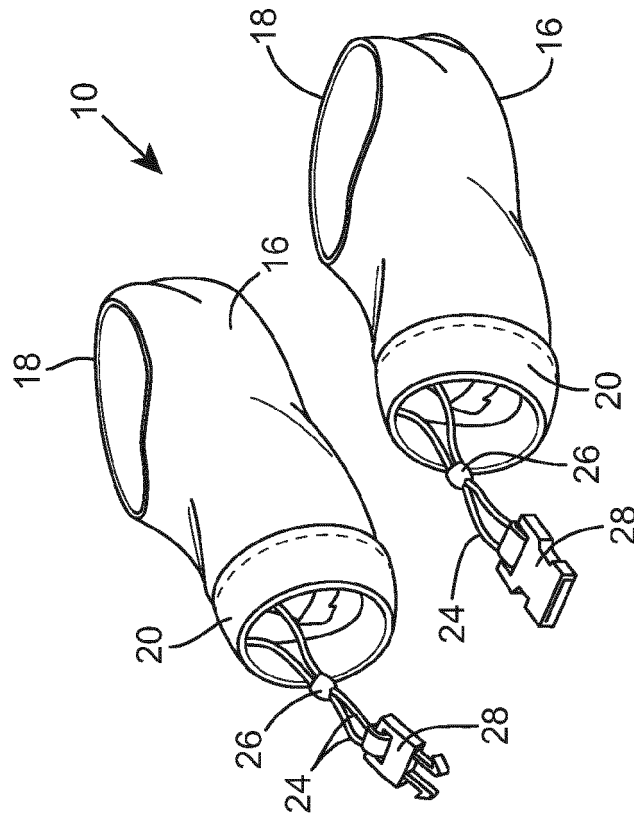

Fig. 4

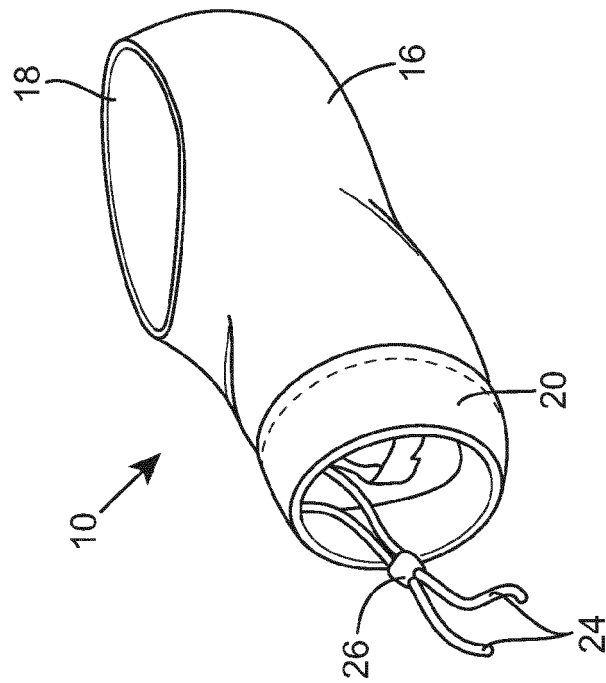

Fig. 3



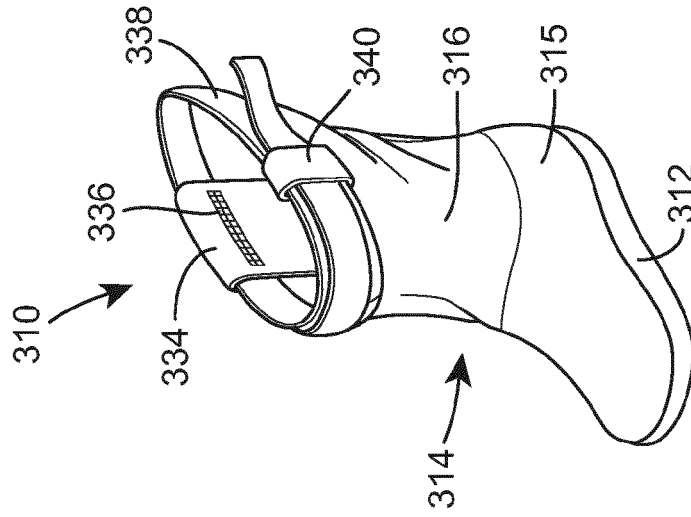

Fig. 5

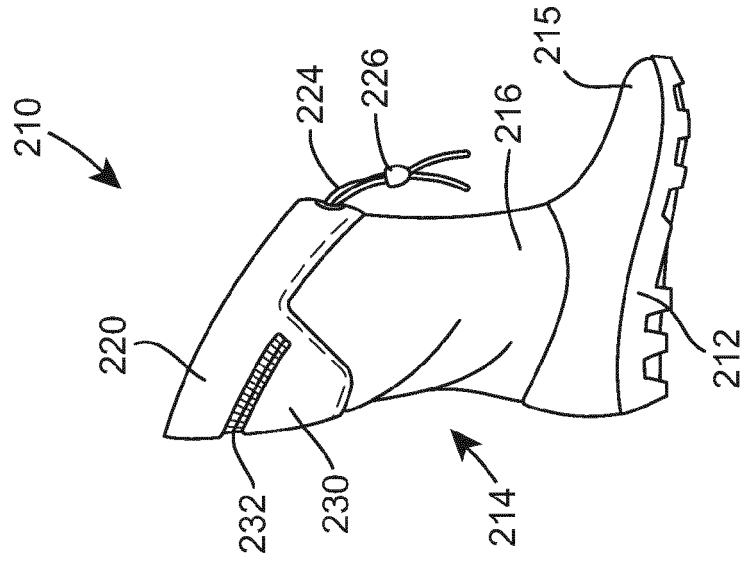

Fig. 6

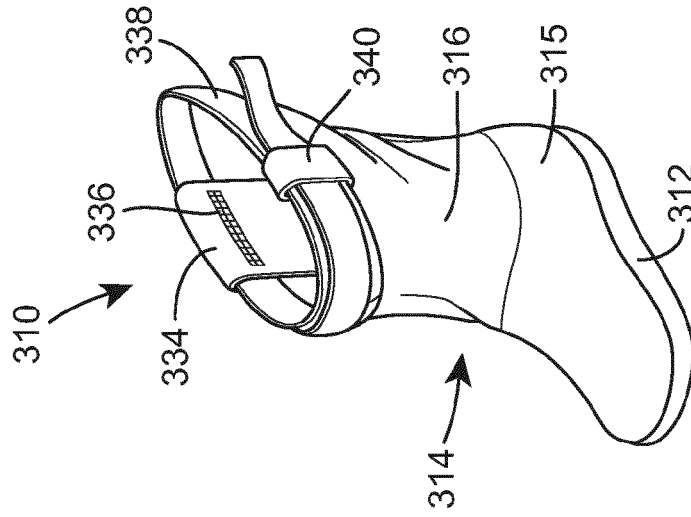

Fig. 7



## EUROPEAN SEARCH REPORT

Application Number  
EP 12 19 3913

DOCUMENTS CONSIDERED TO BE RELEVANT			
Category	Citation of document with indication, where appropriate, of relevant passages	Relevant to claim	CLASSIFICATION OF THE APPLICATION (IPC)
X	US 4 937 881 A (HEISE ANNEMARIE [US]) 3 July 1990 (1990-07-03) * column 3, line 61 - column 6, line 17 * * figures 13,16 *	1,2,4,5,8,9	INV. A43B3/24 A43B3/02
X	GB 2 487 407 A (CLARK ASHER [GB]) 25 July 2012 (2012-07-25)  * the whole document *	1,2,8-11,13-15	ADD. A43B23/06 A43B1/06
X	EP 0 356 586 A2 (DATSON IAN ARNOLD) 7 March 1990 (1990-03-07) * the whole document *	1-5,8-14	
X	US 2009/158503 A1 (DUCLOS GARY PAUL [US]) 25 June 2009 (2009-06-25) * the whole document *	1,2,8,9,13-15	
X	US 2012/047766 A1 (MOORE LINDA FAYE [US]) 1 March 2012 (2012-03-01) * the whole document *	1-3,5,6	
X	WO 2007/082360 A1 (1216080 ALBERTA LTD [CA]; LEVESQUE LUC JOSEPH [CA]; GERSTNER MICHAEL A) 26 July 2007 (2007-07-26) * the whole document * * figures 14-21 *	1-3,5-15	
The present search report has been drawn up for all claims			TECHNICAL FIELDS SEARCHED (IPC) A43B A43C
Place of search The Hague		Date of completion of the search 16 December 2013	Examiner Millward, Richard
CATEGORY OF CITED DOCUMENTS X : particularly relevant if taken alone Y : particularly relevant if combined with another document of the same category A : technological background O : non-written disclosure P : intermediate document		T : theory or principle underlying the invention E : earlier patent document, but published on, or after the filing date D : document cited in the application L : document cited for other reasons & : member of the same patent family, corresponding document	

1  
EPO FORM 1503 03.82 (F04C01)

**ANNEX TO THE EUROPEAN SEARCH REPORT  
ON EUROPEAN PATENT APPLICATION NO.**

EP 12 19 3913

This annex lists the patent family members relating to the patent documents cited in the above-mentioned European search report.  
The members are as contained in the European Patent Office EDP file on  
The European Patent Office is in no way liable for these particulars which are merely given for the purpose of information.

16-12-2013

Patent document cited in search report	Publication date	Patent family member(s)	Publication date
US 4937881 A	03-07-1990	AU 3692984 A EP 0150425 A1 JP S60155703 A US 4937881 A ZA 8410090 A	11-07-1985 07-08-1985 15-08-1985 03-07-1990 28-08-1985
GB 2487407 A	25-07-2012	GB 2487407 A WO 2012098417 A2	25-07-2012 26-07-2012
EP 0356586 A2	07-03-1990	NONE	
US 2009158503 A1	25-06-2009	US 2009158503 A1 US 2012017355 A1	25-06-2009 26-01-2012
US 2012047766 A1	01-03-2012	US 2012047766 A1 WO 2012027311 A2	01-03-2012 01-03-2012
WO 2007082360 A1	26-07-2007	NONE	