



(12) **EUROPEAN PATENT APPLICATION**

(88) Date of publication A3:
18.06.2014 Bulletin 2014/25

(51) Int Cl.:
F21V 17/16^(2006.01) F21V 19/00^(2006.01)

(43) Date of publication A2:
26.03.2014 Bulletin 2014/13

(21) Application number: **13182387.4**

(22) Date of filing: **30.08.2013**

(84) Designated Contracting States:
AL AT BE BG CH CY CZ DE DK EE ES FI FR GB GR HR HU IE IS IT LI LT LU LV MC MK MT NL NO PL PT RO RS SE SI SK SM TR
 Designated Extension States:
BA ME

• **OSRAM S.P.A. - SOCIETA' RIUNITE OSRAM EDISON CLERICI**
20126 Milano (IT)

(30) Priority: **24.09.2012 IT TO20120824**

(72) Inventors:
 • **Sagliocco, Alessio**
30027 San Donà di Piave (IT)
 • **Vianello, Davide**
30038 Spinea (IT)

(71) Applicants:
 • **OSRAM GmbH**
80807 München (DE)

(54) **Optical assembly for lighting sources**

(57) An optical assembly (12) for lighting sources (L) includes a cup-shaped reflector (14) having a bottom portion (14a) for mounting a light radiation source and a mouth portion (14b) for projecting the light radiation, the mouth portion (14b) having a peripheral rim (140). A light-permeable screen (16) peripherally rests on the rim (140) of the mouth portion (14b) of the reflector (14). Provision is made of a front ring (18) forming a receiving frame for the screen (16) to arrange the screen (16) sandwiched between the reflector (14) and an annular inner side (18a)

of the front ring (18). The front ring (18) has a plurality of cusp formations (18b) protruding from the annular inner side (18a) to surround the reflector (14). An annular assembly spring (20) is coupleable to the front ring (18) to urge the reflector (14) and the screen (16) towards the annular inner side (18a) of the front ring (18); the assembly spring (20) has a plurality of cusps having distal ends (200) coupled to the cusp formations (18b) of the front ring (18).

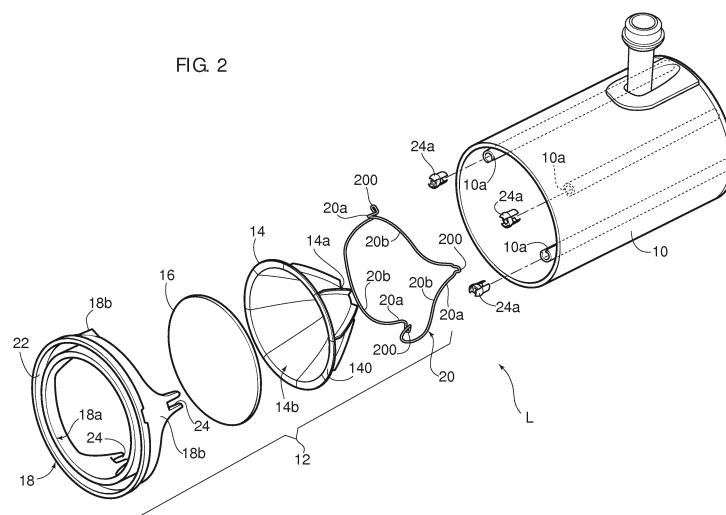



EUROPEAN SEARCH REPORT

Application Number
EP 13 18 2387

DOCUMENTS CONSIDERED TO BE RELEVANT			
Category	Citation of document with indication, where appropriate, of relevant passages	Relevant to claim	CLASSIFICATION OF THE APPLICATION (IPC)
A	DE 44 10 192 A1 (ERCO LEUCHTEN [DE]) 19 October 1995 (1995-10-19) * column 2, line 66 - column 4, line 59; figure 1 * -----	1-9	INV. F21V17/16 F21V19/00
A	GB 1 027 873 A (MEYER MFG COMPANY LTD) 27 April 1966 (1966-04-27) * page 1, line 60 - page 2, line 68; figures 1-4 * -----	1-9	
A	US 5 215 371 A (PILESKI MICHAEL J [US]) 1 June 1993 (1993-06-01) * column 2, line 29 - column 3, line 58; figures 1-4 * -----	1	
			TECHNICAL FIELDS SEARCHED (IPC)
			F21V
The present search report has been drawn up for all claims			
Place of search Munich		Date of completion of the search 2 April 2014	Examiner Arboreanu, Antoniu
CATEGORY OF CITED DOCUMENTS X : particularly relevant if taken alone Y : particularly relevant if combined with another document of the same category A : technological background O : non-written disclosure P : intermediate document		T : theory or principle underlying the invention E : earlier patent document, but published on, or after the filing date D : document cited in the application L : document cited for other reasons & : member of the same patent family, corresponding document	

1
EPO FORM 1503 03.82 (POAC01)

**ANNEX TO THE EUROPEAN SEARCH REPORT
ON EUROPEAN PATENT APPLICATION NO.**

EP 13 18 2387

This annex lists the patent family members relating to the patent documents cited in the above-mentioned European search report. The members are as contained in the European Patent Office EDP file on
The European Patent Office is in no way liable for these particulars which are merely given for the purpose of information.

02-04-2014

Patent document cited in search report		Publication date	Patent family member(s)	Publication date
DE 4410192	A1	19-10-1995	NONE	

GB 1027873	A	27-04-1966	NONE	

US 5215371	A	01-06-1993	NONE	

EPO FORM P0459

For more details about this annex : see Official Journal of the European Patent Office, No. 12/82