



(12) **EUROPEAN PATENT APPLICATION**

(88) Date of publication A3:  
**03.01.2018 Bulletin 2018/01**

(51) Int Cl.:  
**D06F 58/24** <sup>(2006.01)</sup> **D06F 25/00** <sup>(2006.01)</sup>

(43) Date of publication A2:  
**09.04.2014 Bulletin 2014/15**

(21) Application number: **13187574.2**

(22) Date of filing: **07.10.2013**

(84) Designated Contracting States:  
**AL AT BE BG CH CY CZ DE DK EE ES FI FR GB  
GR HR HU IE IS IT LI LT LU LV MC MK MT NL NO  
PL PT RO RS SE SI SK SM TR**  
Designated Extension States:  
**BA ME**

(71) Applicant: **Whirlpool EMEA S.p.A.**  
**20016 Pero (MI) (IT)**

(72) Inventor: **Marchesi, Nicola**  
**60044 Fabriano (ANCONA) (IT)**

(74) Representative: **Gotra, Stefano**  
**BUGNION S.p.A.**  
**Largo Michele Novaro, 1/A**  
**43121 Parma (IT)**

(30) Priority: **08.10.2012 IT PR20120005 U**

(54) **Electrical household appliance for washing and drying linen**

(57) An electrical household appliance for washing and drying linen comprising:

- i) a drying compartment (2);
- ii) a circulation line (3) which takes a gaseous fluid from the compartment (2) and re-introduces it into said compartment (2);
- iii) a condenser (4) which enables the condensation of at least a part of the vapour contained in the gaseous fluid; said condenser (4) comprising:
  - a first channel (41) for the passing of the gaseous fluid from the compartment (2); the first channel (41) being integrated into said circulation line (3);
  - a second channel (42) for the passing of a coolant liquid;

- iv) a tank (5) for storing a liquid;
- v) first hydraulic connection means (6) active at least between the second passing channel (42) and said tank (5) for performing a transfer of the liquid from the second passing channel (42) to the tank (5) in order to store the coolant liquid transiting in the second channel (42) to be used as a washing liquid.

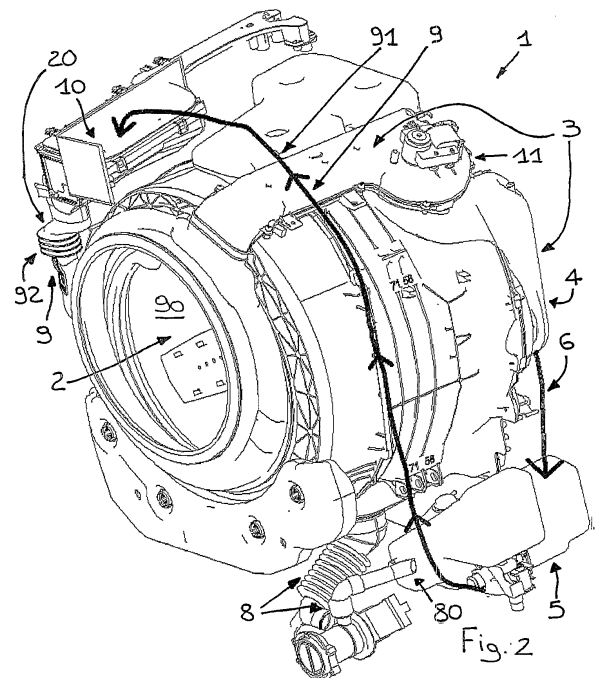



## EUROPEAN SEARCH REPORT

Application Number  
EP 13 18 7574

5

10

15

20

25

30

35

40

45

50

55

DOCUMENTS CONSIDERED TO BE RELEVANT			
Category	Citation of document with indication, where appropriate, of relevant passages	Relevant to claim	CLASSIFICATION OF THE APPLICATION (IPC)
X	EP 2 241 663 A1 (ELECTROLUX HOME PROD CORP [BE]) 20 October 2010 (2010-10-20)	1,5	INV.
A	* paragraph [00250027]; figure 1 *	2,4,6-12	D06F58/24
	-----		D06F25/00
X	EP 1 029 961 A2 (IAR SILTAL SPA [IT]) 23 August 2000 (2000-08-23)	1	
A	* paragraphs [0023] - [0027]; figures *	2-12	
	-----		
A,P	EP 2 573 246 A1 (INDESIT CO SPA [IT]) 27 March 2013 (2013-03-27)	1-12	
	* paragraph [0015]; figure 6 *		
	-----		
A	EP 2 149 635 A1 (ELECTROLUX HOME PROD CORP [BE]) 3 February 2010 (2010-02-03)	1-12	
	* claim 1; figures *		
	-----		
			TECHNICAL FIELDS SEARCHED (IPC)
			D06F
The present search report has been drawn up for all claims			
Place of search		Date of completion of the search	Examiner
Munich		27 November 2017	Stroppa, Giovanni
<p>CATEGORY OF CITED DOCUMENTS</p> <p>X : particularly relevant if taken alone  Y : particularly relevant if combined with another document of the same category  A : technological background  O : non-written disclosure  P : intermediate document</p> <p>T : theory or principle underlying the invention  E : earlier patent document, but published on, or after the filing date  D : document cited in the application  L : document cited for other reasons  &amp; : member of the same patent family, corresponding document</p>			

EPO FORM 1503 03/82 (P04C01)

**ANNEX TO THE EUROPEAN SEARCH REPORT  
ON EUROPEAN PATENT APPLICATION NO.**

EP 13 18 7574

5

This annex lists the patent family members relating to the patent documents cited in the above-mentioned European search report.  
The members are as contained in the European Patent Office EDP file on  
The European Patent Office is in no way liable for these particulars which are merely given for the purpose of information.

27-11-2017

10

Patent document cited in search report	Publication date	Patent family member(s)	Publication date
EP 2241663	A1	20-10-2010	NONE
EP 1029961	A2	23-08-2000	AT 289637 T 15-03-2005 DE 69923830 D1 31-03-2005 DE 69923830 T2 29-12-2005 DK 1029961 T3 09-05-2005 EP 1029961 A2 23-08-2000 ES 2239425 T3 16-09-2005 IT MI990304 A1 16-08-2000 PT 1029961 E 31-05-2005 TR 9903165 A2 21-09-2000
EP 2573246	A1	27-03-2013	EP 2573246 A1 27-03-2013 PL 2573246 T3 31-08-2017 RU 2012132715 A 10-02-2014
EP 2149635	A1	03-02-2010	EP 2149635 A1 03-02-2010 RU 2009129555 A 10-02-2011 WO 2010012357 A1 04-02-2010

15

20

25

30

35

40

45

50

55

EPO FORM P0459

For more details about this annex : see Official Journal of the European Patent Office, No. 12/82