



(12) **EUROPEAN PATENT APPLICATION**

(88) Date of publication A3:  
**28.06.2017 Bulletin 2017/26**

(51) Int Cl.:  
**B65H 75/40 (2006.01)** **B65H 75/44 (2006.01)**  
**B65H 75/36 (2006.01)**

(43) Date of publication A2:  
**14.05.2014 Bulletin 2014/20**

(21) Application number: **13192267.6**

(22) Date of filing: **11.11.2013**

(84) Designated Contracting States:  
**AL AT BE BG CH CY CZ DE DK EE ES FI FR GB GR HR HU IE IS IT LI LT LU LV MC MK MT NL NO PL PT RO RS SE SI SK SM TR**  
Designated Extension States:  
**BA ME**

(71) Applicant: **CLABER S.P.A.**  
**33080 Fiume Veneto (PN) (IT)**

(72) Inventor: **Franchini, Gaetano**  
**33080 FIUME VENETO (PN) (IT)**

(74) Representative: **Mittler, Enrico et al**  
**Mittler & C. S.r.l.**  
**Viale Lombardia, 20**  
**20131 Milano (IT)**

(30) Priority: **12.11.2012 IT MI20120405 U**

(54) **Hose support and watering accessories.**

(57) A support (100) for hose (99) and watering accessories comprising a winding drum (3) with end flanges (1, 2) for the containment of the hose, in which one (1) of the two flanges (1, 2) is provided with a pair of upper lateral fins (18), symmetrically protruding one on one side and the other on the other side of said flange (1), provided with hollow seats (19) for housing respective fittings (20) intended for connecting the hose (99) to a water outlet (22) and to an end dispenser (24). Said seats (19) of the fittings are made so as to allow the positioning of seated-like fittings. The front surface of said flange (1) is provided with means (6-8, 10) for attaching and supporting a dispensing gun (24). A retractable lifting handle (16) is provided which can be extracted from the area of the two flanges (1, 2) by partial vertical extraction from a seat (14) formed in said flange (1).

Fig.10

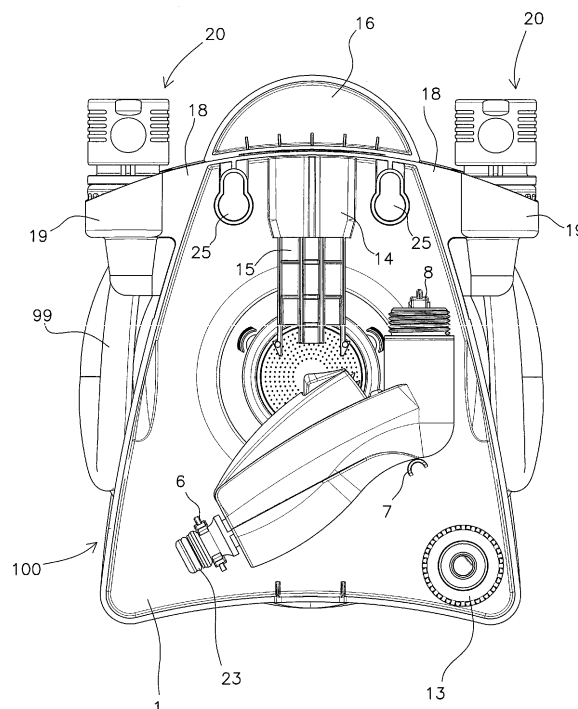



## EUROPEAN SEARCH REPORT

 Application Number  
 EP 13 19 2267

5

10

15

20

25

30

35

40

45

50

55

DOCUMENTS CONSIDERED TO BE RELEVANT			
Category	Citation of document with indication, where appropriate, of relevant passages	Relevant to claim	CLASSIFICATION OF THE APPLICATION (IPC)
X	JP 3 057052 B2 (KOTOBUKI TSUSHO KK) 26 June 2000 (2000-06-26)	1,2,4	INV. B65H75/40 B65H75/44 B65H75/36
Y	* abstract; figures 1,5,7,9 * -----	3	
Y	US 6 857 713 B1 (KUELBS GREGORY G [US] ET AL) 22 February 2005 (2005-02-22) * column 3, lines 1-5; figures 1,3 * -----	3	
E	DE 20 2013 104936 U1 (WANG KUAN HSIUNG [TW]) 20 November 2013 (2013-11-20) * the whole document * -----	1-4	
			TECHNICAL FIELDS SEARCHED (IPC)
			B65H
The present search report has been drawn up for all claims			
Place of search <b>The Hague</b>		Date of completion of the search <b>16 May 2017</b>	Examiner <b>Pussemier, Bart</b>
CATEGORY OF CITED DOCUMENTS X : particularly relevant if taken alone Y : particularly relevant if combined with another document of the same category A : technological background O : non-written disclosure P : intermediate document T : theory or principle underlying the invention E : earlier patent document, but published on, or after the filing date D : document cited in the application L : document cited for other reasons & : member of the same patent family, corresponding document			

 1  
 EPO FORM 1503 03.02 (P04C01)

**ANNEX TO THE EUROPEAN SEARCH REPORT  
ON EUROPEAN PATENT APPLICATION NO.**

EP 13 19 2267

5 This annex lists the patent family members relating to the patent documents cited in the above-mentioned European search report.  
The members are as contained in the European Patent Office EDP file on  
The European Patent Office is in no way liable for these particulars which are merely given for the purpose of information.

16-05-2017

Patent document cited in search report	Publication date	Patent family member(s)	Publication date
JP 3057052 B2	26-06-2000	CN 1227900 A	08-09-1999
		JP 3057052 B2	26-06-2000
		JP H11246000 A	14-09-1999
		TW 367302 B	21-08-1999
-----			
US 6857713 B1	22-02-2005	NONE	
-----			
DE 202013104936 U1	20-11-2013	NONE	
-----			