



(12) **EUROPEAN PATENT APPLICATION**

(43) Date of publication:
02.07.2014 Bulletin 2014/27

(51) Int Cl.:
A63H 3/31 (2006.01) A63H 3/36 (2006.01)

(21) Application number: **12199773.8**

(22) Date of filing: **28.12.2012**

(84) Designated Contracting States:
AL AT BE BG CH CY CZ DE DK EE ES FI FR GB GR HR HU IE IS IT LI LT LU LV MC MK MT NL NO PL PT RO RS SE SI SK SM TR
Designated Extension States:
BA ME

(71) Applicant: **Foluck International Co., Ltd.**
Taoyuan (TW)

(72) Inventor: **Hsu, Ming Tay**
Taoyuan (TW)

(74) Representative: **Jeannet, Olivier**
JEANNET & Associés
26 Quai Claude Bernard
69007 Lyon (FR)

(54) **Protruding tongue and sounding structure of puppet**

(57) A protruding tongue and sounding structure of a puppet (1) includes a protruding tongue (222) and sounding device (2) mounted inside the puppet (1). The puppet (1) is a soft and hollow bag-shaped configuration. The protruding tongue (222) and sounding device (2) includes a housing (21) and a slide member (22) which is movable in the housing (21) by air flow. A whistle (24) is provided in the slide member (22). The slide member (22) includes a tongue (222) at one end thereof. The tongue (222) can extend out of the slide member (22) and the puppet (1). When the puppet (1) is pressed by the user's fingers, the air in the puppet (1) flows out through the protruding tongue (222) and sounding device (2). The air in the puppet (1) pushes the slide member (22) of the protruding tongue (222) and sounding device (2) to move outward and forces the whistle (24) to sound. Furthermore, the tongue (222) extends outward, like the puppet (1) to protrude its tongue (222).

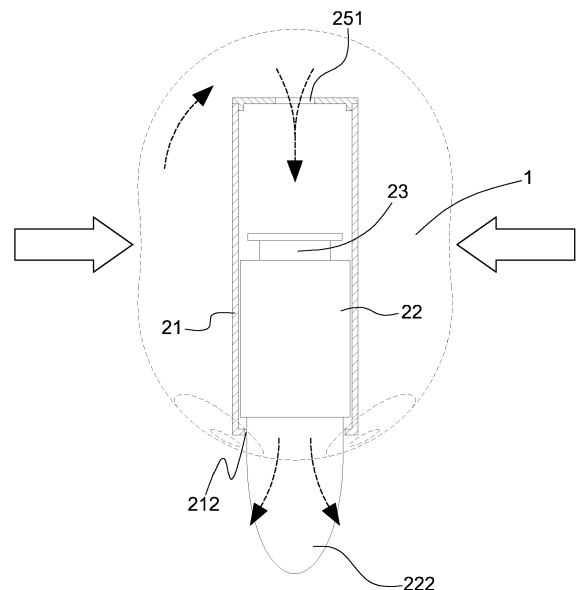

Fig.5

Description

BACKGROUND OF THE INVENTION

1. Field of the Invention

[0001] The present invention relates to a protruding tongue and sounding structure of a puppet, and more particularly, to a protruding tongue and sounding structure of a puppet which can protrude its tongue and sound by pressing the puppet.

2. Description of the Prior Art

[0002] There are many various puppets on the market. Most puppets have a special shape to attract consumers, such as a cartoon or an animal shape. Some puppets have a sounding device. For example, Taiwan Patent Publication No. M243261 discloses an improved helicopter toy which comprises a balloon, a plurality of wings, a horn and a pivot seat. After the balloon is inflated, the horn will sound by releasing the balloon.

[0003] Traditional toys only provide a visual effect or a hearing effect. Accordingly, the inventor of the present invention has devoted himself based on his many years of practical experiences to solve these problems in order to attract consumers.

SUMMARY OF THE INVENTION

[0004] The primary object of the present invention is to provide a protruding tongue and sounding structure of a puppet for improving the shortcomings mentioned above. When in use, the puppet is pressed by the user's fingers so that the puppet will have a change in shape and sound to provide visual and hearing effects. The present invention is great fun.

[0005] In order to achieve the aforesaid object, the present invention comprises a puppet and a protruding tongue and sounding device mounted inside the puppet.

[0006] The puppet is a soft and hollow bag-shaped configuration, and is deformable when pressed.

[0007] The puppet has a mouth opening.

[0008] The protruding tongue and sounding device is mounted inside the mouth opening of the puppet.

[0009] The protruding tongue and sounding device comprises a housing. An inner end of the housing has a housing chamber therein. The housing has a cylinder shape. An opposing outer end of the housing has a slot.

[0010] The protruding tongue and sounding device further comprises a slide member disposed in the housing chamber. The slide member is slidably movable in the housing. The slide member has a hollow shape. The slide member has an inner space. The slide member comprises a tongue at one end thereof. A sleeve member is mounted in the inner space of the slide member.

[0011] The tongue is made of soft and hard plastic materials. When the tongue is made of a soft plastic material,

the tongue provides a certain real effect.

[0012] The sleeve member has a space therein. A whistle is provided in the space. When air flows, the whistle will sound.

[0013] The housing comprises a cover at an inner end thereof. The cover has an aperture.

BRIEF DESCRIPTION OF THE DRAWINGS

[0014]

Fig. 1 is a perspective view of the present invention;

Fig. 2 is an exploded view of the protruding tongue and sounding device of the present invention;

Fig. 3 is a perspective view of the protruding tongue and sounding device of the present invention;

Fig. 4 is a top sectional view of the present invention;

Fig. 5 is a top sectional view of the present invention in an operating state; and

Fig. 6 is a perspective view of the present invention in an operating state.

DETAILED DESCRIPTION OF THE PREFERRED EMBODIMENTS

[0015] Embodiments of the present invention will now be described, by way of example only, with reference to the accompanying drawings.

[0016] As shown in Fig. 1, Fig. 2 and Fig. 3, a protruding tongue and sounding structure of a puppet comprises a protruding tongue and sounding device 2 mounted inside a puppet 1.

[0017] The puppet 1 is a soft and hollow bag-shaped configuration, and is deformable when pressed. The puppet 1 has a mouth opening 11.

[0018] The protruding tongue and sounding device 2 is mounted inside the mouth opening 11 of the puppet 1. The protruding tongue and sounding device 2 comprises a housing 21. An inner end of the housing 21 has a housing chamber 211 therein. The housing 21 has a cylinder shape. An outer end of the housing 21 has a slot 212. The protruding tongue and sounding device 2 further comprises a slide member 22 disposed in the housing chamber 211. The slide member 22 is slidably movable in the housing 21. The slide member 22 has a hollow shape. The slide member 22 has an inner space 221. The slide member 22 comprises a tongue 222 at one end thereof. A sleeve member 23 is mounted in the inner space 221 of the slide member 22. The sleeve member 23 has a space 231 therein. A whistle 24 is provided in the space 231. When air flows, the whistle 24 will sound. The housing 21 comprises a cover 25 at an inner end thereof. The cover 25 has an aperture 251.

[0019] As shown in Fig. 4, the slide member 22 is located inside the housing 21. The tongue 222 is located inside the puppet 1. The tongue 222 is made of soft and hard plastic materials. When the tongue 222 is made of a soft plastic material, the tongue 222 provides a certain real effect.

[0020] When in use, referring to Fig. 1, Fig. 2 and Fig. 5, when the puppet 1 is pressed by the user's hand to be deformed inward, the air in the puppet 1 flows out toward the month opening 11 through the protruding tongue and sounding device 2. The air in the puppet 1 pushes the slide member 22 of the protruding tongue and sounding device 2 to move outward and forces the whistle 24 to sound. Furthermore, the tongue 222 extends outward from the slot 212 and the month opening 11, like the puppet 1 to protrude its tongue as shown in Fig. 6. Thus, the present invention makes the puppet 1 protrude its tongue and sound so it is great fun.

[0021] Accordingly, the protruding tongue and sounding structure of the puppet of the present invention overcomes the shortcomings of the conventional toys that can sound or be deformed only. The present invention provides better visual and hearing effects by protruding tongue and sounding.

[0022] Although particular embodiments of the present invention have been described in detail for purposes of illustration, various modifications and enhancements may be made without departing from the spirit and scope of the present invention. Accordingly, the present invention is not to be limited except as by the appended claims.

Claims

1. A protruding tongue and sounding structure of a puppet (1), comprising:
 - the puppet (1) having a mouth opening (11);
 - a protruding tongue and sounding device (2) mounted inside the mouth opening (11) of the puppet (1), the protruding tongue and sounding device (2) comprising a housing (21), an inner end of the housing (21) having a housing chamber (211) therein, an outer end of the housing (21) having a slot (212), the protruding tongue and sounding device (2) further comprising a slide member (22) disposed in the housing (21) chamber, the slide member (22) having an inner space (221), the slide member (22) comprising a tongue (222) at one end thereof, a sleeve member (23) mounted in the inner space (221) of the slide member (22), a whistle (24) provided in the sleeve member (23), the housing (21) comprising a cover (25) at an inner end thereof, the cover (25) having an aperture (251).
2. The protruding tongue and sounding structure of a puppet (1) as claimed in claim 1, wherein the puppet

(1) is a soft and hollow bag-shaped configuration.

3. The protruding tongue and sounding structure of a puppet (1) as claimed in claim 1, wherein the housing (21) has a cylinder shape.
4. The protruding tongue and sounding structure of a puppet (1) as claimed in claim 1, wherein the sleeve member (23) has a space (231) therein, and the whistle (24) is disposed in the space (231).
5. The protruding tongue and sounding structure of a puppet (1) as claimed in claim 1, wherein the tongue (222) is located inside the slot (212).
6. The protruding tongue and sounding structure of a puppet (1) as claimed in claim 1, wherein the tongue (222) is made of soft and hard plastic materials.

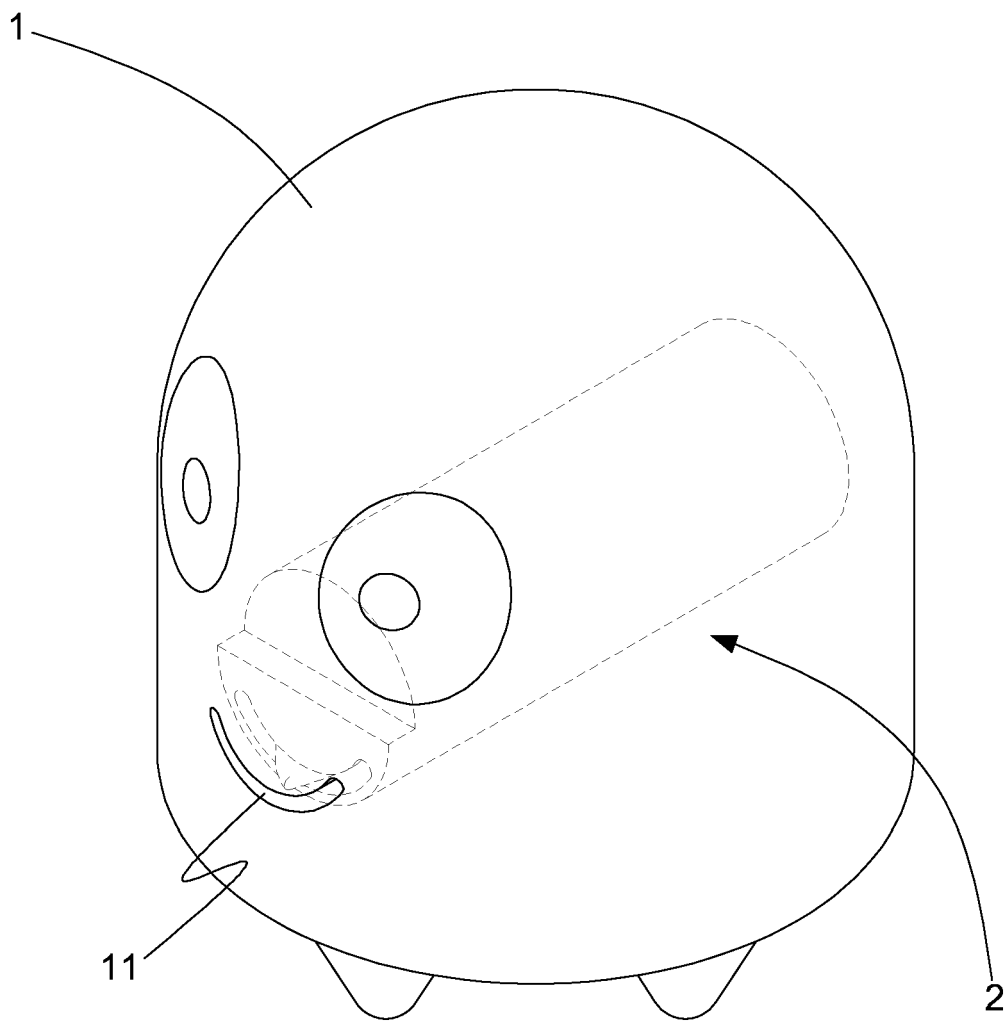

Fig.1

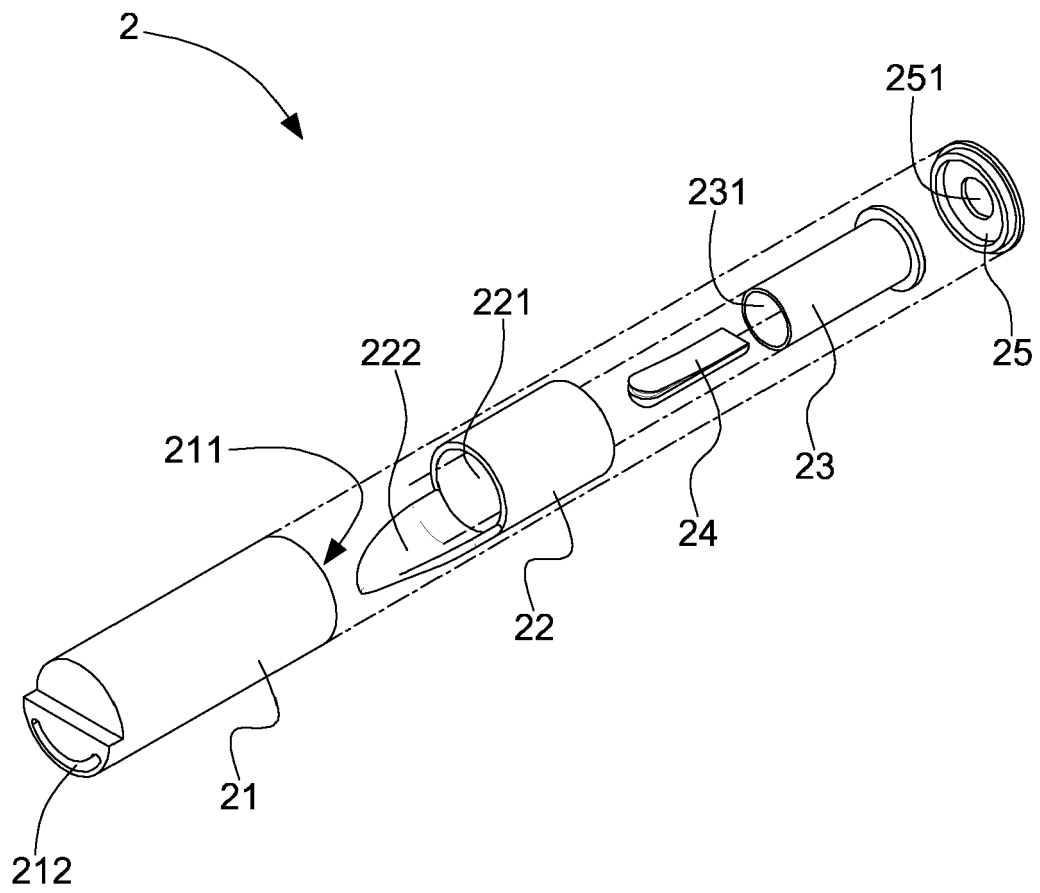

Fig.2

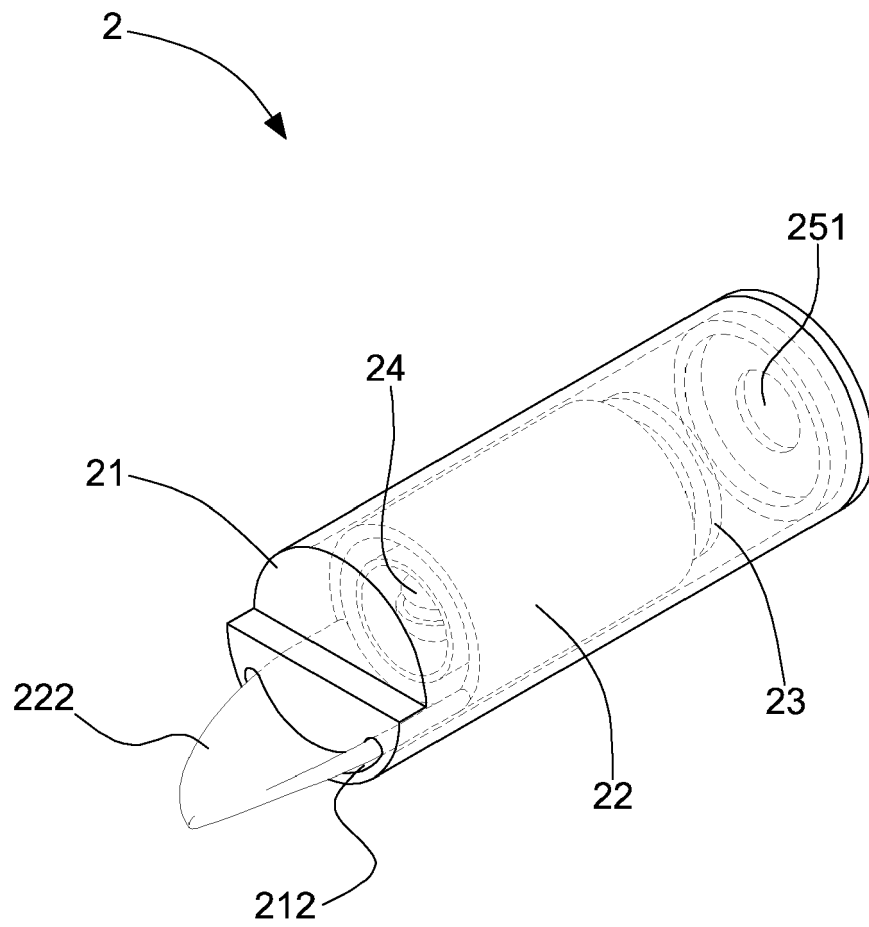

Fig.3

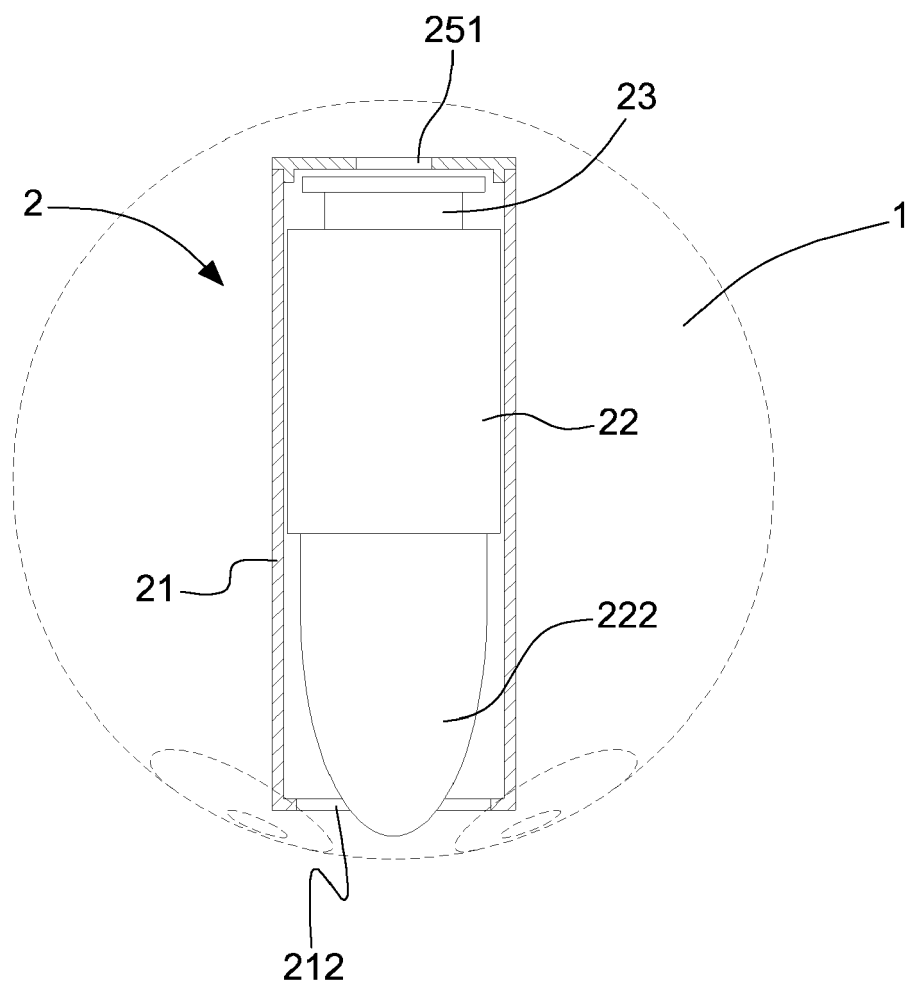

Fig.4

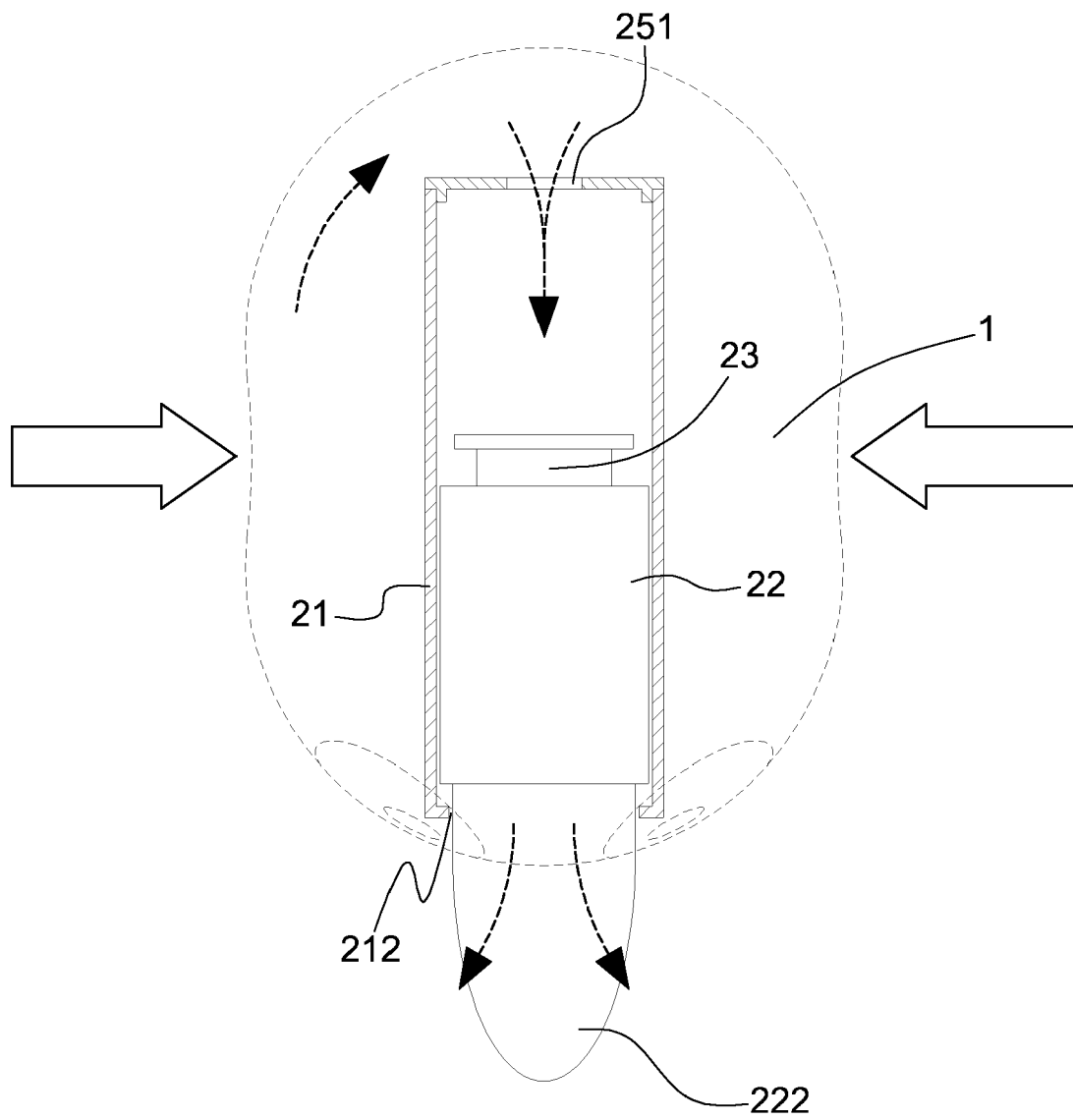

Fig.5

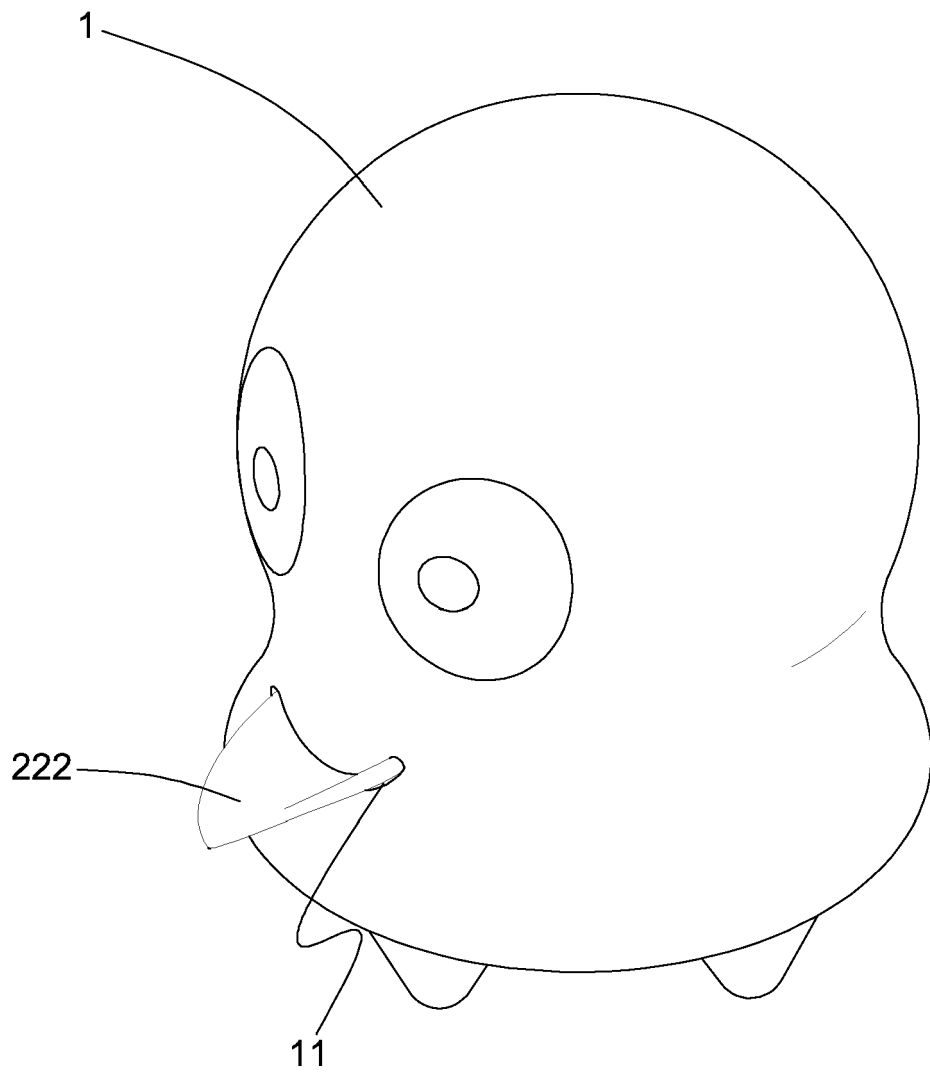

Fig.6



EUROPEAN SEARCH REPORT

 Application Number
EP 12 19 9773

5

10

15

20

25

30

35

40

45

50

55

DOCUMENTS CONSIDERED TO BE RELEVANT			
Category	Citation of document with indication, where appropriate, of relevant passages	Relevant to claim	CLASSIFICATION OF THE APPLICATION (IPC)
A	GB 1 094 560 A (SANYEI CORP HONG KONG LTD) 13 December 1967 (1967-12-13) * page 1, line 39 - page 2, line 14; figure 1 *	1-6	INV. A63H3/31 A63H3/36
A	GB 196 244 A (BERNHARD HEUMANN; ERNST BAETZ) 21 June 1923 (1923-06-21) * page 1, line 21 - line 35; figure 1 *	1-6	
A	DE 91 14 975 U1 (MUHS, HENRIK) 20 February 1992 (1992-02-20) * page 3, line 16 - page 4, line 26; figures *	1-6	
A	US 2007/184750 A1 (MATHENY KELLY [US] ET AL) 9 August 2007 (2007-08-09) * paragraph [0022] - paragraph [0033]; figures *	1-6	
A	CN 201 832 419 U (QINLE PRODUCTS FACTORY LISONGYIN GONGMING BAOAN SHENZHEN) 18 May 2011 (2011-05-18) * the whole document *	1-6	TECHNICAL FIELDS SEARCHED (IPC) A63H
The present search report has been drawn up for all claims			
Place of search Munich		Date of completion of the search 3 May 2013	Examiner Lucas, Peter
CATEGORY OF CITED DOCUMENTS X : particularly relevant if taken alone Y : particularly relevant if combined with another document of the same category A : technological background O : non-written disclosure P : intermediate document T : theory or principle underlying the invention E : earlier patent document, but published on, or after the filing date D : document cited in the application L : document cited for other reasons & : member of the same patent family, corresponding document			

 1
EPO FORM 1503 03.82 (P04C01)

**ANNEX TO THE EUROPEAN SEARCH REPORT
ON EUROPEAN PATENT APPLICATION NO.**

EP 12 19 9773

5

This annex lists the patent family members relating to the patent documents cited in the above-mentioned European search report.
The members are as contained in the European Patent Office EDP file on
The European Patent Office is in no way liable for these particulars which are merely given for the purpose of information.

03-05-2013

10

Patent document cited in search report		Publication date	Patent family member(s)	Publication date
GB 1094560	A	13-12-1967	NONE	
GB 196244	A	21-06-1923	NONE	
DE 9114975	U1	20-02-1992	NONE	
US 2007184750	A1	09-08-2007	NONE	
CN 201832419	U	18-05-2011	NONE	

15

20

25

30

35

40

45

50

EPO FORM P0459

For more details about this annex : see Official Journal of the European Patent Office, No. 12/82

55

REFERENCES CITED IN THE DESCRIPTION

This list of references cited by the applicant is for the reader's convenience only. It does not form part of the European patent document. Even though great care has been taken in compiling the references, errors or omissions cannot be excluded and the EPO disclaims all liability in this regard.

Patent documents cited in the description

- TW M243261 [0002]