



(12) **EUROPEAN PATENT APPLICATION**

(88) Date of publication A3:  
**29.04.2015 Bulletin 2015/18**

(51) Int Cl.:  
**A63B 22/02 (2006.01) A63B 22/00 (2006.01)**  
**A63B 21/22 (2006.01)**

(43) Date of publication A2:  
**24.12.2014 Bulletin 2014/52**

(21) Application number: **14173756.9**

(22) Date of filing: **27.02.2004**

(84) Designated Contracting States:  
**AT BE BG CH CY CZ DE DK EE ES FI FR GB GR HU IE IT LI LU MC NL PT RO SE SI SK TR**

(30) Priority: **28.02.2003 US 450789 P**  
**28.02.2003 US 451104 P**  
**28.02.2003 US 450890 P**  
**26.02.2004 US 789182**

(62) Document number(s) of the earlier application(s) in accordance with Art. 76 EPC:  
**04715796.1 / 1 601 419**

(71) Applicant: **Nautilus, Inc.**  
**Vancouver, WA 98683 (US)**

(72) Inventors:  
• **Piaget, Gary**  
**Deer Harbor, WA Washington 98243 (US)**  
• **Cristopher, Brent**  
**Denver, CO Colorado 80206 (US)**  
• **Cook, Brian, R.**  
**Washougal, WA Washington 98631 (US)**

- **Crawford, Douglas, A.**  
**Lafayette, CO Colorado 80026 (US)**
- **Flick, Edward, L.**  
**Denver, CO Colorado 80203 (US)**
- **Golesh, Eric, D.**  
**Thornton, CO Colorado 80241 (US)**
- **Monette, Ben**  
**Vancouver, WA Washington 98683 (US)**
- **Potter, Randal**  
**Camas, WA Washington 98607 (US)**
- **Singh, Todd**  
**West Linn, OR Oregon 97068 (US)**
- **Rauwerdink, Matt**  
**Westminster, CO Colorado 80021 (US)**
- **Warner, Patrick, A.**  
**Boulder, CO Colorado 80305 (US)**
- **Smith, Bradley, J.**  
**Tyler, TX Texas 75703 (US)**

(74) Representative: **Miller, James Lionel Woolverton**  
**Kilburn & Strode LLP**  
**20 Red Lion Street**  
**London WC1R 4PJ (GB)**

(54) **Dual deck exercise device**

(57) An exercise device employing side-by-side pivotally supported moving surfaces. In one particular example, an exercise device employs a first belt deployed about a front roller and a rear roller and an adjacent second belt deployed about a front roller and a rear roller. The rear of the belts in the area of the rear rollers are pivotally secured and the front of the belts in the area of the front roller are adapted to reciprocate in an up and down motion during use. In some implementations, the moving surfaces include an interconnection structure such that a generally downward movement of one surface is coordinated with a generally upward movement of the other surface. In other implementations, the moving surfaces are operably associated with one or more resistance elements that effect the amount of force required to pivot or actuate the moving surfaces.

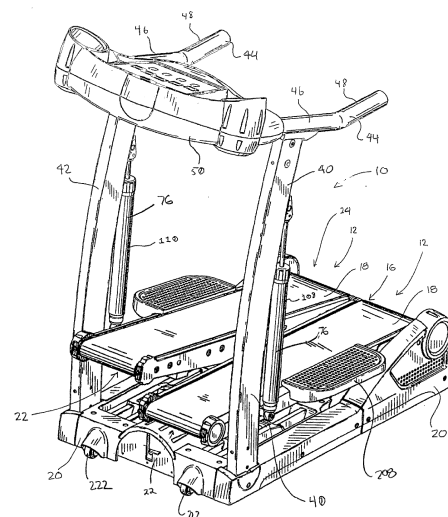

**Fig. 1**



## EUROPEAN SEARCH REPORT

Application Number  
EP 14 17 3756

5

10

15

20

25

30

35

40

45

50

55

DOCUMENTS CONSIDERED TO BE RELEVANT			
Category	Citation of document with indication, where appropriate, of relevant passages	Relevant to claim	CLASSIFICATION OF THE APPLICATION (IPC)
A	FR 2 806 921 A3 (WANG WEI CHEN [TW]) 5 October 2001 (2001-10-05) * page 4, lines 5-34 - page 6, lines 26-34; figures *	1	INV. A63B22/02 A63B22/00 A63B21/22
X	US 6 505 845 B1 (FONG CHIN-LONG [TW]) 14 January 2003 (2003-01-14) * column 2, lines 1-62 - column 3, lines 1-44; figures *	1-4	
X	US 5 336 146 A (PIAGET GARY D [US] ET AL) 9 August 1994 (1994-08-09) * column 2, lines 36-68 - column 3, lines 1-64; figure 1 *	1-5	
Y		6,7	
Y	US 6 132 340 A (WANG LEAO [TW] ET AL) 17 October 2000 (2000-10-17) * column 2, lines 15-27; figures *	6,7	
A	US 5 518 471 A (HETTINGER RONALD K [US] ET AL) 21 May 1996 (1996-05-21) * column 2, lines 61-67; figures 1,2,8 *	1-4	TECHNICAL FIELDS SEARCHED (IPC)
A	US 5 279 528 A (DALEBOUT WILLIAM T [US] ET AL) 18 January 1994 (1994-01-18) * column 4, lines 64-68; figures *	1-4	A63B
A	US 6 461 275 B1 (WANG LEAO [TW] ET AL) 8 October 2002 (2002-10-08) * column 2, lines 26-67 - column 3, lines 1-18; figures *	6,7	
X	US 2001/016542 A1 (YOSHIMURA SHINICHIRO [JP]) 23 August 2001 (2001-08-23) * paragraphs [0029] - [0034]; figures *	1,5,6, 8-12,15	
	-/--		
The present search report has been drawn up for all claims			
Place of search Munich		Date of completion of the search 24 March 2015	Examiner Teissier, Sara
CATEGORY OF CITED DOCUMENTS X : particularly relevant if taken alone Y : particularly relevant if combined with another document of the same category A : technological background O : non-written disclosure P : intermediate document T : theory or principle underlying the invention E : earlier patent document, but published on, or after the filing date D : document cited in the application L : document cited for other reasons & : member of the same patent family, corresponding document			

EPO FORM 1503 03.82 (P04C01)



## EUROPEAN SEARCH REPORT

Application Number  
EP 14 17 3756

5

10

15

20

25

30

35

40

45

50

55

DOCUMENTS CONSIDERED TO BE RELEVANT			
Category	Citation of document with indication, where appropriate, of relevant passages	Relevant to claim	CLASSIFICATION OF THE APPLICATION (IPC)
X A	US 6 461 279 B1 (KUO HAI PIN [TW] ET AL) 8 October 2002 (2002-10-08) * column 2, lines 31-67 - column 3, lines 1-49; figures * -----	1-5,8,9, 14 13	
			TECHNICAL FIELDS SEARCHED (IPC)
The present search report has been drawn up for all claims			
Place of search Munich		Date of completion of the search 24 March 2015	Examiner Teissier, Sara
CATEGORY OF CITED DOCUMENTS X : particularly relevant if taken alone Y : particularly relevant if combined with another document of the same category A : technological background O : non-written disclosure P : intermediate document T : theory or principle underlying the invention E : earlier patent document, but published on, or after the filing date D : document cited in the application L : document cited for other reasons & : member of the same patent family, corresponding document			

EPO FORM 1503 03.82 (P04C01)



Application Number

EP 14 17 3756

**CLAIMS INCURRING FEES**

The present European patent application comprised at the time of filing claims for which payment was due.

☐ Only part of the claims have been paid within the prescribed time limit. The present European search report has been drawn up for those claims for which no payment was due and for those claims for which claims fees have been paid, namely claim(s):

☐ No claims fees have been paid within the prescribed time limit. The present European search report has been drawn up for those claims for which no payment was due.

**LACK OF UNITY OF INVENTION**

The Search Division considers that the present European patent application does not comply with the requirements of unity of invention and relates to several inventions or groups of inventions, namely:

see sheet B

☒ All further search fees have been paid within the fixed time limit. The present European search report has been drawn up for all claims.

☐ As all searchable claims could be searched without effort justifying an additional fee, the Search Division did not invite payment of any additional fee.

☐ Only part of the further search fees have been paid within the fixed time limit. The present European search report has been drawn up for those parts of the European patent application which relate to the inventions in respect of which search fees have been paid, namely claims:

☐ None of the further search fees have been paid within the fixed time limit. The present European search report has been drawn up for those parts of the European patent application which relate to the invention first mentioned in the claims, namely claims:

☐ The present supplementary European search report has been drawn up for those parts of the European patent application which relate to the invention first mentioned in the claims (Rule 164 (1) EPC).



# **LACK OF UNITY OF INVENTION** **SHEET B**

Application Number

EP 14 17 3756

The Search Division considers that the present European patent application does not comply with the requirements of unity of invention and relates to several inventions or groups of inventions, namely:

## 1. claims: 1-7

An exercise device comprising and an adjustment mechanism for adjusting a slope of at least one of the first treadle assembly or the second treadle assembly

---

## 2. claims: 8-12

an exercise device comprising at least one resistance element

---

## 3. claims: 13, 14

an exercise device wherein pivotal movement of the first treadle assembly causes movement of the first foot platform and/or the second foot platform relative to the frame

---

## 4. claim: 15

an exercise apparatus compressing a brake-based dampening assembly

---

**ANNEX TO THE EUROPEAN SEARCH REPORT  
ON EUROPEAN PATENT APPLICATION NO.**

EP 14 17 3756

This annex lists the patent family members relating to the patent documents cited in the above-mentioned European search report. The members are as contained in the European Patent Office EDP file on  
The European Patent Office is in no way liable for these particulars which are merely given for the purpose of information.

24-03-2015

Patent document cited in search report	Publication date	Patent family member(s)	Publication date
FR 2806921 A3	05-10-2001	DE 20005640 U1 FR 2806921 A3	21-06-2000 05-10-2001
US 6505845 B1	14-01-2003	DE 20206816 U1 FR 2839694 A3 GB 2387824 A US 6505845 B1	29-08-2002 21-11-2003 29-10-2003 14-01-2003
US 5336146 A	09-08-1994	AU 675378 B2 AU 1405395 A CA 2178905 A1 DE 69427773 D1 DE 69427773 T2 EP 0746386 A1 ES 2163493 T3 JP H09506796 A US 5336146 A WO 9516502 A1	30-01-1997 03-07-1995 22-06-1995 23-08-2001 29-05-2002 11-12-1996 01-02-2002 08-07-1997 09-08-1994 22-06-1995
US 6132340 A	17-10-2000	NONE	
US 5518471 A	21-05-1996	NONE	
US 5279528 A	18-01-1994	NONE	
US 6461275 B1	08-10-2002	NONE	
US 2001016542 A1	23-08-2001	JP 2001170205 A US 2001016542 A1	26-06-2001 23-08-2001
US 6461279 B1	08-10-2002	US RE42698 E1 US 6461279 B1	13-09-2011 08-10-2002

EPO FORM P0459

For more details about this annex : see Official Journal of the European Patent Office, No. 12/82