



(12) **EUROPEAN PATENT APPLICATION**

(88) Date of publication A3:
09.12.2015 Bulletin 2015/50

(51) Int Cl.:
B25B 21/02 (2006.01)

(43) Date of publication A2:
21.10.2015 Bulletin 2015/43

(21) Application number: **15162794.0**

(22) Date of filing: **08.04.2015**

(84) Designated Contracting States:
**AL AT BE BG CH CY CZ DE DK EE ES FI FR GB
GR HR HU IE IS IT LI LT LU LV MC MK MT NL NO
PL PT RO RS SE SI SK SM TR**
Designated Extension States:
BA ME
Designated Validation States:
MA

- **Taylor, Lucas James**
Philadelphia, PA 19146 (US)
- **McClung, Mark T.**
Andover
New Jersey 07821 (US)
- **Zimmer, Kenneth James**
Freehold
New Jersey 07728 (US)

(30) Priority: **11.04.2014 US 201414251552**

(74) Representative: **Roberts, Peter David**
Marks & Clerk LLP
1 New York Street
Manchester, M1 4HD (GB)

(72) Inventors:
• **Seith, Warren Andrew**
Bethlehem
Pennsylvania 18020 (US)

(54) **ANGLE IMPACT TOOLS**

(57) In at least one illustrative embodiment, an angle impact tool (10) may comprise a handle assembly (12) extending along a first axis and supporting a motor (16), the motor including a shaft (40) configured to rotate about the first axis, and a work attachment (14) coupled to the handle assembly. The work attachment may comprise an impact mechanism (60) including an anvil configured to rotate about a second axis that is non-parallel to the first axis and a hammer configured to rotate about the

second axis to periodically deliver an impact load to the anvil, a gear assembly (58) configured to transfer rotation from the shaft of the motor to the hammer of the impact mechanism, and a housing (46,48) supporting the impact mechanism and the gear assembly. The housing may be partitioned along a first parting plane that is perpendicular to the second axis such that the housing includes first and second housing sections.

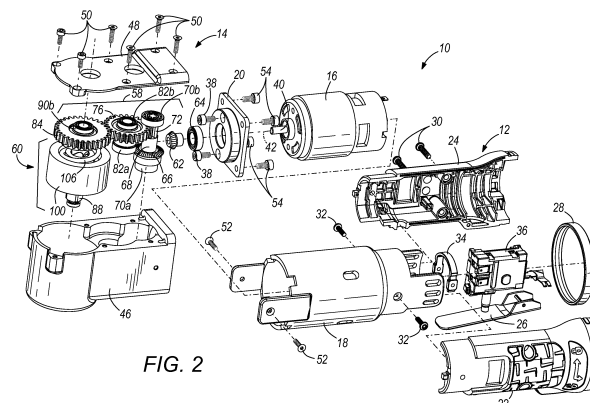

FIG. 2



EUROPEAN SEARCH REPORT

Application Number
EP 15 16 2794

5

10

15

20

25

30

35

40

45

50

55

DOCUMENTS CONSIDERED TO BE RELEVANT			
Category	Citation of document with indication, where appropriate, of relevant passages	Relevant to claim	CLASSIFICATION OF THE APPLICATION (IPC)
X	JP 2013 000869 A (VESSEL FUKUCHIYAMA KK) 7 January 2013 (2013-01-07)	1,3-9, 13,14	INV. B25B21/02
Y	* abstract; figures *	2,6-12, 15	
Y	----- US 2012/118596 A1 (SCOTT JOHN S [US]) 17 May 2012 (2012-05-17) * figures 3,4 *	2	
Y	----- WO 2012/115921 A2 (INGERSOLL RAND CO [US]; SEITH WARREN ANDREW [US]; TAYLOR LUCAS JAMES []) 30 August 2012 (2012-08-30) * figures 1-4,6,7 *	6-12	
Y	----- WO 2007/063106 A1 (RENAULT GEORGES ETS [FR]; LE DU NICOLAS [FR]; LEME JEAN-CLAIR [FR]; AL) 7 June 2007 (2007-06-07) * page 11, lines 11-17; figures 3,4 *	15	
			TECHNICAL FIELDS SEARCHED (IPC)
			B25B B25F
The present search report has been drawn up for all claims			
Place of search Munich		Date of completion of the search 29 October 2015	Examiner Kühn, Thomas
CATEGORY OF CITED DOCUMENTS X : particularly relevant if taken alone Y : particularly relevant if combined with another document of the same category A : technological background O : non-written disclosure P : intermediate document T : theory or principle underlying the invention E : earlier patent document, but published on, or after the filing date D : document cited in the application L : document cited for other reasons & : member of the same patent family, corresponding document			

EPO FORM 1503 03.82 (P04C01)

**ANNEX TO THE EUROPEAN SEARCH REPORT
ON EUROPEAN PATENT APPLICATION NO.**

EP 15 16 2794

This annex lists the patent family members relating to the patent documents cited in the above-mentioned European search report.
The members are as contained in the European Patent Office EDP file on
The European Patent Office is in no way liable for these particulars which are merely given for the purpose of information.

29-10-2015

Patent document cited in search report	Publication date	Patent family member(s)	Publication date
JP 2013000869 A	07-01-2013	JP 5700821 B2	15-04-2015
		JP 2013000869 A	07-01-2013
US 2012118596 A1	17-05-2012	US 2012118596 A1	17-05-2012
		WO 2012068016 A2	24-05-2012
WO 2012115921 A2	30-08-2012	CN 103608149 A	26-02-2014
		EP 2678138 A2	01-01-2014
		US 2012211249 A1	23-08-2012
		US 2014216776 A1	07-08-2014
		US 2015075829 A1	19-03-2015
		WO 2012115921 A2	30-08-2012
WO 2007063106 A1	07-06-2007	EP 1954447 A1	13-08-2008
		FR 2894172 A1	08-06-2007
		JP 5184368 B2	17-04-2013
		JP 2009517234 A	30-04-2009
		US 2010269646 A1	28-10-2010
		WO 2007063106 A1	07-06-2007