



(12) **EUROPEAN PATENT APPLICATION**

(88) Date of publication A3:  
**27.01.2016 Bulletin 2016/04**

(51) Int Cl.:  
**F01L 13/08** <sup>(2006.01)</sup>

(43) Date of publication A2:  
**02.12.2015 Bulletin 2015/49**

(21) Application number: **15163608.1**

(22) Date of filing: **15.04.2015**

(84) Designated Contracting States:  
**AL AT BE BG CH CY CZ DE DK EE ES FI FR GB GR HR HU IE IS IT LI LT LU LV MC MK MT NL NO PL PT RO RS SE SI SK SM TR**  
Designated Extension States:  
**BA ME**  
Designated Validation States:  
**MA**

(72) Inventors:  
• **HASHIMOTO, Hideaki**  
**Iwata-shi, Shizuoka 438-8501 (JP)**  
• **HARA, Chihiro**  
**Iwata-shi, Shizuoka 438-8501 (JP)**

(74) Representative: **Grünecker Patent- und Rechtsanwälte**  
**PartG mbB**  
**Leopoldstraße 4**  
**80802 München (DE)**

(30) Priority: **27.05.2014 JP 2014108986**

(71) Applicant: **Yamaha Hatsudoki Kabushiki Kaisha**  
**Iwata-shi, Shizuoka 438-8501 (JP)**

(54) **ENGINE AND VEHICLE**

(57) A decompression mechanism includes a flange, a pivot pin, a weight, and a decompression cam. The flange is a body separate from the cam shaft and is press-fitted onto the cam shaft. The pivot pin is attached to the flange. The weight is supported on the cam shaft in a

rotatable manner between a closed state and an open state. The decompression cam switches between a state of coming into contact with a valve mechanism and a state of not coming into contact with the valve mechanism in response to the rotation of the weight.

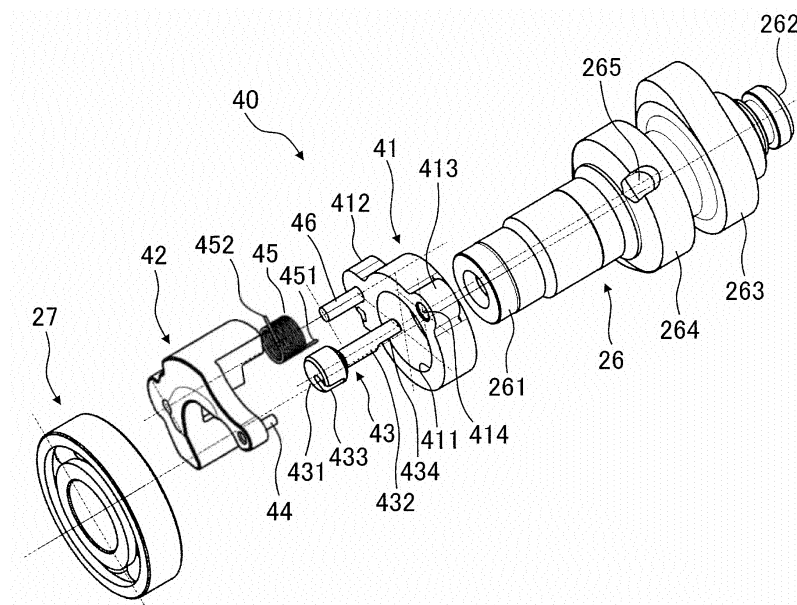

**FIG. 6**



## EUROPEAN SEARCH REPORT

Application Number  
EP 15 16 3608

5

10

15

20

25

30

35

40

45

50

55

DOCUMENTS CONSIDERED TO BE RELEVANT			
Category	Citation of document with indication, where appropriate, of relevant passages	Relevant to claim	CLASSIFICATION OF THE APPLICATION (IPC)
X	EP 1 380 729 A1 (TECUMSEH PRODUCTS CO [US]) 14 January 2004 (2004-01-14) * abstract; figures 5a,6,7 *	1-4,9,10	INV. F01L13/08
A	US 2006/048736 A1 (SUGIURA TOSHIKAZU [JP] ET AL) 9 March 2006 (2006-03-09) * abstract; figures *	1-10	
A	US 2006/225686 A1 (ASANO YUUICHI [JP] ET AL) 12 October 2006 (2006-10-12) * abstract; figures *	1-10	
			TECHNICAL FIELDS SEARCHED (IPC)
			F01L
The present search report has been drawn up for all claims			
Place of search Munich		Date of completion of the search 17 December 2015	Examiner Paulson, Bo
CATEGORY OF CITED DOCUMENTS X : particularly relevant if taken alone Y : particularly relevant if combined with another document of the same category A : technological background O : non-written disclosure P : intermediate document T : theory or principle underlying the invention E : earlier patent document, but published on, or after the filing date D : document cited in the application L : document cited for other reasons & : member of the same patent family, corresponding document			

EPO FORM 1503 03.82 (P04C01)

**ANNEX TO THE EUROPEAN SEARCH REPORT  
ON EUROPEAN PATENT APPLICATION NO.**

EP 15 16 3608

5

This annex lists the patent family members relating to the patent documents cited in the above-mentioned European search report.  
The members are as contained in the European Patent Office EDP file on  
The European Patent Office is in no way liable for these particulars which are merely given for the purpose of information.

17-12-2015

10

Patent document cited in search report	Publication date	Patent family member(s)	Publication date
EP 1380729 A1	14-01-2004	EP 1380729 A1	14-01-2004
		US 2004003791 A1	08-01-2004
-----			
US 2006048736 A1	09-03-2006	JP 4234653 B2	04-03-2009
		JP 2006070831 A	16-03-2006
		US 2006048736 A1	09-03-2006
-----			
US 2006225686 A1	12-10-2006	JP 2006291778 A	26-10-2006
		US 2006225686 A1	12-10-2006
-----			

15

20

25

30

35

40

45

50

55

EPO FORM P0459

For more details about this annex : see Official Journal of the European Patent Office, No. 12/82