



(11)

EP 3 020 864 A3

(12)

EUROPEAN PATENT APPLICATION

(88) Date of publication A3:
28.09.2016 Bulletin 2016/39

(51) Int Cl.:
E01C 19/05 ^(2006.01) **B28D 1/00** ^(2006.01)

(43) Date of publication A2:
18.05.2016 Bulletin 2016/20

(21) Application number: **15178834.6**

(22) Date of filing: **27.06.2013**

(84) Designated Contracting States:
**AL AT BE BG CH CY CZ DE DK EE ES FI FR GB
GR HR HU IE IS IT LI LT LU LV MC MK MT NL NO
PL PT RO RS SE SI SK SM TR**

(30) Priority: **29.06.2012 TR 201207601**

(62) Document number(s) of the earlier application(s) in
accordance with Art. 76 EPC:
13762071.2 / 2 867 413

(71) Applicant: **E-MAK Makine Insaat Ticaret Ve Sanayi
A.S.**
16180 Yunuseli Osmangazi Bursa (TR)

(72) Inventor: **Gencer, Mehmet Nezir**
Bursa (TR)

(54) **A CRUSHING MACHINE**

(57) Crushing machine comprising two converging crushing units (31a, 31b) for pulverizing recycled asphalt layers (RAP), which are desired to be recycled by being removed from the place thereof, in order to transform the RAP into recycled asphalt concrete (RAC).

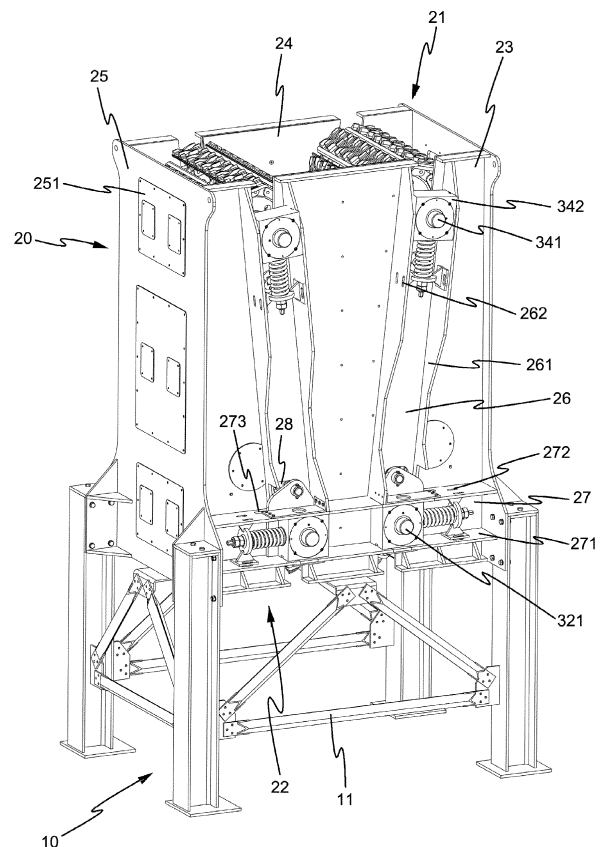

Figure 1



EUROPEAN SEARCH REPORT

 Application Number
 EP 15 17 8834

5

10

15

20

25

30

35

40

45

50

55

DOCUMENTS CONSIDERED TO BE RELEVANT			
Category	Citation of document with indication, where appropriate, of relevant passages	Relevant to claim	CLASSIFICATION OF THE APPLICATION (IPC)
X A	US 2 959 364 A (ANDERSON RICHARD F ET AL) 8 November 1960 (1960-11-08) * column 1, lines 15-54 * * column 2, line 60 - column 5, line 18 * * column 10, lines 17-28 * * figures 1-8 * -----	1,2,4-16 3	INV. E01C19/05 B28D1/00
X A	US 5 713 269 A (MAURER DENNIS [US]) 3 February 1998 (1998-02-03) * column 1, lines 6-10 * * column 2, line 44 - column 3, line 9 * * column 3, line 36 - column 4, line 29 * * figures 2,4 * -----	1 2-15	
X A	US 1 773 476 A (CHAMBERLAIN ELIZABETH G) 19 August 1930 (1930-08-19) * the whole document * -----	1 2-15	
X A	US 1 448 013 A (WARREN JAMES A) 13 March 1923 (1923-03-13) * the whole document * -----	1 2-15	
The present search report has been drawn up for all claims			TECHNICAL FIELDS SEARCHED (IPC) E01C B28D B02C
Place of search Munich		Date of completion of the search 21 July 2016	Examiner Kremsler, Stefan
CATEGORY OF CITED DOCUMENTS X : particularly relevant if taken alone Y : particularly relevant if combined with another document of the same category A : technological background O : non-written disclosure P : intermediate document		T : theory or principle underlying the invention E : earlier patent document, but published on, or after the filing date D : document cited in the application L : document cited for other reasons & : member of the same patent family, corresponding document	

 2
 EPO FORM 1503 03.82 (P04C01)

**ANNEX TO THE EUROPEAN SEARCH REPORT
ON EUROPEAN PATENT APPLICATION NO.**

EP 15 17 8834

5

This annex lists the patent family members relating to the patent documents cited in the above-mentioned European search report. The members are as contained in the European Patent Office EDP file on
The European Patent Office is in no way liable for these particulars which are merely given for the purpose of information.

21-07-2016

10

Patent document cited in search report		Publication date	Patent family member(s)	Publication date
US 2959364	A	08-11-1960	NONE	
US 5713269	A	03-02-1998	NONE	
US 1773476	A	19-08-1930	NONE	
US 1448013	A	13-03-1923	NONE	

15

20

25

30

35

40

45

50

55

EPO FORM P0459

For more details about this annex : see Official Journal of the European Patent Office, No. 12/82