

(19)



(11)

EP 3 048 224 A1

(12)

EUROPEAN PATENT APPLICATION

(43) Date of publication:
27.07.2016 Bulletin 2016/30

(51) Int Cl.:
E05B 19/00 (2006.01)

(21) Application number: **16151533.3**

(22) Date of filing: **15.01.2016**

(84) Designated Contracting States:
AL AT BE BG CH CY CZ DE DK EE ES FI FR GB GR HR HU IE IS IT LI LT LU LV MC MK MT NL NO PL PT RO RS SE SI SK SM TR
Designated Extension States:
BA ME
Designated Validation States:
MA MD

(72) Inventors:
• **Alcelay Bea, Jose**
20305 Irun (Guipuzcoa) (ES)
• **Sanchez Hernandez, Sergio**
20305 Irun (Guipuzcoa) (ES)

(74) Representative: **Gulde & Partner**
Patent- und Rechtsanwaltskanzlei mbB
Wallstraße 58/59
10179 Berlin (DE)

(30) Priority: **22.01.2015 ES 201530058**

(71) Applicant: **Talleres De Escoriaza, S.A.**
20305 Irun (Guipuzcoa) (ES)

(54) KEY OF A LOCK HAVING A COMPATIBLE ACTIVATION LIMIT STOP

(57) Key of a lock having a compatible penetration limit stop, of the type of keys which, on their blade, have a penetration limit stop which determines the position of said blade within the rotor of the cylinder, wherein said penetration limit stop is constituted by lateral wings one

of which projects on either side of the blade in the manner of lateral branches of a "T", and wherein there is a recessed portion between the lateral wings and the handle head of the key.

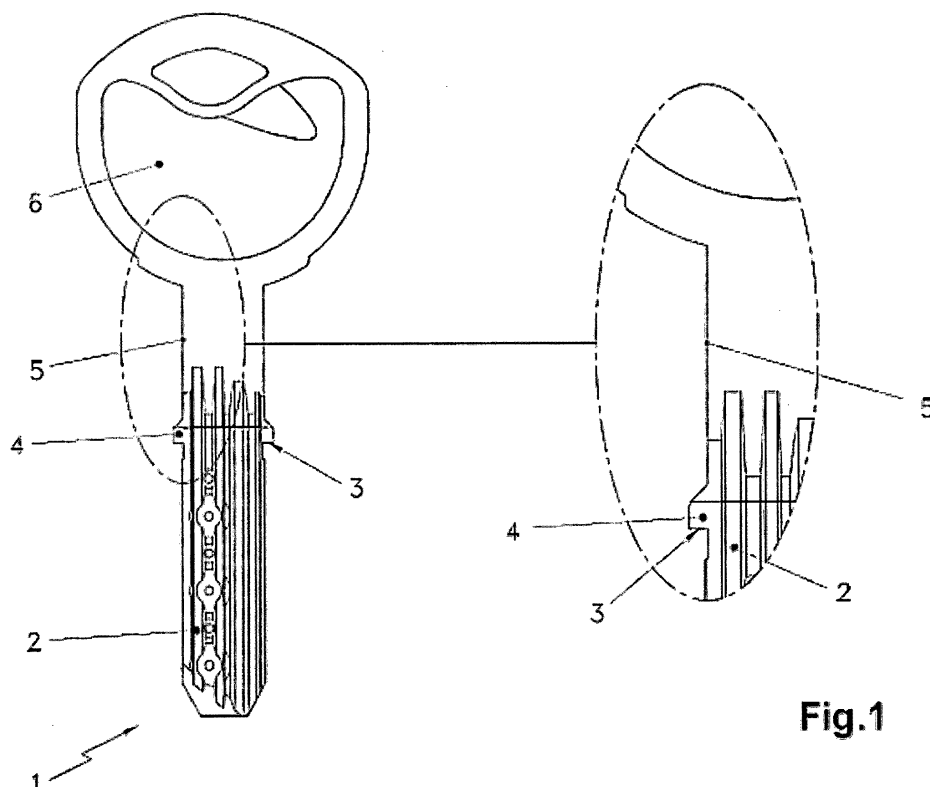

Fig.1

EP 3 048 224 A1

Description

FIELD OF THE INVENTION

[0001] This invention relates to a key of a lock having a compatible penetration limit stop, of the type of keys which, on their blade, have a penetration limit stop which determines the position of said blade within the rotor of the cylinder.

PRIOR ART

[0002] At present and with regard to the state of the art it is common and known to use penetration limit stops in keys in order to correctly fix the position of the key, with the aim of achieving correct engagement with the pins of the cylinder.

[0003] To achieve the aforesaid penetration limit stops, the keys have a larger width in the rear part of their blade than in the front part where the engagement portion is situated, said change in cross-section allowing for the penetration limit stop.

[0004] However, said width in the rear part of the blade prevents its correct use in a lock cylinder with reduced dimensions and/or an off-centre lock cylinder, as there will be a collision between the rear part of the blade and the stator and/or the protective cover of the cylinder.

EXPLANATION OF THE INVENTION AND ADVANTAGES

[0005] In view of this state of affairs, the present invention refers to a key of a lock having a compatible penetration limit stop, of the type of keys which, on their blade, have a penetration limit stop which determines the position of said blade within the rotor of the cylinder, wherein said penetration limit stop is constituted by lateral wings one of which projects on either side of the blade in the manner of lateral branches of a "T", and wherein there is a recessed portion between the lateral wings and the handle head of the key.

[0006] Thanks to this configuration the key can be successfully used in a lock cylinder with reduced dimensions and/or an off-centre lock cylinder, as the actuation limit stop is provided by means of the two wings in the form of a "T" which are present on the key. In this way the rear part of the blade of the key can have a smaller width than the front part of the blade of the key where the engagement holes are situated, allowing rotation of the key without colliding with the protective cover of the cylinder.

[0007] Another feature of the invention is that, on at least one of the sides of the blade, there is a recessed portion between the lateral wings and the handle head of the key.

[0008] Thanks to this configuration keys having only one penetration limit stop can also be successfully used in cylinders with reduced dimensions and/or off-centre cylinders without there being a collision between the rear

part of the blade and the stator and/or the protective cover of the cylinder.

[0009] These and other special features of the invention will be apparent from the detailed explanation below in conjunction with the attached graphic representation.

DRAWINGS AND REFERENCE NUMERALS

[0010] For a better understanding of the nature of the invention, the attached drawings show an industrial embodiment which has the character of a merely illustrative and non-limiting example.

Figure 1 shows a plan view of the key (1) with an enlarged detail of one of the recessed portions (5) which extend from the lateral wings (4) to the handle head (6) of the key (1).

Figure 2 shows a longitudinal sectional view of the key (1) inserted in the cylinder (7).

Figure 3 shows an isometric view of the combined key (1) and cylinder (7), with an enlarged detail of how the key (1) is finally introduced in the cylinder (7). Figure 4 shows a plan view of the combined key (1) and cylinder (7), and a section D-D in front of the lateral wings (4) of the key (1).

1. Key
2. Blade
3. Penetration limit stop
4. Lateral wings
5. Recessed portion
6. Handle head
7. Cylinder
8. Rotor
9. Stator
10. Protective cover

DESCRIPTION OF A PREFERRED EMBODIMENT

[0011] With reference to the drawings and reference numerals listed above, the attached diagrams illustrate a preferred mode of carrying out the subject matter of the invention, which is a key (1) of a lock having a compatible penetration limit stop (3); of the type of keys which, on their blade (2), have a penetration limit stop (3) which determines the position of said blade (2) within the rotor (8) of the cylinder (7), wherein said penetration limit stop (3) is constituted by lateral wings (4) one of which projects on either side of the blade (2) in the manner of lateral branches of a "T", and wherein there is a recessed portion (5) between the lateral wings (4) and the handle head (6) of the key (1).

[0012] As is seen in Figure 2, the lateral wings (4) are received in the space between the stator (9) and the protective cover (10) of the cylinder (7) when the key (1) is introduced in the rotor (8) of the cylinder (7). In this position the penetration limit stop (3) makes contact with the outer surface of the rotor (8). In this way the key (1)

can be used in a lock cylinder (6) with reduced dimensions and/or an off-centre lock cylinder (6), as the actuation limit stop (3) is provided by means of the two lateral wings (4) in the form of a "T" which are present on the key (1).

5

[0013] Another feature of the invention which is seen in Figure 1 is that, on at least one of the sides of the blade (2), there is a recessed portion (5) between the lateral wings (4) and the handle head (6) of the key (1).

[0014] When the key (1) is introduced (1) in the cylinder (7), as is seen in Figure 4, the recessed portion (5) prevents the key (1) from colliding with the cover of the lock during the process of unlocking and locking the lock, as the rear part of the blade (2) of the key (1) has a smaller width than the front part of the blade (2) of the key (1) where the engagement portion is situated.

10

15

[0015] The essence of this invention is not altered by any variation in materials, shape, size and arrangement of the constituent elements, which are described in a non-limiting manner, and this specification is sufficient to enable reproduction of the invention by a person skilled in the art.

20

Claims

25

1. A key (1) of a lock having a compatible penetration limit stop (3), of the type of keys which, on their blade (2), have a penetration limit stop (3) which determines the position of said blade (2) within the rotor (7) of the cylinder (6), **characterized in that** said penetration limit stop (3) is constituted by lateral wings (4) one of which projects on either side of the blade (2) in the manner of lateral branches of a "T", and wherein there is a recessed portion (5) between the lateral wings (4) and the handle head (6) of the key (1).

30

35

2. The key (1) of a lock having a compatible penetration limit stop (3) according to Claim 1, **characterized in that**, on at least one of the sides of the blade (2), there is a recessed portion (5) between the lateral wings (4) and the handle head (6) of the key (1).

40

45

50

55

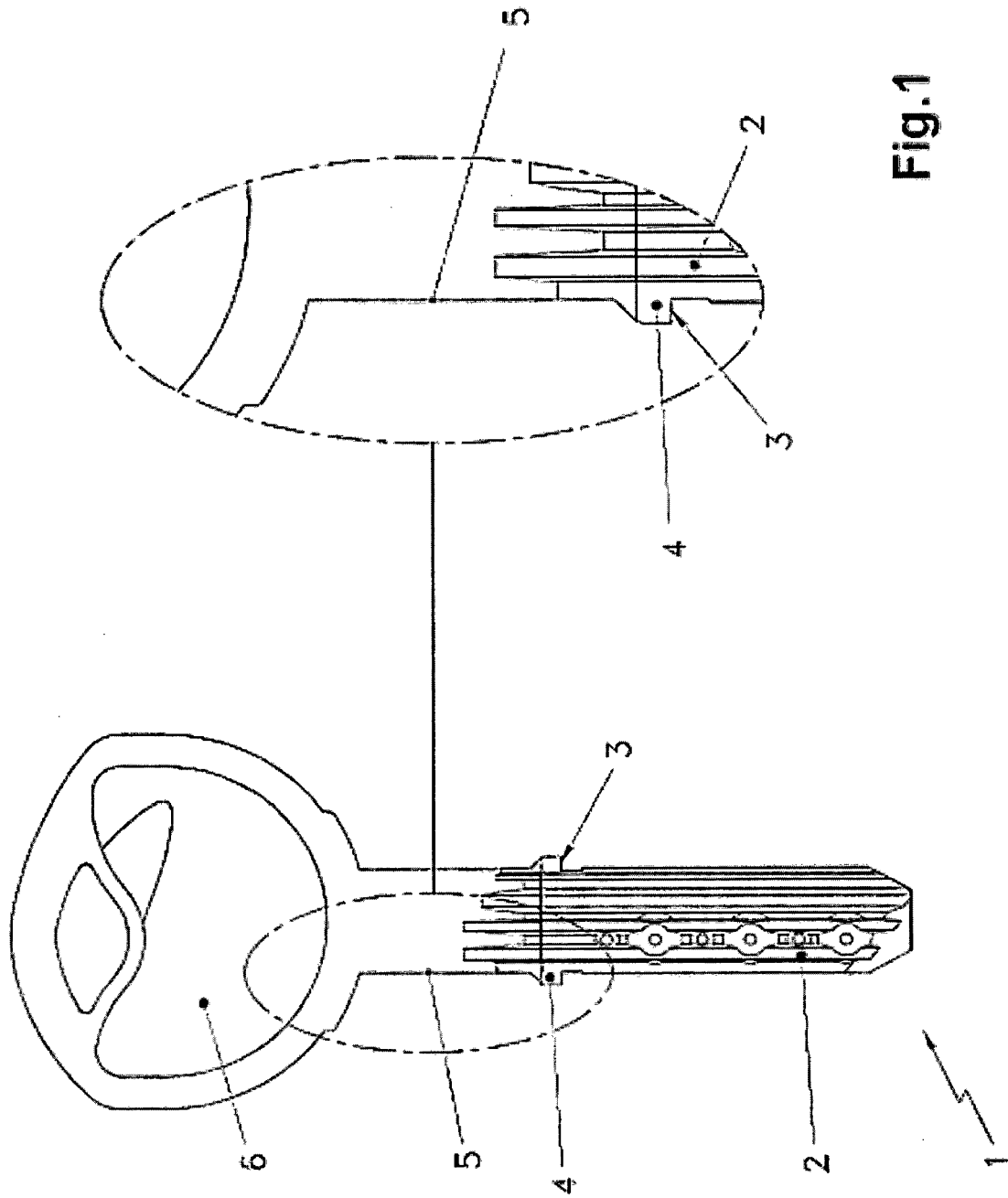

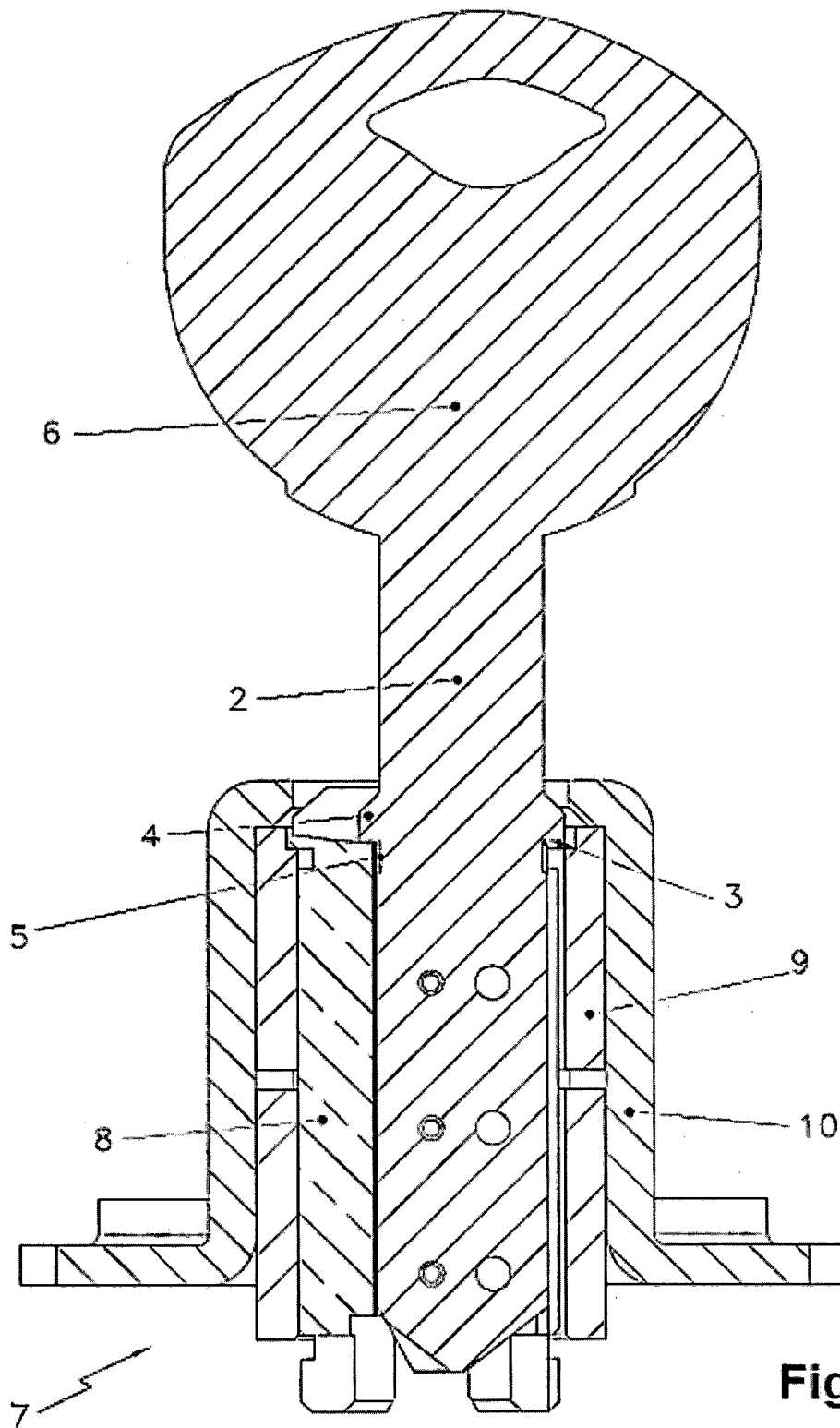

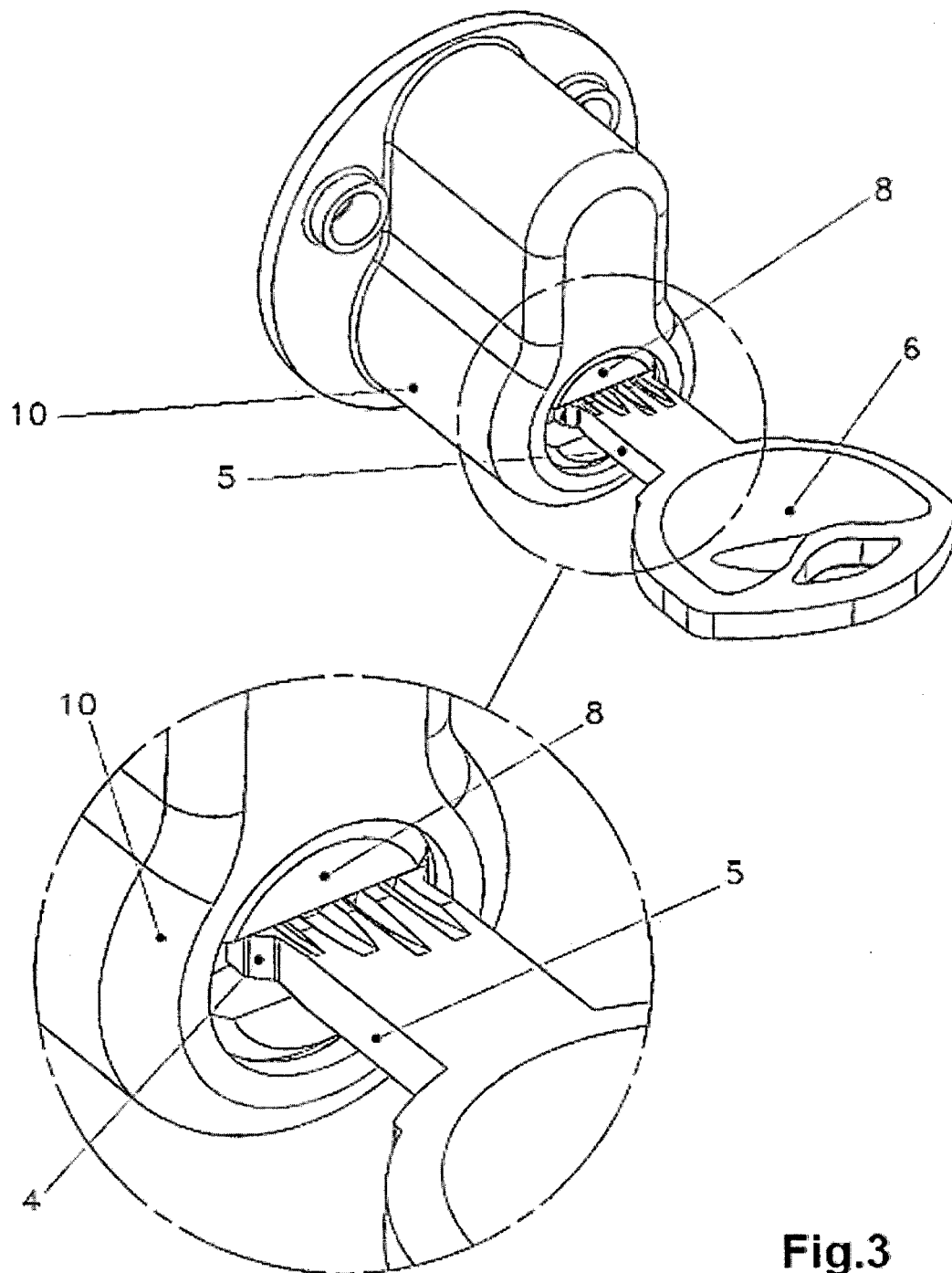

Fig.3

Section D-D

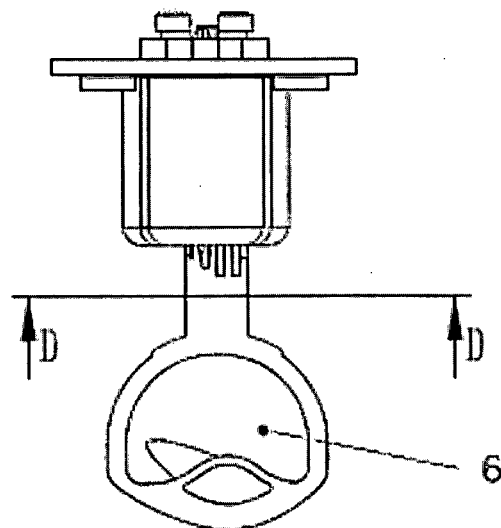
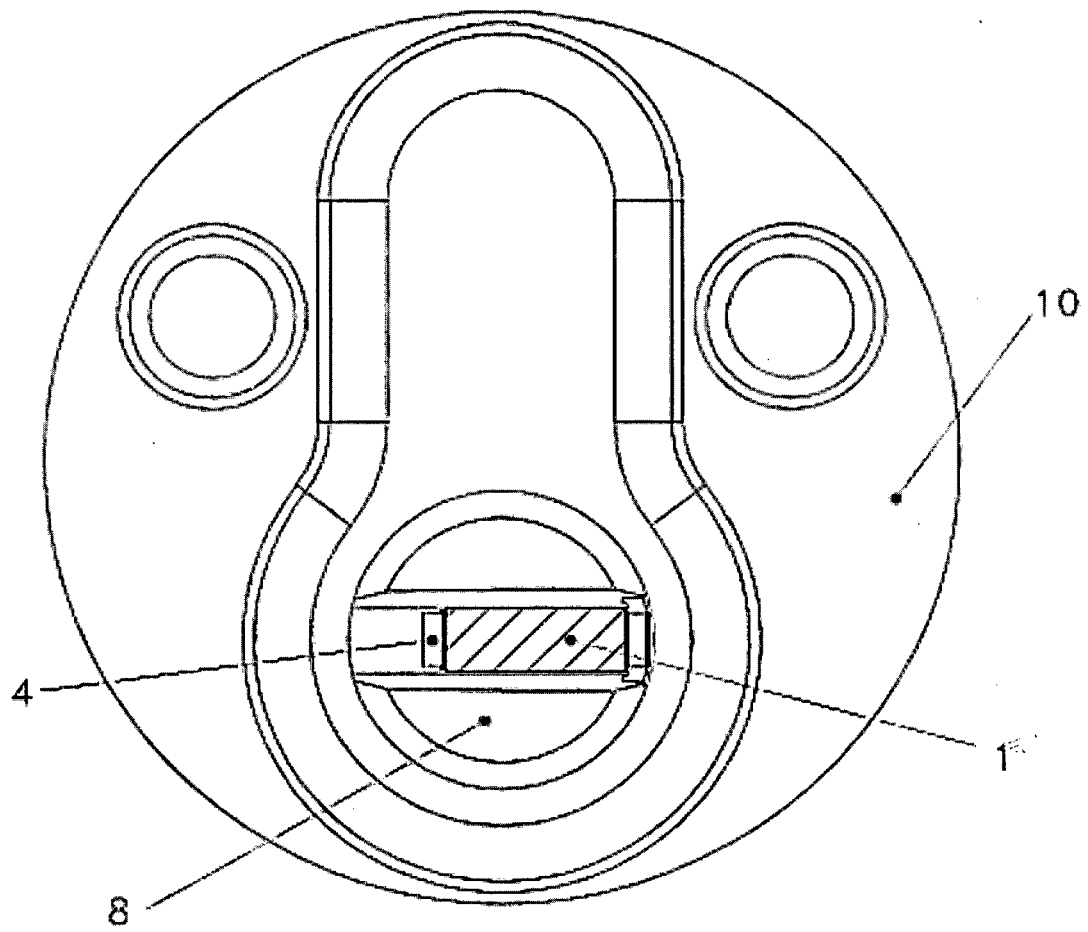

Fig.4



EUROPEAN SEARCH REPORT

Application Number
EP 16 15 1533

5

10

15

20

25

30

35

40

45

50

55

DOCUMENTS CONSIDERED TO BE RELEVANT			
Category	Citation of document with indication, where appropriate, of relevant passages	Relevant to claim	CLASSIFICATION OF THE APPLICATION (IPC)
X	WO 2014/111739 A1 (VALENTE MASSIMO [FR]; MIGLIASSO MARCO [IT]) 24 July 2014 (2014-07-24) * page 4, line 22 - line 27; figures 1,4 * * page 9, line 18 - line 21 *	1,2	INV. E05B19/00
X	WO 98/40589 A1 (RIELDA SRL [IT]) 17 September 1998 (1998-09-17) * page 5, line 31 - line 35; figure 2 *	1,2	
			TECHNICAL FIELDS SEARCHED (IPC)
			E05B
The present search report has been drawn up for all claims			
Place of search The Hague		Date of completion of the search 15 June 2016	Examiner Ansel, Yannick
CATEGORY OF CITED DOCUMENTS X : particularly relevant if taken alone Y : particularly relevant if combined with another document of the same category A : technological background O : non-written disclosure P : intermediate document T : theory or principle underlying the invention E : earlier patent document, but published on, or after the filing date D : document cited in the application L : document cited for other reasons & : member of the same patent family, corresponding document			

 1
EPO FORM 1503 03/02 (P04C01)

**ANNEX TO THE EUROPEAN SEARCH REPORT
ON EUROPEAN PATENT APPLICATION NO.**

EP 16 15 1533

5 This annex lists the patent family members relating to the patent documents cited in the above-mentioned European search report.
The members are as contained in the European Patent Office EDP file on
The European Patent Office is in no way liable for these particulars which are merely given for the purpose of information.

15-06-2016

Patent document cited in search report	Publication date	Patent family member(s)	Publication date
WO 2014111739 A1	24-07-2014	US 2015013404 A1	15-01-2015
		US 2015121977 A1	07-05-2015
		WO 2014111739 A1	24-07-2014
WO 9840589 A1	17-09-1998	AT 242392 T	15-06-2003
		AU 735251 B2	05-07-2001
		BG 63512 B1	29-03-2002
		BR 9804774 A	17-08-1999
		CA 2254400 A1	17-09-1998
		CN 1226947 A	25-08-1999
		CO 4780050 A1	26-05-1999
		CZ 9804070 A3	11-08-1999
		DE 69815234 D1	10-07-2003
		DE 69815234 T2	22-04-2004
		DK 0900310 T3	22-09-2003
		EG 20941 A	30-07-2000
		EP 0900310 A1	10-03-1999
		ES 2200331 T3	01-03-2004
		HK 1019909 A1	27-05-2005
		HR P980128 A2	31-12-1998
		HU 0001502 A2	28-09-2000
		ID 22088 A	02-09-1999
		IL 126794 A	19-03-2001
		IT T0970192 A1	10-09-1998
		JP 4073498 B2	09-04-2008
		JP 2001504188 A	27-03-2001
		KR 20000010576 A	15-02-2000
		MA 24479 A1	01-10-1998
		NO 984990 A	26-10-1998
		NZ 332743 A	29-07-1999
		PL 329721 A1	12-04-1999
		PT 900310 E	31-10-2003
		RU 2184197 C2	27-06-2002
		SK 168698 A3	11-06-1999
		TR 9802283 T1	21-06-1999
		TW 590141 U	01-06-2004
		UA 61909 C2	29-03-2000
		US 6119495 A	19-09-2000
		WO 9840589 A1	17-09-1998
		ZA 9801968 A	10-09-1998

EPO FORM P0459

For more details about this annex : see Official Journal of the European Patent Office, No. 12/82