

(19)



(11)

EP 3 109 195 B1

(12)

EUROPEAN PATENT SPECIFICATION

(45) Date of publication and mention of the grant of the patent:
15.09.2021 Bulletin 2021/37

(51) Int Cl.:
B66B 23/00 (2006.01)

(21) Application number: **15382335.6**

(22) Date of filing: **25.06.2015**

(54) **ESCALATOR/MOVING WALKWAY MODULAR TRUSS AND METHOD OF ASSEMBLING AN ESCALATOR/MOVING WALKWAY MODULAR TRUSS**

MODULARER FAHRTREPPEN-/FAHRSTEIGTRÄGER UND VERFAHREN ZUR MONTAGE EINES MODULAREN FAHRTREPPEN-/FAHRSTEIGTRÄGERS

TREILLIS MODULAIRE D'ESCALATOR/TAPIS ROULANT ET PROCÉDÉ D'ASSEMBLAGE D'UN ESCALATOR/TAPIS ROULANT

(84) Designated Contracting States:
AL AT BE BG CH CY CZ DE DK EE ES FI FR GB GR HR HU IE IS IT LI LT LU LV MC MK MT NL NO PL PT RO RS SE SI SK SM TR

(43) Date of publication of application:
28.12.2016 Bulletin 2016/52

(73) Proprietor: **Thyssenkrupp Elevator Innovation Center, S.A.**
33203 Gijon - Asturias (ES)

(72) Inventors:
 • **GONZÁLEZ PANTIGA, Juan Domingo**
33212 - GIJÓN (Asturias) (ES)

• **MORÁN GARCÍA, Eduardo**
33210 Gijón (ES)

(74) Representative: **Michalski Hüttermann & Partner Patentanwälte mbB**
Speditionstraße 21
40221 Düsseldorf (DE)

(56) References cited:
WO-A1-2011/141945 JP-A- 2009 263 062
US-A1- 2013 228 414

• **None**

EP 3 109 195 B1

Note: Within nine months of the publication of the mention of the grant of the European patent in the European Patent Bulletin, any person may give notice to the European Patent Office of opposition to that patent, in accordance with the Implementing Regulations. Notice of opposition shall not be deemed to have been filed until the opposition fee has been paid. (Art. 99(1) European Patent Convention).

Description

Field of the invention

[0001] The present invention is encompassed within the technical field of escalators and moving walkways, specifically to the truss and structural elements for holding the mechanism of the escalator/moving walkway, and more specifically, to modular structures assembled together to make a whole escalator/moving walkway truss.

[0002] The invention relates, in particular, to an escalator/moving walkway modular truss which is assembled by means of cold joining technology, providing accurate final dimensions, and being able to support and position the whole guiding system and both right and left balustrades of the escalator/moving walkway.

Background of the invention

[0003] Nowadays the escalator and moving walkway truss is intended merely as a structural element with the only aim of holding the mechanisms located inside the escalator or the moving walkway.

[0004] Current escalator and moving walkway modular trusses comprise mainly an upper module, a central module and a lower module, assembled together to form the whole truss. Figure 1 shows an overall view of a current escalator/moving walkway modular truss with those three modules. These modules consist of a plurality of welded steel tubes or hot rolled profiles, which due to bad tolerances and thermal stresses in the manufacturing process made by welding, form a deformed and misaligned truss. These deformations in the welded structure make the following assembly phase of guide supports and guiding system assembly a very time-consuming and expensive process, since due to these deformations and the high number of components, the connection between elements and modules is difficult, and highly qualified operators are required. That is, due to the deformations in the steel during the welding, the final task for each truss assembly is a straightening process of the whole structure in order to maintain the general dimensions into tolerance. This is a very archaic task which depends basically on the expertise of the operators.

[0005] In addition, since the welding process does not ensure accurate truss dimensions, it is not possible to get the same general dimensions in two theoretically identical structures. This means that it is not possible to know exactly the time consumed in assembling each escalator or moving walkway.

[0006] Another problem is that during the welding process a lot of sparks, fumes and noises are generated, creating a bad environment at working place. Also, to take into account, the high energy consumption in the welding process.

[0007] Figures 2a, 2b, 2c and 2d show different views of an assembly process of a truss known in the prior art with all the drawbacks thereof. First, welded structures

provide dimensions out of tolerance due to poor raw materials and archaic manufacturing process. Also, the assembly of guide supports for supporting and positioning the guiding system of the escalator/moving walkway takes several hours due to adjustments required. Additionally, the assembly of the guiding system takes another big amount of time due to a high precision required, since ride quality of the escalator/moving walkway highly depends on this guiding system. Moreover, the assembly of aluminum supports for balustrades is required and it takes several hours due to adjustments required, and additionally, balustrades have to be assembled on the aluminum supports, requiring this operation additional time.

[0008] Document EP2117747 discloses a method for clinching thick metal workpieces and the use of a clinching tool. The invention relates to a method for the production of a load-bearing structural steel connection. A clinching connection is formed by a male die and a female die using local deformation, and it connects two metal workpieces. The metal workpieces are placed on top of each other on a processing surface of the female die and aligned. Then the male die is applied and lowered into the two metal workpieces until the clinching connection is formed by plastic deformation. The die is configured in a rotationally symmetrical manner with regard to the rotational axis thereof and has a conically shaped transitional region tapering at an angle in the lowering direction of the die.

[0009] Document WO2011048437 discloses a truss construction for a passenger conveyor. The invention relates to a truss construction for a passenger conveyor comprising at least one self-supporting element. The self-supporting element, which is a roller molded element, extends in a conveying direction of the passenger conveyor and is formed with at least one rail portion for guiding step chain rollers and/or step rollers.

[0010] Document US2009/0050443 discloses a traveler, moving ramp or escalator for transporting passengers, and it comprises a conveyor mounted on a frame that is supported on a fixed structure. The frame comprises a number of mutually identical profiled metallic bodies joined together end to end one after the other and containing coupling, supporting and/or guide elements integrated in the profiled metallic body of solid material.

[0011] Document US2013/0228414 discloses an escalator or a moving walkway which includes a support structure and a soffit plate. A first side edge region of the soffit plate is fixedly connected with the support structure. In addition, the soffit plate is biased between the first side edge region and a second side edge region, which is opposite the first side edge region, by a predetermined biasing force. In order to maintain the bias the second side edge region is fixedly connected with the support structure, wherein through the maintenance of the biasing force a stiffness of the support structure is increased and in operation of the escalator or the moving walkway the output of noise is reduced.

[0012] Document EP2527283 discloses a support, a module to be placed on the support, and a transport system for displacement of people/goods modernized with the module and a modernization method of transport systems for displacement of people/goods. The support has: fixings to fix the support to a bearing structure of the transport system, horizontal tie plates to support and horizontally place the module, lateral tie plates to support and laterally place the module, longitudinal tie plates to support and longitudinally place the module. The module has positioning and verification equipment to place the module maintaining within tolerances the system lines of the transport system. The transport system has: a support and an entrance/exit/central module on an entrance/exit finished floor/in a central section.

[0013] Document US6685002 shows a method of modernizing an escalator using modular components. The mechanical and electrical parts of an existing escalator are removed, leaving only the structural truss framework and cross members as well as external parts, such as external panels, that interface with the building. A single module is placed at the top of the escalator and another module at the bottom. A plurality of incline modules are placed in the central inclined part of the escalator, at each cross member. By utilizing these modules, the assembly of the escalator is simplified. Furthermore, an entirely new escalator system using the latest technology may be installed rather than merely installing new parts in an old system.

[0014] Document US2002/0175039 discloses a support structure for an escalator, which includes a bottom landing, a top landing, and a rise that interconnects the bottom and top landings. An improved truss design comprised of steel modules that are stamped or bent is used to form the rise, the top landing, and the bottom landing. The modules have closed sides, which increases the strength and stiffness of the truss while also providing the enclosure for internal escalator components. The modules are either formed as a single piece or formed from multiple pieces that are welded or fastened together. The modules are then secured to each other to form the rise, the top landing, and the bottom landing.

[0015] WO 2011/141945 A1 refers to a passenger conveyor which is provided with: a frame body that is disposed in a building structure; platform floors that are provided to both ends in the longitudinal direction of the frame body; a footstep that is endlessly connected between the platform floors so as to circulate/turn; a drive device that drives the footstep; and railings that face right and left in the direction in which the footstep turns, wherein the frame body has a structure in which a plurality of blocks divided in the longitudinal direction are interconnected, and each of the blocks has an upper chord member, a lower chord member, a longitudinal member, and a diagonal member, and in which the longitudinal member and the diagonal member are fastened to the upper chord member and the lower chord member by reamer bolts.

Description of the invention

[0016] The present invention provides an advantage with respect to the current modular trusses for escalators and moving walkways, providing a modular and accurate truss, with both guide supports and balustrades supports integrated, which reduces the number of components and saves time in the escalator or moving walkway assembly line.

[0017] This is achieved by means of an escalator/moving walkway modular truss as disclosed in claim 1 of the present application.

[0018] This truss comprises three independent modules which are joined together in a complex structure. These modules are an upper module, a central module, and a lower module.

[0019] Each module comprises a first side, a second side, which is opposite to the first side, and a soffit plate placed between both sides. Each side of the modules has in turn a lower profile and an upper profile, which according to a preferred embodiment of the invention, are cold rolled profiles.

[0020] Therefore, steel hot rolled profiles or tubes with poor finished and bad dimensional and geometrical tolerances of the prior art are replaced by custom-made cold rolled steel profiles with good tolerances.

[0021] The modules of the escalator/moving walkway have vertical beams placed between the lower profile and the upper profile of each side. Said vertical beams are the vertical guide supports for supporting and positioning the guiding system of the escalator/moving walkway. These vertical guide supports includes a plurality of ledges and/or noses to accurately position the guiding system of the escalator/moving walkway on the truss, in terms of parallelism and perpendicularity, and the specific geometry thereof will depend on the guiding system that will be supported and positioned by said vertical guide supports. So, vertical guide supports are now part of the structure itself, contributing to the overall stiffness of the truss. In addition, these guide supports, manufactured by press forging, stamping or bending steel sheet ensure good tolerances and mechanical properties.

[0022] Additionally, the modules have diagonal beams arranged between the lower profile and the upper profile of each side, and according a particular embodiment of the invention each diagonal beam is placed between two consecutive vertical guide supports of each side.

By means of this configuration, the lower profiles of the modules support directly the outer cladding of the escalator/moving walkway, whereas that the upper profiles of the modules support directly the balustrades and the outer decking profiles of the escalator/moving walkway, since cross sections of these lower and upper profiles have a high moment of inertia, and its behaviour regarding deflection and stresses will be suitable for supporting directly the outer cladding and the balustrades and the outer decking profiles of the escalator/moving walkway respectively. The upper profile has two differentiated

parts. Firstly, the lower part of the upper profile, which is an open part directly connected to vertical and diagonal beams with several protuberances to allow connections and to enhance rigidity of the truss. And secondly, the upper part of the upper profile is wider than the lower part thereof, and it includes a plurality of specific shapes to connect the outer decking profile in the outer side and the glass balustrade in the inner side. Regarding the lower profile, it is uniform and quite similar to the lower part of the upper profile, it is narrow and it includes several protuberances on both sides to allow connections and to enhance rigidity of the truss. So, supports for outer cladding, balustrades and outer decking profiles are also integrated in the structure itself. In order to improve the rigidity and to enhance the structural behaviour of the assembly, the modules of the escalator/moving walkway have a plurality of crossbars between both sides, each crossbar placed between a pair of opposite vertical guide supports, preferably perpendicularly to both sides.

[0023] In accordance with a particular embodiment of the invention, the upper module and the lower module are joined to the central module by means of at least a joining bended plate placed at the ends of said upper and lower modules.

[0024] Another object of the invention is a method of assembling an escalator/moving walkway modular truss as disclosed in claim 7 of the present application.

[0025] The first stage of the method is an assembly of a first side and a second side opposite to the first side, for each one of the three modules of the escalator/moving walkway.

[0026] Then, a soffit plate is placed between both sides of each module, and finally the modules are assembled together.

[0027] According to the object of the present invention, the assembly of each side of the modules includes a cold rolling of a lower profile and an upper profile, and a cold joining of vertical beams, or vertical guide supports between the lower profile and the upper profile, these vertical guide supports for supporting and positioning the guiding system of the escalator/moving walkway. Additionally, the assembly of the sides of the modules includes a cold joining of diagonal beams between the lower profile and the upper profile, and according a particular embodiment of the invention each diagonal beam is arranged between two consecutive vertical guide supports.

[0028] According this method object of the present invention, an outer cladding of the escalator/moving walkway will be attached directly to the lower profiles by cold joining means, and balustrades and outer decking profiles of the escalator/moving walkway will be attached directly to the upper profiles also by cold joining means.

[0029] So, in order to avoid thermal loads generated during the process and therefore deformations in the truss, the assembly between different parts is not made by welding, but by cold joining technologies.

[0030] With this invention, the truss plays an additional role, besides of the structural one, and thanks to its good

dimensional tolerances it is now able to support and position the whole guiding system and both right and left balustrades of the escalator directly over the upper profiles.

5 **[0031]** So, guide supports and balustrade supports adjusting tasks of prior assemblies are removed from the present assembly method, saving intermediate parts and assembling time.

10 **[0032]** Additionally, by using the cold joint technologies, it is possible to get good general dimensions in the trusses, and in addition, sparks, fumes or noises are not generated. Besides, energy consumption is low. Therefore, the assembly method can be considered environmentally friendly.

15 **[0033]** In order to improve the rigidity and to enhance the structural behaviour of the assembly, the method may include a cold joining of a plurality of crossbars between both sides of the modules, placing each crossbar between a pair of opposite vertical guide supports, preferably perpendicularly to both sides.

20 **[0034]** One of the most critical points in the current escalator and moving walkway trusses is the assembly of upper and lower modules to the central one, due to the high amount of heat generated when welding. These thermal loads results in a deformation between different modules that make impossible achieve the required angle of the escalator or the moving walkway.

25 **[0035]** So, in accordance with a particular embodiment of the invention, the assembly of the upper module and the lower module to the central module is made by the cold joining of joining bended plates to the ends of the modules, Preferably the cold joining in this case is clinching. These joining bended plates are conformed specifically according to the escalator requirements. Besides, since the connection between upper module and central module is the most demanded zone of the escalator/moving walkway regarding loads, the method object of the present invention reinforce the area and improve the strength in this transition point, due to the substitution of
30 welding by cold joining technologies. Again, since this joint is made by cold joining technologies instead of welding, an important reduction in the energy consumption is also performed.

35 **[0036]** According to different particular embodiments of the invention, the cold joining includes a method which may be clinching, bolting, riveting, screwing, using adhesives, and any combination of any of them.

40 **[0037]** In addition to all of this, one of the main advantages of the present method over the prior art, is to replace an archaic and obsolete manufacturing process depending on high skilled welders, by a fully automatic process. Most of cold joint technologies can be easily automated ensuring a high degree of repetitiveness instead of the current process, in which it is not possible
45 to achieve the same final result in two theoretically identical escalator or moving walkway trusses.

50 **[0038]** Additionally, this is an environmental friendly and sustainable manufacturing method, and it allows a

reduction in the number of components and in the number of assembly stages that result in a more cost-effective truss for escalators/moving walkways.

Brief description of the drawings

[0039] Next, in order to facilitate the comprehension of the invention, in an illustrative rather than limitative manner an embodiment of the invention with reference to a series of figures shall be made below.

Figure 1 shows an overall and schematic view of an escalator/moving walkway modular truss including an upper module, a central module, and a lower module.

Figures 2a, 2b, 2c and 2d show detailed views of an assembly process of a truss known in the prior art. Figure 3 shows a central module for an escalator/moving walkway modular truss object of the present invention.

Figure 4a shows a schematic view of an upper profile of the direct joining of different structures to the truss of the present invention.

Figure 4b shows a schematic view of a lower profile of the direct joining of different structures to the truss of the present invention.

Figure 5 shows an upper module including joining bended plates according a preferred embodiment of the present invention.

Figure 6 shows the assembly of different elements of the present invention by bolting.

[0040] These figures refer to the following set of elements:

1. upper module of the escalator/moving walkway
2. central module of the escalator/moving walkway
3. lower module of the escalator/moving walkway
4. first side of the modules
5. second side of the modules
6. lower profiles of the modules
7. upper profiles of the modules
8. soffit plate of the modules
9. vertical guide supports of the modules
10. diagonal beams of the modules
11. crossbars of the modules
12. balustrades of the escalator/moving walkway
13. outer decking profiles of the escalator/moving walkway
14. joining bended plates
15. outer cladding.

Detailed description of the invention

[0041] One object of the present invention is an escalator/moving walkway modular truss.

[0042] As shown in the figures, the modular truss has an upper module 1, a central module 2, and a lower mod-

ule 3.

[0043] As it can be seen in figure 3, each module 1,2,3 has a first side 4 and a second side 5 which is opposite to the first side 4, and a soffit plate 8 placed between both sides 4,5. Additionally, each side 4,5 of the modules 1,2,3 comprises in turn a lower profile 6 and an upper profile 7, which preferably are cold roller profiles 6,7. - The modules 1,2,3 of the truss of the present invention have a plurality of vertical beams placed between the lower profile 6 and the upper profile 7 of each side 4,5. These vertical beams are vertical guide supports 9 configured for supporting and positioning the guiding system of the escalator/moving walkway. Also, the modules 1,2,3 have a plurality of diagonal beams 10 between the lower profile 6 and the upper profile 7 of each side 4,5. According a particular embodiment of the invention, each diagonal beam 10 is placed between two consecutive vertical guide supports 9 of each side 4,5.

[0044] According to this invention, the lower profiles 6 are a direct support for an outer cladding 15 of the escalator/moving walkway, and the upper profiles 7 are a direct support for balustrades 12 and outer decking profiles 13 of the escalator/moving walkway. Figure 4b shows a schematic view of the direct union of an outer cladding 15 of the escalator/moving walkway to the lower profile 6, and figure 4a shows the direct union of balustrades 12 and outer decking profiles 13 to the upper profile 7

[0045] Each module 1,2,3 has a plurality of crossbars 11 between both sides 4,5, and each crossbar 11 is placed between a pair of opposite vertical guide supports 9, preferably perpendicularly to both sides 4,5. These crossbars 11 improve the rigidity of the assembly, enhancing the structural behaviour of the modular truss.

[0046] According a particular embodiment of the invention, the upper module 1 and the lower module 3 are joined to the central module 2 by means of at least a joining bended plate 14 which is placed at the ends of said upper 1 and lower 2 modules. Preferably the truss has a joining bended plate 14 placed at the end of each side 4,5 of the upper module 1 and the lower module 3. These joining bended plates 14 have the same height as the sides 4,5, and are arranged between the lower profile 6 and the upper profile 7. Figure 5 shows an upper module including these joining bended plates 14 according this preferred embodiment.

[0047] Another object of the present invention is a method of assembling an escalator/moving walkway modular truss formed by an upper module 1, a central module 2, and a lower module 3.

[0048] The method includes an assembly of a first side 4 and a second side 5 opposite to the first side 4 for each module 1,2,3, and attaching a soffit plate 8 between both sides 4,5 of each module 1,2,3, specifically between opposite lower profiles 6. Later, the three modules 1,2,3 are assembled together.

[0049] According to the method of the present invention, the assembly of each side 4,5 of the modules includes first a cold rolling of a lower profile 6 and an upper

profile 7, and then a cold joining of a plurality of vertical guide supports 9 between the lower profile 6 and the upper profile 7, said vertical guide supports 9 intended for supporting and positioning the guiding system of the escalator/moving walkway. Also, the assembly includes a cold joining of a plurality of diagonal beams 10 between the lower profile 6 and the upper profile 7, and according to a particular embodiment of the invention, each diagonal beam 10 is arranged between two consecutive vertical guide supports 9.

[0050] The method includes a cold joining of a plurality of crossbars 11 between both sides 4,5 of the modules 1,2,3. Each crossbar 11 is placed between a pair of opposite vertical guide supports 9, preferably perpendicularly to both sides 4,5 of the modules 1,2,3.

[0051] In accordance to a particular embodiment of the method of the present invention, the assembly of the upper module 1 and the lower module 3 to the central module 2 is made by a cold joining of bended plates 14 to the ends of the modules.

[0052] According to different particular embodiments of the invention, the cold joining of the different elements of the assembly includes a method which may be selected between clinching, bolting, riveting, screwing, using adhesives, and a combination of these methods. Figure 6 shows particularly the assembly of different elements of the invention by bolting.

Claims

1. Escalator/moving walkway modular truss comprising an upper module (1), a central module (2), and a lower module (3), each module (1,2,3) comprising
 - a first side (4) and a second side (5) opposite to the first side (4), each side (4,5) of the modules (1,2,3) comprising in turn a lower profile (6) and an upper profile (7), and
 - a soffit plate (8) placed between both sides (4,5),
 - wherein the modules (1,2,3) comprise
 - a plurality of vertical beams placed between the lower profile (6) and the upper profile (7) of each side (4,5), said vertical beams being vertical guide supports (9) configured for supporting and positioning the guiding system of the escalator/moving walkway,
 - a plurality of diagonal beams (10) between the lower profile (6) and the upper profile (7) of each side (4,5),
 - and a plurality of crossbars (11) between both sides (4,5), each crossbar (11) placed between a pair of opposite vertical guide supports (9),

- wherein the lower profiles (6) are a direct support for an outer cladding (15) of the escalator/moving walkway,

CHARACTERIZED IN THAT

- each of the lower profiles (6) includes several protuberances on both sides to allow connections,
 - wherein the upper profiles (7) are a direct support for balustrades (12) and outer decking profiles (13) of the escalator/moving walkway,
 - each of the upper profiles (7) has two differentiated parts, which are an upper part and a lower part,
 - wherein the upper part is wider than the lower part,
 - wherein the lower part is an open part being directly connected to the vertical beams and the diagonal beams (10) with several protuberances to allow connections, and
 - wherein the upper part includes a plurality of shapes to connect the outer decking profile (13) in an outer side and the balustrade (12) in an inner side.
2. Escalator/moving walkway modular truss, according to claim 1, **characterized in that** the lower profiles (6) and the upper profiles (7) are cold rolled profiles.
 3. Escalator/moving walkway modular truss, according to any of claims 1-2, **characterized in that** it comprises at least one joining bended plate (14) placed at the ends of the upper module (1) and the lower module (3) configured for joining them to the central module (2).
 4. Escalator/moving walkway modular truss, according to claim 3, **characterized in that** each of said joining bended plates (14) is placed at the end of each side (4,5) of the upper module (1) and the lower module (3), said joining bended plates (14) having the same height as the sides (4,5), and being arranged between the lower profile (6) and the upper profile (7).
 5. Escalator/moving walkway modular truss, according to any of claims 1-4, **characterized in that** each diagonal beam (10) is placed between two consecutive vertical guide supports (9) of each side (4,5).
 6. Escalator/moving walkway, **characterized in that** it comprises an escalator/moving walkway modular truss according to any of claims 1-5.
 7. Method of assembling an escalator/moving walkway modular truss according to claim 1, the method comprising

- assembling of a first side (4) and a second side (5) opposite to the first side (4) for each module (1,2,3),
- joining a soffit plate (8) between both sides (4,5) of each module (1,2,3),
- and assembling of the modules (1,2,3),

said method **characterized in that** the assembling of each side (4,5) comprises

- cold rolling of a lower profile (6),
- cold rolling of an upper profile (7),
- cold joining of vertical guide supports (9) between the lower profile (6) and the upper profile (7), for supporting and positioning the guiding system of the escalator/moving walkway,
- cold joining of diagonal beams (10) between the lower profile (6) and the upper profile (7),
- and cold joining of a plurality of crossbars (11) between both sides (4,5) of the modules (1,2,3), each crossbar (11) placed between a pair of opposite vertical guide supports (9),
- wherein the lower profiles (6) are a direct support for an outer cladding (15) of the escalator/moving walkway,
- wherein each of the lower profiles (6) includes several protuberances on both sides,
- wherein the upper profiles (7) are a direct support for balustrades (12) and outer decking profiles (13) of the escalator/moving walkway,
- wherein each of the upper profiles (7) has two differentiated parts, which are an upper part and a lower part,
- wherein the upper part is wider than the lower part,
- wherein the lower part is an open part being directly connected to the vertical beams and the diagonal beams (10) with several protuberances, and
- wherein the upper part includes a plurality of shapes to connect the outer decking profile (13) in an outer side and the balustrade (12) in an inner side.

8. Method of assembling an escalator/moving walkway modular truss, according to claim 7, **characterized in that** the assembly of the upper module (1) and the lower module (3) with the central module (2) is made by the cold joining of joining bended plates (14) to the ends of said modules (1,2,3).

9. Method of assembling an escalator/moving walkway modular truss, according to any of claims 7-8, **characterized in that** the cold joining comprises a method selected between clinching, bolting, riveting, screwing using adhesives, and a combination of them.

10. Method of assembling an escalator/moving walkway modular truss, according to any of claims 7-9, **characterized in** the cold joining of each diagonal beam (10) between two consecutive vertical guide supports (9).

Patentansprüche

1. Modulare Rolltreppen/Fahrsteig-Tragestruktur mit einem oberen Modul (1), einem mittleren Modul (2) und einem unteren Modul (3), wobei jedes Modul (1, 2, 3) aufweist:

eine erste Seite (4) und eine der ersten Seite (4) gegenüberliegende zweite Seite (5), wobei jede Seite (4, 5) der Module (1, 2, 3) ihrerseits ein unteres Profil (6) und ein oberes Profil (7) aufweist, und

eine zwischen den beiden Seiten (4, 5) angeordnete Laibungsplatte (8), wobei die Module (1, 2, 3) aufweisen:

mehrere Vertikalträger, die zwischen dem unteren Profil (6) und dem oberen Profil (7) jeder Seite (4, 5) angeordnet sind, wobei die Vertikalträger vertikale Führungsstützen (9) sind, die dafür konfiguriert sind, das Führungssystem der Rolltreppe/des Fahrsteigs zu tragen und zu positionieren; mehrere Diagonälträger (10) zwischen dem unteren Profil (6) und dem oberen Profil (7) jeder Seite (4, 5); und mehrere Querträger (11) zwischen beiden Seiten (4, 5), wobei jeder Querträger (11) zwischen einem Paar von gegenüberliegenden vertikalen Führungsstützen (9) angeordnet ist,

wobei die unteren Profile (6) eine direkte Halterung für eine äußere Verkleidung (15) der Rolltreppe/des Fahrsteigs sind,

dadurch gekennzeichnet, dass

jedes der unteren Profile (6) auf beiden Seiten mehrere Vorsprünge zum Ermöglichen von Verbindungen aufweist,

wobei die oberen Profile (7) eine direkte Halterung für Balustraden (12) und Außenverkleidungsprofile (13) der Fahrtreppe/des Fahrsteigs sind,

jedes der oberen Profile (7) zwei unterschiedliche Teile aufweist, die ein oberer Teil und ein unterer Teil sind,

wobei der obere Teil breiter ist als der untere Teil,

wobei der untere Teil ein offener Teil mit mehreren Vorsprüngen zum Ermöglichen von Verbindungen ist, der direkt mit den Vertikalträgern

- und mit den Diagonalträgern (10) verbunden ist, und
wobei der obere Teil mehrere Formen zum Verbinden des Außenverkleidungsprofils (13) mit einer Außenseite und der Balustrade (12) mit einer Innenseite aufweist. 5
2. Modulare Rolltreppen-/Fahrsteig-Tragestruktur nach Anspruch 1, **dadurch gekennzeichnet, dass** die unteren Profile (6) und die oberen Profile (7) kaltgewalzte Profile sind. 10
3. Modulare Rolltreppen-/Fahrsteig-Tragestruktur nach einem der Ansprüche 1 bis 2, **dadurch gekennzeichnet, dass** sie mindestens eine gebogene Verbindungsplatte (14) aufweist, die an den Enden des oberen Moduls (1) und des unteren Moduls (3) angeordnet und dafür konfiguriert ist, diese mit dem mittleren Modul (2) zu verbinden. 15
4. Modulare Rolltreppen-/Fahrsteig-Tragestruktur nach Anspruch 3, **dadurch gekennzeichnet, dass** jede der gebogenen Verbindungsplatten (14) am Ende jeder Seite (4, 5) des oberen Moduls (1) und des unteren Moduls (3) angeordnet ist, wobei die gebogenen Verbindungsplatten (14) die gleiche Höhe wie die Seiten (4, 5) haben und zwischen dem unteren Profil (6) und dem oberen Profil (7) angeordnet sind. 20
5. Modulare Rolltreppen-/Fahrsteig-Tragestruktur nach einem der Ansprüche 1 bis 4, **dadurch gekennzeichnet, dass** jeder Diagonalträger (10) zwischen zwei aufeinanderfolgenden vertikalen Führungsstützen (9) jeder Seite (4, 5) angeordnet ist. 25
6. Fahrtreppe/Fahrsteig, **dadurch gekennzeichnet, dass** sie/er eine modulare Rolltreppen-/Fahrsteig-Tragestruktur nach einem der Ansprüche 1 bis 5 aufweist. 30
7. Verfahren zum Montieren einer modularen Rolltreppen-/Fahrsteig-Tragestruktur nach Anspruch 1, wobei das Verfahren die Schritte aufweist:
Montieren einer ersten Seite (4) und einer der ersten Seite (4) gegenüberliegenden zweiten Seite (5) für jedes Modul (1, 2, 3);
Verbinden einer Laibungsplatte (8) zwischen beiden Seiten (4, 5) jedes Moduls (1, 2, 3); und
Montieren der Module (1, 2, 3), wobei das Verfahren **dadurch gekennzeichnet ist, dass** das Montieren jeder Seite (4, 5) aufweist:
Kaltwalzen eines unteren Profils (6);
Kaltwalzen eines oberen Profils (7);
Kaltverbinden vertikaler Führungsstützen (9) zwischen dem unteren Profil (6) und dem 35
- oberen Profil (7) zum Tragen und Positionieren des Führungssystems der Rolltreppe/des Fahrsteigs;
Kaltfügen von Diagonalträgern (10) zwischen dem unteren Profil (6) und dem oberen Profil (7); und
Kaltfügen mehrerer Querträger (11) zwischen beiden Seiten (4, 5) der Module (1, 2, 3), wobei jeder Querträger (11) zwischen einem Paar von gegenüberliegenden vertikalen Führungsstützen (9) angeordnet ist, wobei die unteren Profile (6) eine direkte Halterung für eine Außenverkleidung (15) der Rolltreppe/des Fahrsteigs sind, wobei jedes der unteren Profile (6) mehrere Vorsprünge auf beiden Seiten aufweist, wobei die oberen Profile (7) eine direkte Halterung für Balustraden (12) und Außenverkleidungsprofile (13) der Fahrtreppe/des Fahrsteigs sind, wobei jedes der oberen Profile (7) zwei unterschiedliche Teile aufweist, die ein oberer Teil und ein unterer Teil sind, wobei der obere Teil breiter ist als der untere Teil, wobei der untere Teil ein offener Teil mit mehreren Vorsprüngen ist, der direkt mit den Vertikalträgern und den Diagonalträgern (10) verbunden ist, und wobei der obere Teil mehrere Formen zum Verbinden des Außenverkleidungsprofils (13) mit einer Außenseite und der Balustrade (12) mit einer Innenseite aufweist. 40
8. Verfahren nach Anspruch 7, **dadurch gekennzeichnet, dass** das Montieren des oberen Moduls (1) und des unteren Moduls (3) am mittleren Modul (2) durch Kaltfügen von gebogenen Platten (14) an den Enden der Module (1, 2, 3) erfolgt. 45
9. Verfahren nach einem der Ansprüche 7 bis 8, **dadurch gekennzeichnet, dass** das Kaltfügen ein Verfahren aufweist, das unter Clinchen, Verschrauben, Nieten, Verschrauben unter Verwendung von Klebstoffen und einer Kombination davon ausgewählt ist. 50
10. Verfahren nach einem der Ansprüche 7 bis 9, **dadurch gekennzeichnet, dass** das Kaltfügen jedes Diagonalträgers (10) zwischen zwei aufeinanderfolgenden vertikalen Führungsstützen (9) erfolgt. 55
- Revendications**
1. Treillis modulaire d'escalator/de tapis roulant comportant un module haut (1), un module central (2) et

un module bas (3), chaque module (1, 2, 3) comportant

- un premier côté (4) et un deuxième côté (5) opposé au premier côté (4), chaque côté (4, 5) des modules (1, 2, 3) comportant réciproquement un profilé bas (6) et un profilé haut (7), et
- une plaque de fond (8) placée entre les deux côtés (4,5),
- les modules (1, 2, 3) comportant

- une pluralité de poutres verticales placées entre le profilé bas (6) et le profilé haut (7) de chaque côté (4, 5), lesdites poutres verticales étant des supports de guidage verticaux (9) configurés pour supporter et positionner le système de guidage de l'escalator/du tapis roulant,

- une pluralité de poutres diagonales (10) entre le profilé bas (6) et le profilé haut (7) de chaque côté (4, 5),

- et une pluralité de barres transversales (11) entre les deux côtés (4, 5), chaque barre transversale (11) étant placée entre une paire de supports de guidage verticaux (9) opposés,

- les profilés bas (6) étant un support direct pour une enveloppe extérieure (15) de l'escalator/du tapis roulant,

CARACTÉRISÉ EN CE QUE

- chaque profilé bas (6) comporte plusieurs protubérances sur les deux côtés pour permettre des liaisons,

- les profilés hauts (7) étant un support direct pour des balustrades (12) et des profilés de recouvrement extérieurs (13) de l'escalator/du tapis roulant,

- chaque profilé haut (7) a deux parties différenciées qui sont une partie haute et une partie basse,

- la partie haute étant plus large que la partie basse,

- la partie basse étant une partie ouverte directement reliée aux poutres verticales et aux poutres diagonales (10) par plusieurs protubérances permettant des liaisons, et

- la partie haute comportant une pluralité de formes pour relier le profilé de recouvrement extérieur (13) sur un côté extérieur et la balustrade (12) sur un côté intérieur.

2. Treillis modulaire d'escalator/de tapis roulant selon la revendication 1, **caractérisée en ce que** les profilés bas (6) et les profilés hauts (7) sont des profilés laminés à froid.

3. Treillis modulaire d'escalator/de tapis roulant selon l'une quelconque des revendications 1 à 2, **caractérisée en ce qu'**il comporte au moins une plaque cintrée de jonction (14) placée aux extrémités du module haut (1) et du module bas (3) et configurée pour les joindre au module central (2).

4. Treillis modulaire d'escalator/de tapis roulant selon la revendication 3, **caractérisée en ce que** chacune desdites plaques cintrées de jonction (14) est placée à l'extrémité de chaque côté (4, 5) du module haut (1) et du module bas (3), lesdites plaques cintrées de jonction (14) ayant la même hauteur que les côtés (4, 5) et étant disposées entre le profilé bas (6) et le profilé haut (7).

5. Treillis modulaire d'escalator/de tapis roulant selon l'une quelconque des revendications 1 à 4, **caractérisée en ce que** chaque poutre diagonale (10) est placée entre deux supports de guidage verticaux (9) consécutifs de chaque côté (4, 5).

6. Escalator/tapis roulant, **caractérisée en ce qu'**il comporte un treillis modulaire d'escalator/de tapis roulant selon l'une quelconque des revendications 1 à 5.

7. Procédé d'assemblage d'un treillis modulaire d'escalator roulant/de tapis roulant selon la revendication 1, le procédé comportant les étapes suivantes :

- assemblage d'un premier côté (4) et d'un deuxième côté (5) opposé au premier côté (4) pour chaque module (1, 2, 3),

- jonction d'une plaque de fond (8) entre les deux côtés (4, 5) de chaque module (1, 2, 3),

- et assemblage ses modules (1,2,3),

ledit procédé étant **caractérisé en ce que** l'assemblage de chaque côté (4, 5) comporte:

- laminage à froid d'un profilé bas (6),

- laminage à froid d'un profilé haut (7),

- jonction à froid de supports de guidage verticaux (9) entre le profilé bas (6) et le profilé haut (7) pour supporter et positionner le système de guidage de l'escalator/du tapis roulant,

- jonction à froid de poutres diagonales (10) entre le profilé bas (6) et le profilé haut (7),

- et jonction à froid d'une pluralité de barres transversales (11) entre les deux côtés (4, 5) des modules (1, 2, 3), chaque barre transversale (11) étant placée entre une paire de supports de guidage verticaux (9) opposés,

- les profilés bas (6) étant un support direct pour une enveloppe extérieure (15) de l'escalator/du tapis roulant,

- chaque profilé bas (6) comportant plusieurs

- protubérances sur les deux côtés,
- les profilés hauts (7) étant un support direct pour des balustrades (12) et des profilés de recouvrement extérieurs (13) de l'escalator/du tapis roulant, 5
 - chaque profilé haut (7) ayant deux parties différenciées qui sont une partie haute et une partie basse,
 - la partie haute étant plus large que la partie basse, 10
 - la partie basse étant une partie ouverte directement reliée aux poutres verticales et aux poutres diagonales (10) par plusieurs protubérances, et
 - la partie haute comportant une pluralité de formes pour relier le profilé de recouvrement extérieur (13) sur un côté extérieur et la balustrade (12) sur un côté intérieur. 15
8. Procédé d'assemblage d'un treillis modulaire d'escalator roulant/de tapis roulant selon la revendication 7, **caractérisé en ce que** l'assemblage du module haut (1) et du module bas (3) avec le module central (2) est réalisé par la jonction à froid de plaques cintrées de jonction (14) aux extrémités desdits modules (1, 2, 3). 20 25
9. Procédé d'assemblage d'un treillis modulaire d'escalator roulant/de tapis roulant selon l'une quelconque des revendications 7 à 8, **caractérisé en ce que** la jonction à froid comporte un procédé choisi parmi le clinchage, le boulonnage, le rivetage, le vissage en utilisant des adhésifs et une combinaison de ceux-ci. 30 35
10. Procédé d'assemblage d'un treillis modulaire d'escalator roulant/de tapis roulant selon l'une quelconque des revendications 7 à 9, **caractérisé par** la jonction à froid de chaque poutre diagonale (10) entre deux supports de guidage verticaux (9) consécutifs. 40 45 50 55

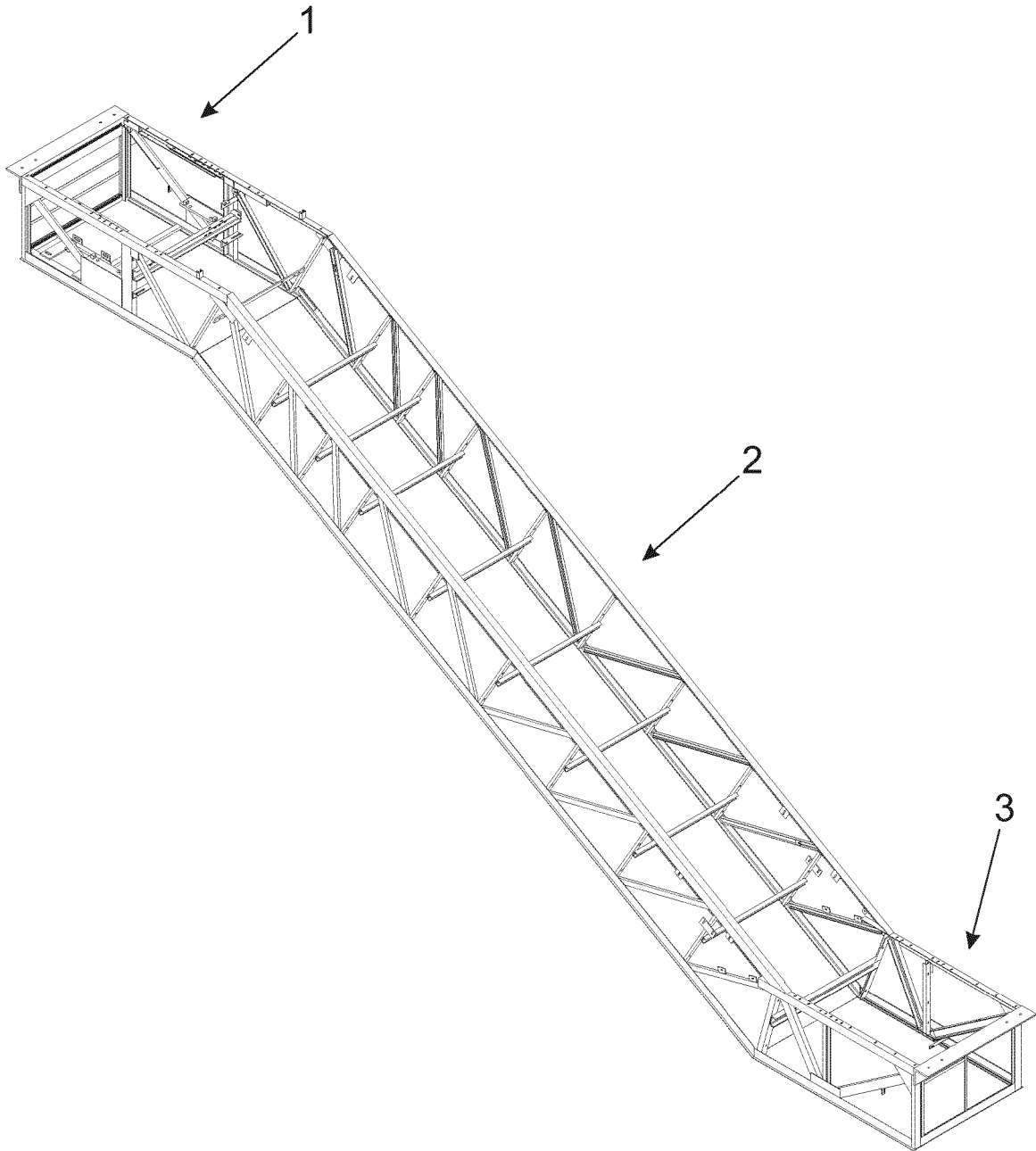

Fig. 1

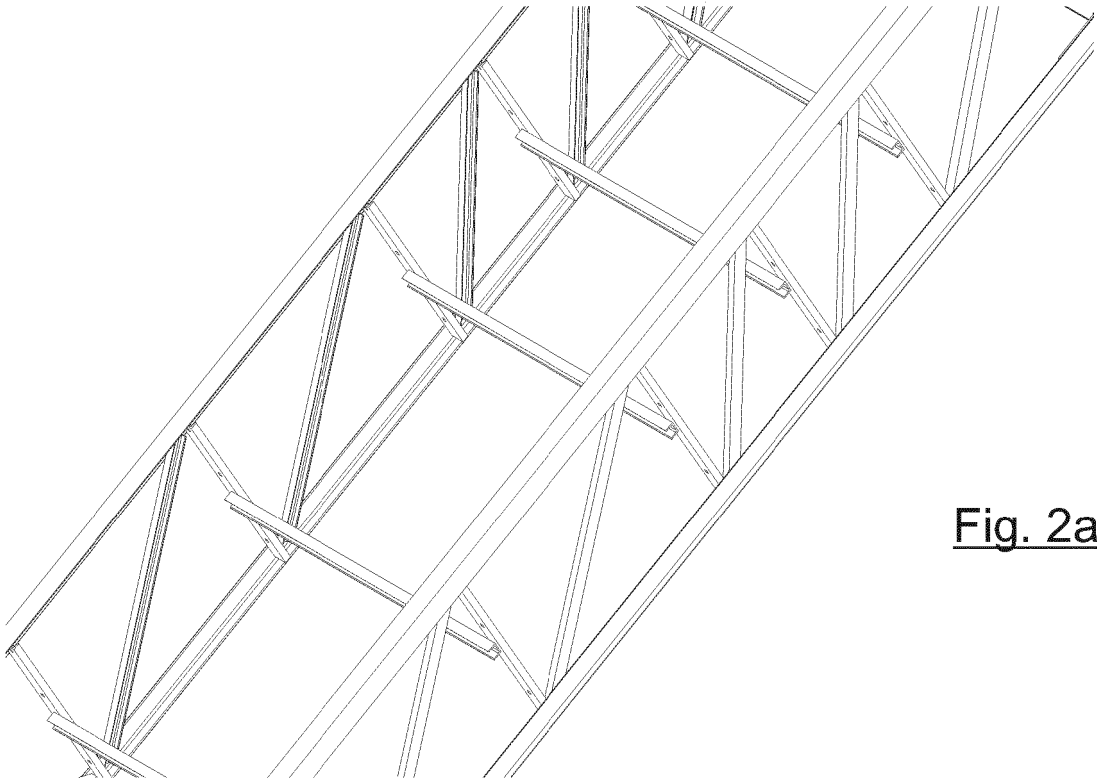

Fig. 2a

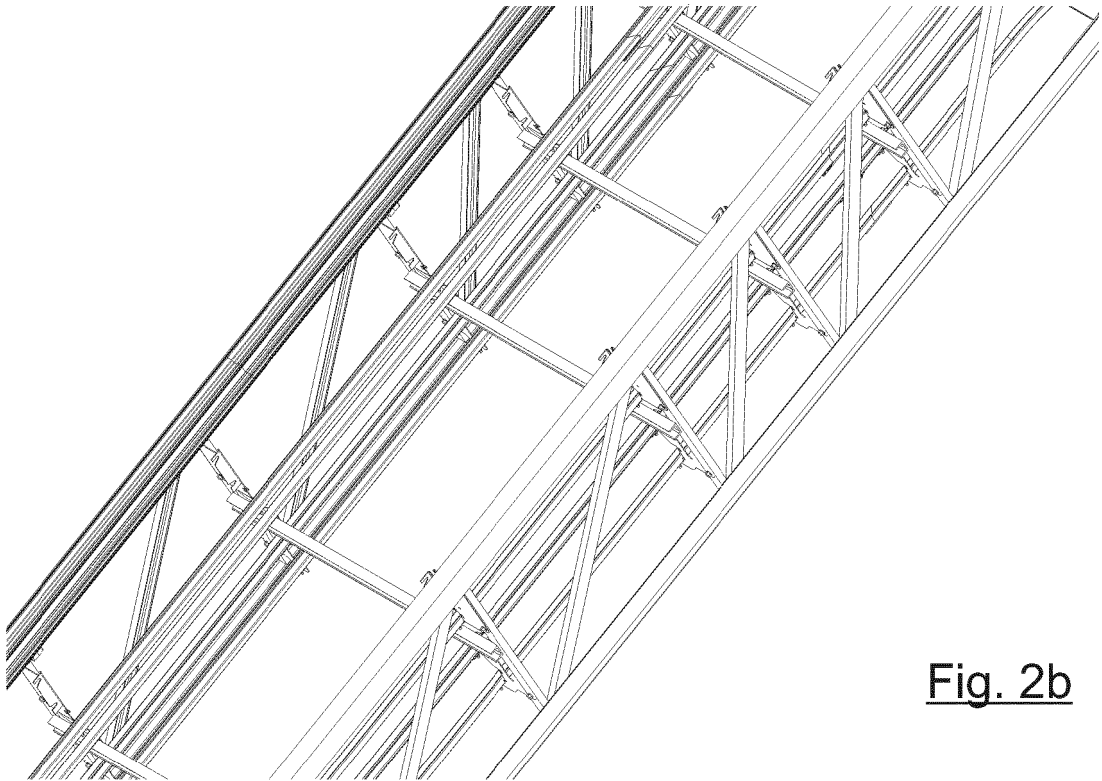

Fig. 2b

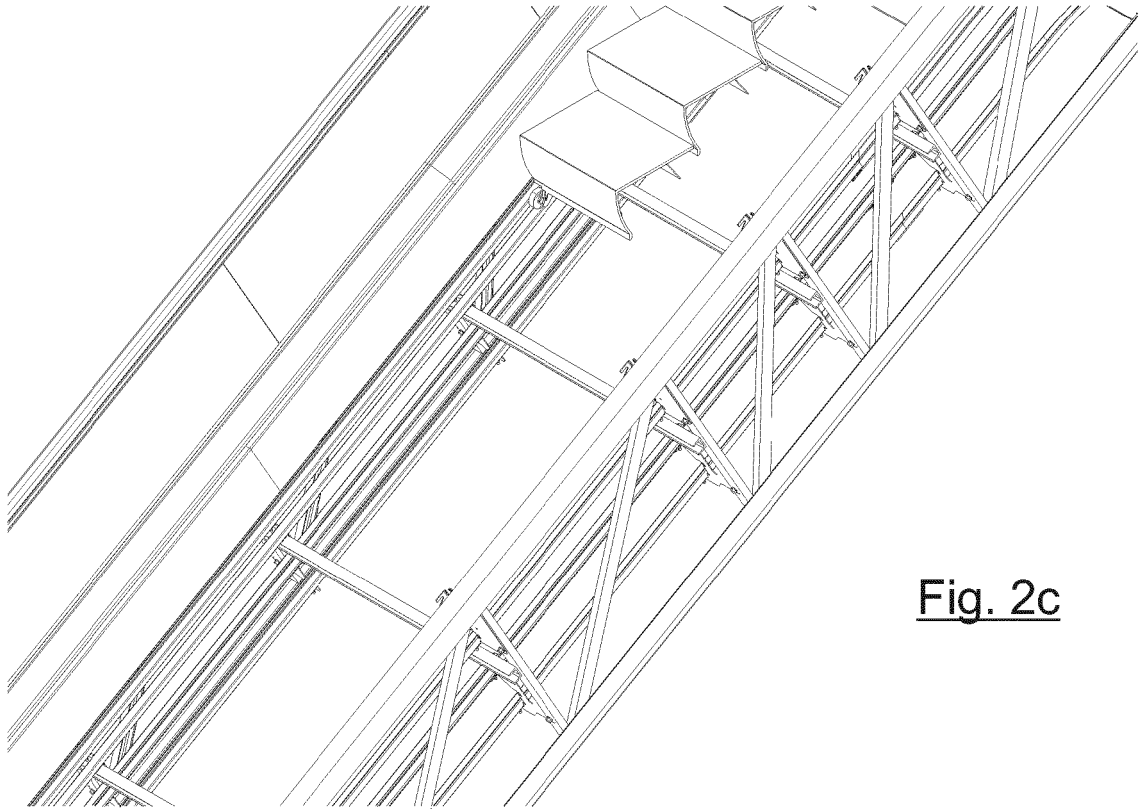

Fig. 2c

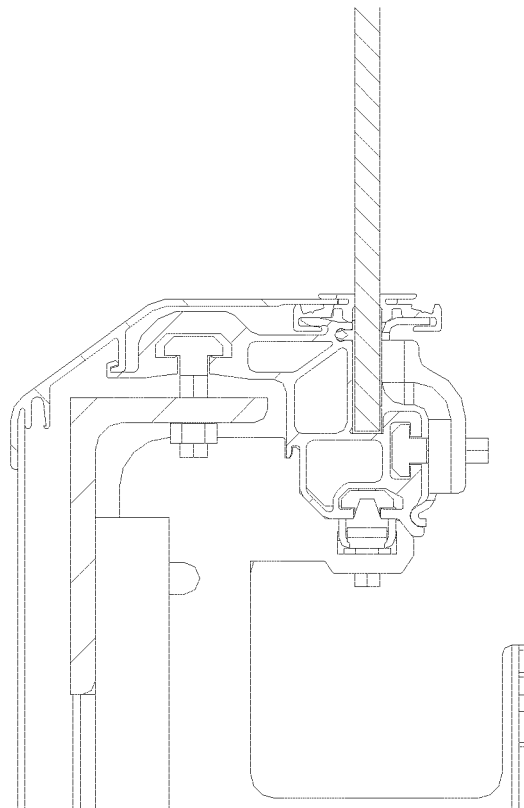

Fig. 2d

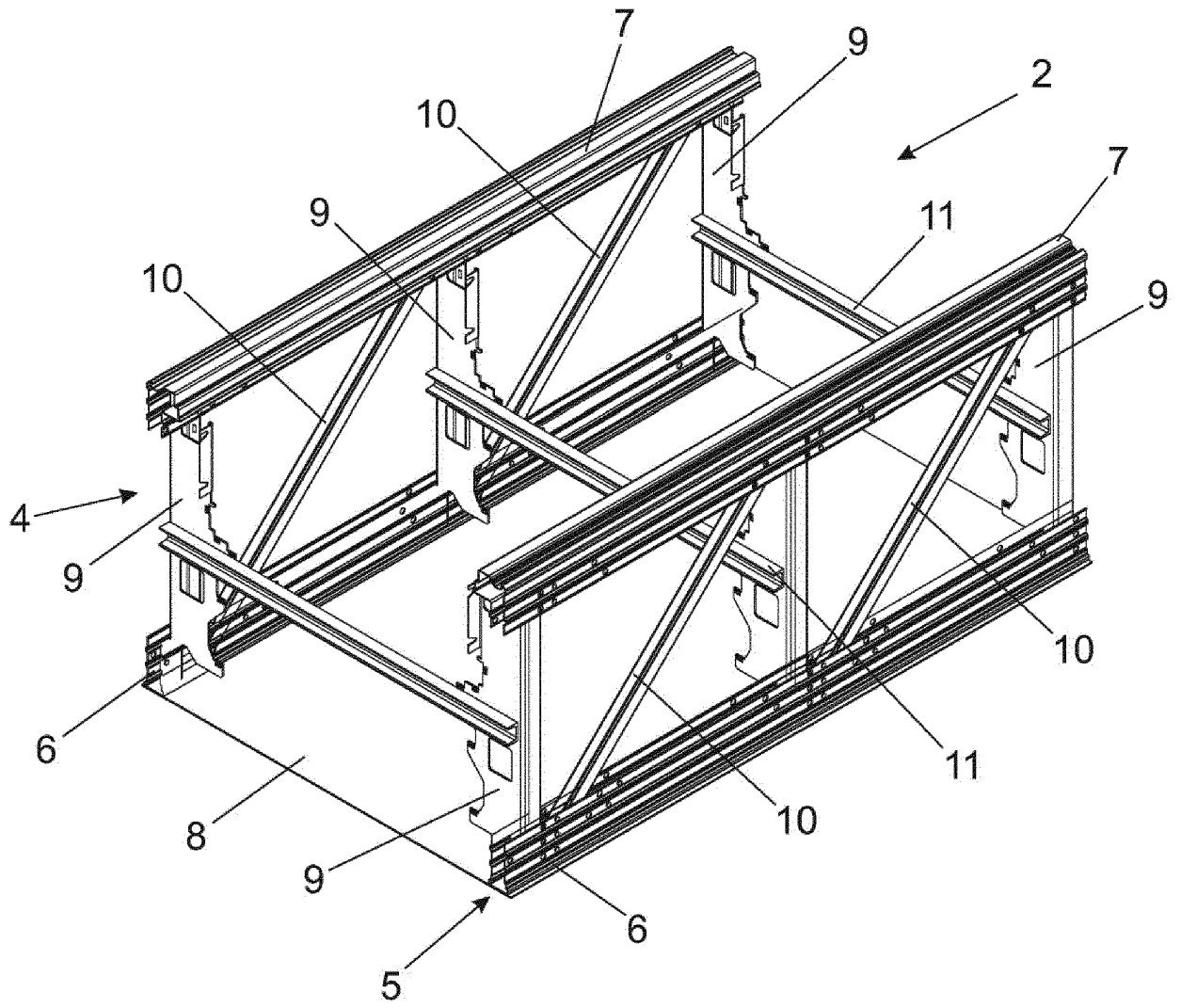

Fig. 3

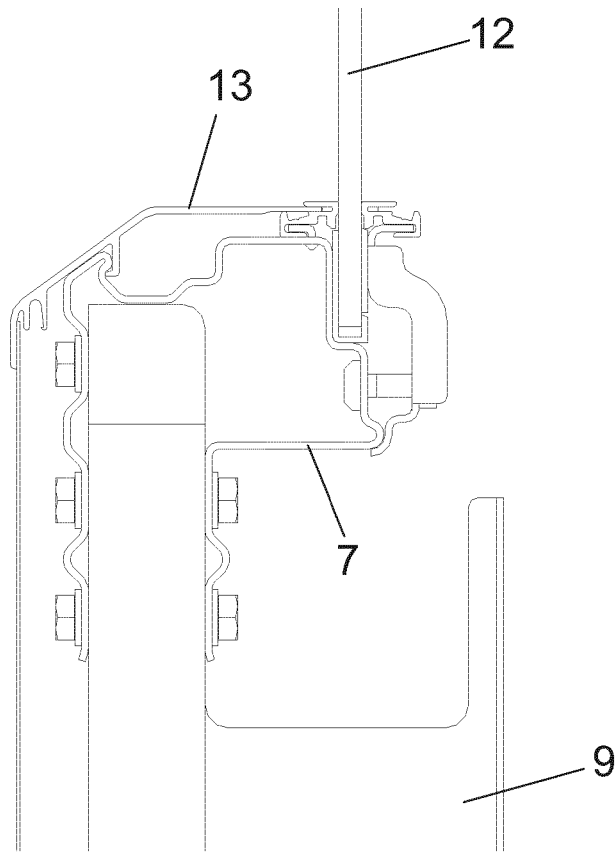

Fig. 4a

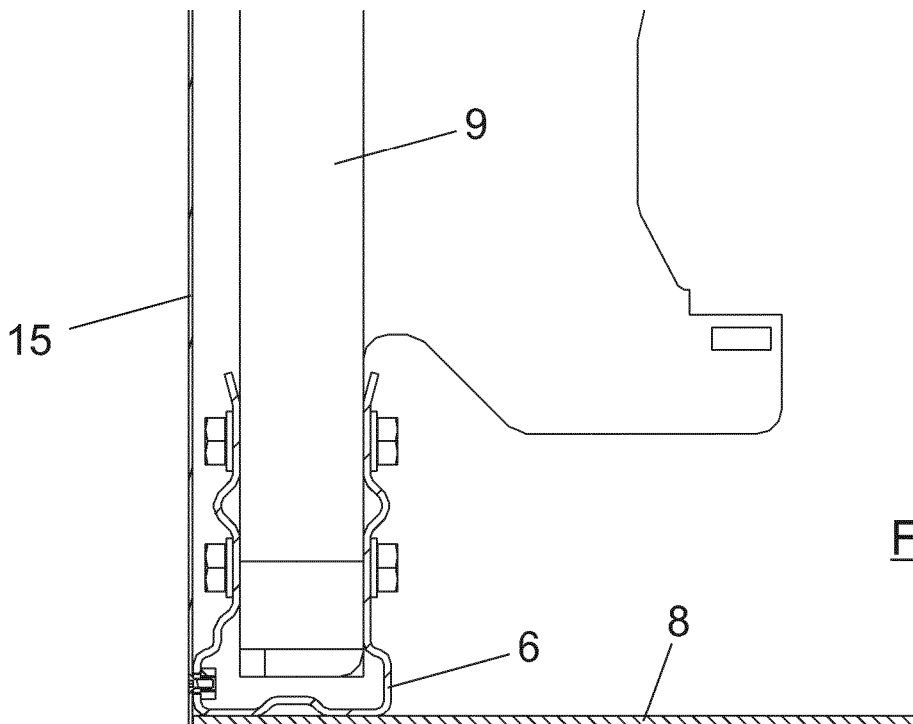

Fig. 4b

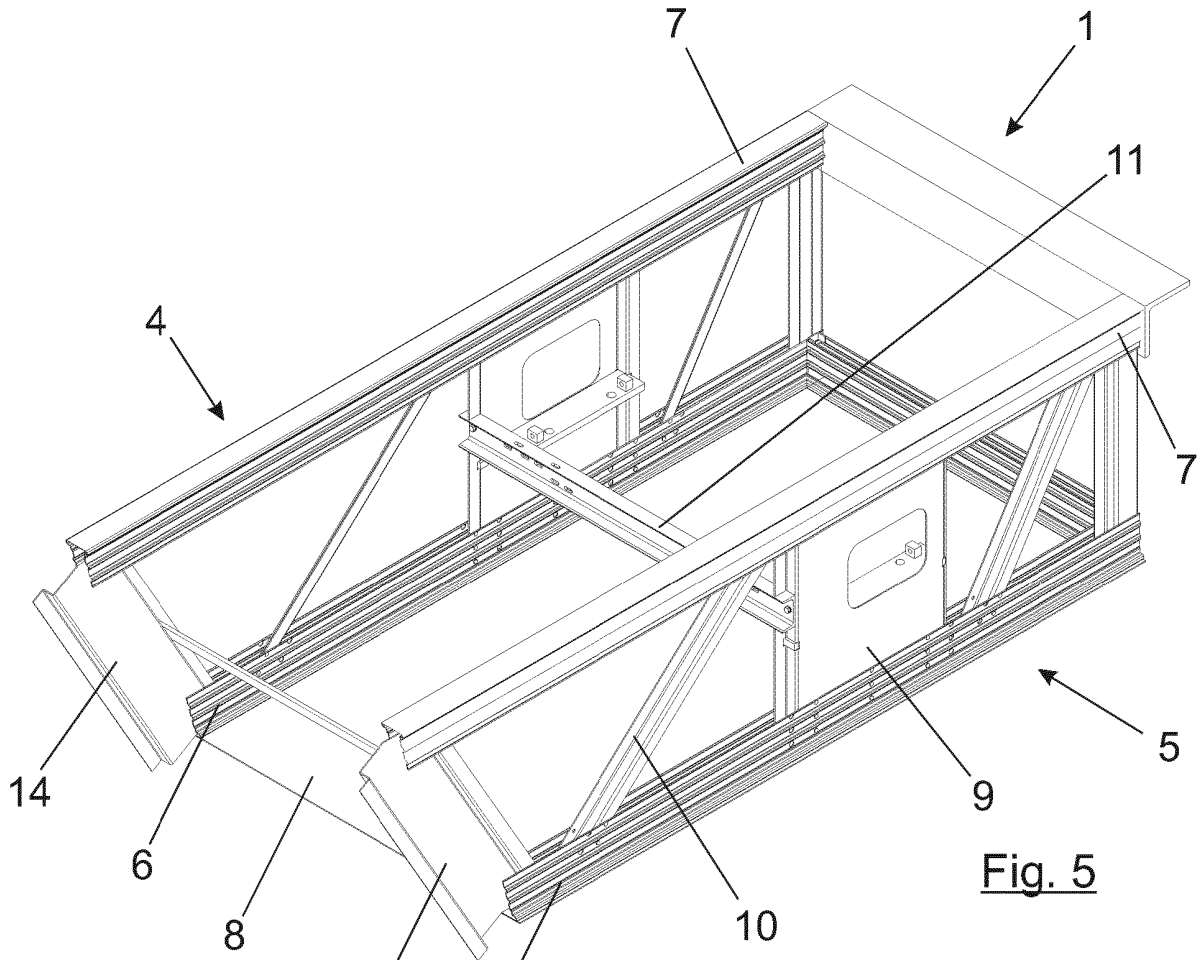

Fig. 5

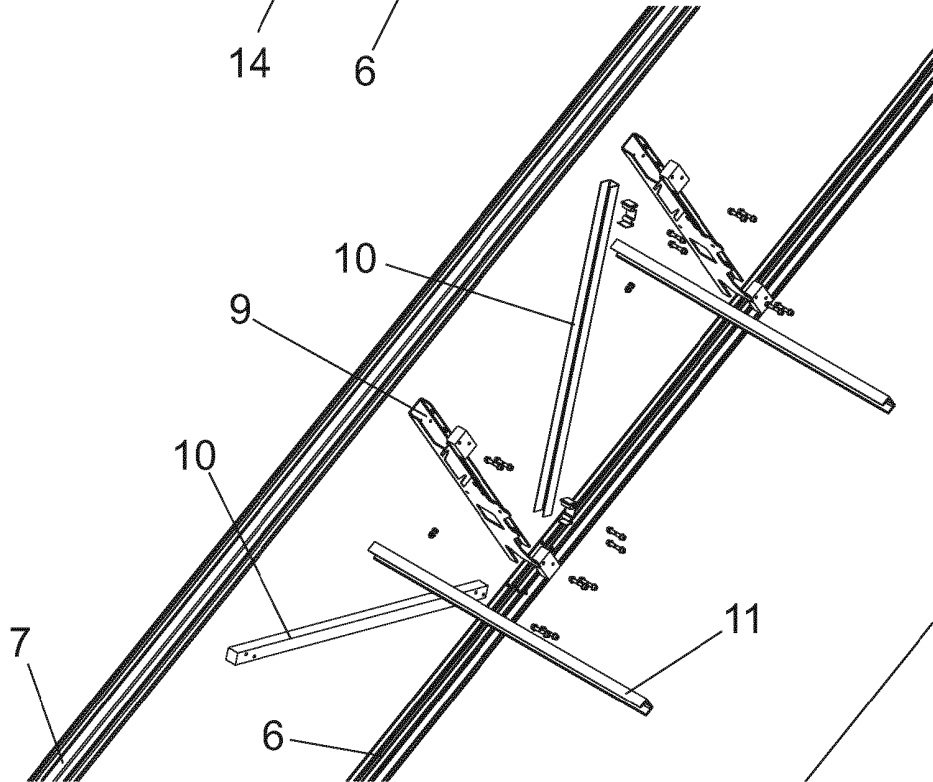

Fig. 6

REFERENCES CITED IN THE DESCRIPTION

This list of references cited by the applicant is for the reader's convenience only. It does not form part of the European patent document. Even though great care has been taken in compiling the references, errors or omissions cannot be excluded and the EPO disclaims all liability in this regard.

Patent documents cited in the description

- EP 2117747 A [0008]
- WO 2011048437 A [0009]
- US 20090050443 A [0010]
- US 20130228414 A [0011]
- EP 2527283 A [0012]
- US 6685002 B [0013]
- US 20020175039 A [0014]
- WO 2011141945 A1 [0015]