



(12) **EUROPEAN PATENT APPLICATION**

(43) Date of publication:
15.03.2017 Bulletin 2017/11

(51) Int Cl.:
B68B 1/04 (2006.01)

(21) Application number: **15382445.3**

(22) Date of filing: **10.09.2015**

(84) Designated Contracting States:
**AL AT BE BG CH CY CZ DE DK EE ES FI FR GB
GR HR HU IE IS IT LI LT LU LV MC MK MT NL NO
PL PT RO RS SE SI SK SM TR**
Designated Extension States:
BA ME
Designated Validation States:
MA

(71) Applicant: **Herrera Martinez, Maria Silvia**
15001 A Coruna (ES)

(72) Inventor: **Herrera Martinez, Maria Silvia**
15001 A Coruna (ES)

(74) Representative: **Urizar Anasagasti, Jesus Maria**
C/ Paseo de la Castellana, 72-1.º
28046 Madrid (ES)

(54) **ERGONOMIC BRIDLE FOR EQUINES**

(57) Ergonomic bridle for equines, formed by a band (1), composed of lateral pieces (2) connected by means of any joining element to an upper bridge (3) and frontal bridge (4); connected to the lateral pieces (2) by means of any joining element, the crescents (5) are provided

which incorporate, at the ends thereof, a belt (6) for the joining to the bit (7); a nasal band (8) which is connected to a throatband (9), said throatband being formed by two curved belts (10) which are joined together by the area of the lower maxilla of the equine.

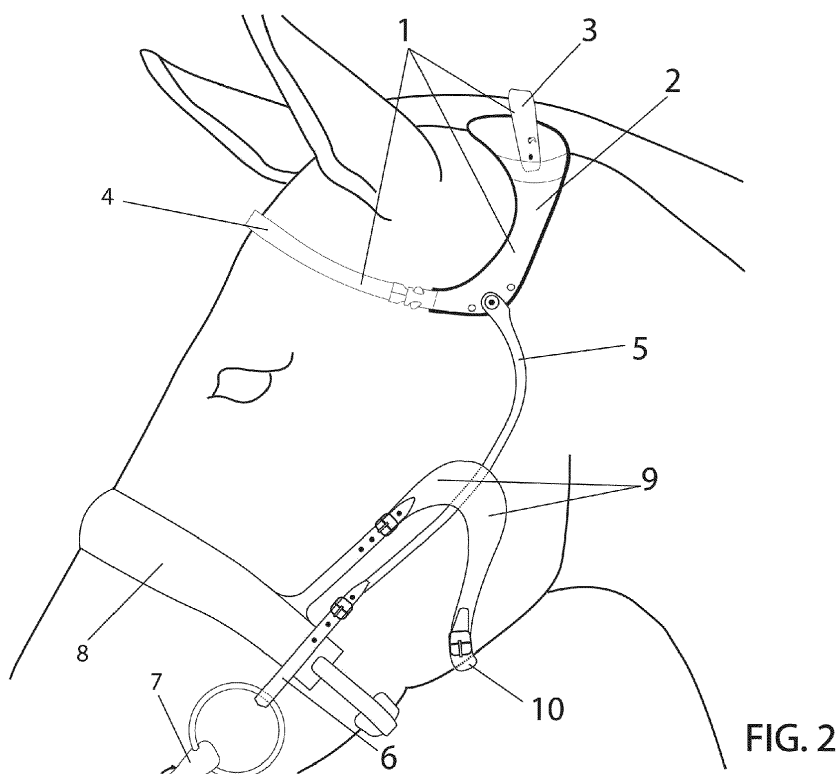

FIG. 2

Description

OBJECT OF THE INVENTION

[0001] The object of the present invention is to provide a novel ergonomic bridle for equines which provides improved ergonomy, optimizing the anatomic adaptability, providing physical benefits, relieving the cervical movements, the ears, the facial muscles in general and also increasing the visual range.

[0002] This novel ergonomic bridle for equines has particular application in the equestrian sector, where, due to the circumstances, it is necessary to provide a bridle with said characteristics.

BACKGROUND OF THE INVENTION

[0003] Up to now, there exists one single traditional system for supporting the bits of equines.

[0004] The existing traditional design generates various problems which have been hitherto unresolved: hindering the rear vision of the equines, they exert increased pressure in the cervical, trachea and throat areas.

[0005] In the prior art, no ergonomic bridle for equines is found having the technical characteristics which are described in the present patent for an invention.

DESCRIPTION OF THE INVENTION

[0006] Ergonomic bridle for equines, essentially composed of a band, said band being formed in turn by lateral pieces connected by means of any joining element to the upper bridge and frontal bridge.

[0007] The crescents, which incorporate, at the ends thereof, a belt for the joining to the bit are provided connected to the lateral pieces and by means of any joining element.

[0008] A nasal band which is connected to a throatband, said throatband being formed by two curved belts which are joined to each other at the area of the lower maxilla of the equine.

[0009] The present invention provides the following advantages:

The band of the bridle gives movement to the ears of the animal by releasing the sixteen muscles which move them, such that the normal development of one of the most important senses of the equine, which is hearing, is achieved which complements the vision which with this new bridle increases the rear and perimetrical perception.

[0010] The curved and rigid pieces, due to the particular form thereof are distanced from the eyes, giving a free movement, avoiding the normal discomforts, allowing it to be located in a more comfortable area for the equine, eliminating the hindering sensation in the near peripheral vision and the pressure of the facial nerves.

[0011] This novel ergonomic bridle for equines is regulatable in different positions.

DESCRIPTION OF THE DRAWINGS

[0012] In order to complement the description and with the aim of aiding a better understanding of the characteristics of the invention, a series of figures accompany the present specification as an integral part of the same, in which the following is represented in an illustrative and non-limiting manner:

Figure 1: exploded view of the elements which form the ergonomic bridle for equines.

Figure 2: lateral perspective view of an exemplary use of the ergonomic bridle for equines.

PREFERRED EMBODIMENT OF THE INVENTION

[0013] As is possible to observe in the attached figures, the ergonomic bridle for equines is composed of a band (1), said band being formed in turn by lateral pieces (2) connected by means of any joining element to the upper bridge (3) and frontal bridge (4).

[0014] The crescents (5), which incorporate, at the ends thereof, a belt (6) for the joining to the bit (7) are provided connected to the lateral pieces (2) and by means of any joining element.

[0015] A nasal band (8) which is connected to a throatband (9), said throatband being formed by two curved belts (10) which are joined to each other at the area of the lower maxilla of the equine.

[0016] With the nature of the present invention as well as a form of putting it into practice having been sufficiently described, it should be added that said invention can undergo variations in form and materials, provided said alterations do not substantially vary the characteristics which are claimed below.

Claims

1. An ergonomic bridle for equines, **characterized in that** it is composed of a band (1), said band being formed in turn by lateral pieces (2) connected by means of any joining element to the upper bridge (3) and frontal bridge (4); the crescents (5), which incorporate, at the ends thereof, a belt (6) for the joining to the bit (7) are provided connected to the lateral pieces (2) by means of any joining element; a nasal band (8) which is connected to a throatband (9), said throatband being formed by two curved belts (10) which are joined to each other at the area of the lower maxilla of the equine.

FIG. 1

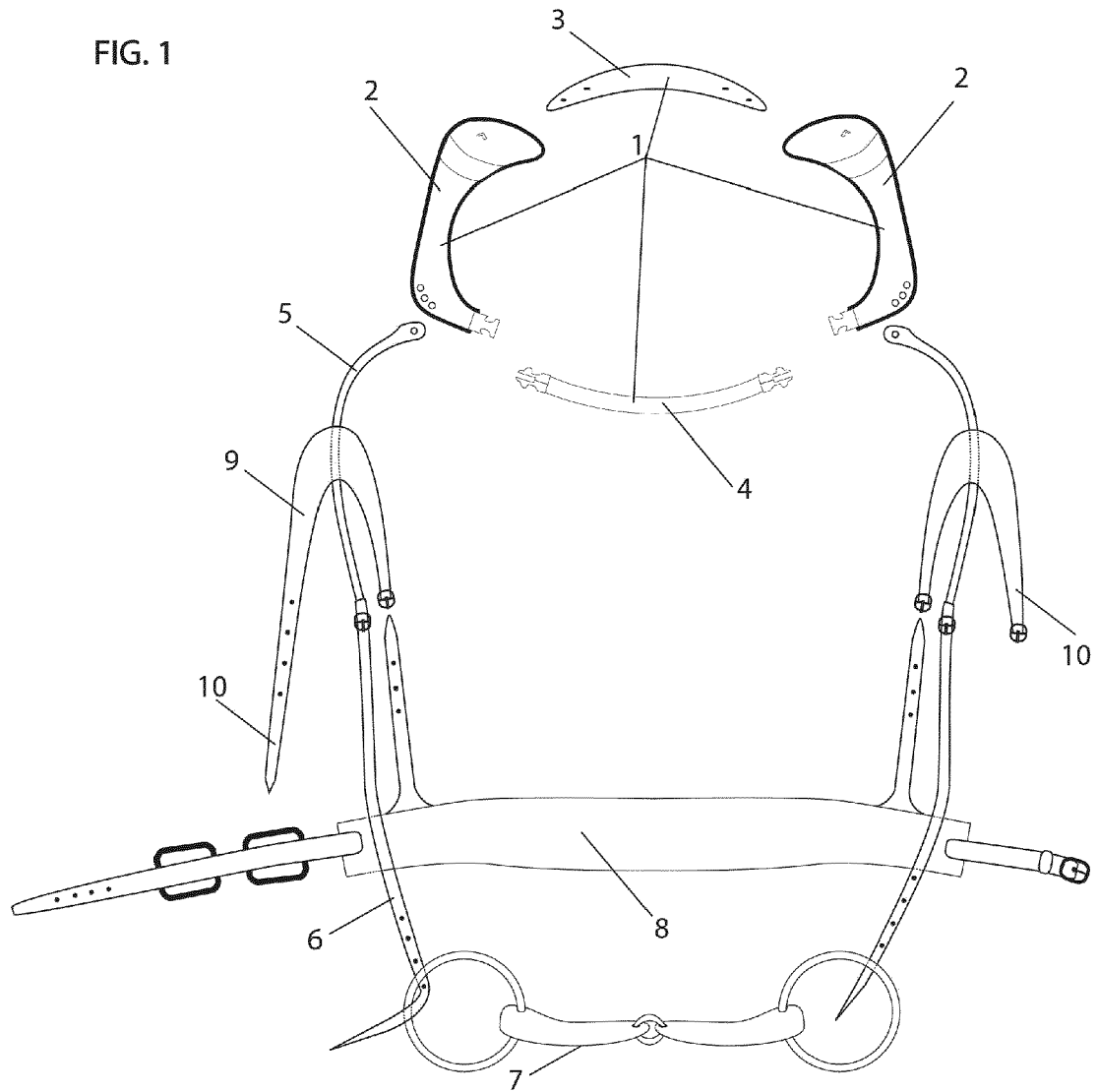

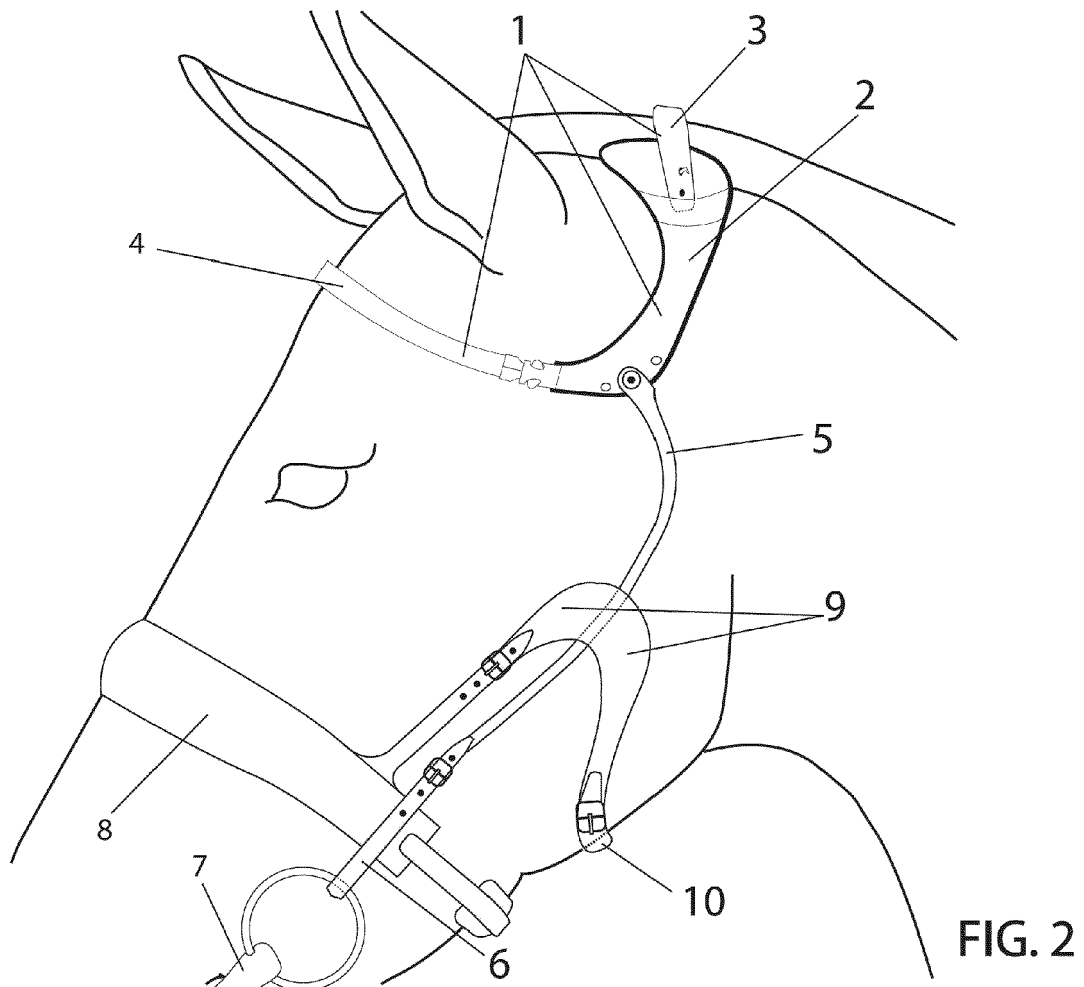



EUROPEAN SEARCH REPORT

Application Number
EP 15 38 2445

5

10

15

20

25

30

35

40

45

50

55

1

EPO FORM 1503 03.02 (P04C01)

DOCUMENTS CONSIDERED TO BE RELEVANT			
Category	Citation of document with indication, where appropriate, of relevant passages	Relevant to claim	CLASSIFICATION OF THE APPLICATION (IPC)
X	WO 2008/004938 A1 (EQUALITY LINE AB [SE]; WILHELMSSON TOMAS [SE]) 10 January 2008 (2008-01-10) * the whole document * -----	1	INV. B68B1/04
			TECHNICAL FIELDS SEARCHED (IPC)
			B68B
The present search report has been drawn up for all claims			
Place of search The Hague		Date of completion of the search 22 February 2016	Examiner Espeel, Els
CATEGORY OF CITED DOCUMENTS X : particularly relevant if taken alone Y : particularly relevant if combined with another document of the same category A : technological background O : non-written disclosure P : intermediate document T : theory or principle underlying the invention E : earlier patent document, but published on, or after the filing date D : document cited in the application L : document cited for other reasons & : member of the same patent family, corresponding document			

