

(19)



(11)

EP 3 162 252 A1

(12)

EUROPEAN PATENT APPLICATION

(43) Date of publication:
03.05.2017 Bulletin 2017/18

(51) Int Cl.:
A47G 25/18 (2006.01) A47G 25/40 (2006.01)

(21) Application number: **15194599.5**

(22) Date of filing: **13.11.2015**

(84) Designated Contracting States:
AL AT BE BG CH CY CZ DE DK EE ES FI FR GB GR HR HU IE IS IT LI LT LU LV MC MK MT NL NO PL PT RO RS SE SI SK SM TR
Designated Extension States:
BA ME
Designated Validation States:
MA MD

(71) Applicant: **Subin Home Art Co., Ltd.**
Jinju-si, Gyeongsangnam-do 660-750 (KR)

(72) Inventor: **OH, Su Bin**
664-702 Gyeongsangnam-do (KR)

(74) Representative: **Scheele, Friedrich**
Ratner Prestia
Alzheimer Eck 2
80331 München (DE)

(30) Priority: **29.10.2015 KR 20150150619**

(54) LAUNDRY HANGER

(57) The laundry hanger allows laundry to be easily put on and is easily mounted to a rod of a washing rack installed on the ceiling of an apartment balcony or the like. The laundry hanger includes a plurality of hanger rods (110), a body unit (120), and an attachment unit (130). Laundry may be put on the hanger rods (110). The body unit (120) includes a pair of mounting blocks (121),

each having a plurality of hook grooves (122) on one surface such that the hanger rods (110) are fitted to the hook grooves (122) in parallel with each other. The attachment unit (130) includes a coupling part (131) at one end rotatably coupled to the body unit (120), and a mounting part (133) at the other end so as to be detachably mountable to a rod.

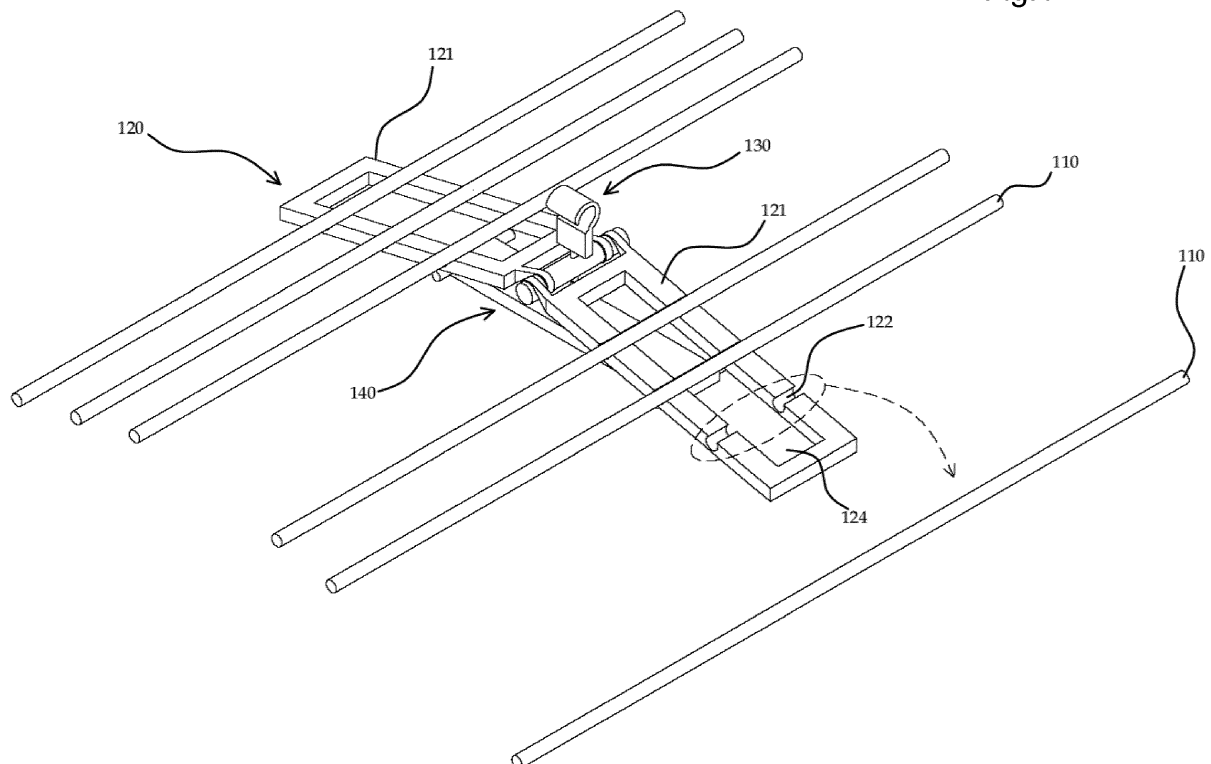
Fig.1**EP 3 162 252 A1**

Description

CROSS-REFERENCE TO RELATED APPLICATION(S)

[0001] This application claims priority to Korean Patent Application No. 10-2015-0150619, filed on October 10, 2015 in the Korean Intellectual Property Office, the disclosure(s) of which is(are) incorporated herein by reference in its(their) entirety.

BACKGROUND OF THE INVENTION

Field of the Invention

[0002] The present invention relates to a laundry hanger, and more particularly, to a laundry hanger capable of allowing laundry to be easily put on and of being easily mounted to a rod of a washing rack installed on the ceiling of an apartment balcony or the like.

Description of the Related Art

[0003] Laundry is dried using drying racks disposed in an interior or a balcony. As illustrated in Fig. 6, a conventional laundry drying rack primarily includes a pair of legs 11 and a pair of drying units 12 which is rotatably mounted to the legs 11 in order to dry laundry. The bottom portions of the legs 11 are supported on the floor, and the upper ends thereof are connected to the drying units 12 by hinges. In addition, the central portions of the legs 11 are interconnected by a connection member 13 such that a maximum rotation angle, by which the legs 11 are rotated away from each other in opposite directions, may be controlled. The connection member 13 is also configured such that the half regions thereof may rotate relative to each other.

[0004] The drying units 12 are provided with hanger members 14 at regular intervals, and laundry is practically put on the hanger members 14 to be dried.

[0005] In addition, the drying units 12 rotate about the legs 11 in an upward or downward direction. Here, the upper ends of distance adjustment members 15 connected to the legs 11 by hinges are located at any hanger members 14 such that the angles of rotation of the drying units 12 may be controlled.

[0006] Since the conventional laundry drying rack 10 includes the pair of drying units 12, the pair of legs 11, the connection member 13, the distance adjustment members 15, etc., it has a complicated structure.

[0007] In addition, in order to dry laundry in the conventional laundry drying rack 10, the drying units 12 must be supported by the distance adjustment members 15 in the state in which the drying units 12 are spread after the legs 11 are rotated away from each other. For this reason, there is a problem in that the laundry drying rack 10 has a complicated structure since several processes are required to fold and unfold the laundry drying rack 10.

SUMMARY OF THE INVENTION

[0008] Accordingly, the present invention is directed to a laundry hanger that substantially obviates one or more problems due to limitations and disadvantages of the related art.

[0009] An object of the present invention is to provide a laundry hanger capable of being easily mounted to a rod of a washing rack installed on the ceiling of an apartment balcony or the like in order to put laundry on the laundry hanger.

[0010] Additional advantages, objects, and features of the invention will be set forth in part in the description which follows and in part will become apparent to those having ordinary skill in the art upon examination of the following or may be learned from practice of the invention. The objectives and other advantages of the invention may be realized and attained by the structure particularly pointed out in the written description and claims hereof as well as the accompanying drawings.

[0011] In accordance with an aspect of the present invention, a laundry hanger includes a plurality of hanger rods, a body unit, and an attachment unit. Laundry may be put on the hanger rods. The body unit includes a pair of mounting blocks, each having a plurality of hook grooves formed on one surface thereof such that the hanger rods are fitted to the hook grooves to be arranged in parallel with each other. The attachment unit includes a coupling part formed at one end thereof so as to be rotatably coupled to the body unit, and a mounting part formed at the other end thereof so as to be detachably mounted to a rod.

[0012] In the laundry hanger, the body unit may further include a connection rod into which the coupling part is rotatably inserted, and one end of each of the mounting blocks may be coupled to the connection rod such that the mounting blocks are rotatable about the connection rod. In this case, the laundry hanger may further include a support unit for supporting the mounting blocks such that the mounting blocks are maintained in a state of rotating about the connection rod by a predetermined angle.

[0013] In the laundry hanger, each of the mounting blocks may further have a through-hole penetrated from one surface thereof to the other surface thereof.

[0014] In the laundry hanger, the support unit may include a support block, and fixed bars protruding from both ends of the support block. In this case, the mounting blocks may have locking protrusions formed on the other surfaces thereof such that the fixed bars are fixedly inserted into the locking protrusions.

[0015] In the laundry hanger, the mounting part may have a ring shape such that the rod is fixedly fitted to the mounting part, and the mounting part may have a predetermined thickness so as not to rotate in a longitudinal direction of the rod.

[0016] In the laundry hanger, the support block may be formed with a hanger part on which a hanger is hung.

[0017] In the laundry hanger, the hanger part may include a through-window formed in a central portion of the support block to be penetrated from one surface of the support block to the other surface thereof, and grooves formed on one surface of the support block such that the hanger is hung while being prevented from sliding.

[0018] It is to be understood that both the foregoing general description and the following detailed description of the present invention are exemplary and explanatory and are intended to provide further explanation of the invention as claimed.

BRIEF DESCRIPTION OF THE DRAWINGS

[0019] The above and other objects, features and other advantages of the present invention will be more clearly understood from the following detailed description taken in conjunction with the accompanying drawings, in which:

Fig. 1 is a conceptual view illustrating a laundry hanger according to an embodiment of the present invention;

Fig. 2 is a conceptual view illustrating a body unit illustrated in Fig. 1;

Fig. 3 is a perspective view illustrating one mounting block illustrated in Fig. 1 when viewed from another direction;

Fig. 4 is a conceptual view illustrating the mounting blocks which are illustrated in Fig. 1 and are folded;

Fig. 5 is a view illustrating an example of another support unit which may be used for the laundry hanger according to the embodiment of the present invention; and

Fig. 6 is a conceptual view illustrating a conventional laundry drying rack.

DETAILED DESCRIPTION OF EMBODIMENTS

[0020] Exemplary embodiments of the present invention will be described below in more detail with reference to the accompanying drawings. The present invention may, however, be embodied in different forms and should not be construed as limited to the embodiments set forth herein. Rather, these embodiments are provided so that this disclosure will be thorough and complete, and will fully convey the scope of the present invention to those skilled in the art. Hereinafter, a laundry hanger according to an embodiment of the present invention will be described with reference to Figs. 1 to 4.

[0021] The laundry hanger according to the embodiment of the present invention includes a plurality of hanger rods 110, a body unit 120, an attachment unit 130, and a support unit 140.

[0022] Laundry may be put on the hanger rods 110, and the hanger rods 110 are identical to the rods of typical laundry drying racks for hanging laundry.

[0023] The body unit 120 includes a pair of mounting blocks 121 and a connection rod 127. One end of each

mounting block 121 is rotatably coupled to the connection rod 127. Thus, the mounting blocks 121 are coupled to the connection rod 127 so as to rotate about the connection rod 127. In this case, each of the mounting blocks 121 has a plurality of hook grooves 122 formed on one surface thereof such that the hanger rods 110 may be fitted to the hook grooves 122 to be arranged in parallel with each other, and a through-hole 124 formed in the center thereof so as to be penetrated from one surface thereof to the other surface thereof. If the through-hole 124 is not formed in the center of the mounting block 121, it is inconvenient since a user's hand strikes the mounting block 121 when the hanger rods 110 are attached to or detached from the mounting block 121. Accordingly, the through-hole 124 serves to prevent the user's hand from striking the mounting block 121, by allowing the user's hand to enter the through-hole 124, when the hanger rods 110 are attached to or detached from the mounting block 121. The mounting block 121 has locking protrusions 126 formed on the other surface thereof. The locking protrusions 126 serve to fix fixed bars 143 of the support unit 140 in such a manner that the fixed bars 143 are inserted into the associated locking protrusions 126 of the mounting blocks 121.

[0024] The attachment unit 130 serves to mount the laundry hanger of the present embodiment to a rod on the ceiling of an apartment balcony or the like. To this end, the attachment unit 130 includes a coupling part 131 and a mounting part 133.

[0025] The coupling part 131 is rotatably inserted into the connection rod 127 to be coupled thereto. The mounting part 133 has a ring shape so as to be detachable attached to the rod. In this case, the mounting part 133 has a predetermined-sized width such that the attachment unit 130 is not rotated in the longitudinal direction of the rod when the rod is mounted to the mounting part 133. The mounting part 133 preferably has a protrusion portion 133a which protrudes from the center thereof. When the mounting part 133 surrounds the rod due to having a large width and by the protrusion portion 133a protruding from the center of the mounting part 133 when the rod is inserted into the mounting part 133, the attachment unit 130 is not rotated in the longitudinal direction of the rod. Accordingly, the mounting part 133 must have a significant large width such that the attachment unit 130 is not rotated in the longitudinal direction of the rod mounted thereto.

[0026] The support unit 140 supports the pair of mounting blocks 121 such that the mounting blocks 121 may be maintained in the state of being rotated away from each other by a predetermined angle. To the end, the support unit 140 includes a support block 141 and fixed bars 143. The fixed bars 143 protrude from both ends of the support block 141 so as to be inserted into the associated locking protrusions 126. Accordingly, when the fixed bar 143 protruding from one end of the support block 141 is inserted into any locking protrusion 126 of one mounting block 121, and the fixed bar 143 protruding

from the other end of the support block 141 is inserted into any locking protrusion 126 of the other mounting block 121, the support block 141 supports the pair of mounting blocks 121 such that the mounting blocks 121 may be maintained in the state of being rotated away from each other by a predetermined angle.

[0027] Meanwhile, a larger quantity of laundry may be put on the laundry hanger of the present embodiment when a support block 141 is configured such that hangers may be hung on the support block. In this case, the support block 141 may be formed with a hanger part on which the hangers may be hung, as illustrated in Fig. 5. The hanger part includes a through-window 141a and grooves 141b, for hanging the hangers on the hanger part. The grooves 141 are formed on one surface of the support block 141 such that the hangers may be hung while being prevented from sliding from the support block 141. Although the support block 141 has the grooves 141b in the present embodiment, it may have protrusions or the like in order to prevent the hangers from sliding. The through-window 141a is penetrated from one surface of the support block 141 to the other surface thereof such that the heads of the hangers may be inserted through the through-window 141b when they are hung on the grooves 141b. If the support block 141 is formed of a flat plate and the through-window 141a is not present therein, the hangers may not be hung on the support block 141 because of the heads thereof. If the support block 141 is formed of a rod having a thin thickness, the through-window 141a may not be present therein.

[0028] In the present embodiment, the mounting part 133 is mounted to the rod installed on the ceiling of the apartment balcony or the like. In this case, since the mounting part 133 has a predetermined thick width, the mounting part 133 is not rotated in the longitudinal direction of the rod mounted thereto.

[0029] Laundry such as towels or socks is put on the hanger rods 110 separated from the mounting blocks 121, and the hanger rods 110 are then inserted into the hook grooves 122 of the mounting blocks 121. Since the hanger rods 110 are separated from the mounting blocks 121, the hanger rods 110 can be easily mounted to the mounting blocks 121 in the state in which laundry is put on the hanger rods 110. In addition, the mounting blocks 121 are rotatable about the connection rod 127 in the present embodiment. Accordingly, when the laundry hanger of the present embodiment is not used, the mounting blocks 121 can be folded by separating the fixed bar 143 located at one end of the support block 141 from the associated locking protrusion 126, as illustrated in Fig. 4. Therefore, the laundry hanger can be easily stored.

[0030] As is apparent from the above description, since laundry is put on hanger rods and the hanger rods are then mounted to a body unit, the laundry can be easily put on a laundry hanger.

[0031] In addition, since a mounting part of an attachment unit is detachably mounted to a rod of a washing

rack installed on the ceiling of an apartment balcony or the like, the laundry hanger of the present invention can be easily installed.

[0032] Although the present invention has been described with respect to the illustrative embodiments, it will be apparent to those skilled in the art that various variations and modifications may be made without departing from the spirit and scope of the invention as defined in the following claims.

Claims

1. A laundry hanger comprising:

a plurality of hanger rods on which laundry is put; a body unit comprising a pair of mounting blocks, each having a plurality of hook grooves formed on one surface thereof such that the hanger rods are fitted to the hook grooves to be arranged in parallel with each other; and an attachment unit comprising a coupling part formed at one end thereof so as to be rotatably coupled to the body unit, and a mounting part formed at the other end thereof so as to be detachably mounted to a rod.

2. The laundry hanger according to claim 1, wherein:

the body unit further comprises a connection rod into which the coupling part is rotatably inserted, and one end of each of the mounting blocks is coupled to the connection rod such that the mounting blocks are rotatable about the connection rod; and the laundry hanger further comprises a support unit for supporting the mounting blocks such that the mounting blocks are maintained in a state of rotating about the connection rod by a predetermined angle.

3. The laundry hanger according to claim 2, wherein each of the mounting blocks further has a through-hole penetrated from one surface thereof to the other surface thereof.

4. The laundry hanger according to claim 3, wherein:

the support unit comprises a support block, and fixed bars protruding from both ends of the support block; and the mounting blocks have locking protrusions formed on the other surfaces thereof such that the fixed bars are fixedly inserted into the locking protrusions.

5. The laundry hanger according to claim 4, wherein the mounting part has a ring shape such that the rod

is fixedly fitted to the mounting part, and the mounting part has a predetermined thickness so as not to rotate in a longitudinal direction of the rod.

6. The laundry hanger according to claim 5, wherein the support block is formed with a hanger part on which a hanger is hung. 5
7. The laundry hanger according to claim 6, wherein the hanger part comprises a through-window formed in a central portion of the support block to be penetrated from one surface of the support block to the other surface thereof, and grooves formed on one surface of the support block such that the hanger is hung while being prevented from sliding. 10 15

20

25

30

35

40

45

50

55

Fig.1

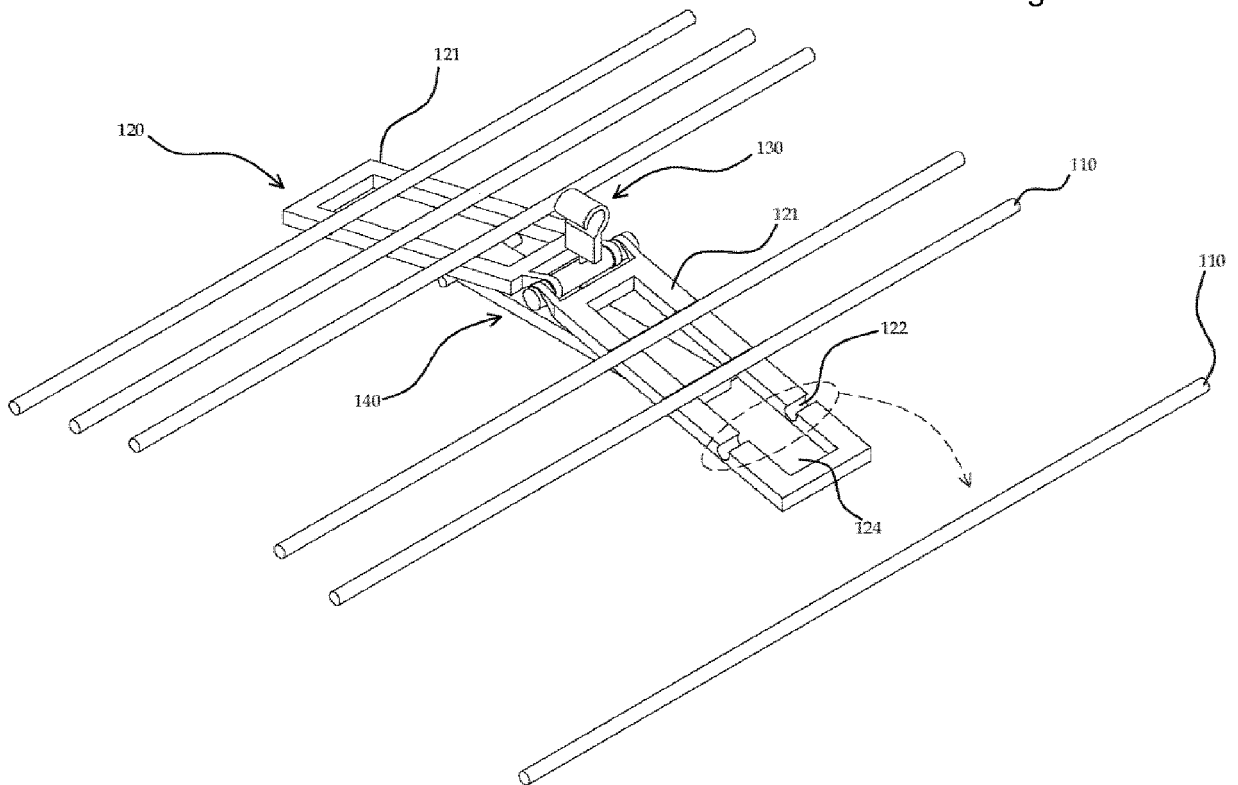

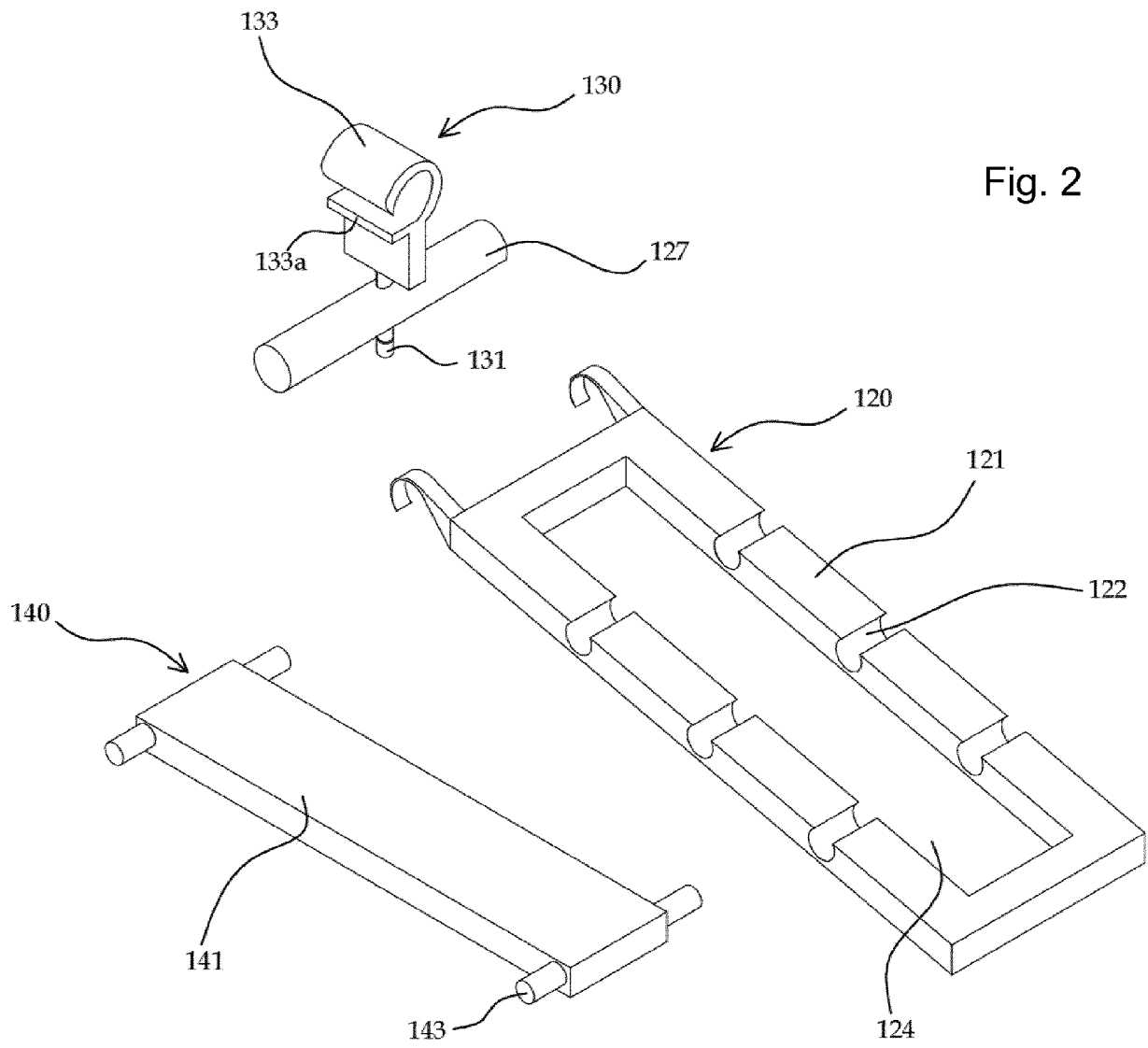

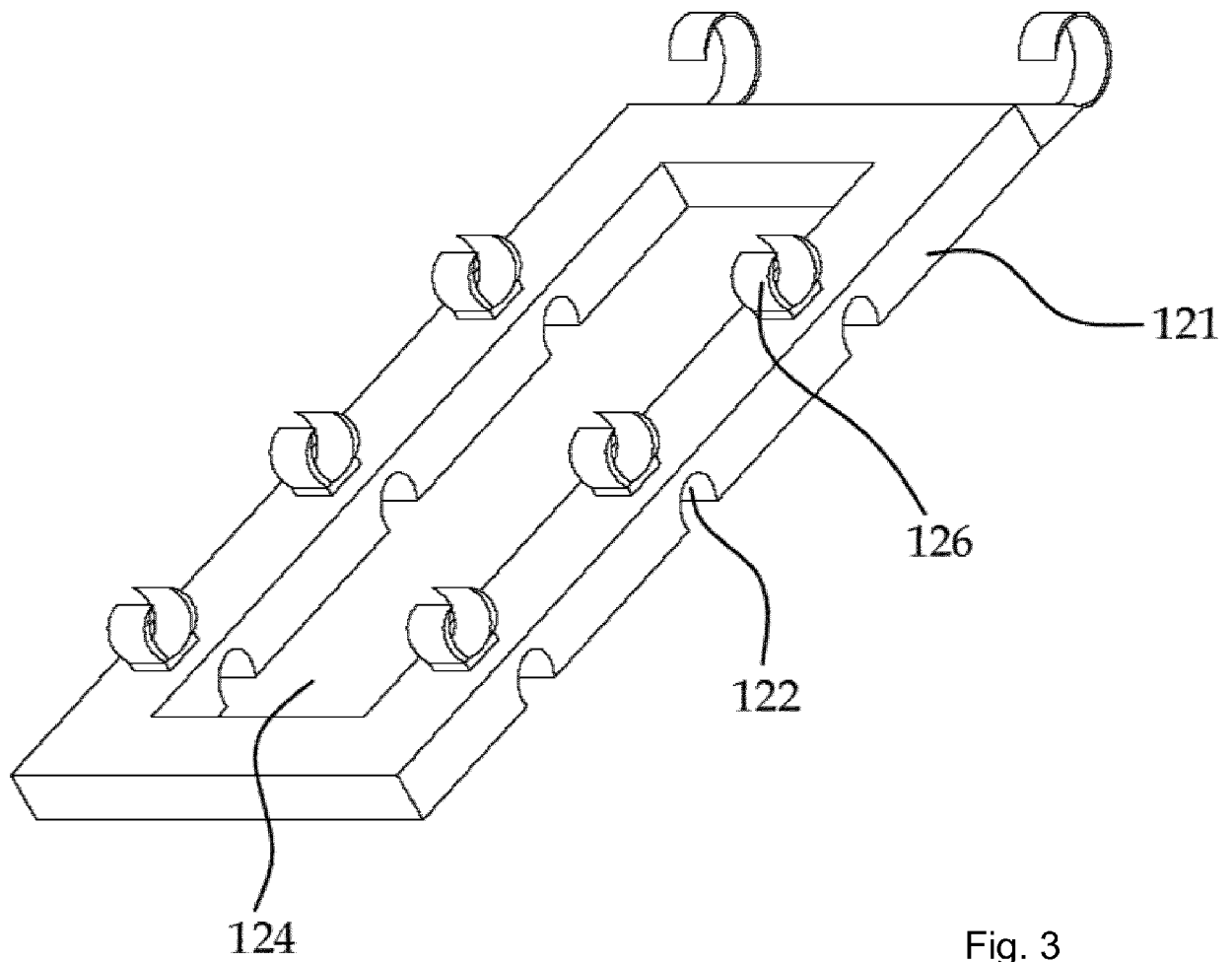

Fig. 3

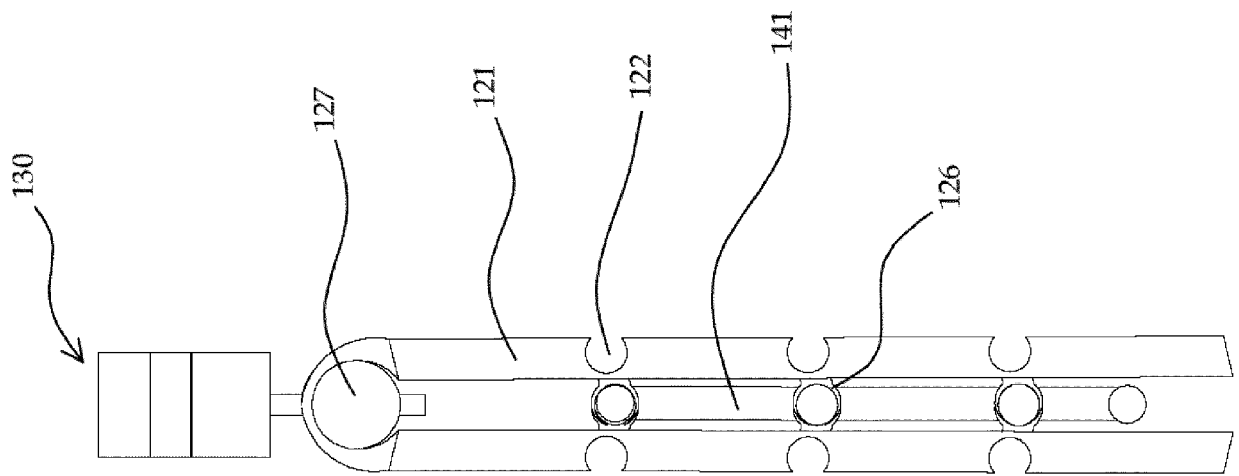

Fig. 4

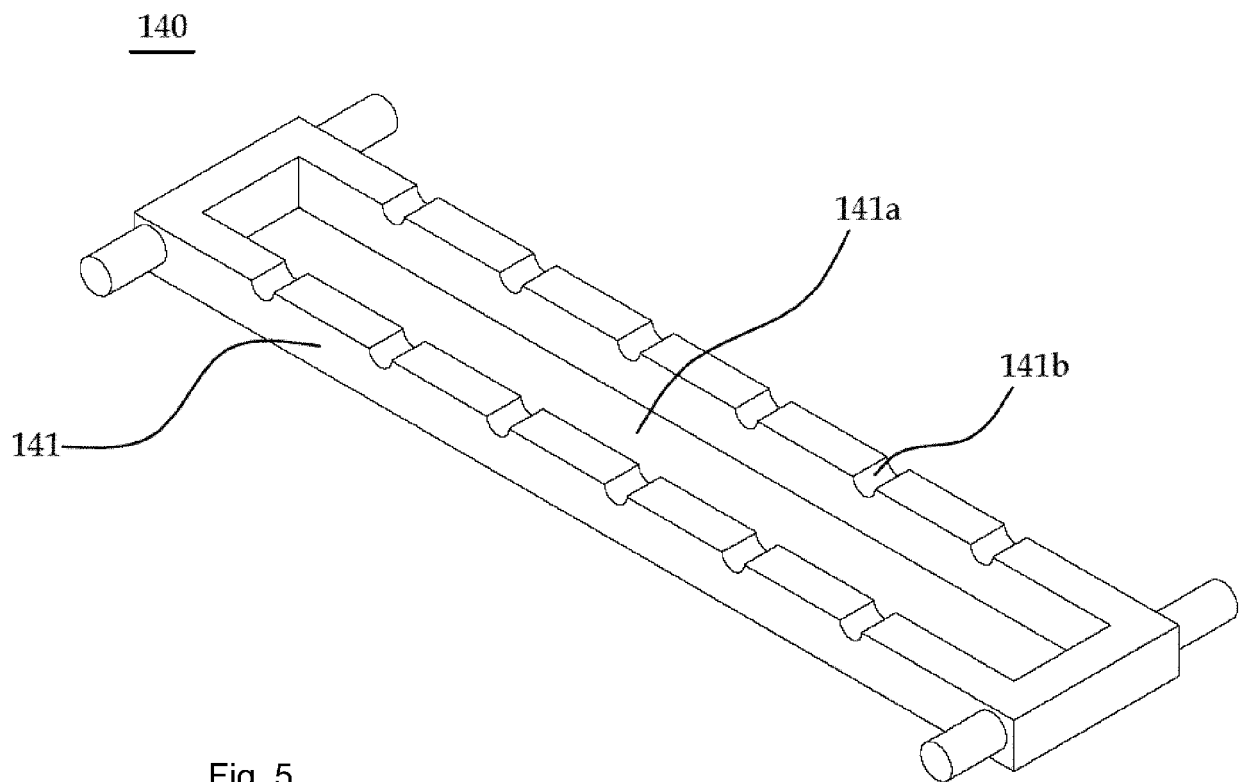
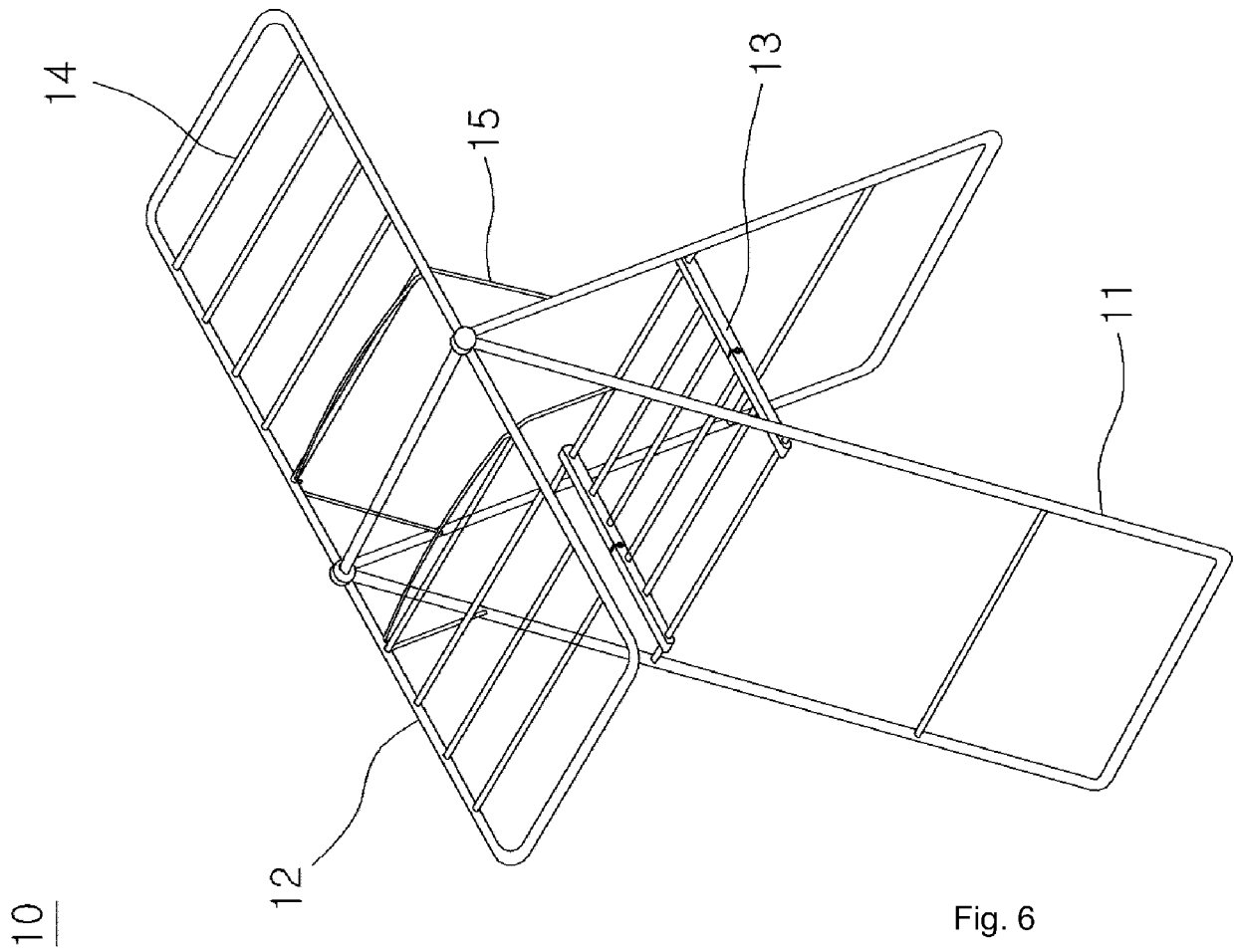

Fig. 5





EUROPEAN SEARCH REPORT

 Application Number
 EP 15 19 4599

5

10

15

20

25

30

35

40

45

50

55

DOCUMENTS CONSIDERED TO BE RELEVANT			
Category	Citation of document with indication, where appropriate, of relevant passages	Relevant to claim	CLASSIFICATION OF THE APPLICATION (IPC)
X	US 5 405 065 A (OLSON) 11 April 1995 (1995-04-11) * figure 1 *	1	INV. A47G25/18 A47G25/40
A	US 2008/217272 A1 (LAM) 11 September 2008 (2008-09-11) * figure 4C *	1	
A	NL 7 906 194 A (FAHMI) 25 February 1980 (1980-02-25) * figure 5 *	1	
A	WO 2014/110843 A1 (JINHUA HAOQIANG IMP & EXP CO LTD) 24 July 2014 (2014-07-24) * figures 6, 7 *	1	
			TECHNICAL FIELDS SEARCHED (IPC)
			A47G D06F
The present search report has been drawn up for all claims			
Place of search		Date of completion of the search	Examiner
The Hague		1 March 2017	Beugeling, Leo
CATEGORY OF CITED DOCUMENTS X : particularly relevant if taken alone Y : particularly relevant if combined with another document of the same category A : technological background O : non-written disclosure P : intermediate document T : theory or principle underlying the invention E : earlier patent document, but published on, or after the filing date D : document cited in the application L : document cited for other reasons & : member of the same patent family, corresponding document			

EPO FORM 1503 03.02 (P04C01)

**ANNEX TO THE EUROPEAN SEARCH REPORT
ON EUROPEAN PATENT APPLICATION NO.**

EP 15 19 4599

5 This annex lists the patent family members relating to the patent documents cited in the above-mentioned European search report.
The members are as contained in the European Patent Office EDP file on
The European Patent Office is in no way liable for these particulars which are merely given for the purpose of information.

01-03-2017

Patent document cited in search report	Publication date	Patent family member(s)	Publication date
US 5405065 A	11-04-1995	NONE	
US 2008217272 A1	11-09-2008	NONE	
NL 7906194 A	25-02-1980	AU 530711 B2	28-07-1983
		CA 1123399 A	11-05-1982
		CH 639839 A5	15-12-1983
		DE 7824917 U1	14-12-1978
		FR 2433921 A1	21-03-1980
		NL 7906194 A	25-02-1980
		US 4278177 A	14-07-1981
		US 4366909 A	04-01-1983
		ZA 7904415 B	27-08-1980
WO 2014110843 A1	24-07-2014	CN 103040330 A	17-04-2013
		WO 2014110843 A1	24-07-2014

REFERENCES CITED IN THE DESCRIPTION

This list of references cited by the applicant is for the reader's convenience only. It does not form part of the European patent document. Even though great care has been taken in compiling the references, errors or omissions cannot be excluded and the EPO disclaims all liability in this regard.

Patent documents cited in the description

- KR 1020150150619 [0001]