



(11) **EP 3 192 659 A3**

(12) **EUROPEAN PATENT APPLICATION**

(88) Date of publication A3:  
**08.11.2017 Bulletin 2017/45**

(51) Int Cl.:  
**B41J 3/407** (2006.01) **B41J 29/377** (2006.01)  
**B41J 2/17** (2006.01) **B41J 11/00** (2006.01)  
**B41J 25/308** (2006.01)

(43) Date of publication A2:  
**19.07.2017 Bulletin 2017/29**

(21) Application number: **17151260.1**

(22) Date of filing: **29.09.2014**

(84) Designated Contracting States:  
**AL AT BE BG CH CY CZ DE DK EE ES FI FR GB GR HR HU IE IS IT LI LT LU LV MC MK MT NL NO PL PT RO RS SE SI SK SM TR**

(72) Inventors:  
• **GOTO, Junichi**  
**Suwa-shi, Nagano 392-8502 (JP)**  
• **HANEDA, Yuya**  
**Suwa-shi, Nagano 392-8502 (JP)**  
• **FUJISHIMA, Kazutoshi**  
**Suwa-shi, Nagano 392-8502 (JP)**

(30) Priority: **01.10.2013 JP 2013206161**

(62) Document number(s) of the earlier application(s) in accordance with Art. 76 EPC:  
**14186880.2 / 2 857 209**

(74) Representative: **Miller Sturt Kenyon**  
**9 John Street**  
**London WC1N 2ES (GB)**

(71) Applicant: **Seiko Epson Corporation**  
**Tokyo 160-8801 (JP)**

(54) **INK JET TEXTILE PRINTING APPARATUS**

(57) Provided is an ink jet textile printing apparatus (1) which includes a head (41) which discharges ink in a liquid droplet state through nozzles, a head moving portion (42) which moves the head, a fabric transporting portion (20) which includes a transporting belt (23) for transporting a fabric (M), and a fan (50) which generates an air flow, in which the fan is disposed further on an upstream side in a transporting direction of the fabric than the head and a flow velocity of the air flow generated, by the fan, in a movement area within which the head moves is set to be in a range of 0.3 m/s to 0.5 m/s.

FIG. 1

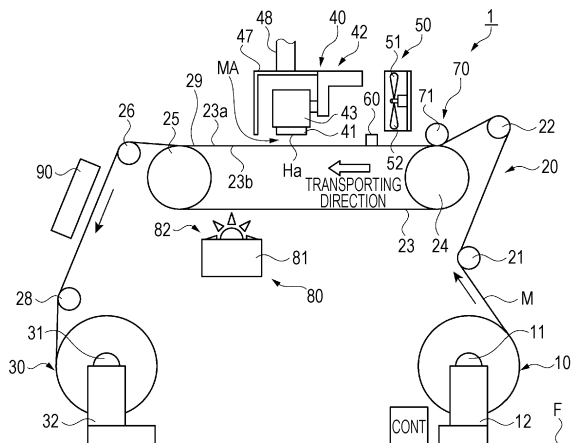

**EP 3 192 659 A3**



EUROPEAN SEARCH REPORT

Application Number  
EP 17 15 1260

5

10

15

20

25

30

35

40

45

50

55

DOCUMENTS CONSIDERED TO BE RELEVANT			
Category	Citation of document with indication, where appropriate, of relevant passages	Relevant to claim	CLASSIFICATION OF THE APPLICATION (IPC)
X	JP 2009 292129 A (SEIKO EPSON CORP) 17 December 2009 (2009-12-17) * paragraph [0055] * -----	1	INV. B41J3/407 B41J29/377 B41J2/17 B41J11/00
Y	US 2011/109693 A1 (OHNISHI MASARU [JP]) 12 May 2011 (2011-05-12) * paragraphs [0006], [0032], [0035], [0046], [0047]; figure 1 * -----	1-6	ADD. B41J25/308
Y	JP 2005 161758 A (CANON KK) 23 June 2005 (2005-06-23) * paragraphs [0002], [0018] * -----	1,5,6	
Y	US 5 541 626 A (HIRAMATSU AKIRA [JP] ET AL) 30 July 1996 (1996-07-30) * column 5, line 52 - column 10, line 62 * -----	2-4	
A	US 2008/253797 A1 (SAKAGAMI YUSUKE [JP]) 16 October 2008 (2008-10-16) * paragraph [0060] * -----	1-6	
			TECHNICAL FIELDS SEARCHED (IPC)
			B41J
The present search report has been drawn up for all claims			
Place of search The Hague		Date of completion of the search 28 August 2017	Examiner Joosting, Thetmar
CATEGORY OF CITED DOCUMENTS X : particularly relevant if taken alone Y : particularly relevant if combined with another document of the same category A : technological background O : non-written disclosure P : intermediate document T : theory or principle underlying the invention E : earlier patent document, but published on, or after the filing date D : document cited in the application L : document cited for other reasons & : member of the same patent family, corresponding document			

EPO FORM 1503 03.02 (P04C01)

ANNEX TO THE EUROPEAN SEARCH REPORT  
ON EUROPEAN PATENT APPLICATION NO.

EP 17 15 1260

5 This annex lists the patent family members relating to the patent documents cited in the above-mentioned European search report.  
The members are as contained in the European Patent Office EDP file on  
The European Patent Office is in no way liable for these particulars which are merely given for the purpose of information.

28-08-2017

Patent document cited in search report	Publication date	Patent family member(s)	Publication date
JP 2009292129 A	17-12-2009	NONE	
US 2011109693 A1	12-05-2011	CN 102066116 A	18-05-2011
		EP 2361774 A1	31-08-2011
		JP 5469857 B2	16-04-2014
		JP 2010137483 A	24-06-2010
		KR 20110016915 A	18-02-2011
		US 2011109693 A1	12-05-2011
		WO 2010070865 A1	24-06-2010
JP 2005161758 A	23-06-2005	NONE	
US 5541626 A	30-07-1996	DE 69303412 D1	08-08-1996
		DE 69303412 T2	02-01-1997
		EP 0566540 A2	20-10-1993
		US 5541626 A	30-07-1996
US 2008253797 A1	16-10-2008	US 2008253797 A1	16-10-2008
		US 2011285802 A1	24-11-2011