



(12) **EUROPEAN PATENT APPLICATION**
published in accordance with Art. 153(4) EPC

(43) Date of publication:
06.12.2017 Bulletin 2017/49

(21) Application number: **16708707.1**

(22) Date of filing: **28.01.2016**

(51) Int Cl.:
A47D 7/04 (2006.01) **A47C 29/00** (2006.01)
A47C 17/16 (2006.01) **A47C 20/04** (2006.01)
A47C 7/72 (2006.01) **A47C 7/74** (2006.01)
A47C 7/54 (2006.01)

(86) International application number:
PCT/ES2016/070047

(87) International publication number:
WO 2016/120512 (04.08.2016 Gazette 2016/31)

(84) Designated Contracting States:
AL AT BE BG CH CY CZ DE DK EE ES FI FR GB GR HR HU IE IS IT LI LT LU LV MC MK MT NL NO PL PT RO RS SE SI SK SM TR
Designated Extension States:
BA ME
Designated Validation States:
MA MD

(30) Priority: **30.01.2015 ES 201530101 U**

(71) Applicant: **Zazo Jordá, Ángel Manuel**
28013 Madrid (ES)

(72) Inventor: **Zazo Jordá, Ángel Manuel**
28013 Madrid (ES)

(74) Representative: **Pons**
Glorieta Ruben Dario 4
28010 Madrid (ES)

(54) **MULTIFUNCTIONAL PIECE OF FURNITURE**

(57) It comprises: a frame (1); and a soft resting body (2), leaning on and/or housed in the frame (1), to allow a user to rest, sitting or lying down. It also comprises: a folding backrest (3) and folding means (4) for selectively arranging the backrest (3) in at least two positions with respect to the frame (1). The backrest (3) incorporates: a chassis (5) pivotally connected to the frame (1); and at least one leaning element (6), connected to the chassis

(5) to enable a user (16) to lean at least one part of his or her body while sitting or lying down on the resting body (2). By incorporating the backrest (3) and folding means (4), a user may use the multifunctional furniture piece of in accordance with multiple functions, depending on whether the backrest (3) is in a retracted position or in a deployed position.

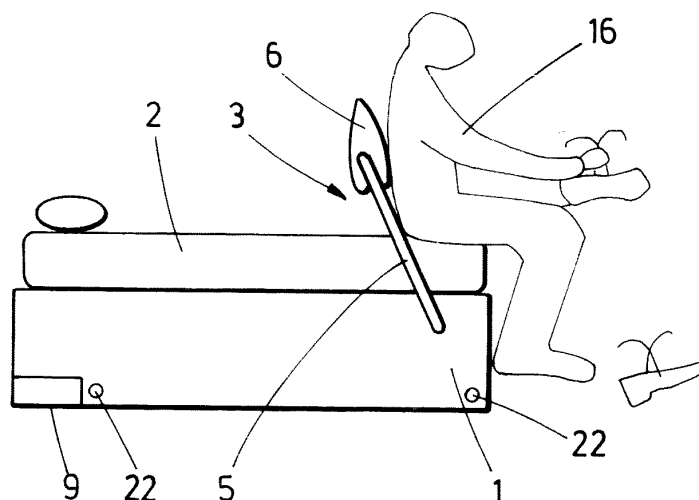

FIG.1

Description

OBJECT OF THE INVENTION

[0001] The present invention may be included in the field of furniture elements, specifically in the bed sector. In particular, the object of the invention relates to a multifunctional piece of furniture which allows a user to lean back while sitting on said piece of furniture.

BACKGROUND OF THE INVENTION

[0002] Within the aforementioned field of the art there are different types of pieces of furniture where each is indicated for certain uses and, therefore, is subject to certain limitations. In particular, for example: beds are destined for lying down, due to which they do not incorporate a backrest, as a result of which they are uncomfortable to use as a piece of furniture on which to sit down; chairs incorporate a backrest but the seat does not have sufficient length to lie down; non-folding or non-sleeper sofas make it possible to sit and lie down but are narrower than a bed; folding or sleeper sofas (also called "sofa beds") adopt sufficient width so as to sleep comfortably, but the mattress is of poorer quality than that of a bed, as it must be discontinuous, or too flexible.

DESCRIPTION OF THE INVENTION

[0003] The present invention describes a multifunctional piece of furniture comprising: a frame and a soft resting body supported by and/or housed in the frame, to enable a user to rest, for example, lying down or sitting on said resting body.

[0004] The multifunctional piece of furniture is characterised in that it additionally comprises a folding backrest which in turn comprises a chassis and at least one leaning element connected to the chassis, wherein the chassis of the backrest is pivotally connected to the frame of the multifunctional piece of furniture, through folding means, to position the backrest with respect to the frame in at least two positions. The leaning element allows a user to rest different parts of his or her body, in particular, different regions of the spine.

[0005] The multifunctional piece of furniture of the invention is designed to preferably be a bed, wherein the resting body is materialised in a mattress. However, it may be any other piece of furniture which enables a user to rest upon said piece of furniture without loss of generality. In particular, by way of an alternative, most preferred example, the piece of furniture is envisaged to be a bed bench, where the resting body is materialised in the seat of the bed bench.

[0006] Through the incorporation of the backrest and folding means, a user may use the multifunctional piece of furniture in accordance with multiple functions, depending on whether the backrest is in a retracted position or in a deployed position, as will be explained below in

the description of a preferred embodiment.

[0007] In particular, the multifunctional piece of furniture of the present invention has, in addition to the basic functionalities, such as lying down or sitting without a backrest, a broad range of added functionalities, namely:

- sitting or reclining, leaning against the backrest;
- reading, studying, watching television or untying shoes;
- sitting to use a nearby desk;
- holding objects;
- reading or watching television in bed without disturbing our partner, etc.

DESCRIPTION OF THE DRAWINGS

[0008] In order to complement the description being made and with the object of helping to better understand the characteristics of the invention, in accordance with a preferred embodiment thereof, said description is accompanied, as an integral part thereof, by a set of drawings where, in an illustrative and non-limiting manner, the following has been represented:

Figure 1 shows a view of an embodiment of a multifunctional piece of furniture in accordance with the invention, materialised in the form of a bed, wherein the backrest is oriented towards the interior of the bed in the deployed position.

Figure 2 shows a view of an embodiment of a bed in accordance with the invention wherein the backrest is oriented outwards from the bed in the deployed position.

Figure 3 shows a detailed view of another embodiment of a bed in accordance with the invention.

Figure 4 shows a side view of an embodiment of the invention, wherein a lamp and an armrest mounted on the chassis of the backrest can be observed.

Figure 5 shows a side view of an embodiment of the invention, wherein a suspension element wherefrom a carrycot is suspended can be observed.

Figure 6 shows a schematic view of an embodiment of the invention, wherein a fan fixed to the chassis and electrically connected through a connection box also fixed to the chassis can be observed.

Figure 7 shows a schematic view of an embodiment of the invention wherein a user may watch television or read in bed without disturbing his or her partner.

Figure 8 shows a schematic view of an example of embodiment of the invention wherein the incorporation of a mosquito net can be observed.

Figure 9 shows a schematic view of an example of embodiment of the invention wherein the backrest is retractable by sections.

Figure 10 shows a schematic view of an embodiment of the invention wherein the backrest comprises separable portions.

Figure 11 shows a schematic view of an embodiment

of the invention wherein the folding means is displaceable along the frame of the piece of furniture. Figure 12 shows a schematic view of an embodiment shown in figure 5, where the backrest additionally includes a supporting foot for resting on the ground.

PREFERRED EMBODIMENT OF THE INVENTION

[0009] Following, with the help of figures 1 to 12, is a more detailed description of a preferred embodiment of the present invention.

[0010] In the present description of a preferred example, a multifunctional piece of furniture in accordance with the present invention is represented, where the piece of furniture is a bed, due to being the most preferred example of the multifunctional piece of furniture in accordance with the present invention. Another, less preferred example and, thus, not represented, is a bed bench. The invention may be implemented, in general, in any type of piece of furniture destined, or adaptable, for being used as a resting piece of furniture.

[0011] The present example, therefore, presents a multifunctional bed which enables a user (16) to sit on the bed keeping his or her back leaning.

[0012] As shown in figures 1 and 2, the multifunctional bed of the invention comprises a frame (1), for example of the bed base or sofabed type, or of any other known type, as well as comprising a resting body (2) which, in the represented example, is a mattress housed in, or leaning on, the frame (1). The bed additionally comprises a folding backrest (3) pivotally connected to the frame (1), and folding means (4) for positioning the backrest (3) with respect to the frame (1) in at least two positions. The backrest (3) comprises a chassis (5) pivotally connected to the bed frame (1) through folding means (4). The backrest (3) additionally comprises at least one support element (6), connected to the chassis (5), which is preferably soft enough to allow the user (16) to lean certain regions of the spine, such as the lumbar region, dorsal region or cervical region. The support element (6) or support elements (6) are preferably pivotal with respect to the chassis (5) for increased user comfort (16).

[0013] When the bed frame (1) comprises frame centre bars and frame cross bars (not represented), for example in the case of frames (1) destined for supporting a bed base, the backrest (3) is preferably connected to the frame centre bars or frame cross bars.

[0014] The positions comprise a retracted position (not represented) wherein the backrest (3) is retracted, such that it does not prevent the user (16) from using the bed for lying down. Preferably, in the retracted position, the backrest (3) is folded towards the exterior of the bed and, more preferably, oriented towards the floor. In this regard, the backrest (3) may be folding, in order to occupy less space in the retracted position.

[0015] The positions additionally comprise at least one deployment position wherein the backrest (3) is deployed, enabling a user (16) to lean his or her back

against the backrest (3) while sitting on the mattress (2), as shown in figures 1 and 2. In the deployed position, the backrest (3) may be oriented towards the interior of the bed (as shown in figure 1) or towards the exterior of the bed (see figure 2). Likewise, the folding means (4) are preferably configured to define a plurality of deployment positions selectable by the user (16), wherein the backrest (3) is oriented at different angles to the frame (1), allowing the user (16) to adopt different inclination angles for increased comfort.

[0016] The backrest (3) is preferably mounted on one end of the bed frame (1), whether oriented lengthwise or transverse (according to width) to the frame (1) wherein, in the latter case, the backrest (3) may be mounted either at the foot or head of the bed. Figures 1 and 2 represent solutions wherein the backrest (3) is mounted at the foot of the bed.

[0017] According to figure 3, the chassis (5) of the backrest (3) preferably adopts a gantry configuration, wherein the chassis (5) comprises: chassis side bars (7) articulated with the bed frame (1) and one or more chassis cross bars (8) that connect the chassis side bars (7) and may also serve as a support for the leaning elements (6). The chassis cross bars (8) may also serve for other additional uses, such as, for example, for hanging clothes, when the backrest (3) is not being used as a backrest (3).

[0018] In accordance with an alternative embodiment, not represented, the chassis (5) may be configured in a P-shaped configuration, with a single chassis side bar (7), where the chassis side bar (7) is pivotal to a longitudinal direction of the chassis side bar (7) itself, making it possible to free space at will, which is useful, for example, when the multifunctional piece of furniture is a bed, since it makes it easier to make the bed. Likewise, in accordance with a variant, two backrests (3) may be disposed, each with its corresponding P-shaped chassis (5), disposed in opposition to each other on opposite sides of the multifunctional piece of furniture, independently operable from each another, in order to enable their use by different users, although they may also be connectable therebetween if desired.

[0019] The operation of the folding means (4) may be manual or, if desired, may be electric. In the case of electric operation, the folding means (4) may comprise a hand control (not represented), whether cable or wireless or, if desired, may incorporate a start/stop switch.

[0020] Additionally, the bed preferably incorporates a counterweight (9) (see figures 1 and 2) associated with the frame (1), for example, housed in the frame (1) and/or fixed to said frame (1) to prevent the bed from overturning due to the weight borne by the chassis (5) of the backrest (3).

[0021] Likewise, figure 3 shows that the bed may incorporate at least one separator (22), preferably a plurality of separators (22), disposed along one of the sides of the frame (1), to keep the bed separated from an adjacent wall. The arrangement of the separators (22) pro-

vides various advantageous effects, such as:

- determining a space between the bed and the wall to house the bed linen hanging from the lateral sides of the bed;
- facilitating the position of the bed with respect to the wall at a desired distance; and
- preventing the elements of the backrest (3) that protrude from the bed base from grazing the wall.

[0022] The chassis (5) of the backrest (3) may be used to additionally support certain accessories, as shown in figures 4, 5 and 6. For example:

- armrests (10) articulately connected to the chassis (5) (see figure 4); preferably, the armrests (10) are articulated, allowing a change in the direction of use of the backrest (3);
- lighting means (11), such as lamps (see figure 4);
- suspension elements (12) such as hooks, hangers or similar, to hang objects, such as baby (33) carry-cots (13) (see figure 5), bags with objects, etc.
- a fan (14);
- boxes (15) for electric or electronic connections (see figure 6), such as connection to the mains (19), telephone connection (not shown), Internet connection (20), connection to a radio or television antenna (21), Ethernet connection (not shown), etc., in order to, for example, be able to watch television on a small screen (17) or be able to connect a computer. In the example represented in figure 6, the box (15) has pins (18) for fixation thereof to the corresponding bar (7);
- a mosquito (25) net (24); in accordance with the example represented in figure 8, the chassis side bars (7) incorporate protruding rods (26), preferably made of flexible material, whereon a first end of the net (24) is mounted. Preferably, the net (24) may be suspended at a second end opposite the first end, for example, hanging from a wall or similar, such as by means of a hook (27). The installation of the net (24) prevents the user (16) from being annoyed by mosquitoes (25).

[0023] Other accessories not mentioned can also be borne by the chassis (5), depending on the functionality to be given to the multifunctional piece of furniture of the invention.

[0024] Likewise, the multifunctional piece of furniture, in particular, the bed, may incorporate a folding footrest (23), as shown in figure 7. Preferably, the footrest (23) is retractable inside the frame (1).

[0025] A multitude of solutions known to the person skilled in the art of the field of articulated joints are applicable for defining folding means (4) and their connection to the bed frame (1). In particular, by way of illustrative example, the following are mentioned, although not represented, in the figures: gears, interlocking mechanisms

(for example, of the ratchet type), threaded joints, springs, etc.

[0026] Similar considerations are applicable, for example, in the case of joints, to the chassis (5), of the leaning elements (6) or armrests (10). Preferably, joints comprising a plurality of interlocking points, such as ratchet mechanisms (not represented), are selected, although there are other possible solutions within reach of the person skilled in the art.

[0027] In any of the embodiments described herein, the leaning elements (6) are connected to the chassis (5) in a preferably detachable manner.

[0028] Figure 9 shows an embodiment, which is compatible at least with any of the embodiments shown in figures 1-5, wherein the backrest (3) is retractable by sections. Specifically, figure 9 illustrates a particular example wherein the chassis (5) of the backrest (3) comprises at least two sections (28) telescopically displaceable with respect to each other in order to retract one of the sections (28) with respect to the other. By means of the aforementioned characteristic, a reduction in the volume occupied by the backrest (3) is obtained, whereupon a greater amount of available space is obtained, which is particularly useful in small rooms, while providing a less invasive visual appearance. In order to enhance space savings, when a pair of adjacent sections (28) comprise respective leaning elements (6), some of said leaning elements (6) may incorporate housings (34) or cavities for housing the leaning element (6) of the adjacent section (28) at least partially.

[0029] Figure 10 illustrates an additional embodiment, compatible with all the described embodiments, wherein the backrest (3) comprises at least two separably connected portions (29, 30). Specifically, figure 10 shows a particular example of embodiment wherein the backrest (3) comprises: a first portion (29), connected to the folding means (4), and a second portion (30) which is separably connected to the first portion (29), for example, by means of clipping.

[0030] Likewise, figure 11 shows an additional preferred embodiment, also compatible with all the previously described embodiments, to the extent that they refer to a P-shaped backrest (3), i.e. having a chassis (5) endowed with a chassis side bar (7) only on one side. In the case mentioned in figure 11, in addition to, as mentioned in more general embodiments, the folding means (4) being connected to the chassis (5), enabling the chassis (5) to rotate about a horizontal axis, the folding means (4) are displaceably connected along the bed frame (1), in order to arrange the backrest (3) selectively on either of the two adjacent sides of the frame (1), for example, on either side of the head/foot, in the case of a bed.

[0031] Even more preferably, the frame (1) additionally comprises, in one corner (31), guides (36), wherein the folding means (4) are displaceable along the guides (36). By way of illustrative example, the folding means (4) may incorporate releasable fixations (37, 38) which cooperatively enable the fixation of folding means (4) to the guides

(36) in the desired positions.

[0032] Lastly, figure 12 describes an additional embodiment compatible with the embodiment shown in figure 5, to enable a baby (33) to sleep next to its parents' bed within minimum space requirements. Specifically, in the embodiment shown in figure 5, the carrycot (13) is suspended by means of cables (35), chains or similar so as to enable rocking thereof. Additionally, it may be complemented, in accordance with that shown in figure 12, with a supporting foot (32) which allows the backrest (3) to lean on the floor to ensure the baby's (33) safety. The embodiment shown in figure 12 is preferably more compatible with those in which the backrest (3) is P-shaped. In the case of the particular example of figure 12, the leaning elements (6) are preferably disassembled, although it is not essential, and it is possible to adapt the configuration and horizontal rotation of the leaning elements (6) so as to provide sufficient space to rock the carrycot (13).

Claims

1. A multifunctional piece of furniture, which comprises:

- a frame (1); and
- a soft resting body (2), leaning on and/or housed in the frame (1), to allow a user to rest, sitting or lying down;

wherein the multifunctional piece of furniture is **characterised in that** it additionally comprises:

- a folding backrest (3), comprising:
 - a chassis (5) pivotally connected to the frame (1); and
 - at least one leaning element (6), connected to the chassis (5) so as to allow a user (16) to lean at least one part of his or her body on the resting body (2) while sitting or lying down; and
- folding means (4) for selectively arranging the backrest (3) in at least two positions with respect to the frame (1).

2. The multifunctional piece of furniture, according to claim 1, **characterised in that** the positions comprise a retracted position, wherein the backrest (3) is retracted without preventing the user (16) from lying down on the mattress (2).

3. The multifunctional piece of furniture, according to claim 2, **characterised in that**, in the retracted position, the backrest (3) is folded towards the exterior of the frame (1).

4. The multifunctional piece of furniture, according to claim 3, **characterised in that**, in the retracted position, the backrest (3) is oriented towards the floor.

5. The multifunctional piece of furniture, according to claim 1, **characterised in that** the backrest (3) is folding so as to occupy less space in the retracted position.

6. The multifunctional piece of furniture, according to claim 1, **characterised in that** the positions additionally comprise at least one deployment position, wherein the backrest (3) is deployed, allowing the user (16) to lean his or her back against the backrest (3) while sitting or lying down on the resting body (2).

7. The multifunctional piece of furniture, according to claim 6, **characterised in that** the folding means (4) are configured to define a plurality of deployment positions selectable by the user (16), which are oriented at different angles to the frame (1).

8. The multifunctional piece of furniture, according to claim 1, **characterised in that** the leaning element (6) or leaning elements (6) are configured and disposed such as to allow the user (16) to lean at least one region of the spine selected from a list consisting of: lumbar region, dorsal region and cervical region.

9. The multifunctional piece of furniture, according to any one of claims 1 and 8, **characterised in that** the leaning elements (6) are pivotal with respect to the chassis (5).

10. The multifunctional piece of furniture, according to claim 1, **characterised in that** the backrest (3) is mounted on one end of the frame (1) and oriented towards the longitudinal direction of the frame (1).

11. The multifunctional piece of furniture, according to claim 1, **characterised in that** the backrest (3) is assembled on one end of the frame (1) and oriented in the transverse direction of the frame (1).

12. The multifunctional piece of furniture, according to claim 1, **characterised in that** the chassis (5) of the backrest (3) adopts a framed configuration, wherein said chassis (5) comprises chassis side bars (7) articulated with the bed frame (1); and one or more chassis cross bars (8) connected to the chassis side bars (7).

13. The multifunctional piece of furniture, according to claim 12, **characterised in that** the leaning elements (6) lean on the chassis side bars (7).

14. The multifunctional piece of furniture, according to claim 1, **characterised in that** the chassis (5) of the

- backrest (3) adopts a P-shaped configuration with one single chassis side bar (7).
15. The multifunctional piece of furniture, according to claim 14, **characterised in that** the chassis side bar (7) is pivotal lengthwise to the chassis side bar (7) itself. 5
 16. The multifunctional piece of furniture, according to any one of claims 14 and 15, **characterised in that** it comprises two backrests (3) having respective P-shaped chassis (5), disposed in opposition to each other on opposite sides of the multifunctional piece of furniture. 10
 17. The multifunctional piece of furniture, according to claim 16, **characterised in that** the two chassis (5) are connectable for being jointly operated. 15
 18. The multifunctional piece of furniture, according to claim 1, **characterised in that** the folding means (4) are manually operated. 20
 19. The multifunctional piece of furniture, according to claim 1, **characterised in that** the folding means (4) are electrically operated. 25
 20. The multifunctional piece of furniture, according to claim 19, **characterised in that** it incorporates an electric start/stop switch for operating the electric folding means (4). 30
 21. The multifunctional piece of furniture, according to claim 19, **characterised in that** the folding means (4) comprise a hand control. 35
 22. The multifunctional piece of furniture, according to any one of claims 1 and 12, **characterised in that** it additionally incorporates, leaning on the chassis (5) of the backrest (3), at least one accessory element selected from among a list consisting of: 40
 - a mosquito (25) net (24);
 - armrests (10) articulately connected to the chassis (5); 45
 - lighting means (11);
 - suspension elements (12) for hanging objects on the backrest;
 - a fan (14); and
 - boxes (15) for electric or electronic connections. 50
 23. The multifunctional piece of furniture, according to claim 22, **characterised in that** the chassis side bars (7) incorporate protruding rods (26) preferably made of flexible material, configured to mount a first end of the net (24). 55
 24. The multifunctional piece of furniture, according to claim 1, **characterised in that** it additionally incorporates a counterweight (9), connected to the frame (1), to prevent the bed from overturning due to the effect of the weight borne by the chassis (5) of the backrest (3).
 25. The multifunctional piece of furniture, according to claim 1, **characterised in that** it additionally incorporates at least one separator (22) for keeping the frame (1) separated with respect to an adjacent wall.
 26. The multifunctional piece of furniture, according to claim 1, **characterised in that** it additionally incorporates a footrest (23).
 27. The multifunctional piece of furniture, according to any one of claims 1 to 26, **characterised in that** it is a bed, wherein the resting body (2) is a mattress.
 28. The multifunctional piece of furniture, according to any one of claims 1 to 26, **characterised in that** it is a bed bench, wherein the resting body (2) is a seat.
 29. The multifunctional piece of furniture, according to claim 1, **characterised in that** the backrest (3) is retractable by sections.
 30. The multifunctional piece of furniture, according to claim 29, **characterised in that** the chassis (5) of the backrest (3) comprises at least two sections (28) telescopically displaceable with respect to each other in order to retract one of the sections (28) with respect to the other.
 31. The multifunctional piece of furniture, according to any one of claims 29-30, **characterised in that** a pair of adjacent sections (28) comprise respective leaning elements (6), wherein one or some of said leaning elements (6) incorporates housings (34) or cavities for housing the leaning element (6) of the adjacent section (28) at least partially.
 32. The multifunctional piece of furniture, according to claim 1, **characterised in that** the backrest (3) comprises at least two separably connected portions (29, 30).
 33. The multifunctional piece of furniture, according to claim 32, **characterised in that** the portions (29, 30) comprise: a first portion (29), connected to the folding means (4), and a second portion (30) which is separably connected to the first portion (29).
 34. The multifunctional piece of furniture, according to any one of claims 14-17, **characterised in that** the folding means (4) are displaceably connected along the frame (1) of the piece of furniture, in order to

selectively arrange the backrest (3) on either of the two adjacent sides of the frame (1).

35. The multifunctional piece of furniture, according to claim 34, **characterised in that** the frame (1) additionally comprises, in one corner (31), guides (36), wherein the folding means (4) are displaceable along the guides (36). 5
36. The multifunctional piece of furniture, according to claim 32, **characterised in that** the folding means (4) incorporate releasable fixations (37, 38) which make it possible to cooperatively fix the folding means (4) to the guides (36) in the desired positions. 10 15
37. The multifunctional piece of furniture, according to claim 22, **characterised in that** the suspension element (12) comprises a baby (33) carrycot (13), wherein the carrycot (13) is suspended by means of cables (35), chains or similar, so as to enable rocking thereof. 20
38. The multifunctional piece of furniture, according to claim 37, **characterised in that** the backrest (3) additionally comprises a supporting foot (32) disposed at the free end of the chassis (5), which allows the backrest (3) to rest on the floor. 25
39. The multifunctional piece of furniture, according to any one of the preceding claims, **characterised in that** the leaning elements (6) are detachably connected to the chassis (5). 30

35

40

45

50

55

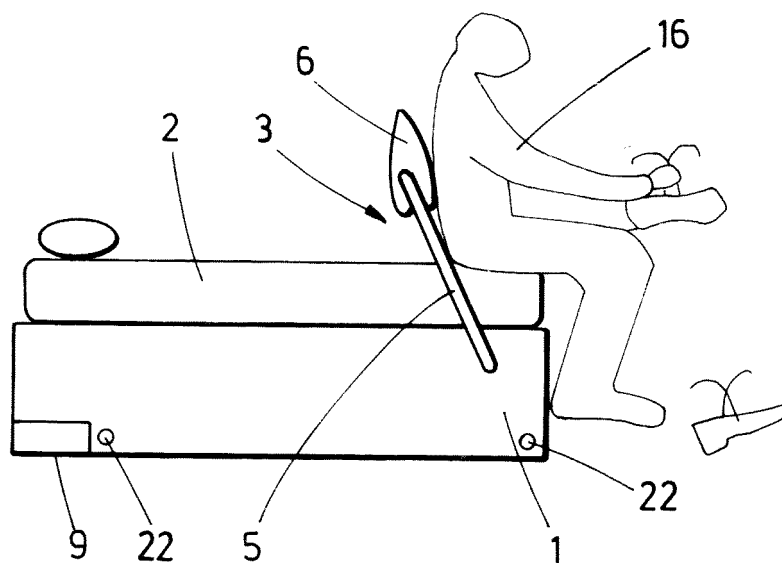

FIG. 1

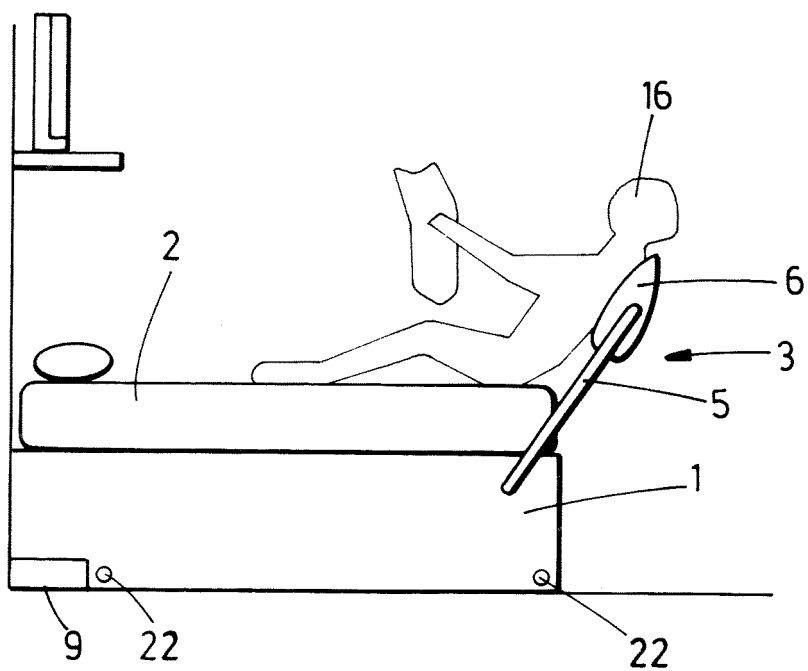

FIG. 2

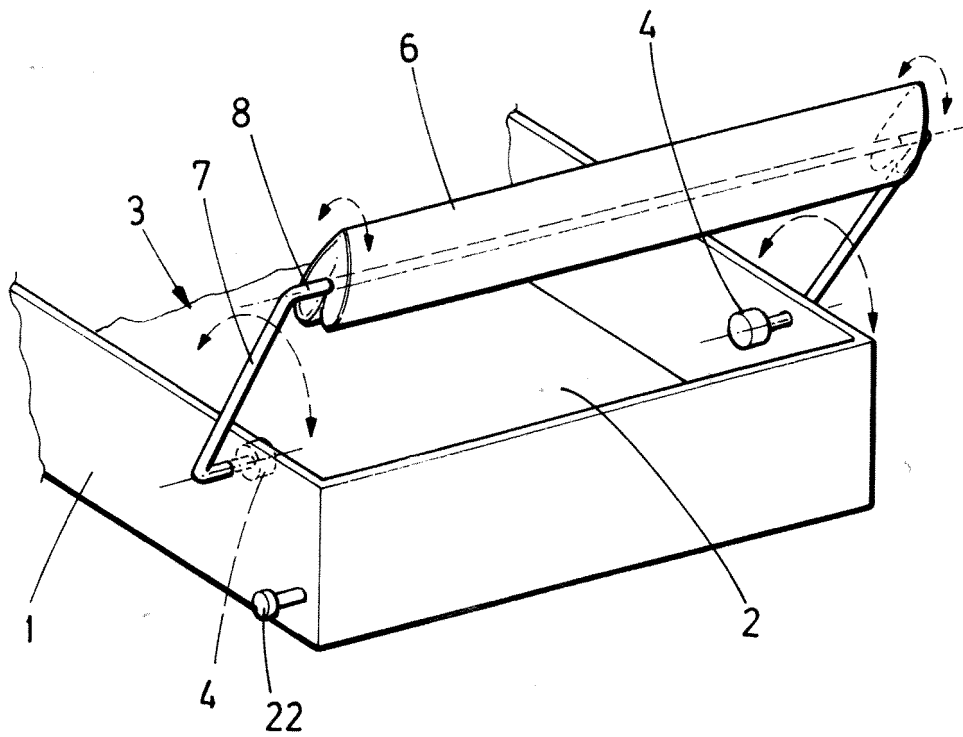

FIG.3

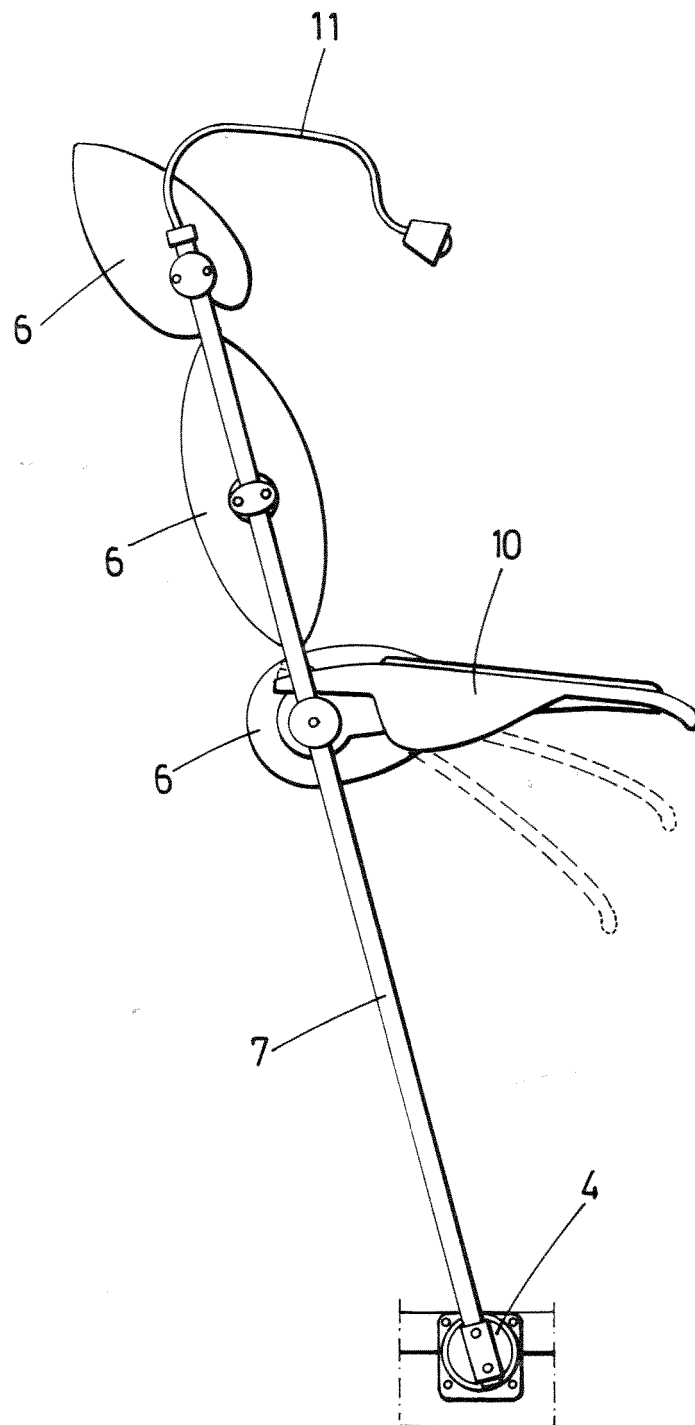

FIG.4

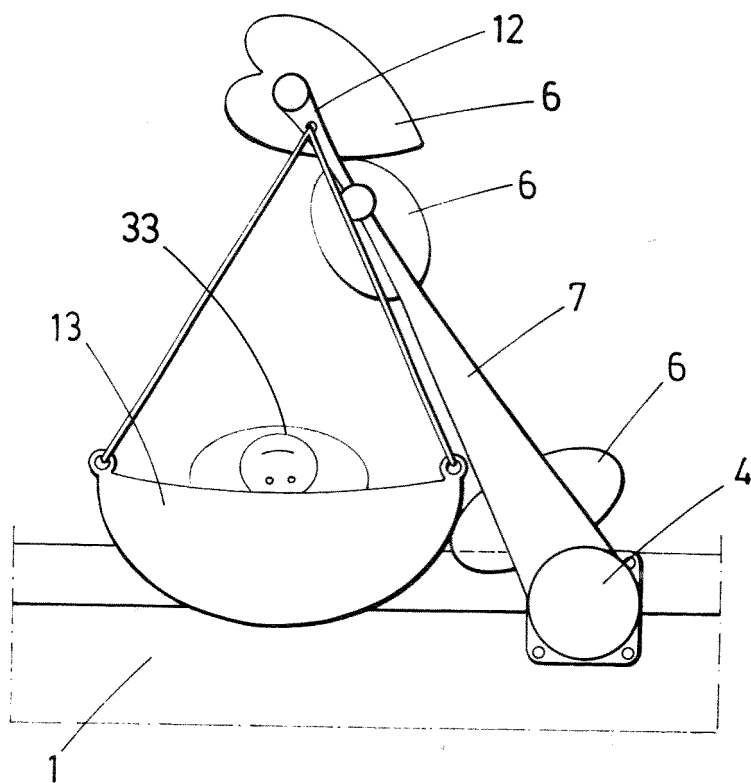

FIG.5

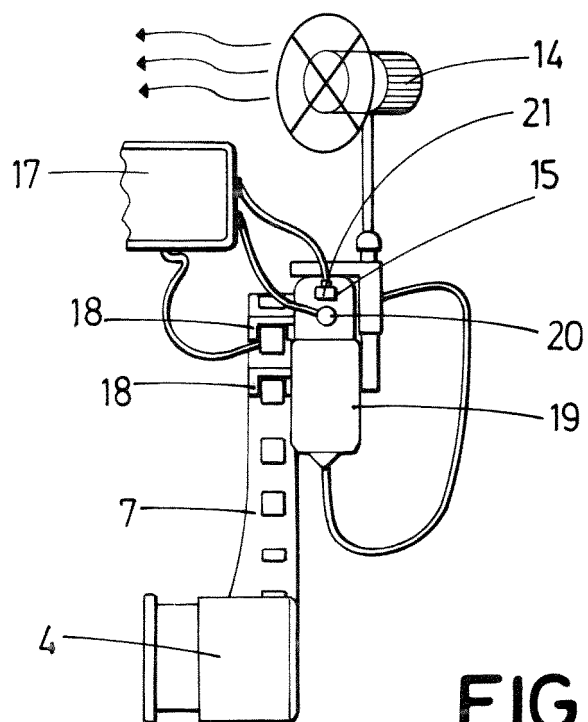

FIG.6

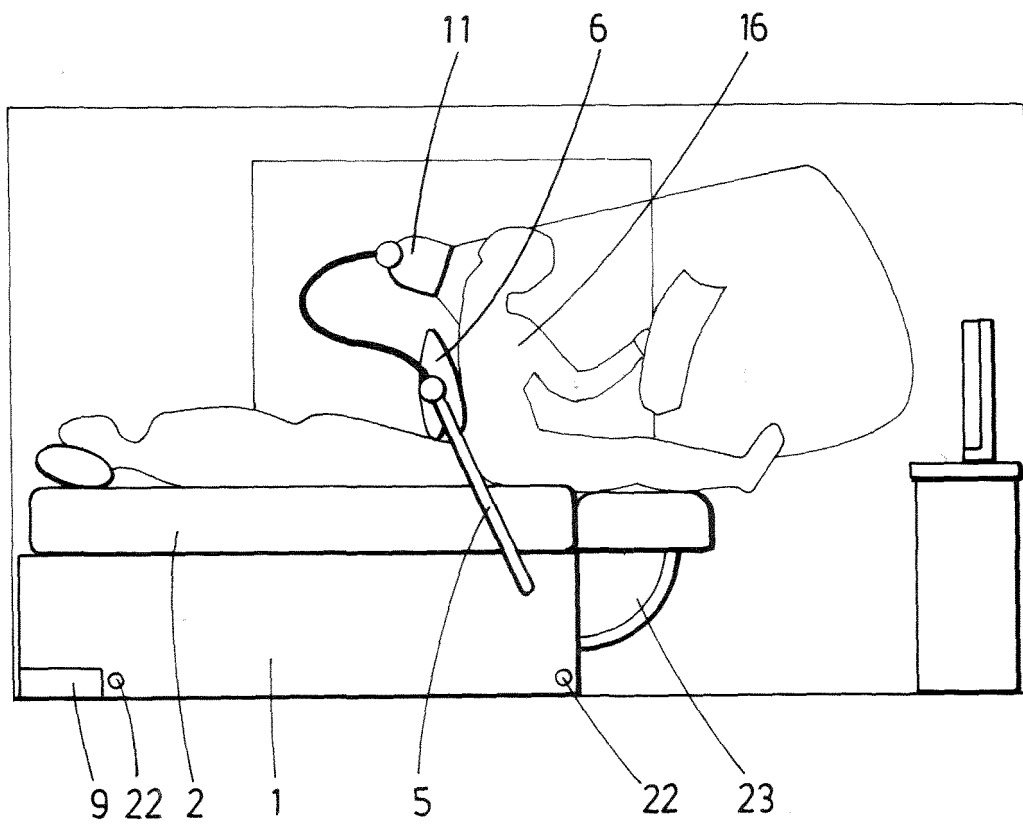

FIG.7

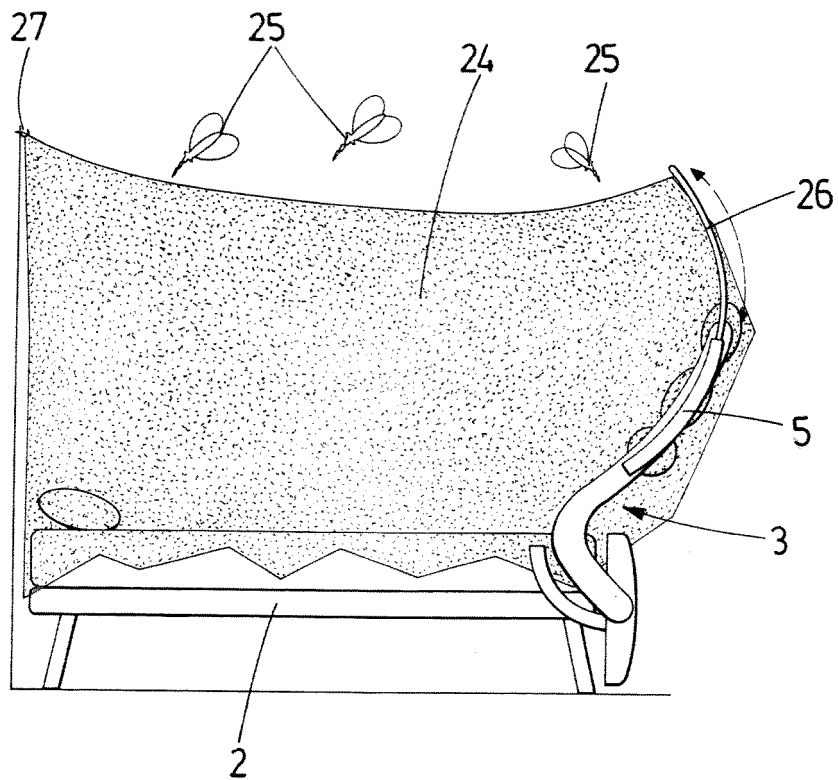

FIG.8

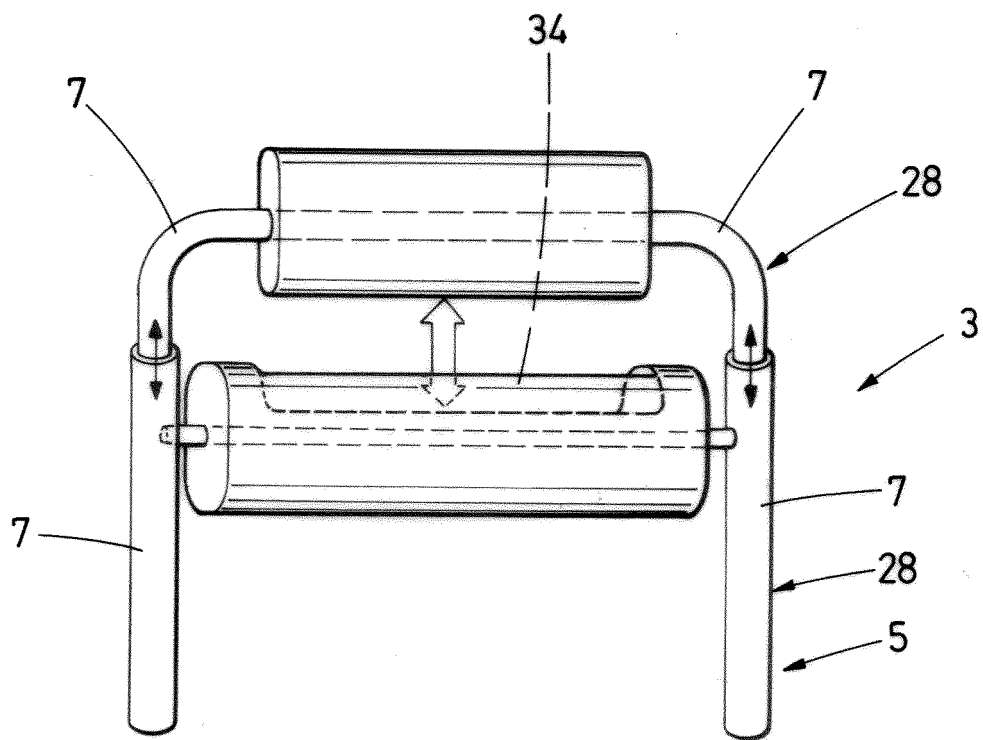

FIG.9

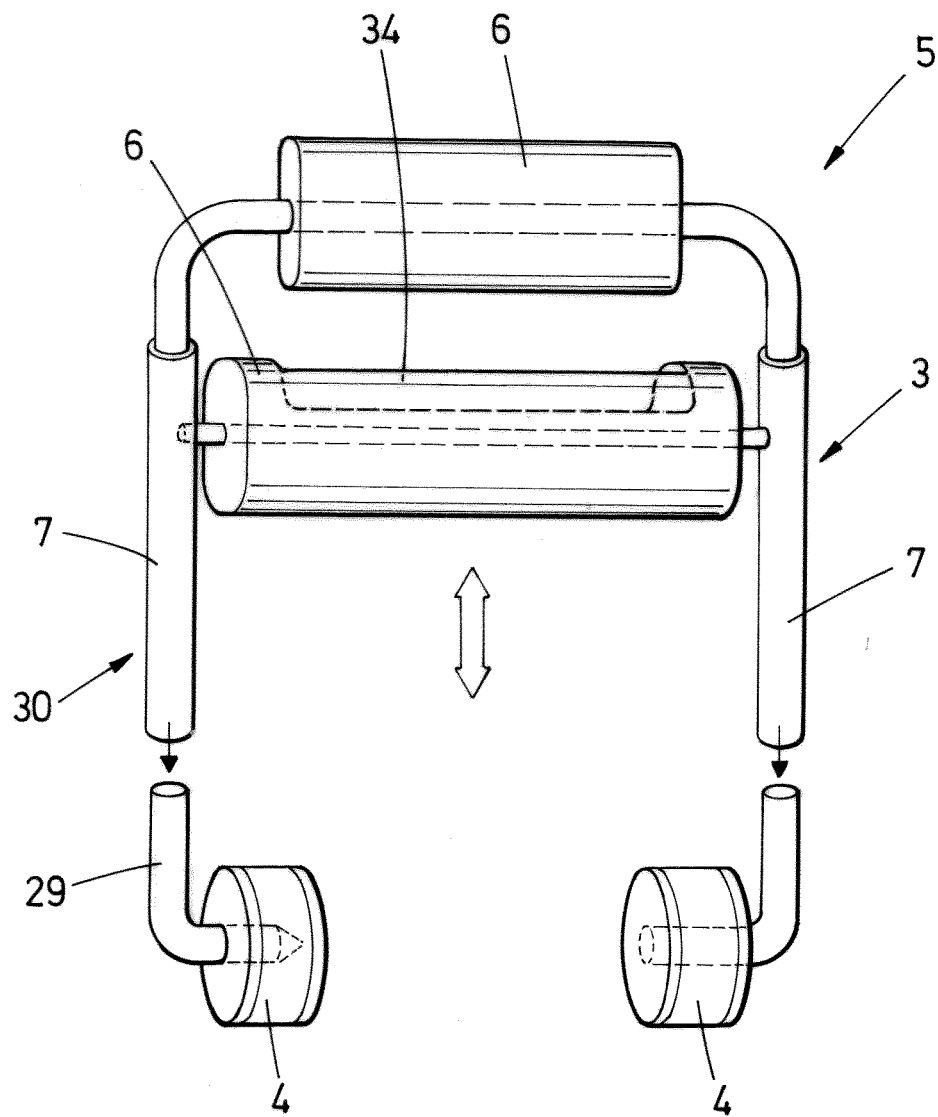

FIG.10

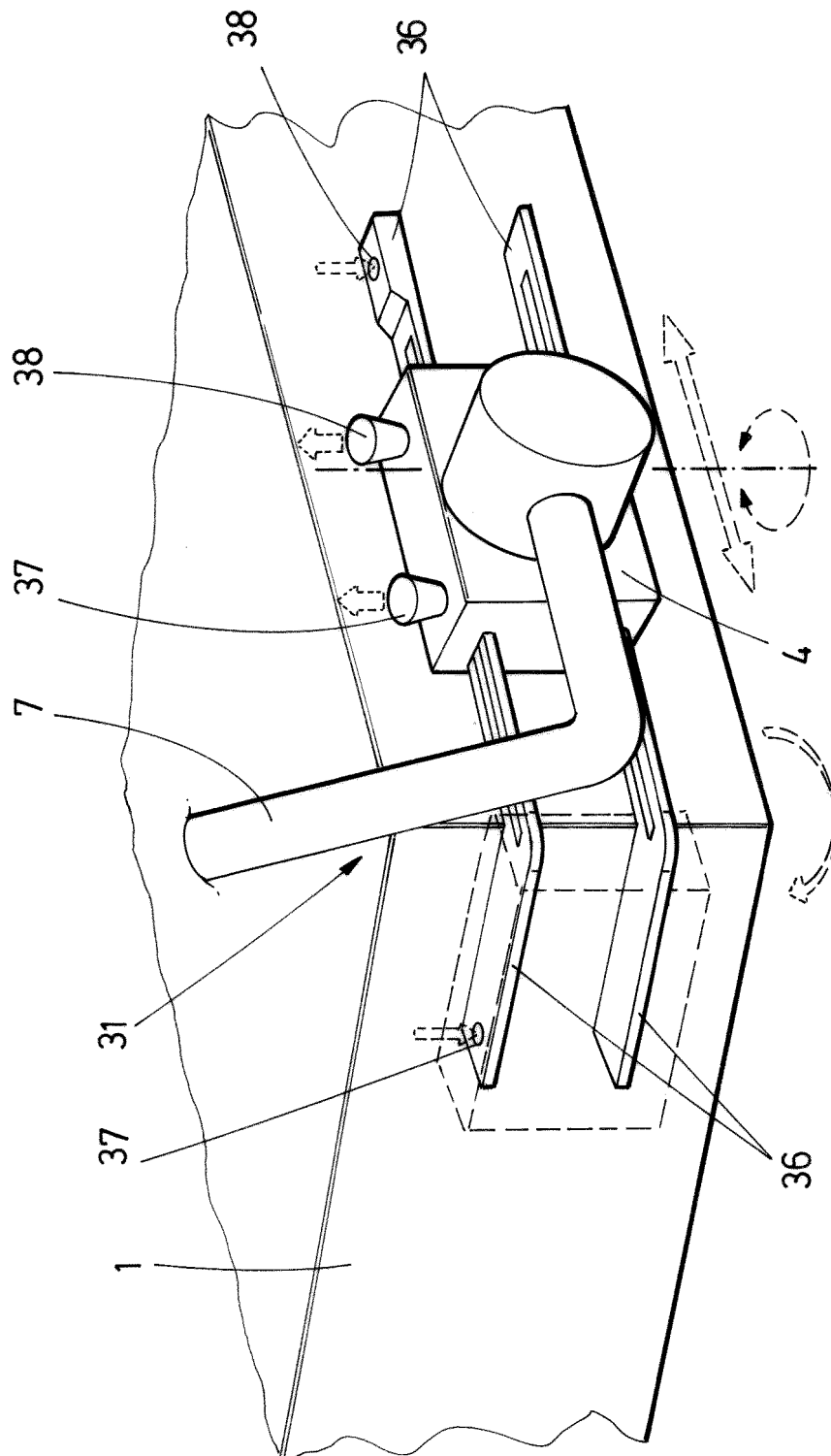

FIG.11

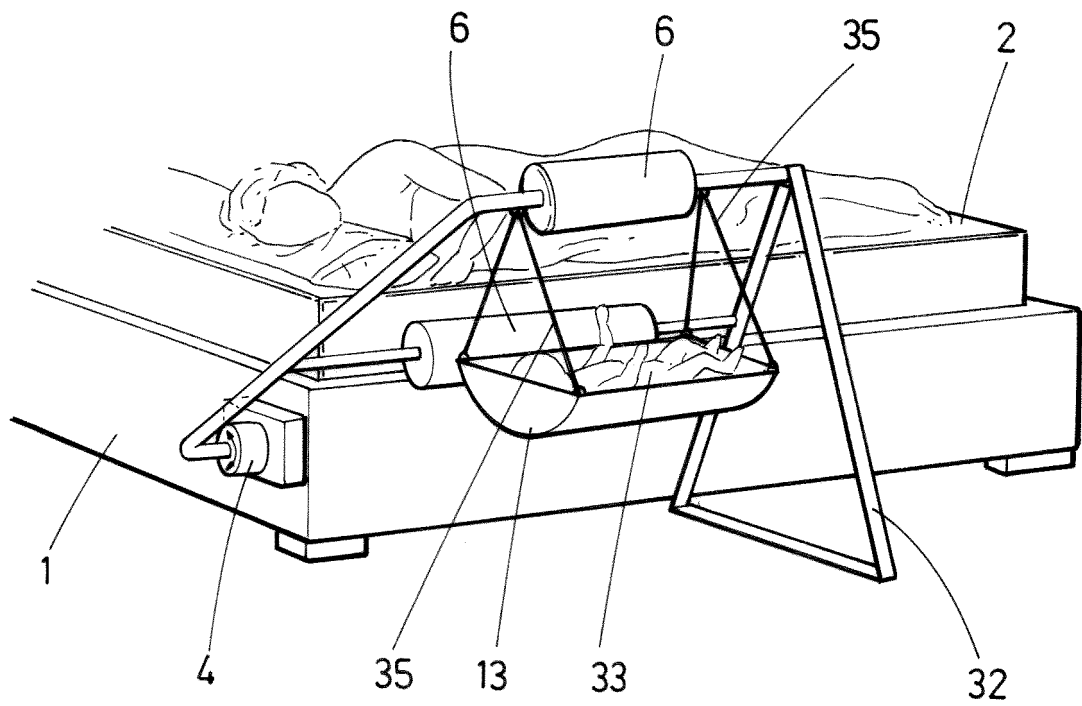

FIG.12

INTERNATIONAL SEARCH REPORT

International application No
PCT/ES2016/070047

A. CLASSIFICATION OF SUBJECT MATTER

INV. A47D7/04 A47C29/00 A47C17/16 A47C20/04 A47C7/72
A47C7/74 A47C7/54

ADD.

According to International Patent Classification (IPC) or to both national classification and IPC

B. FIELDS SEARCHED

Minimum documentation searched (classification system followed by classification symbols)

A47D A47C

Documentation searched other than minimum documentation to the extent that such documents are included in the fields searched

Electronic data base consulted during the international search (name of data base and, where practicable, search terms used)

EPO-Internal, WPI Data

C. DOCUMENTS CONSIDERED TO BE RELEVANT

Category*	Citation of document, with indication, where appropriate, of the relevant passages	Relevant to claim No.
X	EP 0 573 671 A1 (KASHIMA, H.; KASHIMA, O.) 15 December 1993 (1993-12-15) column 16, lines 22-37; figures -----	1-3, 5-10, 18-21, 27-36,39
X	US 2 412 329 A (FOX) 10 December 1946 (1946-12-10) figures -----	1-6,8, 10,12, 13,18, 27,28,39
X	CH 511 005 A (WEISS) 15 August 1971 (1971-08-15) figures ----- -/-	1-3, 5-10,12, 13,18, 25-29

☒ Further documents are listed in the continuation of Box C.

☒ See patent family annex.

* Special categories of cited documents :

"A" document defining the general state of the art which is not considered to be of particular relevance

"E" earlier application or patent but published on or after the international filing date

"L" document which may throw doubts on priority claim(s) or which is cited to establish the publication date of another citation or other special reason (as specified)

"O" document referring to an oral disclosure, use, exhibition or other means

"P" document published prior to the international filing date but later than the priority date claimed

"T" later document published after the international filing date or priority date and not in conflict with the application but cited to understand the principle or theory underlying the invention

"X" document of particular relevance; the claimed invention cannot be considered novel or cannot be considered to involve an inventive step when the document is taken alone

"Y" document of particular relevance; the claimed invention cannot be considered to involve an inventive step when the document is combined with one or more other such documents, such combination being obvious to a person skilled in the art

"&" document member of the same patent family

Date of the actual completion of the international search

21 April 2016

Date of mailing of the international search report

02/05/2016

Name and mailing address of the ISA/

European Patent Office, P.B. 5818 Patentlaan 2
NL - 2280 HV Rijswijk
Tel. (+31-70) 340-2040,
Fax: (+31-70) 340-3016

Authorized officer

Kis, Pál

INTERNATIONAL SEARCH REPORT

International application No
PCT/ES2016/070047

C(Continuation). DOCUMENTS CONSIDERED TO BE RELEVANT		
Category*	Citation of document, with indication, where appropriate, of the relevant passages	Relevant to claim No.
X	DE 44 32 615 A1 (SACHSENPOLSTER GMBH) 21 March 1996 (1996-03-21) column 2, lines 5-7; figures -----	1-3,5-8, 10,11, 19-21, 26,28, 34,35
X	GB 349 769 A (GUSTAV KUEHN) 4 June 1931 (1931-06-04) column 1, paragraph 2; figures -----	1-3,6,8, 11,18, 22,24, 26,28
X	GB 1 494 728 A (MONTROSE B) 14 December 1977 (1977-12-14) figures -----	1-3,5-8, 10-13, 18,22, 26,28, 32,39
A	US 559 186 A (MAUERMAN; WUNDERLICH) 28 April 1896 (1896-04-28) figures -----	37,38

Form PCT/ISA/210 (continuation of second sheet) (April 2005)

INTERNATIONAL SEARCH REPORT

Information on patent family members

International application No

PCT/ES2016/070047

Patent document cited in search report	Publication date	Patent family member(s)	Publication date
EP 0573671 A1	15-12-1993	EP 0573671 A1 TW 217379 B US 5517706 A WO 9312695 A1	15-12-1993 11-12-1993 21-05-1996 08-07-1993
US 2412329 A	10-12-1946	GB 625793 A US 2412329 A	04-07-1949 10-12-1946
CH 511005 A	15-08-1971	CH 511005 A DE 2134068 A1	15-08-1971 23-03-1972
DE 4432615 A1	21-03-1996	NONE	
GB 349769 A	04-06-1931	NONE	
GB 1494728 A	14-12-1977	CH 582499 A5 DE 2446144 A1 DE 7432481 U ES 229794 U FR 2246242 A1 GB 1494728 A IT 1020885 B JP S5245448 A US 3972562 A	15-12-1976 03-04-1975 02-02-1978 01-12-1977 02-05-1975 14-12-1977 30-12-1977 09-04-1977 03-08-1976
US 559186 A	28-04-1896	NONE	

Form PCT/ISA/210 (patent family annex) (April 2005)