



(12) **EUROPEAN PATENT APPLICATION**

(88) Date of publication A3:  
**09.01.2019 Bulletin 2019/02**

(51) Int Cl.:  
**B26B 21/56 (2006.01)** **B26B 21/22 (2006.01)**  
**B26B 21/40 (2006.01)**

(43) Date of publication A2:  
**26.09.2018 Bulletin 2018/39**

(21) Application number: **18167402.9**

(22) Date of filing: **08.10.2012**

(84) Designated Contracting States:  
**AL AT BE BG CH CY CZ DE DK EE ES FI FR GB GR HR HU IE IS IT LI LT LU LV MC MK MT NL NO PL PT RO RS SE SI SK SM TR**

(30) Priority: **06.10.2011 PCT/EP2011/067451**

(62) Document number(s) of the earlier application(s) in accordance with Art. 76 EPC:  
**12769444.6 / 2 763 823**

(71) Applicant: **BIC-Violex S.A.**  
**145 69 Anixi, Attiki (GR)**

(72) Inventors:  
• **DAVOS, Vasileios**  
**131 21 ILION (GR)**

- **PAPACHRISTOS, Vassilis**  
**157 73 ATHENES (GR)**
- **EFTHIMIADIS, Dimitrios**  
**114 76 Nea Kypseli (GR)**
- **ZAFIROPOULOS, Panagiotis**  
**115 24 Nea Philothei - Athens (GR)**
- **SKOUNAKIS, Nikolaos**  
**142 33 Perissos (GR)**
- **KOMIANOS, Ioannis**  
**121 35 PERISTERI (GR)**
- **KARO USSIS, Michalis**  
**141 22 ATHENES (GR)**
- **PAPAGEORGIU, Anastasios**  
**121 36 PERISTERI (GR)**

(74) Representative: **Cabinet Plasseraud**  
**66, rue de la Chaussée d'Antin**  
**75440 Paris Cedex 09 (FR)**

(54) **RAZOR BLADE, RAZOR HEAD, AND METHOD OF MANUFACTURE**

(57) A razor head 5 comprising a housing 10 having a top face defining a shaving window, and an opposed stopping face, the housing further comprising at least one guide 45, at least one integrally formed rigid razor blade 24, each freely mounted in the housing, and having a cutting edge portion 39 extending along a cutting edge portion axis, and having a cutting edge 26 accessible through the shaving window, a guided portion 35 extending along a guided portion axis, and a bent portion 53 intermediate the cutting edge portion and the guided portion, wherein the cantilever dimension, measured as the distance between the cutting edge and the guided portion axis, is between 1.1 millimeter and 1.8 millimeter, wherein the guided portion cooperates with the guide so that each blade is independently translatable with respect to the housing along a sliding direction parallel to the guided portion axis, under the effect of shaving forces applied to the blade during shaving.

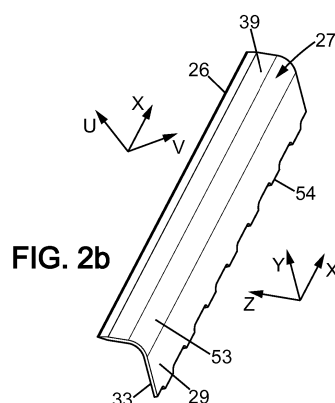

**FIG. 3b**

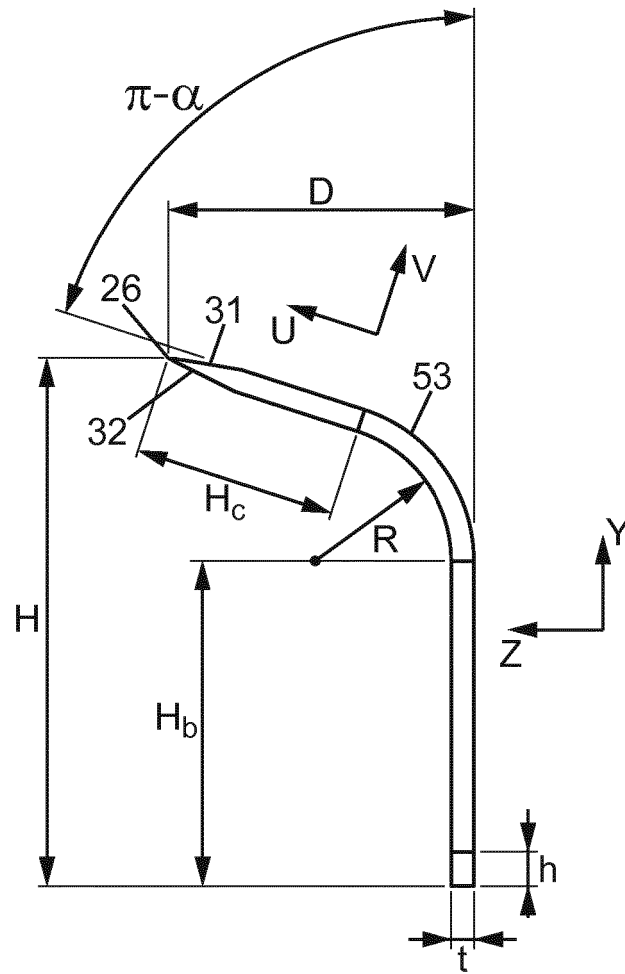



## EUROPEAN SEARCH REPORT

 Application Number  
 EP 18 16 7402

5

10

15

20

25

30

35

40

45

50

55

DOCUMENTS CONSIDERED TO BE RELEVANT			
Category	Citation of document with indication, where appropriate, of relevant passages	Relevant to claim	CLASSIFICATION OF THE APPLICATION (IPC)
X,D	US 5 010 646 A (NEAMTU NICOLAE [US]) 30 April 1991 (1991-04-30)	1,2,5,6,11	INV. B26B21/56
Y	* column 2, line 41 - column 3, line 63;	3,4	B26B21/22
A	figures 1-4 *	7-10	B26B21/40
Y	US 4 498 235 A (JACOBSON CHESTER F [US]) 12 February 1985 (1985-02-12)	3	
	* column 3, lines 45-60; figures 1, 2, 7 *		
Y,D	US 2007/234577 A1 (MASEK WILLIAM [US] ET AL) 11 October 2007 (2007-10-11)	4	
	* paragraph [0044]; figures 2A-2C *		
X,P	WO 2012/006043 A1 (GILLETTE CO [US]; PETERSON MARK [GB]) 12 January 2012 (2012-01-12)	1,2,4,5	
	* page 4, line 22 - page 6, line 2;		
	figures 1-4 *		
	* page 3, lines 25-29 *		
	* page 9, lines 13-15 *		
A	US 2007/234576 A1 (MASEK WILLIAM [US] ET AL) 11 October 2007 (2007-10-11)	1-7	TECHNICAL FIELDS SEARCHED (IPC) B26B B21D
	* paragraphs [0035] - [0037]; figures 2A-2C *		
A	WO 2009/137389 A1 (EVEREADY BATTERY INC [US]; BYKOWSKI HENRYK [DE]; FISCHER STEPHAN [DE];) 12 November 2009 (2009-11-12)	1-7	
	* page 5, line 10 - page 7, line 5;		
	figures 1-7 *		
A	GB 548 647 A (GEORGE THEOPHILUS MONEY) 19 October 1942 (1942-10-19)	1-10	
	* page 1, line 70 - page 2, line 21;		
	figures 1-8 *		
	-/--		
The present search report has been drawn up for all claims			
Place of search Munich		Date of completion of the search 3 December 2018	Examiner Rattenberger, B
CATEGORY OF CITED DOCUMENTS		T : theory or principle underlying the invention E : earlier patent document, but published on, or after the filing date D : document cited in the application L : document cited for other reasons & : member of the same patent family, corresponding document	
X : particularly relevant if taken alone Y : particularly relevant if combined with another document of the same category A : technological background O : non-written disclosure P : intermediate document			

EPO FORM 1503 03.82 (P04C01)



## EUROPEAN SEARCH REPORT

Application Number  
EP 18 16 7402

5

10

15

20

25

30

35

40

45

50

55

DOCUMENTS CONSIDERED TO BE RELEVANT			
Category	Citation of document with indication, where appropriate, of relevant passages	Relevant to claim	CLASSIFICATION OF THE APPLICATION (IPC)
A	US 1 734 554 A (BEHRMAN MARCUS B) 5 November 1929 (1929-11-05) * page 2, lines 19-116; figures 1-6 *	8-10	
A	US 2010/077618 A1 (PETERSON MARK [GB]) 1 April 2010 (2010-04-01) * paragraph [0024]; figure 6 *	8-11	
The present search report has been drawn up for all claims			TECHNICAL FIELDS SEARCHED (IPC)
Place of search Munich		Date of completion of the search 3 December 2018	Examiner Rattenberger, B
CATEGORY OF CITED DOCUMENTS			
X : particularly relevant if taken alone Y : particularly relevant if combined with another document of the same category A : technological background O : non-written disclosure P : intermediate document		T : theory or principle underlying the invention E : earlier patent document, but published on, or after the filing date D : document cited in the application L : document cited for other reasons & : member of the same patent family, corresponding document	

EPO FORM 1503 03.82 (P04C01)



Application Number

EP 18 16 7402

**CLAIMS INCURRING FEES**

The present European patent application comprised at the time of filing claims for which payment was due.

☐ Only part of the claims have been paid within the prescribed time limit. The present European search report has been drawn up for those claims for which no payment was due and for those claims for which claims fees have been paid, namely claim(s):

☐ No claims fees have been paid within the prescribed time limit. The present European search report has been drawn up for those claims for which no payment was due.

**LACK OF UNITY OF INVENTION**

The Search Division considers that the present European patent application does not comply with the requirements of unity of invention and relates to several inventions or groups of inventions, namely:

see sheet B

☒ All further search fees have been paid within the fixed time limit. The present European search report has been drawn up for all claims.

☐ As all searchable claims could be searched without effort justifying an additional fee, the Search Division did not invite payment of any additional fee.

☐ Only part of the further search fees have been paid within the fixed time limit. The present European search report has been drawn up for those parts of the European patent application which relate to the inventions in respect of which search fees have been paid, namely claims:

☐ None of the further search fees have been paid within the fixed time limit. The present European search report has been drawn up for those parts of the European patent application which relate to the invention first mentioned in the claims, namely claims:

☐ The present supplementary European search report has been drawn up for those parts of the European patent application which relate to the invention first mentioned in the claims (Rule 164 (1) EPC).



**LACK OF UNITY OF INVENTION**  
**SHEET B**

Application Number

EP 18 16 7402

The Search Division considers that the present European patent application does not comply with the requirements of unity of invention and relates to several inventions or groups of inventions, namely:

1. claims: 1-7

A razor head comprising a housing comprising at least one guide, at least one integrally formed rigid razor blade freely mounted in the housing, and having a cutting edge portion, a guided portion and a bent portion intermediate the cutting edge portion and the guided portion, wherein the cantilever dimension, measured as the distance between the cutting edge and the guided portion axis, is between 1.1 millimeter and 1.8 millimeter, and wherein the guided portion cooperates with the guide of the housing.

---

2. claims: 8-11

An integrally formed rigid razor blade having in cross-section transverse to a long axis a cutting edge portion, a base portion having an abutment edge at one end, and a bent portion intermediate the cutting edge portion and the guided/base portion, wherein the abutment edge is corrugated along the long axis, with corrugations with a height of at most 0.32 millimeters; and method of manufacturing such an integrally formed razor blade.

---

**ANNEX TO THE EUROPEAN SEARCH REPORT  
ON EUROPEAN PATENT APPLICATION NO.**

EP 18 16 7402

5

This annex lists the patent family members relating to the patent documents cited in the above-mentioned European search report. The members are as contained in the European Patent Office EDP file on  
The European Patent Office is in no way liable for these particulars which are merely given for the purpose of information.

03-12-2018

10

15

20

25

30

35

40

45

50

Patent document cited in search report	Publication date	Patent family member(s)	Publication date
US 5010646 A	30-04-1991	AT 120999 T	15-04-1995
		BR 9104187 A	03-03-1992
		CA 2047171 A1	27-07-1991
		CN 1055690 A	30-10-1991
		DE 69108799 D1	18-05-1995
		DE 69108799 T2	23-11-1995
		DK 0465634 T3	08-05-1995
		EP 0465634 A1	15-01-1992
		ES 2071300 T3	16-06-1995
		GR 3015775 T3	31-07-1995
		JP 3214853 B2	02-10-2001
		JP H04506470 A	12-11-1992
		KR 0157603 B1	15-10-1998
		TR 25511 A	01-05-1993
US 4498235 A	12-02-1985	US 5010646 A	30-04-1991
		WO 9111300 A1	08-08-1991
US 4498235 A	12-02-1985	BR 8406992 A	02-07-1985
		CA 1228720 A	03-11-1987
		DE 3483321 D1	31-10-1990
		EP 0153334 A1	04-09-1985
		ES 291574 U	01-05-1986
		IN 160909 B	15-08-1987
		IT 1174621 B	01-07-1987
		JP H0631666 U	26-04-1994
		JP H0725172 Y2	07-06-1995
		JP S60501890 A	07-11-1985
		US 4498235 A	12-02-1985
		US 4551916 A	12-11-1985
		WO 8500773 A1	28-02-1985
US 2007234577 A1	11-10-2007	BR P10709815 A2	26-07-2011
		CA 2683626 A1	18-10-2007
		CN 101421061 A	29-04-2009
		EP 2004343 A2	24-12-2008
		JP 2009533129 A	17-09-2009
		KR 20090007392 A	16-01-2009
		RU 2008136714 A	20-05-2010
		US 2007234577 A1	11-10-2007
		US 2011283550 A1	24-11-2011
		US 2013091710 A1	18-04-2013
		US 2014041234 A1	13-02-2014
		WO 2007116358 A2	18-10-2007
WO 2012006043 A1	12-01-2012	BR 112012032115 A2	08-11-2016
		CN 102958626 A	06-03-2013

EPO FORM P0459

For more details about this annex : see Official Journal of the European Patent Office, No. 12/82

55

**ANNEX TO THE EUROPEAN SEARCH REPORT  
ON EUROPEAN PATENT APPLICATION NO.**

EP 18 16 7402

5

This annex lists the patent family members relating to the patent documents cited in the above-mentioned European search report. The members are as contained in the European Patent Office EDP file on  
The European Patent Office is in no way liable for these particulars which are merely given for the purpose of information.

03-12-2018

10

15

20

25

30

35

40

45

50

Patent document cited in search report	Publication date	Patent family member(s)	Publication date
		EP 2588259 A1	08-05-2013
		RU 2012152272 A	10-08-2014
		US 2011314678 A1	29-12-2011
		WO 2012006043 A1	12-01-2012
US 2007234576 A1	11-10-2007	EP 2004365 A2	24-12-2008
		US 2007234576 A1	11-10-2007
		US 2013276588 A1	24-10-2013
		US 2014245865 A1	04-09-2014
		WO 2007116356 A2	18-10-2007
WO 2009137389 A1	12-11-2009	AU 2009244489 A1	12-11-2009
		EP 2276591 A1	26-01-2011
		JP 5592875 B2	17-09-2014
		JP 2012525858 A	25-10-2012
		US 2010107425 A1	06-05-2010
		US 2012132036 A1	31-05-2012
		US 2016167104 A1	16-06-2016
		US 2018257126 A1	13-09-2018
		WO 2009137389 A1	12-11-2009
GB 548647 A	19-10-1942	NONE	
US 1734554 A	05-11-1929	NONE	
US 2010077618 A1	01-04-2010	AU 2009296283 A1	01-04-2010
		BR P10919450 A2	15-12-2015
		CA 2738795 A1	01-04-2010
		CN 102164721 A	24-08-2011
		EP 2349658 A1	03-08-2011
		EP 2559526 A1	20-02-2013
		JP 5318958 B2	16-10-2013
		JP 2012502778 A	02-02-2012
		KR 20110057193 A	31-05-2011
		RU 2011107393 A	10-11-2012
		US 2010077618 A1	01-04-2010
		WO 2010037078 A1	01-04-2010

EPO FORM P0459

For more details about this annex : see Official Journal of the European Patent Office, No. 12/82

55