

(19)



(11)

EP 3 714 721 A1

(12)

EUROPEAN PATENT APPLICATION

(43) Date of publication:
30.09.2020 Bulletin 2020/40

(51) Int Cl.:
A42B 3/04 (2006.01)

(21) Application number: **20165707.9**

(22) Date of filing: **25.03.2020**

(84) Designated Contracting States:
AL AT BE BG CH CY CZ DE DK EE ES FI FR GB GR HR HU IE IS IT LI LT LU LV MC MK MT NL NO PL PT RO RS SE SI SK SM TR
Designated Extension States:
BA ME
Designated Validation States:
KH MA MD TN

(71) Applicant: **Wilcox Industries Corp.**
Newington, NH 03801 (US)

(72) Inventors:
• **Goupil, Dominic R.**
Kittery, ME 03904 (US)
• **Dalzell, Ned A.**
Portsmouth, NH 03801 (US)

(30) Priority: **28.03.2019 US 201962825480 P**

(74) Representative: **FRKelly**
27 Clyde Road
Dublin D04 F838 (IE)

(54) INTERFACE SYSTEM FOR A HELMET MOUNTING SYSTEM

(57) An interface system for a helmet mounting system comprises a helmet strap assembly. A helmet shroud includes a shroud interface assembly configured to mate with a first hot shoe of a helmet mount assembly. The shroud interface assembly comprises a high speed data interface configured to be electrically coupled to the first hot shoe when the shroud interface assembly is coupled with the first hot shoe. A battery mount assembly com-

prises a second hot shoe portion which is configured to mate with a hot shoe receiver of a battery pack. The second hot shoe portion comprises a high speed data interface which is configured to be electrically coupled to high speed contacts on the hot shoe receiver of the battery pack when the second hot shoe portion is coupled with the hot shoe receiver of a battery pack.

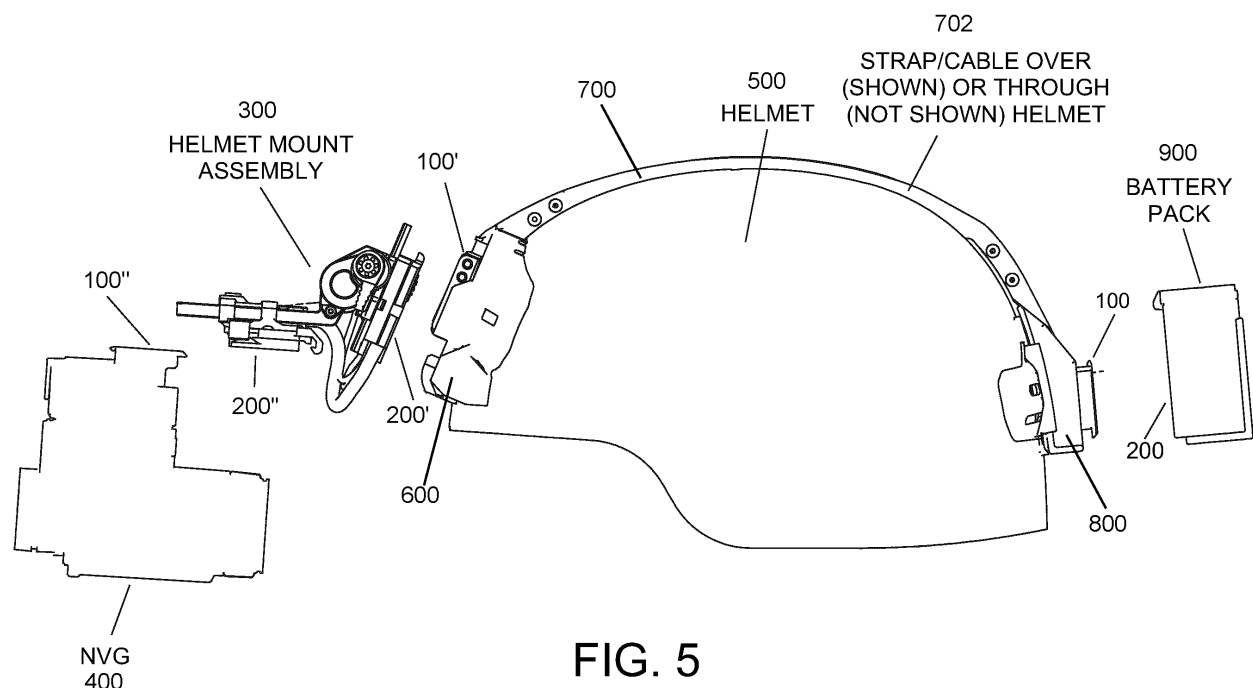
**FIG. 5****EP 3 714 721 A1**

Description

CROSS-REFERENCE TO RELATED APPLICATION

[0001] This application claims the priority benefit of U.S. Provisional Application No. 62/825,480 filed March 28, 2019 (ADN 111602_2). This application also a continuation-in-part of U.S. Application No. 16/441,608 filed June 14, 2019 (ADN 114363), which claims the priority benefit of U.S. Provisional Application No. 62/685,180 filed June 14, 2018 (ADN 111602). Each of the aforementioned application is incorporated herein by reference in its entirety.

[0002] The aforementioned applications are incorporated herein by reference in their entirety.

BACKGROUND

[0003] The present invention relates generally to a hot shoe interface capable of transmitting high speed data.

[0004] Existing data communication interfaces use external connectors that are polarized and include cables that must be physically mated or de-mated. In order to transmit video, for example, with a smart phone, a connector must be used, such as an external cable or docking station. Hot shoe interfaces are known in the art and are advantageous where ease of connection and disconnection, for example, one-handed connection and disconnection, is desired. However, existing hot shoe interfaces typically provide limited electrical coupling between devices, and are often limited to carrying power.

[0005] The present disclosure contemplates a hot shoe interface capable of serving as a communication port that may be mated and de-mated without the use of an external cable connector or a plug and socket type of connector, and without degradation of the data signal. In a more limited aspect, the hot shoe has a generally planar surface with terminal contacts such as contact pads configured to communicate with aligned contacts such as contact pins on a mounting assembly or accessory device. The contact points are capable of transmitting high speed data including video and augmented reality data across the hot shoe interface. In certain embodiments, the contact pins comprise gold plated brass pins. In another more limited aspect, the high speed hot shoe is configured for use with a helmet mount assembly. In certain embodiments, the helmet mount assembly combines fiber optic cables and high speed data cables to transmit data and power at high speeds.

SUMMARY

[0006] In one aspect, an interface system for a helmet mounting system comprises a helmet strap assembly including a strap. A helmet shroud is disposed at a first end of the helmet strap assembly and includes a shroud interface assembly configured to mate with a first hot shoe of a helmet mount assembly. The shroud interface as-

sembly comprises a high speed data interface including a first plurality of high speed contacts which are configured to be electrically coupled to a second plurality of high speed contacts on the first hot shoe when the shroud interface assembly is coupled with the first hot shoe. A battery mount assembly comprises a second hot shoe portion disposed at a second end of the helmet strap assembly opposite the first end, wherein the second hot shoe portion is configured to mate with a hot shoe receiver of a battery pack. The second hot shoe portion comprises a high speed data interface including a third plurality of high speed contacts which are configured to be electrically coupled to a fourth plurality of high speed contacts on the hot shoe receiver of the battery pack when the second hot shoe portion is coupled with the hot shoe receiver of a battery pack.

[0007] In a more limited aspect, the helmet strap assembly is configured to be run over an exterior surface of a helmet.

[0008] In another more limited aspect, the first plurality of high speed contacts are contact pads and the second plurality of high speed contacts are electrically conductive pins.

[0009] In another more limited aspect, each high speed contact of the first plurality of high speed contacts is electrically coupled to a corresponding one of the high speed contacts of the third plurality of high speed contacts by a respective conductor of a twisted pair of conductors passing within the strap.

[0010] In another more limited aspect, each twisted pair of conductors is a twisted pair differential cable configured to provide 90 ohms of impedance.

[0011] In another more limited aspect, the shroud interface assembly further comprises a power interface including a first set of power contacts and ground contacts.

[0012] In another more limited aspect, the helmet mounting system further includes the helmet mount assembly which comprises the first hot shoe.

[0013] In another more limited aspect, the first hot shoe includes a high speed data interface portion including the second plurality of high speed contacts and a power connector portion including a second set of power contacts and ground contacts which engage the first set of power contacts and ground contacts, respectively.

[0014] In another more limited aspect, the shroud interface assembly further includes an optical interface portion including a plurality of optical terminals.

[0015] In another more limited aspect, the helmet mount assembly further comprises a receptacle including a high speed data interface portion including the plurality of high speed contacts, the receptacle configured to mate with a viewing device.

[0016] In another more limited aspect, the receptacle is configured to receive a viewing device selected from the group consisting of a night vision device, camera, and near-eye display.

[0017] In another more limited aspect, the helmet mount assembly is pivotable between a first operable

position wherein the viewing device is positioned in front of an eye of a user and a the operable position and a second stowed position wherein the viewing device is positioned out of a line of sight of the user.

[0018] In another more limited aspect, the helmet mount assembly further comprises a connector configured for operable connection with an accessory device.

[0019] In another more limited aspect, the connector is a Type-C USB connector.

[0020] In another more limited aspect, the helmet mounting system further comprises the battery pack, wherein the battery pack includes the hot shoe receiver.

[0021] In another more limited aspect, the helmet mounting system further comprises an RF antenna electrically coupled to an RF interface on the second hot shoe portion.

[0022] In another more limited aspect, the RF interface is a coaxial RF interface.

[0023] In certain embodiments, a hot shoe interface system for a helmet mount assembly includes a first shoe receiver that further includes a first set of one or more electrical contacts configured to provide a power signal from a first device attached to the first receiver portion, a first hot shoe portion which includes a second set of one or more electrical contacts configured to receive the power signal, and a second hot shoe portion which includes a third set of one or more electrical contacts configured to receive the power signal, a fourth set of one or more electrical contacts configured to communicate high speed data with the first device, a fifth set of one or more electrical contacts configured to communicate low speed data with the first device, and a first set of optical terminals configured to communicate optical data with the first device. The hot shoe interface also includes a helmet strap assembly, wherein the strap assembly comprises one or more conductive pathways operably connecting the first hot shoe portion and the second hot shoe portion and a second shoe receiver includes a sixth set of one or more electrical contacts configured to receive the power signal, a seventh set of one or more electrical contacts configured to communicate the high speed data with a second device, an eighth set of one or more electrical contacts configured to communicate the low speed data with the second device, and a second set of optical terminals configured to communicate the optical data with the second device.

[0024] In certain embodiments, one or more of the high speed data, power signal, low speed data, and optical data, are transmitted from the first hot shoe portion to the second hot shoe portion via the conductive pathways.

[0025] In certain embodiments, the conductive pathways are comprised of fiber optic cabling.

[0026] In certain embodiments, the hot shoe interface system further includes a third shoe receiver, which includes a ninth set of one or more electrical contacts configured to receive the power signal, a tenth set of one or more electrical contacts configured to communicate the high speed data with the second device, an eleventh set

of one or more electrical contacts configured to communicate the low speed data with the second device, and a third set of optical terminals configured to communicate optical data with the second device.

[0027] In certain embodiments, the hot shoe interface system further includes a third hot shoe portion, which includes a twelfth set of one or more electrical contacts configured to receive the power signal, a thirteenth set of one or more electrical contacts configured to communicate the high speed data with the second device attached to the third hot shoe portion, a fourteenth set of one or more electrical contacts configured to communicate the low speed data with the second device attached to the third hot shoe portion; and a fourth set of optical terminals configured to communicate the optical data with the second device.

[0028] In certain embodiments, the first shoe receiver further comprises a fifteenth set of one or more electrical contacts configured to communicate high speed data with the first device, a sixteenth set of one or more electrical contacts configured to communicate low speed data with the first device, a fifth set of optical terminals configured to communicate optical data with the first device.

[0029] In certain embodiments, the first hot shoe portion further includes a seventeenth set of one or more electrical contacts configured to communicate high speed data with the first device, an eighteenth set of one or more electrical contacts configured to communicate low speed data with the first device, and a sixth set of optical terminals configured to communicate optical data with the first device.

[0030] In certain embodiments, the fourth set of one or more electrical contacts are contact pins.

[0031] In certain embodiments, the fourth set of one or more electrical contacts is electrically coupled to one or more twisted pairs of conductors.

[0032] In certain embodiments, the first hot shoe portion and the second hot shoe portion are disposed on a helmet.

[0033] In certain embodiments, the first device is a battery pack.

[0034] In certain embodiments, the second shoe receiver and the third shoe receiver are disposed on a helmet mount assembly, wherein the third shoe receiver is removably attachable to the third hot shoe portion of the second device.

[0035] In certain embodiments, the helmet mount assembly comprises one or more coaxial antennas.

[0036] In certain embodiments, the second device is a viewing device or a camera.

[0037] In certain embodiments, the second device is pivotable between an operable position and a stowed position.

[0038] In certain embodiments, the helmet mount assembly further comprises a connector configured for operable connection with the second device.

[0039] In certain embodiments, the connector is a Type-C USB connector.

BRIEF DESCRIPTION OF THE DRAWINGS

[0040] The invention may take form in various components and arrangements of components, and in various steps and arrangements of steps. The drawings are only for purposes of illustrating preferred embodiments and are not to be construed as limiting the invention.

FIG. 1 is an isometric view of a hot shoe according to an exemplary embodiment.

FIG. 2 is an isometric view, taken generally from the bottom, of a shoe receiver assembly configured to interface with the hot shoe of FIG. 1.

FIG. 3 is an isometric view, taken generally from the top, of the shoe receiver assembly of FIG. 2 engaged with the hot shoe of FIG. 1.

FIG. 4 is a partially exploded view of the shoe receiver assembly of FIG. 2 in relation to the hot shoe of FIG. 1.

FIG. 5 is a partially exploded view of a helmet mount system with a helmet strap system employing the hot shoe interface of FIG. 3.

FIG. 6 is an isometric view, taken generally from the front and right side, of the helmet strap system in FIG. 5.

FIG. 7 is a bottom view of the helmet strap system in FIG. 5.

FIG. 8 is a schematic diagram of an exemplary series of hot shoe interfaces in a helmet mount system between a remote battery pack and a helmet mounted device.

FIG. 9 is a block diagram of an exemplary flow of data and power in a helmet mount assembly system.

FIG. 10 is a front view illustrating a helmet having a helmet shroud including a hot shoe interface according to a second embodiment.

FIG. 11 is rear and right side view of a helmet mount assembly for positioning in front of the eyes of a user a viewing device that has a hot shoe interface portion in accordance with a first embodiment this disclosure.

FIG. 12 is an isometric view, taken generally from the front and left side, of the helmet mount assembly for positioning a viewing device appearing in FIG. 11.

FIG. 13 is bottom view of a carriage assembly portion of the helmet mount assembly appearing in FIG. 11.

FIG. 14A is an isometric view of a battery pack hot shoe in accordance with an exemplary embodiment.

FIG. 14B is a fragmentary view of a high speed data interface.

FIG. 14C is a side view of a power and optical interface of a helmet shroud interface assembly.

FIG. 15 is a fragmentary view of the helmet strap system illustrating the battery mount shroud appearing in FIG. 6 and the battery pack hot shoe interface appearing in FIG. 14A.

FIG. 16 is an isometric view of exemplary cabling connecting the helmet shroud mounting assembly

to the battery pack hot shoe interface.

FIG. 17A illustrates isometric views of the top and bottom surfaces of the battery pack hot shoe appearing in FIG. 14A.

FIG. 17B illustrates front and back views of a power and optical interface of the helmet shroud interface assembly of FIG. 14C.

FIG. 17C is an isometric view of a housing for an RF antenna provided on the helmet shroud mounting assembly illustrated in FIG. 10.

FIG. 18 is an isometric view, taken generally from the rear and left side, of a helmet mount assembly for positioning in front of the eyes of a user a viewing device that has a hot shoe interface portion in accordance with a second embodiment this disclosure.

FIG. 19 is an isometric view, taken generally from the front and right side, of the helmet mount assembly for positioning in front of the eyes of a user a viewing device appearing in FIG. 18.

DETAILED DESCRIPTION OF THE PREFERRED EMBODIMENTS

[0041] Referring now to the drawings, FIGS. 1-4 illustrate a hot shoe interface configured to serve as a communication port with a helmet mount assembly and/or other external accessory device. The hot shoe, generally designated **100**, includes a set of contact pads configured to communicate with a set of corresponding contact pins on a shoe receiver assembly generally designated **200**. In certain embodiments, the hot shoe **100** is advantageously disposed on an electrically operated device (not shown) or mounting unit therefor and serves as a mechanical and electrical attachment point.

[0042] Referring now to FIG. 1, the contact pads or terminals on the hot shoe **100** include one or more of the following: optical interface terminals **101**, high speed contact pairs **102** each comprising two pads **110**, low speed contact pads **103**, high speed drain pad **104**, coaxial or radio frequency (RF) contacts **105**, power ground pads **106**, power drains **107**, power pads **108**, and shield pad **109**. The hot shoe **100** further allows redundant power, ground, and/or control or data signals to pass through the interface. In certain preferred embodiments, the contact pads are gold plated, e.g., gold plated brass or gold plated copper, to minimize corrosion. Each high speed contact pad **110** is electrically coupled to a respective conductor **217** of a twisted pair **218** of conductors. In certain preferred embodiments, the twisted pair **218** of conductors is a twisted pair differential cables configured to provide 90 ohms of impedance to support high speed transmission performance.

[0043] Each pair of adjacent contacts **110** defines a pair of contact pads **102**. The contact pads **110** defining each pair **102** are preferentially arranged/spaced apart to facilitate transmittal of data with the proper level of impedance. Each pad may be hardwired, e.g., soldered directly to a cable, or connected to a circuit board or other

circuit substrate. In certain embodiments where the pads are soldered to a circuit board or substrate, such as a printed circuit board, the circuit board traces of the conductive pair should be of equal lengths and widths in order to control impedance.

In certain embodiments, the radio frequency contact **105** is a coaxial conductor pair, e.g., an RF-type connector for transmitting an RF video signal (e.g., composite video) across the hot shoe interface.

[0044] In certain preferred embodiments, the hot shoe **100** has a generally planar surface **113**, without plugs or receptacles. The surface **113** is advantageously sealed with a sealing ring or gasket. In certain embodiments, the sealing ring or gasket is positioned on the complementary shoe receiver assembly **200** and forms a seal when the hot shoe **100** is engaged with the shoe receiver assembly **200**. In certain embodiments, the hot shoe **100** includes a front lip **114** which may include a ramped or inclined surface to facilitate connection with the shoe receiver assembly **200**. The hot shoe **100** further includes a rear lip **112** which may include a ramped or inclined surface to facilitate connection with the shoe receiver assembly **200**.

[0045] In certain embodiments, the hot shoe interface is capable of communicating data at high speeds, e.g., greater than 1.5 gigabits per second. In certain embodiments, the hot shoe interface is further capable of transmitting video data and/or augmented reality data sent from an accessory device, such as a viewing device.

[0046] Referring now to FIGS. 2 and 3, the shoe receiver assembly **200** includes a hot shoe receptacle **215**. In certain embodiments, the shoe receiver assembly **200** includes a resilient fastener element **214** for removable attachment of the shoe receiver assembly **200**, e.g., of an accessory device, battery pack, etc., to a hot shoe **100**, e.g., via a snap fit engagement with the edges of the hot shoe **100**. It is recognized that other means of attachment are contemplated, e.g., wherein the hot shoe **100** slides into a hot shoe receptacle portion **215** of the shoe receiver assembly **215** and is held in place by a lock or clamp mechanism. Activation of a release mechanism **216** allows the hot shoe **100** to be released for removal of the viewing device, battery pack, or other device, from the respective mounting assembly.

[0047] As illustrated in FIG. 2, the hot shoe receptacle **215** includes a number of contact pins for coupling with the corresponding aligned contact pads of the hot shoe **100**. In certain embodiments, the contact pins are pogo pins (i.e., telescoping, spring biased pins), conductive spring-loaded buttons, or other suitable physical connection transmitting feature. In certain embodiments, high speed contact pins **210** are gold plated brass or gold plated copper pins. When the hot shoe receptacle **215** is attached to the hot shoe **100**, the contact pins on the hot shoe receptacle **215** are in operable connection with a respective aligned one of the contact pads **110** on the hot shoe **100**, such that data and power may be transmitted through the hot shoe interface.

[0048] The illustrated hot shoe receptacle **215** includes one or more of the following contact points: optical interface terminal **201**, high speed contact pins **210**, low speed contact pins **203**, high speed drain pins **204**, RF contact points **205**, ground pins **206**, power drains **207**, power pins **208**, and shield pin **209**. Each high speed contact pin **210** is coupled to a respective conductor **217** of a twisted pair cable **218**.

[0049] Each set of adjacent pins **210** comprises a pair of contact pins **202** and corresponds to contact pads **110**. Optical interface terminals **201** on the hot shoe receptacle **215** are in optical communication with the respective aligned optical interface terminals **101** on the hot shoe **100**. Low speed contact pins **203** on the hot shoe receptacle **215** are operably aligned with the low speed contact pads **103** on the hot shoe **100**. Drain pins **204** (for the high speed conductors) on the hot shoe receptacle **215** are operably aligned with high speed drain pads **104** on the hot shoe **100**. RF contact points **205** on the hot shoe receptacle **215** are operably aligned to RF contacts **105** on the hot shoe **100**. Power ground pins **206** on the hot shoe receptacle **215** are operably aligned with power ground pads **106** on the hot shoe **100**. Power drain pins **207** on the hot shoe receptacle **215** are operably aligned with the drain pads **107** on the hot shoe **100**. Power pins **208** on the hot shoe receptacle **215** are operably aligned with power pads **108** on the hot shoe **100**. Shield pin **209** on the hot shoe receptacle **215** is operably connected to shield pad **109** on the hot shoe **100**.

[0050] In certain embodiments, the shoe receiver assembly **200** includes one or more front catch mechanisms **214**, to removably engage the front lip **114** of the hot shoe **100**. The shoe receiver assembly **200** further includes an opening **212** for removably engaging the rear lip **112** of the hot shoe **100**. In certain embodiments, the shoe receiver assembly **200** includes a release lever **216** for disconnection of the shoe receiver assembly **200** from the hot shoe **100**. The release lever **216** is operably connected to the catches **214** such that engagement of the release lever **216** disengages the catches **214** from the front lip **114**.

[0051] In certain embodiments, wherein the hot shoe interface is employed in connection with a helmet mount assembly **300**, e.g., for positioning a viewing device **400** in front of the eyes of a user, the viewing device **400** may be operable when an attached accessory device, such as a night vision device or other viewing device, is in an active/viewable position and powered off when the mounted accessory device is moved to a stowed or inactive position (i.e., when not in use). In certain embodiments, the accessory device, for example, a viewing device, includes a magnetic sensing device, such as a reed switch, Hall effect sensor, magnetometer or the like, for sensing when the mount assembly **300** is in an operative position, e.g., an active/viewing position versus stowed position. When the mount assembly **300** is in an active position, the accessory device is powered on and able to receive or transmit data, including video or augmented

reality data, via the hot shoe interface. Other means of activating or deactivating the accessory device are contemplated, such as manual buttons or switches.

[0052] The hot shoe interface may be used with, for example, a helmet system **500**. Referring now to FIG. 5, there is shown an exemplary helmet system including a battery pack **900**, helmet mount **300**, and viewing accessory (e.g., a night vision device) **300**. In certain embodiments, a system with multiple hot shoe interfaces is contemplated. For example, as illustrated in FIG. 5, a helmet system with multiple hot shoe interfaces is contemplated, wherein the first hot shoe **100** is mounted to a rear portion of the helmet and is configured to connect to an external battery pack **900** having a shoe receiver assembly **200**. A helmet shroud **600** disposed on the front of the helmet **500** includes a shroud interface assembly **100'**, e.g., defining a hot shoe receiver. The shroud interface assembly **100'** is mounted to a front portion of the helmet and is configured to connect to a first end of a helmet mount assembly **300** having a second hot shoe **200'** on the first end of the helmet mount assembly **300**. A third hot shoe **100''** is disposed on the second end of the helmet mount assembly **300**. The third hot shoe **100''** is configured to connect to a shoe receiver assembly **200''** of an accessory device **400**. The accessory device may be a night vision goggle, camera, and/or other near-eye display, and so forth. The accessory device may alternatively be a helmet mounted display screen, heads-up display, or any other helmet mounted optical, electro-optical, or other viewing or tactical device that may be mounted to the helmet mount assembly **300** or configured to mount directly or indirectly to the helmet. In certain embodiments, the helmet mount assembly **300** and/or the shoe receiver assembly **200** are adjustable. It will be recognized that the present development is not limited to use with helmets. It will also be recognized that any one or more of the hot shoe **100** / shoe receiver assembly **200** pairs as shown in FIG. 5 may be reversed from the arrangement depicted in FIG. 5.

[0053] In certain embodiments, the helmet includes one or more conductive pathways to provide power, control and/or data signals between a power source, such as the outside battery pack, and the helmet mount accessory and/or accessory device. In certain embodiments, the conductive pathways include fiber optic cabling. In certain embodiments, the conductive pathways include copper cabling, such as high speed copper cables. In certain embodiments, the conductive pathways include a combination of fiber optic and high speed copper cabling.

[0054] In certain embodiments, an outside computer processor, such as a computer processor on a weapon, may be configured to communicate wirelessly with the battery pack and/or accessory device and control the same.

[0055] In certain embodiments, a battery pack **900** for the helmet system includes a shoe receiver assembly **200**, which has electrical pin terminals, optical terminals,

and RF interface terminals as described above by way of reference to FIG. 2. A battery mounting bracket or shroud **800** on the helmet includes a hot shoe **100** which has electrical pad terminals, optical terminals, and RF interface terminals as described above by way of reference to FIG. 1. FIG. 17A illustrates an enlarged view of the front side and potted backside of the hot shoe interface **100**.

[0056] A front shroud assembly **600** includes a high speed interface **100'** which engages a complementary shoe receiver assembly interface **200'** on the helmet mount assembly **300**. A preferred embodiment of the interface **100'**, depicted generally in FIG. 5, appears in FIG. 10. A preferred embodiment of the interface **200'**, depicted generally in FIG. 5, appears in FIGS. 11 and 12.

[0057] Referring to FIG. 8, there appears a schematic diagram of an exemplary series of hot shoe interfaces in a helmet mount system between a remote battery pack and a helmet mounted device.

[0058] Referring to FIG. 9, there appears a block diagram of an exemplary flow of data and power in a helmet mount assembly system including an accessory device **400** operably connected to a mounting assembly **300** which is further connected to a front helmet mount interface of the helmet mount assembly **300**. A battery pack **900** is mounted to the rear helmet mount interface **800**. Power **250** is transmittable from the battery pack **900** to the helmet mount interface **300** and across the entire helmet mount system to the accessory device **400**. The system is capable of transmitting data **260**, including without limitation high speed video and/or audio and video data across the system from accessory device **400** to the helmet mount assembly **300** or to the battery pack **900** or vice versa. In certain embodiments, one or more coaxial RF antennas **640** housed within antenna housing **642** (as illustrated in FIG. 17C) receive wireless signals **310** and transmit such signals across a coaxial interface of the helmet mount assembly **300**. In certain embodiments, the battery pack **900** includes a video recording module for storing data representative of video images acquired by the accessory device **400**. In certain embodiments, the battery pack includes an augmented reality processor for generating video data which is combined with or overlaid upon video images acquired by the accessory device to provide video output via a display screen(s) of the accessory device **400** to provide an augmented or enhanced visual perception of the user's environment.

[0059] FIG. 10 illustrates an alternative embodiment of a hot shoe. The helmet shroud **600** includes an interface assembly **100'**, which includes a high speed data interface **610**, including high speed contact pads **110'**, which are electrically coupled to high speed contact pins **210'** when the hot shoe is coupled with the hot shoe receiver **200'** of the helmet mount assembly **300**. In certain embodiments, the interface assembly **100'** also includes a power interface **620** including low resistance power line pads **106'** and **108'** (as illustrated in FIG. 17B). Conduc-

tors and optical fibers connecting the hot shoe **100** of the battery mount assembly **800** and the interface **100'** of the helmet mount assembly **300** pass within the helmet strap **700**. In certain embodiments, the interface assembly **100'** further includes optical terminals **101'** which are optically coupled to the optical terminals **101** on the shoe **100**. The strap assembly **700** includes a strap **702** extending along a centerline of the helmet **500** between the front shroud portion **304** of the helmet mount assembly **300** and the battery bracket portion **806** of the battery mounting assembly **800**.

[0060] An exemplary strap assembly **700** is illustrated in FIGS. 6-7. In certain embodiments, the conductive pathways in the helmet mount assembly system are configured to run externally over the helmet. The cabling **708** is run through a center chassis portion **702** of the helmet strap assembly **700** that retains the wires **708**, for example, in captured grooves on the underside of the chassis portion **702**. In alternative embodiments, the conductive pathways are configured to run internally through the helmet. An illustration of exemplary wiring and optical cable with the strap removed is shown in FIG. 16.

[0061] An enlarged view of the battery pack interface appears in FIG. 14A. An enlarged view of the high speed data interface **610** appears in FIG. 14B. An enlarged view of the power and optical interface **620** appears in FIG. 14C. An enlarged view of the battery mount shroud and hot shoe interface **100** appears in FIG. 15.

[0062] Referring now to FIGS. 11-13, there appears a helmet mount assembly **300** for positioning an accessory device, such as a viewing device or camera. For brevity, the embodiments herein will be described primarily by way of reference to a viewing device, such as a night vision goggle, as the accessory device, but other devices as noted above, such as a camera or near-eye display, are equally applicable to each of the embodiments, and are incorporated into descriptions thereof by reference. The helmet mount assembly **300** includes an interface portion **200'** which engages the shroud **600**.

[0063] A first high speed data interface portion **330** includes a plurality of high speed pins **210'** and associated shield and drain pins, which engage respective high speed contact pads **110'** and associated shield and drain pads on the second high speed data interface portion **610**. A sealing ring **332** engages a complementary sealing area **632** on the interface area **100'** to seal the high speed interface against resistance or environmental contamination. Power and ground pins **208'** and **206'**, respectively, engage the respective, aligned power and ground pads **108'** and **106'**, respectively.

[0064] A vertical adjusting arm **340** is attached to the interface assembly **200'** to provide a vertical adjustment for aligning a viewing device with the eyes of the user. Horizontal pivoting arms **350** are pivotally attached to vertical adjusting arm **340**, pivotable between a viewing or operable position and a stowed position. The arms **350** pivot about a power cylinder **360**. A sliding carriage **370** provides a fore and aft adjustment of an attached

viewing device relative to the eye of the user.

[0065] The carriage assembly **370** includes a hot shoe receiver **200''**, which includes a plurality of pins as follows: optical interface terminal **201''**, high speed contact pins **210''**, low speed contact pins **203''**, high speed drain pins **204''**, RF contact points **205''**, ground pins **206''**, power drains **207''**, power pins **208''**, and shield pin **209''**. The hot shoe receiver **200''** may be configured as described above by way of reference to the hot shoe receptacle **215**, except that the optical terminals and RF interface are omitted.

[0066] An accessory device **400**, such as a viewing device, configured for use with the helmet mount assembly **300** includes a hot shoe **100''** with contact pads for coupling with the contact pins of hot shoe receiver **200''**. Optical interface terminal **201''** on the hot shoe receiver **200''** is in optical communication with optical interface terminal **101''** on the hot shoe **100''**. Low speed contact pins **203''** on the hot shoe receiver **200''** are operably aligned with the low speed contact pads **103''** on the hot shoe **100''**. Drain pin **204''** on the hot shoe receiver **200''** is configured for high speed conducting with high speed drain pad **104''** on the hot shoe **100''**. RF contact points **205''** on the hot shoe receiver **200''** are operably aligned to RF contacts **105''** on the hot shoe **100''**. Power ground pins **206''** on the hot shoe receiver **200''** are operably aligned with power ground pads **106''** on the hot shoe **100''**. Power drains **207''** on the hot shoe receiver **200''** are operably aligned with drain pads **107''** on the hot shoe **100''**. Power pins **208''** on the hot shoe receiver **200''** are operably aligned with power pads **108''** on the hot shoe **100''**. Shield pin **209''** on the hot shoe receptacle **215''** is operably connected to shield pad **109** on the hot shoe **100''**.

[0067] In certain embodiments (not illustrated), the hot shoe **100''** of the accessory device **400** is configured to directly engage with a hot shoe receiver **200''** on a helmet **500** or on a shroud assembly **600** on a helmet **500**. It will be recognized that the arrangement of the hot shoe **100''** and the hot shoe receiver **200''** may also be reversed.

[0068] Referring now to FIGS. 18 and 19, there appears a helmet mount assembly **300A** for positioning an accessory device (not shown), such as a viewing device or camera. For brevity, the embodiments herein will be described primarily by way of reference to a camera, but other devices as noted above, such as a viewing device, e.g., night vision goggles or near-eye display, are equally applicable to each of the embodiments, and are incorporated into descriptions thereof by reference. The helmet mount assembly **300A** includes an interface portion **200A'** which engages the shroud **600**.

[0069] A first high speed data interface portion **330A** includes a plurality of high speed pins **210A'** and associated shield and drain pins, which engage corresponding high speed contact pads **110'** and associated shield and drain pads on the second high speed data interface portion **610**. A sealing ring **332A** engages a complementary sealing area **632** on the interface area **100'** to seal

the high speed interface against resistance or environmental contamination. Power and ground pins **208A'** and **206A'**, respectively, engage the corresponding power and ground pads **108'** and **106'**, respectively.

[0070] A vertical adjusting arm **340A** is attached to the interface assembly **200A'** to provide a vertical adjustment for aligning a viewing device with the eyes of the user. Horizontal pivoting arms **350A** are pivotally attached to vertical adjusting arm **340A**, pivotable between a viewing or operable position and a stowed position. A sliding carriage **370A** provides a fore and aft adjustment of an attached viewing device relative to the eye of the user.

[0071] The mounting assembly **300A** includes a frame with a pair of vertical pivoting arms **390** for further aligning a viewing device or camera with the eyes of the user and a pair of horizontal fixed arms **392**. In certain embodiments, the vertical frame arms **390** are configured to receive threaded fasteners **380** for retaining the camera or viewing device. The mounting assembly also includes a release **216A** allows for release and adjustment of the vertical frame arms **390**. In the illustrated embodiment, the helmet mount assembly **300A** includes a data port or connector **394**, such as a Universal Serial Bus (USB) port or connector, for mating with a corresponding connector or port of the camera. In certain embodiments, the data port or connector **394** is a Type-C USB connector (USB-C). In certain alternative embodiments, the camera is configured for wireless communication with the helmet, a computer, or computer-based information handling system.

[0072] The invention has been described with reference to the preferred embodiment. Modifications and alterations will occur to others upon a reading and understanding of the preceding detailed description. It is intended that the invention be construed as including all such modifications and alterations insofar as they come within the scope of the appended claims and equivalents thereof.

Claims

1. An interface system for a helmet mounting system, comprising:

a helmet strap assembly (700) including a strap (702);

a helmet shroud (600) disposed at a first end of the helmet strap assembly (700), the helmet shroud (600) including a shroud interface assembly (100'), the shroud interface assembly being configured to mate with a first hot shoe (200') of a helmet mount assembly (300);

the shroud interface assembly (100') comprising a high speed data interface (610) including a first plurality of high speed contacts (110') which are configured to be electrically coupled to a second plurality of high speed contacts (210') on

the first hot shoe (200') when the shroud interface assembly (610) is coupled with the first hot shoe (200');

a battery mount assembly (800) comprising a second hot shoe portion (100) disposed at a second end of the helmet strap assembly (700) opposite the first end, the second hot shoe portion (100) being configured to mate with a hot shoe receiver (200) of a battery pack (900); and the second hot shoe portion (100) comprising a high speed data interface including a third plurality of high speed contacts (110) which are configured to be electrically coupled to a fourth plurality of high speed contacts (210) on the hot shoe receiver (200) of the battery pack (900) when the second hot shoe portion (100) is coupled with the hot shoe receiver (200) of a battery pack (900).

2. The hot shoe interface system of claim 1, wherein the helmet strap assembly (700) is configured to be run over an exterior surface of a helmet (500).

3. The hot shoe interface system of claim 1 or 2, wherein the first plurality of high speed contacts (110') are contact pads and the second plurality of high speed contacts (210') are electrically conductive pins.

4. The hot shoe interface system of any one of claims 1 to 3, wherein each high speed contact of the first plurality of high speed contacts (110') is electrically coupled to a corresponding one of the high speed contacts of the third plurality of high speed contacts (110) by a respective conductor (217) of a twisted pair (218) of conductors passing within the strap (702).

5. The hot shoe interface system of claim 4, wherein each twisted pair (218) of conductors is a twisted pair differential cable configured to provide 90 ohms of impedance.

6. The hot shoe interface system of any one of claims 1 to 5, wherein the shroud interface assembly (610) further comprises a power interface (620) including a first set of power contacts (108') and ground contacts (106').

7. The hot shoe interface system of claim 6, further comprising:

the helmet mount assembly (300) wherein the helmet mount assembly comprises the first hot shoe (200');

the first hot shoe (200') including a high speed data interface portion (330) including the second plurality of high speed contacts (210') and a power connector portion including a second set

of power contacts (208') and ground contacts (206') which engage the first set of power contacts (108') and ground contacts (106'), respectively.

5

8. The hot shoe interface system of claim 7, wherein the shroud interface assembly (610) further includes an optical interface portion including a plurality of optical terminals (101').

10

9. The hot shoe interface system of claim 7 or 8, wherein the helmet mount assembly (300) further comprises a receptacle (200") including a high speed data interface portion including the plurality of high speed contacts (210"), the receptacle configured to mate with a viewing device (400).

15

10. The hot shoe interface system of claim 9, wherein the receptacle (200") is configured to receive a viewing device (400) selected from the group consisting of a night vision device, camera, and near-eye display.

20

11. The hot shoe interface system of any one of claims 7 to 10, wherein the helmet mount assembly (300) is pivotable between a first operable position wherein the viewing device is positioned in front of an eye of a user and a the operable position and a second stowed position wherein the viewing device is positioned out of a line of sight of the user.

25

30

12. The hot shoe interface system of any one of claims 7 to 10, wherein the helmet mount assembly (300) further comprises a connector (394) configured for operable connection with an accessory device.

35

13. The hot shoe interface system of claim 12, wherein the connector (394) is a Type-C USB connector.

14. The hot shoe interface system of any one of claims 1 to 13, further comprising the battery pack (900), the battery pack including the hot shoe receiver (200).

40

15. The hot shoe interface system of any one of claims 1 to 14, further comprising
an RF antenna (640) electrically coupled to an RF interface (105) on the second hot shoe portion (100);
or
an RF antenna (640) electrically coupled to an RF interface (105) on the second hot shoe portion (100);
wherein the RF interface (105) is a coaxial RF interface.

45

50

55

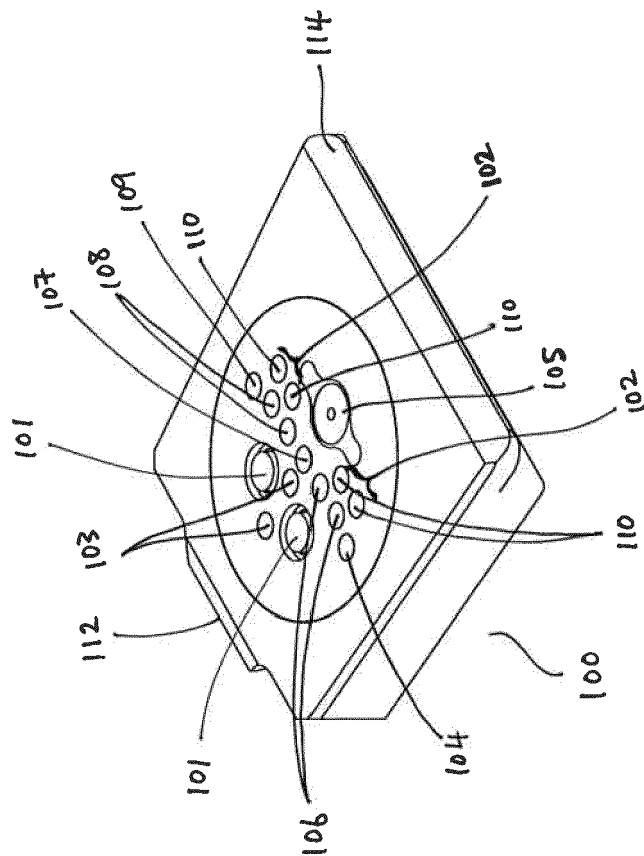

FIG. 1

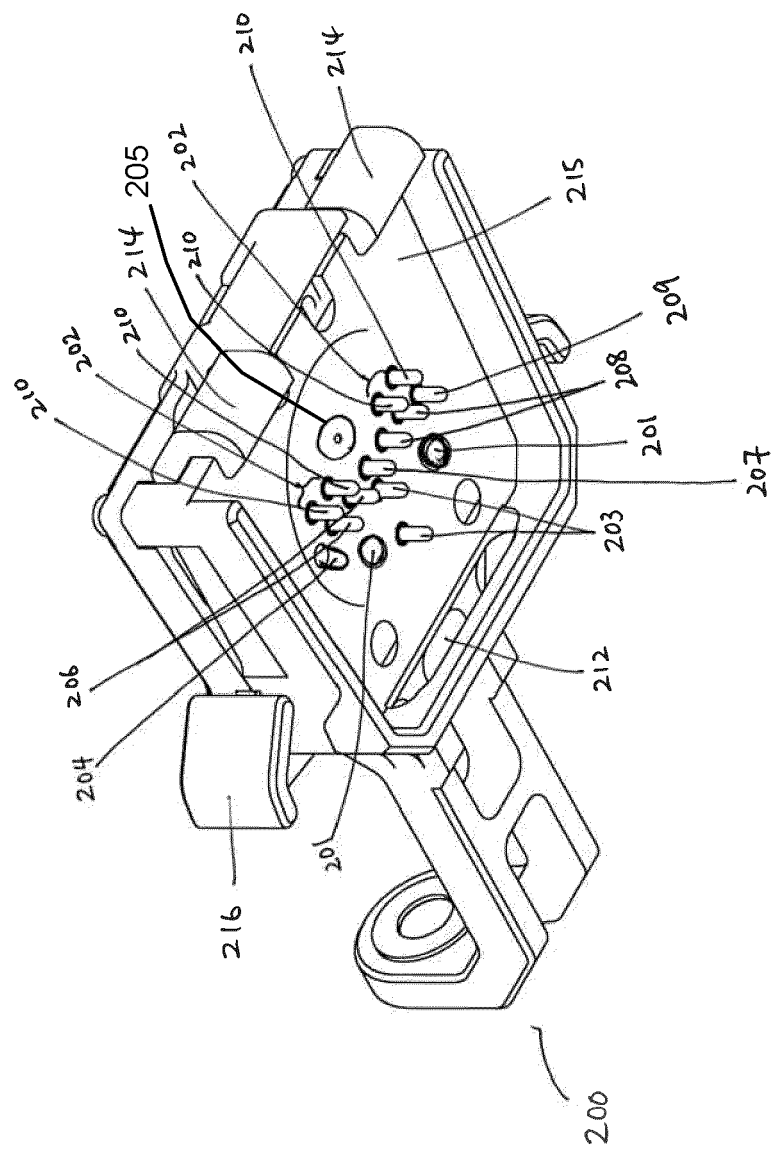

FIG. 2

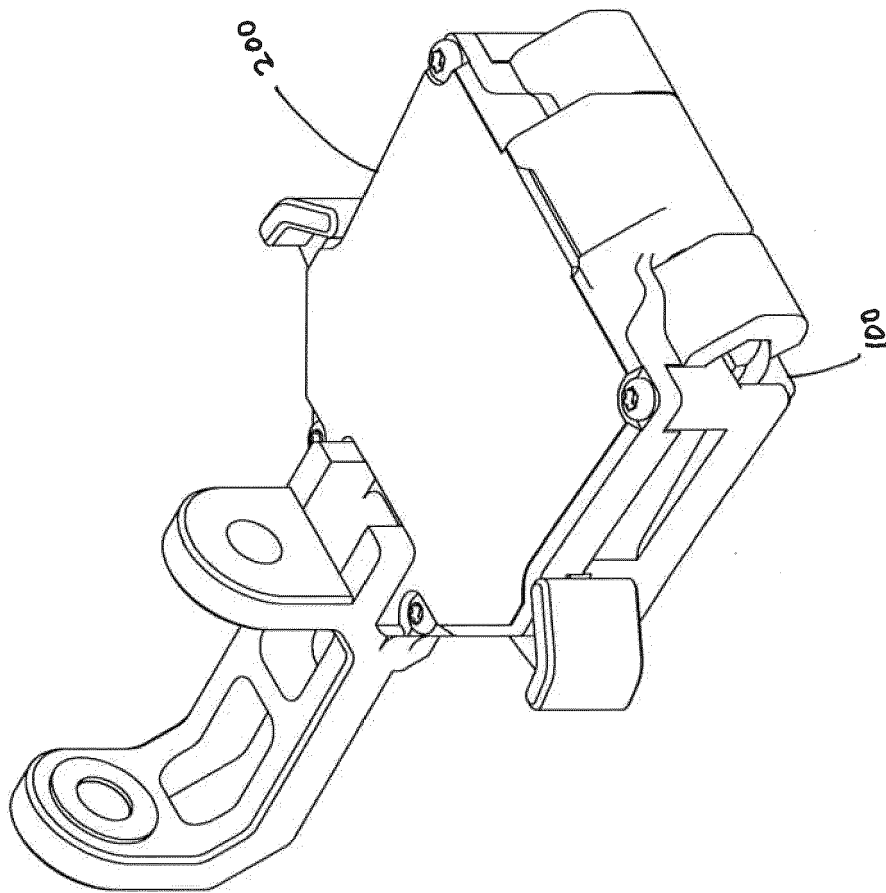

FIG. 3

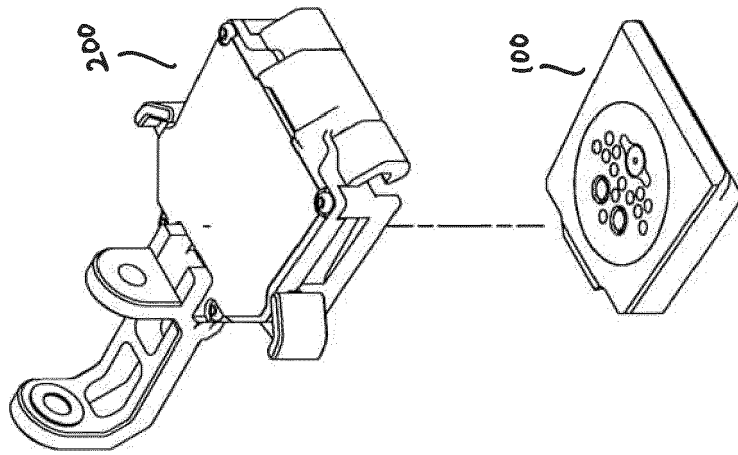

FIG. 4

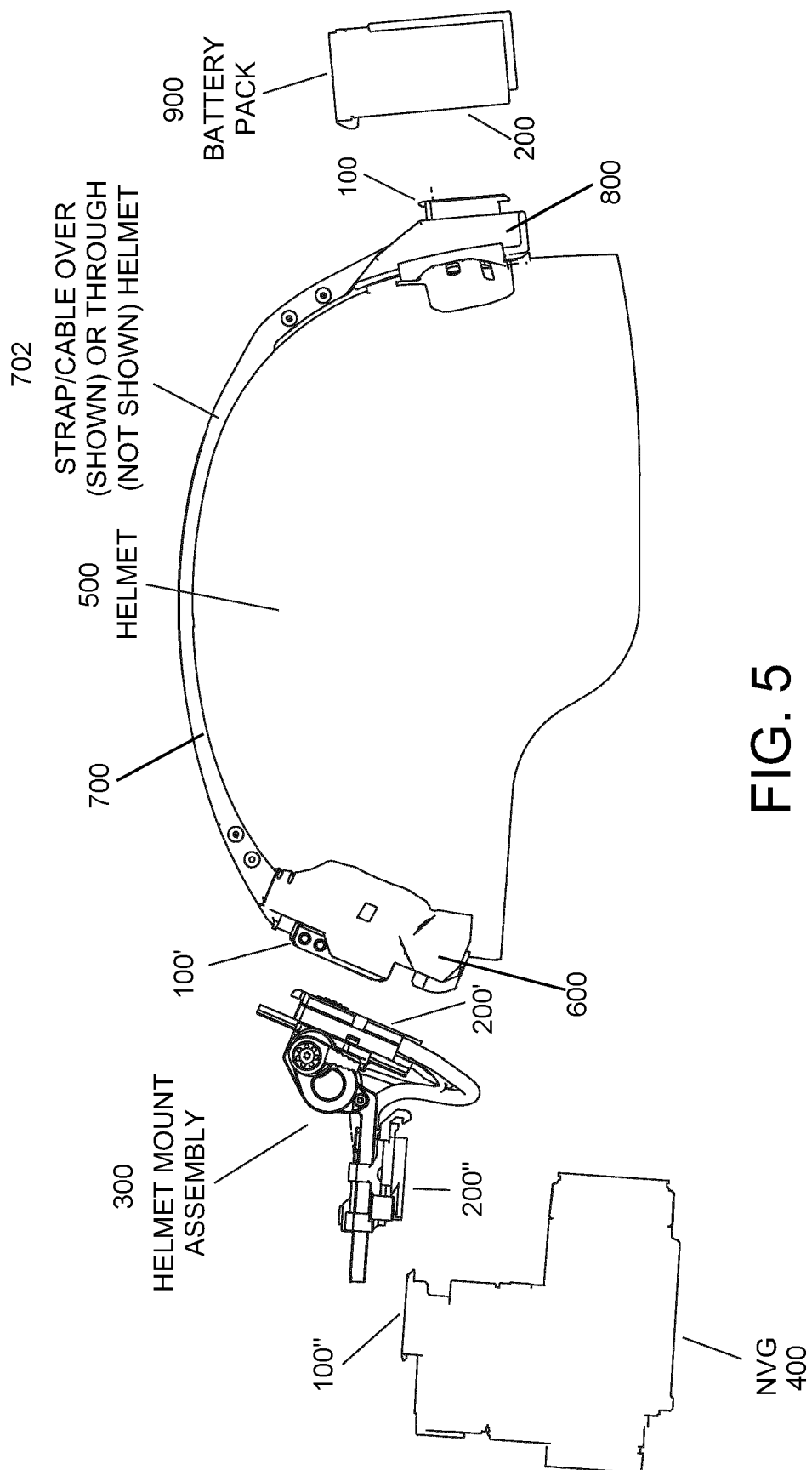

FIG. 5

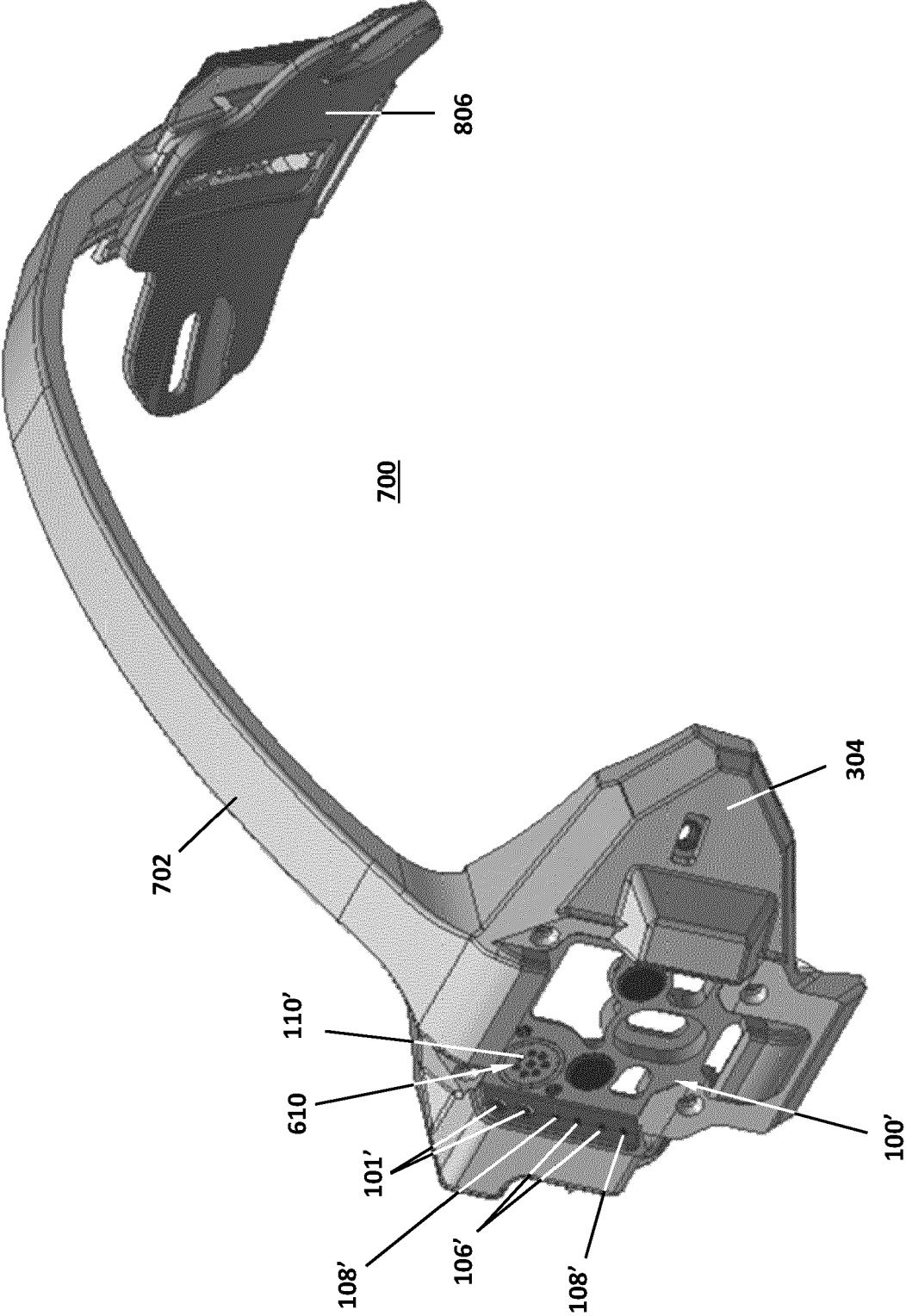

FIG. 6

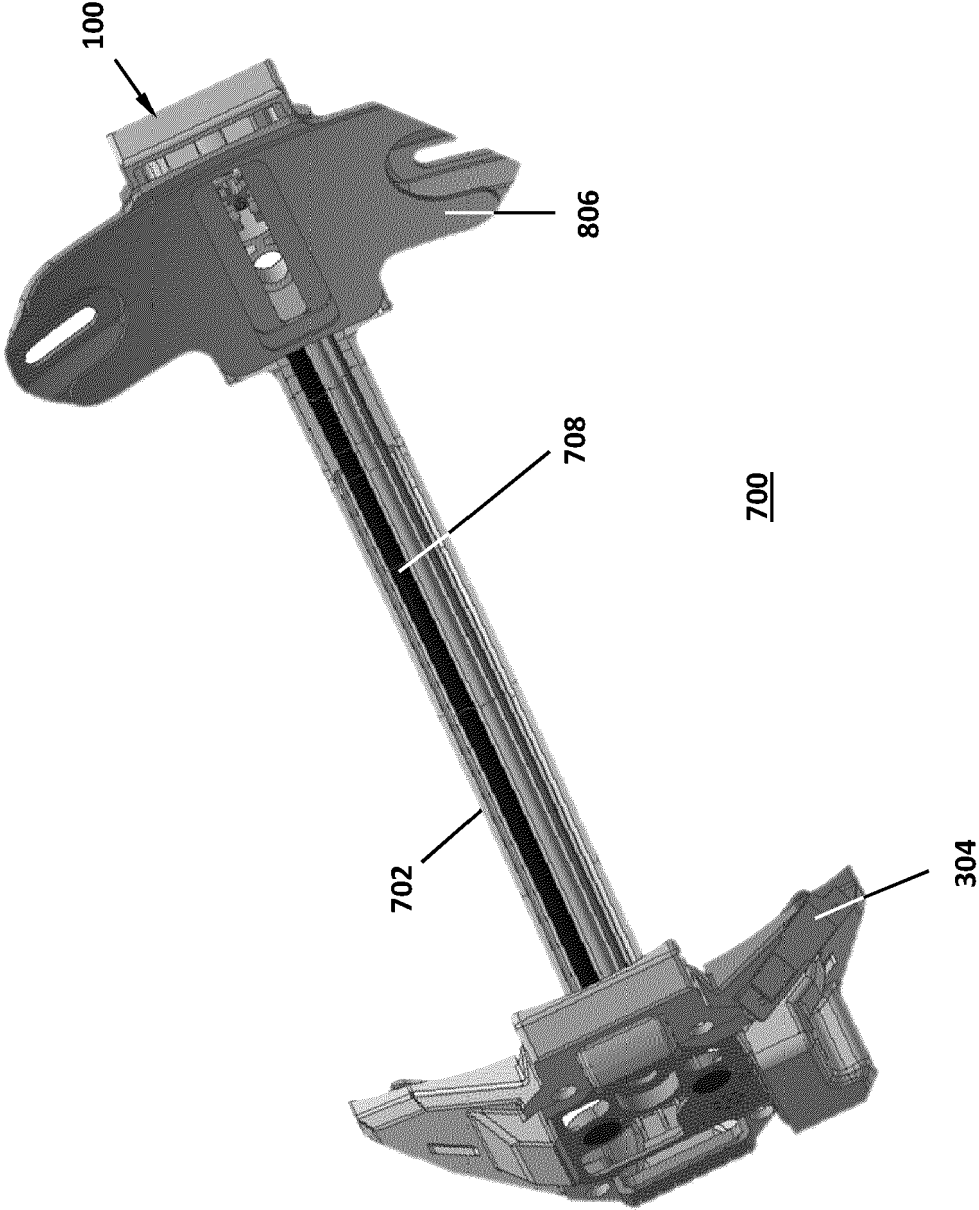

FIG. 7

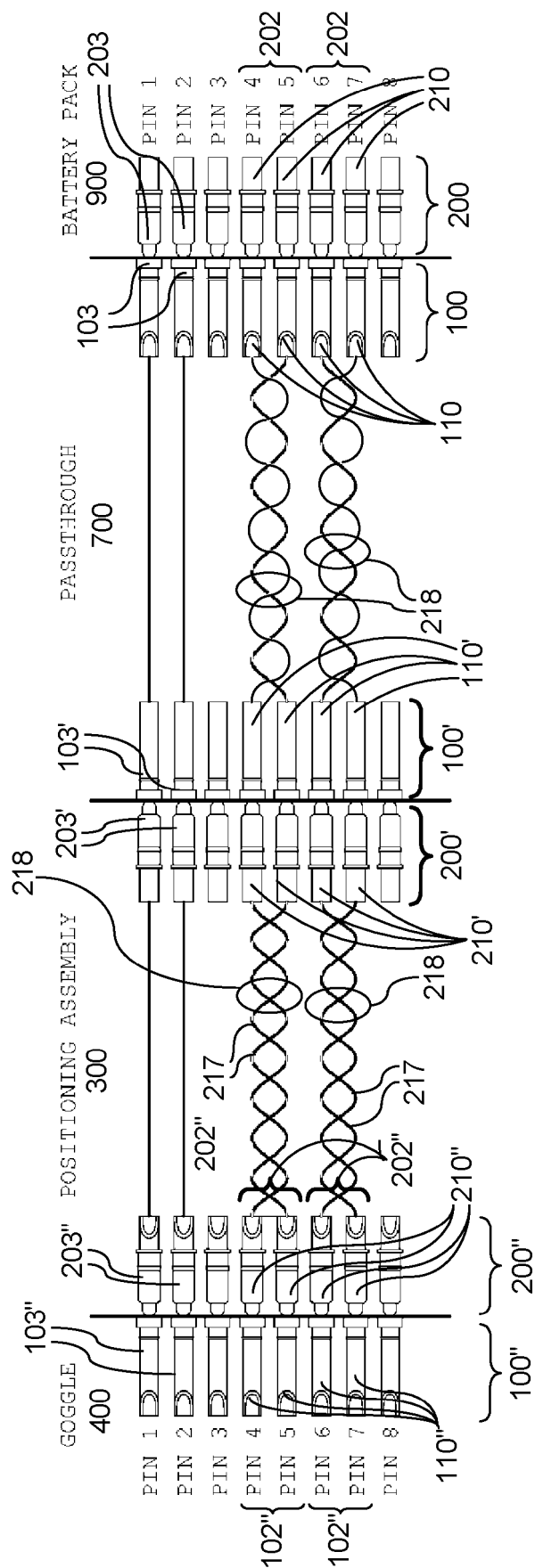

FIG. 8

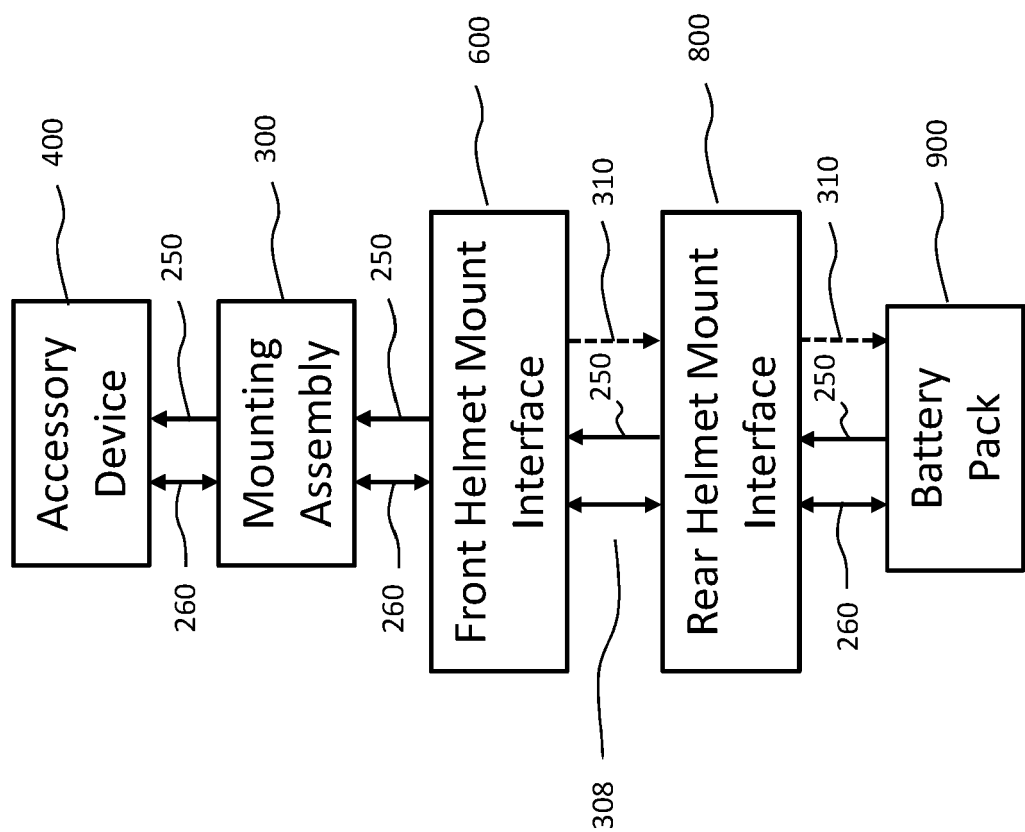

FIG. 9

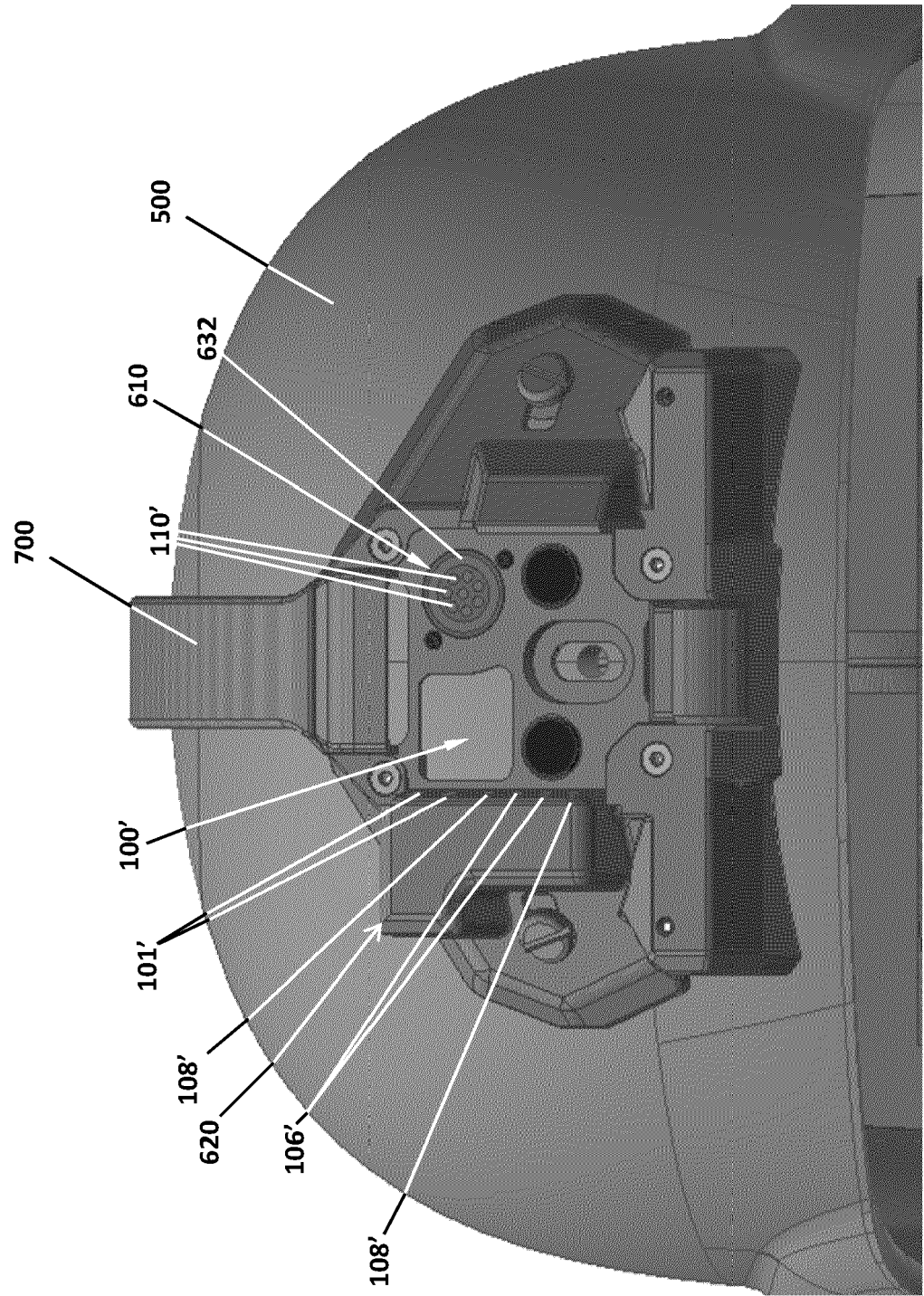

FIG. 10

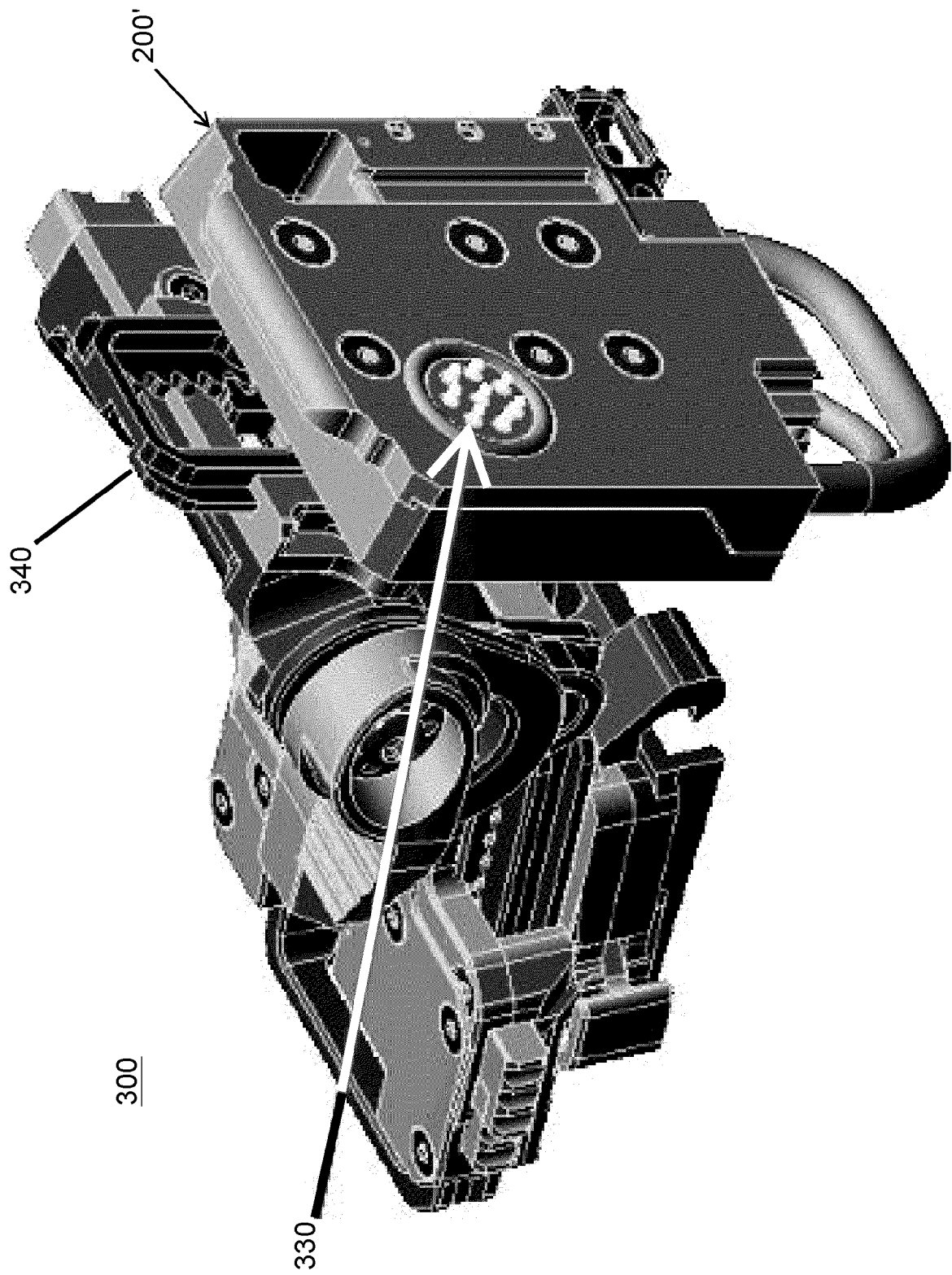

FIG. 11

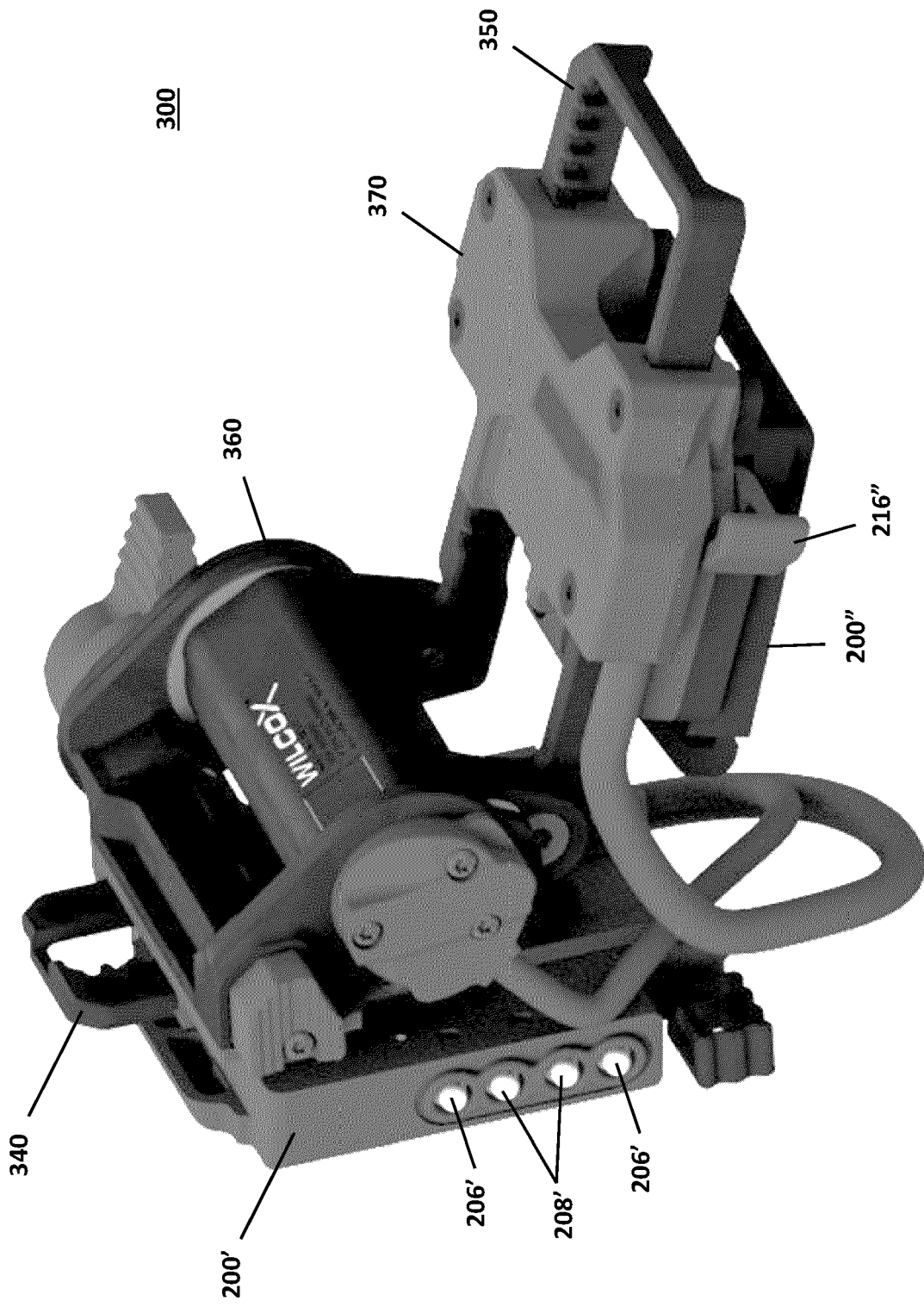

FIG. 12

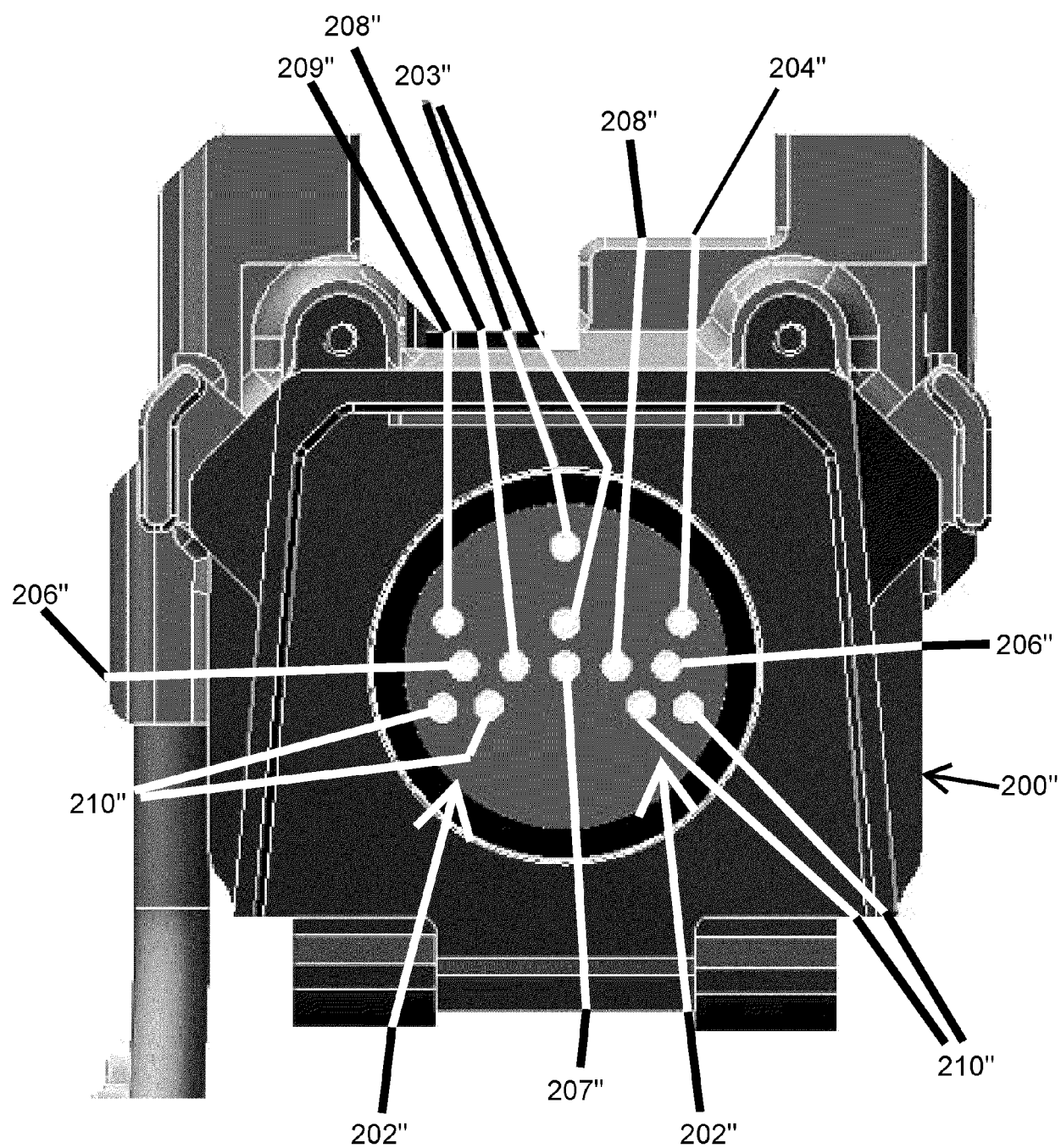

FIG. 13

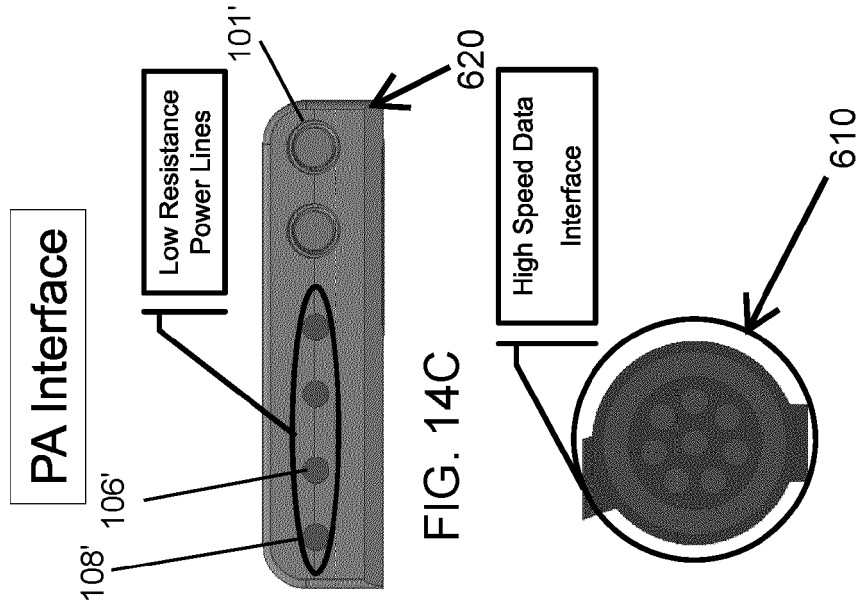

FIG. 14B

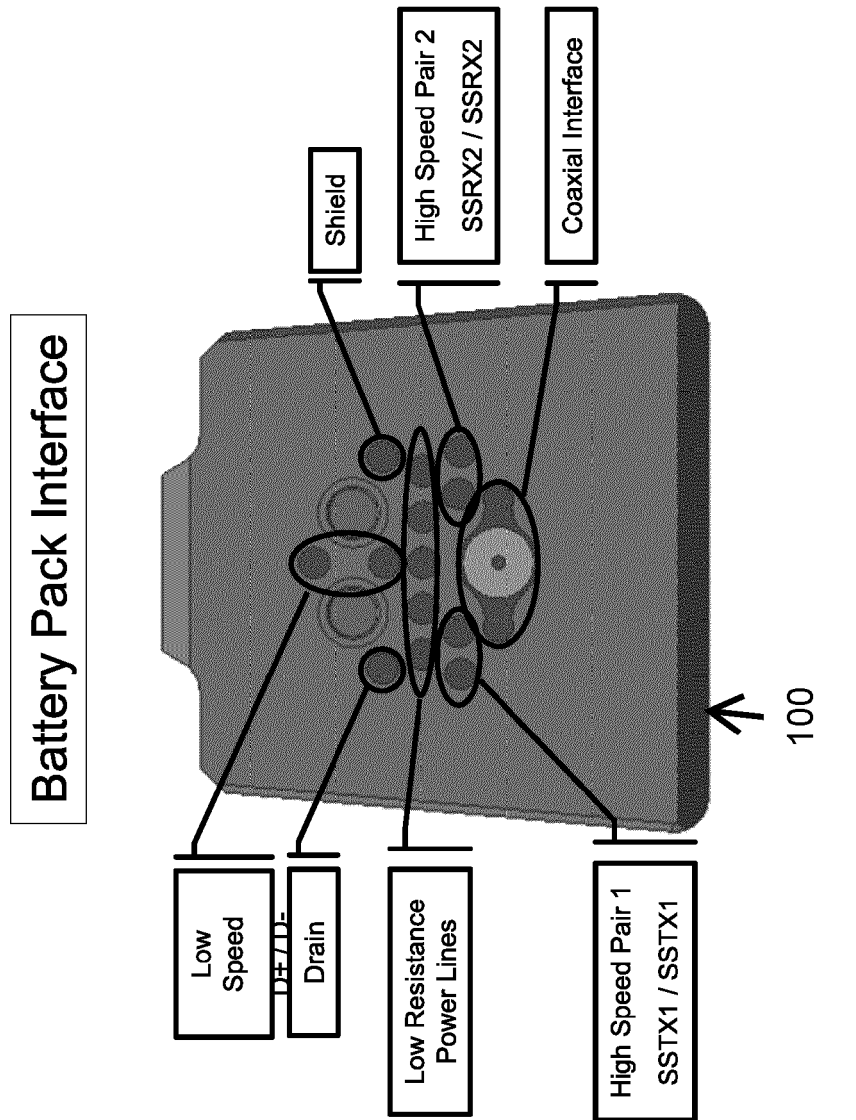

FIG. 14A

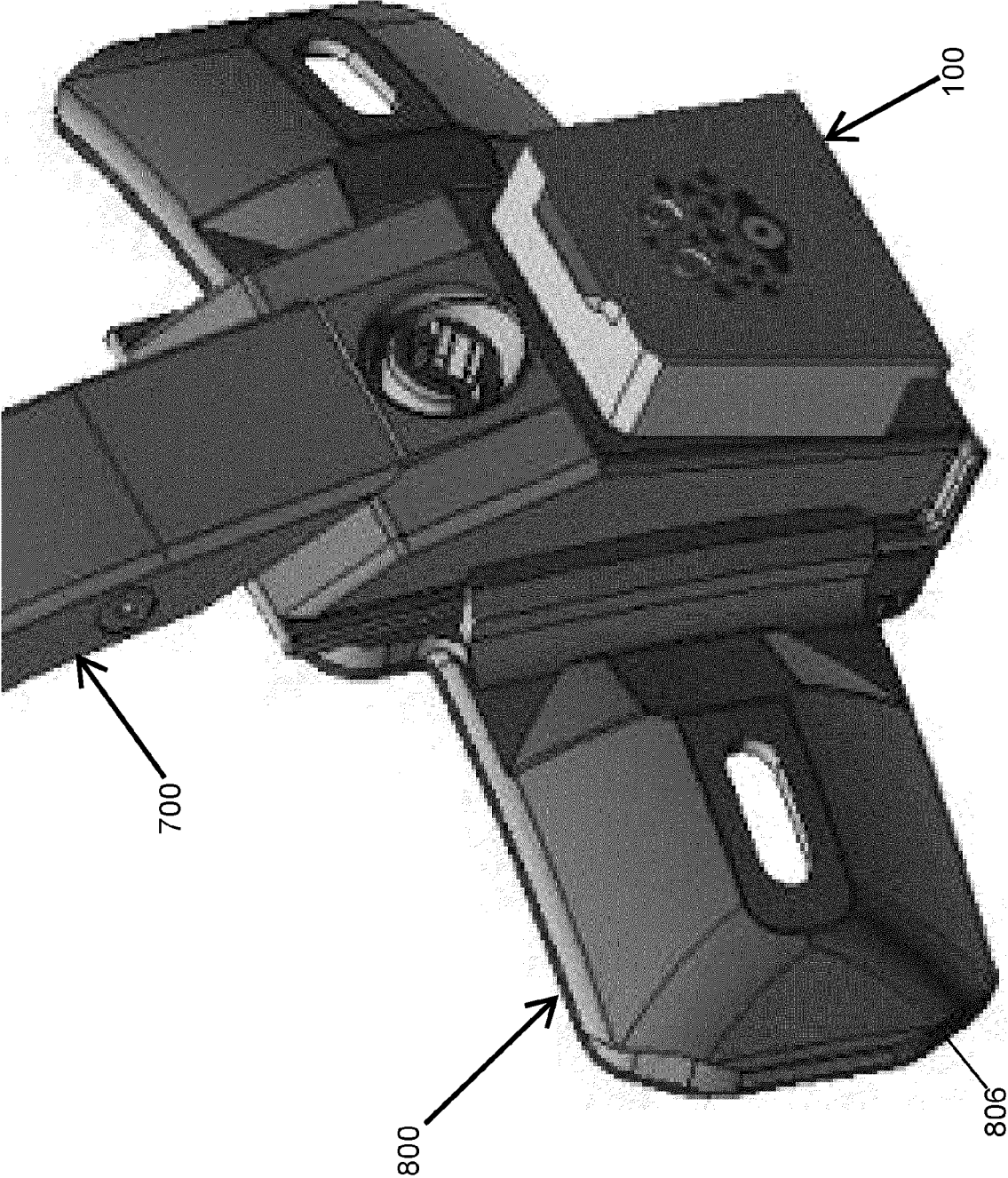

FIG. 15

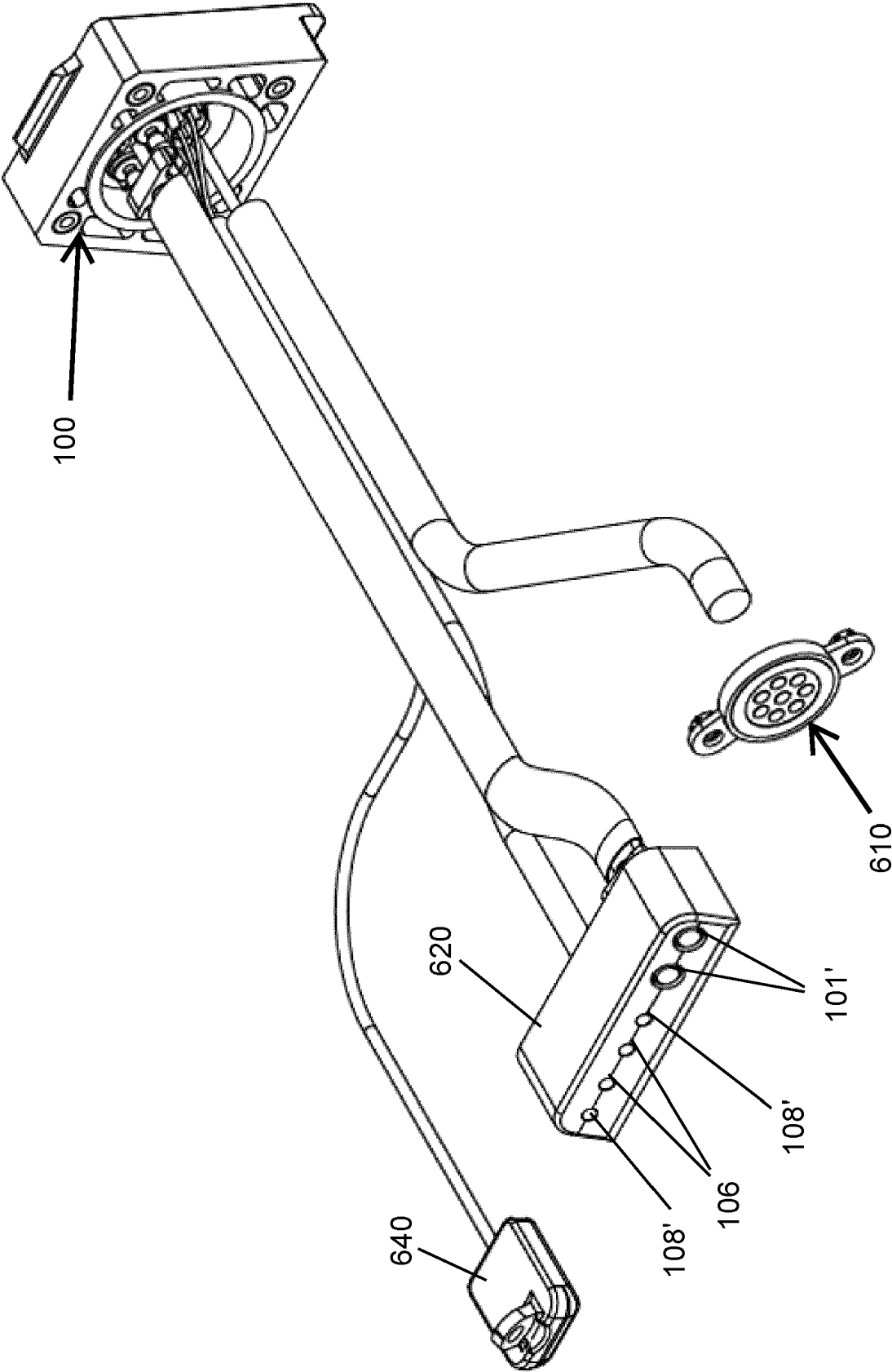

FIG. 16

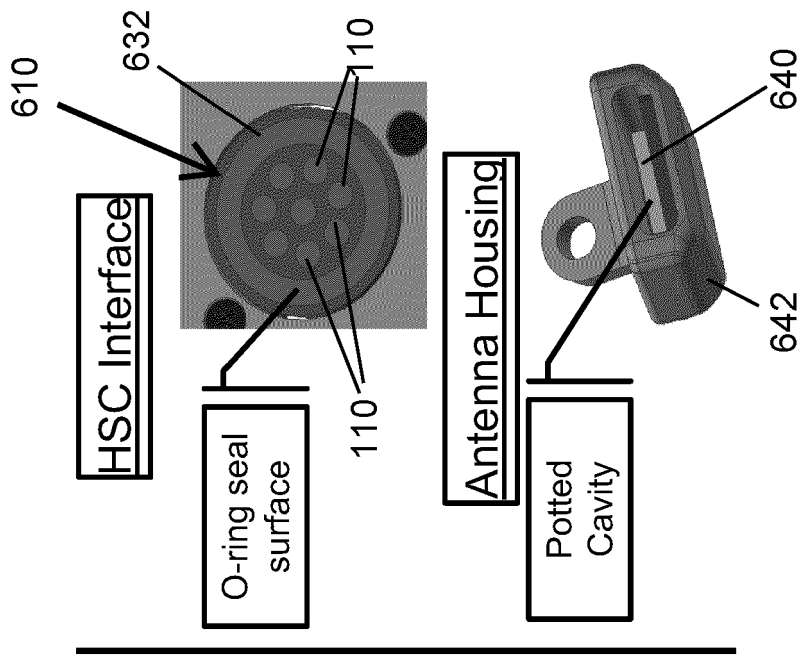

FIG. 17C

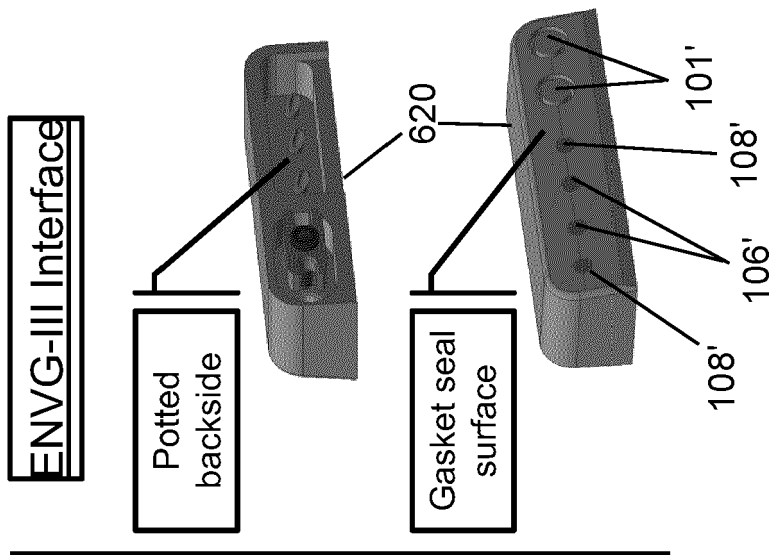

FIG. 17B

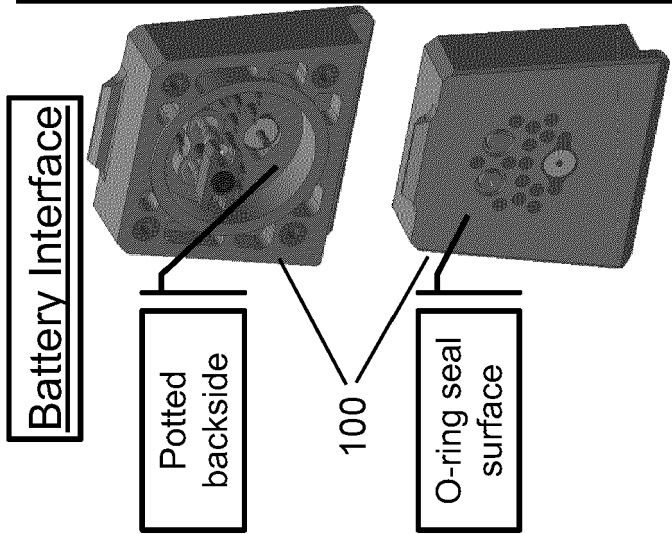

FIG. 17A

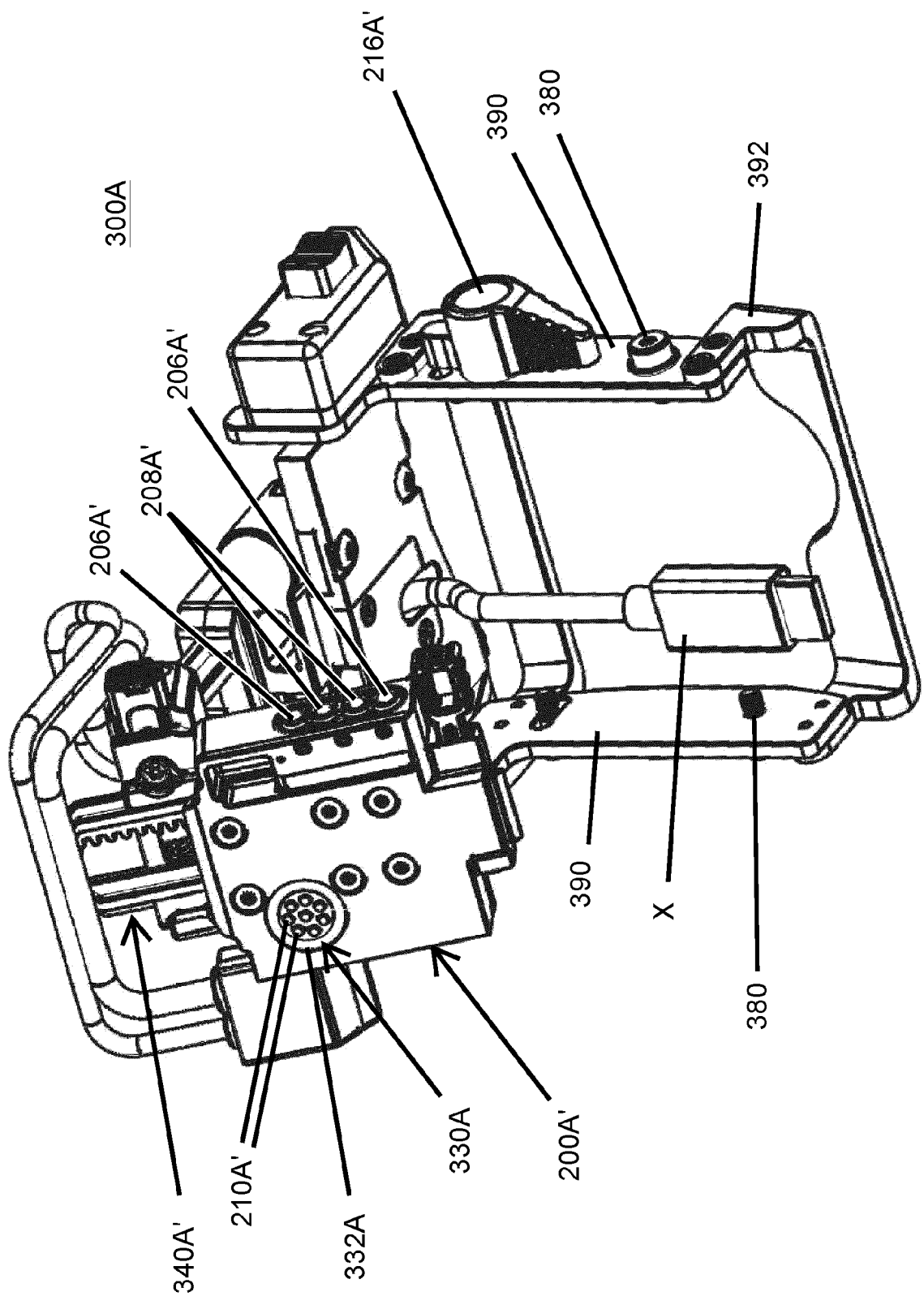

FIG. 18

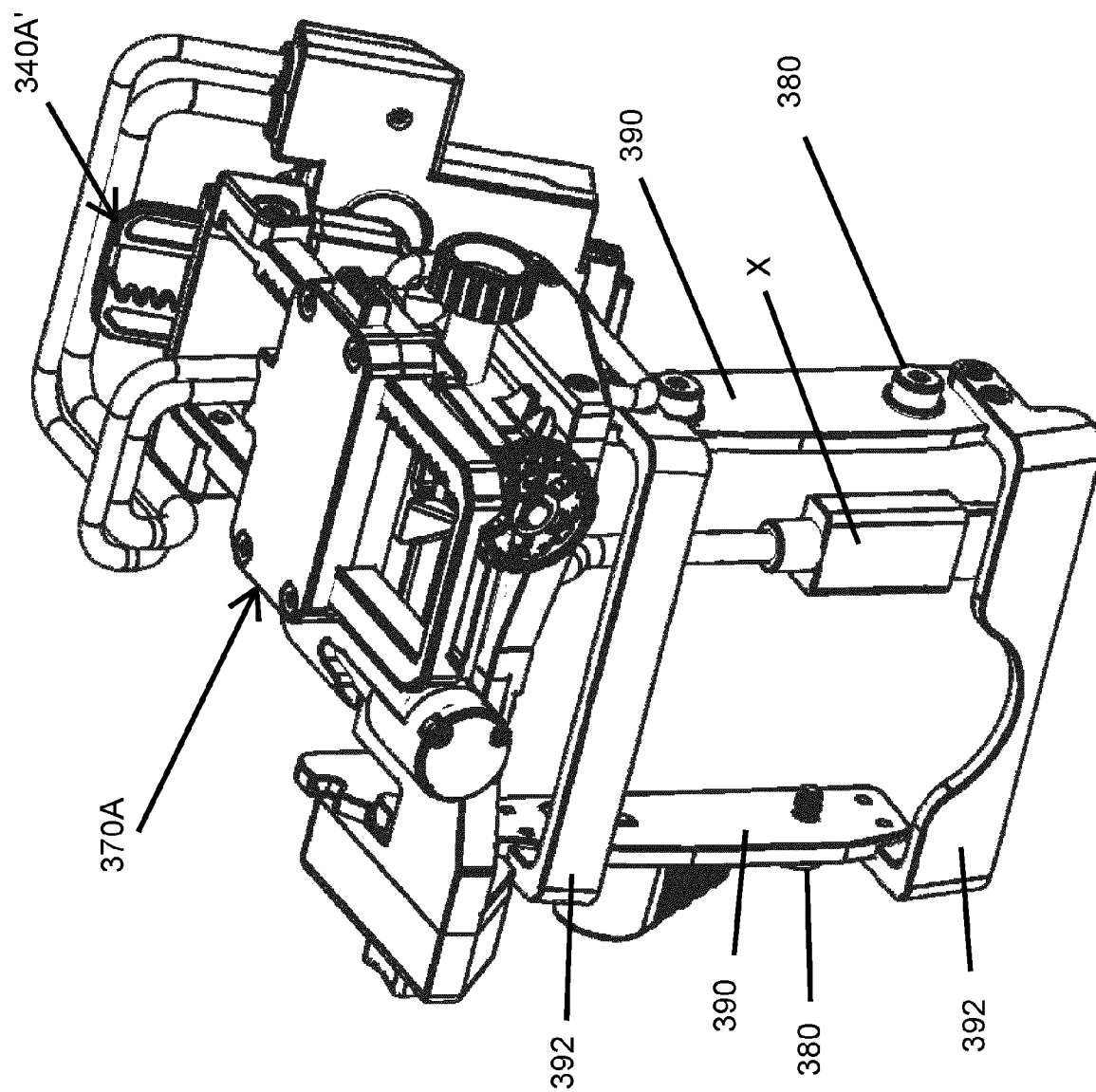

FIG. 19



EUROPEAN SEARCH REPORT

 Application Number
 EP 20 16 5707

5

10

15

20

25

30

35

40

45

50

55

DOCUMENTS CONSIDERED TO BE RELEVANT			
Category	Citation of document with indication, where appropriate, of relevant passages	Relevant to claim	CLASSIFICATION OF THE APPLICATION (IPC)
X,D,P	EP 3 582 331 A1 (WILCOX IND CORP [US]) 18 December 2019 (2019-12-18) * paragraphs [0006], [0058], [0068], [0069]; figures 1-5 *	1-12,14,15	INV. A42B3/04
X	US 2011/239354 A1 (CELONA MARC J [US] ET AL) 6 October 2011 (2011-10-06) * paragraphs [0045], [0046], [0053], [0054]; figures 1,4 *	1-3,14,15	
X	US 2008/170838 A1 (TEETZEL JAMES W [US] ET AL) 17 July 2008 (2008-07-17) * paragraphs [0016], [0017]; figures 1-3 *	1,2,13-15	
X	US 2015/264229 A1 (TEETZEL JAMES W [US] ET AL) 17 September 2015 (2015-09-17) * paragraphs [0042], [0043]; figure 1 *	1,2	
			TECHNICAL FIELDS SEARCHED (IPC)
			A42B
The present search report has been drawn up for all claims			
Place of search The Hague		Date of completion of the search 31 July 2020	Examiner D'Souza, Jennifer
CATEGORY OF CITED DOCUMENTS X : particularly relevant if taken alone Y : particularly relevant if combined with another document of the same category A : technological background O : non-written disclosure P : intermediate document T : theory or principle underlying the invention E : earlier patent document, but published on, or after the filing date D : document cited in the application L : document cited for other reasons & : member of the same patent family, corresponding document			

 1
 EPO FORM 1503 03.82 (P04C01)

**ANNEX TO THE EUROPEAN SEARCH REPORT
ON EUROPEAN PATENT APPLICATION NO.**

EP 20 16 5707

5

This annex lists the patent family members relating to the patent documents cited in the above-mentioned European search report.
The members are as contained in the European Patent Office EDP file on
The European Patent Office is in no way liable for these particulars which are merely given for the purpose of information.

31-07-2020

10

Patent document cited in search report	Publication date	Patent family member(s)	Publication date
EP 3582331 A1	18-12-2019	EP 3582331 A1	18-12-2019
		US 2019386412 A1	19-12-2019

US 2011239354 A1	06-10-2011	NONE	

US 2008170838 A1	17-07-2008	US 2008170838 A1	17-07-2008
		US 2013294740 A1	07-11-2013

US 2015264229 A1	17-09-2015	AU 2015201313 A1	01-10-2015
		GB 2526402 A	25-11-2015
		US 2015264229 A1	17-09-2015

15

20

25

30

35

40

45

50

55

EPO FORM P0459

For more details about this annex : see Official Journal of the European Patent Office, No. 12/82

REFERENCES CITED IN THE DESCRIPTION

This list of references cited by the applicant is for the reader's convenience only. It does not form part of the European patent document. Even though great care has been taken in compiling the references, errors or omissions cannot be excluded and the EPO disclaims all liability in this regard.

Patent documents cited in the description

- US 62825480 [0001]
- US 44160819 [0001]
- US 62685180 [0001]