



(11)

EP 4 009 341 A1

(12)

EUROPEAN PATENT APPLICATION

(43) Date of publication:
08.06.2022 Bulletin 2022/23

(51) International Patent Classification (IPC):
H01H 3/46 (2006.01) **H01H 21/36** (2006.01)
H01H 13/60 (2006.01) **H01H 23/16** (2006.01)

(21) Application number: **21211643.8**

(52) Cooperative Patent Classification (CPC):
H01H 3/46; H01H 21/36; H01H 13/60; H01H 23/162

(22) Date of filing: **01.12.2021**

(84) Designated Contracting States:
AL AT BE BG CH CY CZ DE DK EE ES FI FR GB GR HR HU IE IS IT LI LT LU LV MC MK MT NL NO PL PT RO RS SE SI SK SM TR
Designated Extension States:
BA ME
Designated Validation States:
KH MA MD TN

(72) Inventors:
• **Acién Fernández, Jonatan**
08013 Barcelona (ES)
• **López López, David**
08013 Barcelona (ES)

(74) Representative: **Balder IP Law, S.L.**
Paseo de la Castellana 93
5ª planta
28046 Madrid (ES)

(30) Priority: **01.12.2020 ES 202031196**

(71) Applicant: **Simon, S.A.U.**
08013 Barcelona (ES)

(54) **MECHANISM FOR SWITCHES WHICH COMPRISES TWO SWINGING MOBILE CONTACTS**

(57) The invention relates to a mechanism for a switch (S) comprising two swinging mobile contacts (P1, P2) each swinging according to an axis of rotation (IP) between two end positions, comprising, for each mobile contact (P1, P2), actuating levers (L1, L2) that can rotate about an axis (IP), comprising respective actuating ends (L1D, L2D) for pushing the mobile contacts (L1, L2), wherein the levers (L1) comprise respective cooperating support surfaces (LS1, LS2), the surfaces (LS1, LS2) being oriented such that the mutual support thereof

means that the first lever (L1) causes the rotation of the second lever (L2) when it is rotated according to the positive direction of rotation (+) and when the support surfaces (LS1, LS2) come into contact with one another; and the first lever (L1) constitutes a stop for stopping the rotation of the second lever (L2) when the second lever (L2) rotates according to the negative direction of rotation (-), such that an undesired configuration of the swinging mobile contacts (P1, P2) is prevented.

EP 4 009 341 A1

Description

TECHNICAL FIELD

[0001] The invention focuses on the field of mechanisms for switches and switches intended for having several positions and preventing undesired configurations of the underlying contacts, which may lead to short-circuits that could cause damage to drive motors. The invention therefore has a preferred application in the field of reversible drive motors for blinds.

BACKGROUND

[0002] Mechanisms for switches which are based on two swinging mobile contacts, also generally assembled adjacent to one another and swinging about a common axis, such that each of the mobile contacts can swing between two end positions, are known. These end positions are determined by respective fixed contacts connected to the input/output terminals of the switch.

[0003] The mobile contacts are moved by means of two actuating levers, also referred to as rocker arms, one for each mobile contact. These levers can in turn rotate about a common shaft, arranged parallel to the axis of the mobile contacts.

[0004] Each lever has an actuating end which is arranged away from the rotating shaft of the lever and mechanically connected with the respective mobile contact. This mechanical connection is made by means of a spring housed in the generally hollow body of the lever, having one end supported inside the lever and another end supported on the edge of the mobile contact.

[0005] Since there are two pairs of lever/mobile contact, in the absence of mechanical link between the levers, there are four possible configurations.

[0006] When these switches are used for actuating reversible motors, for example, for raising and lowering blinds or for extending and drawing back awnings, only three out of the four configurations are of interest. The fourth configuration corresponds to a short-circuit situation that must be avoided. The mechanism must prohibit that configuration.

[0007] To allow the three operating configurations and at the same time prohibit the short-circuit configuration, the interposition of a mechanism between the levers which prohibits said configuration is known in the state of the art.

[0008] However, the known mechanisms are complex because they involve a large number of parts.

DESCRIPTION OF THE INVENTION

[0009] To overcome the drawbacks of the state of the art, the present invention proposes a mechanism for switches comprising two swinging mobile contacts swinging according to an axis of rotation, such that each of the mobile contacts can swing between two end posi-

tions, comprising first and second swinging actuating levers, one for each mobile contact, the levers being able to rotate about a common shaft, with there being defined in each lever an actuating end, the actuating end being intended for directly and/or indirectly pushing the mobile contacts in a push area for pushing the mobile contacts, such that positive and negative directions of rotation of the levers are defined, wherein the first lever comprises a support surface and the second lever comprises a support surface intended for being supported on the support surface of the first lever, the surfaces being oriented such that the mutual support thereof can exert a moment on the levers with respect to the common shaft and such that:

- the first lever causes the rotation of the second lever when rotating according to one direction and when the support surfaces come into contact with one another; and
- the first lever constitutes a stop for stopping the rotation of the second lever when the second lever rotates according to the opposite direction of rotation.

[0010] The invention therefore consists of directly linking the levers to one another. This reduces the complexity of the mechanisms and their costs, as well as provides greater reliability.

[0011] Furthermore, these features can be formed during lever manufacture. The invention can also be implemented with a single lever design.

[0012] In some embodiments, each lever is made up of a rod joining the actuating end with the common shaft.

[0013] In some embodiments, each lever comprises two opposite extensions with respect to the common shaft which are perpendicular to the rod, these extensions comprising ends provided on an upper side with pressure application surfaces intended for the actuation of the levers.

[0014] In some embodiments, each lever comprises two support surfaces intended for being supported on the support surface of the other lever, the two surfaces of each of the levers being arranged opposite one another with respect to the common shaft.

[0015] By making the forces symmetrical, a pure moment is thereby achieved without any forces being applied on the shaft.

[0016] In some embodiments, each lever comprises in one of the extensions a projection extending according to the direction of the common shaft and towards the other lever, the projection being provided with one of the support surfaces, and the other extension of each lever being provided with the other support surface for the corresponding projection.

[0017] This is a symmetrical way of implementing the invention which allows the two levers to be made with a single design.

[0018] In some embodiments, the pressure application

surfaces have a V-shaped section such that they are made up of two inclined planes defining a concavity.

[0019] In some embodiments, the actuating end of each lever is made up of U-shaped grooves in which the push areas for pushing the mobile contacts snugly fit.

[0020] In some embodiments, the mechanism comprises stabilising springs for stabilising the lever/mobile contact assemblies, in which the rods of the levers comprise a cavity at the actuating end and house the spring therein.

[0021] In some embodiments, the mobile contacts have a common axis of rotation.

[0022] In some embodiments, the mobile contacts are made up of two segments, a first push or actuating segment which is pushed or actuated by the corresponding lever and provided with a projection for the fitting of the end of a spring arranged in the cavity of the actuating end of the lever and a second contact segment provided with a tab which comprises at its end a contact point.

[0023] In some embodiments, the mobile contacts are arranged in a manner relative to one another with their actuating segments being adjacent, such that their contact segments are arranged more towards the outside.

[0024] In some embodiments, the mechanism comprises a main terminal, a first terminal, and a second terminal, which are made up of a board provided at one end with a connection post, the main terminal being provided, at an end opposite the connection post, with a strip with a V-shaped section the vertex of which constitutes the common axis of rotation of the mobile contacts, such that there are defined in the strip a support segment for the first mobile contact and a support segment for the second mobile contact.

[0025] In some embodiments, the first terminal is arranged opposite the main terminal with respect to the axis of rotation of the first mobile contact, in which the second terminal is arranged facing the support segment for the second mobile contact and beside the main terminal, the first terminal being provided with a contact point, the second terminal being provided with a contact point, such that as a result of the support surfaces of the levers, only the following configurations are allowed:

- a first configuration in which the first mobile contact is not connected with the contact point of the first terminal, and in which the second mobile contact is not connected with the contact point of the second terminal, such that the connection post of the main terminal is electrically isolated from the connection terminals of the first terminal and the second terminal;
- a second configuration in which the first mobile contact is connected with the contact point of the first terminal, and in which the second mobile contact is not connected with the contact point of the second terminal, such that the connection post of the main terminal is in electrical contact with the connection post of the first terminal; and

- a third configuration in which the first mobile contact is not connected with the contact point of the first terminal, and in which the second mobile contact is connected with the contact point of the second terminal, such that the connection post of the main terminal is in electrical contact with the connection post of the terminal second;

with a configuration in which the first mobile contact is connected with the contact point of the first terminal, and in which the second mobile contact is connected with the contact point of the second terminal, not being possible.

[0026] In some embodiments, the surfaces for the mutual support of the levers are arranged such that when they come into contact with one another, the main axes of the rods of the two levers form an angle, preferably of 3° or greater.

[0027] In some embodiments, the mechanism comprises three buttons or pushbuttons:

- a first button provided with a pressure application end for applying pressure on the pressure application surface of the first lever leading to the second configuration;
- a second button provided with a pressure application end for applying pressure on the pressure application surface of the second lever leading to the third configuration; and
- a third button provided with two pressure application ends for simultaneously applying pressure on the application surfaces of the first lever and the second lever leading to the first configuration.

[0028] Lastly, the invention relates to a system for actuating blinds, comprising a reversible motor provided with three posts and a mechanism according to any of the variants, such that the motor can only be in:

- a forward movement operating mode;
 - a backward movement operating mode; and
 - an unpowered mode,
- with a short-circuit connection being impeded.

BRIEF DESCRIPTION OF THE FIGURES

[0029] To complete the description and for the purpose of providing a better understanding of the invention, a set of drawings is provided. Said drawings constitute an integral part of the description and illustrate embodiments of the invention that must not be interpreted as limiting the scope of the invention, but simply as an example of how to carry out the invention. The drawings comprise the following figures:

Figures 1 and 2 show the mechanism of the invention according to a preferred embodiment. Figures 3 and 4 show two configurations of the relative position of the actuating levers.

Figure 5a shows a front view of the mechanism in a configuration in which the mobile contacts are inclined to the left, and therefore connection is established between terminals B1 and BF. The levers are in the corresponding position.

Figure 5b is a plan view corresponding to Figure 5a, showing herein that the terminal B2 is isolated.

Figure 5c schematically shows the connection established in the configurations shown in Figure 5a. Figures 6a, 6b, and 6c are similar to Figures 5a, 5b, and 5c, respectively, but for a configuration in which the mobile contacts are arranged away from the first terminal and the second terminal, and therefore there is no conduction.

Figures 7a, 7b, and 7c are similar to Figures 5a, 5b, and 5c, respectively, but in the third stable configuration in which both mobile contacts are inclined to the right, and therefore the main terminal and the second terminal are electrically connected.

Figures 8 and 9 show two elevational sections of an embodiment provided with a button intended for bringing the mechanism to the configuration illustrated in Figures 6a to 6c.

Figure 10 shows the embodiment of Figures 8 and 9, but arranged in the crossed configuration, in a section to which there has been added, in order to facilitate viewing, the part provided with an extension and a leg on the side of the second lever.

Figure 11 shows a perspective view of the button with the relative position of the extensions and the legs which, together, perform the guiding and retention functions in the standby configuration.

DESCRIPTION OF PREFERRED EMBODIMENTS

[0030] As can be seen in Figure 1, the invention relates to a mechanism for switches S comprising two swinging mobile contacts P1, P2 each swinging according to an axis of rotation ΓP , such that each of the mobile contacts P1, P2 can swing between two end positions.

[0031] The mechanism comprises actuating levers L1, L2, i.e., first actuating lever L1 and second actuating lever L2, for each mobile contact P1, P2, the levers L1, L2 being able to rotate about a common shaft ΓL .

[0032] Each lever L1, L2, also referred to as rocker arms, has an actuating end L1D, L2D intended for directly and/or indirectly pushing the mobile contacts L1, L2 in a push area P11, P12 for pushing the mobile contacts P1, P2.

[0033] A direct push is possible because the end itself can directly push the mobile contacts. However, generally, that push will occur as a result of a push through a spring M inserted in a cavity of the lever, at the actuating end L1D, L2D thereof.

[0034] Positive and negative directions of rotation of the levers L1, L2 can also be defined.

[0035] According to the invention, as can be seen in Figures 3 and 4, the first lever L1 comprises a support

surface LS1 and the second lever L2 comprises a support surface LS2 intended for being supported on the support surface LS1 of the first lever L1. These surfaces LS1, LS2 are oriented such that the mutual support thereof can exert a moment on the levers L1, L2 with respect to the common shaft ΓL and such that:

- the first lever L1 causes the rotation of the second lever L2 when rotating according to the positive direction of rotation + and when the support surfaces LS1, LS2 come into contact with one another; and
- the first lever L1 constitutes a stop for stopping the rotation of the second lever L2 when the second lever L2 rotates according to the negative direction of rotation.

[0036] In other words, in the operating interval of the levers which is demarcated by the contacts which limit the angular working interval of the mobile contacts, the lever L1 can push the lever L2 according to one of the directions and the lever L2 can push L1 according to the opposite direction. However, the lever L1 cannot 'pull' the lever in the opposite direction. In other words, the lever L1 constitutes a stop for the lever L2, and from the configuration viewpoint, there is a prohibited configuration, which is that in which the lever L2 is arranged on the right and the lever 1 on the left (in reference to the part arranged below the rotating shaft ΓL of the levers, when viewing the levers from a front view in which the first lever is arranged in front of the second lever).

[0037] Each lever L1, L2 is made up of a rod LH1, LH2 joining the actuating end L1D, L2D with the common shaft ΓL and comprises two opposite extensions E11, E12, E21, E22 with respect to the common shaft ΓL which are perpendicular to the rod LH1, LH2, these extensions E11, E12, E21, E22 comprising ends provided on an upper side with pressure application surfaces L11, L12, L21, L22 intended for the actuation of the levers L1, L2.

[0038] The mutual push is implemented by means of two support surfaces LS1, LS2 in each lever L1, L2. These two surfaces LS1, LS2 of each of the levers L1, L2 are arranged opposite one another with respect to the common shaft ΓL .

[0039] One of the extensions E11, E22 of each lever L1, L2 comprises a projection S11, S21 extending according to the direction of the common shaft ΓL and towards the other lever L1, L2, the projection S11, S21 being provided with one of the support surfaces LS1, LS2, and the other extension E12, E21 of each lever L1, L2 being provided with a support surface for the corresponding projection S11, S21.

[0040] The pressure application surfaces L11, L12, L21, L22 have a V-shaped section such that they are made up of two inclined planes defining a concavity. The concavities resulting from these V-shaped sections are intended for receiving the push of non-depicted buttons that can be directly actuated by the user and arranged above the depicted mechanism.

[0041] According to a preferred embodiment, the actuating end L1D, L2D of each lever L1, L2 is made up of U-shaped grooves in which the push areas P11, P12 for pushing the mobile contacts P1, P2 snugly fit.

[0042] In a preferred embodiment, the actuating ends L1D, L2D of the levers L1, L2 are connected to a push area or actuating segment TA for pushing or actuating the mobile contact P1, P2, with the interposition of a stabilising spring M.

[0043] The stabilising springs M for stabilising the lever/mobile contact assemblies L1/P1, L2/P2, are housed in a cavity inside the rods LH1, LH2 which are hollow at least at their actuating end L1D, L2D.

[0044] Moreover, an embodiment in which the mobile contacts P1, P2 have a common axis of rotation ΓP is preferred. An embodiment in which the mobile contacts P1, P2 are made up of two segments TA, TC is also preferred. A first actuating segment TA or push area that is actuated or pushed by the corresponding lever L1, L2 and provided with a projection F1A, F2A for the fitting of the end of a spring M arranged in the lever L1, L2 and a second contact segment TC provided with a tab which comprises at its end a contact point F1, F2.

[0045] The mobile contacts P1, P2 are therefore arranged in a manner relative to one another with their actuating segments TA being adjacent, such that their contact segments TC are arranged more towards the outside.

[0046] Besides the movable mechanism of the switch, the invention comprises a main terminal F, a first terminal 1, and a second terminal 2, which are made up of a board provided at one end with a connection post BF, B1, B2, the main terminal F being provided, at an end opposite the connection post BF, with a strip with a V-shaped section the vertex of which constitutes the common axis of rotation ΓP of the mobile contacts P1, P2, such that there are defined in the strip a support segment for the first mobile contact P1 and a support segment for the second mobile contact P2.

[0047] As shown in Figures 5a to 7c, the first terminal 1 is arranged opposite the main terminal F with respect to the common axis of rotation ΓP of the mobile contacts P1, P2, in which the second terminal 2 is arranged facing the support segment for the second mobile contact P2 and beside the main terminal F, the first terminal 1 being provided with a contact point C1, the second terminal 2 being provided with a contact point C2, such that as a result of the support surfaces LS1, LS2 only the following configurations are allowed:

- a first configuration, shown in Figures 6a to 6c, in which the first mobile contact P1 is not connected with the contact point C1 of the first terminal 1, and in which the second mobile contact P2 is not connected with the contact point C2 of the second terminal 2, such that the connection post BF of the main terminal F is electrically isolated from the connection terminals B1, B2 of the first terminal 1 and the second

terminal 2.

- a second configuration, shown in Figures 5a to 5c, in which the first mobile contact P1 is connected with the contact point C1 of the first terminal 1, and in which the second mobile contact P2 is not connected with the contact point C2 of the second terminal 2, such that the connection post BF of the main terminal F is in electrical contact with the connection post B1 of the first terminal 1; and
- a third configuration, shown in Figures 7a to 7c, in which the first mobile contact P1 is not connected with the contact point C1 of the first terminal 1, and in which the second mobile contact P2 is connected with the contact point C2 of the second terminal 2, such that the connection post BF of the main terminal F is in electrical contact with the connection post B2 of the second terminal 2;

with a configuration in which the first mobile contact P1 is connected with the contact point C1 of the first terminal 1, and in which the second mobile contact P2 is connected with the contact point C2 of the second terminal 2, not being possible.

[0048] The described mechanism is designed for operating with three buttons or pushbuttons:

- a first button provided with a pressure application end for applying pressure on the pressure application surface L11 of the first lever L1 leading to the second configuration;
- a second button provided with a pressure application end for applying pressure on the pressure application surface L22 of the second lever L2 leading to the third configuration; and
- a third button provided with two pressure application ends for simultaneously applying pressure on the application surfaces of the first lever L1 and the second lever L2 leading to the first configuration.

[0049] The present invention therefore has advantageous application in a system for actuating blinds, comprising a reversible motor provided with three posts and a mechanism for switches according to the invention, such that the motor can only be in: a forward movement operating mode;

a backward movement operating mode; and
an unpowered mode,
with a short-circuit connection being impeded.

50

[0050] So far, the part of the levers has been described in detail up until the axis level. However, it is also envisaged that the mechanism comprises, as shown in Figures 8 and 9, a button BO1 comprising a body BB and having an axis of movement ΓB perpendicular to the common shaft ΓL of the levers L1, L2.

[0051] As shown in Figures 8 to 11, this button BO1 comprises a body BB and having an axis of movement

ΓB perpendicular to the common shaft ΓL .

[0052] This button BO1 comprises on one side a first leg B11 extending in the direction of the axis of movement ΓB and is arranged for pressing on a first pressure application surface L12 of the first swinging lever L1.

[0053] In turn, the first swinging lever L1 comprises an upper extension LU1 opposite its rod LH1 with respect to the common shaft ΓL . This upper extension LU1 comprises, in a very advantageous manner, an oblique surface LB1 with respect to the rod LH1.

[0054] Moreover, the body BB comprises a protuberance BP oriented towards the oblique surface LB1 and preferably centred in the axis of movement ΓB . This surface LB1 is oriented such that a force G1, exerted by the protuberance BP, shown in Figure 9, on the oblique surface LB1 exerts a moment MBP1 on the lever L1 with respect to the common shaft ΓL having the same direction as a moment MB11 exerted by the first leg B11 on the pressure application surface L12.

[0055] Therefore, when pressing the button at one of its ends, which causes a rotation thereof, and therefore an insufficient movement of the end arranged in the instantaneous axis of rotation of the button, the centre of the button does indeed most certainly move, and said movement is utilised by means of the protuberance BP to exert a moment on the lever.

[0056] Figures 8 to 10 depict the first lever L1 in a second plane (in contrast to Figures 1 to 7c), whereas the second lever L2 is in a first plane. Therefore, the part of the button which is located substantially above the first lever L1 is seen in Figures 8 and 9. Figure 10, however, also depicts a part of the button arranged in front of the section plane of the section, i.e., a part of the button arranged on the second lever L2.

[0057] The button comprises a second leg B12 protruding from the body of the button in the direction of the axis of movement ΓB and arranged for pressing on a first pressure application surface L22 of the second swinging lever L2, the second swinging lever L2 comprising an upper extension LU2 opposite its rod LH2 with respect to the common shaft ΓL , the upper extension LU2 comprising an oblique surface LB2 with respect to the rod LH2, the oblique surface LB2 being oriented such that a force G2 (shown in Figure 8) exerted by the protuberance BP on the oblique surface LB2 exerts a moment MBP2 on the swinging lever L2 with respect to the common shaft ΓL having the same direction as a moment MB12 exerted by the second leg B12 on the pressure application surface L21, such that when the button BO1 is pressed, the second lever L2 rotates in the direction opposite the rotation of the first swinging lever L1.

[0058] Likewise, there is envisaged a button spring MB which presses on the pushbutton BO1, moving it away from the common shaft ΓL , the button spring MB being supported on an upper end thereof on an inner surface of the button BO1 and on a lower end thereof on a support SB fixed with respect to the body of the switch.

[0059] As a retention accessory for the button, and as

shown in Figure 11, it is envisaged that the legs B11 and B12 comprise retention projections (of which reference is only made in Figures 10 and 11 to B12S of B12), which are arranged on the outer side of the legs B11 and B12, facing the wall of the switch S in which the button BO1 is housed. The function of the retention projections B12S is to act as means for stopping the button BO1 so as to stabilise same when it is pressed by the button spring MB towards its position farther away with respect to the levers L1, L2. In the wall of the switch containing the button, there is envisaged on the surface facing the extension a recess (not shown in the figures) which will be complementary with the retention projection B12S, to thereby act as a stop. Therefore, in a standby situation, the button BO1 will be in equilibrium pushed at the lower part thereof by a button spring MB and retained in the opposite direction by the retention projections B12S being supported in the recess of the walls.

[0060] It can be seen, for example in Figure 11, that the button BO1 comprises a guiding and retention extension RG1 arranged with respect to the first leg B11 on the other side with respect to the plane defined by the common shaft ΓL and the axis of movement ΓB , said guiding and retention extension projecting from the body of the button in the direction of the axis of movement ΓB and being provided with a retention projection R1S.

[0061] There can also be envisaged a second guiding and retention extension R2 arranged with respect to the second leg B12 on the other side with respect to the plane defined by the common shaft ΓL and the axis of movement ΓB , said second guiding and retention extension projecting from the body of the button in the direction of the axis of movement ΓB and being provided with a retention projection R2S.

[0062] The button BO1 is designed with a cavity BU oriented towards the swinging levers L1, L2, with the upper extension LU1, LU2 of the levers being housed in said cavity BU.

[0063] The term "comprises" and its derivations (such as "comprise", etc.) must not be understood herein in an exclusive sense, i.e., these terms must not be interpreted as excluding the possibility of what is described and defined may include other elements.

[0064] Obviously, the invention is not limited to the specific embodiments described herein, but also covers any variation that may be considered by any person skilled in the art within of the general scope of the invention defined in the claims.

Claims

1. A mechanism for a switch (S) comprising two swinging mobile contacts (P1, P2) each swinging according to an axis of rotation (ΓP), such that each of the mobile contacts (P1, P2) can swing between two end positions, comprising actuating levers (L1, L2), i.e., a first actuating lever (L1) and a second actuating

lever (L2), one for each mobile contact (P1, P2), the levers (L1, L2) being able to rotate about a common shaft (Γ L), with there being defined in each lever (L1, L2) an actuating end (L1D, L2D), the actuating end (L1D, L2D) being intended for directly and/or indirectly pushing the mobile contacts (P1, P2) in a push area (P11, P12) for pushing the mobile contacts (P1, P2), such that positive and negative directions of rotation of the levers (L1, L2) are defined, **characterised in that** the first lever (L1) comprises a support surface (LS1) and the second lever (L2) comprises a support surface (LS2) intended for being supported on the support surface (LS1) of the first lever (L1), the surfaces (LS1, LS2) being oriented such that the mutual support thereof can exert a moment on the levers (L1, L2) with respect to the common shaft (Γ L) and such that:

- the first lever (L1) causes the rotation of the second lever (L2) when rotating according to the positive direction of rotation (+) and when the support surfaces (LS1, LS2) come into contact with one another; and
 - the first lever (L1) constitutes a stop for stopping the rotation of the second lever (L2) when the second lever (L2) rotates according to the negative direction of rotation (-).
2. The mechanism for a switch according to claim 1, wherein each lever (L1, L2) is made up of a rod (LH1, LH2) joining the actuating end (L1D, L2D) with the common shaft (Γ L).
 3. The mechanism for a switch according to claim 2, wherein each lever (L1, L2) comprises two opposite extensions (E11, E12, E21, E22) with respect to the common shaft (Γ L) which are perpendicular to the rod (LH1, LH2), these extensions (E11, E12, E21, E22) comprising ends provided on an upper side with pressure application surfaces (L11, L12, L21, L22) intended for the actuation of the levers (L1, L2).
 4. The mechanism for a switch according to any of the preceding claims, wherein each lever (L1, L2) comprises two support surfaces (LS1, LS2) intended for being supported on the support surface of the other lever (L1, L2), the two surfaces (LS1, LS2) of each of the levers (L1, L2) being arranged opposite one another with respect to the common shaft (Γ L).
 5. The mechanism for a switch according to claims 3 and 4, wherein one of the extensions (E11, E21) of each lever (L1, L2) comprises a projection (S11, S21) extending according to the direction of the common shaft (Γ L) and towards the other lever (L1, L2), the projection (S11, S21) being provided with one of the support surfaces (LS1, LS2), and the other extension (E12, E22) of each lever (L1, L2) being pro-

vided with a support surface for the corresponding projection (S11, S21).

6. The mechanism for a switch according to any of the preceding claims, wherein the pressure application surfaces (L11, L12, L21, L22) have a V-shaped section such that they are made up of two inclined planes defining a concavity.
7. The mechanism for a switch according to claim 2 or any claim depending on said claim, comprising stabilising springs (M) for stabilising the lever/mobile contact assemblies (L1/P1, L2/P2), wherein the actuating ends LD1, LD2 of the rods (LH1, LH2) are hollow and house the springs (M).
8. The mechanism for a switch according to any of the preceding claims, wherein the mobile contacts (P1, P2) have a common axis of rotation (Γ P).
9. The mechanism for a switch according to claim 8, wherein the mobile contacts (P1, P2) are made up of two segments (TA, TC), a first actuating segment (TA) which is actuated by the corresponding lever (L1, L2) and provided with a projection (F1A, F2A) for the fitting of the end of a spring (M) arranged in the lever (L1, L2) and a second contact segment (TC) provided with a tab which comprises at its end a contact point (F1, F2).
10. The mechanism for a switch according to claim 9, wherein the mobile contacts (P1, P2) are arranged in a manner relative to one another with their actuating segments (TA) being adjacent, such that their contact segments (TC) are arranged more towards the outside.
11. The mechanism for a switch according to claim 8 or any claim depending on said claim, comprising a main terminal (F), a first terminal (1), and a second terminal (2), which are made up of a board provided at one end with a connection post (BF, B1, B2), the main terminal (F) being provided, at an end opposite the connection post (BF), with a strip with a V-shaped section the vertex of which constitutes the common axis of rotation (Γ P) of the mobile contacts (P1, P2), such that there are defined in the strip a support segment for the first mobile contact (P1) and a support segment for the second mobile contact (P2).
12. The mechanism for a switch according to claim 11, wherein the first terminal (1) is arranged opposite the main terminal (F) with respect to the common axis of rotation (Γ P) of the mobile contacts (P1, P2), in which the second terminal (2) is arranged facing the support segment for the second mobile contact (P2) and beside the main terminal (F), the first terminal (1) being provided with a contact point (C1),

the second terminal (2) being provided with a contact point (C2), such that as a result of the support surfaces (LS1, LS2) only the following configurations are allowed:

- a first configuration in which the first mobile contact (P1) is not connected with the contact point (C1) of the first terminal (1), and in which the second mobile contact (P2) is not connected with the contact point (C2) of the second terminal (2), such that the connection post (BF) of the main terminal (F) is electrically isolated from the connection terminals (B1, B2) of the first terminal (1) and the second terminal (2);
- a second configuration in which the first mobile contact (P1) is connected with the contact point (C1) of the first terminal (1), and in which the second mobile contact (P2) is not connected with the contact point (C2) of the second terminal (2), such that the connection post (BF) of the main terminal (F) is in electrical contact with the connection post (B1) of the first terminal (1); and
- a third configuration in which the first mobile contact (P1) is not connected with the contact point (C1) of the first terminal (1), and in which the second mobile contact (P2) is connected with the contact point (C2) of the second terminal (2), such that the connection post (BF) of the main terminal (F) is in electrical contact with the connection post (B2) of the second terminal (2);

with a configuration in which the first mobile contact (P1) is connected with the contact point (C1) of the first terminal (1), and in which the second mobile contact (P2) is connected with the contact point (C2) of the second terminal (2), not being possible.

13. The mechanism for a switch according to claim 3 and claim 12, comprising:

- a first button provided with a pressure application end for applying pressure on the pressure application surface (L11) of the first lever (L1) leading to the second configuration;
- a second button provided with a pressure application end for applying pressure on the pressure application surface (L22) of the second lever (L2) leading to the third configuration; and
- a third button provided with two pressure application ends for simultaneously applying pressure on the application surfaces of the first lever (L1) and the second lever (L2) leading to the first configuration.

14. A system for actuating blinds, comprising a reversible motor provided with three posts and a switch according to claim 12 or 13, such that the motor can only be in:

a forward movement operating mode;
a backward movement operating mode; and
an unpowered mode,
with a short-circuit connection being impeded.

Fig. 1

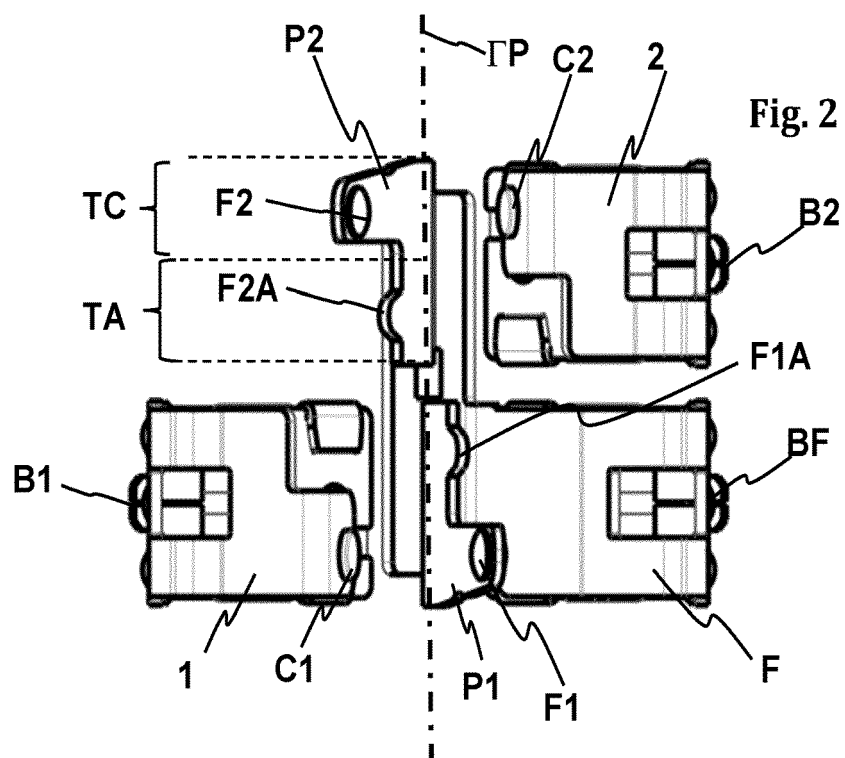
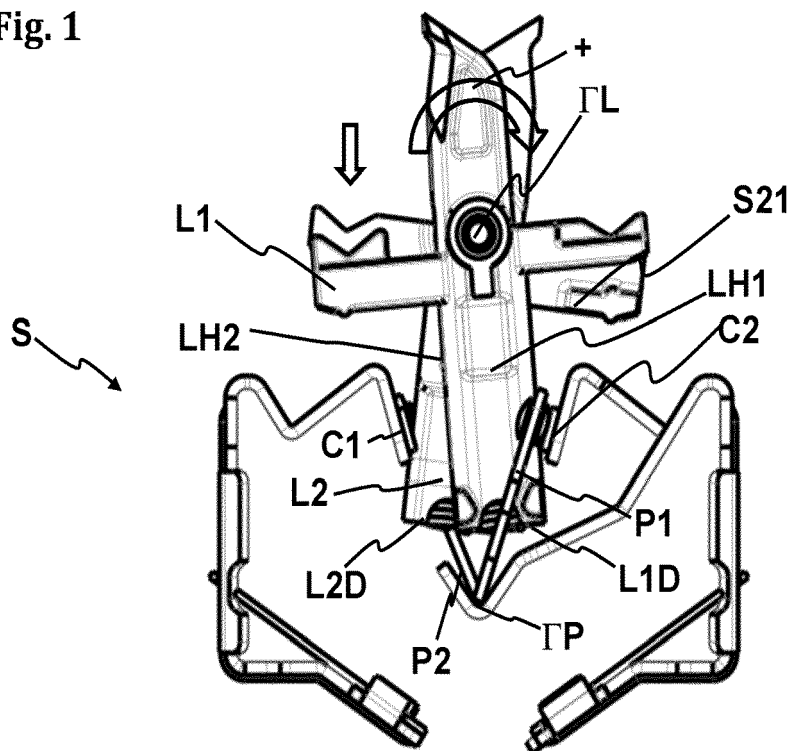

Fig. 2

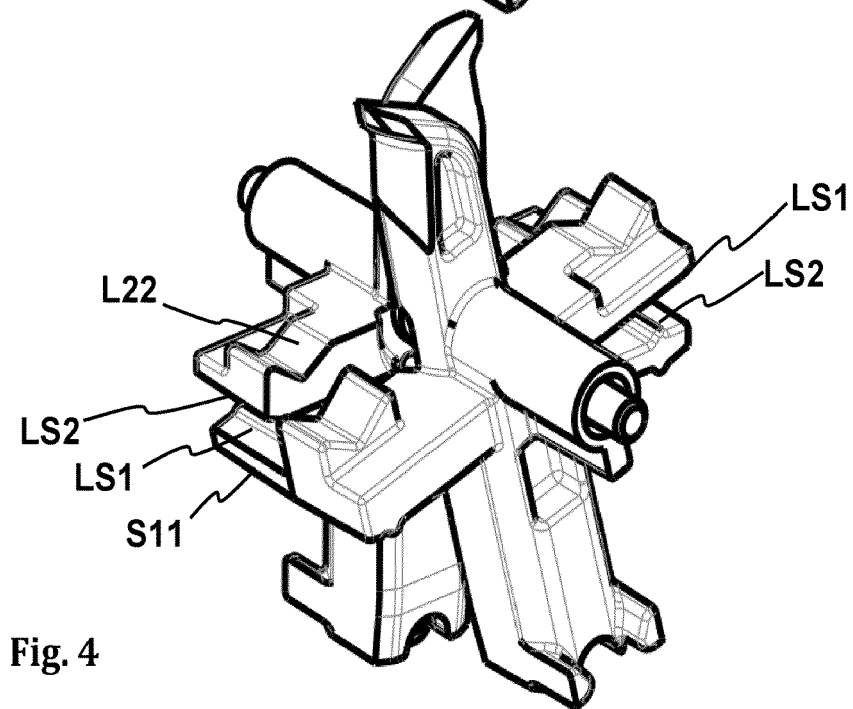
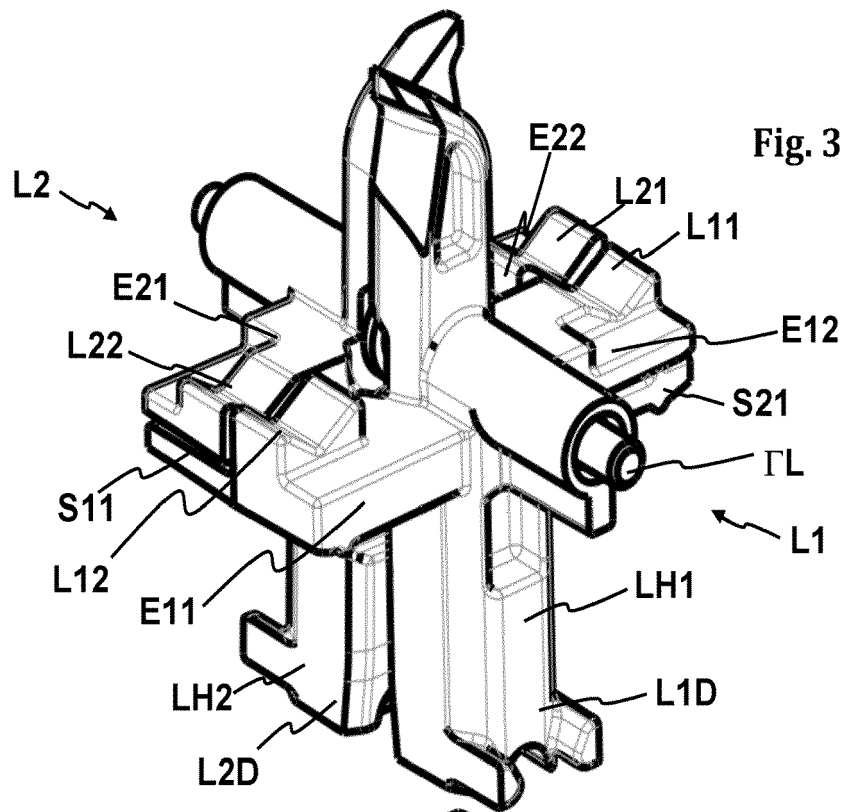

Fig. 5a

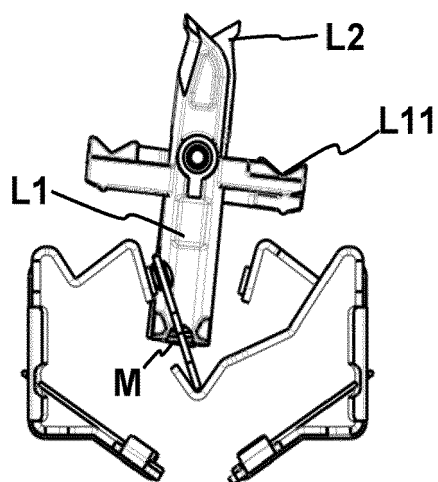

Fig. 6a

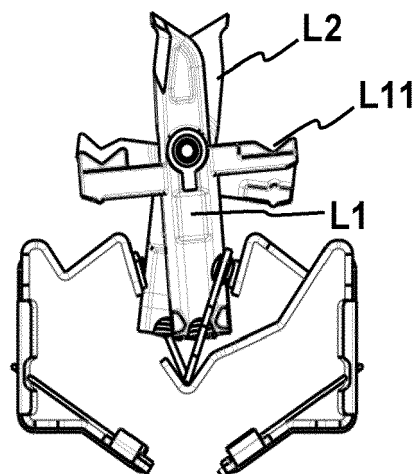

Fig. 5b

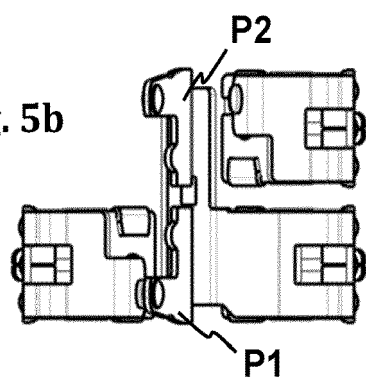

Fig. 6b

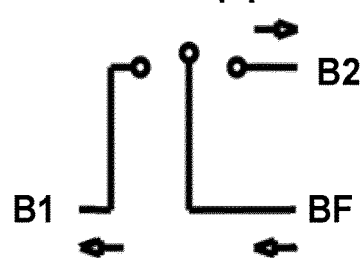
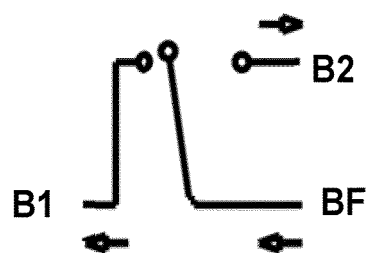
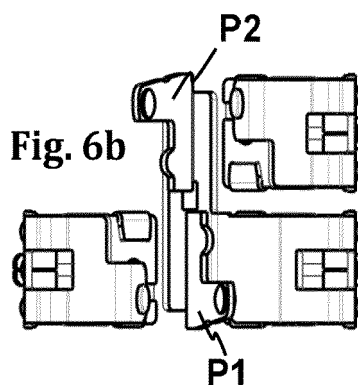

Fig. 5c

Fig. 6c

Fig. 7a

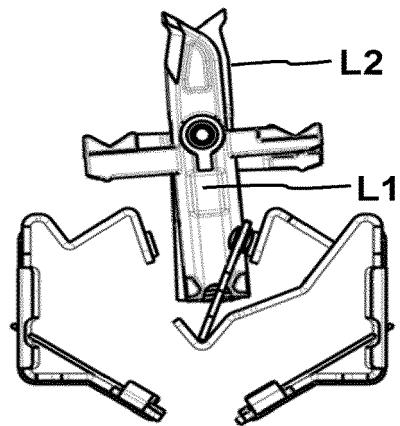

Fig. 7b

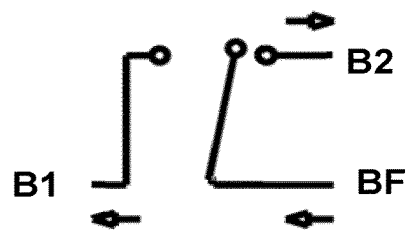
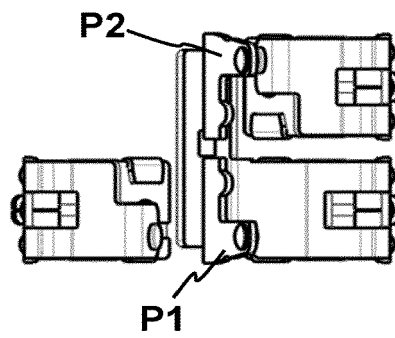

Fig. 7c

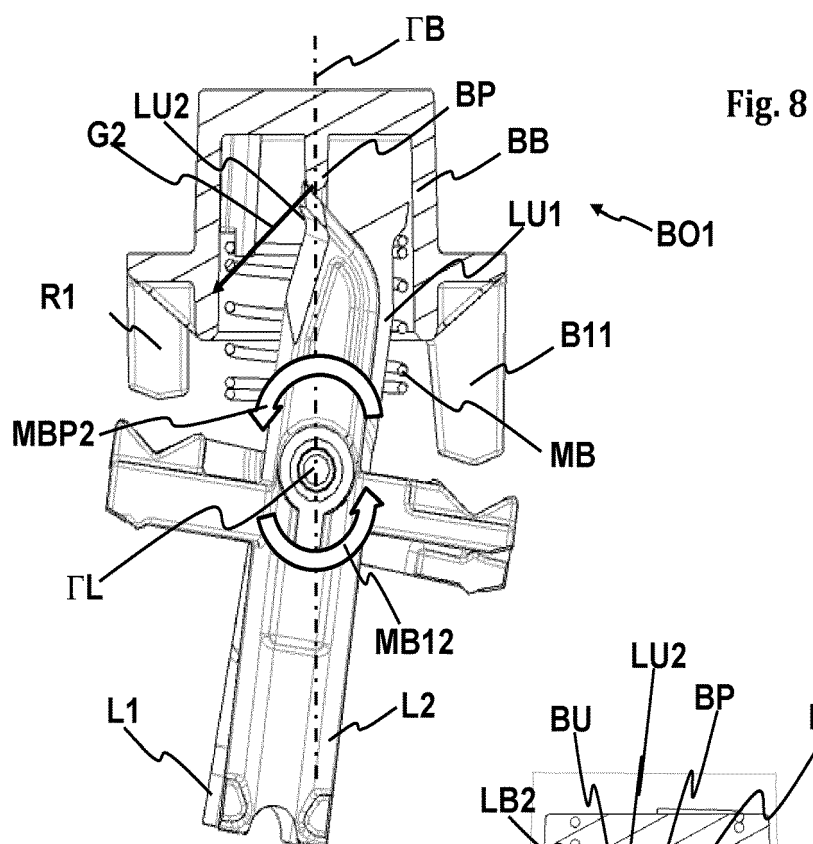
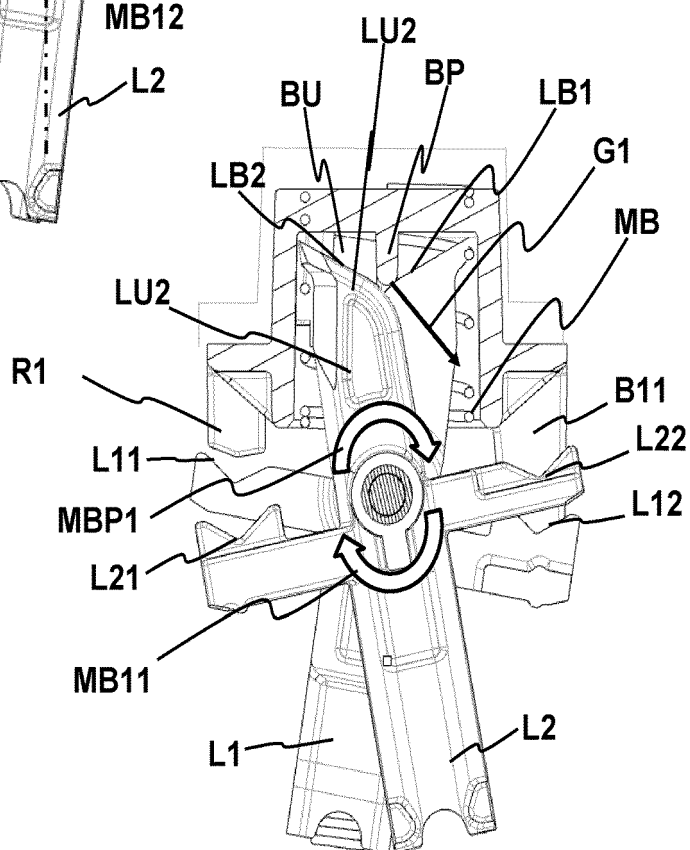

Fig. 9



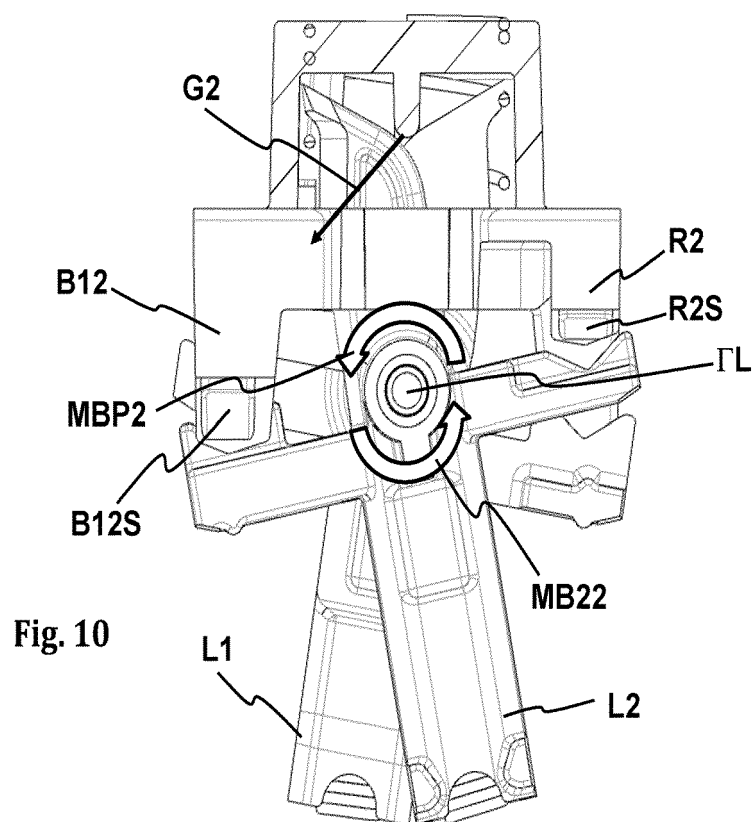

Fig. 10

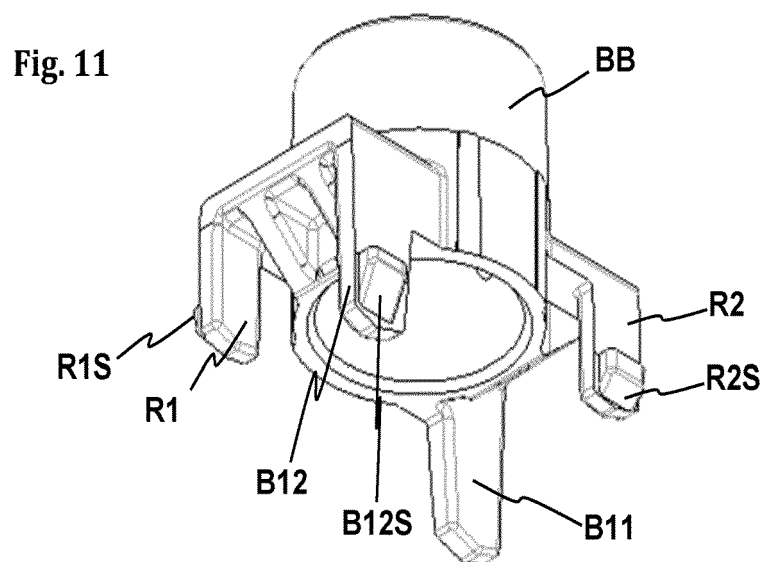

Fig. 11



EUROPEAN SEARCH REPORT

Application Number

EP 21 21 1643

DOCUMENTS CONSIDERED TO BE RELEVANT

Category	Citation of document with indication, where appropriate, of relevant passages	Relevant to claim	CLASSIFICATION OF THE APPLICATION (IPC)
A	WO 2019/239225 A1 (BTICINO SPA [IT]) 19 December 2019 (2019-12-19) * paragraph [0033] - paragraph [0080]; figures 1-13 *	1-14	INV. H01H3/46 H01H21/36
A	WO 2017/141093 A1 (BTICINO SPA [IT]) 24 August 2017 (2017-08-24) * paragraph [0032] - paragraph [0086]; figures 1-21 *	1-14	ADD. H01H13/60 H01H23/16
			TECHNICAL FIELDS SEARCHED (IPC)
			H01H
The present search report has been drawn up for all claims			
Place of search		Date of completion of the search	Examiner
Munich		27 April 2022	Nieto, José Miguel
CATEGORY OF CITED DOCUMENTS		T : theory or principle underlying the invention E : earlier patent document, but published on, or after the filing date D : document cited in the application L : document cited for other reasons & : member of the same patent family, corresponding document	
X : particularly relevant if taken alone Y : particularly relevant if combined with another document of the same category A : technological background O : non-written disclosure P : intermediate document			

EPO FORM 1503 03.82 (P04C01)

ANNEX TO THE EUROPEAN SEARCH REPORT ON EUROPEAN PATENT APPLICATION NO.

EP 21 21 1643

5 This annex lists the patent family members relating to the patent documents cited in the above-mentioned European search report.
The members are as contained in the European Patent Office EDP file on
The European Patent Office is in no way liable for these particulars which are merely given for the purpose of information.

27-04-2022

10	Patent document cited in search report	Publication date	Patent family member(s)	Publication date
15	WO 2019239225 A1	19-12-2019	AU 2019286354 A1	19-11-2020
			BR 112020025385 A2	09-03-2021
			CN 112335009 A	05-02-2021
			EP 3807917 A1	21-04-2021
			WO 2019239225 A1	19-12-2019

20	WO 2017141093 A1	24-08-2017	NONE	

25				
30				
35				
40				
45				
50				
55				

ORM P0459