



(11) **EP 4 067 672 A1**

(12) **EUROPEAN PATENT APPLICATION**

(43) Date of publication:
05.10.2022 Bulletin 2022/40

(51) International Patent Classification (IPC):
F16B 2/20 (2006.01) **B60N 2/015** (2006.01)
F16B 21/07 (2006.01) **F16B 45/00** (2006.01)

(21) Application number: **21176842.9**

(52) Cooperative Patent Classification (CPC):
F16B 45/00; B60N 2/01541; F16B 2/20;
F16B 21/073

(22) Date of filing: **31.05.2021**

(84) Designated Contracting States:
AL AT BE BG CH CY CZ DE DK EE ES FI FR GB
GR HR HU IE IS IT LI LT LU LV MC MK MT NL NO
PL PT RO RS SE SI SK SM TR
Designated Extension States:
BA ME
Designated Validation States:
KH MA MD TN

(72) Inventors:
• **KOLB, Christian**
79589 Binzen (DE)
• **RUFF, Alexander**
79576 Weil am Rhein (DE)
• **SCHEIYÄCK, Daniel**
79576 Weil am Rhein-Ötlingen (DE)

(30) Priority: **01.04.2021 EP 21166515**

(74) Representative: **König Szynka Tilmann von**
Renesse
Patentanwälte Partnerschaft mbB Düsseldorf
Mönchenwerther Straße 11
40545 Düsseldorf (DE)

(71) Applicant: **A. Raymond et Cie**
38000 Grenoble (FR)

(54) **LOCK FOR HOLDING A FIRST PART TO A SECOND PART AND ASSEMBLY OF A FIRST PART AND A SECOND PART**

(57) The invention relates to a lock for holding a first part to a second part comprising a holding body with a receptacle for receiving a protruding part of the second part, the holding body having a wall that borders the receptacle and a locking element, the locking element having a protrusion, whereby the locking element has a first position, whereby in the first position the protrusion is in a locking position, whereby in the locking position the protrusion protrudes from the wall into the receptacle by a first amount and the locking element has a second position, whereby in the second position the protrusion is in a release position, whereby in the release position the protrusion either protrudes from the wall into the receptacle by a second amount, whereby the second amount is smaller than the first amount, or the protrusion does not protrude from the wall, whereby the protrusion can be moved from the locking position to the release position

in a retraction direction relatively to the holding body, whereby a lever, whereby the lever has a first end and a second end that is arranged opposite the first end, whereby the protrusion is attached to the first end of the lever and the lever is or can be moved into a position, where the lever rests against a protrusion of the holding body at a point of contact, and when in contact with the protrusion the lever can be swiveled about the protrusion or the lever is connected to the holding body by a rotational joint, whereby the point of contact the rotational joint is arranged between the first end and the second end of the lever and applying a force to the second end that is directed against the retraction direction leads to a swivel movement of the lever about the protrusion or in the rotational joint and a movement of the protrusion in the retraction direction.

EP 4 067 672 A1

Description

[0001] The invention pertains to a lock for holding a first part to a second part. The invention also pertains to an assembly of a first part and a second part. The invention also pertains to a method for disassembly of such an assembly.

[0002] From CN 107487232 BB a lock for holding a first part to a second part is known. The lock comprises a holding body that has a receptacle for receiving a protruding part of the second part. The holding body has a wall that borders the receptacle. The lock also has a locking element that can be slidably arranged in the holding body. The locking element has a protrusion, whereby the locking element has a first position, whereby in the first position the protrusion protrudes from the wall into the receptacle by a first amount (locking position), and the locking element has a second position, whereby in the second position the protrusion protrudes from the wall into the receptacle by a second amount, whereby the second amount is smaller than the first amount, or whereby in the second position the protrusion does not protrude from the wall (release position). The protrusion can be moved from the first position to the second position in a retraction direction relative to the holding body.

[0003] A lock for holding a first part to a second part is also known from US 8,780,797. A lock for holding a first part to a second part is also known from CN104512280. A lock for holding a first part a second part is also known from KR 101403858 B1.

[0004] Given this background, the problem to be solved by the invention is to provide a lock for holding a first part to a second part that can be handled more easily by a worker.

[0005] This problem is solved by the lock according to claim 1, the assembly according to claim 6 and the method according to claim 7. Preferred embodiments are given in the subordinate claims and the description following hereafter.

[0006] The basic concept of the lock according to the invention is to have the retraction direction be a rotational retraction direction and for it to be in a certain sense the opposite direction of a pushing direction, with which the locking element can be moved. For example in CN 107487232 a push onto the locking element leads for the protrusion to move in the same direction as the pushing direction. Here the retraction direction would be the same direction as the pushing direction. That means, however, that space needs to be provided at the opposite end of the holding body in order to allow the protrusion to move at least partially out of the receptacle when the locking element is pushed. The basic concept of the invention, however, is to have the retraction direction of the protrusion to be the opposite direction of a pushing movement of the locking element.

[0007] This basic concept of the invention is implemented by providing the lock according to the invention with at least one lever. According to the invention the

lever has a first end and a second end that is arranged opposite the first end, whereby the protrusion is attached to the first end of the lever or forms a part of the first end of the lever. According to the invention the lever is connected to the holding body by a rotational joint or the lever is connected to an attachment body by a rotational joint, whereby the attachment body is attached to the holding body.

[0008] The rotational joint is arranged between the first end and the second end of the lever.

[0009] According to the invention, applying a force to the second end that is directed towards the receptacle leads to a swivel movement of the lever in the rotational joint. This leads to a movement of the protrusion in the retraction direction. It can be said that providing the lever allows the application of force to the second end of the lever to be translated into a movement of the protrusion in the opposite direction. Pushing the locking element in leads to the protrusion being pulled out.

[0010] The lock has a holding body with a receptacle for receiving a protruding part of the second part. A holding body can be an individual body that can be attached to the first part. A holding body can, for example be made by injection moulding. A holding body can, however, also be made as one part of the first part.

[0011] The holding body has a wall that borders the receptacle. The holding body can have more than one wall that borders the receptacle. For example if the receptacle has a rectangular cross-section, the holding body will have a first wall, a second wall, a third wall, a fourth wall that each border the receptacle and between them give the receptacle its rectangular shape. In a preferred embodiment, the receptacle has a bottom wall. The receptacle preferably is made like a cul-de-sac having one opening that allows the protruding part of the second part to be inserted the remainder of the receptacle being delineated by the walls. The bottom wall can be used as a limitation to pushing the protruding part of the second part into the receptacle. The protruding part of the second part can only be pushed into the receptacle until the tip of the protruding part contacts the bottom wall of the receptacle. However, designs are also feasible, where the receptacle has no bottom wall. Designs are also feasible, where the walls of the holding body that border the receptacle have openings. The walls that border the receptacle can also be more of the style of a frame. The holding body is said in claim 1 to have a wall that borders the receptacle in order to define the reference plane within the holding body relative to which reference plane the position of the protrusion of the locking element for the locking position and the release position can be described.

[0012] In a preferred embodiment the wall that borders the receptacle is arranged on a first part of the holding body, whereby a further wall that is arranged on the other side of the receptacle and faces the wall is additionally provided, whereby the further wall is arranged on a second part of the holding body. In a preferred embodiment

the first part of the holding body has an upper surface that is arranged in a first plane, whereby the second part of the holding body has an upper surface that is arranged in a second plane, whereby the first plane is above the second plane. In a preferred embodiment the first part of the holding body is longer than the second part of the holding body.

[0013] In a preferred embodiment, the holding body has an outward facing surface that is arranged flush with an outward facing surface of the lever. In a preferred embodiment the first part of the holding body has an outward facing surface that is arranged flush with an outward facing surface of the lever. Having an outward facing surface of the holding body being arranged flush with an outward facing surface of the lever prevents the lever from being pushed by a large object. Having an outward facing surface of holding body being arranged flush with an outward facing surface of the lever requires the lever to be pushed by an element that has the same size or is smaller than the outward facing surface of the lever.

[0014] The wall that borders the receptacle may have a hole and the locking element may protrude through the hole into the receptacle.

[0015] In a preferred embodiment, the holding body has a first wall that borders the receptacle, whereby in the locking position the protrusion protrudes from the first wall into the receptacle by a first amount and whereby in the release position

- the protrusion either protrudes from the first wall into the receptacle by a second amount, whereby the second amount is smaller than the first amount,
- or the protrusion does not protrude from the first wall,

whereby in this preferred embodiment the holding body has a second wall that borders the receptacle, whereby the second wall is arranged opposite the first wall and whereby the second wall has a hole or a recess, whereby the protrusion has a tip, whereby the protrusion can be brought into a position, where the tip of the protrusion engages the hole or recess in the second wall. In a first alternative, the tip of the protrusion engages the hole or recess in the second wall when the protrusion is in the locking position. In a second alternative, the tip of the protrusion engages the hole or recess in the second wall in a forward position, whereby in the forward position the protrusion protrudes from the first wall into the receptacle by an amount that is larger than the first amount.

[0016] In a preferred embodiment, the recess is provided by way of a section of the second wall protruding towards the first wall over other sections of the second wall.

[0017] The lock according to the invention has a locking element. The purpose of the locking element is to hold the protruding part of the second part in the receptacle, once the protruding part of the second part has been introduced into the receptacle. For this purpose, the locking element has a protrusion. The locking ele-

ment has a first position, whereby in the first position the protrusion protrudes from the wall into the receptacle by a first amount. This position of the protrusion is called the locking position. The locking element also has a second position, whereby when the locking element is in the second position, the protrusion protrudes from the wall into the receptacle by a second amount, whereby the second amount is smaller than the first amount or as an alternative the protrusion does not protrude from the wall into the receptacle at all when the locking element is in the second position. The position of the protrusion when the locking element is in the second position is called the release position.

[0018] The form and shape of the protrusion can be chosen in dependence of the form and shape of the protruding part of the second part that is received in the receptacle. According to the invention, it is intended, that the protrusion in the locking position blocks the protruding part of the second part from being retracted from the receptacle, while the protrusion in the release position allows the protruding part of the second part to be retracted from the receptacle.

[0019] According to the invention, the protrusion can be moved from the locking position to the release position in a rotational retraction direction relative to the holding body, for example a circumferential direction of a rotational movement.

[0020] In a preferred embodiment, the lever is a longitudinal element. A longitudinal element is understood to be an element, which has a length, a height and a width, whereby the maximum length is larger by a factor of at least two, preferably by a factor of at least three, more preferably by a factor of at least four than the maximum width and/or the maximum height of the element. In a preferred embodiment, the lever is a solid element and acts like a bar.

[0021] According to the invention the lever has a first end and a second and that is arranged opposite the first end, whereby the protrusion is attached to the first end of the lever. The protrusion can be directly and rigidly attached to the first end of the lever; it can even be formed as one piece with the lever. This would mean that the protrusion would follow in its movement the path of movement of the first end.

[0022] In one alternative of the invention, the lever is connected to the holding body by a rotational joint, whereby the rotational joint is arranged between the first end and the second end. In a second alternative of the invention, the lever is connected to an attachment body by a rotational joint, whereby the attachment body is attached to the holding body.

[0023] The lever, the joint and the attachment body can all be parts of an one-piece element, for example an element that is created by molding. In a preferred embodiment the joint is provided by a torsion bar. The lever, the torsion bar and the attachment body can all be parts of an one-piece element, for example an element that is created by molding.

[0024] According to the invention the applying of force to the second end of the lever that is directed towards the receptacle leads to a swivel movement of the lever in the rotational joint and leads to a movement of the protrusion in the rotational retraction direction. By introducing the lever, the invention provides the possibility of applying a force in one direction (for example a pushing force onto the locking element) that by way of the lever swiveling in the rotational joint is translated into a movement of the protrusion of the locking element into the opposite direction.

[0025] In a preferred embodiment, the attachment body has a first end that is attached to the joint and has a second end that is distanced from the first end. In a preferred embodiment, a locking protrusion is arranged at the second end of attachment protrusion, whereby the locking protrusion can be engaged with a part of the holding body to hold the attachment body in a predetermined position in the holding body.

[0026] In a preferred embodiment, a guide arm is arranged at the second end of the attachment body, whereby the guide arm is arranged in a channel in the holding body.

[0027] In a preferred embodiment, the holding body is made of plastic material. In a preferred embodiment, the holding body is made by way of injection moulding. In a preferred embodiment, the locking element is made of plastic material. In a preferred embodiment, the locking element is made by way of injection moulding. The locking element could, for example, also be made by way of stamping from a blank

[0028] In a preferred embodiment the holding body and/or the locking element and most preferably the entire lock is designed to be mirror-symmetrical about a plane that dissects the protrusion and include the retraction direction.

[0029] In a preferred embodiment the protruding part of the second part is introduced into the receptacle along a linear insertion direction.

[0030] In a preferred embodiment, the rotational axis about which the lever rotates in the rotational joint is antiparallel to the linear insertion direction and preferably is perpendicular to the linear insertion direction.

[0031] In a preferred embodiment the holding body and/or the locking element and most preferably the entire lock is designed to be mirror-symmetrical about a plane that includes the retraction direction and the linear insertion direction.

[0032] In a preferred embodiment, the protrusion of the locking element is designed to be wedge shaped. In a preferred embodiment, the protrusion of the locking element has a tip. The wedge shaped protrusion of the locking element in a preferred embodiment has its thinnest portion at the tip and then increases in thickness further away from the tip. The wedge shaped protrusion can have a push back surface at its underside that can come into contact with the protruding part as the protruding part is moved upwards and if the protrusion is in the release

position or close to the release position. If for example the protrusion has been moved from the locking position towards the release position and has either reached the release position or is close to the release position and in this position is in the way of the protruding element, the push back surface of the protrusion can lead to the protruding part pushing the protrusion further into the release direction when the protruding part contacts the push back surface of the wedge shaped protrusion.

[0033] In a preferred embodiment, the protrusion can have a pull out surface at its underside that is pointing towards the wall and is arranged at an angle to the release direction, whereby the pull out surface can come into contact with the protruding part as the protruding part is moved upwards and if the protrusion is in the locking position or close to the locking position. If for example the protrusion is in the locking position or close to the locking position and in this position is in the way of the protruding element, the pull out surface can lead to the protruding part pulling the protrusion further away from the wall and against the release direction when the protruding part contacts the pull out surface. Such an arrangement can be used, for example to bring the tip of the protrusion into contact with a hole or a recess in a second wall of the receptacle. This arrangement can secure the protruding part in the receptacle. The more the protruding part is tried to be pulled out of the receptacle, the more the protrusion is pulled out and prevents the protruding part from being pulled out of the receptacle.

[0034] In a preferred embodiment, the locking element has a spring. The spring can be a torsion bar in the joint. As an alternative or in addition a spring, for example a leaf spring or a coil spring can be provided. In a preferred embodiment the spring is tensioned as the lever is moved to bring the locking element from the first position towards the second position. If the spring is tensioned as the lever is moved to bring the locking element from the first position towards the second position, the spring will push the lever and hence the locking element back towards the first position once the force has been taken away.

[0035] In a preferred embodiment, the spring is loaded when the locking element is in the second position. The loading of the spring pretensions the locking element to move from the second position into the first position.

[0036] In a preferred embodiment, the lever is a part of the locking element. In a preferred embodiment, the protrusion, the lever and - if present - the locking protrusion of the lever, the guide arm of the lever are all part of the locking element and made as one piece, for example by way of injection moulding or by way of stamping from a blank.

[0037] In a preferred embodiment the rotational joint defines a rotational axis and the lever swivels about the rotational axis, whereby the rotational axis is not parallel to an insertion direction, whereby the insertion direction is the direction along which the second protruding part of the second part is intended to be inserted into the receptacle. In a preferred embodiment, the insertion direc-

tion is a direction that runs parallel to the surface of the wall that borders the receptacle.

[0038] In a preferred embodiment a torsion bar is provided that extends from the lever, which torsion bar has an end that is held in the holding body or held in the attachment body. The torsion bar can act as a spring that pretensions the protrusion into the locking position. If the lever is rotate so that the protrusion moves from the locking position towards the release position, the torsion bar is loaded. If the force that is applied to the lever to rotate so that the protrusion moves from the locking position towards the release position is reduced or taken away, the loaded torsion bar leads to a return movement of the lever and leads to the protrusion being moved towards and preferably into the locking position.

[0039] In a preferred embodiment the holding body has a recess and the attachment body has a portion that is arranged in the recess. In a preferred embodiment the circumferential walls of the holding body that form the recess and the circumferential walls of the portion of the attachment body that is arranged in the recess are adapted to each other to prevent the attachment body from rotation. In a preferred embodiment, the recess is of polygonal shape, preferably square shaped, triangular shaped, rectangular shaped. In a preferred embodiment, the portion of the attachment body arranged in the recess is of polygonal shape, preferably square shaped, triangular shaped, rectangular shaped.

[0040] In a preferred embodiment the recess has a bottom wall and a channel that leads from the bottom wall further into the holding body. In a preferred embodiment, the attachment body has a portion that is arranged in the recess and that has an abutment surface that abuts against the bottom wall, whereby the attachment body has an arm that extends into the channel. In a preferred embodiment, the arm has a locking protrusion. In a preferred embodiment, the locking protrusion engages a part of the holding body that faces away from the bottom wall, such that the engagement of the locking protrusion with this part prevents the attachment body from being pulled out of the recess.

[0041] The assembly according to the invention has a first part and a second part whereby the first part is connected to the holding body of the lock (which is to be understood to include those embodiments where the holding body is an element of the first part) and whereby the second part comprises a protruding part with an opening or a recess, protruding part is arranged in the receptacle and wherein the protrusion of the locking element is in the locking position and at least partially arranged inside the protruding part.

[0042] In a preferred embodiment, the protruding part is a U-shaped protruding part. In a preferred embodiment the protruding part can be a part of a hook. In a preferred embodiment the protruding part can have wedged portion at its end, the wedged portion forming a tip of the protruding part and whereby the protruding part has a recess at the end of the wedged portion, the recess preferably

being designed as a step after the wedged portion.

[0043] In a preferred embodiment the protruding part is a wire. In an alternative embodiment, the protruding part is a piece stamped out from a metal sheet.

[0044] In a preferred embodiment, the first part is a part of a vehicle, for example the cushion of the backbench of a vehicle. In a preferred embodiment, the second part of the assembly is a part of a vehicle, for example a frame or a floor or a wall of the vehicle. In a preferred embodiment, the lock according to the invention is used to attach the part of the upholstering, especially a cushion of a backbench of a car to the body of the car.

[0045] The method for disassembly of an assembly according to the invention is characterized in that a force is applied to the second end of the lever that is directed against the retraction direction, which application of force leads to a swivel movement of the lever about the protruding piece of the holding body or in the rotational joint and leads to a movement of the protrusion in the retraction direction into the release position, whereby in the release position the protrusion of the locking element is arranged outside the U-shaped protruding part. As part of the method according to the invention, the U-shaped protruding part is moved out of the receptacle.

[0046] In the following, the invention will be described by reference of figures that only show exemplary embodiments. In the figures

- Fig. 1** shows a perspective view of the lock according to the invention with a protruding part of a second part arranged in the receptacle;
- Fig. 2** shows a perspective view onto the holding body of the lock according to Fig. 1;
- Fig. 3** shows a perspective view onto the locking element of the lock according to Fig. 1;
- Fig. 4** shows a further perspective view of the lock according to the invention according to Fig. 1, the protrusion being in the locking position;
- Fig. 5** shows a further perspective view of the lock according to the invention according to Fig. 1, the protrusion being in the release position;
- Fig. 6** shows a sectional side view through the lock according to Fig. 1, the section side view going through the middle of the lock, the protrusion being in the locking position;
- Fig. 7** shows a sectional side view through the lock according to Fig. 1, the section side view going through a part arranged further towards the right from the middle in the view of Fig. 1, the protrusion being in the locking position;
- Fig. 8** shows a sectional side view through the lock according to Fig. 1, the section side view going through the middle of the lock, the protrusion being in the locking position;
- Fig. 9** a schematic exploded view from behind a lock according to the invention showing the holding body and the locking element set apart and

Fig. 10 the schematic, partially sectional perspective view from behind the lock according to Fig. 9.

[0047] Fig. 1 shows a lock 1 for holding a first part to a second part. The lock 1 comprises a holding body 2 and a locking element 3. The holding body 2 has a receptacle 4 for receiving a u-shaped protruding part 5 of the second part. The holding body having a wall 6 and further walls 7 and a bottom wall 10 that border the receptacle. The receptacle is a cul-de-sac.

[0048] The locking element 3 has a protrusion 11. The locking element 3 has a first position shown in Fig. 1, 4, 6, 7. In the first position of the locking element 3, the protrusion 11 protrudes from the wall 6 into the receptacle 4 by a first amount. This position of the protrusion 11 is called the locking position.

[0049] The locking element 3 has a second position (shown in Fig. 5 and 8). In the second position the protrusion 11 protrudes from the wall 6 into the receptacle 4 by a second amount, whereby the second amount is smaller than the first amount. This position of the protrusion 11 is called the release position.

[0050] In the locking position, the protrusion 11 is placed inside the u-shaped protruding part 5 and prevents the protruding part 5 to be retrieved (pulled out) from the receptacle 4 (see Fig. 6, 7). In the release position, the protrusion 11 is placed outside the u-shaped protruding part 5 and allows the protruding part 5 to be retrieved (pulled out) from the receptacle 4 (see Fig. 8).

[0051] The protrusion 11 can be moved from the locking position to the release position in a rotational retraction direction A relatively to the holding body 2.

[0052] The lock 1 has a lever 12. The lever 12 has a first end 14 and a second end 15 that is arranged opposite the first end 14. The protrusion 11 forms part of the first end 14 of the lever 12.

[0053] As seen in Fig. 3, 7 the lever 12 has two torsion bars 17 that function as part of a joint. The respective torsion bar 17 is arranged between the lever 12 and an attachment body 23. A protrusion of the attachment body 23 rests in a respective recess 18 in the holding body 2.

[0054] The holding body 2 has a recess 24 (see Fig. 2) and the attachment body has a portion 25 that is arranged in the recess 24. The recess is square shaped and the portion 25 of the attachment body 23 arranged in the recess 24 is of square shape.

[0055] The recess 24 has a bottom wall 26 and a channel 27 that leads from the bottom wall 26 further into the holding body 2. In a preferred embodiment, the attachment body 23 has a portion 25 that is arranged in the recess 24 and that has an abutment surface 28 that abuts against the bottom wall 26, whereby the attachment body 23 has an arm 20 that extends into the channel 27. The arm 20 has a locking protrusion 21. The locking protrusion 21 engages a part of the holding body 2 that faces away from the bottom wall 26, such that the engagement of the locking protrusion 21 with this part prevents the attachment body 23 from being pulled out of the recess

24.

[0056] Fig. 5 and 8 show the lock 1 without the attachment body 23 and the torsion bar 17 to allow for a better understanding of the movement of the lever 3.

[0057] As can best be seen from Fig. 6, the wall 6 that borders the receptacle 4 is arranged on a first part of the holding body 2 (left hand side in Fig. 6), whereby a further wall 7 that is arranged on the other side of the receptacle 4 and faces the wall is additionally provided, whereby the further wall 7 is arranged on a second part of the holding body 2 (right hand side in Fig. 6). The first part of the holding body 2 has an upper surface that is arranged in a first plane, whereby the second part of the holding body 2 has an upper surface that is arranged in a second plane, whereby the first plane is above the second plane. The first part of the holding body 2 is longer than the second part of the holding body 2.

[0058] As can best be seen from Fig. 4 and 5 the holding body 2 has an outward facing surface that is arranged flush with an outward facing surface at the second end 15 of the lever 3. The first part of the holding body 2 has an outward facing surface that is arranged flush with an outward facing surface at the second end 15 of the lever 3. Having an outward facing surface of holding body 2 being arranged flush with an outward facing surface of the lever 3 prevents the lever 3 from being pushed by a large object. Having an outward facing surface of holding body 2 being arranged flush with an outward facing surface of the lever 3 requires the lever 3 to be pushed by an element that has the same size or is smaller than the outward facing surface of the lever 3.

[0059] Starting from the first position of the locking element shown in Fig. 6, 7 applying a force to the second end 15 of the lever 12 that is directed towards the receptacle 4 leads to a swivel movement of the lever 12 about the axis of the torsion bar 17 and a movement of the protrusion 11 in the retraction direction A. In doing so, the protrusion 11 could be moved from the locking position (Fig. 6,7) to the release position (Fig. 8).

[0060] The torsion bar 17 operates as a spring. In the first position of the locking element 3 (Fig. 6,7) the torsion bar 17 is relaxed. As the locking element 3 is moved from the first position toward the second position the torsion bar 17 is twisted and hence loaded.

[0061] In a method for disassembly and starting from the first position of the locking element 3 as shown in Fig. 6,7

- a force is applied to the second end 15 that is directed towards the receptacle 4, which leads to a swivel movement of the lever 12 about the axis of the torsion bar 17 and hence a swivel movement about a rotational joint and a movement of the protrusion 11 in the rotational retraction direction A into the second position (Fig. 8), whereby in the second position the protrusion 11 is in a release position, whereby in the release position

- the protrusion 11 either protrudes from the wall 6 into the receptacle by a second amount, whereby the second amount is smaller than the first amount,
- or the protrusion 11 does not protrude from the wall 6,

and

- the u-shaped protruding part 5 is moved out of the receptacle 4.

[0062] Fig. 5 shows that the holding body 2 has a first wall 6 that borders the receptacle 4, whereby in the locking position the protrusion 11 protrudes from the first wall 6 into the receptacle 4 by a first amount and whereby in the release position

- the protrusion 11 protrudes from the first wall 6 into the receptacle 4 by a second amount, whereby the second amount is smaller than the first amount,

whereby the holding body 2 has a second wall 7 that borders the receptacle 4, whereby the second wall 7 is arranged opposite the first wall 6 and whereby the second wall 7 has a recess 30, whereby the protrusion 11 has a tip 31, whereby the protrusion 11 can be brought into a position (shown in Fig. 6), where the tip 31 of the protrusion 11 engages the recess 30 in the second wall 7. The tip 31 of the protrusion 11 preferably engages the recess 30 in the second wall 7 when the protrusion 11 is in the locking position. The recess 30 is provided by way of a section 32 of the second wall 7 protruding towards the first wall 6 over other sections 33 of the second wall 7.

[0063] Fig. 6 shows that the wedge shaped protrusion 11 can have a push back surface 34 at its underside that can come into contact with the protruding part 5 as the protruding part 5 is moved upwards and if the protrusion 11 is in the release position or close to the release position. If for example the protrusion 11 has been moved from the locking position (shown in Fig. 5) towards the release position and has either reached the release position or is close to the release position and in this position is in the way of the protruding element 5, the push back surface 34 of the protrusion 11 can lead to the protruding part 5 pushing the protrusion 11 further into the release direction A when the protruding part 5 contacts the push back surface 34 of the wedge shaped protrusion 11.

[0064] Fig. 6 shows that the protrusion 11 can have a pull out surface 35 at its underside that is pointing towards the wall 6 and is arranged at an angle to the release direction, whereby the pull out surface 35 can come into contact with the protruding part 5 as the protruding part 5 is moved upwards and if the protrusion 11 is in the locking position or close to the locking position (Fig. 6). If for example the protrusion 11 is in the locking position or close to the locking position (Fig. 6) and in this position is in the way of the protruding element 5, the pull out surface 35 can lead to the protruding part 5 pulling the

protrusion 11 further away from the wall 6 and against the release direction when the protruding part 5 contacts the pull out surface 35.

[0065] Fig. 9 and 10 show a further embodiment of the lock 1, whereby the same reference numerals are used for like parts. The embodiment of Fig. 9 and 10 shows that the torsion bar 17 has been amended in its shape in comparison to Fig. 3 (is more round than the design of the torsion bar in Fig. 3) and the attachment body 23 has been slightly redesigned.

Claims

1. Lock (1) for holding a first part to a second part comprising

- a holding body (2) with a receptacle (4) for receiving a protruding part (5) of the second part, the holding body (2) having a wall (6) that borders the receptacle (4) and
- a locking element (3), the locking element (3) having a protrusion (11), whereby

- the locking element (3) has a first position, whereby in the first position the protrusion (11) is in a locking position, whereby in the locking position the protrusion (11) protrudes from the wall (6) into the receptacle (4) by a first amount and
- the locking element (3) has a second position, whereby in the second position the protrusion (11) is in a release position, whereby in the release position

- the protrusion (11) either protrudes from the wall (6) into the receptacle (4) by a second amount, whereby the second amount is smaller than the first amount,
- or the protrusion (11) does not protrude from the wall (6),

- whereby the protrusion (11) can be moved from the locking position to the release position in a rotational retraction direction (A) relatively to the holding body (2),

characterized by

a lever (12), whereby

- the lever (12) has a first end (14) and a second end (15) that is arranged opposite the first end (14), whereby the protrusion (11) is attached to the first end (14) of the lever (12) or forms part of the first end (14) of the lever (12) and
- the lever (12) is connected to the holding body (2) by a rotational joint or is connected to an

- attachment body (23) by a rotational joint, whereby the attachment body is attached to the holding body (2),
- whereby the rotational joint is arranged between the first end (14) and the second end (15) of the lever (12) and
 - applying a force to the second end (15) that is directed towards the receptacle leads to
 - a swivel movement of the lever (12) in the rotational joint
 - and a movement of the protrusion (11) in the retraction direction (A).
2. Lock according to claim 1, **characterized in that** a locking protrusion (21) is arranged at the attachment body (23), whereby the locking protrusion (212) can releasably engage with a part of the holding body (2) to hold the attachment body (23) in a predetermined position.
3. Lock according to any one of claims 1 or 2, **characterized in that** the attachment body (23) has a guide arm (20), whereby the guide arm (20) is arranged in a channel (27) in the holding body (2).
4. Lock according to any one of claims 1 to 3, **characterized in that** the rotational joint defines a rotational axis and that the lever (12) swivels about the rotational axis, whereby the rotational axis is not parallel to an insertion direction, whereby the insertion direction is the direction along which the second protruding part of the second part is intended to be inserted into the receptacle (4).
5. Lock according to any one of claims 1 to 4, **characterized by** a torsion bar (17) that extends from the lever (12), which torsion bar (17) has an end that is held in the holding body (2).
6. Assembly of a first part and a second part, whereby
- the first part is connected to the holding body (2) of the lock (1) according to any one of claims 1 to 5 and
 - the second part comprises a protruding part (5) with an opening or a recess, whereby the protruding part (5) is arranged in the receptacle (4) and
 - the protrusion (11) of the locking element (3) is in the first position and at least partially arranged inside protruding part (5).
7. Method for disassembly of an assembly according to claim 6, **characterized in that**
- a force is applied to the second end (15) that is directed against towards the receptacle (4),

which leads to a swivel movement of the lever (12) in the rotational joint and a movement of the protrusion (11) in the retraction direction (A) into the second position the protrusion (11) is in a release position, whereby in the release position

- the protrusion (11) either protrudes from the wall (6) into the receptacle (4) by a second amount, whereby the second amount is smaller than the first amount,
- or the protrusion (11) does not protrude from the wall (6),
- the u-shaped protruding part (5) is moved out of the receptacle (4).

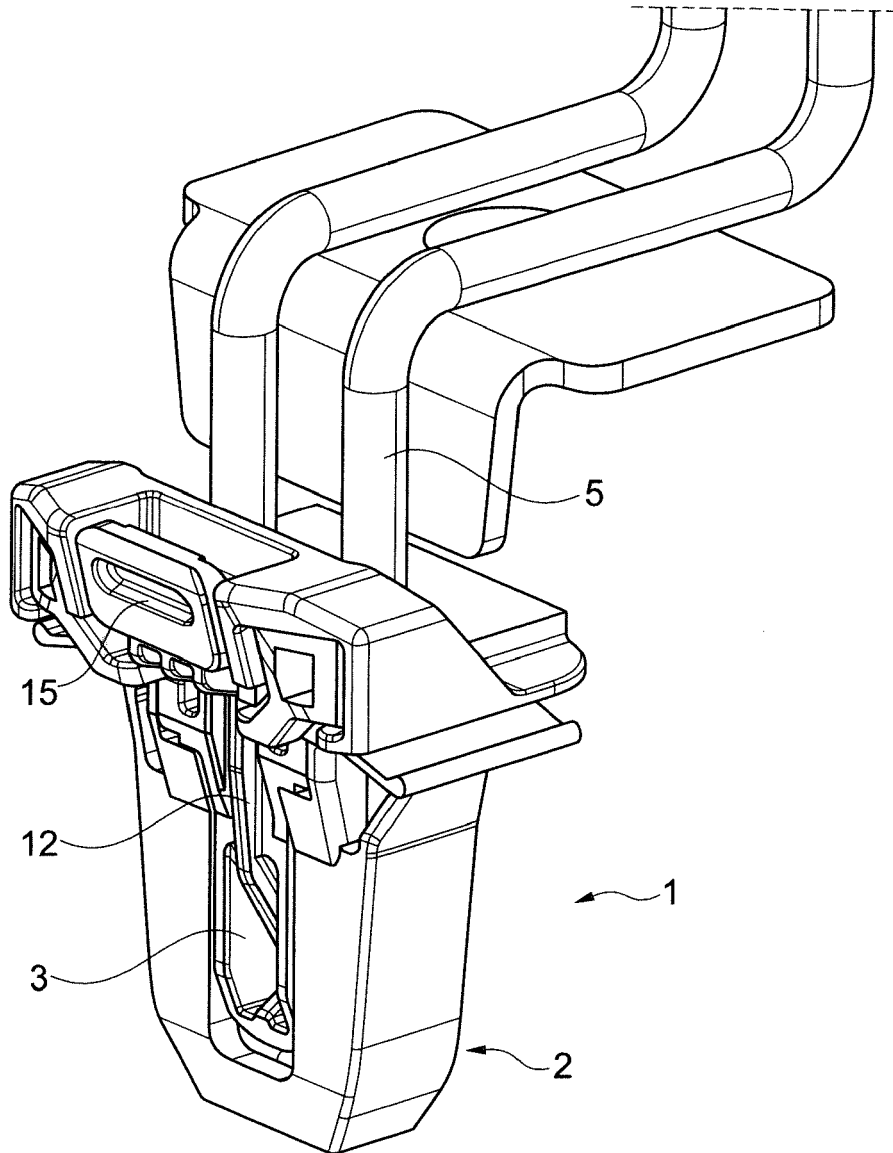

Fig. 1

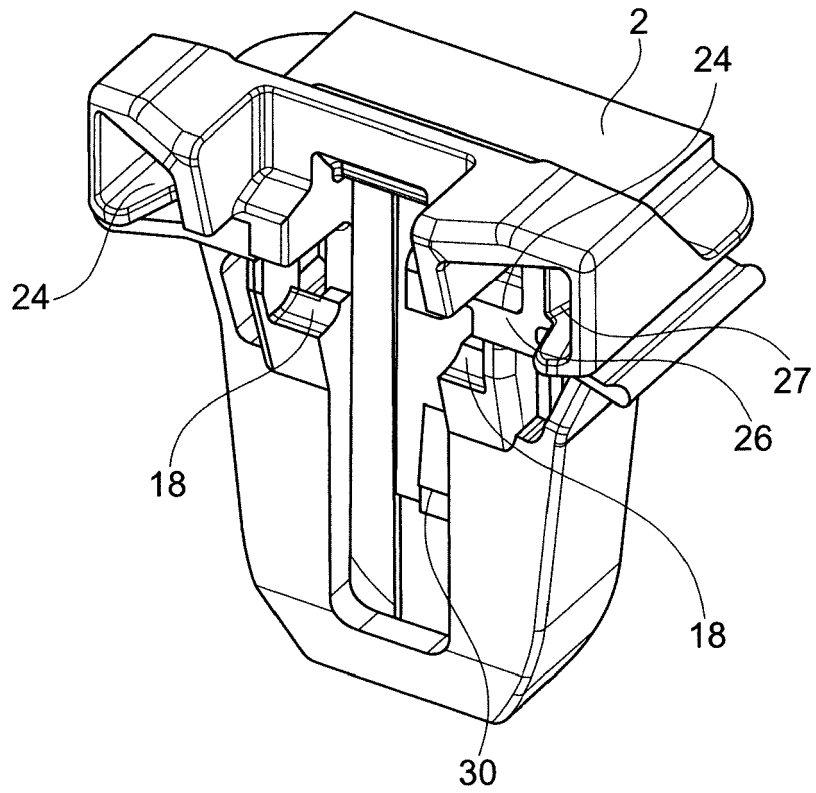

Fig. 2

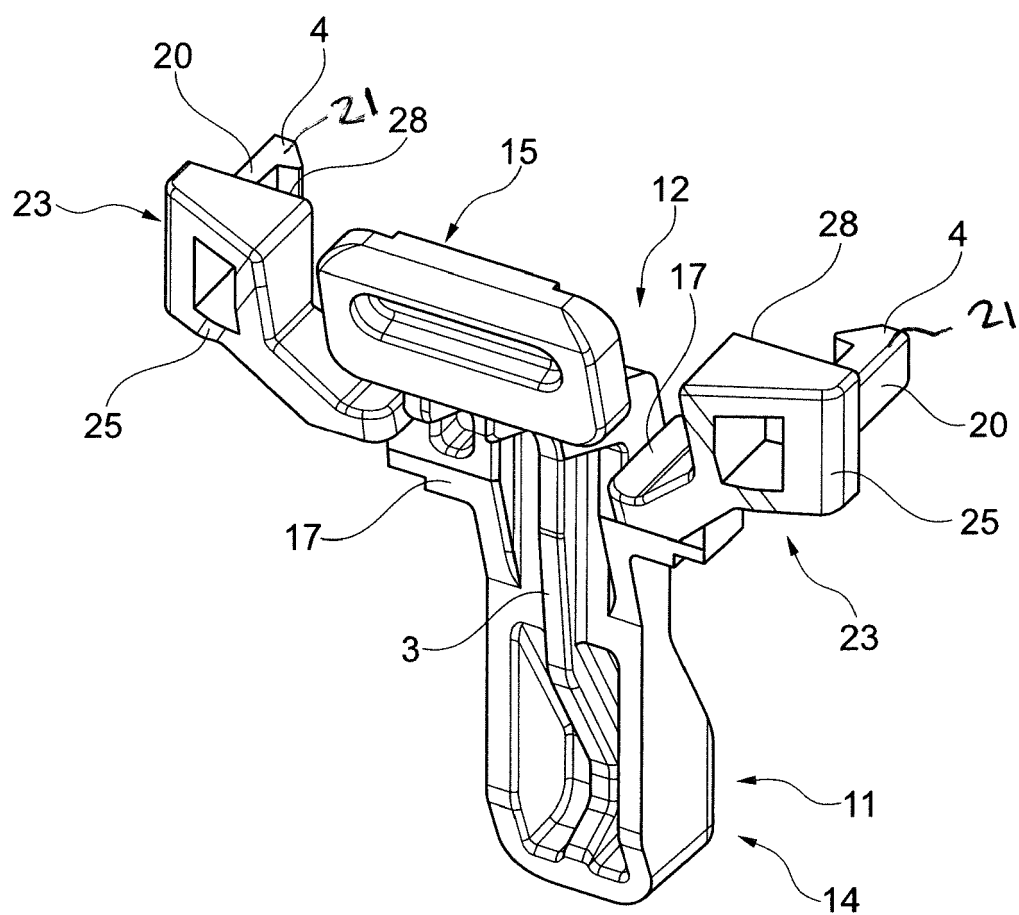

Fig. 3

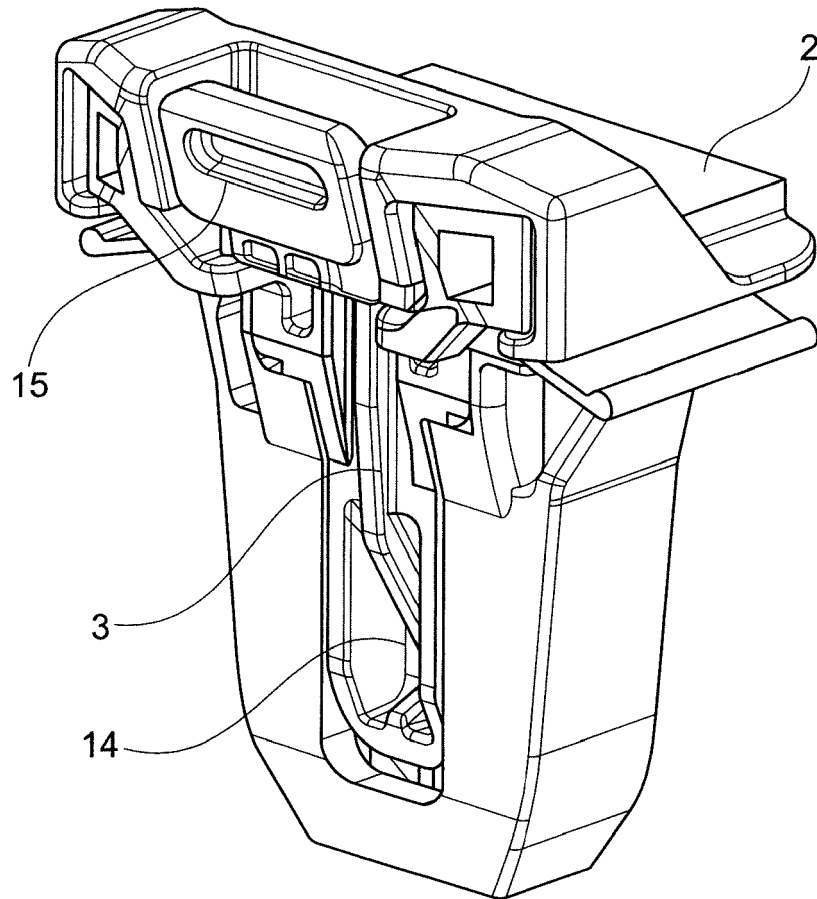

Fig. 4

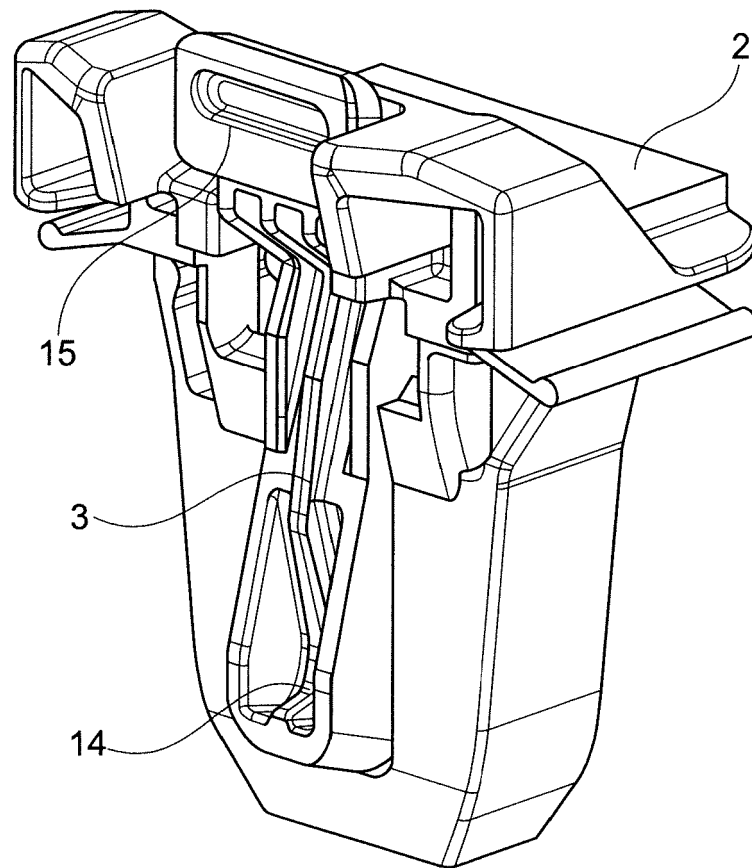

Fig. 5

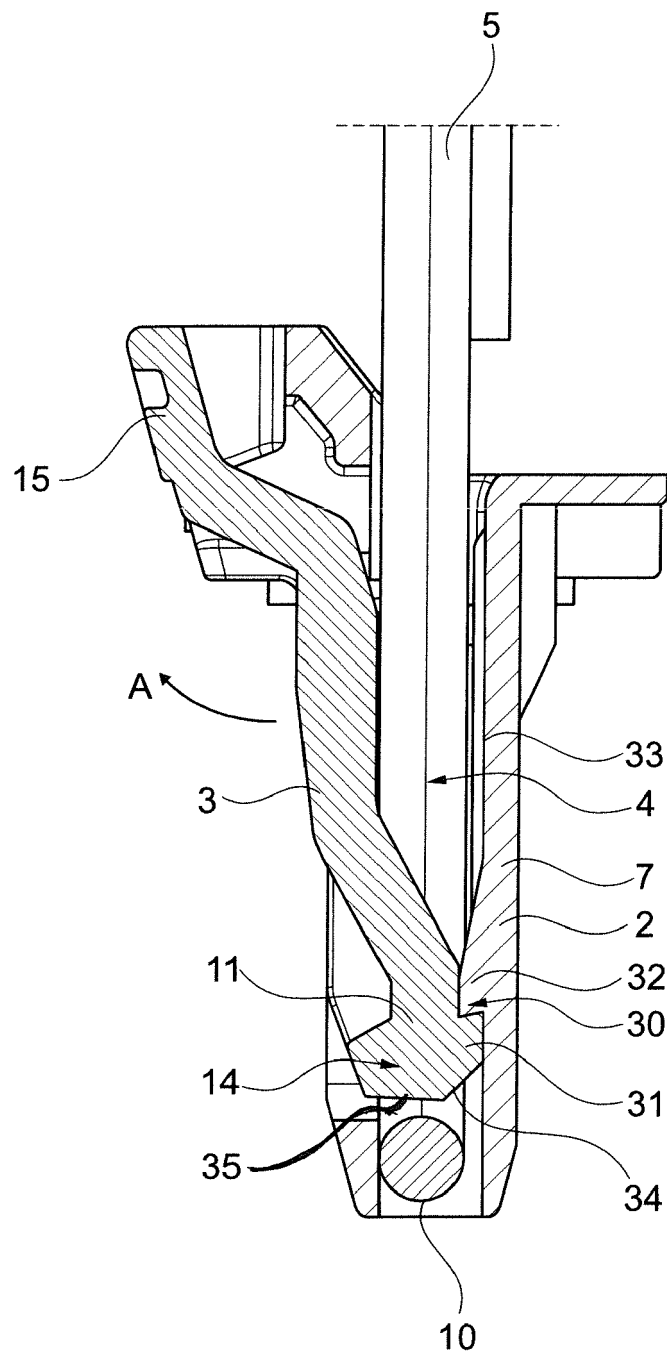

Fig. 6

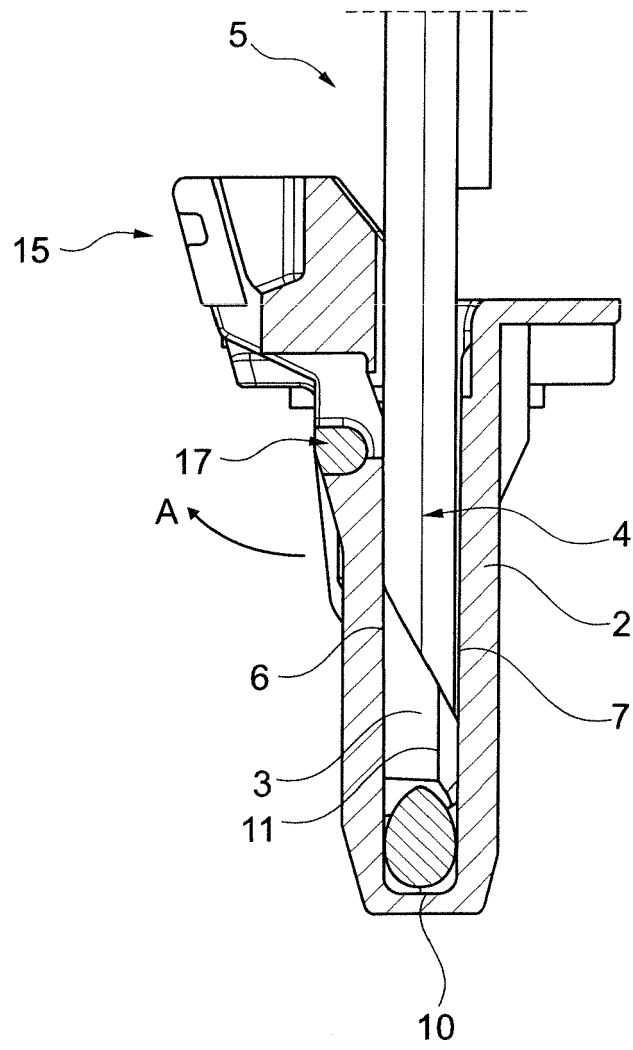

Fig. 7

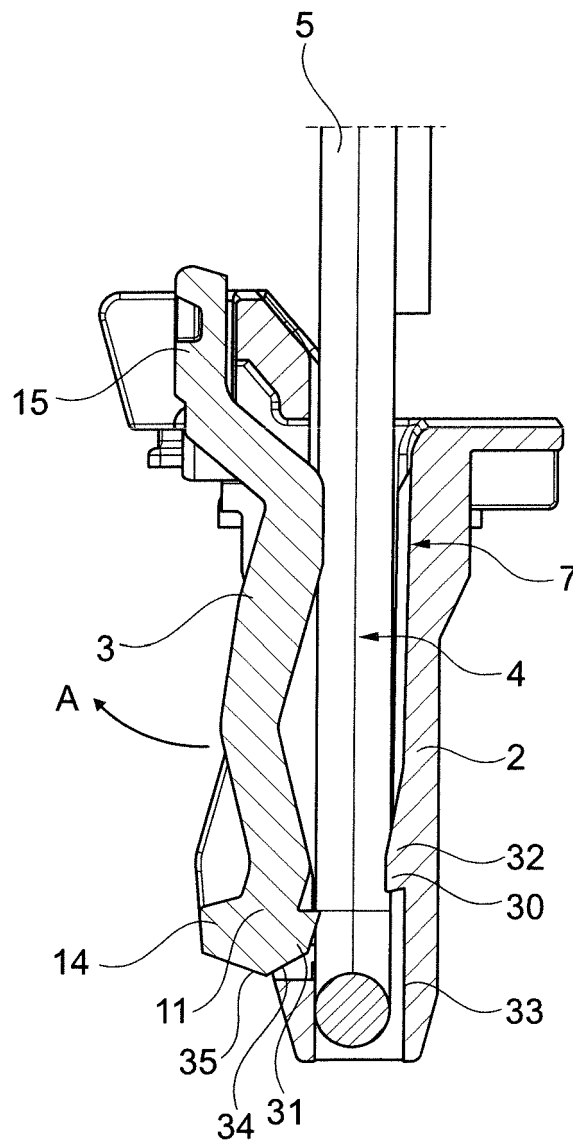

Fig. 8

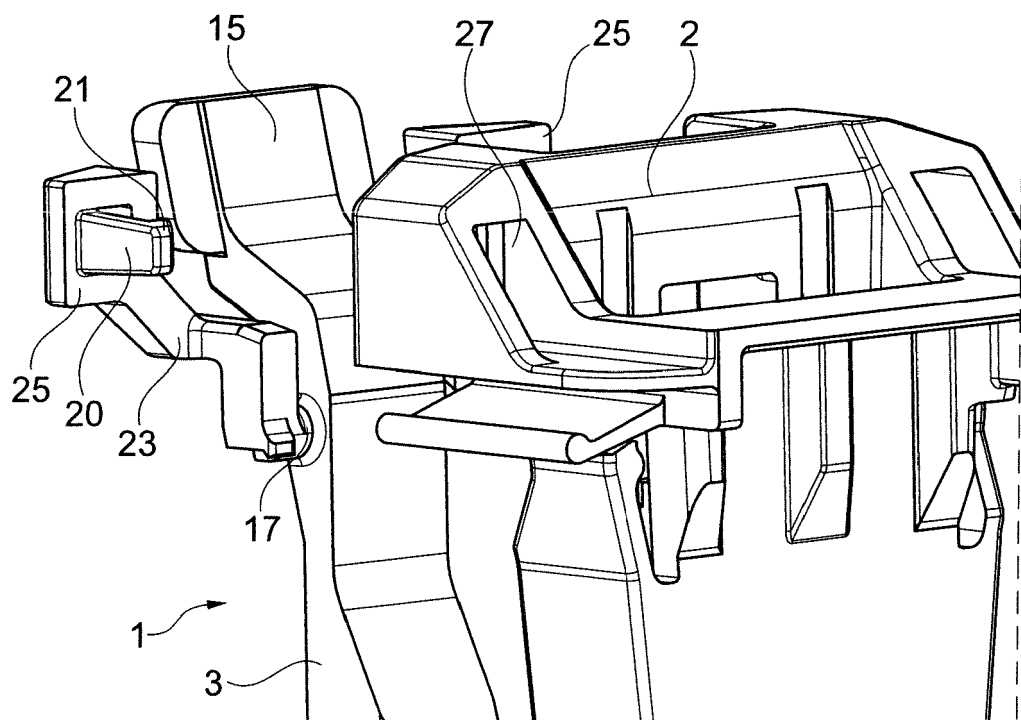

Fig. 9

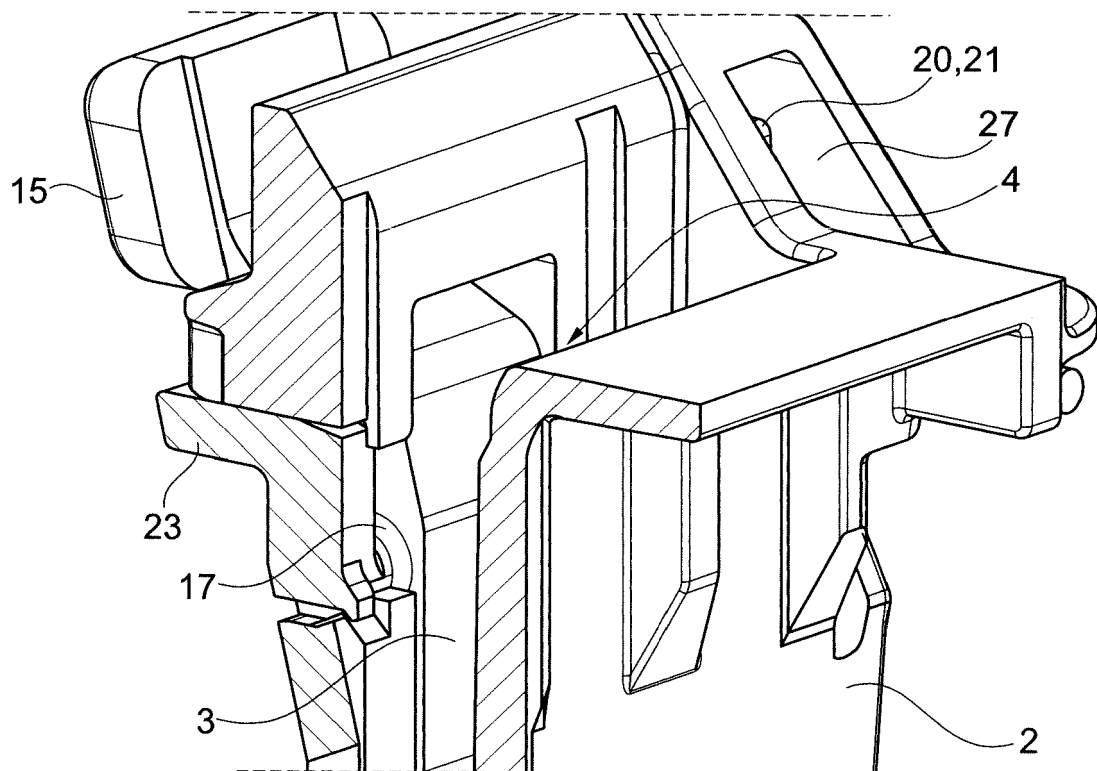

Fig. 10



EUROPEAN SEARCH REPORT

Application Number
EP 21 17 6842

5

10

15

20

25

30

35

40

45

50

55

DOCUMENTS CONSIDERED TO BE RELEVANT			
Category	Citation of document with indication, where appropriate, of relevant passages	Relevant to claim	CLASSIFICATION OF THE APPLICATION (IPC)
X	US 3 358 340 A (NORI HIGUCHI) 19 December 1967 (1967-12-19) * column 1, line 23 - column 4, line 33; figures 1-4 *	1-7	INV. F16B2/20 B60N2/015 F16B21/07 F16B45/00
A	----- CN 104 512 280 A (BEIQI FOTON MOTOR CO LTD) 15 April 2015 (2015-04-15) * paragraphs [0001] - [0063]; figures 1-9 * -----	1	
			TECHNICAL FIELDS SEARCHED (IPC)
			F16B B60N
The present search report has been drawn up for all claims			
Place of search Munich		Date of completion of the search 25 October 2021	Examiner Sisinni, Giovanni
CATEGORY OF CITED DOCUMENTS X : particularly relevant if taken alone Y : particularly relevant if combined with another document of the same category A : technological background O : non-written disclosure P : intermediate document T : theory or principle underlying the invention E : earlier patent document, but published on, or after the filing date D : document cited in the application L : document cited for other reasons & : member of the same patent family, corresponding document			

 1
EPO FORM 1503 03.82 (P04C01)

**ANNEX TO THE EUROPEAN SEARCH REPORT
ON EUROPEAN PATENT APPLICATION NO.**

EP 21 17 6842

5

This annex lists the patent family members relating to the patent documents cited in the above-mentioned European search report.
The members are as contained in the European Patent Office EDP file on
The European Patent Office is in no way liable for these particulars which are merely given for the purpose of information.

25-10-2021

10

Patent document cited in search report	Publication date	Patent family member(s)	Publication date
US 3358340	A	19-12-1967	NONE

CN 104512280	A	15-04-2015	NONE

15

20

25

30

35

40

45

50

55

EPO FORM P0459

For more details about this annex : see Official Journal of the European Patent Office, No. 12/82

REFERENCES CITED IN THE DESCRIPTION

This list of references cited by the applicant is for the reader's convenience only. It does not form part of the European patent document. Even though great care has been taken in compiling the references, errors or omissions cannot be excluded and the EPO disclaims all liability in this regard.

Patent documents cited in the description

- CN 107487232 BB [0002]
- US 8780797 B [0003]
- CN 104512280 [0003]
- KR 101403858 B1 [0003]
- CN 107487232 [0006]