

(19)



(11)

EP 4 092 280 B1

(12)

EUROPEAN PATENT SPECIFICATION

(45) Date of publication and mention of the grant of the patent:
24.04.2024 Bulletin 2024/17

(51) International Patent Classification (IPC):
F16B 21/07^(2006.01)

(21) Application number: **22171548.5**

(52) Cooperative Patent Classification (CPC):
F16B 21/07

(22) Date of filing: **04.05.2022**

(54) **DUAL COMPONENT SEALING FASTENER AND COUPLING ASSEMBLY INCLUDING SAME**

ZWEIKOMPONENTEN-DICHTUNGSBEFESTIGUNGSELEMENT UND KUPPLUNGSANORDNUNG DAMIT

FIXATION D'ÉTANCHÉITÉ À DEUX COMPOSANTS ET ENSEMBLE D'ACCOUPLLEMENT LA COMPRENANT

(84) Designated Contracting States:
AL AT BE BG CH CY CZ DE DK EE ES FI FR GB GR HR HU IE IS IT LI LT LU LV MC MK MT NL NO PL PT RO RS SE SI SK SM TR

(72) Inventor: **FORTI, Adam**
Troy, 48084 (US)

(30) Priority: **12.05.2021 US 202117318591**

(74) Representative: **SBD IPAdmin**
270 Bath Road
Slough, Berkshire SL1 4DX (GB)

(43) Date of publication of application:
23.11.2022 Bulletin 2022/47

(56) References cited:
EP-A1- 3 557 086 EP-A1- 3 800 362
EP-A1- 3 808 998 GB-A- 2 201 723
US-A- 5 533 237 US-A1- 2015 321 622
US-A1- 2019 017 527

(60) Divisional application:
24164109.1

(73) Proprietor: **Newfrey LLC**
New Britain, CT 06053 (US)

EP 4 092 280 B1

Note: Within nine months of the publication of the mention of the grant of the European patent in the European Patent Bulletin, any person may give notice to the European Patent Office of opposition to that patent, in accordance with the Implementing Regulations. Notice of opposition shall not be deemed to have been filed until the opposition fee has been paid. (Art. 99(1) European Patent Convention).

Description

FIELD

[0001] The present disclosure relates to dual component sealing fasteners designed to couple a first component having a rib to a second component having an aperture therethrough and coupling assemblies including same.

BACKGROUND

[0002] This section provides background information related to the present disclosure which is not necessarily prior art.

[0003] One type of sealing fastener designed to couple a first component having a rib to a second component having an aperture therethrough are referred to as bathtub fasteners. Such bathtub fasteners typically have a bathtub portion that seals around a specially-designed metal clip. The metal clip couples the rib to the interior of the bathtub. In turn, the bathtub is inserted into the aperture to seal the aperture and provide the coupling between the aperture and the metal clip. Among their disadvantages, such bathtub fasteners typically require a relatively large amount of space to implement, and have a relatively high cost to manufacture.

[0004] Another type of sealing fastener designed to couple a first component having a rib to a second component having an aperture therethrough are referred to as pour-over clips. Such pour-over clips typically have a liquid sealing material that is poured over the terminal end of the metal clip to form a planar seal element for sealing between the two components. Among their disadvantages, it is difficult to ensure the clip is centered so that an effective seal is formed against both the components, and pour-over material options are very limited.

[0005] From GB 2 201 723 A there is known a part mounting structure for mounting a part having a boss portion on a panel having an elliptically shaped mounting hole.

SUMMARY

[0006] This section provides a general summary of the disclosure, and is not a comprehensive disclosure of its full scope or all of its features.

[0007] In accordance with one aspect of the present disclosure, a dual component sealing fastener designed to couple a first component having a rib to a second component having an aperture therethrough can include a U-base clip component and a seal component. The U-base clip component can include two opposing clip side walls joined together at a clip insertion end to form a U-shaped clip portion. A pair of rib coupling barbs can extend inwardly from the two opposing clip side walls. The seal component can include a central wall having a rib receiving aperture therethrough. Two opposing aperture

retention wings can be joined together at a wing insertion end to form a U-shaped wing portion. Each of the two opposing aperture retention wings can have a wing trailing end, opposite the wing insertion end, that is coupled to the central wall. A first component annular seal can extend in a first direction away from a first side of the central wall. A second component annular seal can extend in a second direction away from a second side of the central wall opposite the first direction and opposite the first side, respectively. The U-base clip component and the seal component can have an assembled configuration in which the U-base clip component and the seal component can be coupled together to define an interior rib receiving cavity between both the two opposing clip side walls and the two opposing aperture retention wings, and in which the pair of rib coupling barbs can extend into the interior rib receiving cavity, and in which the two opposing aperture retention wings can extend exteriorly of the two opposing clip side walls. The pair of rib coupling barbs can be designed to engage the rib to couple the dual component sealing fastener to the rib in the assembled configuration with the rib received within the interior rib receiving cavity. The two opposing aperture retention wings can be designed to engage the aperture to couple the dual component sealing fastener to the aperture in the assembled configuration with the clip insertion end and the wing insertion end extending through the aperture.

[0008] In accordance with one aspect of the present disclosure, a dual component sealing fastener designed to couple a first component having a rib to a second component having an aperture therethrough can include a metal U-base clip component and a dual material seal component. The metal U-base clip component can include two opposing clip side walls joined together at a clip insertion end to form a U-shaped clip portion. Each of the opposing clip side walls can have a wall opening therethrough. A pair of rib coupling barbs can extend inwardly from the two opposing clip side walls. The dual material seal component can include a single piece plastic material part and a single piece seal material part. The single piece plastic material part can include a central wall that has a rib receiving aperture therethrough. Two opposing aperture retention wings can be joined together at a wing insertion end to form a U-shaped wing portion. Each of the two opposing aperture retention wings can have a wing trailing end, opposite a wing insertion end, coupled to the central wall. A pair of wing coupling arms can couple each wing trailing end to the central wall. The single piece seal material part can include a first component annular seal extending in a first direction away from a first side of the central wall. A second component annular seal can extend in a second direction away from a second side of the central wall opposite the first direction and opposite the first side, respectively. The metal U-base clip component and the dual material seal component can have an assembled configuration in which the metal U-base clip component and the dual material seal

component are coupled together to define an interior rib receiving cavity between both the two opposing clip side walls and the two opposing aperture retention wings, and in which the wing insertion end is positioned interiorly of the clip insertion end, and in which the pair of rib coupling barbs extend interiorly into the interior rib receiving cavity, and in which the two opposing aperture retention wings extend exteriorly through the wall openings. The pair of rib coupling barbs can be designed to engage the rib to couple the dual component sealing fastener to the rib in the assembled configuration with the rib received within the interior rib receiving cavity. The two opposing aperture retention wings can be designed to engage the aperture to couple the dual component sealing fastener to the aperture in the assembled configuration with the clip insertion end and the wing insertion end extending through the aperture.

[0009] In an embodiment, a formed metal sheet material comprises the metal U-base clip component.

[0010] In an embodiment, the single piece plastic material part comprises a single piece molded plastic part.

[0011] In an embodiment, all surfaces of the single piece molded plastic part are oriented and positioned to enable molding of the single piece molded plastic part in a mold without any slides.

[0012] In an embodiment, the single piece seal material part comprises a moldable seal material.

[0013] In an embodiment, each of the two opposing aperture retention wings has a wing insertion end portion and a wing trailing end portion and the wing trailing end portion has a wing trailing width that is greater than a wing insertion width of the wing insertion end portion.

[0014] In an embodiment, each wing coupling arm has an inwardly extending portion, a longitudinally extending portion, and an axially extending portion.

[0015] In an embodiment, the inwardly extending portion is adjacent the central wall, and the axially extending portion is adjacent one of the opposing aperture retention wings,

[0016] In an embodiment, an inwardly extending portion of each of the wing coupling arms includes a longitudinal pivot axis that enables the wing coupling arm to pivot upwardly in response to the two opposing aperture retention wings moving toward each other during insertion of the wing insertion end through the aperture.

[0017] In an embodiment, each wing coupling arm includes an axial pivot axis at a connection between an inwardly extending portion and a longitudinally extending portion thereof that enables the wing coupling arm to pivot inwardly in response to the two opposing aperture retention wings moving toward each other during insertion of the wing insertion end through the aperture.

[0018] In an embodiment, each wing coupling arm has an inwardly extending portion and a wall trailing end of each of the two opposing clip side walls is positioned between the inwardly extending portions of one of the pairs of wing coupling arms in the assembled configuration.

[0019] In an embodiment, each wing coupling arm has an axially extending portion, and a trailing portion of each wall opening defines a downwardly extending tab that is positioned between the axially extending portions of one of the pairs of wing coupling arms in the assembled configuration.

[0020] In accordance with another aspect of the present invention, a coupling assembly can include a first component that can have a coupling rib and a first component sealing surface surrounding the coupling rib. A second component can have a coupling aperture there-through and a second component sealing surface surrounding the coupling aperture. A U-base clip component can include two opposing clip side walls joined together at a clip insertion end to form a U-shaped clip portion. A pair of rib coupling barbs can extend inwardly from the two opposing clip side walls. A seal component can include a central wall having a rib receiving aperture there-through. Two opposing aperture retention wings can be joined together at a wing insertion end to form a U-shaped wing portion. Each of the two opposing aperture retention wings can have a wing trailing end, opposite the wing insertion end, coupled to the central wall. A first component annular seal can extend in a first direction away from a first side of the central wall. A second component annular seal extending in a second direction away from a second side of the central wall opposite the first direction and opposite the first side, respectively. The U-base clip component and the seal component can have an assembled configuration in which the U-base clip component and the seal component are coupled together to define an interior rib receiving cavity between both the two opposing clip side walls and the two opposing aperture retention wings, and in which the pair of rib coupling barbs extend into the interior rib receiving cavity, and in which the two opposing aperture retention wings extend exteriorly of the two opposing clip side walls. The pair of rib coupling barbs can engage the coupling rib to couple the U-base clip component to the first component in the assembled configuration with the coupling rib received within the interior rib receiving cavity. The two opposing aperture retention wings can engage the coupling aperture to couple the seal component to the second component in the assembled configuration with the clip insertion end and the wing insertion end extending through the coupling aperture.

[0021] Further areas of applicability will become apparent from the description provided herein. The description and specific examples in this summary are intended for purposes of illustration only and are not intended to limit the scope of the present disclosure.

DRAWINGS

[0022] The drawings described herein are for illustrative purposes only of selected embodiments and not all possible implementations, and are not intended to limit the scope of the present disclosure.

Fig. 1 is an exploded view of components of one example dual component sealing fastener, and of one example coupling assembly including a dual component sealing fastener, in accordance with the present disclosure.

Fig. 2 is an exploded view of the dual component sealing fastener of Fig. 1.

Fig. 3 is another exploded view of the dual component sealing fastener of Fig. 1.

Fig. 4 is a perspective view of the dual component sealing fastener of Fig. 1 in an assembled configuration.

Fig. 5 is another perspective view of the dual component sealing fastener of Fig. 1 in an assembled configuration.

Fig. 6 is a cross-section view of the seal component of the dual component sealing fastener of Fig. 1 taken along line 6-6 of Fig. 7.

Fig. 7 is a top plan view of the seal component of the dual component sealing fastener of Fig. 1.

Fig. 8 is a bottom plan view of the seal component of the dual component sealing fastener of Fig. 1.

Fig. 9 is a cross-section view of the seal component of the dual component sealing fastener of Fig. 1 taken along line 9-9 of Fig. 8.

Fig. 10 is a cross-section view of the dual component sealing fastener of Fig. 1.

Fig. 11 is an end elevation view of the dual component sealing fastener of Fig. 1.

Fig. 12 is a cross-section view of the coupling assembly of Fig. 1, with the dual component sealing fastener in a coupling position coupling the first and second components together.

Fig. 13 is a cross-section view of the coupling assembly of Fig. 1, with the dual component sealing fastener with the aperture retention wings pushed or moving toward each other as they pass through the aperture.

[0023] Corresponding reference numerals indicate corresponding parts throughout the several views of the drawings.

DETAILED DESCRIPTION

[0024] Example embodiments will now be described more fully with reference to the accompanying drawings.

[0025] Referring to Figs. 1-13, one example dual component sealing fastener 20 designed to couple a first component 22 having a coupling rib 24 to a second component 26 having a coupling aperture 28 therethrough in a coupling assembly 18 in accordance with the present disclosure is described herein. The dual component sealing fastener 20 includes a U-base clip component 30 and a seal component 32.

[0026] The U-base clip component 30 includes two opposing side walls 34 joined together at an insertion end 36 with a rib receiving cavity 38 between the two opposing

side walls 34. Each of the two opposing side walls 34 includes a wall trailing end 40 that is opposite the clip insertion end 36. As in the illustrated embodiment, the wing trailing end 40 of each of the two opposing side walls 34 need not have a flanged portion. Each of the opposing side walls 34 can have a wall opening 62 there-through and through which a corresponding aperture retention wing 42 of the seal component 32 can extend outwardly from the side walls 34 as discussed below.

[0027] As in the illustrated embodiment, each wall opening 62 can have a keyhole shape, and can be formed by an opening insertion portion 86 combined with an opening trailing portion 88. The opening trailing portion 88 can have an opening trailing width 90 that is greater than an opening insertion width 92 of the opening insertion portion 86. Each aperture retention wing 42 can similarly have a wing insertion end portion that can correspond to the opening insertion portion 86 and a wing trailing end portion that can correspond to the opening trailing portion 88, and the wing trailing end portion can have a wing trailing width that can correspond to the opening trailing width 90 that is greater than a wing insertion width that can correspond to the opening insertion width 92 of the wing insertion end portion.

[0028] A pair of rib coupling arms 44 can extend inwardly from the two opposing side walls 34. Such rib coupling arms 44 are designed to couple the U-base clip component 30 to the first component 22 when the coupling rib 24 of the first component 22 is received within the rib receiving cavity 38 of the U-base clip component 30. The rib coupling arms can be barbs 44. As in the illustrated embodiment, multiple pairs of rib coupling arms or barbs 44 can be provided. The U-base clip component 30 can be a metal component. For example, a single piece of sheet metal can fully comprise the U-base clip component 30.

[0029] The seal component 32 can include a central wall 46 having a rib receiving aperture 48 therethrough. The rib receiving aperture 48 can have multiple configurations and can accept multiple coupling rib 24 configurations. For example, the rib receiving aperture 48 can accept coupling ribs 24 with cross-rib locating ribs at each end, such as in the illustrated embodiment. Two opposing aperture retention wings 42 can be joined together at a wing insertion end 64 to form a U-shaped wing portion 66. Each of the two opposing aperture retention wings 42 can have a wing trailing end 68, opposite the wing insertion end 64. The aperture retention wings 42 are designed to couple the sealing fastener 20 to the second component 26 when the retention wings 42 are received within the coupling aperture 28 of the second component 26.

[0030] The wing trailing end 68 of each retention wing 42 can be coupled to the central wall 46. For example, one or more coupling arms 70 can couple each wing trailing end 68 to the central wall 46. Each wing coupling arm 70 can include a longitudinal pivot axis 72 that enables the wing coupling arm 70 and wing trailing end 68 to pivot

upwardly in response to the two opposing aperture retention wings 42 moving toward each other. This upward pivoting can be designed to enable the trailing end 68 of the retention wings 42 to move upwardly as the retention wings 42 elongate in response to the aperture retention wings 42 moving toward each other during insertion through the coupling aperture 28.

[0031] Each coupling arm 70 can include an axial pivot axis 74 that enables the coupling arm 70 to pivot inwardly in response to the two opposing aperture retention wings 42 moving toward each other. This inward pivoting can be designed to enable the trailing end 68 of the retention wings 42 to move inwardly in response to the aperture retention wings 42 moving toward each other during insertion through the coupling aperture 28.

[0032] As in the illustrated example, a pair of wing coupling arms 70 can couple each wing trailing end 68 to the central wall 46. Each coupling arm 70 can have an inwardly extending portion 80 that can be adjacent the central wall 46. Each coupling arm 70 can have an axially extending portion 82 adjacent the aperture retention wing 42. Each coupling arm 70 can have a longitudinally extending portion 84 extending between the inwardly extending portion 80 and the axially extending portion 82. The inwardly extending portion 80 of the coupling arm 70 can have an end adjacent the central wall 46 and an end distal from the central wall 46. The end of the inwardly extending portion 80 of the wing coupling arm 70 that is distal from the central wall 46 can be positioned axially lower or downward from the end of the inwardly extending portion 80 of the wing coupling arm 70 that is adjacent or proximal the central wall 46. This can enable the coupling arm 70 to pivot upwardly in response to the two opposing aperture retention wings 42 to move toward each other during insertion of the retention insertion end through the aperture, without the coupling arms 70 or retention wings 42 moving above a distal end of the first component annular seal 50 or engaging the first component 22.

[0033] The longitudinal pivot axis 72 of the coupling arm 70 can be positioned at the end of the inwardly extending portion 80 of the coupling arm 70 that is adjacent or proximal the central wall 46. The axial pivot axis 74 of the coupling arm 70 can be at the end of the inwardly extending portion 80 of the coupling arm 70 that is distal from the central wall 46. The axial pivot axis 74 of the coupling arm 70 can be at the joining ends between the inwardly extending portion 80 and the longitudinally extending portion 84.

[0034] A single piece plastic material part 94 can fully comprise the central wall 46 and the two opposing aperture retention wings 42, including any wing coupling arms 70. All surfaces of the single piece plastic material part 94 can be oriented and positioned to enable molding of the single piece plastic material part 94 in a mold (not shown) without any slides. For example, all surfaces of the single piece molded plastic part 94 can be either: oriented and positioned to be visible in either a top plan

view (Fig. 7) or a bottom plan view (Fig. 8); with any non-visible surface being oriented perpendicular to the top plan view and the bottom plan view and having an edge of the non-visible surface positioned to be visible in the top plan and in the bottom plan view.

[0035] A first component annular seal 50 can extend in a first direction away from a first side 52 of the central wall 46. Such a first component annular seal 50 is designed to seal against a surface of the first component 22 surrounding the coupling rib 24. A second component annular seal 54 can extend in a second direction away from a second side 56 of the central wall 46. The second direction and the second side 56 are opposite the first direction and opposite the first side 52, respectively. As in the illustrated embodiment, the central wall 46 can flat planar shape, and an outer or contacting lip or edge of the seals 50, 54 can terminate in a flat plane. Alternatively, the central wall 46, the contacting lip of the seals 50, 54, or both can have a somewhat curved shape so that the seals 50, 54 progressively engages the respective component sealing surfaces 76, 78. As another alternative, each of the seals 50, 54 can include multiple, e.g. two, outer or contacting lips or edges. Examples of alternatives to the oval shape of the seals 50, 54 can include circular and rectangular shapes.

[0036] A single piece of seal material part 60 can fully comprise the first component annular seal 50 and the second component annular seal 54. In other words, a single piece seal material part 60 can include both the first component annular seal 50 and the second component annular seal 54. An annular recess 58 can extend around the outside of the single piece seal material part 60 between the first component annular seal 50 and the second component annular seal 54. The seal component 32 can be fully formed of the single piece seal material part and the single piece plastic material part 94. The single piece seal material part 60 and the single piece plastic material part 94 can be bonded together. For example, single piece seal material part 60 and the single piece plastic material part 94 can be bonded together as a result of molding them together in a two-shot molding process.

[0037] The seal component 32 and the U-base clip component 30 can be coupled together in an assembled configuration shown, e.g., in Figs. 4 and 5. In this assembled configuration, the first side 52 is typically a side facing toward the trailing end 40 of the U-base clip component 30, away from the clip insertion end 36 of the U-base clip component 30, toward the first component 22, or away from the second component 26. Similarly, the first direction is typically a direction extending toward the trailing end 40 of the U-base clip component 30, away from the clip insertion end 36 of the U-base clip component 30, toward the first component 22, or away from the second component 26. Conversely, when assembled together, the second side 56 is typically a side facing toward the clip insertion end 36 of the U-base clip component 30, away from the trailing end 40 of the U-base clip com-

ponent 30, toward the second component 26, or away from the first component 22. Similarly, the second direction is typically a direction extending toward the insertion end 36 of the U-base clip component 30, away from the trailing end 40 of the U-base clip component 30, toward the second component 26, or away from the first component 22.

[0038] In the assembled configuration of the dual component sealing fastener 20, the U-base clip component 30 and the seal component 32 can be coupled together to define an interior rib receiving cavity 38 between both the two opposing clip side walls 34 and the two opposing aperture retention wings 42. As in the illustrated example, the two opposing aperture retention wings 42 can operate to couple the U-base clip component 30 and the seal component 32 together, which can eliminate the need for additional coupling elements to accomplish to couple this assembly together. The wing insertion end 64 can be positioned interiorly of the clip insertion end 36, and the rib coupling arms of barbs 44 can extend interiorly into the interior rib receiving cavity 38. The two opposing aperture retention wings 42 can extend exteriorly through the wall openings 62 of the two opposing clip side walls 34.

[0039] A wall trailing end 40 of each side wall 34 of the U-base clip component 30 can be positioned between the inwardly extending portions 80 of a pair of coupling arms 70 that connect one of the aperture retention wings 42 to the central wall 46. This can facilitate proper centering and orientation of the U-base clip 30 and the seal component 32 during assembly and while assembled together. The trailing portion 88 of the wall opening 62 of the opposing clip side walls 34 can define a downwardly extending tab 96 that is positioned between the axially extending portions 82 of a pair of coupling arms 70 that connect one of the aperture retention wings 42 to the central wall 46. This can similarly facilitate proper centering and orientation of the U-base clip 30 and the seal component 32 during assembly and while assembled together. Each of the aperture retention wings 42 can include a groove or recessed portion (not shown) on its outer surface to corresponding the downwardly extending tab 96, which can similarly facilitate proper centering and orientation of the U-base clip 30 and the seal component 32 during assembly.

[0040] The dual component sealing fastener 20 can be a sub-assembly or portion of a coupling assembly 18 having a coupling configuration in which the first component 22 is coupled to the second component 26 as shown in Figs 12 and 13. In this coupling configuration, the U-base clip component 30 can extend through the clip aperture 48 of the seal component 32 and through the coupling aperture 28 of the second component 26 with the aperture retention wings 42 retaining the second component annular seal 54 against a sealing surface 76 of the second component 26 surrounding the coupling aperture 28. The coupling rib 24 can extend into the rib receiving cavity 38 with the rib coupling arms 44 retaining

the first component annular seal 50 against a sealing surface 78 of the first component 22 surrounding the coupling rib 24. As a result, the first component sealing surface 78 and the and second component sealing surface 76 can be sealed together around both the coupling aperture 28 of the second component 26 and the clip aperture 48 of the seal component 32.

[0041] The distal most exterior surface of the wing insertion end 64 and the distal most interior surface of the clip insertion end 63 can be positioned and designed to engage against each other to insure consistent compression of the seal 50 against the sealing surface 78. Similarly, the distal most end surface of the coupling rib 24 and the distal most interior surface of the wing insertion end 64 can be positioned and designed to engage against each other to insure consistent compression of the seal 54 against the sealing surface 76.

[0042] As used herein, the terms "longitudinal" and "longitudinally" refer to directions generally aligned with the longest overall dimension of the dual component fastener or seal component in a top plan view as shown in Fig. 7, or in a bottom plan view as shown in Fig. 8. This also corresponds to the X direction of an X, Y, Z coordinate system in these plan views. The terms "lateral" and "laterally" refer to directions generally aligned with the shortest overall dimension of the dual component fastener or seal component in a top plan view as shown in Fig. 7, or in a bottom plan view as shown in Fig. 8. This also corresponds to the Y direction of the X, Y, Z coordinate system in these plan views. The terms "axial" and "axially" corresponds to the Z direction of the X, Y, Z coordinate system in these plan views. The terms "upward" and "upwardly" are used in relation to the dual component fastener or its components being oriented as shown in Figs. 6 and 9-13. The terms "downward" and "downwardly" are used in relation to the dual component fastener or its components being oriented as shown in Figs. 6 and 9-13. Thus, upward, upwardly, downward, and downwardly, generally refer to Z directions of the X, Y, Z coordinate system. The terms "outward" and "outwardly" mean in a direction away from one of the aperture retention wings and toward the other aperture retention wings (which is along a Y direction of the X, Y, Z coordinate system). The terms "inward" and "inwardly" mean in a direction toward a center of the rib retention cavity. The terms "outward" and "outwardly" mean in a direction away from one of the aperture retention wings and also away from the other aperture retention wings, also along a Y direction of the X, Y, Z coordinate system.

Claims

1. A dual component sealing fastener (20) designed to couple a first component (22) having a rib (24) to a second component (26) having an aperture (28) therethrough, the dual component sealing fastener (20) comprising:

a U-base clip component (30) comprising:

two opposing clip side walls (34) joined together at a clip insertion end (36) to form a U-shaped clip portion; and
a pair of rib coupling barbs (44) extending inwardly from the two opposing clip side walls; and

a seal component (32) comprising:

a central wall (46) having a rib receiving aperture (48) therethrough; and
two opposing aperture retention wings (42) joined together at a wing insertion end (64) to form a U-shaped wing portion (66), and each of the two opposing aperture retention wings (42) having a wing trailing end (68), opposite the wing insertion end (64), coupled to the central wall (46); and
a first component annular seal (50) extending in a first direction away from a first side (52) of the central wall (46); and
a second component annular seal (54) extending in a second direction away from a second side (56) of the central wall opposite the first direction and opposite the first side (52), respectively; and

wherein the U-base clip component (30) and the seal component (32) have an assembled configuration in which the U-base clip component and the seal component are coupled together to define an interior rib receiving cavity (38) between both the two opposing clip side walls (34) and the two opposing aperture retention wings (42), and in which the pair of rib coupling barbs (44) extend into the interior rib receiving cavity (38), and in which the two opposing aperture retention wings extend exteriorly of the two opposing clip side walls (34); and
wherein the pair of rib coupling barbs (44) are designed to engage the rib to couple the dual component sealing fastener (20) to the rib in a coupled configuration with the rib received within the interior rib receiving cavity (38), and wherein the two opposing aperture retention wings (42) are designed to engage the aperture to couple the dual component sealing fastener (20) to the aperture (28) in the coupled configuration with the clip insertion end (36) and the wing insertion end (64) extending through the aperture (28).

2. The dual component sealing fastener (20) of claim 1, wherein a single piece molded plastic part (94) comprises the central wall (46) and the two opposing aperture retention wings (42).

3. The dual component sealing fastener (20) of claim 2, wherein all surfaces of the single piece molded plastic part (94) are oriented and positioned to enable molding of the single piece molded plastic part in a mold without any slides.

4. The dual component sealing fastener (20) of any of claims 1 to 3, wherein a single piece sheet metal part comprises the U-base clip component (30).

5. The dual component sealing fastener (20) of any of claims 1 to 4, wherein a single piece seal part comprises the first component annular seal (50) and the second component annular seal (54).

6. The dual component sealing fastener (20) of claim 5, wherein an annular recess (58) extends around the outside of the single piece seal part between the first component annular seal (50) and the second component annular seal (54).

7. The dual component sealing fastener (20) of any of claims 1 to 6, wherein the wing insertion end (64) is positioned interiorly of the clip insertion end (36) in the assembled configuration.

8. The dual component sealing fastener (20) of any of claims 1 to 7, wherein each of the two opposing clip side walls (34) has a wall opening (62) therethrough, and the two opposing aperture retention wings (42) extend outwardly through the wall openings (62).

9. The dual component sealing fastener (20) of claim 1, wherein an opening insertion end portion (86) and an opening trailing end portion (88) combine to form each wall opening (62) and the opening trailing end portion (88) has an opening trailing width (90) that is greater than an opening insertion width (92) of the opening insertion end portion.

10. The dual component sealing fastener (20) of claim 1, wherein each of the two opposing aperture retention wings (42) has a wing insertion end portion and a wing trailing end portion and the wing trailing end portion has a wing trailing width that is greater than a wing insertion width of the wing insertion end portion.

11. The dual component sealing fastener (20) of any of claims 1 to 10, wherein a wing coupling arm (70) couples each wing trailing end (68) to the central wall (46).

12. The dual component sealing fastener (20) of claim 11, wherein each wing coupling arm (70) includes a longitudinal pivot axis (72) that enables the wing coupling arm (70) to pivot upwardly in response to the two opposing aperture retention wings (42) moving

toward each other during insertion of the wing insertion end through the aperture.

13. The dual component sealing fastener (20) of claim 11 or claim 12, wherein each wing coupling arm (70) includes an axial pivot axis (74) that enables the wing coupling arm to pivot inwardly in response to the two opposing aperture retention wings (42) moving toward each other during insertion of the wing insertion end through the aperture.
14. The dual component sealing fastener (20) of claim 1, wherein a pair of wing coupling arms (70) couples each wing trailing end (68) to the central wall (46).
15. The dual component sealing fastener (20) of claim 14, wherein each wing coupling arm has an inwardly extending portion and a wall trailing end of each of the two opposing clip side walls is positioned between the inwardly extending portions of one of the pairs of wing coupling arms in the assembled configuration and/or wherein each wing coupling arm (70) has an axially extending portion, and each of the two opposing clip side walls (34) has a wall opening (62) therethrough with a trailing portion of each wall opening defining a downwardly extending tab (96) that is positioned between the axially extending portions of one of the pairs of wing coupling arms in the assembled configuration.

Patentansprüche

1. Zweikomponenten-Abdichtungsbefestiger (20), der dazu konzipiert ist, eine erste Komponente (22), die eine Rippe (24) aufweist, an eine zweite Komponente (26), die eine dort hindurchgehende Öffnung (28) aufweist, zu koppeln, wobei das Zweikomponenten-Abdichtungsbefestiger (20) umfasst:
- eine U-Basis-Klammerkomponente (30), umfassend:
- zwei entgegengesetzte Klammerseitenwände (34), die an einem Klammereinführungsende (36) miteinander verbunden sind, um einen U-förmigen Klammerabschnitt zu bilden; und
- ein Paar Rippenkopplungsarme (44), die sich von den zwei entgegengesetzten Klammerseitenwänden nach innen erstrecken; und
- eine Dichtungskomponente (32), umfassend:
- eine Mittelwand (46), die eine dort hindurchgehende Rippenaufnahmeöffnung (48) aufweist; und

zwei entgegengesetzte Öffnungshalteflügel (42), die an einem Flügeleinführungsende (64) miteinander verbunden sind, um einen U-förmigen Flügelabschnitt (66) zu bilden, und wobei jeder der zwei entgegengesetzten Öffnungshalteflügel (42) ein Flügelhinterende (68) gegenüber dem Flügeleinführungsende (64) aufweist, das mit der Mittelwand (46) gekoppelt ist; und

eine ringförmige Dichtung (50) der ersten Komponente, die sich in einer ersten Richtung von einer ersten Seite (52) der Mittelwand (46) weg erstreckt; und

eine ringförmige Dichtung (54) der zweiten Komponente, die sich in einer zweiten Richtung von einer zweiten Seite (56) der Mittelwand entgegengesetzt zu der ersten Richtung und entgegengesetzt zu der ersten Seite (52) weg erstreckt; und

wobei die U-Basis-Klammerkomponente (30) und die Dichtungskomponente (32) eine zusammengebaute Konfiguration aufweisen, in welcher die U-Basis-Klammerkomponente und die Dichtungskomponente miteinander gekoppelt sind, um einen inneren Rippenaufnahmehohlraum (38) sowohl zwischen den zwei entgegengesetzten Klammerseitenwänden (34) als auch den zwei entgegengesetzten Öffnungshalteflügeln (42) zu definieren, und in welcher sich das Paar Rippenkopplungsarme (44) in den inneren Rippenaufnahmehohlraum (38) erstreckt, und in welcher sich die zwei entgegengesetzten Öffnungshalteflügel außerhalb der zwei entgegengesetzten Klammerseitenwände (34) erstrecken; und

wobei das Paar Rippenkopplungsarme (44) so konzipiert ist, dass es in die Rippe eingreift, um das Zweikomponenten-Abdichtungsbefestiger (20) in einer gekoppelten Konfiguration mit der im inneren des Rippenaufnahmehohlraums (38) aufgenommenen Rippe zu koppeln, und wobei die zwei entgegengesetzten Öffnungshalteflügel (42) so konzipiert sind, dass sie in die Öffnung (28) eingreifen, um das Zweikomponenten-Abdichtungsbefestiger (20) in der gekoppelten Konfiguration mit dem Klammereinführungsende (36) und dem Flügeleinführungsende (64), das sich durch die Öffnung (28) erstreckt, zu koppeln.

2. Zweikomponenten-Abdichtungsbefestiger (20) nach Anspruch 1, wobei ein einstückiges Kunststoffformteil (94) die Mittelwand (46) und die zwei entgegengesetzten Öffnungshalteflügel (42) umfasst.
3. Zweikomponenten-Abdichtungsbefestiger (20) nach Anspruch 2, wobei alle Oberflächen des ein-

- stückigen Kunststoffformteils (94) so ausgerichtet und positioniert sind, dass das Formen des einstückigen Kunststoffformteils in einer Form ohne Schieber möglich ist.
4. Zweikomponenten-Abdichtungsbefestiger (20) nach einem der Ansprüche 1 bis 3, wobei ein einstückiges Blechteil die U-Basis-Klammerkomponente (30) umfasst.
5. Zweikomponenten-Abdichtungsbefestiger (20) nach einem der Ansprüche 1 bis 4, wobei ein einstückiges Dichtungsteil die ringförmige Dichtung (50) der ersten Komponente und die ringförmige Dichtung (54) der zweiten Komponente umfasst.
6. Zweikomponenten-Abdichtungsbefestiger (20) nach Anspruch 5, wobei sich eine ringförmige Vertiefung (58) rund um die Außenseite des einstückigen Dichtungsteils zwischen der ringförmigen Dichtung (50) der ersten Komponente und der ringförmigen Dichtung (54) der zweiten Komponente erstreckt.
7. Zweikomponenten-Abdichtungsbefestiger (20) nach einem der Ansprüche 1 bis 6, wobei das Flügeleinführungsende (64) in der zusammengebauten Konfiguration innerhalb des Klammereinführungsendes (36) positioniert ist.
8. Zweikomponenten-Abdichtungsbefestiger (20) nach einem der Ansprüche 1 bis 7, wobei jede der zwei entgegengesetzten Klammerseitenwände (34) eine dort hindurchgehende Wandöffnung (62) aufweist, und sich die zwei entgegengesetzten Öffnungshalteflügel (42) durch die Wandöffnungen (62) nach außen erstrecken.
9. Zweikomponenten-Abdichtungsbefestiger (20) nach Anspruch 1, wobei ein Öffnungseinführungsendabschnitt (86) und ein Öffnungshinterendabschnitt (88) kombiniert sind, um jede Wandöffnung (62) zu bilden, und der Öffnungshinterendabschnitt (88) eine hintere Öffnungsbreite (90) aufweist, die größer ist als eine Öffnungseinführungsbreite (92) des Öffnungseinführungsendabschnitts.
10. Zweikomponenten-Abdichtungsbefestiger (20) nach Anspruch 1, wobei jeder der zwei entgegengesetzten Öffnungshalteflügel (42) einen Flügeleinführungsendabschnitt und einen Flügelhinterendabschnitt aufweist und der Flügelhinterendabschnitt eine Flügelhinterbreite aufweist, die größer ist als eine Flügeleinführungsbreite des Flügeleinführungsendabschnitts.
11. Zweikomponenten-Abdichtungsbefestiger (20) nach einem der Ansprüche 1 bis 10, wobei ein Flügelkopplungsarm (70) jedes Flügelhinterende (68) an die Mittelwand (46) koppelt.
12. Zweikomponenten-Abdichtungsbefestiger (20) nach Anspruch 11, wobei jeder Flügelkopplungsarm (70) eine Längsschwenkachse (72) aufweist, die es dem Flügelkopplungsarm (70) ermöglicht, sich als Reaktion darauf, dass die zwei entgegengesetzten Öffnungshalteflügel (42) sich beim Einführen des Flügeleinführungsendes durch die Öffnung aufeinander zu bewegen, nach oben zu schwenken.
13. Zweikomponenten-Abdichtungsbefestiger (20) nach Anspruch 11 oder 12, wobei jeder Flügelkopplungsarm (70) eine axiale Schwenkachse (74) aufweist, die es dem Flügelkopplungsarm ermöglicht, sich als Reaktion darauf, dass die zwei entgegengesetzten Öffnungshalteflügel (42) sich beim Einführen des Flügeleinführungsendes durch die Öffnung aufeinander zu bewegen, nach innen zu schwenken.
14. Zweikomponenten-Abdichtungsbefestiger (20) nach Anspruch 1, wobei ein Paar Flügelkopplungsarme (70) jedes Flügelhinterende (68) an die Mittelwand (46) koppelt.
15. Zweikomponenten-Abdichtungsbefestiger (20) nach Anspruch 14, wobei jeder Flügelkopplungsarm einen sich nach innen erstreckenden Abschnitt aufweist, und ein Wandhinterende von jeder der zwei entgegengesetzten Klammerseitenwände in der zusammengebauten Konfiguration zwischen den sich nach innen erstreckenden Abschnitten eines der Paare von Flügelkopplungsarmen positioniert ist, und/oder wobei jeder Flügelkopplungsarm (70) einen sich axial erstreckenden Abschnitt aufweist, und jede der zwei entgegengesetzten Klammerseitenwände (34) eine dort hindurchgehende Wandöffnung (62) aufweist, wobei ein hinterer Abschnitt jeder Wandöffnung eine sich nach unten erstreckende Lasche (96) definiert, der in der zusammengebauten Konfiguration zwischen den sich axial erstreckenden Abschnitten eines der Paare von Flügelkopplungsarmen positioniert ist.

Revendications

1. Fixation d'étanchéité à deux composants (20) conçue pour coupler un premier composant (22) présentant une nervure (24) à un second composant (26) présentant un orifice (28) à travers celui-ci, la fixation d'étanchéité à deux composants (20) comprenant :
- un composant de pince de base en U (30) comprenant :

deux parois latérales de pince opposées (34) réunies au niveau d'une extrémité d'insertion de pince (36) pour former une partie de pince en forme de U ; et
une paire de pointes de couplage de nervure (44) s'étendant vers l'intérieur à partir des deux parois latérales de pince opposées ; et

un composant de joint d'étanchéité (32) comprenant :

une paroi centrale (46) présentant un orifice de réception de nervure (48) à travers celle-ci ; et

deux ailes de retenue d'orifice opposées (42) réunies au niveau d'une extrémité d'insertion d'aile (64) pour former une partie d'aile en forme de U (66) et chacune des deux ailes de retenue d'orifice opposées (42) présentant une extrémité de fuite d'aile (68), à l'opposé de l'extrémité d'insertion d'aile (64), couplée à la paroi centrale (46) ; et

un joint d'étanchéité annulaire de premier composant (50) s'étendant dans une première direction à l'écart d'un premier côté (52) de la paroi centrale (46) ; et

un joint d'étanchéité annulaire de second composant (54) s'étendant dans une seconde direction à l'écart d'un second côté (56) de la paroi centrale respectivement à l'opposé de la première direction et à l'opposé du premier côté (52) ; et

dans laquelle le composant de pince de base en U (30) et le composant de joint d'étanchéité (32) présentent une configuration assemblée dans laquelle le composant de pince de base en U et le composant de joint d'étanchéité sont couplés l'un à l'autre pour définir une cavité de réception de nervure intérieure (38) entre les deux parois latérales de pince opposées (34) et les deux ailes de retenue d'orifice opposées (42), et dans laquelle la paire de pointes de couplage de nervure (44) s'étendent dans la cavité de réception de nervure intérieure (38) et dans laquelle les deux ailes de retenue d'orifice opposées s'étendent à l'extérieur des deux parois latérales de pince opposées (34) ; et
dans laquelle la paire de pointes de couplage de nervure (44) est conçue pour venir en prise avec la nervure pour coupler la fixation d'étanchéité à deux composants (20) à la nervure dans une configuration couplée avec la nervure reçue à l'intérieur de la cavité de réception de nervure intérieure (38) et dans laquelle les deux ailes de retenue d'orifice opposées (42) sont conçues pour s'engager dans l'orifice pour coupler la fixa-

tion d'étanchéité à deux composants (20) à l'orifice (28) dans la configuration couplée avec l'extrémité d'insertion de pince (36) et l'extrémité d'insertion d'aile (64) s'étendant à travers l'orifice (28).

2. Fixation d'étanchéité à deux composants (20) selon la revendication 1, dans laquelle une pièce en plastique moulée d'un seul tenant (94) comprend la paroi centrale (46) et les deux ailes de retenue d'orifice opposées (42).
3. Fixation d'étanchéité à deux composants (20) selon la revendication 2, dans laquelle toutes les surfaces de la pièce en plastique moulée d'un seul tenant (94) sont orientées et positionnées pour permettre le moulage de la pièce en plastique moulée d'un seul tenant dans un moule sans aucune glièsière.
4. Fixation d'étanchéité à deux composants (20) selon l'une quelconque des revendications 1 à 3, dans laquelle une pièce en tôle d'un seul tenant comprend le composant de pince de base en U (30).
5. Fixation d'étanchéité à deux composants (20) selon l'une quelconque des revendications 1 à 4, dans laquelle une pièce d'étanchéité d'un seul tenant comprend le joint d'étanchéité annulaire de premier composant (50) et le joint d'étanchéité annulaire de second composant (54).
6. Fixation d'étanchéité à deux composants (20) selon la revendication 5, dans laquelle un évidement annulaire (58) s'étend autour de l'extérieur de la pièce d'étanchéité d'un seul tenant entre le joint d'étanchéité annulaire de premier composant (50) et le joint d'étanchéité annulaire de second composant (54).
7. Fixation d'étanchéité à deux composants (20) selon l'une quelconque des revendications 1 à 6, dans laquelle l'extrémité d'insertion d'aile (64) est positionnée à l'intérieur de l'extrémité d'insertion de pince (36) dans la configuration assemblée.
8. Fixation d'étanchéité à deux composants (20) selon l'une quelconque des revendications 1 à 7, dans laquelle chacune des deux parois latérales de pince opposées (34) présente une ouverture de paroi (62) à travers celle-ci, et les deux ailes de retenue d'orifice opposées (42) s'étendent vers l'extérieur à travers les ouvertures de paroi (62).
9. Fixation d'étanchéité à deux composants (20) selon la revendication 1, dans laquelle une partie d'extrémité d'insertion d'ouverture (86) et une partie d'extrémité de fuite d'ouverture (88) se combinent pour former chaque ouverture de paroi (62) et la partie d'extrémité de fuite d'ouverture (88) présente une

largeur de fuite d'ouverture (90) qui est plus grande qu'une largeur d'insertion d'ouverture (92) de la partie d'extrémité d'insertion d'ouverture.

dans la configuration assemblée.

10. Fixation d'étanchéité à deux composants (20) selon la revendication 1, dans laquelle chacune des deux ailes de rétention d'orifice opposées (42) présente une partie d'extrémité d'insertion d'aile et une partie d'extrémité de fuite d'aile et la partie d'extrémité de fuite d'aile présente une largeur de fuite d'aile qui est plus grande qu'une largeur d'insertion d'aile de la partie d'extrémité d'insertion d'aile. 5
10
11. Fixation d'étanchéité à deux composants (20) selon l'une quelconque des revendications 1 à 10, dans laquelle un bras de couplage d'aile (70) couple chaque extrémité de fuite d'aile (68) à la paroi centrale (46). 15
12. Fixation d'étanchéité à deux composants (20) selon la revendication 11, dans laquelle chaque bras de couplage d'aile (70) inclut un axe de pivotement longitudinal (72) qui permet au bras de couplage d'aile (70) de pivoter vers le haut en réponse aux deux ailes de retenue d'orifice opposées (42) se déplaçant l'une vers l'autre lors de l'insertion de l'extrémité d'insertion d'aile par l'orifice. 20
25
13. Fixation d'étanchéité à deux composants (20) selon la revendication 11 ou 12, dans laquelle chaque bras de couplage d'aile (70) inclut un axe de pivotement axial (74) qui permet au bras de couplage d'aile de pivoter vers l'intérieur en réponse aux deux ailes de retenue d'orifice opposées (42) se déplaçant l'une vers l'autre lors de l'insertion de l'extrémité d'insertion d'aile par l'orifice. 30
35
14. Fixation d'étanchéité à deux composants (20) selon la revendication 1, dans laquelle une paire de bras de couplage d'aile (70) couple chaque extrémité de fuite d'aile (68) à la paroi centrale (46). 40
15. Fixation d'étanchéité à deux composants (20) selon la revendication 14, dans laquelle chaque bras de couplage d'aile présente une partie s'étendant vers l'intérieur et une extrémité de fuite de paroi de chacune des deux parois latérales de pince opposées est positionnée entre les parties s'étendant vers l'intérieur de l'une des paires de bras de couplage d'aile dans la configuration assemblée et/ou dans laquelle chaque bras de couplage d'aile (70) présente une partie s'étendant axialement et chacune des deux parois latérales de pince opposées (34) présente une ouverture de paroi (62) à travers celle-ci, une partie de fuite de chaque ouverture de paroi définissant une languette s'étendant vers le bas (96) qui est positionnée entre les parties s'étendant axialement de l'une des paires de bras de couplage d'aile 45
50
55

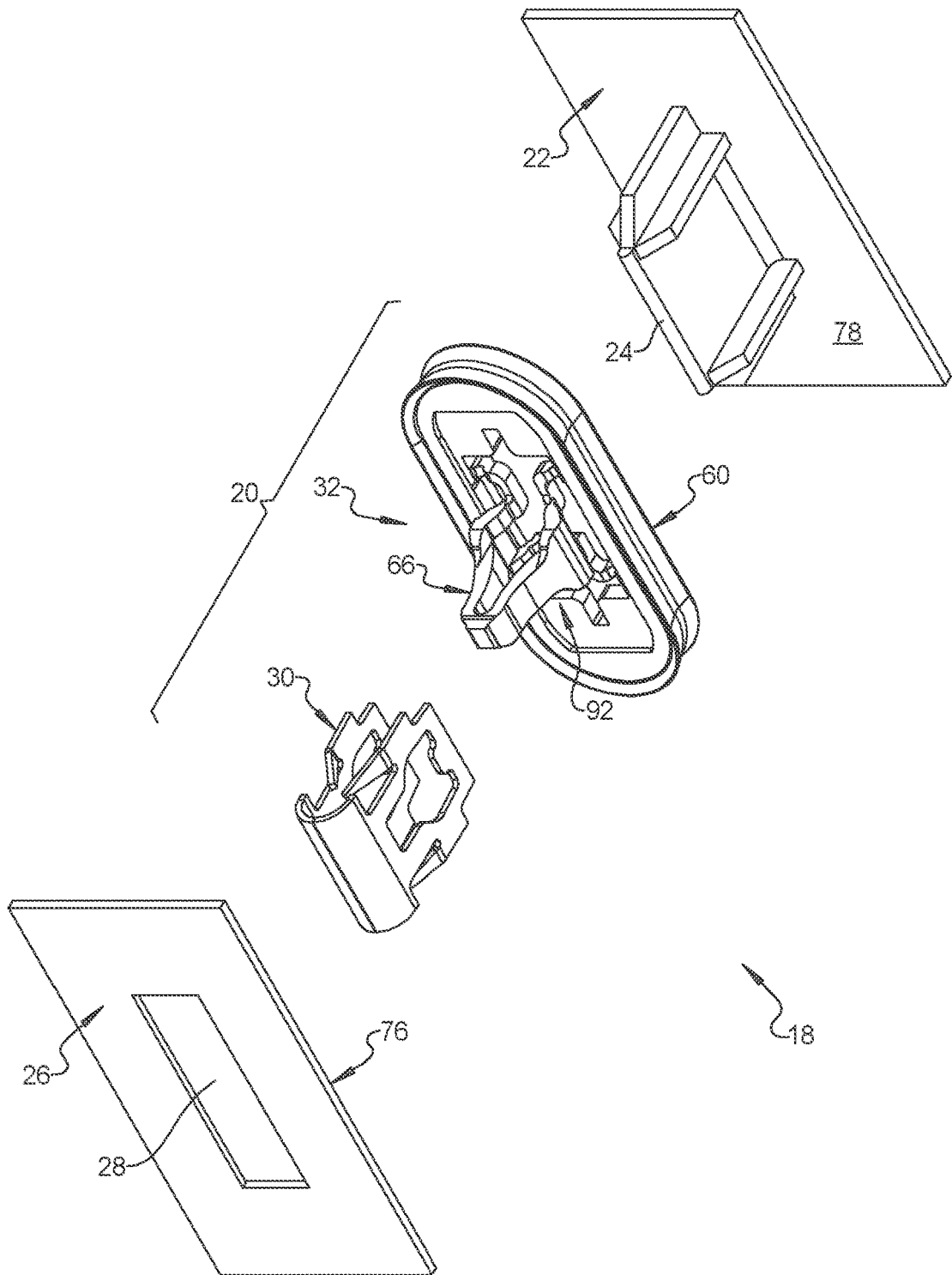

FIG. 1

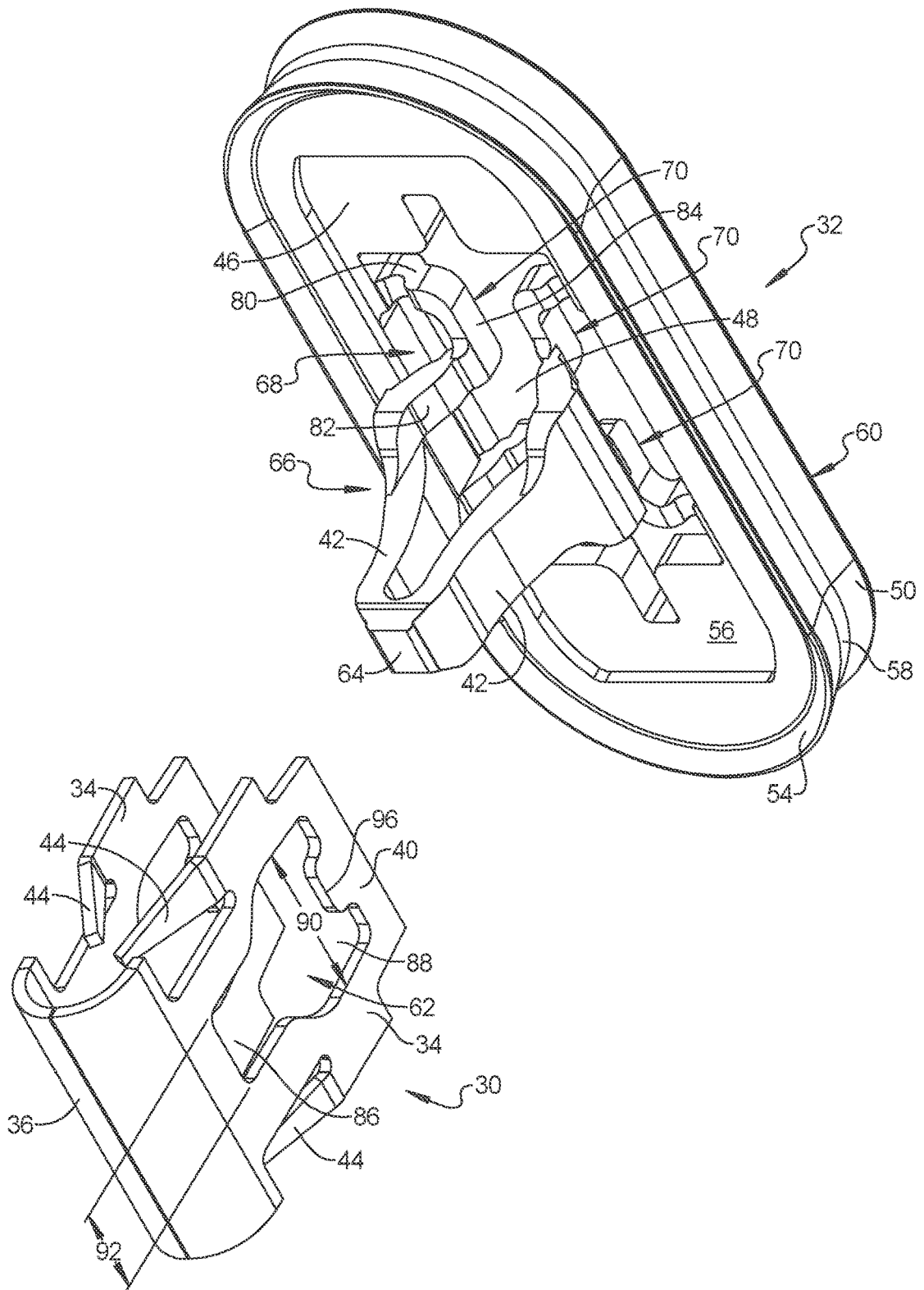

FIG. 2

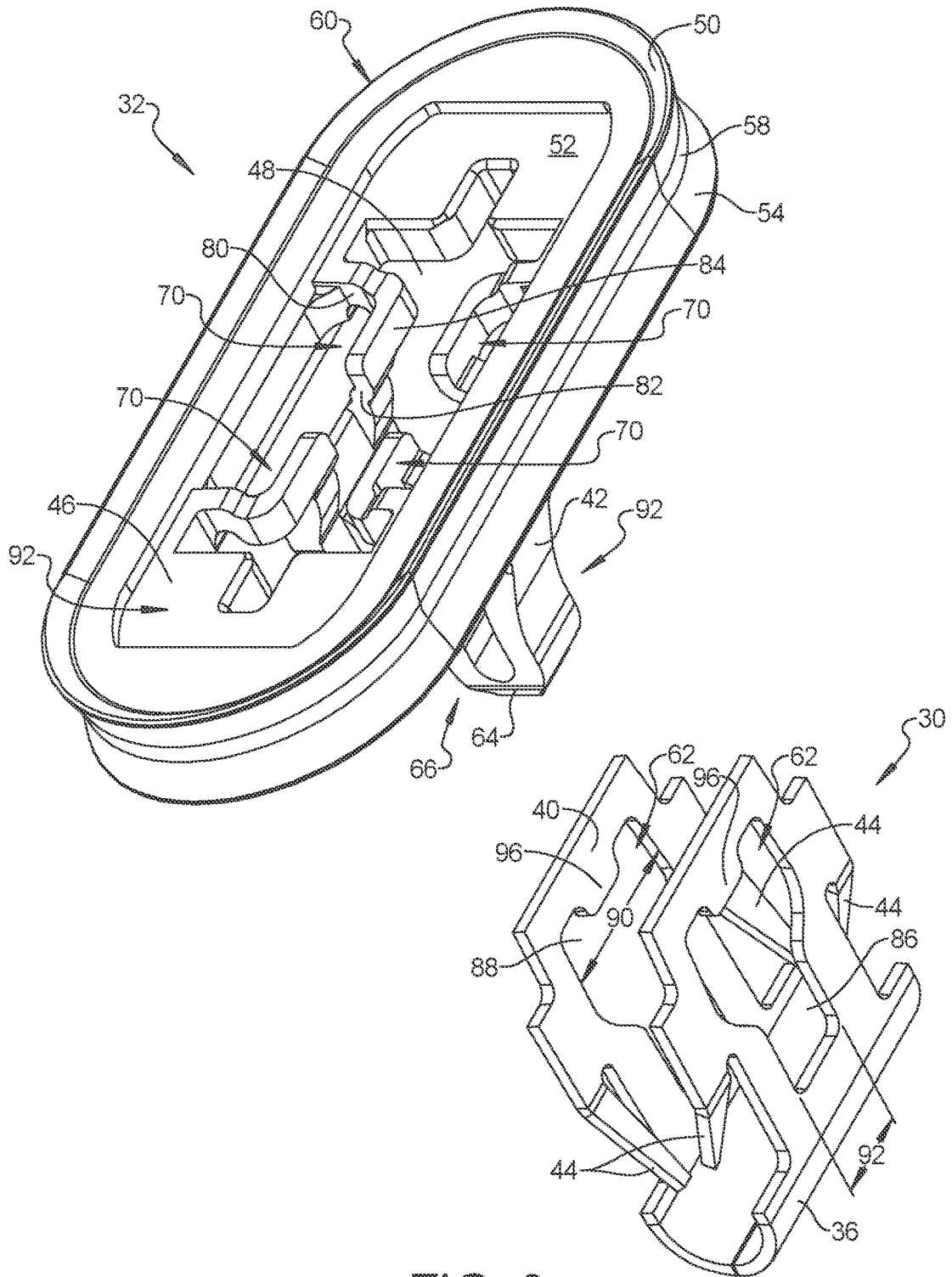

FIG. 3

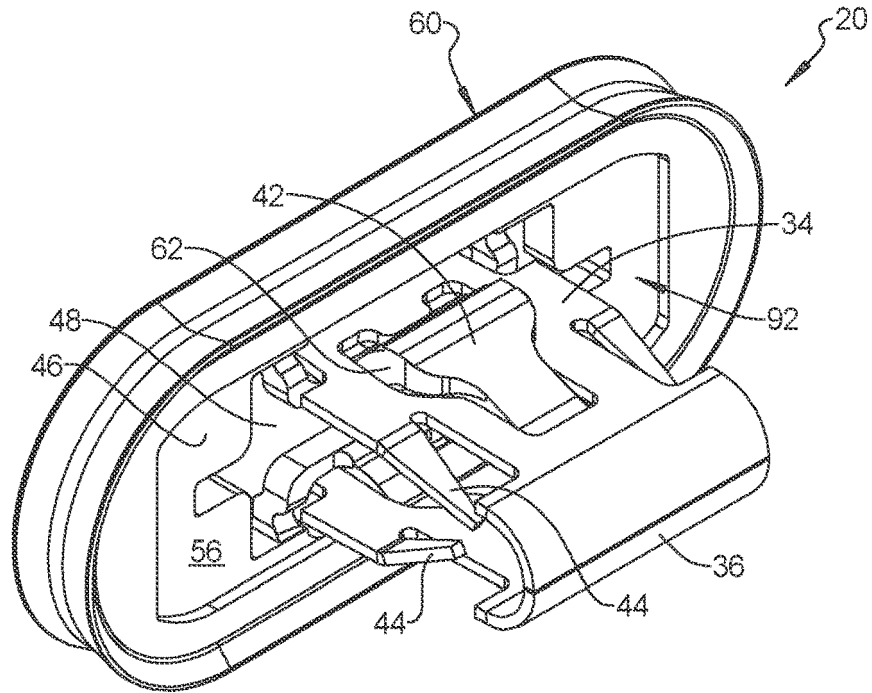

FIG. 4

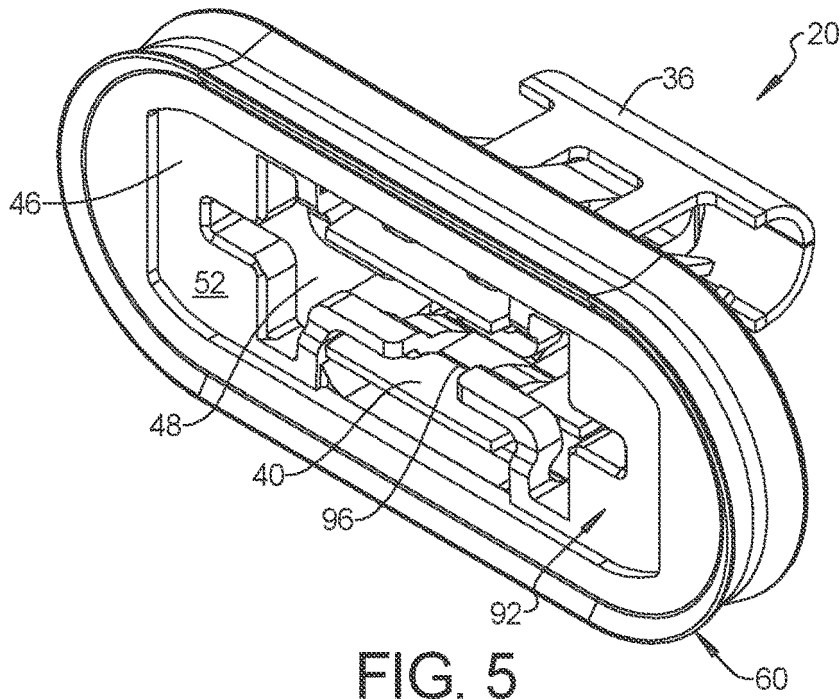

FIG. 5

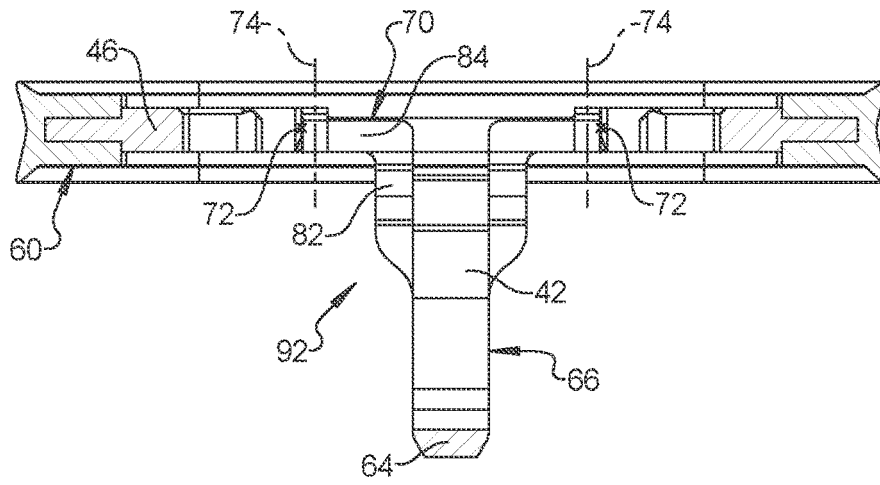

FIG. 6

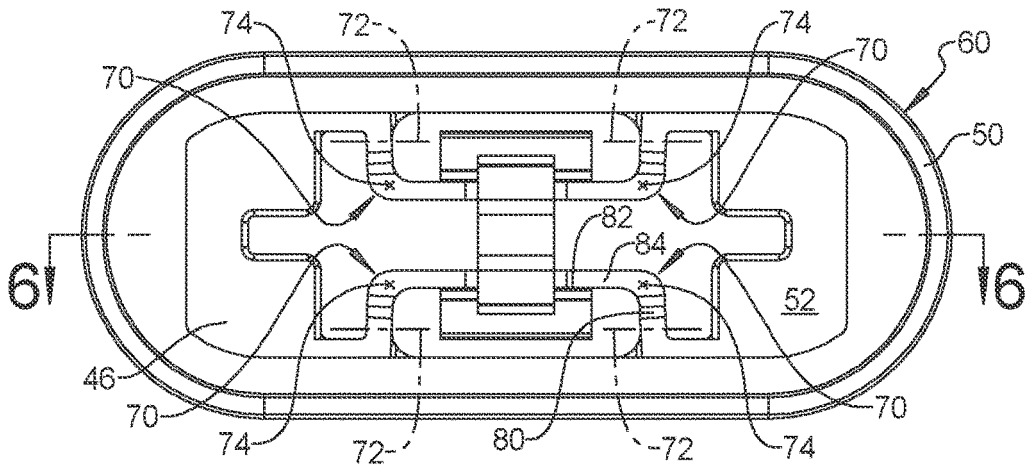

FIG. 7

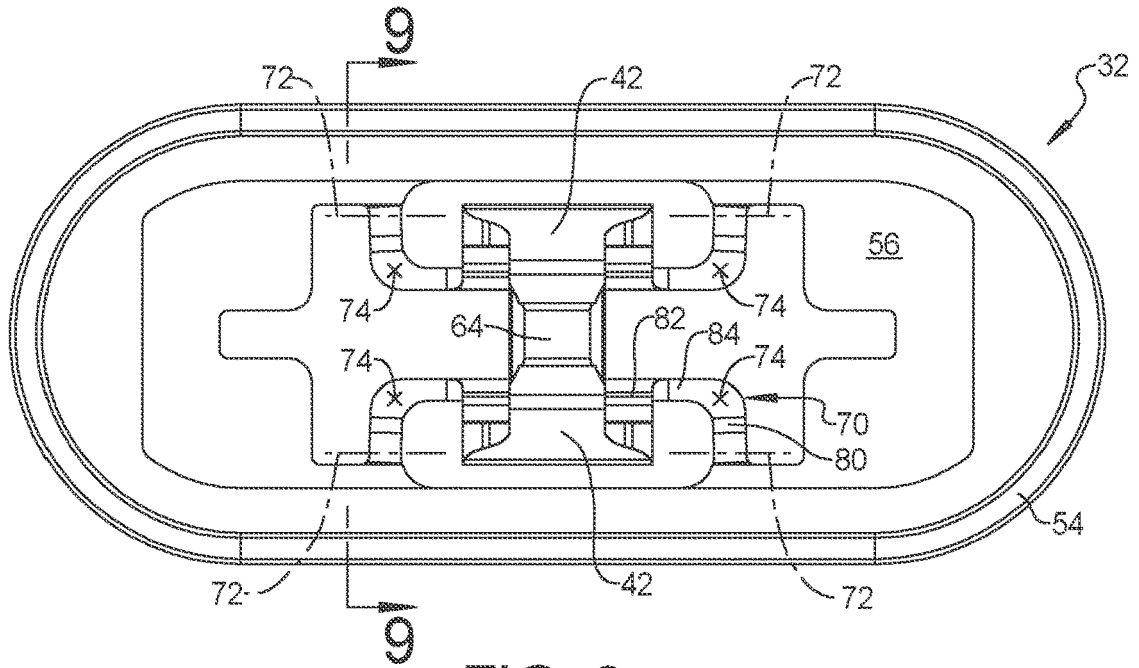

FIG. 8

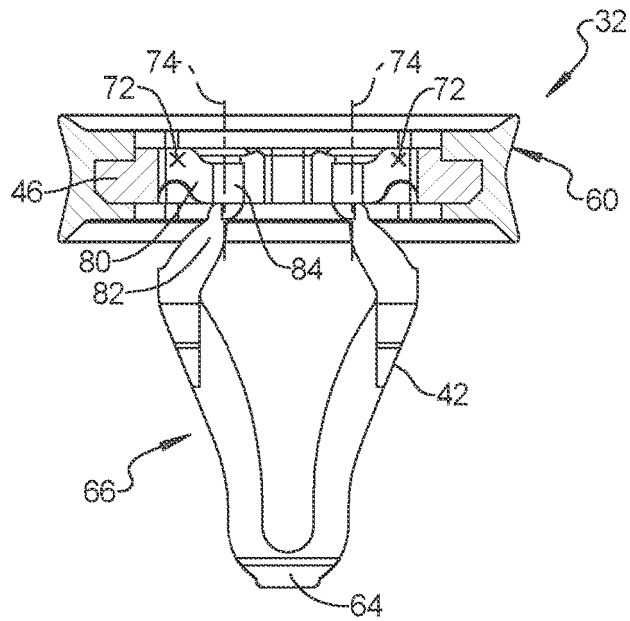

FIG. 9

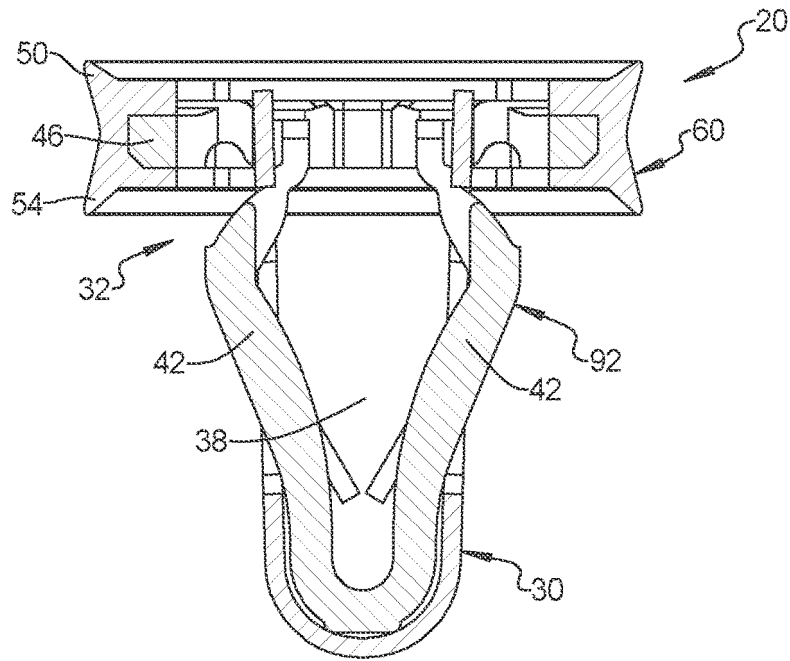

FIG. 10

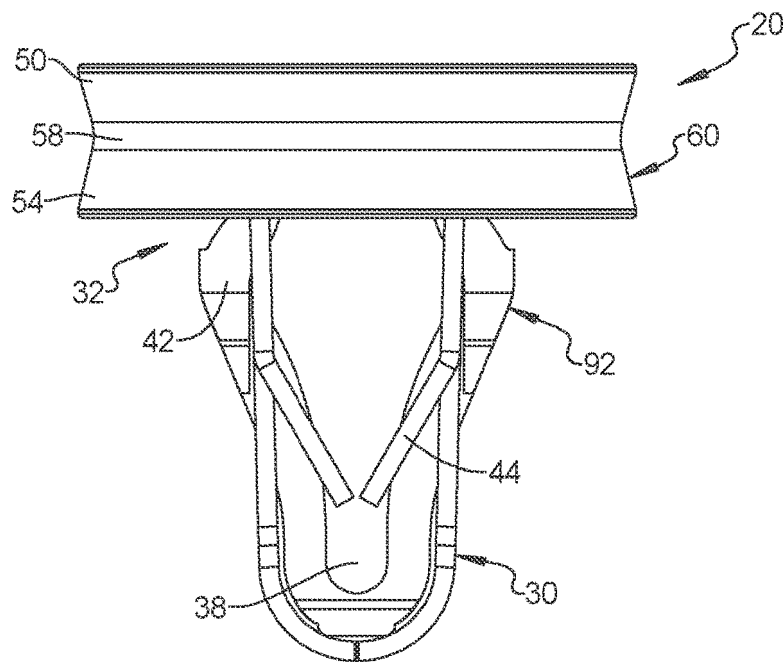

FIG. 11

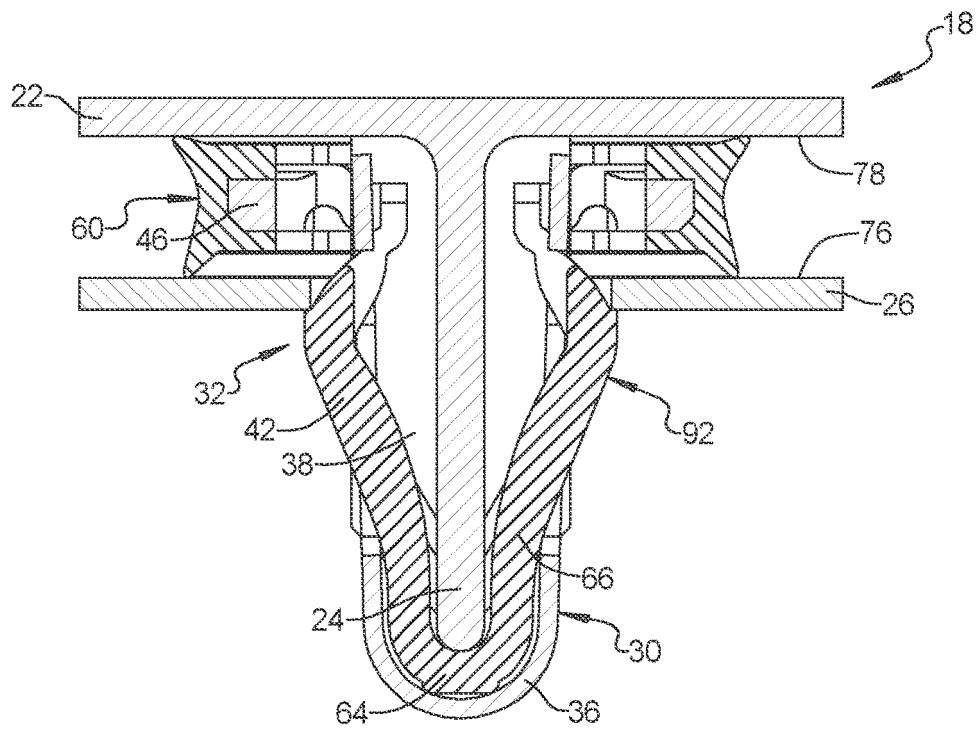

FIG. 12

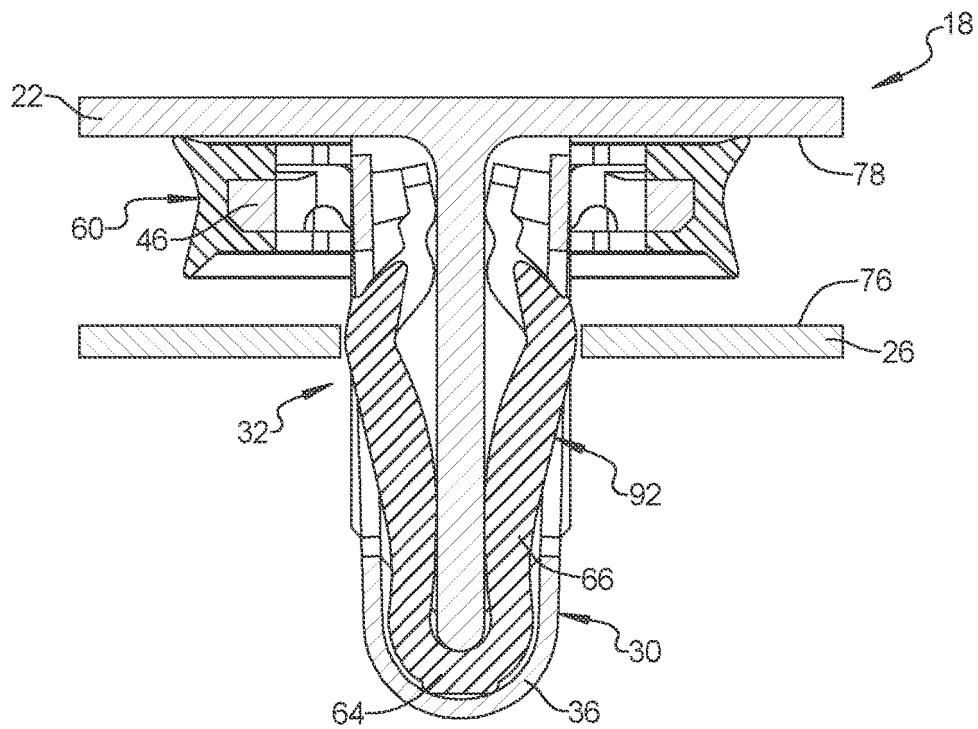

FIG. 13

REFERENCES CITED IN THE DESCRIPTION

This list of references cited by the applicant is for the reader's convenience only. It does not form part of the European patent document. Even though great care has been taken in compiling the references, errors or omissions cannot be excluded and the EPO disclaims all liability in this regard.

Patent documents cited in the description

- GB 2201723 A [0005]