

(19)



(11)

EP 4 209 705 B1

(12)

EUROPEAN PATENT SPECIFICATION

(45) Date of publication and mention of the grant of the patent:

01.05.2024 Bulletin 2024/18

(21) Application number: **22154289.7**

(22) Date of filing: **31.01.2022**

(51) International Patent Classification (IPC):

F21S 4/28 ^(2016.01)	F21V 23/00 ^(2015.01)
F21V 27/02 ^(2006.01)	F21V 31/00 ^(2006.01)
F21V 15/01 ^(2006.01)	F21S 8/04 ^(2006.01)
F21V 21/03 ^(2006.01)	F21Y 103/10 ^(2016.01)
F21Y 107/00 ^(2016.01)	F21Y 115/10 ^(2016.01)

(52) Cooperative Patent Classification (CPC):

F21V 31/005; F21S 4/28; F21S 8/04; F21V 15/013; F21V 21/03; F21V 23/001; F21V 23/006; F21V 27/02; F21Y 2103/10; F21Y 2107/00; F21Y 2115/10

(54) **EXTRUSION-TYPE TRI-PROOF LAMP**

EXTRUSIONSARTIGE FEUCHTRAUMLEUCHTE

LAMPE TRIPLE PROTECTION DE TYPE EXTRUSION

(84) Designated Contracting States:

AL AT BE BG CH CY CZ DE DK EE ES FI FR GB GR HR HU IE IS IT LI LT LU LV MC MK MT NL NO PL PT RO RS SE SI SK SM TR

(30) Priority: **07.01.2022 CN 202220038501 U**
07.01.2022 CN 202210015030

(43) Date of publication of application:
12.07.2023 Bulletin 2023/28

(73) Proprietor: **Xiamen AXG Lighting Co., Ltd.**
Xiamen City, Fujian Province (CN)

(72) Inventors:

- **YU, Xiaoming**
Xiamen City (CN)

- **LU, Kai**
Xiamen City (CN)
- **CHAN, Kum Cheong**
Xiamen City (CN)
- **TAN, Jianye**
Xiamen City (CN)
- **CHEN, Buxing**
Xiamen City (CN)

(74) Representative: **Izquierdo Blanco, Maria Alicia**
Acopat ID
General Salazar, 10
48012 Bilbao (ES)

(56) References cited:

EP-A1- 3 179 164	CN-A- 113 847 557
CN-U- 204 005 554	CN-U- 206 786 418
DE-U1-202011 051 252	

EP 4 209 705 B1

Note: Within nine months of the publication of the mention of the grant of the European patent in the European Patent Bulletin, any person may give notice to the European Patent Office of opposition to that patent, in accordance with the Implementing Regulations. Notice of opposition shall not be deemed to have been filed until the opposition fee has been paid. (Art. 99(1) European Patent Convention).

Description

BACKGROUND OF THE INVENTION

1. Technical Field

[0001] The invention relates to the field of tri-proof lamps, in particular to an extrusion-type tri-proof lamp.

2. Description of Related Art

[0002] Tri-proof lamps are illuminating lamps with a water-proof function, a dust-proof function and a corrosion-proof function, and have been widely used in factories, offices, metros, airports and other special occasions with water-proof, dust-proof and corrosion-proof requirements. Generally, the tri-proof lamps are produced by injection-molding or extrusion. Different molds are needed for injection-molding of tri-proof lamps with different sizes, which makes the investment cost high. Extrusion-type tri-proof lamps with any lengths can be fabricated without any mold. Most existing extrusion-type tri-proof lamps are of an integrated structure, and wiring holes are reserved only in two sides of the extrusion-type tri-proof lamps to allow electricians to assemble or disassemble wires; a small part of the tri-proof lamps are provided with a detachable battery, but the drive module, the light source module, and a microwave sensor are undetachable. The tri-proof lamp is expensive and will not be able to function normally once one part is broken, so the use effect is compromised, and even the whole lamp will be discarded, thus causing resource waste and increasing the use cost due to the replacement with a new lamp. In addition, wires are connected into the existing extrusion-type tri-proof lamps from two sides, so the overall wiring is disordered, and the use effect and overall appearance of the lamps are compromised.

[0003] Document EP3179164A1 describes a tri-proof lamp according to the preamble of claim 1 of the present invention.

BRIEF SUMMARY OF THE INVENTION

[0004] The objective of the invention is to provide an extrusion-type tri-proof lamp to solve the problems of resource waste and high use cost caused by difficult maintenance and disordered overall wiring of the existing tri-proof lamps.

[0005] To fulfill the objective of the invention, the following technical solution is adopted.

[0006] An extrusion-type tri-proof lamp comprises a lampshade, shell assemblies disposed at two ends of the lampshade, and end cover assemblies detachably mounted on the shell assemblies, wherein a slideway and a heat sink slidably connected to the slideway are disposed in the lampshade, a light source module and a drive module are disposed on the heat sink, the light source module is connected to the drive module, the drive

module is connected to an external power source, a wiring board to be connected to the external power source and a mounting plate fixedly connected to a mounting face are disposed on the back of the lampshade, the wiring board is detachably connected to the mounting plate, a first water-proof ring is disposed between the mounting plate and the lampshade, the mounting plate is provided with a wiring hole allowing the power source to be connected thereto, and a second water-proof ring is disposed in the wiring hole.

[0007] Preferably, the mounting plate comprises a first base plate, the first base plate is provided with a first wiring socket and a first wiring terminal to be connected to the power wire, the first wiring terminal is connected to the first wiring socket through a wire, the wiring board comprises a second base plate, the second base plate is provided with a second wiring socket matched with the first wiring socket, the first wiring socket is connected to the second wiring socket in a pluggable manner, and the drive module is connected to the second wiring socket through a wire.

[0008] Preferably, the first wiring socket comprises a PCB male pin connecting board fixed to a first board body, a male pin fixing base disposed on the PCB male pin connecting board, a male pin assembly disposed in the male pin fixing base, and a male pin fixing gland covering the PCB male pin connecting board; and the second wiring socket comprises a PCB female pin connecting board fixed to a second board body, a female pin fixing base disposed on the PCB female pin connecting board, a female pin assembly disposed in the female pin fixing base, and a female pin fixing gland covering the PCB female pin connecting board.

[0009] Preferably, a second wiring terminal and a third wiring terminal are disposed at two ends of the heat sink, and the drive module is connected to one of the first wiring terminal, the second wiring terminal and the third wiring terminal.

[0010] Preferably, mounting brackets for mounting the second wiring terminal and the third wiring terminal are disposed at the two ends of the heat sink, and are provided with handles for users to pull the heat sink out.

[0011] Preferably, the mounting plate is provided with fasteners, the lampshade is provided with fastening portions clamped on and matched with the fasteners, and after being connected to the wiring board, the mounting plate is clamped and fixed to the lampshade through the fasteners.

[0012] Preferably, each of the end cover assemblies comprises a cover and a water-proof connector, the covers are provided with first wire holes allowing the power wire to penetrate through, the water-proof connectors are provided with second wire holes allowing the power wire to penetrate through, rubber plugs are disposed in the first wire holes, the water-proof connectors are detachably mounted on the covers, internal threads are disposed on inner walls of the shell assemblies, external threads matched with the internal threads are disposed

on the covers, and the end cover assemblies and the shell assemblies are fixed or disassembled by screwing.

[0013] Preferably, a pressing plate is disposed between each shell assembly and the corresponding end cover assembly, and is fixedly connected to the shell assembly.

[0014] Preferably, the heat sink is further provided with a microwave sensor connected to the drive module.

[0015] Preferably, the heat sink comprises a cooling substrate, a first side plate and a second side plate, the first side plate and the second side plate are obliquely disposed at two ends of the cooling substrate and are slidably connected to the slideway, the light source assembly comprises a first light strip disposed on the surface of the cooling substrate, a second light strip disposed on the surface of the first side plate, and a third light strip disposed on the second side plate, the microwave sensor and the drive module are disposed at the bottom of the cooling substrate, and the cooling substrate is provided with a via hole for detecting the microwave sensor.

[0016] The invention has the following beneficial effects:

1. The extrusion-type tri-proof lamp of the invention is provided with the slidable heat sink, and the light source module, and the microwave sensor and the drive module are disposed on the heat sink, such that internal components can be pulled out to be replaced or maintained; and the whole lamp does not need to be discarded, such that resource waste is effectively avoided, and the use cost is reduced for users.

2. Wiring on the back of the lampshade is added, so that more wiring methods are provided for customers; and the power wire will not be seen after the lamp is assembled, such that the whole lamp is more beautiful

BRIEF DESCRIPTION OF THE SEVERAL VIEWS OF THE DRAWINGS

[0017]

FIG. 1 is a disassembled structural view of the invention;

FIG. 2 is an overall structural view of the invention;

FIG. 3 is a structural view of the invention after a mounting plate is disassembled;

FIG. 4 is a structural view of top wiring of the invention;

FIG. 5 is a structural view of the invention after end cover assemblies are disassembled;

FIG. 6 is a structural view of side wiring of the invention;

FIG. 7 is a structural view of the pulling condition of the internal structure of the invention;

FIG. 8 is a schematic diagram of the internal structure of the invention;

FIG. 9 is a disassembled structural view of the surface of the internal structure of the invention;

FIG. 10 is a disassembled structural view of the bottom surface of the internal structure of the invention;

5

5

5

5

5

5

5

5

5

5

5

5

5

5

5

5

5

5

5

5

5

5

5

5

5

5

5

5

5

5

5

5

5

5

5

5

5

5

5

5

5

5

5

5

5

5

5

5

5

5

5

5

5

5

5

5

5

5

5

5

5

5

5

5

5

5

[0018] In the figures: 10, lampshade; 20, shell assembly; 30, end cover assembly; 40, slideway; 50, heat sink; 51, cooling substrate; 52, first side plate; 53, second side plate; 60, light source module; 61, first light strip; 62, second light strip; 63, third light strip; 70, microwave sensor; 80 drive module; 90, mounting plate; 91, first base plate; 92, first wiring socket; 921, PCB male pin connecting board; 922, male pin fixing base; 923, male pin assembly; 924, male pin fixing gland; 93, first wiring terminal; 100, wiring board; 101, second base plate; 102, first wiring socket; 1021, PCB female pin connecting board; 1022, female pin fixing base; 1023, female pin assembly; 1024, female pin fixing gland; 110, first water-proof ring; 120, second water-proof ring; 130, second wiring terminal; 140, third wiring terminal; 150, mounting bracket; 151, handle; 160, fastener; 170, pressing plate.

DETAILED DESCRIPTION OF THE INVENTION

25

25

25

25

25

25

25

25

25

25

25

25

25

25

25

25

25

25

25

25

25

25

25

25

25

25

25

25

25

25

25

25

25

25

25

25

25

25

25

25

25

25

25

25

25

[0019] The lampshade 10 of existing tri-proof lamps are fabricated typically by injection-molding and extrusion. Molds with different lengths are needed for injection-molding of lampshades 10 with different lengths, so the production cost is extremely high, and the range of selectable machines is narrow. Tubes with the same section and any lengths can be continuously fabricated by extruding, so that the mold cost is effectively reduced. The existing tri-proof lamps are difficult to maintain, thus causing resource waste and high use cost; and back wiring is not available yet at present. In view of this, the invention provides a new solution. For the sake of a clearer representation, the invention will be described in detail below in conjunction with the accompanying drawings.

40

40

40

40

40

40

40

40

40

40

40

40

40

40

40

40

40

40

40

40

40

40

40

40

40

40

40

40

40

40

[0020] As shown in FIG. 1-FIG. 10, an extrusion-type tri-proof lamp comprises a lampshade 10, shell assemblies 20 fixedly disposed at two ends of the lampshade 10, and end cover assemblies 30 detachably mounted on the shell assemblies 20. A slideway 40 and a heat sink 50 slidably connected to the slideway 40 are disposed in the lampshade 10. A light source module 60, a microwave sensor 70 and a drive module 80 are disposed on the heat sink 50. The microwave sensor 70 is used to detect whether a person approaches the tri-proof lamp, controls the tri-proof lamp to be turned on or increases the brightness of the tri-proof lamp when detecting that a person approaches the tri-proof lamp, and controls the tri-proof lamp to be turned off or decrease the brightness of the tri-proof lamp when detecting that the person moves away from the tri-proof lamp. The light source module 60 and the microwave sensor 70 are both connected to the drive module 80, and the drive module 80 is connected to an external power source. A wiring board 100 to be connected to the external power source and a

mounting plate 90 fixedly connected to a mounting face are disposed on the back of the lampshade 10, the wiring board 100 is detachably connected to the mounting plate 90, a first water-proof ring 110 is disposed between the mounting plate 90 and the lampshade 10, the mounting plate 90 is provided with a wiring hole allowing a power wire to be connected thereto, and a second water-proof ring 120 is disposed in the wiring hole, such that a water-proof effect over level 5 is effectively realized.

[0021] In other embodiments, only the light source module 60 and the drive module 80 are disposed on the heat sink 50 to meet requirements of different users.

[0022] The mounting plate 90 comprises a first base plate 91, connecting holes are formed in two ends of the first base plate 91, and expansion bolts penetrate through the connecting holes to fixedly connect the mounting plate 90 to the mounting face such as a ceiling. The first base plate 91 is provided with a first wiring socket 92 and a first wiring terminal 93 to be connected to the power wire, and the first wiring terminal 93 is connected to the first wiring socket 92 through a wire. In this embodiment, the first wiring terminal 93 comprises a three-position terminal and a two-position terminal, such that the requirements for connection to a power source in different usage scenarios are met.

[0023] A mounting hole is formed in the back of the lampshade 10, the wiring board 100 is disposed in the lampshade 10 and corresponds to the mounting hole in position. The wiring board 100 comprises a second base plate 101, the second base plate 101 is provided with a second wiring socket 102 matched with the first wiring socket 92, the first wiring socket 92 is connected to the second wiring socket 102 in a pluggable manner, and the drive module 80 is connected to the second wiring socket 102 through a wire.

[0024] The first wiring socket 92 comprises a PCB male pin connecting board 921 fixed to a first board body, a male pin fixing base 922 disposed on the PCB male pin connecting board 921, a male pin assembly 923 disposed in the male pin fixing base 922, and a male pin fixing gland 924 covering the PCB male pin connecting board 921; and the second wiring socket 102 comprises a PCB female pin connecting board 1021 fixed to a second board body, a female pin fixing base 1022 disposed on the PCB female pin connecting board 1021, a female pin assembly 1023 disposed in the female pin fixing base 1022, and a female pin fixing gland 1024 covering the PCB female pin connecting board 1021.

[0025] A second wiring terminal 130 and a third wiring terminal 140 are disposed at two ends of the heat sink 50, and the drive module 80 is connected to one of the first wiring terminal 93, the second wiring terminal 130 and the third wiring terminal 140. Any one of the first wiring terminal 93, the second wiring terminal 130 and the third wiring terminal 140 is connected to the power wire, such that power supply to the whole lamp is realized.

[0026] Mounting brackets 150 for mounting the second wiring terminal 130 and the third wiring terminal 140 are

disposed at the two ends of the heat sink 50, and the mounting bracket 150 are provided with handles 151 for users to pull the heat sink 50 out.

[0027] In this embodiment, each of the second wiring terminal 130 and the third wiring terminal 140 comprises a three-position terminal and a four-position terminal, such that the requirements for connection to a power source in different usage scenarios are met. Correspondingly, each of the mounting brackets 150 comprises a three-position terminal bracket and a four-position terminal bracket, the three-position terminals are fixed to the three-position terminal brackets, the four-position terminals are fixed to the four-position terminal brackets, the four-position terminal brackets are fixedly connected to the three-position terminal brackets, the three-position terminal brackets are fixedly disposed at the two ends of the heat sink 50, and the handle 151 are disposed at one end of the four-position terminal brackets.

[0028] The mounting plate 90 is provided with fasteners 160 locked at the bottom of the mounting plate 90 with screws, the lampshade 10 is provided with fastening portions fastened on and matched with the fasteners 160, and after being connected to the wiring board 100, the mounting plate 90 is clamped and fixed to the lampshade 10 through the fasteners 160. In this embodiment, the fasteners 160 are metal fasteners 160, and one to three fasteners 160 may be arranged to guarantee the fixing stability.

[0029] Each of the end cover assemblies 30 comprises a cover and a water-proof connector, the covers are provided with first wire holes allowing the power wire to penetrate through, the water-proof connectors are provided with second wire holes allowing the power wire to penetrate through, rubber plugs are disposed in the first wire holes, and the water-proof connectors are detachably mounted on the covers.

[0030] Internal threads are disposed on inner walls of the shell assemblies 20, external threads matched with the internal threads are disposed on the covers, and the end cover assemblies 30 and the shell assemblies 20 are fixed or disassembled by screwing.

[0031] A pressing plate 170 is disposed between each shell assembly 20 and the corresponding end cover assembly 30, and is fixedly connected to the shell assembly 20 through a screw. The pressing plates 170 can protect the internal structure from being opened with bare hands, thus guaranteeing the safety.

[0032] The heat sink 50 comprises a cooling substrate 51, a first side plate 52 and a second side plate 53, wherein the first side plate 52 and the second side plate 53 are obliquely disposed at two ends of the cooling substrate 51, the first side plate and the second side plate are slidably connected to the slideway, the cooling substrate 51 is provided with an aluminum part, and internal elements are cooled by means of the heat conductivity of aluminum.

[0033] In this embodiment, the light source module 60 comprises a first light strip 61 disposed on the surface of

the cooling substrate 51, a second light strip 62 disposed on the surface of the first side plate 52, and a third light strip 63 disposed on the second side plate 53, and the first light strip 61, the second light strip 62 and the third light strip 63 are all locked on the surface of the heat sink with screws.

[0034] In other embodiments, the light source module 60 can be arranged as actually needed, and may comprise one or more light strips to meet requirements of different users.

[0035] In this embodiment, the microwave sensor 70 and the drive module 80 are disposed at the bottom of the cooling substrate 51, the microwave sensor 70 is locked in the three-position terminal bracket at one end with screws, and the three-position terminal bracket and the cooling substrate 51 are provided with via holes for detecting the microwave sensor 70. Drive brackets are disposed at two ends of the drive module 80 and are locked at the bottom of the cooling substrate 51 with screws, and the drive module 80 is locked on the drive brackets with screws.

[0036] The invention is used as follows: Referring to FIG. 3-FIG. 4, top wiring: the fasteners 160 are pulled outwards, the mounting plate 90 is disassembled, the power wire penetrates through the second water-proof ring 120, and the mounting plate 90 is fixed to a ceiling with expansion bolts; then, the power wire is connected to the first wiring terminal 93; and finally, the mounting plate 90 is inserted in the wiring plate 100, and the fasteners 160 are further fixed to the lampshade 10, such that power supply is realized.

[0037] Referring to FIG. 5-FIG. 6, side wiring: the end cover assembly 30 at the wiring end is unscrewed first, then the water-proof connector of the end cover assembly 30 is unscrewed, the rubber plug in the water-proof connector is taken out, and after that, the power wire penetrates through the water-proof connector and the cover and is connected to the wiring terminal at the corresponding end; after wiring is completed, the cover and the shell assembly 20 are screwed to be fixed; and finally, the water-proof connector is screwed to realize power supply.

[0038] Similarly, an adjacent tri-proof lamp can obtain power through the second wiring terminal 130 or the third wiring terminal 140 (that is, power is supplied from one terminal and comes out from the other terminal, and the next tri-proof lamp obtains power from the former tri-proof lamp), and the two adjacent tri-proof lamps are connected in parallel in this way.

[0039] One of the top wiring and the side wiring may be selected to effectively meet the requirements of different users.

[0040] Referring to FIG. 7-FIG. 10, replacement of internal components: the end cover assembly 30 at any one end is unscrewed first, then the corresponding pressing plate 170 is disassembled, the corresponding handle 151 is pulled outwards to pull the whole internal structure out, and the light source module 60, the microwave sensor

70 or the drive module 80 may be separately disassembled to be maintained or replaced.

[0041] The extrusion-type tri-proof lamp of the invention is provided with the slidable heat sink 50, and the light source module and the drive module are disposed on the heat sink 50, such that internal components can be pulled out to be replaced or maintained, and the whole lamp does not need to be discarded, thus effectively avoiding resource waste and reducing use cost for users; in addition, wiring on the back of the lampshade 10 is added, so that more wiring methods are provided for customers; and the power wire will not be seen after the lamp is assembled, such that the whole lamp is more beautiful.

Claims

1. An extrusion-type tri-proof lamp, comprising a lampshade (10), shell assemblies (20) disposed at two ends of the lampshade (10), and end cover assemblies (30) detachably mounted on the shell assemblies (20), wherein a slideway (40) and a heat sink (50) slidably connected to the slideway (40) are disposed in the lampshade (10), a light source module (60) and a drive module (80) are disposed on the heat sink (50), the light source module (60) is connected to the drive module (80), and the drive module (80) is connected to an external power source, **characterised in that** a wiring board (100) to be connected to the external power source and a mounting plate (90) fixedly connected to a mounting face are disposed on a back of the lampshade (10), the wiring board (100) is detachably connected to the mounting plate (90), a first water-proof ring (110) is disposed between the mounting plate (90) and the lampshade (10), the mounting plate (90) is provided with a wiring hole allowing a power wire to be connected thereto, and a second water-proof ring (120) is disposed in the wiring hole.
2. The extrusion-type tri-proof lamp according to Claim 1, wherein the mounting plate comprises a first base plate, the first base plate is provided with a first wiring socket and a first wiring terminal to be connected to the power wire, the first wiring terminal is connected to the first wiring socket through a wire, the wiring board comprises a second base plate, the second base plate is provided with a second wiring socket matched with the first wiring socket, the first wiring socket is connected to the second wiring socket in a pluggable manner, and the drive module is connected to the second wiring socket through a wire.
3. The extrusion-type tri-proof lamp according to Claim 2, wherein the first wiring socket comprises a PCB male pin connecting board fixed to a first board body, a male pin fixing base disposed on the PCB male pin connecting board, a male pin assembly disposed

in the male pin fixing base, and a male pin fixing gland covering the PCB male pin connecting board; and the second wiring socket comprises a PCB female pin connecting board fixed to a second board body, a female pin fixing base disposed on the PCB female pin connecting board, a female pin assembly disposed in the female pin fixing base, and a female pin fixing gland covering the PCB female pin connecting board.

4. The extrusion-type tri-proof lamp according to Claim 2, wherein a second wiring terminal and a third wiring terminal are disposed at two ends of the heat sink, and the drive module is connected to one of the first wiring terminal, the second wiring terminal and the third wiring terminal.
5. The extrusion-type tri-proof lamp according to Claim 4, wherein mounting brackets for mounting the second wiring terminal and the third wiring terminal are disposed at the two ends of the heat sink, and are provided with handles for users to pull the heat sink out.
6. The extrusion-type tri-proof lamp according to Claim 1, wherein the mounting plate is provided with fasteners, the lampshade is provided with fastening portions clamped on and matched with the fasteners, and after being connected to the wiring board, the mounting plate is clamped and fixed to the lampshade through the fasteners.
7. The extrusion-type tri-proof lamp according to Claim 1, wherein each of the end cover assemblies comprises a cover and a water-proof connector, the covers are provided with first wire holes allowing the power wire to penetrate through, the water-proof connectors are provided with second wire holes allowing the power wire to penetrate through, rubber plugs are disposed in the first wire holes, the water-proof connectors are detachably mounted on the covers, internal threads are disposed on inner walls of the shell assemblies, external threads matched with the internal threads are disposed on the covers, and the end cover assemblies and the shell assemblies are fixed or disassembled by screwing.
8. The extrusion-type tri-proof lamp according to Claim 1, wherein a pressing plate is disposed between each said shell assembly and the corresponding end cover assembly, and is fixedly connected to the shell assembly.
9. The extrusion-type tri-proof lamp according to Claim 1, wherein the heat sink is further provided with a microwave sensor connected to the drive module.
10. The extrusion-type tri-proof lamp according to Claim

9, wherein the heat sink comprises a cooling substrate, a first side plate and a second side plate, the first side plate and the second side plate are obliquely disposed at two ends of the cooling substrate and are slidably connected to the slideway, the light source assembly comprises a first light strip disposed on a surface of the cooling substrate, a second light strip disposed on a surface of the first side plate, and a third light strip disposed on the second side plate, the microwave sensor and the drive module are disposed at a bottom of the cooling substrate, and the cooling substrate is provided with a via hole for detecting the microwave sensor.

Patentansprüche

1. Dreifach-sichere Lampe vom Extrusionstyp, umfassend einen Lampenschirm (10), Schalenbaugruppen (20), die an zwei Enden des Lampenschirms (10) angeordnet sind, und Endabdeckungsbaugruppen (30), die abnehmbar an den Schalenbaugruppen (20) montiert sind, wobei im Lampenschirm (10) eine Gleitführung (40) und ein mit der Gleitführung (40) verschiebbar verbundener Kühlkörper (50) angeordnet sind, auf dem ein Lichtquellenmodul (60) und ein Antriebsmodul (80) auf dem Kühlkörper (50) angeordnet sind, das Lichtquellenmodul (60) ist mit dem Antriebsmodul (80) verbunden, und das Antriebsmodul (80) ist mit einer externen Stromquelle verbunden, **dadurch gekennzeichnet, dass** eine Verdrahtungsplatine (100), die an die externe Stromquelle angeschlossen werden soll und eine fest mit einer Montagefläche verbundene Montageplatte (90) auf einer Rückseite des Lampenschirms (10) angeordnet sind, die Verdrahtungsplatine (100) lösbar mit der Montageplatte (90) verbunden ist, ein erster wasserdichter Ring (110) ist zwischen der Montageplatte (90) und dem Lampenschirm (10) angeordnet, die Montageplatte (90) ist mit einem Kabelloch versehen, in das ein Stromkabel angeschlossen werden kann, und ein zweiter wasserdichter Ring (120) ist im Verkabelungsloch angeordnet.
2. Dreifach-sichere Lampe vom Extrusionstyp nach Anspruch 1, wobei die Montageplatte eine erste Basisplatte umfasst, die erste Basisplatte mit einer ersten Verdrahtungsbuchse und einem ersten Verdrahtungsanschluss zum Anschließen an das Stromkabel versehen ist, der erste Verdrahtungsanschluss ist über einen Draht mit der ersten Verdrahtungsbuchse verbunden. Die Verdrahtungsplatine umfasst eine zweite Grundplatte, die zweite Grundplatte ist mit einer zweiten Verdrahtungsbuchse versehen, die zur ersten Verdrahtungsbuchse passt, die erste Verdrahtungsbuchse ist mit der zweiten Verdrahtungsbuchse steckbar mit dem Antriebsmodul verbunden und das Antriebsmodul ist über ein

Kabel mit der zweiten Verdrahtungsbuchse verbunden.

3. Dreifach-sichere Lampe vom Extrusionstyp nach Anspruch 2, wobei die erste Verdrahtungsbuchse umfasst: eine PCB-Steckerstift-Verbindungsplatine, die an einem ersten Platinenkörper befestigt ist, eine auf der PCB-Steckerstift-Verbindungsplatine angeordnete Steckerstift-Befestigungsbasis, eine Steckerstiftbefestigungsdrüse, die in der Steckerstift-Befestigungsbasis angeordnet ist, und eine Steckerstift-Befestigungsstopfbuchse, die die Leiterplatte mit Steckerstift-Verbindungsplatine abdeckt; und die zweite Verdrahtungsbuchse umfasst: eine PCB-Buchsenstift-Verbindungsplatine, die an einem zweiten Platinenkörper befestigt ist, eine Buchsenstift-Befestigungsbasis, die auf der PCB-Buchsenstift-Verbindungsplatine angeordnet ist, eine Buchsenstiftanordnung, die in der Buchsenstift-Befestigungsbasis angeordnet ist, und eine Buchsenstift-Befestigungsstopfbuchse, die die Leiterplatte mit Steckerstift-Verbindungsplatine abdeckt
4. Dreifach-sichere Lampe vom Extrusionstyp nach Anspruch 2, wobei ein zweiter Verdrahtungsanschluss und ein dritter Verdrahtungsanschluss an zwei Enden des Kühlkörpers angeordnet sind und das Antriebsmodul mit einem des ersten Verdrahtungsanschlusses, des zweiten Verdrahtungsanschlusses und des dritten Verdrahtungsanschlusses verbunden ist.
5. Dreifach-sichere Lampe vom Extrusionstyp nach Anspruch 4, wobei Montagehalterungen zum Befestigen des zweiten Verdrahtungsanschlusses und des dritten Verdrahtungsanschlusses an den beiden Enden des Kühlkörpers angeordnet und mit Griffen versehen sind, damit Benutzer den Kühlkörper ziehen können.
6. Dreifach-sichere Lampe vom Extrusionstyp nach Anspruch 1, wobei die Montageplatte mit Befestigungselementen versehen ist, der Lampenschirm mit Befestigungsabschnitten versehen ist, die an den Befestigungselementen festgeklemmt und angepasst sind, und nach dem Verbinden mit der Verdrahtungsplatte die Montageplatte an dem Lampenschirm festgeklemmt und durch die Befestigungselemente am Lampenschirm befestigt wird.
7. Dreifach-sichere Lampe vom Extrusionstyp nach Anspruch 1, wobei jede der Endabdeckungsbaugruppen eine Abdeckung und einen wasserdichten Verbinder umfasst, wobei die Abdeckungen mit ersten Kabellöchern versehen sind, die es ermöglichen, dass das Stromkabel durch das Wasser dringen kann. Die wasserdichten Steckverbinder sind mit zweiten Kabellöchern versehen, die das Durchdrin-

gen des Stromkabels ermöglichen. Gummistopfen sind in den ersten Kabellöchern angeordnet. Die wasserdichten Steckverbinder sind abnehmbar an den Abdeckungen montiert. Innengewinde sind an den Innenwänden der Gehäusebaugruppen angebracht. Auf den Abdeckungen sind Außengewinde angebracht, die zu den Innengewinde passen, und die Endabdeckungsbaugruppen und die Schalenbaugruppen werden durch Schrauben befestigt oder demontiert.

8. Dreifach-sichere Lampe vom Extrusionstyp nach Anspruch 1, wobei zwischen jeder Gehäusebaugruppe und der entsprechenden Endabdeckungsbaugruppe eine Pressplatte angeordnet und fest mit der Gehäusebaugruppe verbunden ist.
9. Dreifach-sichere Lampe vom Extrusionstyp nach Anspruch 1, wobei der Kühlkörper außerdem mit einem Mikrowellensensor ausgestattet ist, der mit dem Antriebsmodul verbunden ist.
10. Dreifach-sichere Lampe vom Extrusionstyp nach Anspruch 9, wobei der Kühlkörper ein Kühlsubstrat, eine erste Seitenplatte und eine zweite Seitenplatte umfasst, wobei die erste Seitenplatte und die zweite Seitenplatte an zwei Enden davon schräg angeordnet sind. Das Kühlsubstrat ist verschiebbar und mit der Gleitführung verbunden. Die Lichtquellenbaugruppe umfasst einen ersten Lichtstreifen, der auf einer Oberfläche des Kühlsubstrats angeordnet ist, einen zweiten Lichtstreifen, der auf einer Oberfläche der ersten Seitenplatte angeordnet ist, und einen dritten Lichtstreifen, an der zweite Seitenplatte darauf angeordnet ist, der Mikrowellensensor und das Antriebsmodul sind an der Unterseite des Kühlsubstrats angeordnet, und das Kühlsubstrat ist mit einem Durchgangsloch zur Erkennung des Mikrowellensensors versehen.

Revendications

1. Lampe tri-résistante de type extrusion, comprenant un abat-jour (10), des ensembles coques (20) disposés aux deux extrémités de l'abat-jour (10), et des ensembles couvercles d'extrémité (30) montés de manière amovible sur les ensembles coques (20), dans lequel une glissière (40) et un dissipateur thermique (50) relié de manière coulissante à la glissière (40) sont disposés dans l'abat-jour (10), un module de source de lumière (60) et un module de commande (80) sont disposés sur le dissipateur thermique (50), le module de source de lumière (60) est connecté au module de commande (80) et le module de commande (80) est connecté à une source d'alimentation externe, **caractérisé en ce qu'**un tableau de câblage (100) devant être connecté à la source d'ali-

- mentation externe et une plaque de montage (90) reliée de manière fixe à une face de montage sont disposées sur un dos de l'abat-jour (10), le tableau de câblage (100) est connecté de manière amovible à la plaque de montage (90), une première un anneau étanche (110) est disposé entre la plaque de montage (90) et l'abat-jour (10), la plaque de montage (90) est dotée d'un trou de câblage permettant à un fil d'alimentation d'y être connecté, et un deuxième anneau étanche (120) est disposé dans le trou de câblage.
2. Lampe tri-résistante de type extrusion selon la revendication 1, dans laquelle la plaque de montage comprend une première plaque de base, la première plaque de base est dotée d'une première prise de câblage et d'une première borne de câblage à connecter au fil d'alimentation, la première borne de câblage est connectée à la première prise de câblage par l'intermédiaire d'un fil, le tableau de câblage comprend une seconde plaque de base, la seconde plaque de base est dotée d'une seconde prise de câblage adaptée à la première prise de câblage, la première prise de câblage est connectée à la seconde prise de câblage de manière enfichable, et le module de commande est connecté à la seconde prise de câblage par l'intermédiaire d'un fil.
 3. Lampe tri-résistante de type extrusion selon la revendication 2, dans laquelle la première prise de câblage comprend une carte de connexion à broche mâle PCB fixée à un premier corps de carte, une base de fixation de broche mâle disposée sur la carte de connexion à broche mâle PCB, un connecteur mâle un ensemble broche disposé dans la base de fixation de broche mâle, et un presse-étoupe de fixation de broche mâle recouvrant la carte de connexion de broche mâle de PCB ; et la seconde prise de câblage comprend une carte de connexion à broche femelle de PCB fixée à un second corps de carte, une base de fixation de broche femelle disposée sur la carte de connexion de broche femelle de PCB, un ensemble broche femelle disposé dans la base de fixation de broche femelle, et une fixation de broche femelle. presse-étoupe recouvrant la carte de connexion de la broche femelle du PCB.
 4. Lampe tri-résistante de type extrusion selon la revendication 2, dans laquelle une deuxième borne de câblage et une troisième borne de câblage sont disposées aux deux extrémités du dissipateur thermique, et le module de commande est connecté à l'une de la première borne de câblage, la deuxième borne de câblage et la troisième borne de câblage.
 5. Lampe tri-résistante de type extrusion selon la revendication 4, dans laquelle des supports de montage pour monter la deuxième borne de câblage et la troisième borne de câblage sont disposés aux deux extrémités du dissipateur thermique et sont pourvus de poignées permettant aux utilisateurs de tirer le dissipateur thermique.
 6. Lampe tri-résistante de type extrusion selon la revendication 1, dans laquelle la plaque de montage est munie de fixations, l'abat-jour est pourvu de parties de fixation serrées et adaptées aux fixations, et après avoir été connecté au tableau de câblage, la plaque de montage est serrée et fixée à l'abat-jour grâce aux attaches.
 7. Lampe tri-résistante de type extrusion selon la revendication 1, dans laquelle chacun des ensembles de couvercles d'extrémité comprend un couvercle et un connecteur étanche à l'eau, les couvercles sont pourvus de premiers trous pour fil permettant au fil d'alimentation de pénétrer à travers, l'eau des connecteurs étanches sont pourvus de seconds trous pour fils permettant au fil d'alimentation de pénétrer à travers, des bouchons en caoutchouc sont disposés dans les premiers trous pour fils, les connecteurs étanches sont montés de manière amovible sur les couvercles, des filetages internes sont disposés sur les parois internes des ensembles coques, des filetages externes correspondant aux filetages internes sont disposés sur les couvercles, et les ensembles couvercles d'extrémité et les ensembles coques sont fixés ou démontés par vissage.
 8. Lampe tri-épreuve du type à extrusion selon la revendication 1, dans laquelle une plaque de pression est disposée entre chaque dit ensemble coque et l'ensemble couvercle d'extrémité correspondant et est reliée de manière fixe à l'ensemble coque
 9. Lampe tri-résistante de type extrusion selon la revendication 1, dans laquelle le dissipateur thermique est en outre pourvu d'un capteur micro-ondes connecté au module de commande.
 10. Lampe tri-résistante de type extrusion selon la revendication 9, dans laquelle le dissipateur thermique comprend un substrat de refroidissement, une première plaque latérale et une seconde plaque latérale, la première plaque latérale et la seconde plaque latérale sont disposées obliquement aux deux extrémités du substrat de refroidissement et sont reliées de manière coulissante à la glissière, l'ensemble source de lumière comprend une première bande lumineuse disposée sur une surface du substrat de refroidissement, une deuxième bande lumineuse disposée sur une surface de la première plaque latérale, et une troisième bande lumineuse disposée sur la seconde plaque latérale, le capteur micro-ondes et le module de commande sont disposés au fond du substrat de refroidissement, et le substrat

de refroidissement est pourvu d'un trou traversant pour détecter le capteur micro-ondes.

5

10

15

20

25

30

35

40

45

50

55

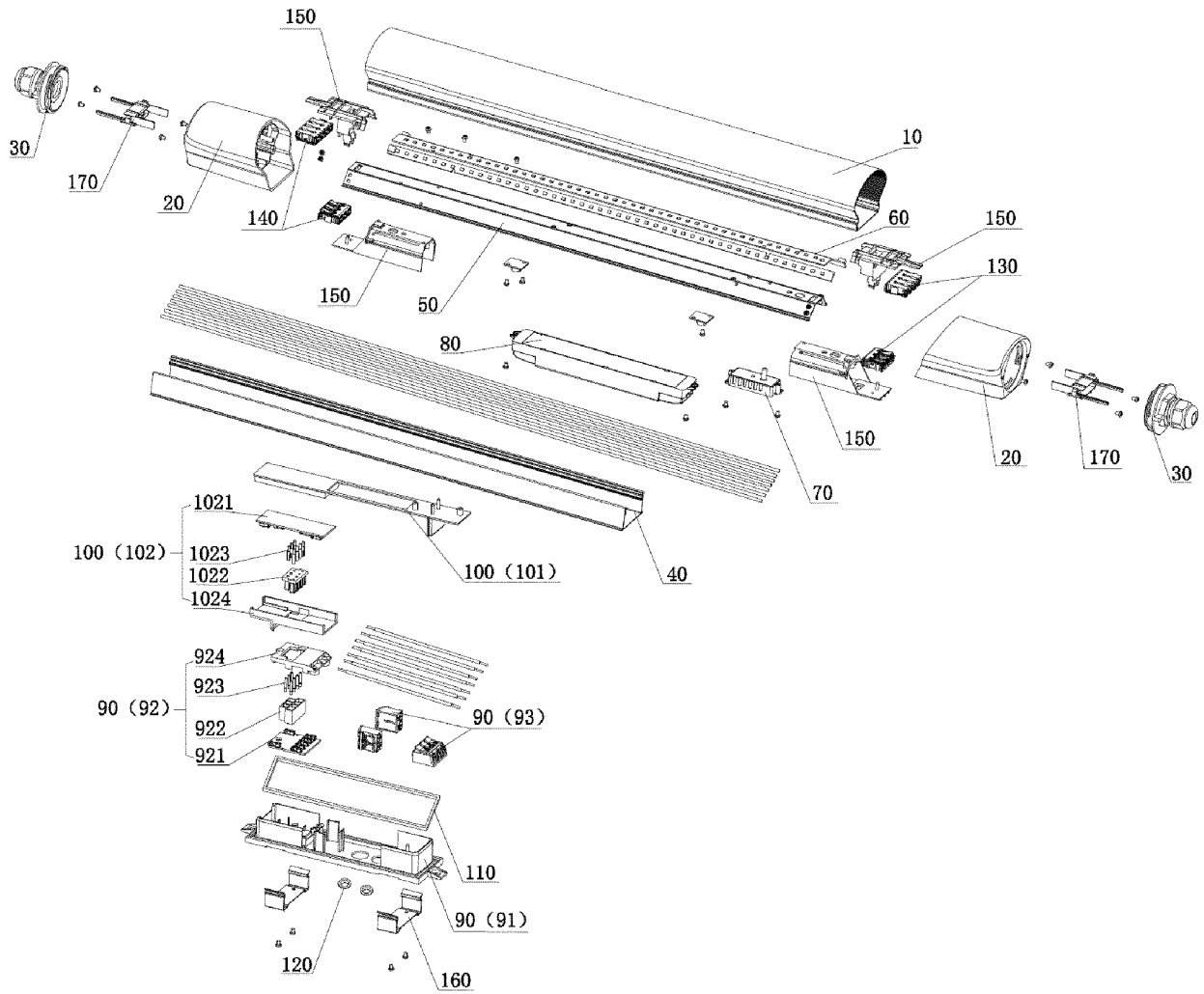

FIG. 1

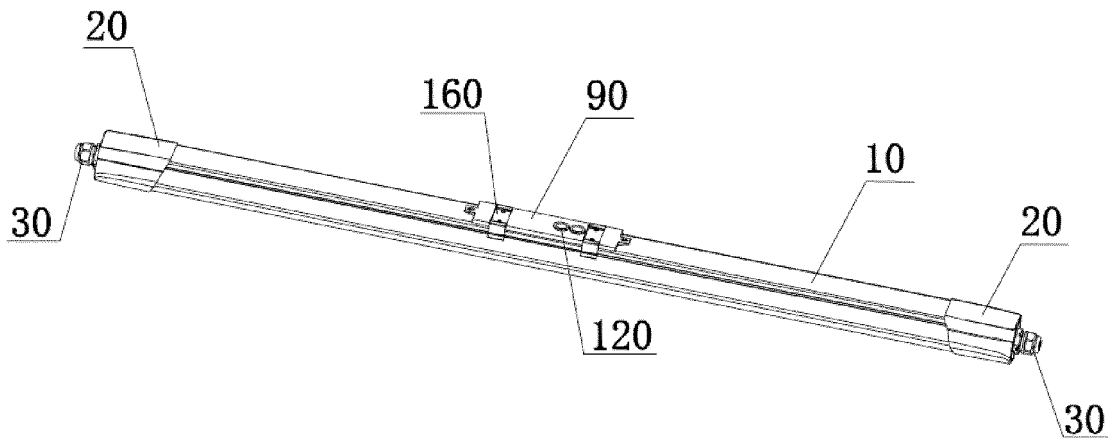

FIG. 2

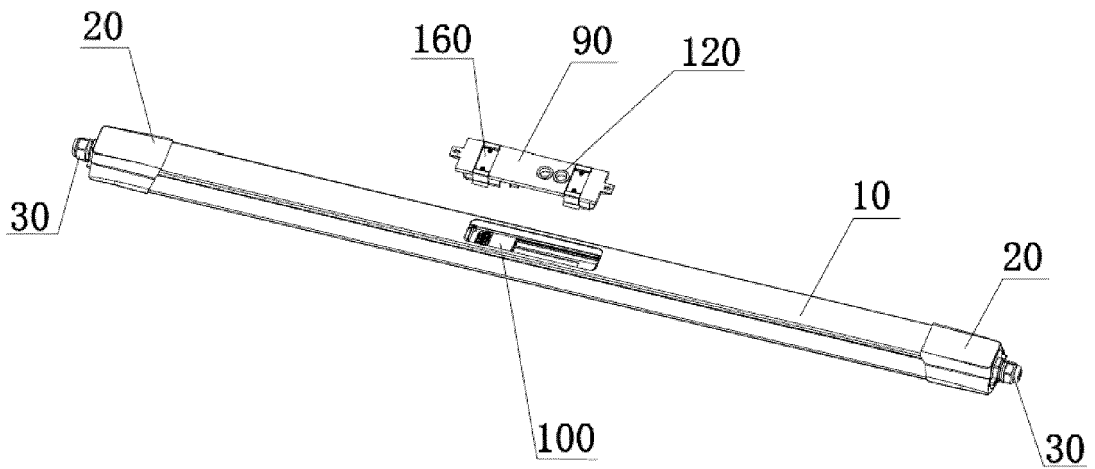

FIG. 3

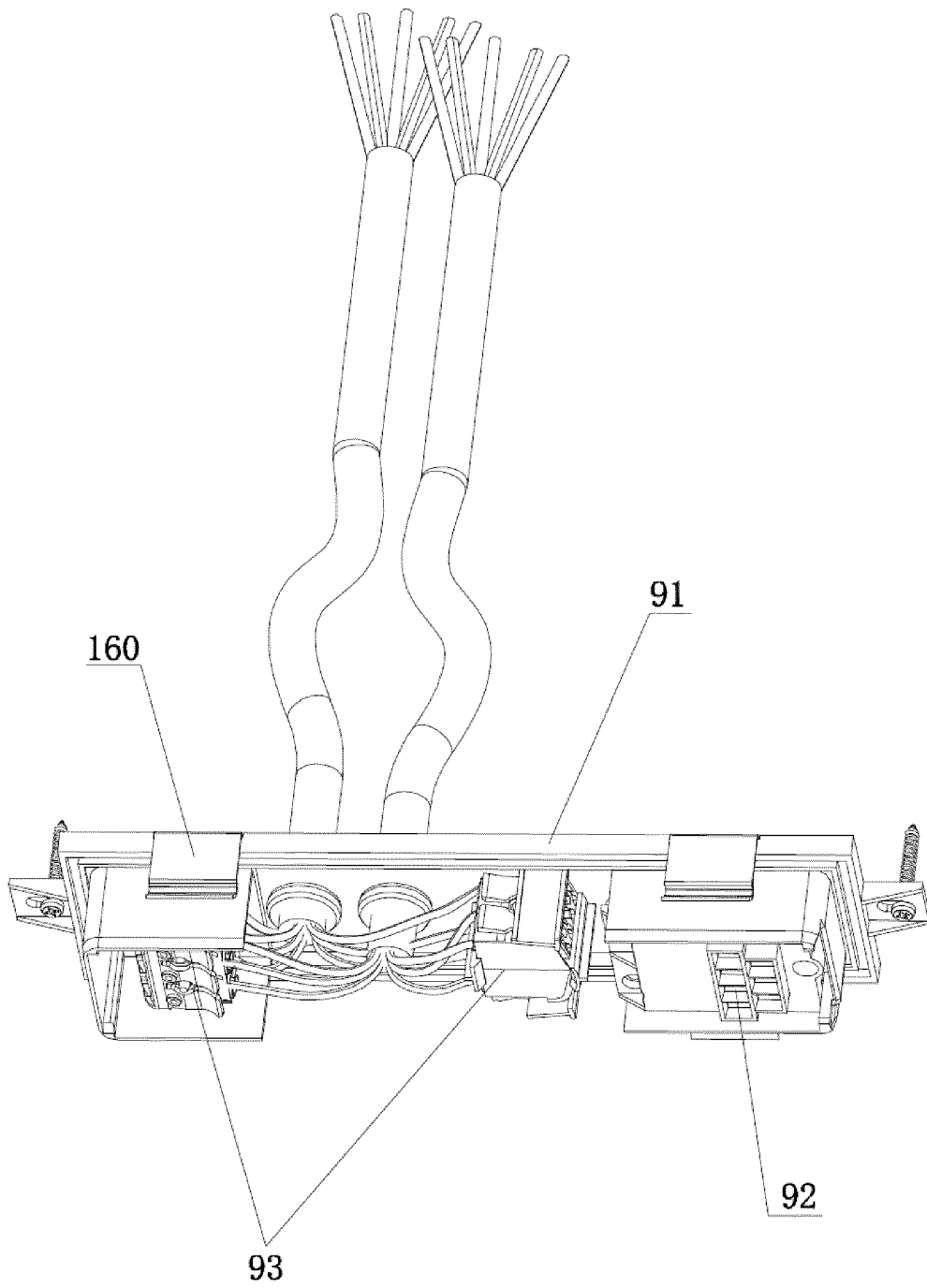

FIG. 4

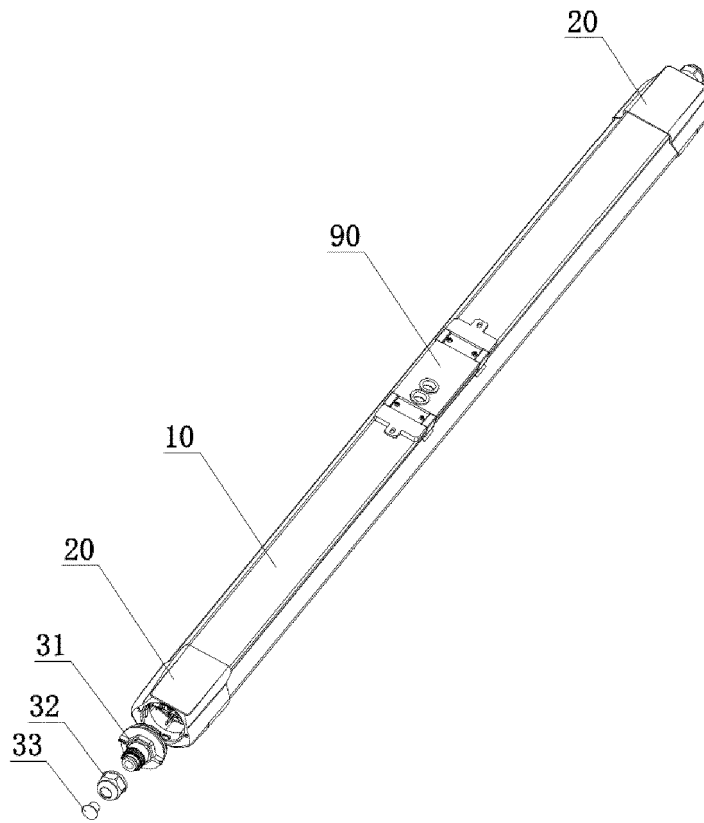

FIG. 5

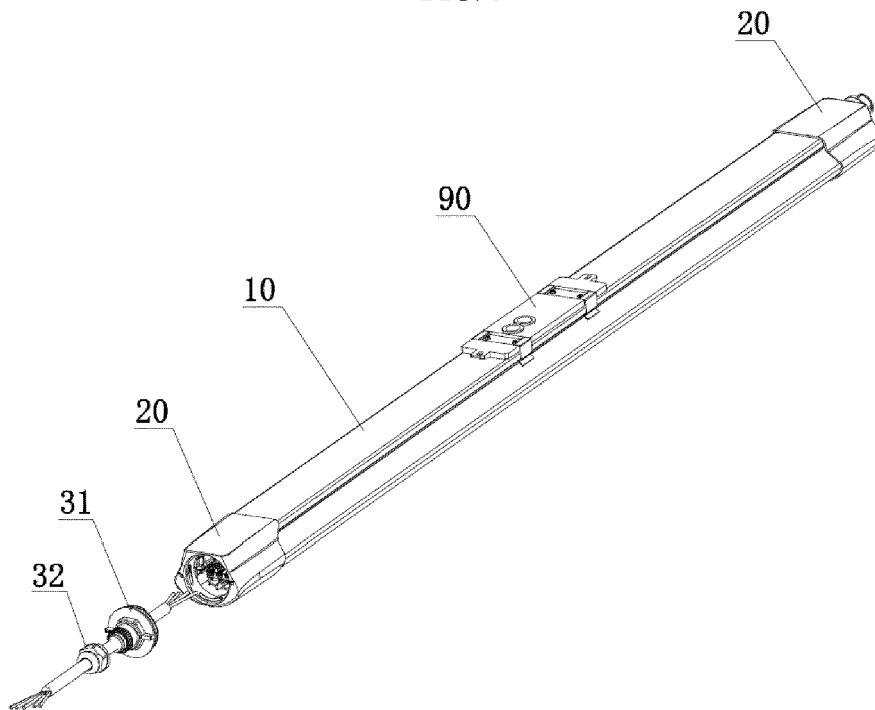

FIG. 6

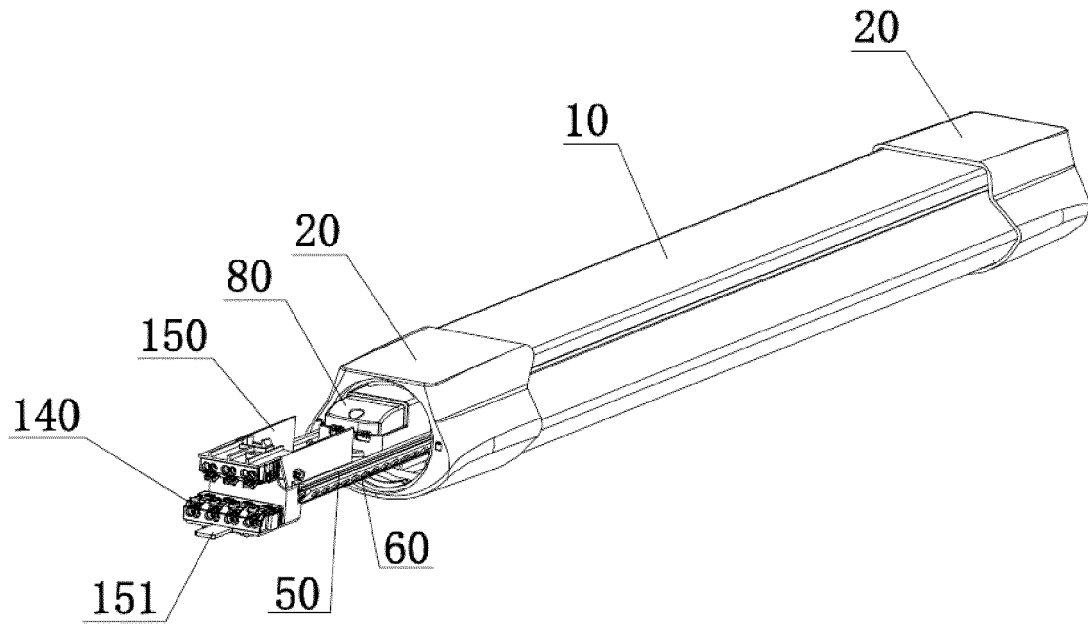

FIG. 7

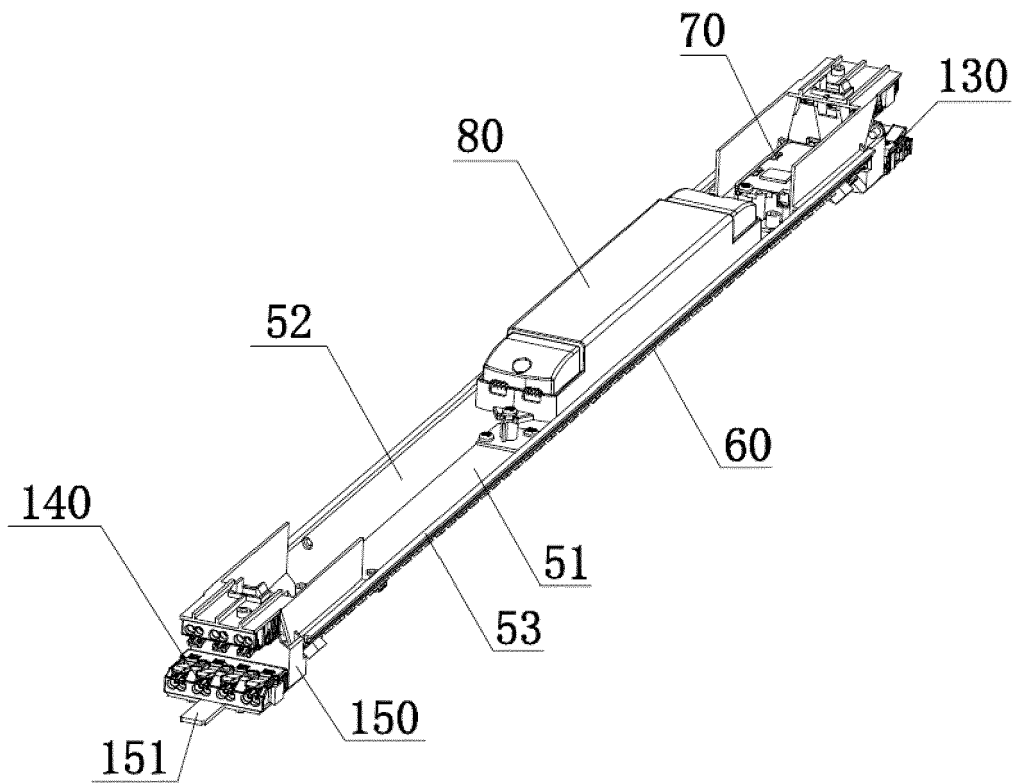

FIG. 8

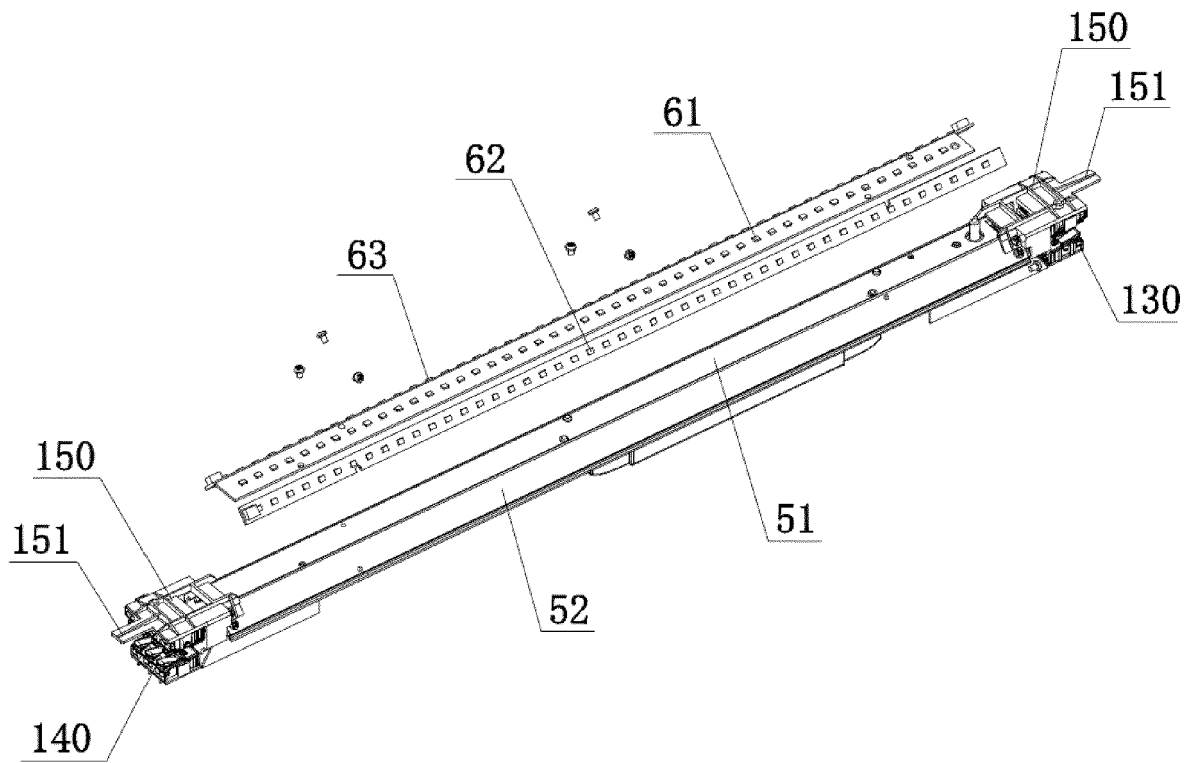

FIG. 9

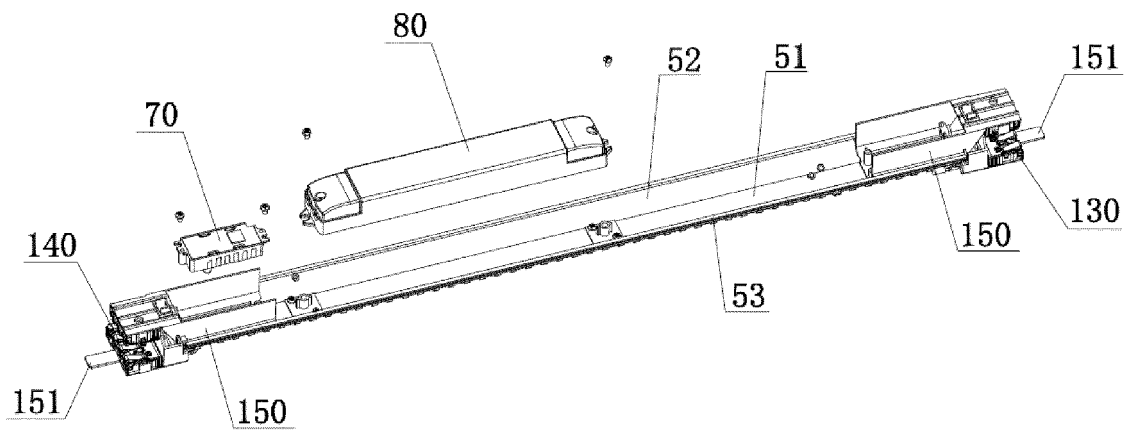

FIG. 10

REFERENCES CITED IN THE DESCRIPTION

This list of references cited by the applicant is for the reader's convenience only. It does not form part of the European patent document. Even though great care has been taken in compiling the references, errors or omissions cannot be excluded and the EPO disclaims all liability in this regard.

Patent documents cited in the description

- EP 3179164 A1 [0003]