



(12)

EUROPEAN PATENT APPLICATION

- (88)

Date of publication A3:
29.05.2024 Bulletin 2024/22
- (51)

International Patent Classification (IPC):
E04F 10/06^(2006.01)
- (43)

Date of publication A2:
13.03.2024 Bulletin 2024/11
- (52)

Cooperative Patent Classification (CPC):
E04F 10/0662; E04F 10/0685
- (21)

Application number: 23192666.8
- (22)

Date of filing: 22.08.2023

- (84)

Designated Contracting States:
AL AT BE BG CH CY CZ DE DK EE ES FI FR GB
GR HR HU IE IS IT LI LT LU LV MC ME MK MT NL
NO PL PT RO RS SE SI SK SM TR
Designated Extension States:
BA
Designated Validation States:
KH MA MD TN
- (72)

Inventors:
 - COUCKE, Davy
8530 Harelbeke (BE)
 - DE MAEYER, Erik
8810 Lichtervelde (BE)
 - ENGELS, Pieter
8500 Kortrijk (BE)
 - SCHURM, Shane
8560 Wevelgem (BE)
- (30)

Priority: 23.08.2022 EP 22191684
- (74)

Representative: Wallentin, Lars
Thule AB
Fosievägen 13
214 31 Malmö (SE)
- (71)

Applicant: Thule NV
8930 Menen (BE)

(54)

AWNING FIXATION, AWNING ACCESSORY AND AWNING ARRANGEMENTS

- (57)

The present disclosure relates to awning systems and components of awning systems, for example of crank operated awning systems, in particular to awnings comprising a stowage configuration for stowing ac-
- cessory parts such as a crank handle or a tensioning bar and to a quick coupling mechanism and release mechanism for awnings for mounting them on a vehicle.

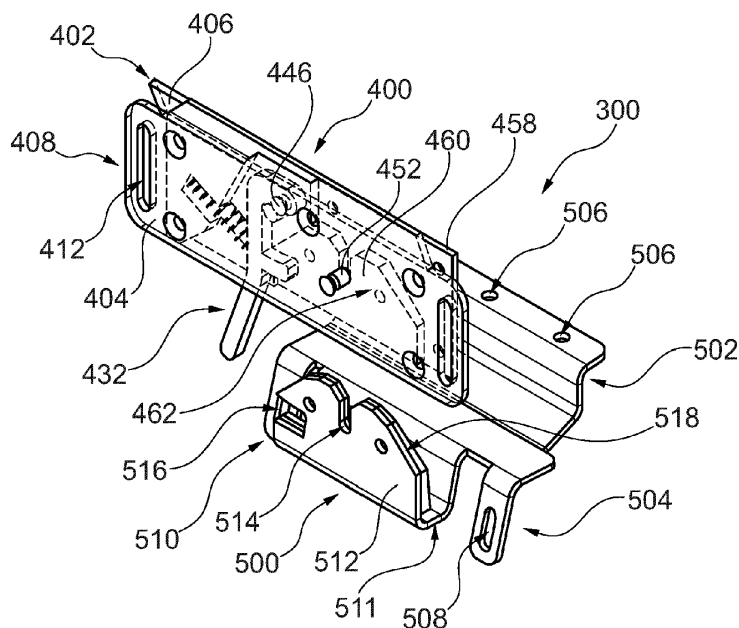

Fig. 16



EUROPEAN SEARCH REPORT

Application Number

EP 23 19 2666

5

10

15

20

25

30

35

40

45

50

55

1

EPO FORM 1503 03.82 (P04C01)

DOCUMENTS CONSIDERED TO BE RELEVANT			
Category	Citation of document with indication, where appropriate, of relevant passages	Relevant to claim	CLASSIFICATION OF THE APPLICATION (IPC)
X	EP 2 351 895 A2 (ERHARDT MARKISENBAU GMBH [DE]) 3 August 2011 (2011-08-03) * figures 1-5 * * paragraphs [0001] - [0004], [0014], [0015], [0017] - [0021], [0023], [0024] *	1-7	INV. E04F10/06
A	US 2019/301166 A1 (THOMPSON SCOTT PATRICK [US] ET AL) 3 October 2019 (2019-10-03) * figures 2A, 2B, 4A, 4B, 5, 6A-6F * * paragraphs [0004], [0005], [0054], [0056], [0057], [0065] - [0067] *	1-7	
			TECHNICAL FIELDS SEARCHED (IPC)
			E04F
The present search report has been drawn up for all claims			
Place of search The Hague		Date of completion of the search 29 January 2024	Examiner Tänzler, Ansgar
CATEGORY OF CITED DOCUMENTS X : particularly relevant if taken alone Y : particularly relevant if combined with another document of the same category A : technological background O : non-written disclosure P : intermediate document		T : theory or principle underlying the invention E : earlier patent document, but published on, or after the filing date D : document cited in the application L : document cited for other reasons & : member of the same patent family, corresponding document	



Application Number

EP 23 19 2666

5

10

15

20

25

30

35

40

45

50

55

CLAIMS INCURRING FEES

The present European patent application comprised at the time of filing claims for which payment was due.

☐ Only part of the claims have been paid within the prescribed time limit. The present European search report has been drawn up for those claims for which no payment was due and for those claims for which claims fees have been paid, namely claim(s):

☐ No claims fees have been paid within the prescribed time limit. The present European search report has been drawn up for those claims for which no payment was due.

LACK OF UNITY OF INVENTION

The Search Division considers that the present European patent application does not comply with the requirements of unity of invention and relates to several inventions or groups of inventions, namely:

see sheet B

☐ All further search fees have been paid within the fixed time limit. The present European search report has been drawn up for all claims.

☐ As all searchable claims could be searched without effort justifying an additional fee, the Search Division did not invite payment of any additional fee.

☐ Only part of the further search fees have been paid within the fixed time limit. The present European search report has been drawn up for those parts of the European patent application which relate to the inventions in respect of which search fees have been paid, namely claims:

☒ None of the further search fees have been paid within the fixed time limit. The present European search report has been drawn up for those parts of the European patent application which relate to the invention first mentioned in the claims, namely claims:

1-7

☐ The present supplementary European search report has been drawn up for those parts of the European patent application which relate to the invention first mentioned in the claims (Rule 164 (1) EPC).



**LACK OF UNITY OF INVENTION
SHEET B**

Application Number

EP 23 19 2666

5

10

15

20

25

30

35

40

45

50

55

The Search Division considers that the present European patent application does not comply with the requirements of unity of invention and relates to several inventions or groups of inventions, namely:

1. claims: 1-7

Awning bracket

2. claim: 8

Awning

3. claims: 9, 11

Carrying structure

4. claim: 10

Securing device

ANNEX TO THE EUROPEAN SEARCH REPORT
ON EUROPEAN PATENT APPLICATION NO.

EP 23 19 2666

5 This annex lists the patent family members relating to the patent documents cited in the above-mentioned European search report.
The members are as contained in the European Patent Office EDP file on
The European Patent Office is in no way liable for these particulars which are merely given for the purpose of information.

29-01-2024

10	Patent document cited in search report	Publication date	Patent family member(s)	Publication date
	EP 2351895 A2	03-08-2011	DE 102009042686 B3 EP 2351895 A2	17-02-2011 03-08-2011
15	US 2019301166 A1	03-10-2019	US 2019301166 A1 US 2021164231 A1	03-10-2019 03-06-2021
20				
25				
30				
35				
40				
45				
50				
55				

EPO FORM P0459

For more details about this annex : see Official Journal of the European Patent Office, No. 12/82