

(12) **EUROPEAN PATENT APPLICATION**

(43) Date of publication:
12.06.2024 Bulletin 2024/24

(51) International Patent Classification (IPC):
E03D 11/02 ^(2006.01) **E03C 1/01** ^(2006.01)
E03D 13/00 ^(2006.01)

(21) Application number: **23211587.3**

(52) Cooperative Patent Classification (CPC):
E03D 11/025; E03C 1/01; E03D 13/00

(22) Date of filing: **22.11.2023**

(84) Designated Contracting States:
**AL AT BE BG CH CY CZ DE DK EE ES FI FR GB
 GR HR HU IE IS IT LI LT LU LV MC ME MK MT NL
 NO PL PT RO RS SE SI SK SM TR**
 Designated Extension States:
BA
 Designated Validation States:
KH MA MD TN

(71) Applicant: **Obemeasor, Donald**
Phoenix, AZ 85040 (US)

(72) Inventor: **Obemeasor, Donald**
Phoenix, AZ 85040 (US)

(74) Representative: **London IP Ltd**
100 High street
Milford on Sea
Lymington, Hampshire SO41 0QE (GB)

(30) Priority: 09.12.2022 US 202263475770 P
20.07.2023 US 202318224436

(54) **WATER DISPENSING UNISEX URINAL FUNNEL FOR A TOILET AND METHOD THEREFOR**

(57) A toilet funneling device has a funnel. A waste tubing has a first end coupled to a bottom area of the funnel and a second end for dispensing contents from

the funnel into a toilet bowl. A water line is coupled to the funnel supplying water to an interior of the funnel.

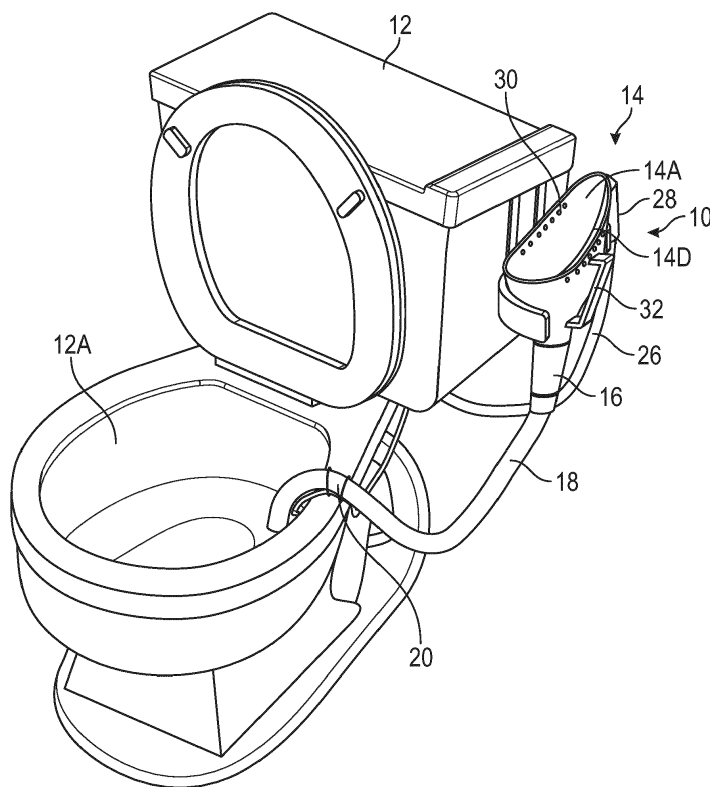

FIG. 1

Description

TECHNICAL FIELD

[0001] The present application in general relates to toilets, and more specifically, to a self-cleaning device for funneling urine from a person standing adjacent to a toilet into the toilet bowl of the toilet.

BACKGROUND

[0002] When using a toilet, either public or private, it is common for men to stand to urinate. Even some women, when using a public toilet may squat above the toilet bowl to urinate for sanitary reasons. However, when standing or squatting above the toilet bowl to urinate, there may be a tendency for the urine to miss the interior of the toilet bowl. This may cause the urine to fall onto the floor and walls around the toilet being used. Even if the urine reaches the interior of the toilet bowl, the urine may splash against the water. This may cause the urine water mixture to hit the toilet seat, floor and walls surrounding the toilet being used.

[0003] Thus, many toilets may have urine splattered around the toilet seat, floors and walls surrounding the toilet. This splattering urine may create unpleasant odors around the general area of the toilet. The splattering of urine is further unsanitary.

[0004] Therefore, it would be desirable to provide a system and method that overcomes the above. The system and method would be able to funnel urine into the toilet bowl thereby preventing the splattering of urine when people stand or squat above the toilet bowl.

SUMMARY

[0005] In accordance with one embodiment, a toilet funneling device is disclosed. The toilet funneling device has a funnel. A waste tubing has a first end coupled to a bottom area of the funnel and a second end for dispensing contents from the funnel into a toilet bowl. A water line is coupled to the funnel supplying water to an interior of the funnel.

[0006] In accordance with one embodiment, a toilet funneling device is disclosed. The toilet funneling device has a funnel. The funnel has an open top area. A side wall extends down from the open top area. A rear area of the side wall extends upward. A bottom area of the side wall curves inwards towards a bottom opening. An inner channel is formed around an interior perimeter of a top opening in the funnel. A plurality of openings is formed through an interior of the funnel and into the interior channel. A waste tubing has a first end coupled to the bottom opening of the funnel and a second end for dispensing contents from the funnel into a toilet bowl. A water line is coupled to the inner channel supplying water to the interior of the funnel.

[0007] In accordance with one embodiment, a toilet

funneling device is disclosed. The toilet funneling device has a funnel. A waste tubing has a first end coupled to a bottom area of the funnel and a second end for dispensing contents from the funnel into a toilet bowl. A channeling is coupled to the bottom end of the funnel and to the waste tubing. A water line is coupled to the funnel supplying water to an interior of the funnel. A water release valve is coupled to the funnel and the water line dispensing the water to the interior of the funnel.

BRIEF DESCRIPTION OF THE DRAWINGS

[0008] The present application is further detailed with respect to the following drawings. These figures are not intended to limit the scope of the present invention but rather illustrate certain attributes thereof.

FIG. 1 is a perspective view of an exemplary toilet funneling device in accordance with one aspect of the present application;

FIG. 2 is an exploded view of the exemplary toilet funneling device shown in **FIG. 1** according to one aspect of the present application;

FIG. 3 is a perspective view of an exemplary funnel of the toilet funneling device shown in **FIG. 1** in accordance with one aspect of the present application.

DESCRIPTION OF THE APPLICATION

[0009] The description set forth below in connection with the appended drawings is intended as a description of presently preferred embodiments of the disclosure and is not intended to represent the only forms in which the present disclosure can be constructed and/or utilized.

The description sets forth the functions and the sequence of steps for constructing and operating the disclosure in connection with the illustrated embodiments. It is to be understood, however, that the same or equivalent functions and sequences can be accomplished by different embodiments that are also intended to be encompassed within the spirit and scope of this disclosure.

[0010] Embodiments of the exemplary device and method relate to a device for funneling urine from a person standing adjacent to a toilet into the toilet bowl of the toilet. The device is self-cleaning and washes the urine from the device into the toilet bowl.

[0011] Referring to Figs 1-3, a device 10 for funneling urine into a toilet bowl 12A of a toilet 12 may be shown. The device 10 may be self-cleaning. The device 10 may be coupled to a water source of the toilet 12 allowing water to wash the device 10 and to move the urine from the device 10 into the toilet bowl 12A as may be described below.

[0012] The device 10 may have a funnel 14. The funnel 14 has an open top area 14A. The open top area 14A may be used to urinate into the funnel 14. A side wall 14B may extend down from the open top area 14A. A rear area 14B' of the side wall 14B may extend upward

to better capture the urine within the interior of the funnel 14. A bottom area of the side walls 14B may be curved inwards towards a bottom opening 14C. The bottom opening 14C may be used for draining the urine from the funnel 14.

[0013] A channeling 16 may have a first end attached to the bottom opening 14C. The channeling 16 may be inward sloping to aid in the draining of the urine from the funnel 14. A second end of the channeling 16 may be coupled to a first end of a waste tube 18. A second end of the waste tube 18 may drain into the toilet bowl 12A allowing the urine from the funnel 14 to drain into the toilet bowl 12A.

[0014] The device 10 may have a clip 20. The clip 20 may be used to secure the waste tube 18 to the toilet bowl 12A. More specifically, the clip 20 may be used to ensure that the second end of the waste tube 18 is directed into the toilet bowl 12A.

[0015] The funnel 14 may be coupled to a water supply. The water from the water supply may be used to rinse the urine down and out of the funnel 14 as well as wash the funnel 14 after use for hygiene reasons. In accordance with one embodiment, the funnel 14 may be coupled to the water supply of the toilet 12. In this embodiment, the device 10 may use a dual headed water valve 22. An inlet of the dual headed water valve 22 may be attached to a water supply line. A first outlet valve of the dual headed water valve 22 may be coupled to a waterline 24 which supplies water to the toilet 12. A second outlet of the dual headed water valve 22 may be coupled to a waterline 26 which is coupled to the funnel 14.

[0016] In accordance with one embodiment, the funnel 14 may have a water release valve 28 coupled to the waterline 26. When the water release valve 28 is activated, water may flow through the waterline 26, through the water release valve 28 and into the interior of the funnel 14 aiding in the flow of the urine from the funnel 14 into the toilet bowl 12A and sanitizing the funnel 14, channeling 16, and waste tube 18.

[0017] In accordance with one embodiment, the funnel 14 may have an interior channel 14D. The interior channel 14D may be formed around an inner perimeter of the open top area 14A. A plurality of openings 30 may be formed through the interior of the funnel 14 and into the interior channel 14D. The water release valve 28 may have an inlet in fluid communication with the interior channel 14D. When a handle of the water release valve 28 is depressed, water may flow through from the waterline 26, through the water release valve 28 and into the interior of the funnel 14 aiding in the flow of the urine from the funnel 14 into the toilet bowl 12A and sanitizing the funnel 14, channeling 16, and waste tube 18.

[0018] In accordance with one embodiment, the funnel 14 may have a handle 32 formed on an exterior surface of the funnel 14. The handle 32 may be used to allow a user to hold the funnel 14 while in use.

[0019] The device 10 may have a holding unit 34. The holding unit 34 may be used to removably secure the

funnel 14 to the toilet 12. In accordance with one embodiment, the holding unit 34 may be used to secure the funnel 14 to the toilet 12 when the funnel 14 is not being used. The user may then use the handle 32 to lift and remove the funnel 14 from the holding unit 34 for use. After the user has urinated in the funnel 14, the user may press the handle of the water release valve 28 so that water flows into the interior of the funnel 14 in order to aid in the flow of the urine from the funnel 14 into the toilet bowl 12A and sanitizing the funnel 14, channeling 16, and waste tube 18.

[0020] The foregoing description is illustrative of particular embodiments of the invention but is not meant to be a limitation upon the practice thereof. The following claims, including all equivalents thereof, are intended to define the scope of the invention.

Claims

1. A toilet funneling device, comprising:
 - a funnel;
 - a waste tubing having a first end coupled to a bottom area of the funnel and a second end for dispensing contents from the funnel into a toilet bowl; and
 - a water line coupled to the funnel supplying water to an interior of the funnel.
2. The toilet funneling device of Claim 1, comprising a water release valve coupled to the funnel and the water line dispensing the water to the interior of the funnel.
3. The toilet funneling device of Claim 1 or 2, comprising:
 - an inner channel formed around an interior perimeter of a top opening in the funnel;
 - a plurality of opening formed in formed through an interior of the funnel and into the interior channel; and
 - a water release valve in fluid communication with the interior channel.
4. The toilet funneling device of any preceding Claim, comprising a clip securing the second end of the waste tubing to the toilet bowl.
5. The toilet funneling device of any preceding Claim, comprising a handle coupled to an exterior surface of the funnel.
6. The toilet funneling device of any preceding Claim, comprising a holding unit securing the funnel to a toilet.

7. The toilet funneling device of any preceding Claim, comprising a channeling coupled to the bottom end of the funnel and to the waste tubing.

8. The toilet funneling device of any preceding Claim, wherein the funnel comprises:

an open top area; and

a side wall extending down from the open top area, wherein a rear area of the side wall extends upward, a bottom area of the side wall curves inwards towards a bottom opening.

15

20

25

30

35

40

45

50

55

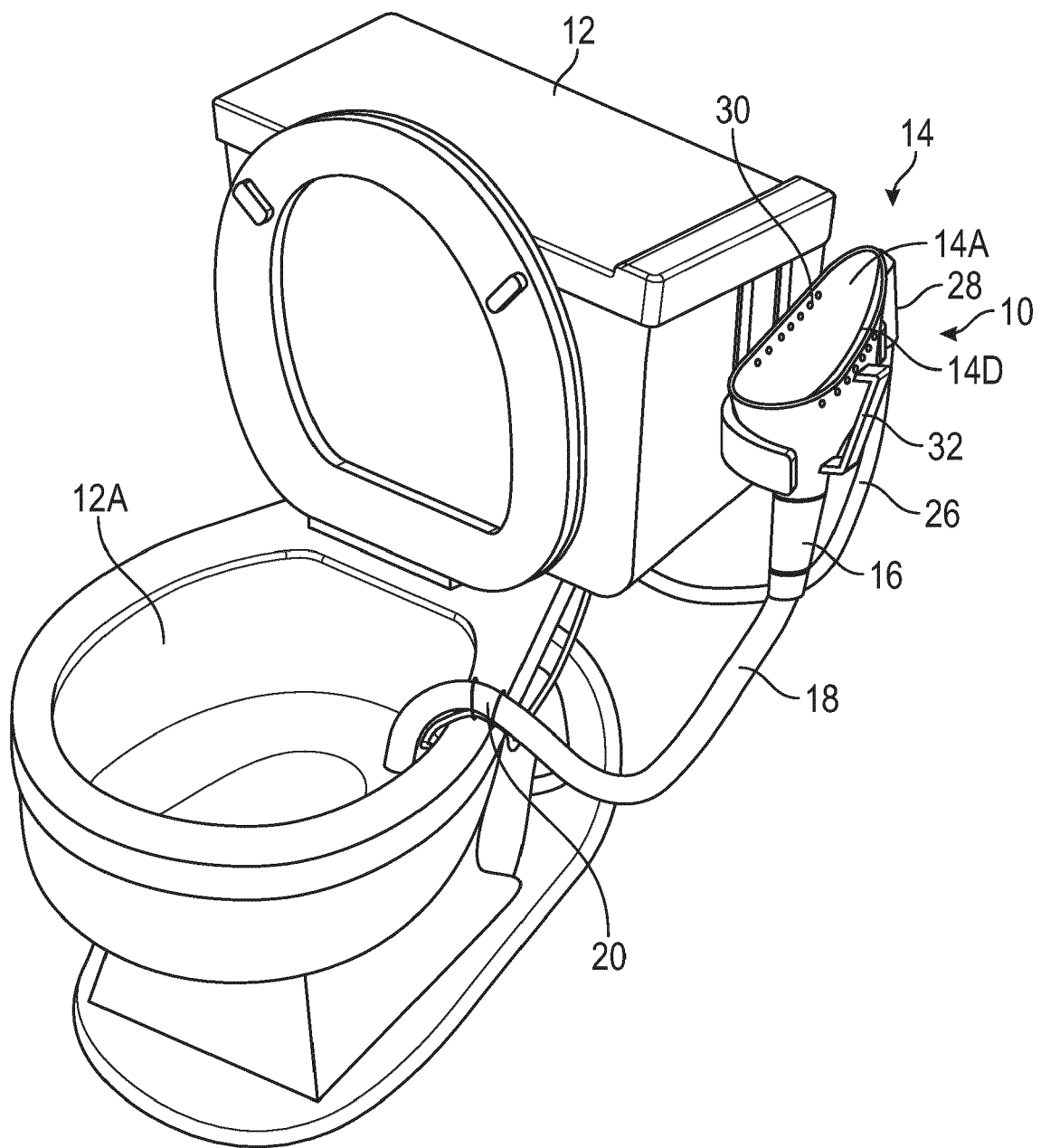
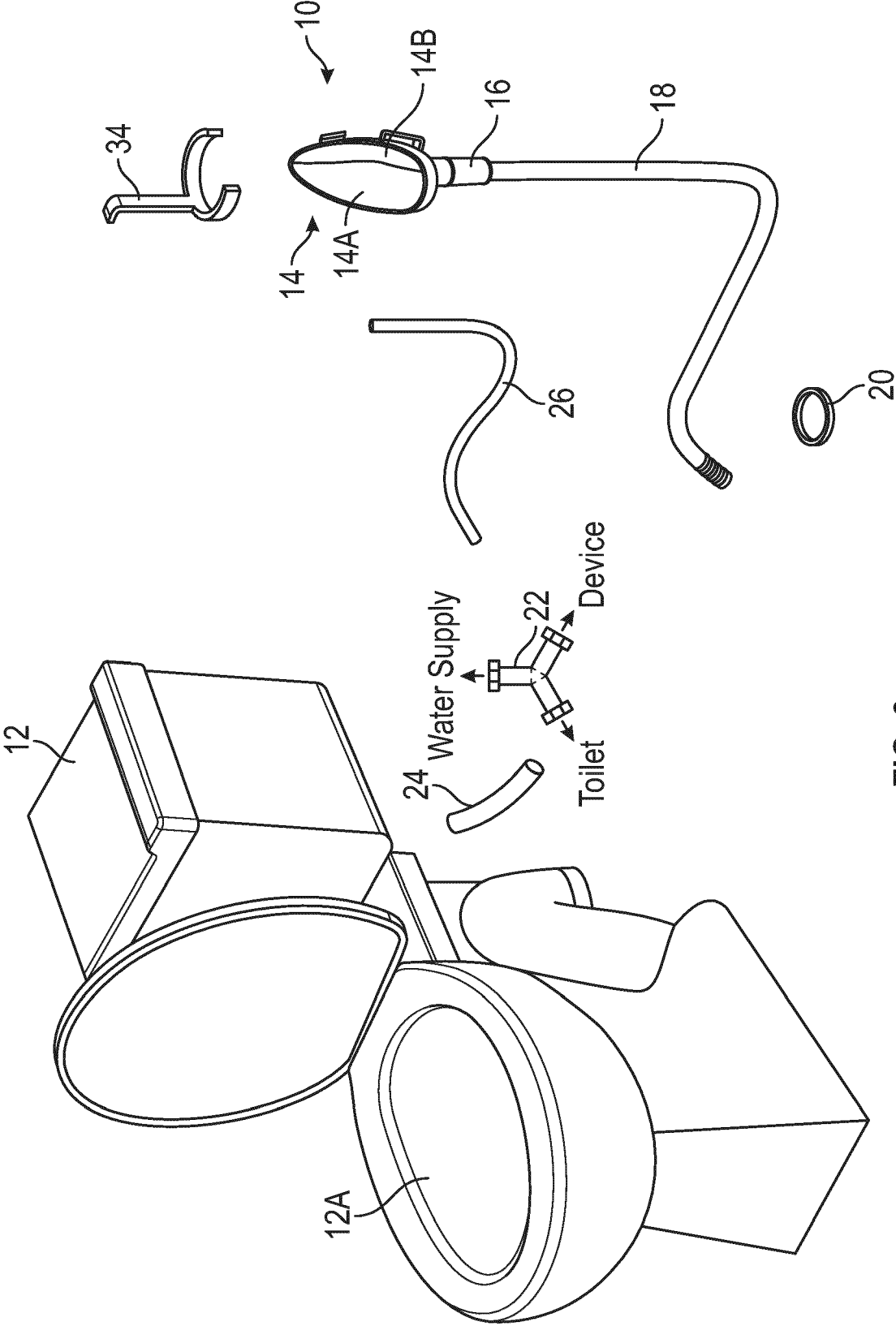

FIG. 1



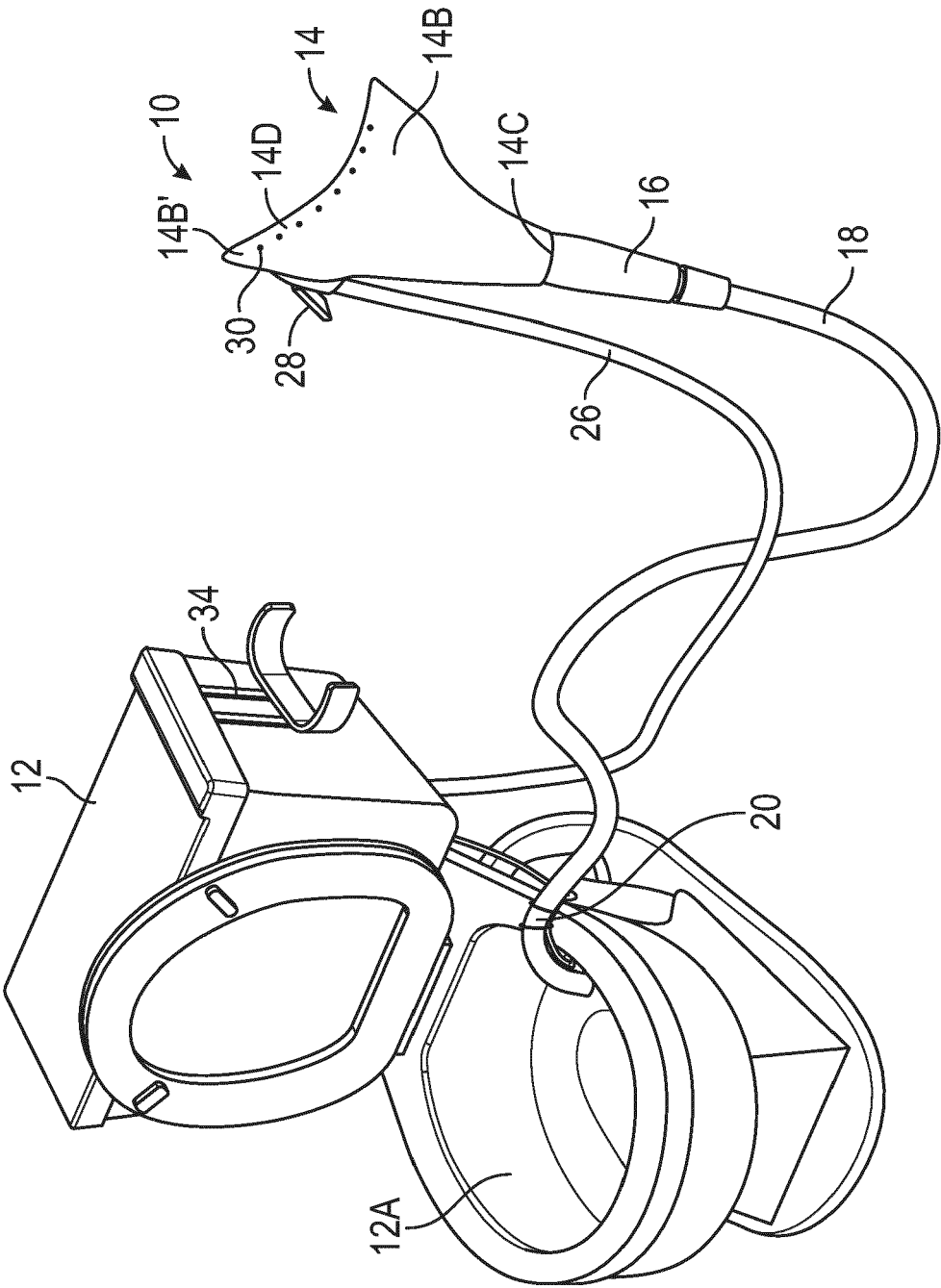

FIG. 3



EUROPEAN SEARCH REPORT

Application Number

EP 23 21 1587

5

10

15

20

25

30

35

40

45

50

55

1

EPO FORM 1503 03.82 (P04C01)

DOCUMENTS CONSIDERED TO BE RELEVANT			
Category	Citation of document with indication, where appropriate, of relevant passages	Relevant to claim	CLASSIFICATION OF THE APPLICATION (IPC)
X	US 2020/217058 A1 (DRAGOMIR PAVEL [US]) 9 July 2020 (2020-07-09) * paragraphs [0001] - [0032]; figures 1A, 1B, 2 *	1, 2, 4, 5, 7	INV. E03D11/02 ADD. E03C1/01 E03D13/00
X	US 3 412 408 A (MICHAL JR JOHN H) 26 November 1968 (1968-11-26) * columns 1-10; figures 1-17 *	1-8	
X	DE 200 18 830 U1 (KRONER ANGELA [DE]) 7 June 2001 (2001-06-07) * pages 1, 2; figures 1-3 *	1, 2, 6, 7	
X	US 5 737 779 A (HADDOCK ROBERT H [US]) 14 April 1998 (1998-04-14) * columns 1-10; figures 1-8 *	1, 2, 4, 6, 7	
A	US 5 499 405 A (COLLINS WILLIAM T [US]) 19 March 1996 (1996-03-19) * abstract; figures 1-3 *	1-8	
A	DE 199 09 669 A1 (BEUTHNER HORST [DE]; JOPE SVEN [DE]) 7 September 2000 (2000-09-07) * abstract; figures 1-6 *	1-8	TECHNICAL FIELDS SEARCHED (IPC) E03D E03C
A	US 5 299 328 A (WALEGA WAYNE [US]) 5 April 1994 (1994-04-05) * abstract; figures 1-14 *	1-8	
The present search report has been drawn up for all claims			
Place of search Munich		Date of completion of the search 11 April 2024	Examiner Posavec, Daniel
CATEGORY OF CITED DOCUMENTS X : particularly relevant if taken alone Y : particularly relevant if combined with another document of the same category A : technological background O : non-written disclosure P : intermediate document T : theory or principle underlying the invention E : earlier patent document, but published on, or after the filing date D : document cited in the application L : document cited for other reasons & : member of the same patent family, corresponding document			

ANNEX TO THE EUROPEAN SEARCH REPORT ON EUROPEAN PATENT APPLICATION NO.

EP 23 21 1587

5 This annex lists the patent family members relating to the patent documents cited in the above-mentioned European search report. The members are as contained in the European Patent Office EDP file on The European Patent Office is in no way liable for these particulars which are merely given for the purpose of information.

11-04-2024

10	Patent document cited in search report	Publication date	Patent family member(s)	Publication date
	US 2020217058 A1	09-07-2020	NONE	
15	US 3412408 A	26-11-1968	NONE	
	DE 20018830 U1	07-06-2001	NONE	
	US 5737779 A	14-04-1998	NONE	
20	US 5499405 A	19-03-1996	NONE	
	DE 19909669 A1	07-09-2000	NONE	
25	US 5299328 A	05-04-1994	NONE	
30				
35				
40				
45				
50				
55				

EPO FORM P0459

For more details about this annex : see Official Journal of the European Patent Office, No. 12/82