

(19)



(11)

**EP 4 470 741 A3**

(12)

**EUROPEAN PATENT APPLICATION**

(88) Date of publication A3:  
**19.02.2025 Bulletin 2025/08**

(51) International Patent Classification (IPC):  
**B28D 1/22 (2006.01)**

(43) Date of publication A2:  
**04.12.2024 Bulletin 2024/49**

(52) Cooperative Patent Classification (CPC):  
**B28D 1/225**

(21) Application number: **24199297.3**

(22) Date of filing: **30.01.2023**

(84) Designated Contracting States:  
**AL AT BE BG CH CY CZ DE DK EE ES FI FR GB  
GR HR HU IE IS IT LI LT LU LV MC ME MK MT NL  
NO PL PT RO RS SE SI SK SM TR**

(72) Inventors:  
• **CASERTELLI, Luigi**  
**21050 CANTELLO (VA) (IT)**  
• **MONTOLI, Vincenzo**  
**21050 CANTELLO (VA) (IT)**

(30) Priority: **01.02.2022 IT 202200001715**

(62) Document number(s) of the earlier application(s) in  
accordance with Art. 76 EPC:  
**23153976.8 / 4 219 110**

(74) Representative: **Faggioni, Carlo Maria et al**  
**Fumero S.r.l.**  
**Pettenkoferstrasse 20/22**  
**80336 München (DE)**

(71) Applicant: **Brevetti Montolit S.P.A.**  
**21050 Cantello (Varese) (IT)**

**(54) IMPROVED MANUAL TILE CUTTING MACHINE**

(57) A manual tile-cutting machine is described, comprising  
a base frame (1, 100) equipped with two supporting posts  
(1a, 1b) where to a guide sliding bar (3) is constrained,  
which guide sliding bar defines a cutting line  
floating plates (2) arranged on an upper portion of said  
base frame (1, 100),  
a tool holder (4) slidingly mounted on said guide sliding  
bar (3), and  
a scaled abutment ruler body (7), rotatably mounted on a  
rotation axis arranged on a front portion of said base  
frame (1, 100) on a longitudinal symmetry axis coinciding

with said cutting line, said abutment ruler body (7) having  
at least one central goniometric body (71), provided with  
a lower articulation pin (7a) coupled with the base frame  
on said rotation axis and wherefrom a major arm (72) and  
a minor arm (73) project opposite to each other defining a  
same rectilinear abutment plane (A-A'),  
said goniometric central body (71) being positioned in the  
proximity of said front post (1a), wherein  
said minor arm (73) is provided with an appendix (74)  
pivotable on a plane perpendicular to said articulation pin  
(7a).

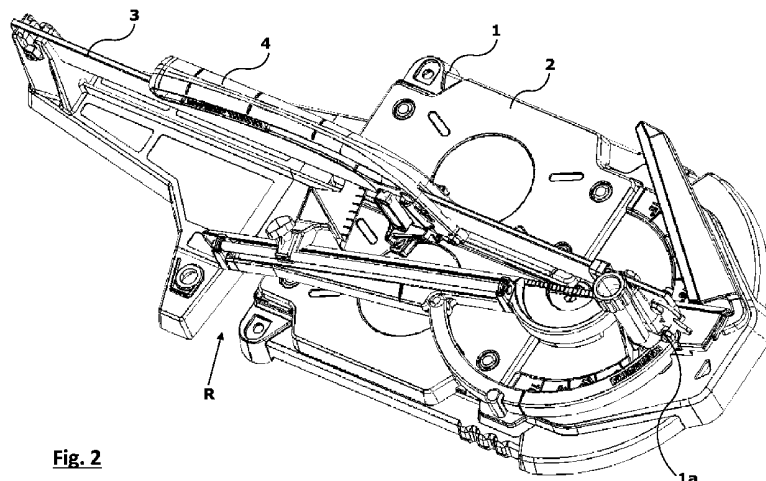
**Fig. 2****EP 4 470 741 A3**



## EUROPEAN SEARCH REPORT

Application Number

EP 24 19 9297

## DOCUMENTS CONSIDERED TO BE RELEVANT

DOCUMENTS CONSIDERED TO BE RELEVANT			
Category	Citation of document with indication, where appropriate, of relevant passages	Relevant to claim	CLASSIFICATION OF THE APPLICATION (IPC)
Y	EP 0 608 476 A2 (MONTOLIT BREVETTI [IT]) 3 August 1994 (1994-08-03)	1,2,8-11	INV. B28D1/22
A	* column 9, lines 14-27 * * figures 2,3,11 * -----	3-7,12	
Y	EP 1 072 371 A2 (SKC DI TONDINI CLAUDIO [IT]) 31 January 2001 (2001-01-31)	1,2,8-11	
A	* paragraph [0017] * * figures 1,2 * -----	3-7,12	<div>TECHNICAL FIELDS SEARCHED (IPC)</div> <div>B28D</div>
A	KR 200 245 803 Y1 (UNKNOWN) 17 October 2001 (2001-10-17) * paragraphs [0007], [0017], [0018], [0032] * * figures * -----	1-12	
A	ES 2 342 244 B1 (INTERNAC DE ELEVACION S A [ES]) 12 May 2011 (2011-05-12) * page 4, lines 42-47 * * figures 1-4 * -----	1-12	
A	KR 101 048 166 B1 (JEON BYUNG KOOK [KR]) 8 July 2011 (2011-07-08) * paragraph [0032] * * figures 1,2 * -----	1-12	
A	EP 3 747 611 A1 (ROMWAY ZJ MACHINERY MFG CO LTD [CN]) 9 December 2020 (2020-12-09) * figure 3 * -----	1-12	
A	WO 2004/030883 A1 (MONTOLIT BREVETTI [IT]; CASARTELLI LUIGI [IT]; MONTOLI VINCENZO [IT]) 15 April 2004 (2004-04-15) * page 6 * * figures 1,3,4,5A,5B * -----	1-12	
The present search report has been drawn up for all claims			
Place of search		Date of completion of the search	
The Hague		12 December 2024	Chariot, David
CATEGORY OF CITED DOCUMENTS		T : theory or principle underlying the invention E : earlier patent document, but published on, or after the filing date D : document cited in the application L : document cited for other reasons ..... & : member of the same patent family, corresponding document	
X : particularly relevant if taken alone Y : particularly relevant if combined with another document of the same category A : technological background O : non-written disclosure P : intermediate document			

# ANNEX TO THE EUROPEAN SEARCH REPORT ON EUROPEAN PATENT APPLICATION NO.

EP 24 19 9297

This annex lists the patent family members relating to the patent documents cited in the above-mentioned European search report. The members are as contained in the European Patent Office EDP file on  
The European Patent Office is in no way liable for these particulars which are merely given for the purpose of information.

12 - 12 - 2024

Patent document cited in search report	Publication date	Patent family member(s)	Publication date
EP 0608476 A2	03-08-1994	AT E175144 T1	15-01-1999
		DE 69322848 T2	29-06-2000
		EP 0608476 A2	03-08-1994
		ES 2128374 T3	16-05-1999
		IT 1265977 B1	16-12-1996
EP 1072371 A2	31-01-2001	EP 1072371 A2	31-01-2001
		IT BO990091 U1	13-01-2001
KR 200245803 Y1	17-10-2001	NONE	
ES 2342244 B1	12-05-2011	NONE	
KR 101048166 B1	08-07-2011	NONE	
EP 3747611 A1	09-12-2020	CN 210633887 U	29-05-2020
		EP 3747611 A1	09-12-2020
		US 2020376711 A1	03-12-2020
WO 2004030883 A1	15-04-2004	AT E430009 T1	15-05-2009
		AU 2003273915 A1	23-04-2004
		EP 1545849 A1	29-06-2005
		ES 2324777 T3	14-08-2009
		WO 2004030883 A1	15-04-2004